

T. 7 S., R. 5 W., W.M.  
 POLK COUNTY  
 PARVIPES MARSH (9M)

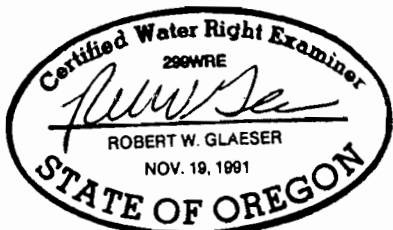

4/17/2000

THE PURPOSE OF THIS MAP IS TO IDENTIFY THE LOCATION OF THE WATER RIGHT. IT IS NOT INTENDED TO PROVIDE INFORMATION RELATIVE TO THE LOCATION OF PROPERTY OWNERSHIP BOUNDARY LINES.

POINT OF DIVERSION IS WEST 825 FEET AND SOUTH 825 FEET FROM THE NORTH QUARTER CORNER, SECTION 14, T.7S., R.5W.

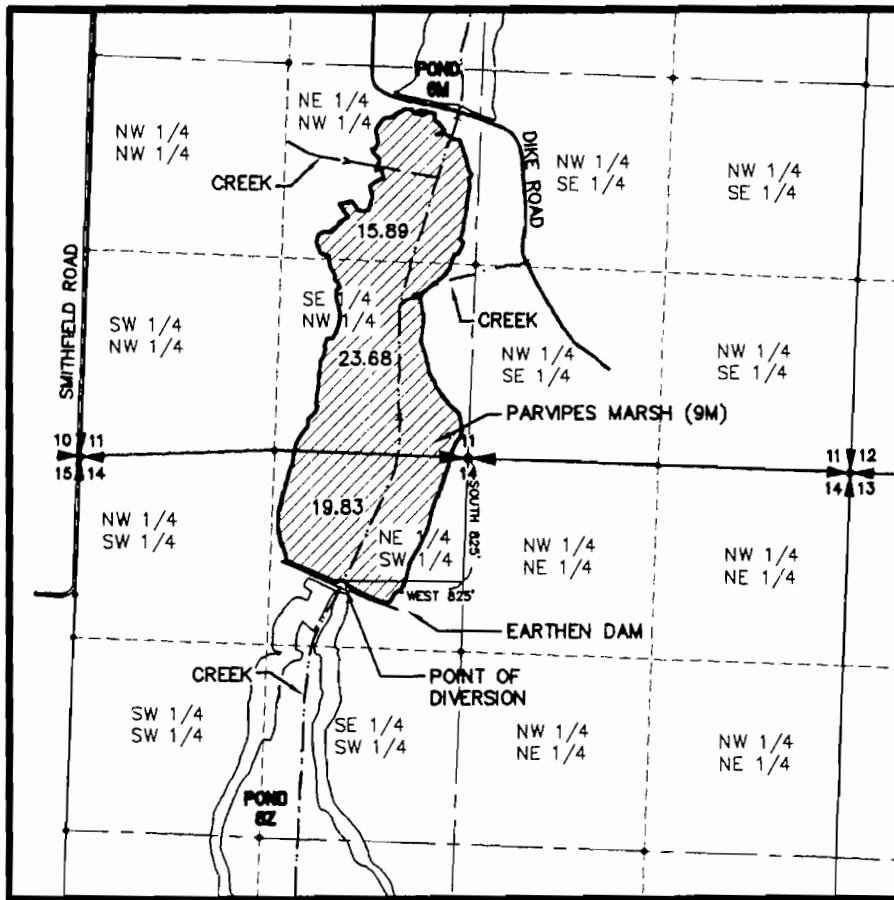

**RECEIVED**

SEP 27 2000

SCALE: 1"=1320'

**FINAL PROOF SURVEY**

UNDER

APPLICATION NO. R-81066 PERMIT NO. R-11973

IN THE NAME OF

U.S FISH AND WILDLIFE SERVICE

SURVEYED AUGUST 11, 1999 BY *Robert W. Glaeser*

WATER RESOURCES DEPT.  
 SALEM, OREGON