

CLAIM OF BENEFICIAL USE SURVEY G17821  
T39S R7W S31 W.M. - ROGUE RIVER BASIN - JOSEHPINE COUNTY OREGON

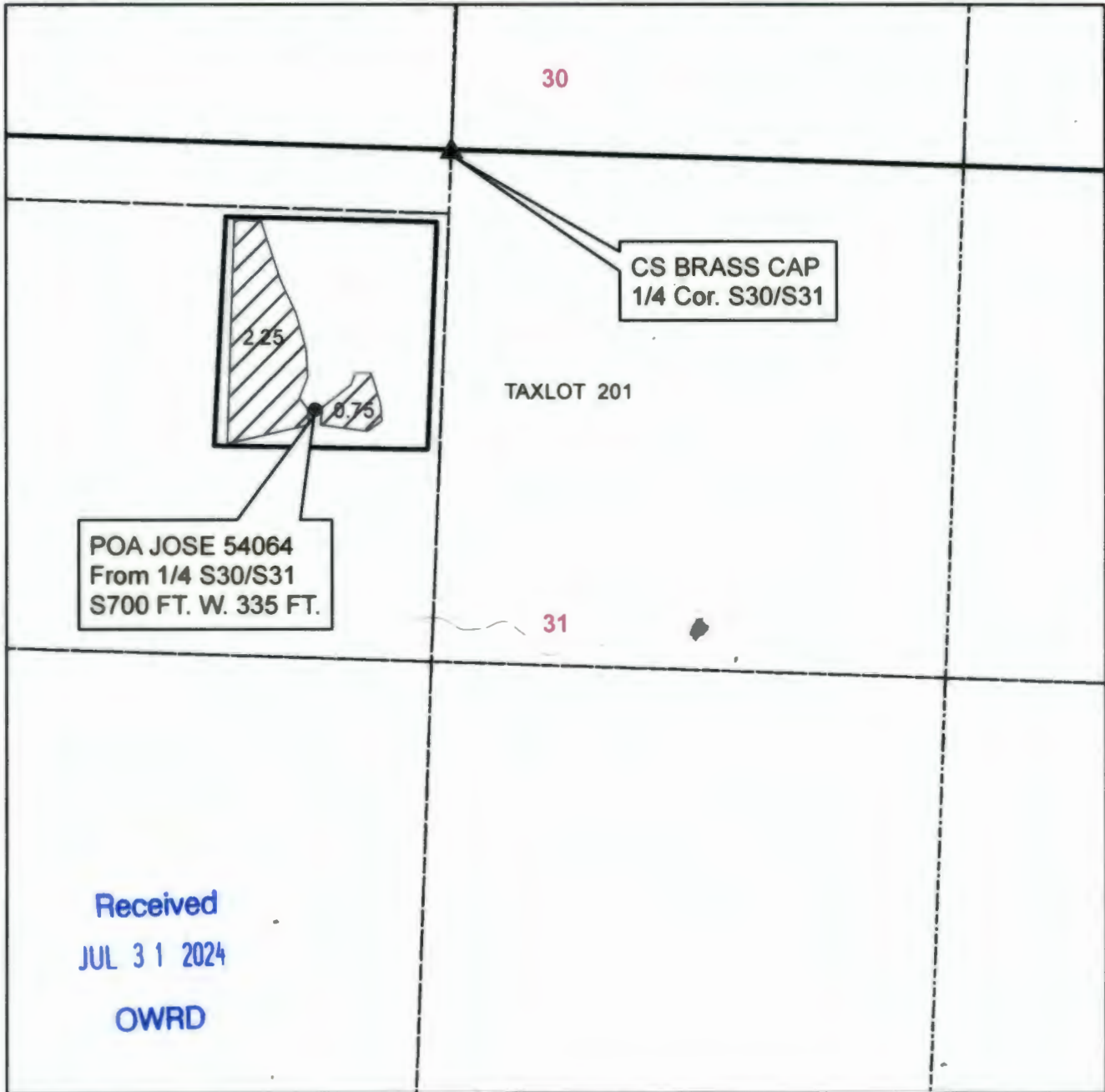

1 inch = 400 feet

PREPARED FOR:  
Rhea Taylor  
280 Garner Rd.  
Cave Junction, OR 97523

Received by OWRD  
SEP 03 2024  
Salem, OR

PREPARED BY:  
Scott Fein, CWRE  
600 Tyler Creek Rd.  
Ashland, OR 97520  
sfeinsurveyor@gmail.com  
541-842-0795

FOR WATER RIGHTS PURPOSES ONLY  
NOT FOR PROPERTY BOUNDARY LOCATIONS  
OR DIMENSIONS.

