

Name ROUGH & READY LUMBER COMPANY
 By - Lew F. Krauss
 Address Box 222
Cave Junction, Oregon

Application No. 29971
 Permit No. 23609
 Certificate No. 22621

FEEES PAID

| Date | Amount | Receipt No. |
|---------|----------------------------|-------------|
| 5-10-55 | 20.00 | 3773 |
| | | |
| | | |
| | | |
| 4/12/57 | B. P. Fee \$1 Cert. Fee | 11287 |

Stream Index, Page No. 15-56 F
 See - R-29970

FEEES REFUNDED

| Date | Amount | Check No. |
|------|--------|-----------|
| | | |
| | | |

Date filed May 9, 1955
 Priority May 9, 1955
 Action suspended until _____

ASSIGNMENTS

| Date | To Whom | Address | Volume | Page |
|------|---------|---------|--------|------|
| | | | | |
| | | | | |

Returned to applicant _____
 Date of approval September 22, 1955

CONSTRUCTION

Date for beginning September 22, 1956
 Date for completion October 1, 1957
 Extended to _____
 Date for application of water October 1, 1958
 Extended to _____

REMARKS

1.0 cfs from Rough and Ready Mill Pond and Rough and Ready Creek for log pond
SEP 24 1956 CARD FOR A

PROSECUTION OF WORK

Form "A" filed _____
 Form "B" filed September 27, 1956
 Form "C" filed September 27, 1956

FINAL PROOF

Blank mailed MAR 26 1957
 Proof received _____
 Date certificate issued APR 12 1957

OWNERSHIP UPDATE

5.28.85 

Form B

Application No. 23609 & R-1750

NOTICE OF COMPLETION OF CONSTRUCTION

I, The Rough and Ready Lumber Company, the holder of Permit No. 23609 & R-1750 to appropriate the public waters of the state of Oregon, completed the construction of the works described therein on the 1st day of October, 19 55.

Remarks: If the works have less capacity than described in the permit, or you have definitely abandoned part of the proposed development, you should so state in order that our records may not be unnecessarily encumbered.

IN WITNESS WHEREOF, I have hereunto set my hand this 26 day of September, 19 56. By: Lew F. Krauss, Partner (Signature of Applicant) P. O. Box 222, Cave Junction, Oregon (Address)

Fill out, detach, and mail to the State Engineer, Salem, Oregon, when construction work is completed.

Form C

IMPORTANT—This form is a notice to the State Engineer that permittee is ready to make final proof to the extent to which the water has actually been applied to the intended use under the terms of the permit. Permittee is cautioned that Certificate of Water Right will be issued based on the extent of the quantity and use as determined by the final proof inspection and survey which will be made in response to the filing of this Form C.

NOTE: In the case of an irrigation permit, this Form C should not be mailed to the State Engineer until all of the land described in the permit, which it is intended to irrigate under this permit at any time, has actually been irrigated. Fill out, detach and mail to the State Engineer, Salem, Oregon, when all of the water has been applied.

Application No. 23609 & R-1750

NOTICE OF COMPLETE APPLICATION OF WATER TO A BENEFICIAL USE

I, The Rough and Ready Lumber Company, the holder of Permit No. 23609 & R-1750 to appropriate the public waters of the state of Oregon, completely applied the waters to a beneficial use in accordance with the terms of said permit, on the 1st day of October, 19 55.

Remarks: This has been ready for your approval for almost a year. We were under the impression that you had been notified.

IN WITNESS WHEREOF, I have hereunto set my hand this 26th day of September, 19 56. By: Lew F. Krauss, Partner (Signature of Applicant) P. O. Box 222, Cave Junction, Oregon (Address)



Oregon Water Resources Department
 725 Summer Street NE, Suite A
 Salem, Oregon 97301
 (503) 986-0900
 www.wrd.state.or.us

Ownership Update For Certificated Rights Only

NO FEES ARE REQUIRED TO SUBMIT THIS FORM

NOTICE: A certificate of water right typically stays with the land. In order to track water right ownership, the Department requests that this form be submitted to the Department. **To update multiple rights, a separate form is required for each right.**

If you have any questions about this form, please contact your local watermaster, or call the Water Resources Department at (503) 986-0900.

This form is not for Applications, Permits, Transfers, Groundwater Registrations, or Limited Licenses. To notify the Department of changes in ownership to these types of authorizations, an Assignment is required.

Current Landowner Information

Name: Michael A. Griggs, Jr. - Junior Bear Property Management LLC
 Mailing Address: 475 East San Francisco Ave.
 City: Willits State: CA Zip: 95490
 Phone (Home): _____ Work: 707-459-3576 Other: Cell 707-354-6796

Property Description

County: Josephine Township: 40 S Range: 08 W Section: 8
 Taxlot Number(s): 2700
 Street Address of water right property: 30365 Redwood Highway, Cave Junction, OR 97526
 Water Right Information: Application: S - 29971 Permit: S - 23609 Certificate #: 22621

Are all the lands associated with this water right owned by the requester? Yes No _____ If No, include a map showing the portion of the right involved.

Name of individual completing this form: Andrew Hosford Phone: 707-354-1218
 Signature of requestor: _____ Date: 6/27/2018

The Department does not change names on certificates. This form will be placed in the file for future reference only. The Department does not provide acknowledgement that this form has been received.



Oregon Water Resources Department
 725 Summer Street NE, Suite A
 Salem, Oregon 97301
 (503) 986-0900
 www.wrd.state.or.us

Ownership Update For Certificated Rights Only

NO FEES ARE REQUIRED TO SUBMIT THIS FORM

NOTICE: A certificate of water right typically stays with the land. In order to track water right ownership, the Department requests that this form be submitted to the Department. **To update multiple rights, a separate form is required for each right.**

If you have any questions about this form, please contact your local watermaster, or call the Water Resources Department at (503) 986-0900.

This form is not for Applications, Permits, Transfers, Groundwater Registrations, or Limited Licenses. To notify the Department of changes in ownership to these types of authorizations, an Assignment is required.

Current Landowner Information

Name: Michael A. Griggs, Jr. Junior Bear Property Management LLC
 Mailing Address: 475 East San Francisco Ave.
 City: Willits State: CA Zip: 95490
 Phone (Home): _____ Work: 707-459-3576 Other: Cell 707-354-6796

Property Description

County: Josephine Township: 40 S Range: 08 W Section: 8
 Taxlot Number(s): 2700
 Street Address of water right property: 30365 Redwood Highway, Cave Junction, OR 97526
 Water Right Information: Application: S - 29971 Permit: S - 23609 Certificate #: 22621

Are all the lands associated with this water right owned by the requester? Yes No _____ If No, include a map showing the portion of the right involved.

Name of individual completing this form: Andrew Hosford Phone: 707-354-1218
 Signature of requestor: _____ Date: 06/27/2018

The Department does not change names on certificates. This form will be placed in the file for future reference only. The Department does not provide acknowledgement that this form has been received.

RECEIVED
 WR JUL 03 2018
 OWRD

RECEIVED
MAY 9 1955
STATE ENGINEER
SALMON, OREGON

T. 40 S., R's 8 and 9 W., W.M.
Scale 4" = 1 mile
May 1955
Rough & Ready Lbr. Co. by Lewis F. Krauss.

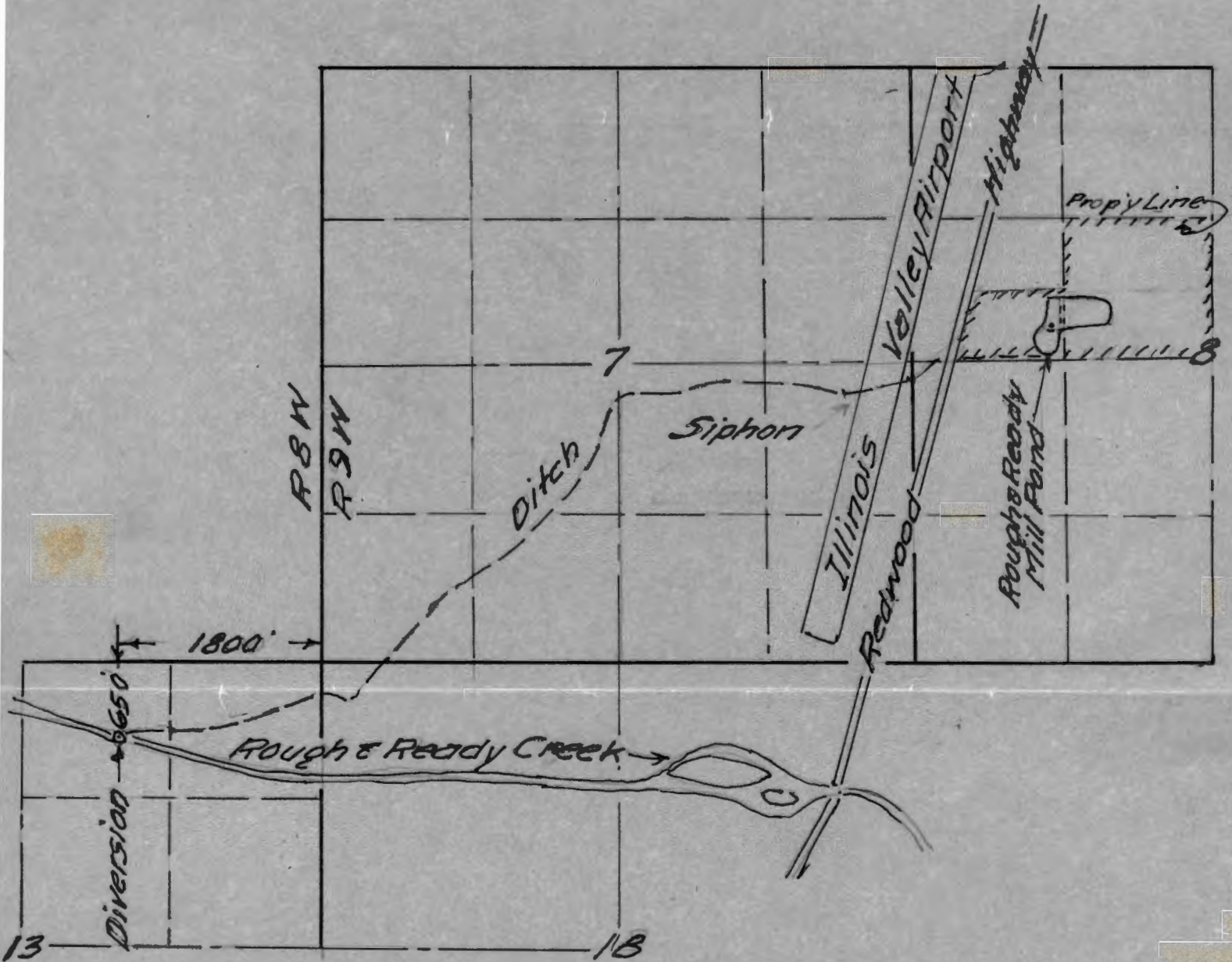

R-29970-1

Application No. R-29970 & 29971
Permit No. R-1750 & 23609

Permit No. 23609

Application No. 29971

County Josephine

Proof of Appropriation of Water

1. Name Rough & Ready Lumber Co.
By Lew F. Krauss
2. Address Box 222; Cave Junction, Oregon
3. Source of supply Rough & Ready mill pond to be constructed under Application No. R-29970,
Permit No. R-1750. and Rough and Ready Creek.
Tributary of West Fork Illinois River
4. Amount of water 1.0 ~~0.5~~ CFS
5. Priority date May 9, 1955
6. Use log pond
7. Location of point of diversion NW $\frac{1}{4}$ NE $\frac{1}{4}$ Sec. 13, Twp. 40 S, Range 9 W, W. M.
(Legal Subdivision)
8. The description of land given below corresponds to that found in your permit covering land to be irrigated, or, if for other purposes, the place of use.

| Township | Range | Section | Legal Subdivision | No. Acres Actually Irrigated |
|---|-------|---------|----------------------------------|---------------------------------|
| 40 S | 8 W | 8 | S $\frac{1}{2}$ NW $\frac{1}{4}$ | mill pond |
| Description: Beginning at the SE corner of the SW $\frac{1}{4}$ NW $\frac{1}{4}$ pf S. 8 in T. 40 S., R. 8 W. WM., in Oregon, and running N. 660 feet; thence W. to the Easterly right of way line of the Redwood Highway; thence Southerly along the Easterly right of way line of the Redwood Highway to the S. line of the SW $\frac{1}{4}$ NW $\frac{1}{4}$ of said Section 8; thence E. to beginning. Also the SE $\frac{1}{4}$ NW $\frac{1}{4}$ of S. 8, T. 40 S., R. 8 W., WM. Josephine County, Oregon | | | | |
| | | | | |
| | | | | |
| | | | | |
| | | | | |
| | | | | |
| | | | | |
| | | | | |

I have read the above and foregoing proof of appropriation of water; I know the contents thereof, and that the facts therein stated are true.

IN WITNESS WHEREOF, I have hereunto set my hand this day of

19.....

Diversion Point: Combination log crib concrete Str. 100' long 8' high
locally known as Seatts Dam, water enters Ditch through
+ 8' of 18" Riveted pipe - 36' head over Invert.
1st 500' of Ditch is overflow Section.

Q measured below overflow section = 5 C.F.S.

ditch measurements: T.W. = 3', bw = 2' d = .9 V = 2.5 F.P.S.

Use: Evaporation, Estimated = .3"/day Perches.

mill Pump - 2 H.P. Berkley - 206 Electric Pump - Mr. Krauss's
Agent Stated Pump operates 60% of Shift

Fire Sprinkler pump: 20 H.P. NO K-34822 Fairbanks make.

4 sprinkler heads - 12 g.p.m.

no Seeps observed with Full reservoir, Mr. Krauss's Agent
stated "no Seeps in Pond".

Estimated Median High Ditch losses with proper control &
maintenance could be cut down, very Rough Ditch Section.

Recommnd 0.5 C.F.S.

Albert M. Petzka,
Engineer. 7/6/57

February 26, 1964

Mr. R. L. Templin, Jr.
County Engineer
Department of Roads
Room 120, Courthouse
Grants Pass, Oregon

Dear Mr. Templin:

The plans for the Rough and Ready Log Ponds have been examined and are being returned to you for additional information on two items.

1. There appears to be an error in the capacity curve. My computations would indicate a capacity of just over 100 acre feet for all ponds.
2. Would you indicate by note or sketch, the location and type of control on valve of the 18" C.M.P. outlet pipe.

Aside from these two points, the plans appear to adequately represent the existing structures and the changes you propose.

The reservoir application is being returned so that data agreeing with your plans can be shown on the application. It appears that the original application did not make proper allowance for borrow from the interior of the log ponds. Therefore, this application should cover the increased storage. The increased storage is considered to be in all four ponds. Changes should be made in the following items of the application:

- Item 3: The capacity shown should be the difference between the existing capacity and 57.6 acre feet for which a right exists. A notation should be entered in the remarks indicating that the 57.6 acre feet is covered by certificate number 22620.
- Item 5: Should be amended to include SW & NW to include two western ponds.
- Item 6: Location should be amended as above. Maximum height appears to be about 16 feet at northeast corner of old

February 26, 1964

pond. Lengths of dike would be total lengths of old and new dikes. Top width should be minimum proposed top width. Upstream slope appears to be steeper than 3:1. Height of dam above water line should be minimum that will exist at any point where pond is contained by dike.

- Item 8: Should show location and dimensions of the proposed new concrete wasteway.
- Item 9: Should describe the 18" C.M.P. outlet pipe.
- Item 10: The total surface area, maximum depth and mean depth should be shown here.

The application has been endorsed so that in order to retain its priority, it should be returned to this office on or before April 27, 1964.

Very truly yours,

CHRIS L. WHEELER
State Engineer

By
Jerry L. Eggleston,
Engineer

JWB:ngb
Enclosure

cc: Laurence A. Cushing
Attorney at Law
P. O. Box 254
Cave Junction, Oregon

R-38503
38525
R-29970
29971

December 13, 1963

Mr. Richard Templin
County Engineer
County Courthouse
Grants Pass, Oregon

Dear Mr. Templin:

Mr. Cushing has told me that you are the engineer preparing the plans for the Rough and Ready Lumber Company log pond near Cave Junction. I inspected the log pond on December 9, 1963, but was not able to talk with you about it before I left Grants Pass on December 10. Mr. Petska will probably be in Grants Pass during the latter part of next week and will be happy to meet with you to discuss any questions you may have about our requirements for these plans.

Very truly yours,

CHRIS L. WHEELER
State Engineer

By
Jerry W. Eggleston,
Engineer

J:Singh
CC: Laurence A. Cushing
Attorney at Law
P. O. Box 23A
Cave Junction, Oregon

R-38583
38525
R-29970
29971

MEMORANDUM OF INSPECTION

Rough and Ready Lumber Company Log Pond

With Robert Steiner this log pond was inspected on December 9, 1963.

A fill appears to have been constructed with a bulldozer by pushing material from below the downstream toe up onto the dam. The material consists of sand, silt and boulders. There was very little seepage noted at the toe although the pond has evidently been full for some time. The maximum height of the dam is $16\frac{1}{2}$ feet with a crest width of approximately six feet minimum. At the northeast corner of the pond is an 18-inch corrugated metal pipe outlet and near the northwest corner there is a wood flume overflow across the crest with a bottom width of 21 inches and a depth of $11\frac{1}{2}$ inches. Along the west side the pond has been formed entirely by excavation. At the present time little damage would be done by a breach of the dike since the water would have to spread over a large area before reaching any structures.

By
Jerry W. Eggleston,
Engineer

R-29970
29971

April 9, 1957

Rough and Ready Lumber Co.
By Lew F. Krauss
Box 222
Cave Junction, Oregon

Gentlemen:

This will acknowledge receipt of the signed final proof forms in connection with your Permit Nos. R-1750 and 23609 and \$1 certificate recording fee for which our receipt No. 11203 is enclosed.

Please be advised that there is a \$1 certificate recording fee for each permit, and if you will now submit the recording fee for Permit No. 23609 further action will be taken toward the issuance of the desired certificates.

Very truly yours,

LEWIS A. STANLEY
State Engineer

By
Trevor Jones, Assistant

ld
enc. receipt

29971 &
R-29970

March 26, 1957

Rough & Ready Lumber Co.
By Lew F. Krauss
Box 222
Cave Junction, Oregon

Gentlemen: We are enclosing herewith for completion, final proof in connection with the incomplete water right represented by your Permit No. 23609 granting a right to the use of 0.5 cfs of the waters of Rough & Ready mill pond and Rough & Ready Creek, and Permit No. R-1750 for 57.6 a.f. from Rough & Ready Creek for storage of water and mill pond.

The data contained in the proof, which is based on an inspection ~~and survey~~ of your project made by a representative of this department, defines the extent to which your water right has been completed within the terms of your Permit. The proof should be dated and signed by you on the second sheet under the Affidavit of Appropriator and returned to this office.

Upon receipt of the proof, properly executed and accompanied by the statutory fee of \$1, a Certificate of Water Right will be issued confirming the rights thereunder and, after being recorded in the records of Josephine County, will be forwarded to you.

In the interest of economy and due to the fact that your completed project was examined by a representative of this department, it is not necessary that your signature be made before a Notary Public, nor that the signatures of witnesses be affixed to the proof.

Yours very truly,

Lewis A. Stanley
LEWIS A. STANLEY
State Engineer

Form 117
mb
Enclosure

P. S. \$1.00 for each Permit

January 14, 1957

Rough and Ready Lumber Co.
Cave Junction
Oregon

Attention: Lew F. Krauss, Partner

Gentlemen:

Our field crews normally make final proof surveys during the summer months and prepare the maps and reports during the winter, however since your permits describe only a log pond we will make an attempt to have an inspection made by the engineer in charge of hydraulic structures. He tentatively plans on being in your area during the latter part of this month or the first part of February and he will contact someone at the mill office prior to making the inspection.

Very truly yours,

LEWIS A. STANLEY
State Engineer

By
Trevor Jones, Assistant

TJ:ld

ROUGH AND READY LUMBER COMPANY

CAVE JUNCTION, OREGON

January 10, 1957

Lewis A. Stanley, State Engineer
State of Oregon
Water Resources Department
Salem, Oregon

RECEIVED
JAN 11 1957
STATE ENGINEER
SALEM, OREGON

Re: File No. 29971 & R-29970

Dear Mr. Stanley:

Please refer to your letter of October 1, 1956.

We are anxious to have the survey made and the certificate issued.

We would appreciate you advising us when the survey is made.

Very truly yours,

ROUGH AND READY LUMBER COMPANY

By

Lew F. Krauss
Lew F. Krauss, Partner

LFK/p

BRIGHT WATER

DELIBLE BOND

FAC CONTENT

29971 &
R-29970

October 1, 1956

Rough & Ready Lumber Co.
Box 222
Cave Junction, Oregon

Gentlemen:

This will acknowledge receipt of your notice to the effect that complete application of water has been made under Permit No. 23609 & R-1750.

Pursuant to your report and in line with the general practice of this office, a survey will be made at a later date. After this survey, proof may be made and certificate issued covering the actual use of water as found by the engineer. In the case of irrigation, any lands described in the permit that have not been irrigated will be automatically eliminated from the water right.

In the meantime, the permit which you hold will be valid evidence of the water right in question so long as you continue to use the water.

Very truly yours,

Lewis A. Stanley

LEWIS A. STANLEY
State Engineer

Form 128

October 6, 1955

R-29970 & 29971'

Rough and Ready Lumber Company
Box 222
Cave Junction, Oregon

Gentlemen:

R-29970, Permit No. R-1750, and
Application No. 29971, Permit No. 23609, together with blueprint.

R-29970
29971

June 30, 1955

Mr. Tom R. Pearce
Watermaster, District No. 16
Grants Pass, Oregon

Dear Mr. Pearce:

This will acknowledge receipt of your letter of May 27, 1955, with which you enclosed completed Application No. R-29970 to construct a reservoir and store therein 57.6 acre feet of water, and No. 29971 to appropriate 1.0 cubic feet of water per second from Rough & Ready Mill Pond and Rough & Ready Creek for a log pond.

Both applications in the name of the Rough & Ready Lumber Company, now appear to be in satisfactory form.

Very truly yours,

LEWIS A. STANLEY
State Engineer

By
Chris L. Heeler, Assistant

CLW:ld

WATER RESOURCES DEPARTMENT

ALL COMMUNICATIONS TO
R. PEARCE, ENGINEER
COURT HOUSE
GRANTS PASS, OREGON

STATE OF OREGON
OFFICE OF
WATER DISTRICT No. 16
GRANTS PASS, OREGON

WATERMASTER DISTRICT No. 16
OREGON REGISTERED ENGINEER No. 838
CALIFORNIA LICENSED SURVEYOR No. 2301

May 27, 1955

RECEIVED
MAY 31 1955
STATE ENGINEER
SALEM, OREGON

Mr. Lewis A. Stanley
State Engineer
303 State Office Building

Re: File No. R-29970
29971

ATTENTION: Robert D. Best, Assistant

Dear Mr. Stanley:

We are returning herewith corrected applications in the name of Rough & Ready Lbr. Co. and also enclosed is plan and topography of the reservoir and a detail design of a section of the dam and spill-way. In our previous letter we sent you the "Additional information to be Submitted with Application Proposing Construction of Dams less than 10 feet in height". This dam or dike for the most part is less than 10 feet in height but the water impounded is considerably more than the three million gallons. In my opinion the specifications shown on this information are sufficient for the construction of this dam. The company has their own equipment for making construction and unless it is very essential we will omit sending detailed specifications.

I hope the plans I am sending you are sufficient, but Mr. Krauss, manager of the Rough & Ready Lbr. Co., requested that I send you such detail as is necessary, and I will be pleased to make corrections or perform further services if you think it is necessary.

Very truly yours,

Tom R. Pearce

Tom R. Pearce
Watermaster, District No. 16

TRP:rm

cc: Lew F. Krauss

R-29970
29971

May 26, 1955

Mr. Tom R. Pearce
Watermaster, District No. 16
Court House
Grants Pass, Oregon

Dear Mr. Pearce:

This will acknowledge receipt of an application in the name of the Rough and Ready Lumber Company for a permit to construct Rough and Ready Mill Pond and store 28 acre feet of water therein and an application for a permit to appropriate 1.0 second foot of water from Rough and Ready Creek and mill pond for log pond, map and print to accompany the applications, data sheet and check in the amount of \$35, for which our receipts No. 3772 and 3773 are enclosed. The applications have been examined, and given file Nos. R-29970 and 29971.

Pursuant to the request in your letter of May 24, the applications are enclosed herewith, endorsed so that in order to retain their dates of priority they must be returned to this office on or before June 27, 1955.

Very truly yours,

LEWIS A. STANLEY
State Engineer

By
Robert D. Best, Assistant

RDB:bc
Encs.