

Name Lew F. Krauss, Helen C. Krauss, Fred R. Krauss, Lewis N. Krauss and John P. Krauss
By a partnership, dba Rough & Ready Lumber Co.

Address P. O. Box 222, 326
Cave Junction, Oregon 97523

Date filed March 20, 1963
Priority March 20, 1963
Action suspended until OKurt

Returned to applicant _____
Date of approval March 24, 1964

CONSTRUCTION

Date for beginning March 24, 1965
Date for completion October 1, 1966
Extended to _____
Date for application of water October 1, 1967
Extended to _____

PROSECUTION OF WORK

Form "A" filed _____
Form "B" filed Complete
Form "C" filed May 20, 1965

FINAL PROOF

Blank mailed JULY 9 1968
Proof received _____
Date certificate issued JULY 29 1968

Application No. 4 38525
Permit No. 29196
Certificate No. 35149

Stream Index, Page No. 15-56 H
see file - R 38583

FEES PAID

Date	Amount	Receipt No.
<u>3/20/63</u>	<u>15.00</u>	<u>37750</u>
<u>4-25-63</u>	<u>5.00</u>	<u>37780</u>
	B. P. Fee	
<u>7-15-68</u>	<u>\$1 Cert. Fee</u>	<u>10513</u>

FEES REFUNDED

Date	Amount	Check No.

ASSIGNMENTS

Date	To Whom	Address	Volume	Page

REMARKS

0.50 c.f.s. from Rough and Ready Creek and Rough and Ready Mill Pond for industrial use including maintenance of log pond. (Subject to S.W.R.B. Policy Statement).

OWNERSHIP UPDATE

W.R.I.S.
 Assembled 8.6.85 by [Signature]
 Entered _____ by _____
 Verified _____ by _____



Oregon Water Resources Department
 725 Summer Street NE, Suite A
 Salem, Oregon 97301
 (503) 986-0900
 www.wrd.state.or.us

Ownership Update For Certificated Rights Only

NO FEES ARE REQUIRED TO SUBMIT THIS FORM

NOTICE: A certificate of water right typically stays with the land. In order to track water right ownership, the Department requests that this form be submitted to the Department. **To update multiple rights, a separate form is required for each right.**

If you have any questions about this form, please contact your local watermaster, or call the Water Resources Department at (503) 986-0900.

This form is not for Applications, Permits, Transfers, Groundwater Registrations, or Limited Licenses. To notify the Department of changes in ownership to these types of authorizations, an Assignment is required.

Current Landowner Information

Name: Michael A. Griggs, Jr. - Junior Bear Property Management LLC
 Mailing Address: 475 East San Francisco Ave.
 City: Willits State: CA Zip: 95490
 Phone (Home): _____ Work: 707-459-3576 Other: Cell 707-354-6796

Property Description

County: Josephine Township: 40 S Range: 08 W Section: 8
 Taxlot Number(s): 2700
 Street Address of water right property: 30365 Redwood Highway, Cave Junction, OR 97526
 Water Right Information: Application: S - 38525 Permit: S - 29196 Certificate #: 35149

Are all the lands associated with this water right owned by the requester? Yes No _____ If No, include a map showing the portion of the right involved.

Name of individual completing this form: Andrew Hosford Phone: 707-354-1218
 Signature of requestor: [Signature] Date: 06/27/2018

The Department does not change names on certificates. This form will be placed in the file for future reference only. The Department does not provide acknowledgement that this form has been received.

RECEIVED
 WR
 JUL 03 2018
 OWRD



Oregon Water Resources Department
 725 Summer Street NE, Suite A
 Salem, Oregon 97301
 (503) 986-0900
 www.wrd.state.or.us

Ownership Update For Certificated Rights Only

NO FEES ARE REQUIRED TO SUBMIT THIS FORM

NOTICE: A certificate of water right typically stays with the land. In order to track water right ownership, the Department requests that this form be submitted to the Department. **To update multiple rights, a separate form is required for each right.**

If you have any questions about this form, please contact your local watermaster, or call the Water Resources Department at (503) 986-0900.

This form is not for Applications, Permits, Transfers, Groundwater Registrations, or Limited Licenses. To notify the Department of changes in ownership to these types of authorizations, an Assignment is required.

Current Landowner Information

Name: Michael A. Griggs, Jr. - Junior Bear Property Management LLC
 Mailing Address: 475 East San Francisco Ave.
 City: Willits State: CA Zip: 95490
 Phone (Home): _____ Work: 707-459-3576 Other: Cell 707-354-6796

Property Description

County: Josephine Township: 40 S Range: 08 W Section: 8
 Taxlot Number(s): 2700
 Street Address of water right property: 30365 Redwood Highway, Cave Junction, OR 97526
 Water Right Information: Application: S - 38525 Permit: S - 29196 Certificate #: 35149

Are all the lands associated with this water right owned by the requester? Yes No _____ If No, include a map showing the portion of the right involved.

Name of individual completing this form: Andrew Hosford Phone: 707-354-1218
 Signature of requestor: _____ Date: 6/27/2018

The Department does not change names on certificates. This form will be placed in the file for future reference only. The Department does not provide acknowledgement that this form has been received.

WR RECEIVED
 JUL 03 2018
 OWRD

Form C

IMPORTANT—This form is a notice to the State Engineer that permittee is ready to make **final proof** to the extent to which the water has actually been applied to the intended use under the terms of the permit. Permittee is cautioned that Certificate of Water Right will be issued based on the extent of the quantity and use as determined by the **final proof** inspection and survey which will be made in response to the filing of this Form C.

NOTE: In the case of an irrigation permit, this Form C should not be mailed to the State Engineer until all of the land described in the permit, which it is intended to irrigate under this permit at any time, has actually been irrigated.
Fill out, detach and mail to the State Engineer, Salem, Oregon, when all of the water has been applied.

R 38583

Application No. 38525

NOTICE OF COMPLETE APPLICATION OF WATER TO A BENEFICIAL USE

29196

I, Rough + Ready Lumber Co., the holder of Permit No. 3871

R1750

appropriate the public waters of the state of Oregon, completely applied the waters to a beneficial use in accordance with the terms of said permit, on the ~~0~~ day of _____, 19_____

Remarks: Oct 13 - cy

IN WITNESS WHEREOF, I have hereunto set my hand this 16 day of May, 1965

Lewis Krauss
(Signature of Applicant)

P.O. Box 222 CAVE JUNCTION OR
(Address)

RECEIVED
MAY 20 1965
STATE ENGINEER
SALEM OREGON

Copy

T.40S. R.8W. W.M.

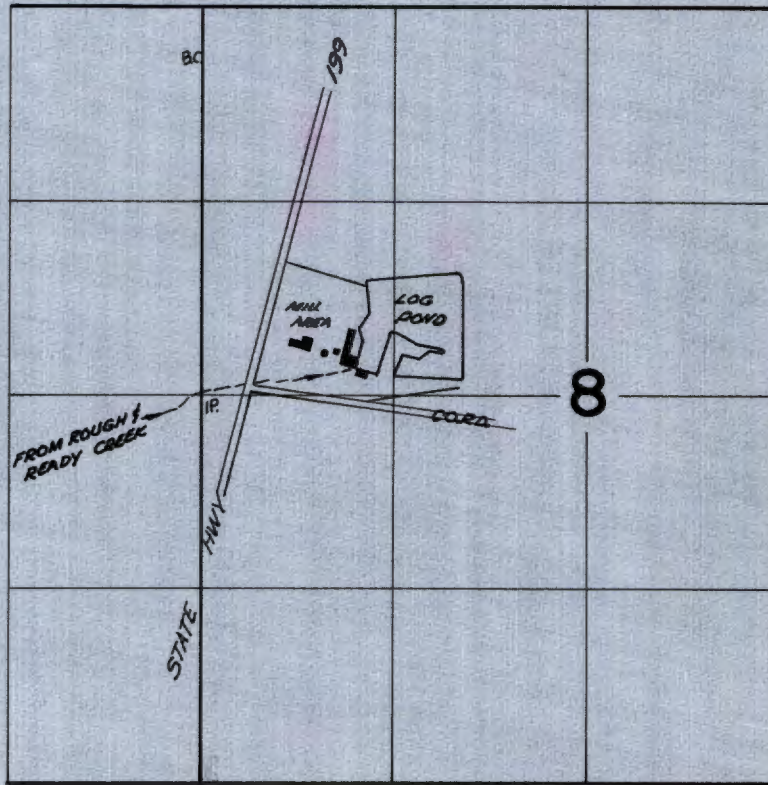

T.40S. R.9W. W.M.

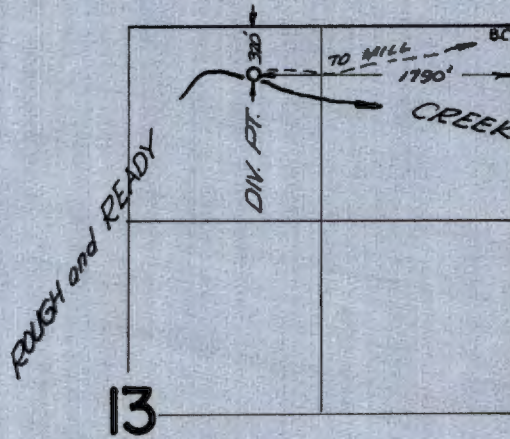

FINAL PROOF SURVEY
UNDER

38525 29196
Application No. R.38583. Permit No. R.3881
IN NAME OF

ROUGH and READY LUMBER CO.

Surveyed May. 18, 1967, by V. Garner

RECEIVED
JUL 19 1968

3852

STATE OF OREGON STATE ENGINEER

COUNTY OF **JOSEPHINE**

SALEM OREGON

Proof of Appropriation of Water

**LEW P. KRAUSS, HELEN C. KRAUSS, FRED R. KRAUSS,
LEWIS N. KRAUSS, and JOHN P. KRAUSS, a Partnership,
dba ROUGH & READY LUMBER COMPANY**

of P. O. Box ³²⁶~~222~~, Cave Junction, State of Oregon,
has applied beneficially the waters of
Rough and Ready Creek and Rough and Ready Mill pond, constructed under Permit No.
R-1750 (Enlargement of Reservoir constructed under Application No. R-38583, Permit *
a tributary of West Fork Illinois River for the purpose of
industrial use (Lumber Mill) including maintenance of log pond

under Permit No. **29196** of the State Engineer, and that the use of said waters has been
completed under the terms of said permit; that the priority of the
right dates from **March 20, 1963**

that the amount of water for the purposes aforesaid, has been actually beneficially used in the
amount of
0.50 cubic foot per second

or its equivalent in case of rotation, measured at the point of diversion from the stream.
The point of diversion is located in the **NW 1/4 NE 1/4, Section 13, T. 40 S., R. 9 W., W. M.**
Diversion point located **320 feet South and 1790 feet West from NE Corner, Section
13.**

The amount of water used for irrigation, together with the amount secured under any other
right existing for the same lands, shall be limited to **-----** of one cubic foot per second
per acre, provided further that the right to use of direct flow is limited to the
period when the flow of the Illinois River is more than 80 c.f.s. at its mouth
and the flow of the Rogue River is more than 735 c.f.s. at its mouth;

and shall conform to such reasonable rotation system as may be ordered by the proper state officer.

A description of the place of use under the right, and to which such right is appurtenant, is as follows:

**SW 1/4 NW 1/4
SE 1/4 NW 1/4
Section 8
T. 40 S., R. 8 W., W. M.**

* No. R-3881)

I have read the above and foregoing proof of appropriation of water; I know the contents thereof, and that the facts therein stated are true.

IN WITNESS WHEREOF, I have hereunto set my hand this 11 day of July,

1968

Lewis Krauss

T40S, R's 8 and 9 W., WM
 Scale 4"=1 mile
 Rough & Ready Lbr. Co.



Application No. 38525 & R-3858
 Permit No. 29196 A-3881

T.40S.R.8W.W.M.

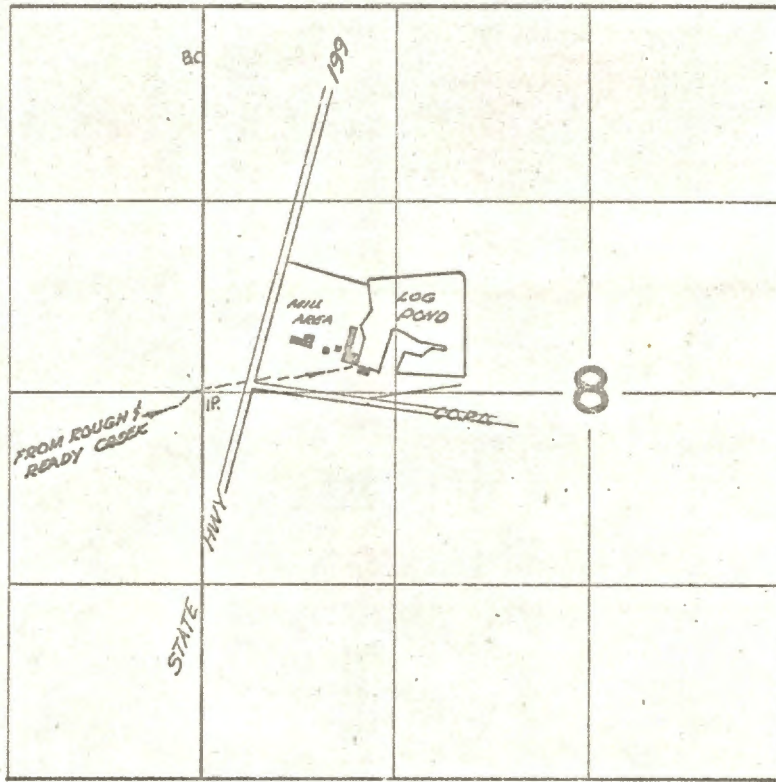

T.40S.R.9W.W.M.

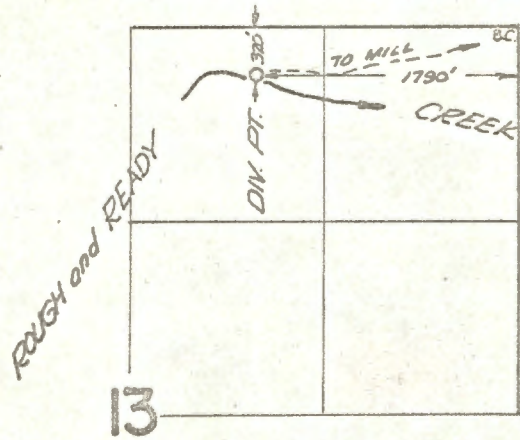

FINAL PROOF SURVEY
UNDER

Application No. 38525 Permit No. 29196
R.38583 R.3881
IN NAME OF

ROUGH and READY LUMBER CO.

Surveyed May 18, 1967, by J. Garner



INFO:- MR LEW KRAUSS & MR. FRED KRAUSS
DIV. PT IS A ROCK & CONCRETE DIV. ST FORCING ROUGH & READY CR.
WATER INTO A DITCH 2° BOTTOM 4° TOP 1° deep. MEASUREMENTS
AT A CONCRETE FLUME JUST PRIOR TO THE INDUSTRIAL AREA
ARE AS FOLLOWS - FLUME = 25° Long 2° wide, VERTICLE SIDES
12° deep, Rate of TRAVEL = 22 SECONDS = 2.825 CFS.

THESE TWO pumps furnish all of the INDUSTRIAL WATER
AND THEY PUMP DIRECTLY FROM THE DITCH, THE REMAINING
WATER FLOWS INTO THE LOG POND.

(MOTOR:- GE, 2HP @ 3540 RPM.
PUMP:- F.M. 3" x 2" D.D.C. OPERATES ON 80 TO 100 PSI)
ABOVE PUMP, PUMPS INTO A 4" MAIN LINE SYSTEM AND
IS USED PRIMARILY ON COOLING THE INCINERATOR, AND ON
THE SAW MILL COOLING SYSTEM

MOTOR:- U.S. 2HP @ 3600 RPM
PUMP:- BERKLEY # 206 TURBINE 1 1/2" DISCHARGE
ABOVE PUMP, PUMPS INTO A PRESSURE TANK. A 1" & A 1 1/2"
PIPE LEAVE P. TANK AND DISTRIBUTE WATER ABOUT
THE ENTIRE PLANT AREA FOR COOLING BEARINGS, SAWS
CHIPPER, EDGER, TREATMENT TANK, ETC.

THE FOLLOWING PUMP, PUMPS FROM LOG POND, AND
IS USED FOR DECK SPRINKLING. EXCESS RETURNS
BACK TO THE LOG POND.

MOTOR:- LEWIS ALLIS 10HP @ 3515 RPM.

PUMP:- CORNELL # 1 1/4 Y-10-2 1 1/2" x 1 1/4" D.D.C

USES PLASTIC PIPE, 2", AND 30 TO 40 RB# 35 3/16"
MAIN USES OF WATER: LOG POND, DECK SPRINKLING, SAW MILL
COOLING SYSTEM, (RB# 40s ON ROOFS OF BUILDINGS)
WATER COOLED SAWS, TREATING LAMBER FOR CURING, 5000 gpd.
FOR MILL AREA ROAD SPRINKLING, WATER COOLING LOG TRUCK
BRAKES, COOLING BARKER, COOLING CHIP STORAGE BINS
COOLING INCINERATOR & INCINERATOR BELTS, WATER IN CHIPPER
LUBRICATING CONVEYER CHAINS, COOLING EDGER, WASHING
EQUIPMENT, WASHING PLANT AREAS
INDUSTRIAL USE IN A SAW MILL, INCLUDING
MAINTENANCE OF A LOG POND

SURVEY TIED TO (SW COR) | (E 1/4 COR) | (NE COR)
ALL OF SEC 7 BC 1/2 IP B.C

Vertical R. Curran
Field Engineer
May 1965

T 40 S, R 8 and 9 W, W 1/4
 Scale 4 = 1 mile March '1963
 Rough & Ready Ltr Co by Lewis Krouss

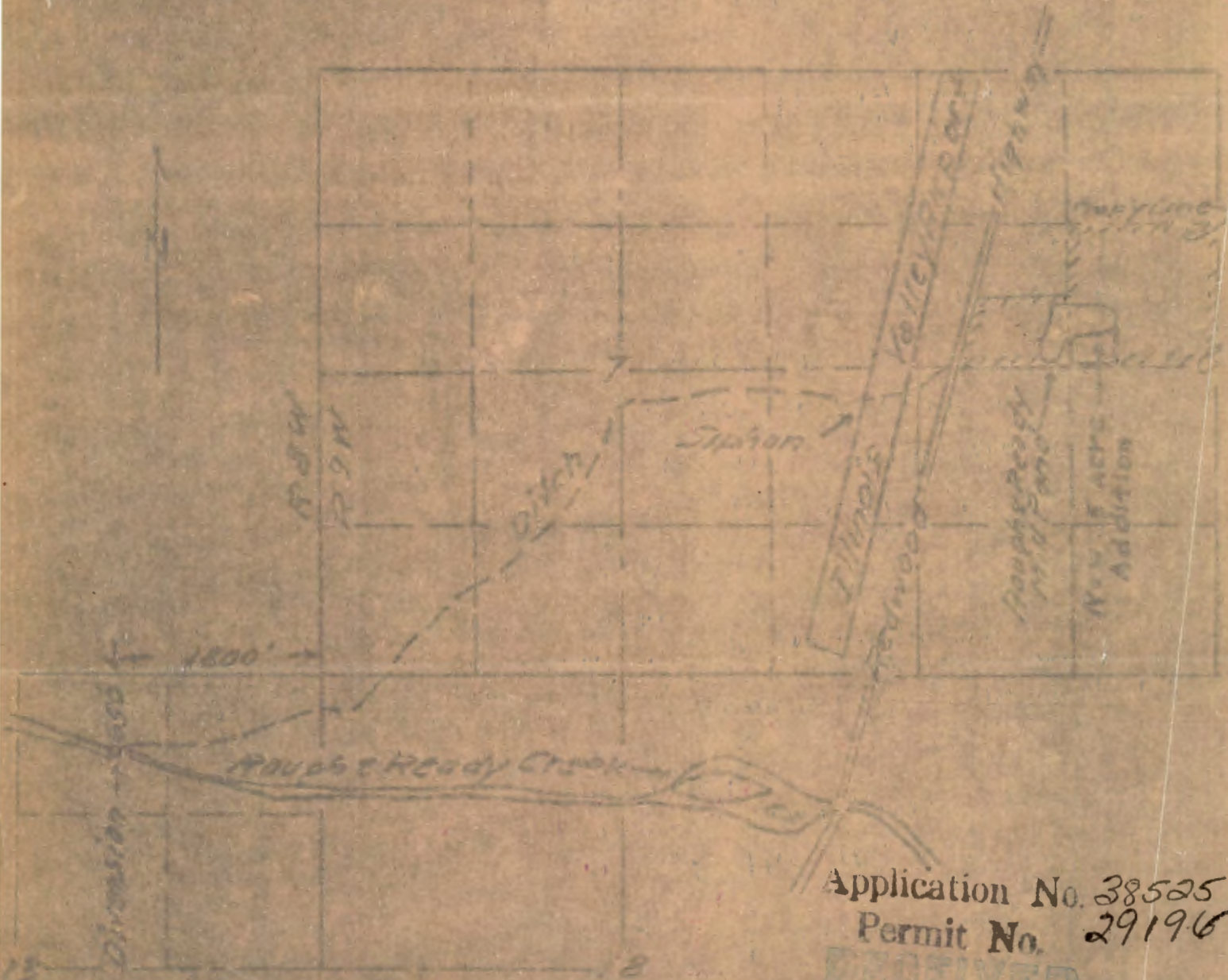

Application No. 38525
 Permit No. 29196
RECEIVED
 MAR 20 1963
 STATE ENGINEER
 SALEM, OREGON

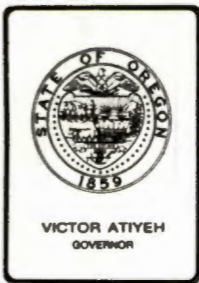

Water Resources Department

MILL CREEK OFFICE PARK

555 13th STREET N.E., SALEM, OREGON 97310

PHONE 378-8508

August 1, 1984

Schultz, Salisbury, Cauble & Medley
Attorneys at Law
PO Box 378
Grants Pass, Oregon 97526

REFERENCE: Files Numbers R-38583 and 38525

Attention: Louis F. Schultz, Jr.,

We have received from you the two requests for assignment of Permits Numbered R-3881 and 29196 from Lew F. Krauss, et.al., dba Rough and Ready Lumber Company to Indian Hill Timber Company along with your check #021946 in the amount of \$20 for recording fees. As discussed by telephone this date with Angie in your office, I am returning your check and the forms herein.

Permits Numbered R-3881 and 29196 were issued Certificates of Water Right recorded at pages 35148 and 35149, respectively, on July 16, 1968. There is no provision for changing names once the certificate has been issued confirming the water right. The right becomes at that point, an appurtenance to the land and passes automatically to the new owner at the time of sale.

Copies of the certificates, if needed, can be requested through this office, along with \$2.50 in copy fees, or through the Water-master's office in Grants Pass.

If you have any questions, please contact us.

Sincerely,

Steven P. Applegate
Senior Water Rights Examiner

SCHULTZ, SALISBURY,
CAUBLE & MEDLEY
ATTORNEYS AT LAW
POST OFFICE BOX 378
GRANTS PASS, OREGON 97526

No 021946

24-12
1230-427

DATE 7-26-84

PAY TWENTY AND 00/100-----DOLLARS \$ 20.00

TO THE
ORDER
OF

WATER RESOURCES
DIRECTOR

SCHULTZ, SALISBURY,
CAUBLE & MEDLEY

FIRST NATIONAL BANK OF OREGON
GRANTS PASS BRANCH GRANTS PASS, OREGON

0532

01230001231427 003745 11

R-38583
38525

May 1, 1964

Rough & Ready Lumber Company
P.O. Box 222
Cave Junction, Oregon

29196 with blueprint.

s. R-38583, 38525, permit Nos. R-3881

476-8825
Angie

RECEIVED

JUL 30 1984

WATER RESOURCES DEPT

SALEM, OREGON

ALLEN, SCHULTZ & SALISBURY
(1954-1959)

SCHULTZ & SALISBURY
(1959-1972)

SCHULTZ, SALISBURY, CAUBLE & MEDLEY

ATTORNEYS AT LAW

III S. E. SIXTH

P. O. BOX 378

GRANTS PASS, OREGON 97526

NIEL R. ALLEN (1894-1959)

LOUIS F. SCHULTZ, JR.

RAYMOND J. SALISBURY

WALTER L. CAUBLE

STEVEN P. MEDLEY

TRANSMITTAL MEMO

DATE: July 27, 1984

Water Resources Director
555 13th Street, N.E.
Salem, OR 97310

RE: Assignment of Water Rights

ENCLOSURES:

Two assignments of water rights to Indian Hill Timber Co. from Fred R. Krauss, Lewis N. Krauss and John P. Krauss, dba Rough & Ready Lumber Company.

Our check number 021946 in the amount of \$20.00, representing payment in full of recording fees.

REQUESTED ACTION:

PLEASE DO NOT RECORD THESE ASSIGNMENTS UNTIL WEDNESDAY, AUGUST 1, 1984.

Very truly yours,

SCHULTZ, SALISBURY, CAUBLE & MEDLEY

Louis F. Schultz, Jr.
Louis F. Schultz, Jr.

/alc

By RB

cc: Rough and Ready

R-38583
38525

July 16, 1968

Rough & Ready Lumber Company
P. O. Box 326
Cave Junction, Oregon 97523

Gentlemen:

This will acknowledge receipt of \$2.00 certificate recording fees for which our receipts numbered 10512 and 10513 are enclosed.

We did not receive the signed proofs of appropriation of water in connection with your permits numbered 29196 and R-3881. Before we can issue the certificates of water right, we will need to receive the final proofs from you.

Very truly yours,

CHRIS L. WHEELER
State Engineer

By
Myron V. Bish
Assistant

MVB:kmh
Enclosures



STATE OF OREGON
STATE ENGINEER
WATER RESOURCES DEPARTMENT
516 PUBLIC SERVICE BUILDING
SALEM 97310

R-38583
REFER TO
FILE NO. 38525

July 9, 1968

Lew F. Krauss, Helen C. Krauss,
Fred R. Krauss, Lewis N. Krauss,
John P. Krauss, dba Rough & Ready Lumber Company
P. O. Box 222
Cave Junction, Oregon 97523

Dear Sirs and Madams:

Enclosed is the final proof in connection with the incomplete water right represented by your permit No. R-3881 and 29196.

The data contained in the proof, which is based on an inspection and survey of your project made by a representative of this department, defines the extent to which your water right has been completed within the terms of your permit. The proof should be dated and signed by you and returned to this office.

Upon receipt of the proof, properly executed and accompanied by the statutory recording fee of \$1, a certificate of water right will be issued confirming the right thereunder and, after being recorded in the county records, will be forwarded to you.

Very truly yours,

CHRIS L. WHEELER
State Engineer

Form 117

Enclosure

kmh

Please submit \$1.00 for each permit.

38525
R-38583

May 25, 1965

Laurence A. Cushing
Attorney At Law
P. O. Box 234
Cave Junction, Oregon

Dear Mr. Cushing:

This will acknowledge receipt of form C, notice of complete application of water to beneficial use under permits 29196 and R-3881.

There will be no further notices required from the Rough & Ready Lumber Company as to the progress of the project described under these permits. The confirming water right certificates will be issued on these permits following the customary final proof survey which will be made at a later date by a representative of this office.

Very truly yours,

CHRIS L. WHEELER
State Engineer

By
C. O. Bartels
Assistant

COB:caw

LAURENCE A. CUSHING

ATTORNEY AT LAW

P. O. BOX 224

CAVE JUNCTION, OREGON

May 18, 1965

BANK BUILDING

TELEPHONE 6711

State of Oregon
State Engineer's Office
Water Resources Department
516 Public Service Building
Salem, Oregon, 97310

RECEIVED
MAY 20 1965
STATE ENGINEER
SALEM OREGON

Re: Rough & Ready Lbr. Co.
Application R38583, 38525
Permit #R3881, 29196

Dear Sir:

With regard to the above, I am enclosing form C which I presume is the final step necessary in order that the final water rights certificates can be issued. Mr. Krauss indicated that he thought an inspection had already been made on this. I am sure the local watermaster, Robert Steimer, has made an inspection.

I did not know exactly what date to use for completion of application to beneficial use since the water has been used and stored under previous permits and except for the period of construction under the new applications I believe it has been used continuously and, of course, at the present time there is complete use under the new permits.

Would you please advise me at your earliest convenience if there is anything at all necessary from this office or from Rough & Ready Lbr. Co. to fully complete this matter.

Very truly yours,

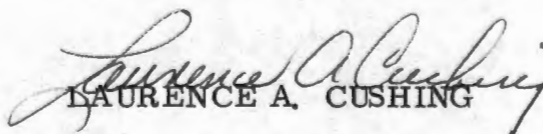
LAURENCE A. CUSHING

LAC:d
encl.

October 15, 1964

Mr. Laurence A. Cushing
Attorney at Law
P. O. Box 234
Cave Junction, Oregon

Dear Mr. Cushing:

In response to your letter of October 13, 1964, the Krauss' should file a Form B, a copy of which was enclosed with their permit. When they have completely applied the water to beneficial use they should then file Form C. The Krauss' engineer who I assume to be Mr. Templin, should file a report to this office that the project was completed in accordance with the approved plans and specifications.

Very truly yours,

CHRIS L. WHEELER
State Engineer

By
A. M. Petska
Engineer

AMP:jb

CC: R. L. Templin, Jr.
Registered Engineer
Josephine County
Room 120, Courthouse
Grants Pass, Oregon

LAURENCE A. CUSHING

ATTORNEY AT LAW

P. O. BOX 224

CAVE JUNCTION, OREGON 97523

October 13, 1964

BANK BUILDING

TELEPHONE 6711

State of Oregon
State Engineer
Water Resources Department
516 Public Service Building
Salem, Oregon 97310

38525
Re: R-38583 X

Attention: Mr. A. M. Petska
Engineer

RECEIVED
OCT 15 1964
STATE ENGINEER
SALEM, OREGON

Dear Sir:

On the above, I am advised by the Krauss', that they have completed all phases of the requirements necessary as outlined by Mr. Templin.

Would you please advise the next step necessary in order to complete this matter.

Very truly yours,

Laurence A. Cushing
LAURENCE A. CUSHING
Attorney at Law

LAC:rs

R-38583
38525

March 25, 1964

Rough and Ready Lumber Company
P.O. Box 222
Cave Junction, Oregon

Gentlemen:

This is to advise you that your applications numbered R-38583 and 38525 have been approved by issuance of permits. Your application numbered R-38583 has been approved by a permit authorizing the enlargement of Rough and Ready Mill Pond constructed under permit numbered R-1750 and the storage of water from Rough and Ready Creek for industrial use to the extent of 50.4 acre feet of water.

The secondary application numbered 38525 has been approved by a permit authorizing the appropriation of not to exceed 0.50 cubic foot of water per second from Rough and Ready Creek and Rough and Ready Mill Pond for industrial use, including maintenance of a log pond. The right to appropriate direct flow has been limited to the period when the flow of the Illinois River is more than eighty cubic feet of water per second from its mouth and the flow of the Rogue River is more than 745 cubic feet of water per second at its mouth. The priority date of the permit is March 20, 1963.

As soon as the necessary recording entries have been made in this office, the permits will be mailed to you. Pending your receipt of the permits, this letter may be used as your authority to proceed with any construction connected with your proposed project and the appropriation of water as authorized by the permits.

Very truly yours,

CHRIS L. WHEELER
State Engineer

By
Walter N. Perry, Assistant

WNP:egw
cc: Mr. Robert B. Steimer
Watermaster, Dist. 14
Josephine County Courthouse
Grants Pass, Oregon

February 26, 1964

Mr. R. L. Templin, Jr.
County Engineer
Department of Roads
Room 120, Courthouse
Grants Pass, Oregon

Dear Mr. Templin:

The plans for the Rough and Ready Log Ponds have been examined and are being returned to you for additional information on two items.

1. There appears to be an error in the capacity curve. My computations would indicate a capacity of just over 100 acre feet for all ponds.
2. Would you indicate by note or sketch, the location and type of control on valve of the 18" C.M.P. outlet pipe.

Aside from these two points, the plans appear to adequately represent the existing structures and the changes you propose.

The reservoir application is being returned so that data agreeing with your plans can be shown on the application. It appears that the original application did not make proper allowance for borrow from the interior of the log ponds. Therefore, this application should cover the increased storage. The increased storage is considered to be in all four ponds. Changes should be made in the following items of the application:

- Item 3: The capacity shown should be the difference between the existing capacity and 57.6 acre feet for which a right exists. A notation should be entered in the remarks indicating that the 57.6 acre feet is covered by certificate number 22620.
- Item 5: Should be amended to include SW¹/₄ NW¹/₄ to include two western ponds.
- Item 6: Location should be amended as above. Maximum height appears to be about 16 feet at northeast corner of old

February 26, 1964

pond. Lengths of dike would be total lengths of old and new dikes. Top width should be minimum proposed top width. Upstream slope appears to be steeper than 3:1. Height of dam above water line should be minimum that will exist at any point where pond is contained by dike.

- Item 8: Should show location and dimensions of the proposed new concrete wasteway.
- Item 9: Should describe the 18" C.M.P. outlet pipe.
- Item 10: The total surface area, maximum depth and mean depth should be shown here.

The application has been endorsed so that in order to retain its priority, it should be returned to this office on or before April 27, 1964.

Very truly yours,

CHRIS L. WISSLER
State Engineer

By
Jerry W. Eggleston,
Engineer

JWE:agb
Enclosure

cc: Laurence A. Cushing
Attorney at Law
P. O. Box 234
Cave Junction, Oregon

R-38503
38525
R-29970
29971

December 13, 1963

Mr. Richard Templin
County Engineer
County Courthouse
Grants Pass, Oregon

Dear Mr. Templin:

Mr. Cushing has told me that you are the engineer preparing the plans for the Rough and Ready Lumber Company log pond near Cave Junction. I inspected the log pond on December 9, 1963, but was not able to talk with you about it before I left Grants Pass on December 10. Mr. Petaka will probably be in Grants Pass during the latter part of next week and will be happy to meet with you to discuss any questions you may have about our requirements for these plans.

Very truly yours,

CHRIS L. WHEELER
State Engineer

By
Jerry W. Eggleston,
Engineer

JWEmgb
CC: Laurence A. Cushing
Attorney at Law
P. O. Box 234
Cave Junction, Oregon

R-38583
38525
R-29970
29971

MEMORANDUM OF INSPECTION

Rough and Ready Lumber Company Log Pond

With Robert Steimer this log pond was inspected on December 9, 1963.

A fill appears to have been constructed with a bulldozer by pushing material from below the downstream toe up onto the dam. The material consists of sand, silt and boulders. There was very little seepage noted at the toe although the pond has evidently been full for some time. The maximum height of the dam is $16\frac{1}{2}$ feet with a crest width of approximately six feet minimum. At the northeast corner of the pond is an 18-inch corrugated metal pipe outlet and near the northwest corner there is a wood flume overflow across the crest with a bottom width of 21 inches and a depth of $11\frac{1}{2}$ inches. Along the west side the pond has been formed entirely by excavation. At the present time little damage would be done by a breach of the dike since the water would have to spread over a large area before reaching any structures.

By
Jerry W. Eggleston,
Engineer

38525
R-38583

November 29, 1963

Mr. Laurence Cushing
Attorney at Law
P. O. Box 234
Cave Junction, Oregon

Dear Mr. Cushing:

This is with reference to the filings for a lumber mill pond for the Rough and Ready Lumber Company in the name of Lew F. Krauss and associates. Would you please advise this office as to the progress of the plans and specifications as outlined in my letter of June 6, 1963.

Very truly yours,

CHRIS L. WHEELER
State Engineer

By
A. M. Petska,
Engineer

AMP:mgb

R-38583
R-38525

October 4, 1963

Mr. Laurence Cushing
Attorney at Law
P. O. Box 234
Cave Junction, Oregon

Dear Mr. Cushing:

This is with reference to the filings for a lumber mill pond for the Rough and Ready Lumber Company in the name of Lew F. Krauss and associates. Would you please advise this office as to the progress of the plans and specifications as outlined in my letter of June 6, 1963.

Very truly yours,

CHRIS L. WHEELER
State Engineer

By
A. M. Petska
Engineer

AMP/dm

R-38583
38525

August 22, 1963

Mr. Laurence Cushing
Attorney at Law
P. O. Box 234
Cave Junction, Oregon

Dear Mr. Cushing:

This is with reference to the filings for a lumber mill pond for the Rough and Ready Lumber Company in the name of Lew F. Krauss and associates. Would you please advise this office as to the progress of the plans and specifications as outlined in my letter of June 6, 1963.

Very truly yours,

CHRIS L. WHEELER
State Engineer

By A. M. Petska,
Engineer

AMP:mgb

Qes 1

June 6, 1963

Mr. Laurence Cushing
Attorney at Law
P. O. Box 234
Cave Junction, Oregon

Dear Mr. Cushing:

This is with reference to the filings for a lumber mill pond for the Rough and Ready Lumber Company in the name of Lew F. Krauss and associates. Since the storage is in excess of 9.2 acre feet and a height of 10 feet, it will be necessary that certain engineering information be submitted in support of these applications. For your convenience I have outlined these specific items below:

1. A topography map of the reservoir and dam, together with an area and capacity table.
2. A profile along the center line of the dam, with the ground level projected to the center line.
3. Cross sections of the dam and reservoir showing its various engineering dimensions.
4. A cross section and profile of the wasteway.
5. A general description of the project and a statement by a registered professional engineer as to the safety and stability of the structure as constructed.

It will be necessary that this information be supplied by a registered professional engineer, and when your engineer has this information in a preliminary form, if you will so advise, an engineer from this office will schedule an inspection of the structure.

Very truly yours,

CHRIS L. WHEELER
State Engineer

By
A. M. Petska,
Engineer

38525
R-38583

April 29, 1963.

Laurence A. Cushing
Attorney at Law
P.O. Box 234
Cave Junction, Oregon

Dear Mr. Cushing:

This will acknowledge recording fees in the sum of \$10 necessary to applications numbered 38525 and R-38583 filed in the name of Rough and Ready Lumber Co. Our receipts numbered 37780 and 37781 are enclosed.

The applications will be considered for approval by issuance of permits with the next group.

Very truly yours,

CHRIS L. WHEELER
State Engineer

By
Walter N. Perry, Assistant

gcc

Enc: Receipts numbered
37780 and 37781

BANK BUILDING

LAURENCE A. CUSHING
ATTORNEY AT LAW
P. O. BOX 234
CAVE JUNCTION, OREGON

April 24, 1963

RECEIVED
APR 25 1963
STATE ENGINEER
SALEM, OREGON

TELEPHONE 6711

State of Oregon
State Engineer
Water Resources Department
516 Public Service Building
Salem 10, Oregon

38525
R-38583

Attention: Mr. Walter N. Perry
Assistant

Dear Mr. Perry:

This will acknowledge your letter of April 22, last, for which I thank you.
Enclosed find my check in the amount of \$10.00 to cover recording fees.
I presume we will receive the permits in the near future.

Very truly yours,

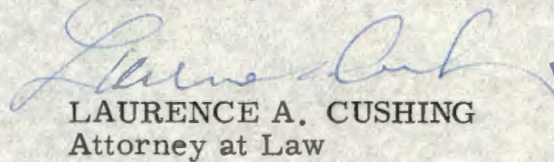
LAURENCE A. CUSHING
Attorney at Law

LAC:rs
encl.

EAGLE-A
TYPE-ERASE
25% COTTON FIBER

38525
R-38583

April 22, 1963

Laurence A. Cushing
Attorney at Law
P.O. Box 234
Cave Junction, Oregon

Dear Mr. Cushing:

This will acknowledge your letter of April 4, 1963 submitting two applications in the names of Lew F. Krauss, Helen C. Krauss, Fred R. Krauss, Lewis N. Krauss and John P. Krauss, dba Rough and Ready Lumber Co.; one for a permit to appropriate 0.5 cubic foot of water per second from Rough and Ready Creek to maintain a log pond for industrial use, and one for a permit to enlarge Rough and Ready Mill Pond for the storage of 60 acre feet of water from Rough and Ready Creek for log storage and industrial use, a map and fees in the sum of \$25 for which our receipts numbered 37450 and 37601 are enclosed.

The applications have been examined and filed in the order of their acknowledgment under files numbered 38525 and R-38583. The applications appear to have been completed in satisfactory form and upon receipt of additional recording fees in the sum of \$5 to accompany each application, we may give further consideration to the approval of the applications by issuance of permits.

Very truly yours,

CHRIS L. WHEELER
State Engineer

By
Walter N. Perry, Assistant

WNP/gcc

Enc: Receipts numbered
37450 and 37601

TYPE-ERASE
25% COTTON

LAURENCE A. CUSHING
ATTORNEY AT LAW
P. O. BOX 234
CAVE JUNCTION, OREGON

BANK BUILDING

March 19, 1963

TELEPHONE 6711

RECEIVED
MAR 20 1963
STATE ENGINEER
SALEM, OREGON

State of Oregon
State Engineer
Water Resources Department
516 Public Service Building
Salem 10, Oregon

Dear Sir:

Enclosed herewith please find application for water right together with check in the amount of \$15.00 in behalf of Rough & Ready Lumber Co., for additional water for log storage pond purposes.

If reservoir permit is needed in conjunction with this application, we will forward the same under separate cover.

Very truly yours,

Laurence A. Cushing
LAURENCE A. CUSHING
Attorney at Law

LAC:rs
encl

EAGLE-A