

RECEIVED

OCT 01 2000

WATER RESOURCES DEPT.
LAND OFFICE

CLAIM OF BENEFICIAL USE MAP

UNDER APPLICATION R-82502 ; PERMIT R-12259

W1/4 COR
SEC. 16
T.26S., R.41E., W.M.

SE1/4 NW1/4 SEC 21 T 26S R 41E W.M.

U.S.G.S. QUAD - CEDAR MTN., OREG. - 7 1/2'

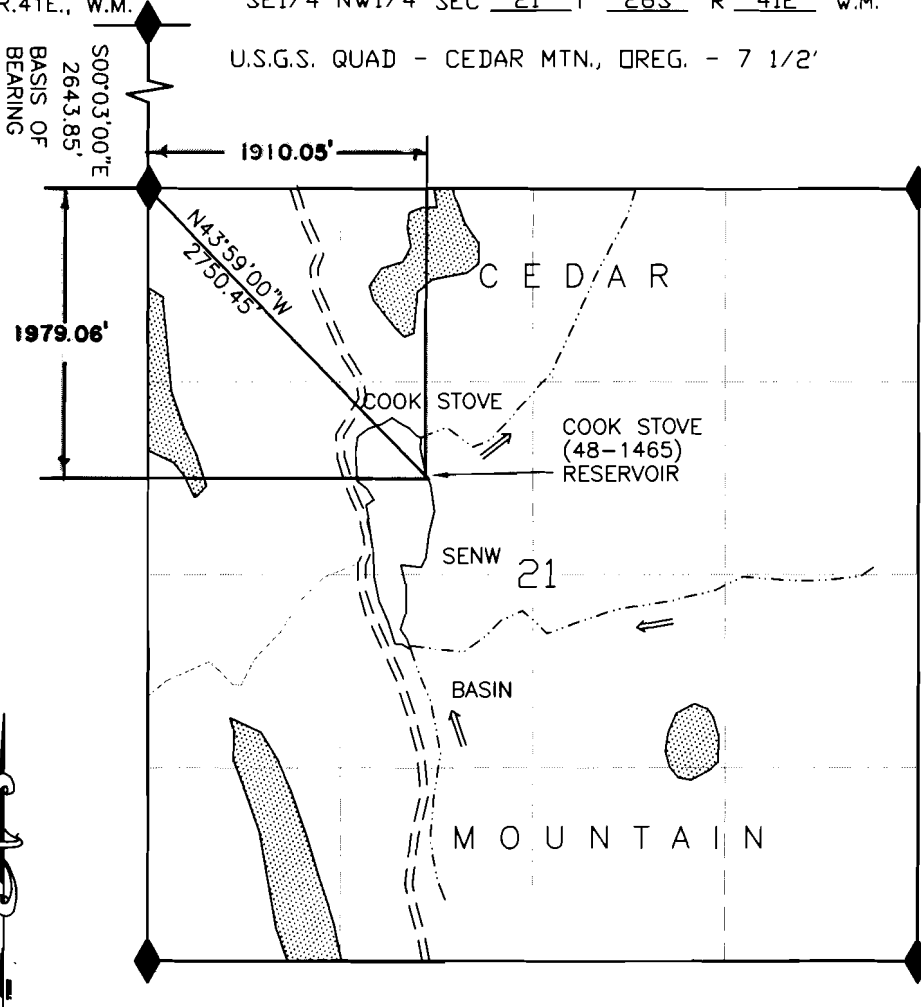

- LEGEND
- RESERVOIR
 - ROAD
 - TRAIL
 - CHANNEL
 - FD SEC COR
 - TREE AREA

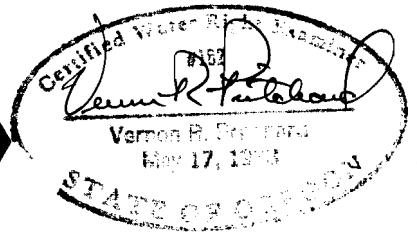

Expires 12/31/02

COOK STOVE (48-1465) RESERVOIR

1320 660 0 1320



SCALE 1"=1320'

I, Jerry Easton Acting ADM Operations/Field Services agree to the findings of the CWRE and do submit this site report and map as my Claim of Beneficial Use of the water as provided under the terms and conditions of my Permit R-12259

Jerry Easton



THIS MAP IS FOR THE PURPOSE OF LOCATING A WATER RIGHT AND IS NOT INTENDED TO PROVIDE LEGAL DIMENSIONS FOR LOCATION OF PROPERTY BOUNDARIES.

ACAD14
DWG FILE:COOKSTOBEN

UNITED STATES DEPARTMENT OF THE INTERIOR BUREAU OF LAND MANAGEMENT DIVISION OF OPERATIONS VALE DISTRICT	
COOK STOVE (48-1465) RESERVOIR	
DRAWN BY:	<u>Vernon R. Stutzman</u>
SURVEYED:	<u>Vernon R. Stutzman</u>
APPROVED:	<u>Jerry Easton</u> ADM OPERATIONS AND FIELD SERVICES
DRAWN:	<u>CG</u> SCALE: 1"=1320'
DATE:	11/02/00 SHEET 1 OF 1
DRAWING NO. OR-03-9172.45-1076	