

GILLIAM FAMILY LIVING TRUST  
109 STALEY ROAD  
EAGLE POINT, OR 97524

LOST CREEK LAKE  
SECONDARY WATER RIGHT  
APPLICATION

SECTION 9  
T35S R1W, W.M.  
JACKSON COUNTY

● GILLIAM POD AND METER  
5' NORTH and 540' WEST  
FROM SE CORNER  
LOT 1, T35S R1W

PLACE OF USE



SE NW 40 ACRES PRIMARY



NE SW 20 ACRES  
15 ACRES PRIMARY



5 ACRES (C-82747)  
SUPPLEMENTAL



SE SW 14.5 ACRES PRIMARY

--- PIPELINES

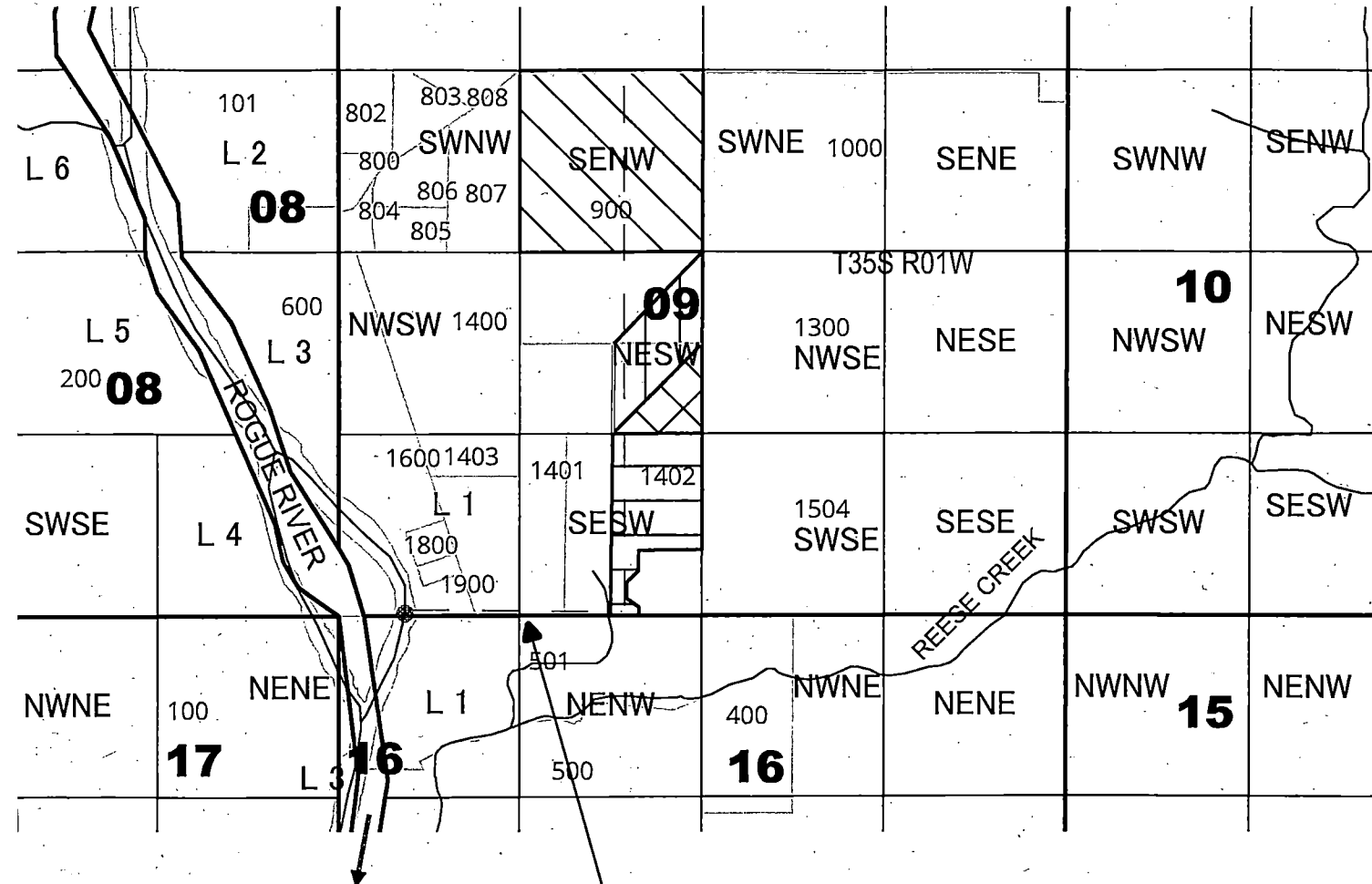

SE CORNER  
LOT 1

Received by OWRD

SEP 27 2024

Salem, OR

0 1320 ft



This map is not intended to provide  
legal dimensions or locations of  
property ownership lines

ParsonsWater Consulting LLC  
rick.parsons@parsonwater.com  
541.499.0257 303.667.5067