

Application for a Permit to Use Surface Water



Oregon Water Resources Department
725 Summer Street NE, Suite A
Salem, Oregon 97301-1266
503-986-0900
www.oregon.gov/OWRD

SECTION 1: APPLICANT INFORMATION AND SIGNATURE

Applicant

NAME SUNNY VALLEY SAND AND GRAVEL INC. ATTN: ANDREAS BLECH			PHONE (HM)
PHONE (WK) (541) 244-2644 541-226-8784	CELL		FAX
MAILING ADDRESS 1867 WILLIAMS HIGHWAY, SUITE 260			
CITY GRANTS PASS	STATE OR	ZIP 97527	E-MAIL * ANDREAS@BLECH.US

Organization

NAME			PHONE	FAX
MAILING ADDRESS			CELL	
CITY	STATE	ZIP	E-MAIL *	

Agent – The agent is authorized to represent the applicant in all matters relating to this application.

AGENT / BUSINESS NAME SHONEE LANGFORD SCHWABE, WILLIAMSON & WYATT			PHONE (503) 540-4261	FAX
MAILING ADDRESS 530 CENTER STREET NE, SUITE 730			CELL	
CITY SALEM	STATE OR	ZIP 97301	E-MAIL * SLANGFORD@SCHWABE.COM	

Note: Attach multiple copies as needed

* By providing an e-mail address, consent is given to receive all correspondence from the Department electronically. (Paper copies of the proposed and final order documents will also be mailed.)

Received by OWRD

OCT 10 2004

Salem, OR

By my signature below I confirm that I understand:

- I am asking to use water specifically as described in this application.
- Evaluation of this application will be based on information provided in the application.
- I cannot legally use water until the Water Resources Department issues a permit.
- The Department encourages all applicants to wait for a permit to be issued before beginning construction of any proposed diversion. Acceptance of this application does not guarantee a permit will be issued.
- If I begin construction prior to the issuance of a permit, I assume all risks associated with my actions.
- If I receive a permit, I must not waste water.
- If development of the water use is not according to the terms of the permit, the permit can be cancelled.
- The water use must be compatible with local comprehensive land use plans.
- Even if the Department issues a permit, I may have to stop using water to allow senior water right holders to receive water to which they are entitled.



I (we) affirm that the information contained in this application is true and accurate

	Andreas Blech, President	9-30-24
Applicant Signature	Print Name and Title if applicable	Date
Applicant Signature	Print Name and Title if applicable	Date

SECTION 2: PROPERTY OWNERSHIP

Please indicate if you own all the lands associated with the project from which the water is to be diverted, conveyed, and used.

- YES, there are no encumbrances.
- YES, the land is encumbered by easements, rights of way, roads or other encumbrances.
- NO, I have a recorded easement or written authorization permitting access.
- NO, I do not currently have written authorization or easement permitting access.
- NO, written authorization or an easement is not necessary, because the only affected lands I do not own are state-owned submersible lands, and this application is for irrigation and/or domestic use only (ORS 274.040).
- NO, because water is to be diverted, conveyed, and/or used only on federal lands.

Affected Landowners: List the names and mailing addresses of all owners of any lands that are not owned by the applicant and that are crossed by the proposed ditch, canal or other work, even if the applicant has obtained written authorization or an easement from the owner. *(Attach additional sheets if necessary).*
 NA

Legal Description: You must provide the legal description of: 1. The property from which the water is to be diverted, 2. Any property crossed by the proposed ditch, canal or other work, and 3. Any property on which the water is to be used as depicted on the map.

SECTION 3: SOURCE OF WATER

A. Proposed Source of Water

Provide the commonly used name of the water body from which water will be diverted, and the name of the stream or lake it flows into (if unnamed, say so), and the locations of the point of diversion (POD):

Source 1: Reservoir 2	Tributary to: Grave Creek
TRSQQ of POD: T34S, R5W, Section 8, SE SW	
Source 2: Reservoir 4	Tributary to: Grave Creek
TRSQQ of POD: T34S, R5W, Section 7, SE SE	

If any source listed above is stored water that is authorized under a water right permit, certificate, or decree, attach a copy of the document or list the document number (for decrees, list the volume, page and/or decree name).

Reservoir 2: Application R-87930, Permit R-15320
 Reservoir 4: Application R-87932, Permit R-15319

Received by OWRD
 OCT 10 2024
 Salem, OR

B. Applications to Use Stored Water

Do you, or will you, own the reservoir(s) described in Section 3A above?

Yes. No. (Enclose a copy of your written notification to the operator of the reservoir of your intent to file this application, which should have been mailed or delivered to the operator.)

If *all* sources listed in Section 3A are stored water, the Department will review your application using the expedited process provided in ORS 537.147, unless you check the box below. Please see the instruction booklet for more information.

By checking this box, you are requesting that the Department process your application under the standard process outlined in ORS 537.150 and 537.153, rather than the expedited process provided by ORS 537.147. To file an application under the standard process, you must enclose the following:

- A copy of a signed non-expired contract or other agreement with the owner of the reservoir (if not you) to impound the volume of water you propose to use in this application.
- A copy of your written agreement with the party (if any) delivering the water from the reservoir to you.

SECTION 4: SENSITIVE, THREATENED OR ENDANGERED FISH SPECIES PUBLIC INTEREST INFORMATION

This information must be provided for your application to be accepted as complete. The Water Resources Department will determine whether the proposed use will impair or be detrimental to the public interest with regard to sensitive, threatened or endangered fish species.

To answer the following questions, use the map provided in [Attachment 3](#) or the link below to determine whether the proposed point of diversion (POD) is located in an area where the Upper Columbia, the Lower Columbia, and/or the Statewide public interest rules apply.

For more detailed information, click on the following link and enter the T,R,S,QQ or the Lat/Long of a POD and click on "Submit" to retrieve a report that will show which section, if any, of the rules apply:
https://apps.wrd.state.or.us/apps/misc/lkp_trsqg_features/

If you need help to determine in which area the proposed POD is located, please call the customer service desk at (503) 986-0900.

Received by OWRD

Upper Columbia - OAR 690-033-0115 thru -0130

OCT 10 2024

Is the POD located in an area where the Upper Columbia Rules apply?

Yes No

If yes, you are notified that the Water Resources Department will consult with numerous federal, state, local and tribal governmental entities so it may determine whether the proposed use is consistent with the "Columbia River Basin Fish and Wildlife Program" adopted by the Northwest Power Planning Council in 1994 for the protection and recovery of listed fish species. The application may be denied, heavily conditioned, or if appropriate, mitigation for impacts may be needed to obtain approval for the proposed use.

If yes,

- I understand that the proposed use does not involve appropriation of direct streamflow during the time period April 15 to September 30, except as provided in OAR 690-033-0140.
- I understand that I will install, operate and maintain a fish screen and fish passage as listed in ORS 498.301 through 498.346, and 509.580 through 509.910, to the specifications and extent required by Oregon Department of Fish and Wildlife, prior to diversion of water under any permit issued pursuant to this application.
- I understand that the Oregon Department of Environmental Quality will review my application to determine if the proposed use complies with existing state and federal water quality standards.
- I understand that I will install and maintain water use measurement and recording devices as required by the Water Resources Department, and comply with recording and reporting permit condition requirements.

Lower Columbia - OAR 690-033-0220 thru -0230

Is the POD located in an area where the Lower Columbia rules apply?

Yes No

If **yes, you are notified** that that the Water Resources Department will determine, by reviewing recovery plans, the Columbia River Basin Fish and Wildlife Program, and regional restoration programs applicable to threatened or endangered fish species, in coordination with state and federal agencies, as appropriate, whether the proposed use is detrimental to the protection or recovery of a threatened or endangered fish species and whether the use can be conditioned or mitigated to avoid the detriment.

If a permit is issued, it will likely contain conditions to ensure the water use complies with existing state and federal water quality standards; and water use measurement, recording and reporting required by the Water Resources Department. The application may be denied, or if appropriate, mitigation for impacts may be needed to obtain approval of the proposed use.

If **yes, provide the following information** (the information must be provided with the application to be considered complete).

Yes No The proposed use is for more than **one** cubic foot per second (448.8 gpm) and is not subject to the requirements of OAR 690, Division 86 (Water Management and Conservation Plans).

If **yes**, provide a description of the measures to be taken to assure reasonably efficient water use:

Received by OWRD

OCT 10 2024

Salem, OR

Statewide - OAR 690-033-0330 thru -0340

Is the POD located in an area where the Statewide rules apply?

Yes No

If **yes**, the Water Resources Department will determine whether the proposed use will occur in an area where endangered, threatened or sensitive fish species are located. If so, the Water Resources Department, Department of Fish and Wildlife, Department of Environmental Quality, and the Department of Agriculture will recommend conditions required to achieve "no loss of essential habitat of threatened and endangered (T&E) fish species," or "no net loss of essential habitat of sensitive (S) fish species." If conditions cannot be identified that meet the standards of no loss of essential T & E fish habitat or no net loss of essential S fish habitat, the agencies will recommend denial of the application unless they conclude that the proposed use would not harm the species.

SECTION 5: WATER USE

Provide the amount of water you propose to use from each source, for each use, in cubic feet-per-second (cfs) or gallons-per-minute (gpm). If the proposed use is from storage, provide the amount in acre-feet (af):
(1 cfs equals 448.8 gpm. 1 acre-foot equals 325,851 gallons or 43,560 cubic feet)

SOURCE	USE	PERIOD OF USE	AMOUNT
Reservoir 2	Mining	Year-Round	13 <input type="checkbox"/> cfs <input type="checkbox"/> gpm <input checked="" type="checkbox"/> af
Reservoir 4	Mining	Year-Round	36 <input type="checkbox"/> cfs <input type="checkbox"/> gpm <input checked="" type="checkbox"/> af

Please indicate the number of primary, supplemental and/or nursery acres to be irrigated.

Primary: NA Acres Supplemental: NA Acres Nursery Use: NA Acres

If supplemental acres are listed, provide the Permit or Certificate number of the underlying primary water right(s): NA

Indicate the maximum total number of acre-feet you expect to use in an irrigation season: NA

- If the use is **municipal or quasi-municipal**, attach **Form M**
- If the use is **domestic**, indicate the number of households:
- If the use is **mining**, describe what is being mined and the method(s) of extraction: Aggregate (primarily sand and gravel) will be mined from open excavations under an Oregon Department of Geology and Mineral Industries (DOGAMI) Permit

SECTION 6: WATER MANAGEMENT

A. Diversion and Conveyance

Received by OWRD

What equipment will you use to pump water from your source?

OCT 10 2024

- Pump (give horsepower and type): Centrifugal pumps ranging from 10 to 100 hp.
- Other means (describe):

Salem, OR

Provide a description of the proposed means of diversion, construction, and operation of the diversion works and conveyance of water.

Reservoirs 2 and 4 have been constructed in general accordance with Permit R-15319 (Application R-879320) and Permit R-15320 (Application R-87932). In addition, the District 14 Watermaster, Scott Ceciliani, inspected the completed reservoirs before the impoundments were filled with water.

Water will be diverted from the reservoirs using portable centrifugal pumps placed on floats and/or on the reservoir embankments. The PODs for the pumps in the reservoirs will change as mining occur; this a common practice at aggregate mines because the mining areas and processing equipment locations change as excavation occurs. The pump locations in and at the reservoirs will be apparent to Department staff during any inspections because the reservoirs are limited in area.

Water will be conveyed using above-ground pipelines and water trucks.

B. Application Method

What equipment and method of application will be used? (e.g., drip, wheel line, high-pressure sprinkler) Spray bars will be used for processing the aggregate at the wash plant. Water trucks will be used for dust control on roadways. Handlines and nozzles connected to the conveyance system piping also will be used for dust control and general site cleanup.

C. Conservation

Please describe why the amount of water requested is needed and measures you propose to: prevent waste; measure the amount of water diverted; prevent damage to public uses of affected surface waters.

The amount of water requested under this application was authorized for storage under Permit R-15319 (Application R-879320) and Permit R-15320 (Application R-87932). Meters to measure water use will be installed at the diversion pumps located at each reservoir. The site operations, including protections for surface water, are regulated under a DOGAMI Permit.

SECTION 7: RESOURCE PROTECTION

In granting permission to use water from a stream or lake, the state encourages, and in some instances requires, careful control of activities that may affect the waterway or streamside area. See instruction guide for a list of possible permit requirements from other agencies. Please indicate any of the practices you plan to undertake to protect water resources:

- Diversion will be screened per ODFW specifications in ORS 498.301 through 498.346 to prevent uptake of fish and other aquatic life.
Describe planned actions: The reservoirs are located off-channel. There is a fish screen at the Grave Creek POD used to fill both reservoirs. As a result, no fish screen is needed to divert water from the reservoirs.
- Excavation or clearing of banks will be kept to a minimum to protect riparian or streamside areas.
Note: If disturbed area is more than one acre, applicant should contact the Department of Environmental Quality to determine if a 1200C permit is required.
Describe planned actions and additional permits required for project implementation: The reservoirs are located off-channel and have been constructed in general accordance with Permit R-15319 (Application R-879320) and Permit R-15320 (Application R-87932).
- Operating equipment in a water body will be managed and timed to prevent damage to aquatic life.
Describe planned actions and additional permits required for project implementation: The reservoirs are located off-channel.
- Water quality will be protected by preventing erosion and run-off of waste or chemical products.
Describe planned actions: The reservoirs are located off-channel.
- List other federal and state permits or contracts to be obtained, if a water right permit is granted.
The District 14 Watermaster, Scott Ceciliani, has inspected the reservoirs, which have been constructed in general accordance with Permit R-15319 (Application R-879320) and Permit R-15320 (Application R-87932). Mining activities at the site are being conducted under a DOGAMI.

SECTION 8: PROJECT SCHEDULE

- a) Date construction will begin: As soon as a permit is issued.
- b) Date construction will be completed: within 1-5 years of permit issuance
- c) Date beneficial water use will begin: within 1-5 years from permit issuance

Received by OWRD

OCT 10 2024

Salem, OR

Surface Water — Page 6

Rev. 07/21

SECTION 9: WITHIN A DISTRICT

Check here if the point of diversion or place of use are located within or are served by an irrigation or other water district.

Irrigation District Name NA	Address	
City	State	Zip

SECTION 10: REMARKS

Use this space to clarify any information you have provided in the application. (*Attach additional sheets if necessary*).

We have coordinated the development of the mine with the District 14 Watermaster, Scott Ceciliani, as well as with DOGAMI, the Oregon Department of Environmental Quality (DEQ) and Josephine County officials.

Received by OWRD
OCT 10 2024
Salem, OR

Minimum Requirements Checklist

Minimum Requirements (OAR 690-310-0040, OAR 690-310-0050 & ORS 537.140)

Include this checklist with the application

Check that each of the following items is included. The application will be returned if all required items are not included. If you have questions, please call the Water Rights Customer Service Group at (503) 986-0900.

Please submit the original application and signatures to the Water Resources Department. Applicants are encouraged to keep a copy of the completed application.

- SECTION 1: Applicant Information and Signature
- SECTION 2: Property Ownership
- SECTION 3: Source of Water
- SECTION 4: Sensitive, Threatened or Endangered Fish Species Public Interest Information
- SECTION 5: Water Use
- SECTION 6: Water Management
- SECTION 7: Resource Protection
- SECTION 8: Project Schedule
- SECTION 9: Within a District
- SECTION 10: Remarks

Include the following additional items:

- Land Use Information Form with approval and signature of local planning department (*must be an original*) or signed receipt.
- Provide the legal description of: (1) the property from which the water is to be diverted, (2) any property crossed by the proposed ditch, canal or other work, and (3) any property on which the water is to be used as depicted on the map.
- Fees - Amount enclosed: \$2,080.60
See the Department's Fee Schedule at www.oregon.gov/owrd or call (503) 986-0900.
- Map that includes the following items:
 - Permanent quality and drawn in ink
 - Even map scale not less than 4" = 1 mile (example: 1" = 400 ft, 1" = 1320 ft, etc.)
 - North Directional Symbol
 - Township, Range, Section, Quarter/Quarter, Tax Lots
 - Reference corner on map
 - Location of each diversion, by reference to a recognized public land survey corner (distances north/south and east/west)
 - Indicate the area of use by Quarter/Quarter and tax lot identified clearly.
 - NA Number of acres per Quarter/Quarter and hatching to indicate area of use if for primary irrigation, supplemental irrigation, or nursery
 - NA Location of main canals, ditches, pipelines or flumes (if well is outside of the area of use)

Received by OWRD

OCT 10 2024

Salem, OR

Surface Water — Page 83

Rev. 07/21

For Department Use: App. Number: _____

Land Use Information Form



Oregon Water Resources Department
 725 Summer Street NE, Suite A
 Salem, Oregon 97301-1266
 (503) 986-0900
 www.oregon.gov/OWRD

NAME Sunny Valley Sand and Gravel Inc. Attn: Andreas Blech				PHONE (541) 244-2644 226-8784	
MAILING ADDRESS 1867 Williams Highway, Suite 260					
CITY Grants Pass		STATE OR	ZIP 97527	EMAIL andreas@blech.us	

A. Land and Location

Please include the following information for all tax lots where water will be diverted (taken from its source), conveyed (transported), and/or used or developed. Applicants for municipal use, or irrigation uses within irrigation districts, may substitute existing and proposed service-area boundaries for the tax-lot information requested below.

Township	Range	Section	¼ ¼	Tax Lot #	Plan Designation (e.g., Rural Residential/RR-5)	Water to be:	Proposed Land Use:
See						<input type="checkbox"/> Diverted <input type="checkbox"/> Conveyed <input type="checkbox"/> Used	
Attached						<input type="checkbox"/> Diverted <input type="checkbox"/> Conveyed <input type="checkbox"/> Used	
List						<input type="checkbox"/> Diverted <input type="checkbox"/> Conveyed <input type="checkbox"/> Used	

List all counties and cities where water is proposed to be diverted, conveyed, and/or used or developed:

Josephine County

NOTE: A separate Land Use Information Form must be completed and submitted for each county and city, as applicable.

B. Description of Proposed Use

Type of application to be filed with the Oregon Water Resources Department:

- Permit to Use or Store Water
 Water Right Transfer
 Permit Amendment or Ground Water Registration Modification
 Limited Water Use License
 Exchange of Water
 Allocation of Conserved Water

Source of water: Reservoir/Pond Ground Water Surface Water (name) _____

Estimated quantity of water needed: Res. 2 = 13 AF; Res. 4 = 36 AF cubic feet per second gallons per minute acre-feet

Intended use of water:
 Irrigation Commercial Industrial Domestic for _____ household(s)
 Municipal Quasi-Municipal Instream Other Mining

Briefly describe:

We are requesting Oregon Water Resources Department approval to use water from two permitted reservoirs for mining activities at the site.

Note to applicant: For new water right applications only, if the Land Use Information Form cannot be completed while you wait, please have a local government representative sign the receipt on the bottom of page 4 and include it with the application filed with the Oregon Water Resources Department.

See Page 4 →

Received by OWRD

OCT 10 2021

For Local Government Use Only

The following section must be completed by a planning official from each county and city listed unless the project will be located entirely within the city limits. In that case, only the city planning agency must complete this form. This deals only with the local land use plan. Do not include approval for activities such as building or grading permits.

Please check the appropriate box below and provide the requested information

- Land uses to be served by the proposed water use(s), including proposed construction, are allowed outright or are not regulated by your comprehensive plan. Cite applicable ordinance section(s): _____
- Land uses to be served by the proposed water use(s), including proposed construction, involve discretionary land-use approvals as listed in the table below. (Please attach documentation of applicable land-use approvals which have already been obtained. Record of Action/land-use decision and accompanying findings are sufficient.) **If approvals have been obtained but all appeal periods have not ended, check "Being Pursued."**

Type of Land-Use Approval Needed (e.g., plan amendments, rezones, conditional-use permits, etc.)	Cite Most Significant, Applicable Plan Policies & Ordinance Section References	Land-Use Approval:	
See findings dated 12-7-16	Section 19.10A.030.B	<input checked="" type="checkbox"/> Obtained <input type="checkbox"/> Denied	<input type="checkbox"/> Being Pursued <input type="checkbox"/> Not Being Pursued
See findings dated 10-14-21	Section 19.72.040.B	<input checked="" type="checkbox"/> Obtained <input type="checkbox"/> Denied	<input type="checkbox"/> Being Pursued <input type="checkbox"/> Not Being Pursued
Development Permit	Section 19.72.040.B	<input checked="" type="checkbox"/> Obtained <input type="checkbox"/> Denied	<input type="checkbox"/> Being Pursued <input type="checkbox"/> Not Being Pursued
		<input type="checkbox"/> Obtained <input type="checkbox"/> Denied	<input type="checkbox"/> Being Pursued <input type="checkbox"/> Not Being Pursued

Local governments are invited to express special land use concerns or make recommendations to the Oregon Water Resources Department regarding this proposed use of water in the box below or on a separate sheet.

Josephine County Planning
 700 NW Dimmick Street
 Suite C
 Grants Pass, OR 97526

Name: Jami Smith Title: Associate Planner
 Signature: Jami Smith Date: 10-3-24
 Governmental Entity: Josephine County Phone: 541-474-5424

Receipt Acknowledging Request for Land Use Information

Note to Local Government Representative:
 Please complete this form and return it to the applicant. **For new water right applications only**, if you are unable to complete this form while the applicant waits, you may complete this receipt and return it to the applicant. If you sign the receipt, you will have 30 days from the date of OWRD's Public Notice of the application to submit the completed Land Use Information Form to Oregon Water Resources Department. Please note while OWRD can accept a signed receipt as part of intake for an application for a new permit to use or store water, a completed Land Use Information Form is required for all other applications.

Applicant Name: _____

Staff Name: _____ Title: _____

Staff Signature: _____ Date: _____

Governmental Entity: _____ Phone: _____

Received by OWRD
OCT 10 2024
Salem, OR

OCT 01 2024

ATTACHMENT TO:

Oregon Water Resources Department

Land Use Information Form

Applicant Name: Sunny Valley Sand and Gravel Inc.

A. Land and Location

Please include the following information for all tax lots where water will be diverted (taken from its source), conveyed (transported), or used. Applicants for municipal use, or irrigation uses within irrigation districts may substitute existing and proposed service-area boundaries for the tax-lot information requested below.

Township	Range	Section	¼ ¼	Tax Lot #	Plan designation	Water to be:	Proposed Land Use:
34 S	5 W	7	NE SE	1200		<input type="checkbox"/> Diverted <input checked="" type="checkbox"/> Conveyed <input checked="" type="checkbox"/> Used	Aggregate Mining
34 S	5 W	7	SE SE	1300		<input type="checkbox"/> Diverted <input checked="" type="checkbox"/> Conveyed <input checked="" type="checkbox"/> Used	Aggregate Mining
34 S	5 W	8	NE SW	400		<input checked="" type="checkbox"/> Diverted <input checked="" type="checkbox"/> Conveyed <input checked="" type="checkbox"/> Used	Aggregate Mining
34 S	5 W	8	NW SW	400		<input checked="" type="checkbox"/> Diverted <input checked="" type="checkbox"/> Conveyed <input checked="" type="checkbox"/> Used	Aggregate Mining
34 S	5 W	8	SW SW	400		<input checked="" type="checkbox"/> Diverted <input checked="" type="checkbox"/> Conveyed <input checked="" type="checkbox"/> Used	Aggregate Mining
34 S	5 W	8	SE SW	400		<input checked="" type="checkbox"/> Diverted <input checked="" type="checkbox"/> Conveyed <input checked="" type="checkbox"/> Used	Aggregate Mining
34 S	5 W	8	NW SE	1002		<input type="checkbox"/> Diverted <input checked="" type="checkbox"/> Conveyed <input checked="" type="checkbox"/> Used	Aggregate Mining

Received by OWRD

OCT 10 2024

Salem, OR



Community Development - Planning Division
 700 NW Dimmick, Suite C
 Grants Pass, OR 97526

Receipt Number: PL24-01013

(541) 474-5421
 planning@josephinecounty.gov

Payer/Payee: BLECH, ANDREAS & BLECH, CAROLE
 1867 WILLIAMS HWY STE 270
 GRANTS PASS OR 97527

Cashier: Tami Smith

Date: 10/01/2024

Primary Parcel: 34050700001200 **Project Description:** Water Resource

PL-2024-01207 LAND USE INFORMATION RESPONSE 274 DAISY MINE RD

<u>Fee Description</u>	<u>Fee Amount</u>	<u>Amount Paid</u>	<u>Fee Balance</u>
Land Use Information Response	\$125.00	\$125.00	\$0.00
	\$125.00	\$125.00	\$0.00

<u>Payment Method</u>	<u>Reference Number</u>	<u>Payment Amount</u>
CHECK	10305	\$125.00
Total Paid:		\$125.00

Received by OWRD
 OCT 10 2024
 Salem, OR

3

1

JOSEPHINE COUNTY OFFICIAL RECORDS
ART HARVEY, COUNTY CLERK 2010-013083
DED-WRD 10/12/2010 10:31 AM
Cnt=1 Pgs=3 Stn=3 TMORRIS
\$15.00 \$11.00 \$15.00 \$8.00 \$5.00 Total:\$54.00



00258612201000130830030037

I, Art Harvey, County Clerk, certify that the within document was received and duly recorded in the official records of Josephine County.

Ca 1632465 (89)

After Recording Return to:
Andreas Blech and Carole Blech
1867 Williams Hwy., #270
Grants Pass, OR 97527

Until a change is requested,
all tax statements shall be
sent to the following address:
Andreas Blech and Carole Blech
1867 Williams Hwy., #270
Grants Pass, OR 97527

5A.

WARRANTY DEED

DOUG AND JACK'S MINE, LLC, an Oregon Limited Liability Company, Grantor, conveys and warrants to **ANDREAS BLECH and CAROLE BLECH**, husband and wife as tenants by the entirety, Grantees, all of it's right, title and interest in and to the following described real property located at 153 Daisy Mine Road, Wolf Creek, Oregon 97497, more particularly described as follows:

The Southeast Quarter of the Southeast Quarter of Section 7, and the Southwest Quarter of Section 8, all in Township 34, Range 5 West of the Willamette Meridian, Josephine County, Oregon, EXCEPTING THEREFROM and portion lying Northerly of the Southerly right-of-way line of Placer Road. TOGETHER WITH: An Easement appurtenant to the herein described property for ingress and egress including the terms and provisions thereof, as set forth in instrument recorded in Document No. Volume 324, Page 572, Josephine County Deed Records of Josephine County, Oregon

Tax Parcel Number R300831 and R300826

The true and actual consideration for this transfer is the sum of Six hundred thousand Dollars (\$600,000.00)

Subject to:

- 1. Rights of the public and of governmental bodies in and to that portion of the premises herein described lying within the limits of streets, roads and highways.

Received by OWRD

OCT 10 2024

Salem, OR

- 2. Easement for electric transmission and distribution lines of one or more wires, and all necessary or desirable appurtenances, including telephone and telegraph wires, towers poles, props, guys, and other supports; and related matters.

Recording information: Volume 153, Page 466, and Volume 165, Page 569, Josephine County Deed Records.

Grantee: California Oregon Power Company
 Affects: Not Specific

- 3. Easement for electric transmission and distribution of one or more wires and all necessary or desirable appurtenances, including telephone and telegraph wires towers, poles, props, guys and other supports; and related matters.

Recording Information: Volume 214, Page 467, Josephine County Deed Records

Grantee: California Oregon Power Company
 Affects: Not Specific

- 4. Easement, including the terms and provisions contained therein:

Recording Information: Volume 229, Page 399, Josephine County Deed Records

For: Gas Pipeline

- 5. Easement, including terms and provisions contained therein:

Recording Information: Volume 324, Page 1721, Josephine County Deed Records

For: Permanent easement for roadway purposes (Affects TL 400)

- 6. Easement, including terms and provisions contained therein:

Recording Information: Volume 326, Page 1318, Josephine County Deed Records

For: Well and Pipeline (Affects TL400)

- 7. Easement, including terms and provisions contained therein:

Recording Information: 2002-007430 and re-recorded as 2002-008736 Official Records of Josephine County, Oregon.

For: A permanent easement for roadway purposes

Received by OWRD

OCT 10 2024

Salem, OR

(3)

~~The total consideration for this instrument is the sum of six hundred thousand~~

~~Dollars (\$600,000.00).~~

Dated this 6th day of October, 2010.

NOTE: THIS INSTRUMENT WILL NOT ALLOW USE OF THE PROPERTY DESCRIBED IN THIS INSTRUMENT IN VIOLATION OF APPLICABLE LAND USE LAWS AND REGULATIONS. BEFORE SIGNING OR ACCEPTING THIS INSTRUMENT, THE PERSON ACQUIRING FEE TITLE TO THE PROPERTY SHOULD CHECK WITH THE APPROPRIATE CITY OR COUNTY PLANNING DEPARTMENT TO VERIFY APPROVED USES AND TO DETERMINE ANY LIMITS ON LAWSUITS AGAINST FARMING OR FOREST PRACTICES AS DEFINED IN ORS 30.930.

THE PROPERTY DESCRIBED IN THIS INSTRUMENT MAY NOT BE WITHIN A FIRE PROTECTION DISTRICT PROTECTING STRUCTURES. THE PROPERTY IS SUBJECT TO LAND USE LAWS AND REGULATIONS WHICH IN FARM OR FOREST ZONES MAY NOT AUTHORIZE CONSTRUCTION OR SITING OF A RESIDENCE AND WHICH LIMIT LAWSUITS AGAINST FARMING OR FOREST PRACTICES AS DEFINED IN ORS 30.930 IN ALL ZONES. BEFORE SIGNING OR ACCEPTING THIS INSTRUMENT, THE PERSON ACQUIRING FEE TITLE TO THE PROPERTY SHOULD CHECK WITH THE APPROPRIATE CITY OR COUNTY PLANNING DEPARTMENT TO VERIFY APPROVED USES AND EXISTENCE OF FIRE PROTECTION FOR STRUCTURES.

DOUG AND JACK'S MINE, LLC, an Oregon limited liability company

By: [Signature]
Jack H. Smith, ~~Managing Member~~, Trustee of the Smith Family Trust dated July 28, 2008 as Managing Member

STATE OF OREGON)
) ss.
COUNTY OF JACKSON)

This instrument was acknowledged before me on October 6, 2010 by Jack H. Smith as ******
~~Managing Member of Doug and Jack's Mine, LLC.~~

Barbara J. Feinstein
Notary Public for Oregon

** Trustee of the Smith Family Trust dated July 28, 2008 as Managing Member of Doug and Jack's Mine, LLC.

3 - Warranty Deed

Received by OWRD
OCT 10 2024
Salem, OR

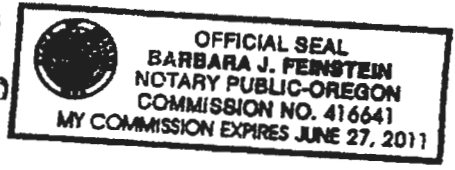



October 9, 2024
Project No. 10058.004

Oregon Water Resources Department
725 Summer Street NE, Suite A
Salem, OR 97301

Via UPS Ground

**Application for a Permit to Use Surface Water (Stored Water)
Sunny Valley Sand and Gravel Inc.
Josephine County, Oregon**

To Whom It May Concern,

Skookum Water Associates Inc. is filing this Application for a Permit to Use Surface Water on behalf of Sunny Valley Sand and Gravel Inc. The source will be water stored in Reservoirs 2 and 4 constructed under Permit R-15320 (Application R-87930) and Permit R-15319 (Application R-87932), respectively. As indicated in the application form, Shonee Langford of Schwabe, Williamson & Wyatt is Sunny Valley Sand and Gravel Inc.'s designated agent.

The enclosed application package consists of the following documents:

- An Application for a Permit to Use Surface Water signed on September 30, 2024 by Andreas Blech, President of Sunny Valley Sand and Gravel Inc.;
- A September 27, 2024 Application for a Secondary Use Permit Application Map prepared by Skookum Water Associates Inc.;
- Check Number 10308 issued on October 3, 2024 by Sunny Valley Sand and Gravel Inc. for \$2080.60 to pay the application fee;
- A Land Use Information form signed on October 3, 2024 by Tami Smith, Josephine County Associate Planner; and
- A Warranty Deed for Andreas Blech and Carole Blech Filed in Josephine County on October 12, 2010.

Thank you for your assistance.

Sincerely,

SKOOKUM WATER ASSOCIATES INC.

Steven R. Bruce, RG, CWRE
Principal Hydrogeologist

enclosures

cc. Andreas Blech; Sunny Valley Sand and Gravel Inc.
Shonee Langford; Schwabe Williamson & Wyatt (via email)

Received by OWRD
OCT 10 2024
Salem, OR

OREGON



WATER RESOURCES
DEPARTMENT

Received by OWRD

OCT 10 2024

Salem, OR

Date Received (Date Stamp Here)

OWRD Over-the-Counter Submission Receipt

Applicant Name(s) & Address: Sunny Valley Sand & Gravel Inc.
1867 Williams Hwy #260, Grants Pass OR 97527

Transaction Type: Surface Water

Fees Received: \$ 2,080.60

Cash

Check:

Check No. 10308

Name(s) on Check: same as applicant

Thank you for your submission. Oregon Water Resources Department (Department) staff will review your submittal as soon as possible.

If your submission is determined to be complete, you will receive a receipt for the fees paid and an acknowledgement letter stating your submittal is complete.

If determined to be incomplete, your submission and the accompanying fees will be returned with an explanation of deficiencies that must be addressed in order for the submittal to be accepted.

If you have any questions, please feel free to contact the Department's Customer Service staff at 503-986-0801 or 503-986-0810.

Sincerely,

OWRD Customer Service Staff

Submission received by: Corie Lovrien

(Name of OWRD staff)

Instructions for OWRD staff:

- Complete this Submission Receipt and make two (2) copies. Place one copy with the check/cash; and place the other copy with the submission (i.e., the application or other document).
- Date-stamp all pages. (NOTE: Do not stamp check.)
- Give this original Submission Receipt to the applicant.
- Record Submission Receipt information on the "RECEIVED OVER THE COUNTER" log sheet.
- Fold and put one copy of the Submission Receipt with check/cash into the Safe slot. Place the other copy of the Submission Receipt with submission (application/other document) in the top drawer of filing cabinet.

OREGON



WATER RESOURCES
DEPARTMENT

Received by OWRD

OCT 10 2024

Salem, OR

Date Received (Date Stamp Here)

OWRD Over-the-Counter Submission Receipt

Applicant Name(s) & Address: Sunny Valley Sand & Gravel Inc.
1867 Williams Hwy #260, Grants Pass OR 97527

Transaction Type: Surface Water

Fees Received: \$ 2,080.60

Cash

Check:

Check No. 10308

Name(s) on Check: same as applicant

Thank you for your submission. Oregon Water Resources Department (Department) staff will review your submittal as soon as possible.

If your submission is determined to be complete, you will receive a receipt for the fees paid and an acknowledgement letter stating your submittal is complete.

If determined to be incomplete, your submission and the accompanying fees will be returned with an explanation of deficiencies that must be addressed in order for the submittal to be accepted.

If you have any questions, please feel free to contact the Department's Customer Service staff at 503-986-0801 or 503-986-0810.

Sincerely,

OWRD Customer Service Staff

Submission received by: Corie Lorrain

(Name of OWRD staff)

Instructions for OWRD staff:

- Complete this Submission Receipt and make two (2) copies. Place one copy with the check/cash; and place the other copy with the submission (i.e., the application or other document).
- Date-stamp all pages. (NOTE: Do not stamp check.)
- Give this original Submission Receipt to the applicant.
- Record Submission Receipt Information on the "RECEIVED OVER THE COUNTER" log sheet.
- Fold and put one copy of the Submission Receipt with check/cash into the Safe slot. Place the other copy of the Submission Receipt with submission (application/other document) in the top drawer of filing cabinet.

SECTIONS 7 & 8, T34S, R5W, W.M.
JOSEPHINE COUNTY

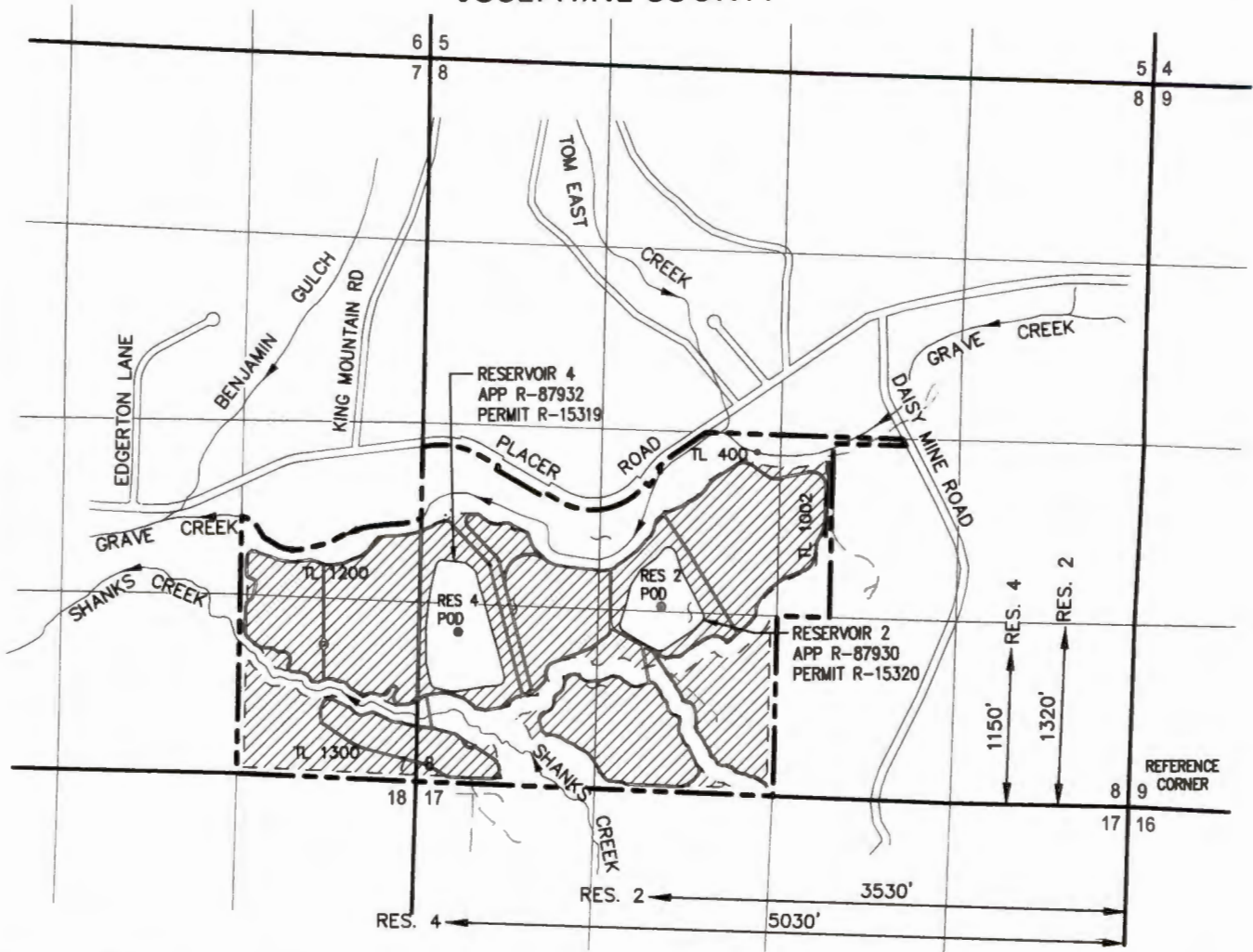

EXPLANATION

- POINT OF DIVERSION (POD)
- SECTION LINE
- - - PROPERTY LINE
- CREEK OR INTERMITTENT STREAM
- == PAVED ROAD
- GRAVEL ROAD
- - - UNPAVED ROAD
- ▨ PROPOSED MINING PLACE OF USE

NOTE:

THE LOCATION OF THE POINT OF DIVERSION (POD) IN EACH RESERVOIR IS EXPECTED TO CHANGE AS MINING OCCURS, THEREFORE, WE ARE REQUESTING THE POD LOCATION FOR EACH RESERVOIR BE DESCRIBED AS BEING WITHIN THE RESERVOIR. THE SPECIFIC POD IS AN EXAMPLE OF A TYPICAL POD FOR PUMPING WATER FROM ANYWHERE WITHIN THE RESERVOIRS.

Received by OWRD

OCT 10 2024

Salem, OR

SEPTEMBER 27, 2024

THIS MAP IS NOT INTENDED TO PROVIDE LEGAL DIMENSIONS OR LOCATIONS OF PROPERTY OWNERSHIP LINES

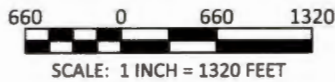

SKOOKUM
WATER ASSOCIATES INC

1626 VICTORIAN WAY
EUGENE, OR 97401
(503) 319-8926

Sunny Valley Sand and Gravel Inc.
Application for a Secondary Use Permit
Westlake Consultants, Inc.