

SECTIONS 7 & 8, T34S, R5W, W.M.  
JOSEPHINE COUNTY

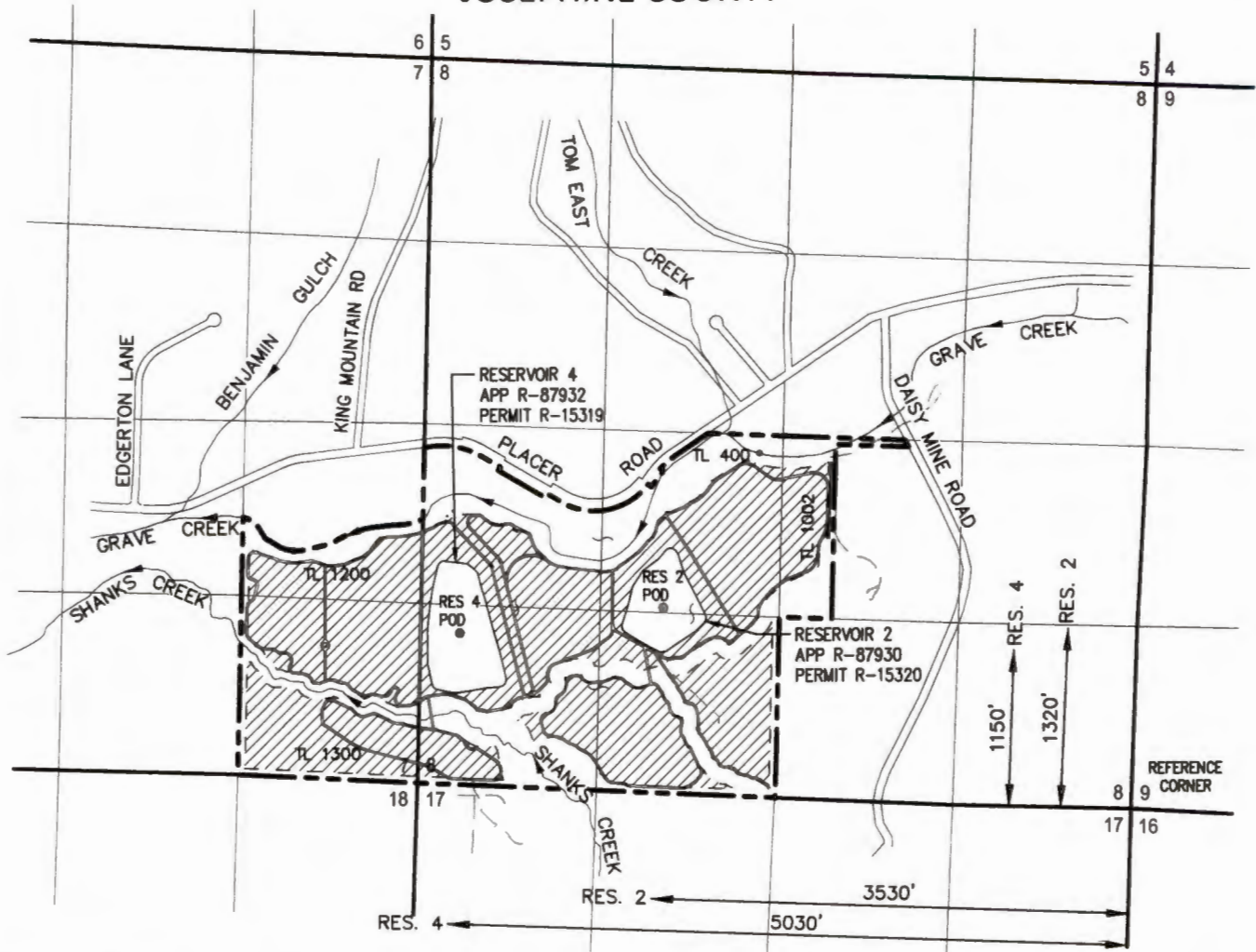

**EXPLANATION**

- POINT OF DIVERSION (POD)
- SECTION LINE
- - - PROPERTY LINE
- CREEK OR INTERMITTENT STREAM
- == PAVED ROAD
- GRAVEL ROAD
- UNPAVED ROAD
- ▨ PROPOSED MINING PLACE OF USE

**NOTE:**

THE LOCATION OF THE POINT OF DIVERSION (POD) IN EACH RESERVOIR IS EXPECTED TO CHANGE AS MINING OCCURS, THEREFORE, WE ARE REQUESTING THE POD LOCATION FOR EACH RESERVOIR BE DESCRIBED AS BEING WITHIN THE RESERVOIR. THE SPECIFIC POD IS AN EXAMPLE OF A TYPICAL POD FOR PUMPING WATER FROM ANYWHERE WITHIN THE RESERVOIRS.

Received by OWRD

OCT 10 2024

Salem, OR

SEPTEMBER 27, 2024

THIS MAP IS NOT INTENDED TO PROVIDE LEGAL DIMENSIONS OR LOCATIONS OF PROPERTY OWNERSHIP LINES

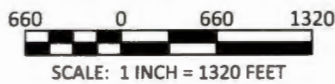

**SKOOKUM**  
WATER ASSOCIATES INC

1626 VICTORIAN WAY  
EUGENE, OR 97401  
(503) 319-8926

Sunny Valley Sand and Gravel Inc.  
Application for a Secondary Use Permit  
Westlake Consultants, Inc.