

Name J. S. Tellvik  
By \_\_\_\_\_  
Address Rt. 1, Box 515  
Cave Junction, Oregon

Application No. G 2204  
Permit No. G 2026  
Certificate No. ~~33163~~ 76333+79434

Stream Index, Page No. 15-95

FEES PAID		
Date	Amount	Receipt No.
<u>1/2/62</u>	<u>\$22<sup>50</sup></u>	<u>32207</u>
<u>4-13-66</u>	<u>\$1 Cert. Fee</u>	<u>9190</u>
FEES REFUNDED		
Date	Amount	Check No.

Date filed January 2, 1962  
Priority January 2, 1962  
Action suspended until ok cont  
Returned to applicant \_\_\_\_\_  
Date of approval February 13, 1962

**CONSTRUCTION**  
Date for beginning February 13, 1963  
Date for completion October 1, 1963  
Extended to \_\_\_\_\_  
Date for application of water October 1, 1964  
Extended to \_\_\_\_\_

**PROSECUTION OF WORK**  
Form "A" filed March 28, 1963  
Form "B" filed Sept. 24, 1963  
Form "C" filed Oct. 27, 1964

**FINAL PROOF**  
Blank mailed MARCH 23 1966  
Proof received \_\_\_\_\_  
Date certificate issued 1 JULY 18 1966

**ASSIGNMENTS**

Date	To Whom	Address	Volume	Page

**REMARKS**

1.01 c.f.s. from Tellvik Well (Democrat Creek) (Sucker Creek) for irrigation and supplemental irrigation of 80.7 acres.

FEB 20 1963 CARD FOR A  
SEP 19 1963 CARD FOR B  
OCT 21 1964 CARD FOR C

T 7857 A POA V53 p 1471

**W.R.I.S.**

Assembled 12-13-84 by JG

Entered \_\_\_\_\_ by \_\_\_\_\_

Verified \_\_\_\_\_ by \_\_\_\_\_

*982*

Form A

NOTICE OF BEGINNING OF CONSTRUCTION

Application No. ....

I, J.S. Tellvik, the holder of Permit No. G-2026

to appropriate the public waters of the state of Oregon, began the actual construction of the works described therein on the 1st day of October, 1962

Remarks: Worked myself and hired one man  
The appropriator should state the manner of beginning construction work, number of men employed, the amount of work completed

with dragline to dig out reservoir.  
up to the date of this statement, and any additional information which may tend to show the beginning of work in good faith.

IN WITNESS WHEREOF, I have hereunto set my hand this 10<sup>th</sup> day of March, 1963

J. Tellvik (Signature of Applicant) Cave Junction, Oregon (Address)

Fill out, detach, and mail to the State Engineer, Salem, Oregon, when construction work is begun.

State Printing 37515

RECEIVED  
MAR 28 1963  
STATE ENGINEER  
SALEM, OREGON

Form B

NOTICE OF COMPLETION OF CONSTRUCTION

Application No. G-2026 2204

I, J. S. Tellvik, the holder of Permit No. G-2026

to appropriate the public waters of the state of Oregon, completed the construction of the works described therein on the 23rd day of September, 1963.

Remarks: .....  
If the works have less capacity than described in the permit, or you have definitely abandoned part of the proposed development, you

should so state in order that our records may not be unnecessarily encumbered.

IN WITNESS WHEREOF, I have hereunto set my hand this 23rd day of September, 1963.

J. Tellvik (Signature of Applicant) Rt. 1 Box 515 Cave Junction, Oregon (Address)

Fill out, detach, and mail to the State Engineer, Salem, Oregon, when construction work is completed.

RECEIVED  
SEP 21 1963  
STATE ENGINEER  
SALEM, OREGON

Form C

**IMPORTANT**—This form is a notice to the State Engineer that permittee is ready to make final proof to the extent to which the water has actually been applied to the intended use under the terms of the permit. Permittee is cautioned that Certificate of Water Right will be issued based on the extent of the quantity and use as determined by the final proof inspection and survey which will be made in response to the filing of this Form C.

NOTE: In the case of an irrigation permit, this Form C should not be mailed to the State Engineer until all of the land described in the permit, which it is intended to irrigate under this permit at any time, has actually been irrigated.  
Fill out, detach and mail to the State Engineer, Salem, Oregon, when all of the water has been applied.

Application No. G-2204

NOTICE OF COMPLETE APPLICATION OF WATER TO A BENEFICIAL USE

I, J. S. TELLVIK, the holder of Permit No. G-2026

to appropriate the public waters of the state of Oregon, completely applied the waters to a beneficial use in accordance with the terms of said permit, on the 28<sup>TH</sup> day of SEPTEMBER, 1964.

Remarks: I AM READY FOR FINAL PROOF, HAVING APPLIED THE WATER

ON THE ACREAGE INTENDED.

IN WITNESS WHEREOF, I have hereunto set my hand this 23<sup>RD</sup> day of OCTOBER, 1964

J. Tellvik (Signature of Applicant) Rt. 1 Box 515 Cave Junction, Oregon (Address)

RECEIVED  
OCT 27 1964  
STATE ENGINEER  
SALEM, OREGON

STATE OF OREGON

COUNTY OF JOSEPHINE

ORDER APPROVING A CHANGE IN CHARACTER OF USE  
AND A CHANGE IN POINT OF DIVERSION  
AND PARTIAL CANCELLATION OF A WATER RIGHT

Pursuant to ORS 537.705, after notice was given and no objections were filed, and finding that no injury to existing water rights would result, this order approves, as conditioned or limited herein, TRANSFER 7857 submitted by

WADE SIMPSON  
P.O. BOX 1309  
CAVE JUNCTION, OREGON 97523.

The right to be modified, as evidenced by a PORTION of Certificate 33163, was perfected under Permit G-2026 with a date of priority of JANUARY 2, 1962. The right allows the use of TELLVIK WELL, in the DEMOCRAT CREEK BASIN, for IRRIGATION OF 2.8 ACRES AND SUPPLEMENTAL IRRIGATION OF 10.8 ACRES. The amount of water to which this right is entitled is limited to an amount actually beneficially used and shall not exceed 0.17 cubic foot per second, if available at the original well; SW¼ NW¼, AS PROJECTED WITHIN NEWMAN DLC 39, SECTION 6, T 40 S, R 7 W, W.M.; WELL LOCATED 2600 FEET SOUTH AND 200 FEET EAST FROM THE NW CORNER OF SECTION 6, or its equivalent in case of rotation, measured at the well.

This is a final order in other than contested case. This order is subject to judicial review under ORS 183.484. Any petition for judicial review must be filed within the 60 day time period specified by ORS 183.484(2).

Pursuant to ORS 536.075 and OAR 137-004-080 and OAR 690-01-005 you may either petition for judicial review or petition the Director for reconsideration of this order.

The amount of water used for irrigation, together with the amount secured under any other right existing on the same lands, is limited to ONE-EIGHTIETH of one cubic foot per second per acre, or its equivalent for each acre irrigated and shall be further limited to a diversion of not to exceed 2½ acre-feet per acre for each acre irrigated during the irrigation season of each year.

The use shall conform to any reasonable rotation system ordered by the proper state officer.

The authorized place of use is as follows:

	<u>CHANGE IN POA ONLY</u>	<u>CHANGE IN USE AND POA</u>
	<u>PRIMARY</u>	<u>SUPPLEMENTAL</u>
NE¼ SW¼		0.7 ACRE
NW¼ SW¼	1.2 ACRES	10.1 ACRES
SW¼ SW¼	1.6 ACRES	
ALL AS PROJECTED WITHIN NEWMAN DLC 39 SECTION 6		

TOWNSHIP 40 SOUTH, RANGE 7 WEST, W.M.

This use may be regulated if analysis of data available discloses that the appropriation will measurably reduce the surface water flows necessary to maintain the free-flowing character of a scenic waterway in quantities necessary for recreation, fish and wildlife in effect as of the priority date of this right or as those quantities may be reduced.

The right to use water for the above purpose is restricted to beneficial use on the lands or place of use described.

The applicant proposes to change the point of appropriation to:

NW¼ SW¼, AS PROJECTED WITHIN NEWMAN DLC 39, SECTION 6,  
T 40 S, R 7 W, W.M.; 1727 FEET NORTH AND 473 FEET EAST FROM THE  
SW CORNER OF SECTION 6.

The applicant proposes to change the character of use from SUPPLEMENTAL IRRIGATION OF 10.8 ACRES to PRIMARY IRRIGATION OF 10.8 ACRES.

An affidavit was received from Mildred L. Frick, owner of certain land and the water right appurtenant to it. A portion of the water right has been abandoned and requested to be cancelled.

The portion is described by Certificate 10170, State Record of Water Right Certificates. The date of priority is APRIL 25, 1930. The water use was for SUPPLEMENTAL IRRIGATION of 10.8 ACRES from DEMOCRAT GULCH AND MULVANEY GULCH, a tributary of the ILLINOIS RIVER. The amount used was 0.11 CUBIC FOOT PER SECOND(CFS) FROM MULVANEY GULCH AND 0.03 CFS FROM DEMOCRAT GULCH.

The abandoned portion is located as follows:

NE $\frac{1}{4}$  SW $\frac{1}{4}$  0.7 ACRE  
NW $\frac{1}{4}$  SW $\frac{1}{4}$  10.1 ACRES  
SECTION 6  
TOWNSHIP 40 SOUTH, RANGE 7 WEST, W.M.

ORS 540.610 provides: "Whenever the owner of a perfected and developed water right certifies under oath to the Water Resources Commission that the water right has been abandoned by the owner and that the owner desires cancellation thereof, the commission shall enter an order cancelling the water right."

THIS CHANGE TO AN EXISTING WATER RIGHT MAY BE MADE PROVIDED THE FOLLOWING CONDITIONS ARE MET BY THE WATER USER:

1. The proposed changes shall be completed on or before October 1, 2001.
2. The quantity of water diverted at the new point of appropriation (well), together with the quantity diverted at the old point of appropriation, shall not exceed the quantity of water lawfully available from the original point of appropriation.

3. When required by the Department the water user shall install an in-line flow meter or other suitable device for measuring and recording the quantity of water used. The type and plans of the measuring device must be approved by the Department prior to beginning construction and shall be installed under the general supervision of the Department.
4. Water shall be acquired from the same aquifer as the original point of appropriation.

The portion of the water right requested to be cancelled is cancelled. Certificates 10170 and 33163 are cancelled. New certificates will be issued to confirm those portions of the rights NOT involved in the transfer and cancellation proceedings. When satisfactory proof of the completed change is received, a new certificate confirming this water right will be issued.

WITNESS the signature of the Water Resources

Director, affixed DEC 08 1999.

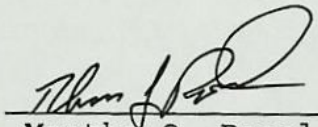
  
for Martha O. Pagel, Director

6-2204

# STATE OF OREGON

COUNTY OF JOSEPHINE

## Proof of Appropriation of Water

**RECEIVED**  
APR 13 1966  
STATE ENGINEER  
SALEM OREGON

J. S. TELLVIK

of **Route 1, Box 515, Cave Junction**, State of **Oregon**,  
has applied beneficially the waters of  
**Tellvik Well**

a tributary of **Democrat Creek, Tributary of Sucker Creek** for the purpose of  
irrigation of **3.6 acres and supplemental irrigation of 52.8 acres**

under Permit No. **G-2026** of the State Engineer, and that the use of said waters has been  
completed under the terms of said permit; that the priority of the  
right dates from **January 2, 1962**

that the amount of water for the purposes aforesaid, has been actually beneficially used in the  
amount of  
**0.71 cubic foot per second**

or its equivalent in case of rotation, measured at the point of diversion from the stream.  
The point of diversion is located in the **SW $\frac{1}{4}$  NW $\frac{1}{4}$**  as projected within **Newman DLC 39, Section 6, T. 40 S., R. 7 W., W. M.** Well located **2600 feet South and 200 feet East** from the NW Corner, Section 6.

The amount of water used for irrigation, together with the amount secured under any other right existing for the same lands, shall be limited to **one-eightieth** of one cubic foot per second per acre, or its equivalent for each acre irrigated and shall be further limited to a diversion of not to exceed **2 $\frac{1}{2}$  acre feet per acre** for each acre irrigated during the irrigation season of each year;

and shall conform to such reasonable rotation system as may be ordered by the proper state officer.

A description of the place of use under the right, and to which such right is appurtenant, is as follows:

Supplemental	Primary	
10.0	0.8	acres SW $\frac{1}{4}$ NW $\frac{1}{4}$
0.4		acre SE $\frac{1}{4}$ NW $\frac{1}{4}$
3.6		acres NE $\frac{1}{4}$ SW $\frac{1}{4}$
24.4	1.2	acres NW $\frac{1}{4}$ SW $\frac{1}{4}$
	1.6	acres SW $\frac{1}{4}$ SW $\frac{1}{4}$
all as projected within Newman DLC 39		
Section 6		
T. 40 S., R. 7 W., W. M.		
6.0		acres SE $\frac{1}{4}$ NE $\frac{1}{4}$
8.4		acres NE $\frac{1}{4}$ SE $\frac{1}{4}$
both as projected within Newman DLC 47		
Section 1		
T. 40 S., R. 8 W., W. M.		

I have read the above and foregoing proof of appropriation of water; I know the contents thereof, and that the facts therein stated are true.

IN WITNESS WHEREOF, I have hereunto set my hand this 10<sup>th</sup> day of April,

19.66.

*J. Tellvik*

T. 40S.

R. 8W.

R. 7W.

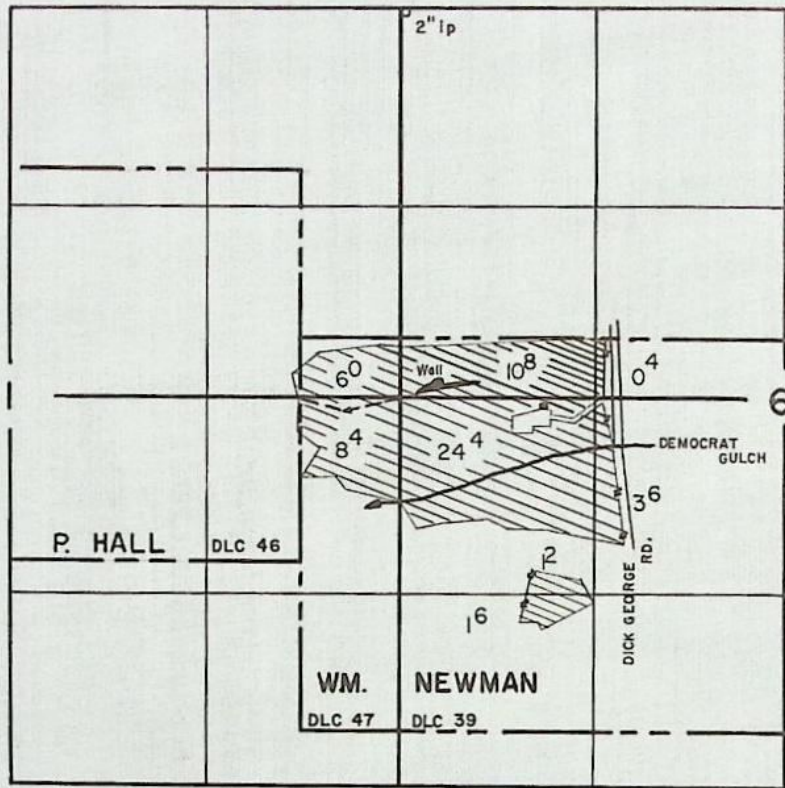

**FINAL PROOF SURVEY**  
UNDER

Application No. G-2204 Permit No. G-2026  
IN NAME OF

J. S. TELLVIK

Surveyed Feb. 3, 1965, by R.B. Steimer



# Abstract of Permit No. G-2026

**RECEIVED**  
MAR 19 1965  
STATE ENGINEER  
SALEM OREGON

Application No. G-2204 Certificate No.

Name: J. S. Tellvik  
 Address: Route 1, Box 515, Cave Junction, Oregon  
 Source of water supply: Tellvik Well, trib. Democrat Creek, trib. Sucker Creek  
 Use: Irrigation and supplemental irrigation of 3.6 and 52.8  
 Point of diversion: ~~Due S. 2600' from the NW cor. Section 6; being within the SW 1/4, Sec. 6, T. 40 S., R. 7 W., W.M., in the county of Josephine.~~ as proj. w/in Newman DLC 39  
 Number of acres: ~~80.7~~

Well located 2600's & 200' E from the NW Cor Sec. 6  
 DESCRIPTION OF LAND TO BE IRRIGATED OR PLACE OF USE

		Supply	Primary	Total
T. 40S R7W Sec 6				
Sec 6	SW 1/4 NW 1/4 as proj w/in Newman DLC 39	10.0	0.2	10.2
	SE 1/4 NW 1/4 " " " " " "	0.4		0.4
	NE 1/4 SW 1/4 " " " " " "	3.6		3.6
	NW 1/4 SW 1/4 " " " " " "	24.4	1.2	25.6
	SW 1/4 SW 1/4 " " " " " "		1.6	1.6
T 40S R 8 W Sec 1				
	SE 1/4 NE 1/4 " " " " " "	4.7		4.7
	NE 1/4 SE 1/4 " " " " " "	4.7		4.7
		52.8	3.6	56.4

Time limit to complete construction extended to  
 Time limit to completely apply water 12/31/64 extended to

Remarks: This appropriation shall be limited to 1/80th of 1 c.f.s. or its equiv. for each acre irrigated & shall be further limited to a diversion of not to exceed 2 1/2 a.f. per acre for each acre irrigated during the irrigation season of each year; & the right allowed hereunder for the appropriation of water for lands having a valid prior right shall be limited to the amt. necessary to make up any deficiency in water available to said lands under said prior right & the amt. allowed herein, together with the amt. secured under any other right existing for said lands, shall be lmt. by the duty of water as fixed herein; & shall be subject to such reasonable rotation system as may be ordered by the proper state officer.

Basin 15 Vol. 13383

# Abstract of Permit No. G-2026

**RECEIVED**  
MAR 19 1965  
STATE ENGINEER  
SALEM OREGON

Application No. G-2204

Certificate No.

Name: J. S. Tellvik  
Address: Route 1, Box 515  
Cave Junction, Oregon

Source of water supply: Tellvik Well, trib. Democrat Creek, trib. Sucker Creek

Use: Irrigation and supplemental irrigation of 3.6 + 52.8

Point of diversion: ~~Due S. 2600' from the NW cor. Section 6; being within the SW1/4, Sec. 6, T. 40 S., R. 7 W., W.M., in the county of Josephine.~~ as proj. w/in Newman DLC 39

Number of acres: ~~20.7~~ Well located 2600's & 200' E from the NW Cor Sec. 6

### DESCRIPTION OF LAND TO BE IRRIGATED OR PLACE OF USE

Twp.	Range	Sec.	NE1/4				NW1/4				SW1/4				SE1/4			
			NE1/4	NW1/4	SW1/4	SE1/4	NE1/4	NW1/4	SW1/4	SE1/4	NE1/4	NW1/4	SW1/4	SE1/4	NE1/4	NW1/4	SW1/4	SE1/4
40 S	7 W	6						10				30						
40 S	8 W	1			6.5										9.5			
THE ABOVE FOR SUPPLEMENTAL																		
40 S	7 W	6									5.7	5.8						
40 S	8 W	1													8.3			4.9
THE ABOVE FOR NEW																		

Priority date: January 2, 1962  
Amount of water: ~~1.61 c.f.s., measured at the point of diversion~~  
0.71

Time limit to begin construction: February 13, 1963

Time limit to complete construction: 10/1/63 extended to extended to

Time limit to completely apply water: 10/1/64 extended to extended to  
This appropriation shall be limited to 1/80th of 1 c.f.s. or its equiv. for each acre

Remarks: irrigated & shall be further limited to a diversion of not to exceed 2 1/2 a.f. per acre for each acre irrigated during the irrigation season of each year; & the right allowed hereunder for the appropriation of water for lands having a valid prior right shall be limited to the amt. necessary to make up any deficiency in water available to said lands under said prior right & the amt. allowed herein, together with the amt. secured under any other right existing for said lands, shall be lmt. by the duty of water as fixed herein; & shall be subject to such reasonable rotation system as may be ordered by the proper state officer.

Basin 15 Vol. 13323

RECEIVED  
MAR 19 1965  
STATE ENGINEER  
SALEM OREGON

March 16, 1965

Report on final proof survey, permit # G-2026,  
application # G-2204, in the name of J.S.Tellvik,  
Route 1 Box 515, Cave Junction, Oregon.

Water used for irrigation.

Point of diversion located 2600' S and 200' E  
from the NW corner of Section 6 being within the  
SW $\frac{1}{4}$  of the NW $\frac{1}{4}$  of Section 6 being within DLC #39  
all in township 40 S, range 7 WWM.

The diversion point consists of a well and an  
infiltration trench.

Pump is mounted on a trailer and is a Goulds  
608A5834 3169 3" x 4" direct connected thru  
a 3 speed car transmission to a 6 cyl. Plymouth engine.

22 - 40' joints of 4" alum pipe  
20 - 40' " " 3" " "

48 - Rainbird #40 3/16" x 1/8" sprinklers.

*Robert B Steimer*  
Robert B. Steimer  
Watermaster, District #14

T. 40S., R. 8W., S. 1., W.M.

T. 40S., R. 7W., S. 6., W.M.

Records show  
stake at this point

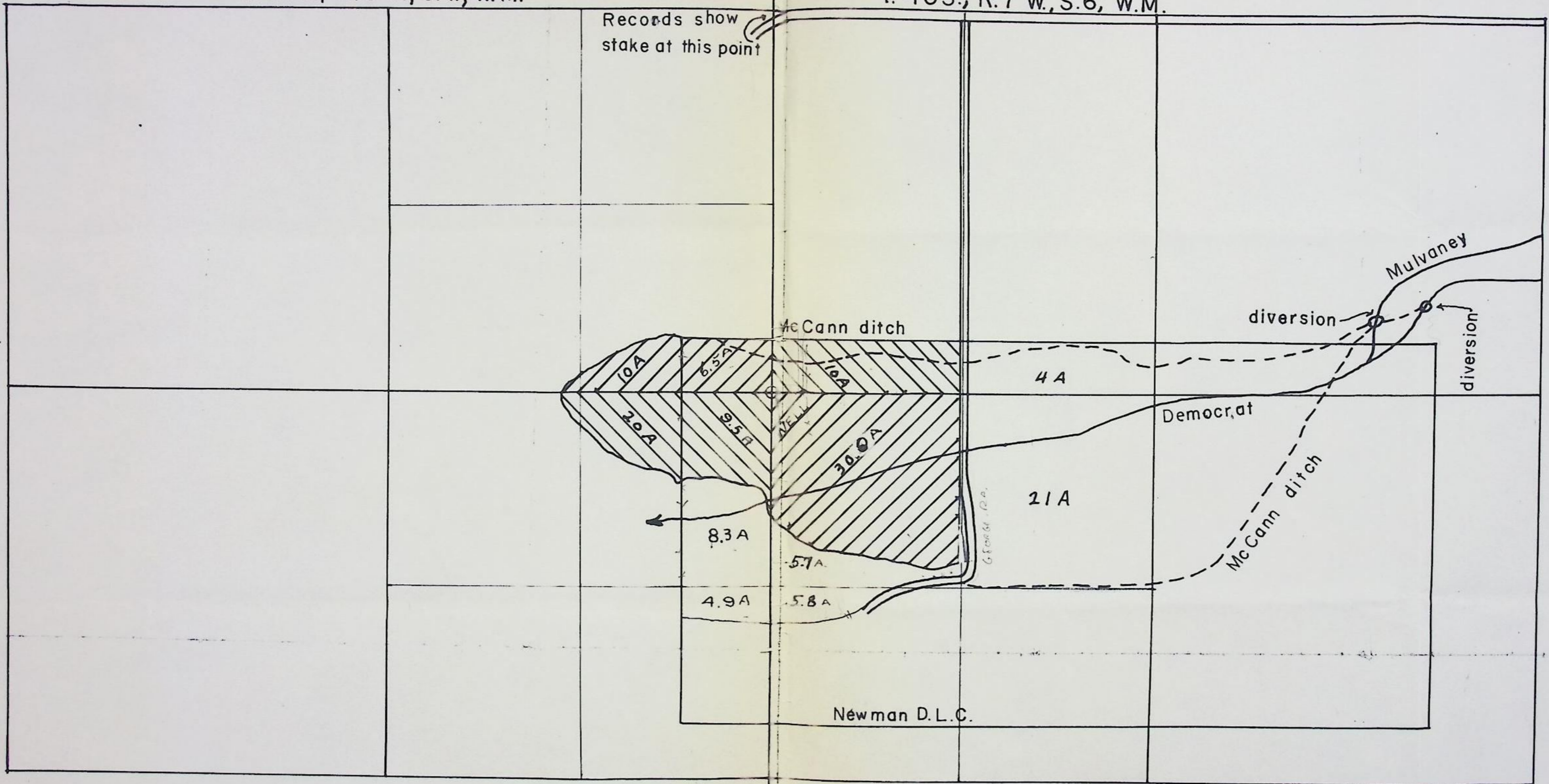

Cross hatched area within D.L.C. is Joe Telvik water right. 10-17-60  
 Scale 8" = 1 mile. 123 acres included on right 1.24 Mulvaney 0.3 cfs  
 Democrat. Telvik has approx. .625 cfs about 55 acres under W/R

Application G-2204  
 Permit G-2026

1500 4 + 3  
 38-RB  
 AS TRIM

50714 2  
 108

STATE OF OREGON  
STATE ENGINEER  
WATER RESOURCES DEPARTMENT  
516 PUBLIC SERVICE BUILDING  
SALEM 97310

REFER TO  
FILE NO. G-2204

March 23, 1966

J. S. Tellvik  
Rt. 1, Box 515  
Cave Junction, Oregon

Dear Mr. Tellvik:

Enclosed is the final proof in connection with the incomplete water right represented by your permit No. G-2026.

The data contained in the proof, which is based on an inspection and survey of your project made by a representative of this department, defines the extent to which your water right has been completed within the terms of your permit. The proof should be dated and signed by you and returned to this office.

Upon receipt of the proof, properly executed and accompanied by the statutory recording fee of \$1, a certificate of water right will be issued confirming the right thereunder and, after being recorded in the county records, will be forwarded to you.

Very truly yours,

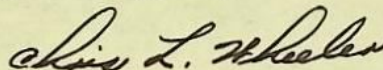

CHRIS L. WHEELER  
State Engineer

Form 117

Enclosure

sfr

March 15, 1966

Robert B. Steimer  
Watermaster, District 14  
County Courthouse  
Grants Pass, Oregon

Dear Bob:

This will acknowledge receipt of your letter dated March 14, 1966, in regards to permit No. G-2026 in the name of J. S. Tellvik.

We have not yet processed this final proof survey for the certificate but will try to send it out in the near future.

Very truly yours,

CHRIS L. WHEELER  
State Engineer

By  
Myron V. Bish  
Assistant

MVB:sfr

WATER DISTRICT NO. 14  
COUNTY COURTHOUSE  
GRANTS PASS 97526  
TEL. 476-6827



STATE OF OREGON  
STATE ENGINEER  
WATER RESOURCES DEPARTMENT  
March 14, 1966

WATER DISTRIBUTION  
HYDROGRAPHIC SURVEYS  
SNOW SURVEYS

REFER TO  
FILE NO. \_\_\_\_\_

**RECEIVED**  
MAR 15 1966  
STATE ENGINEER  
SALEM, OREGON

Chris L. Wheeler,  
State Engineer,  
Salem, Oregon

Att: Myron Bish, Asst.

Dear Mr. Bish:

J. S. Tellvik of the Illinois Valley came in to see me Saturday. He wondered what had happened to his water right certificate covering permit #G-2026, located in section 6, township 40 S, range 7 W and section 1, township 40 S, range 8 W.

I made the final proof survey in February, 1965.

Anything you can let me know will be appreciated.

Very truly yours,

*Bob*

Robert B. Steimer  
Watermaster, District #14

rbs.fan



STATE OF OREGON  
STATE ENGINEER  
516 PUBLIC SERVICE BUILDING  
SALEM 10

REFER TO  
FILE NO. G-2204

October 29, 1964

Mr. J. S. Tellvik  
Route 1, Box 515  
Cave Junction, Oregon

Gentlemen:

This will acknowledge receipt of your notice to the effect that complete application of water has been made under permit No. G-2026.

Pursuant to your report and in line with the general practice of this office, a survey will be made at a later date.

After this survey, proof may be made and certificate issued covering the actual use of water as found by the engineer. In case of irrigation, any lands described in the permit that have not been irrigated will be automatically eliminated from the water right.

In the meantime, the permit which you hold will be valid evidence of the water right in question so long as you continue to use the water.

Very truly yours,

CHRIS L. WHEELER  
State Engineer

Form 128

Pj



STATE OF OREGON  
STATE ENGINEER  
WATER RESOURCES DEPARTMENT  
516 PUBLIC SERVICE BUILDING  
SALEM 10

REFER TO  
FILE NO. G-2204

October 1, 1963

J. S. Tellvik  
Route 1, Box 515  
Cave Junction, Oregon

Dear Sir:

This will acknowledge the notice of completion of construction under the terms of permit No. G-2026.

Under the provisions of the permit, the time limit for completion of the appropriation by accomplishing the authorized beneficial use of water to the full extent intended will expire October 1, 1964. (In the case of irrigation completion of the appropriation means at least one beneficial irrigation of all the land to be irrigated under the subject permit.)

Very truly yours,



CHRIS L. WHEELER  
State Engineer

Form 119

jb

RECEIVED  
SEP 24 1963  
STATE ENGINEER  
SALEM, OREGON

Rt. 1 Box 515  
Cave Junction, Oregon

September 23, 1963

File No, G-2204

Chris L. Wheeler  
State Engineer  
516 Public Service Bldg.  
Salem, Oregon

Dear Sir:

Enclosed please find completed Form B. At the present time, I cannot complete Form C. since complete application of the water has not been made. Construction is complete, however, and the facilities have been purchased for the beneficial use of the water.

According to instructions on Form C, it is to be mailed to your office when the water has been applied. Will it be necessary, therefore, to have an extension of time on this phase of the project? If so, please advise.

Sincerely yours,

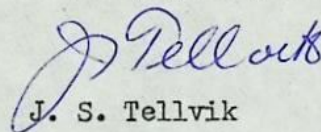
  
J. S. Tellvik

STATE OF OREGON

STATE ENGINEER

WATER RESOURCES DEPARTMENT

516 PUBLIC SERVICE BUILDING

SALEM 10

April 12, 1963

REFER TO

FILE NO. C-201

J: S. Tellvik  
Rt. 1, Box 515  
Cave Junction, Oregon

Dear Sir:

This will acknowledge the notice of beginning of construction under the terms of permit No. G-2026.

Our records show the time limit for completion of construction of the works and/or the purchase and installation of all the facilities required for the authorized beneficial use of water will expire on October 1, 1963.

Very truly yours,

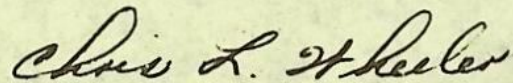

CHRIS L. WHEELER  
State Engineer

Form 118

mks

March 4, 1963

J. S. Tellvik  
Route 1, Box 515  
Cave Junction, Oregon

Dear Mr. Tellvik:

Enclosed is the proper form for your use in reporting beginning of construction in connection with your Permit number G-2026.

Also enclosed are Forms B and C for your use as required.

Very truly yours,

CHRIS L. WHEELER  
State Engineer

By  
Trevor Jones, Assistant

TJ:jp  
Enclosures

*Mc*

RECEIVED  
FEB 27 1963  
STATE ENGINEER  
SALEM, OREGON

G2204

Route 1, Box 515  
Cave Junction, Oregon  
February 25, 1963

Mr. Chris L. Wheeler, State Engineer  
Office of the State Engineer  
Salem 10, Oregon

Dear Sir:

In reply to the enclosed card which we received from you, we have not been able to locate the Form A which you mention, but the work of developing the well which was to have been started by February 13, was started and completed last fall. If we find the form in the next few days, I will immediately sign and send it in.

Very truly yours,

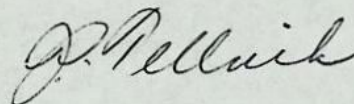

J. S. Tellvik

G-2204

March 7, 1962

J. S. Tellvik  
Rt. 1, Box 515  
Cave Junction, Oregon

Dear Mr. Tellvik:

G-2204, Permit No. G-2026 with blueprint.

January 24, 1962

Mr. J. S. Tellvik  
Route 1, Box 515  
Cave Junction, Oregon

Dear Mr. Tellvik:

This will acknowledge receipt of your letter dated January 19, 1962, returning application number G-2204 and the accompanying map.

The application has been re-examined and now appears to be in satisfactory form to be considered for approval by issuance of a permit with the next group.

Very truly yours,

LEWIS A. STANLEY  
State Engineer

By  
Walter N. Perry, Assistant

mgö

Rt 1 Box 515

Cave Jet. Ore

Jan. 19, 1962

State Engineer  
Salem, Ore

RECEIVED  
JAN 23 1962  
STATE ENGINEER  
SALEM, OREGON  
1e No. G 2204

Dear Sir:

Thank you for your prompt attention to my application. I regret the errors, nevertheless, will get them squared away.

Hoping the corrections will take care of everything, I remain,

Sincerely yours  
J Pellvik



January 18, 1962

Mr. J. S. Tellvik  
Route 1, Box 515  
Cave Junction, Oregon

Dear Mr. Tellvik:

This will acknowledge receipt of your letter dated January 11, 1962 returning application number G-2204 and the accompanying map.

The application has been re-examined and it appears that I was in error regarding the location of the well being shown on the map. The re-examination of the map reveals that the map does not agree with the information shown in item 12 of the application. The map must be completed to show the number of acres to be irrigated within each quarter quarter section. We are therefore returning your application and the accompanying map for completion of the accompanying map, the application being endorsed so that in order to retain its date of priority it must be returned to this office on or before March 19, 1962.

Very truly yours,

LEWIS A. STANLEY  
State Engineer

By  
Walter N. Perry, Assistant

WNP:mg  
Enclosures

Jan. 11, 1962

RECEIVED

JAN 12 1962

STATE ENGINEER  
SALEM, OREGON

FILE NO. G-2204

Lewis A. Stanley  
State Engineer

Dear Sir:

Your letter dated Jan 9 is answered herewith.

You stated the map does not show the location of the well. It does.

The application (No 4) gives the location of the well and is traced on the map.

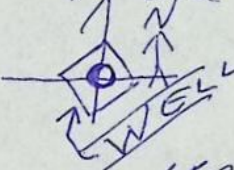
 We specified the pumps to be used, but did not specify their function. The Goulds is for overhead irrigation and the other for flood.

Hoping this is satisfactory. I remain

Sincerely yours

P. Pellik

January 9, 1962

Mr. J. S. Tellvik  
Rt. 1, Box 515  
Cave Junction, Oregon

Dear Mr. Tellvik:

This will acknowledge receipt of your application for a permit to appropriate 1.6 cubic feet of water per second from a well for the irrigation of 80.7 acres, a tracing, legal description and fees in the sum of \$22.50 for which our receipt numbered 32207 is enclosed.

Your application has been examined and filed under file number G-2204. Upon examination of your application, it is noted that the map submitted to accompany your application does not show the location of the well nor the means by which the water will be conveyed to the land. It appears that the map submitted was prepared to show a diversion of surface water from Democrat and Mulvaney Creeks. We are therefore returning your application and the accompanying map for correction, the application being endorsed so that in order to retain its date of priority it must be returned to this office on or before March 9, 1962.

Please note that all final entries on the application form must be in ink or made with a typewriter.

Very truly yours,

LEWIS A. STANLEY  
State Engineer

By  
Walter N. Perry, Assistant

WNP:mgb  
Enclosures

This Indenture, made this 20th day of June, 1955, between

J. S. Tellvik - a single man

herein.

after called "Mortgagor", and BANK OF ILLINOIS VALLEY - Cave Junction, Oregon  
hereinafter called "Mortgagee";

WITNESSETH:

For value received by the Mortgagor from the Mortgagee, the Mortgagor has bargained and sold and does hereby grant, bargain, sell and convey unto the Mortgagee, all the following described property situate in

Josephine County, Oregon, to wit:

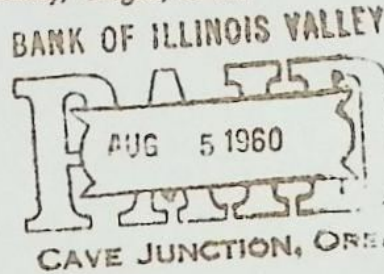

A tract of land situated in Wm Newman Donation Land Claims No. 39 and 47 described as follows:

Beginning at a point on the West side of a County Road, 415.80 feet North of and 624.72 feet East of the Southwest corner of Section 6, Township 40, South, Range 7 West of the Willamette Meridian, and running thence West 1309.8 feet; thence North 2643.96 feet; thence East 2128 feet to a point on the West right of way line of said County Road; thence in a Southerly direction along the Westerly right of way line of said Road, to the point of beginning, Josephine County, Oregon.

Recorded at Page 163-65 of Vol. 101 MORTGAGE BEN W. COJANT Deputy

INDEXED

State of Oregon, County of Josephine, 158325

together with the tenements, hereditaments and appurtenances now or hereafter thereunto belonging or in anywise appertaining; also all such apparatus, equipment and fixtures now or hereafter situate on said premises, as are ever furnished by landlords in letting unfurnished buildings similar to the one situated on the real property hereinafter described, including, but not exclusively, all fixtures and personal property used or intended for use for plumbing

T. 40S., R. 8W., S. 1., W.M.

T. 40S., R. 7W., S. 6., W.M.

Records show  
stake at this point

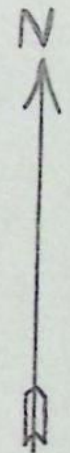
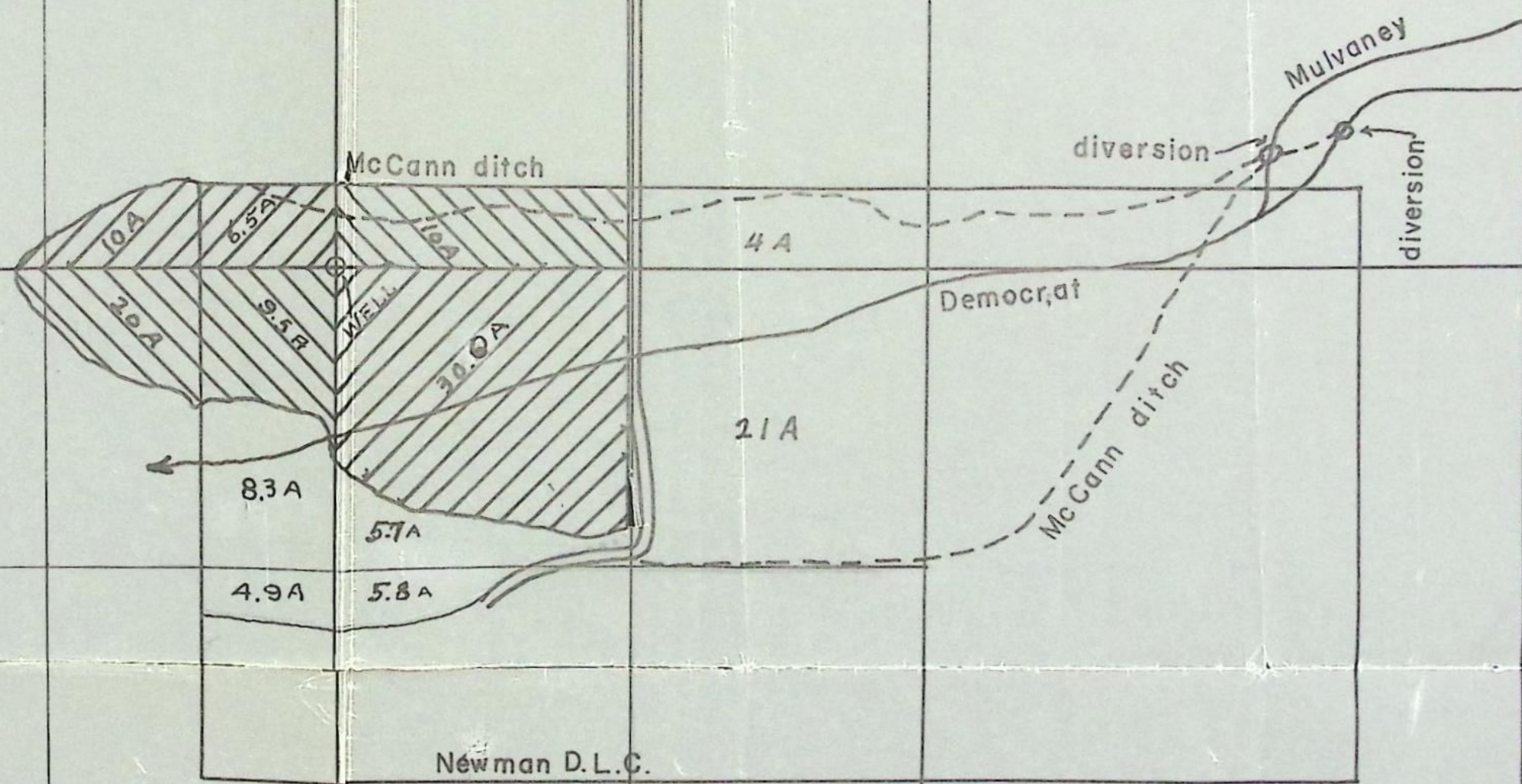

Cross hatched area within D.L.C. is Joe Telvik water right. 10-17-60  
 Scale 8"=1 mile. 123 acres included on right 1.24 Mulvaney 0.3 cfs  
 Democrat. Telvik has approx. .625 cfs about 55 acres under W/R

Application No. G-2204  
 Permit No. G-2026

RECEIVED  
 STATE ENGINEER  
 SALEM, OREGON

RECEIVED  
 STATE ENGINEER  
 SALEM, OREGON  
 JAN 1 9 1965

RECEIVED  
 STATE ENGINEER  
 SALEM, OREGON  
 JAN 2 8 1965

SE 1/4 + 2/4  
 SW 1/4 + 2/4  
 NE 1/4  
 3