

18487 S. Valley Vista Rd.
Mulino, Oregon 97042
(503) 632-5016 Phone
(503) 632-5983 Fax

Pacific Hydro-Geology Inc.

E-RECEIVED
OCT 21 2024
OWRD

Memo

To: Oregon Water Resources Department / Luinda Vranizan
From: Doann Hamilton, CWRE
CC:
Date: October 19, 2024
Re: Application G-19253.

On October 18, 2024 the initial review (IR) was issued for our client Robinson farm LLC Application G-18253 noting corrections needed to be made to the map. Corrections have been made to the map to add additional mainlines. Attached is the corrected map to reflect this change.

CERTIFIED WATER RIGHT EXAMINER
85503
Doann Hamilton
DOANN HAMILTON
MAY 10, 2012
STATE OF OREGON
EXPIRES: *June 30, 2025*

E-RECEIVED
 OCT 21 2024
 OWRD

T.5S. R.4W. Section 7, W.M.

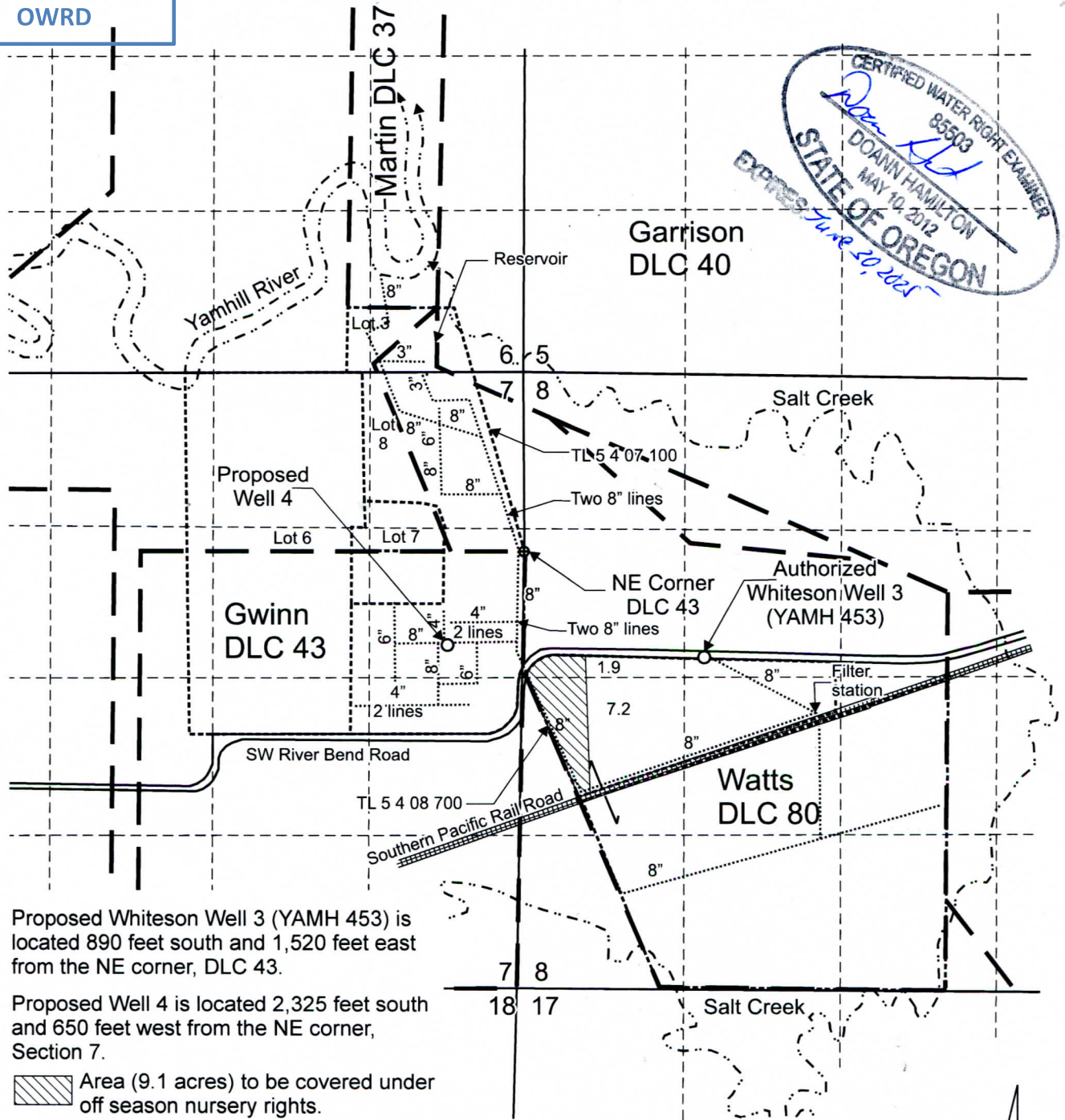
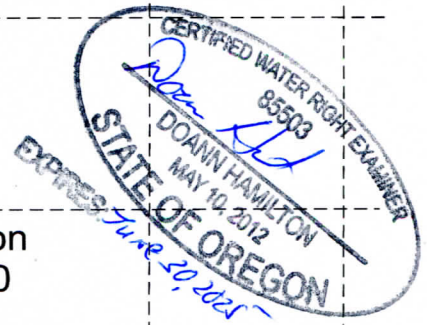

Proposed Whiteson Well 3 (YAMH 453) is located 890 feet south and 1,520 feet east from the NE corner, DLC 43.

Proposed Well 4 is located 2,325 feet south and 650 feet west from the NE corner, Section 7.

 Area (9.1 acres) to be covered under off season nursery rights.

----- Tax lot boundary - - - - - Donation Land Claim boundary Water main line

Scale: 1" = 1,320'



This map was prepared for the purpose of identifying the location of a water right only and is not intended to provide legal dimensions or location of property ownership lines.



Water Right Application Map

Pacific Hydro-Geology Inc.

02/2022
 Rev. 10/2024

Robinson Farm LLC
 T.5S. R.4W. Section 7, W.M.

RobinsonOffSeasonGWAppMap.cdr