

**CLAIM OF
BENEFICIAL USE
for Reservoir Permits by
CWRE's (not self-certified)**



Oregon Water Resources Department
725 Summer Street NE, Suite A
Salem, Oregon 97301-1266
(503) 986-0900
www.oregon.gov/OWRD

**A fee of \$230 must accompany this form for permits
with priority dates of July 9, 1987, or later.**
Claims received without the correct fee of \$200 will be returned.
The \$230 fee is included with this application.

A separate form shall be completed for each permit.

In cases where a permit has been amended through the permit amendment process, a separate claim for the permit amendment is not required. Incorporate the permit amendment into the claim for the permit.

This form is subject to revision. **Begin each new claim** by checking for a new version of this form at:

<https://www.oregon.gov/OWRD/Forms/Pages/default.aspx>

The completion of this form is required by OAR 690-014-0100(1) and 690-014-0110(4).

Please type or print in dark ink. If this form is found to contain errors or omissions, it may be returned to you. **Every item must have a response.** If any requested information does not apply to the claim, insert "NA." **Do not delete or alter any section of this form unless directed by the form.** The Department may require the submittal of additional information from any water user or authorized agent.

"Section 8" of this form is intended to aid in the completion of this form and should not be submitted.

If you have questions regarding the completion of this form, please call 503-979-9103.

The Department has a program that allows it to enter into a voluntary agreement with an applicant for expedited services. Under such an agreement, the applicant pays the cost to hire additional staff that would not otherwise be available. This program means a certificate may be issued in about a month. For more information on this program see:

<https://www.oregon.gov/OWRD/programs/WaterRights/RA/Pages/default.aspx>

**SECTION 1
GENERAL INFORMATION**

Received by OWRD

NOV 04 2024

Salem, OR

1. File Information

APPLICATION # R-88417	PERMIT # (IF APPLICABLE) R-15271	PERMIT AMENDMENT # (IF APPLICABLE) N/A
---------------------------------	--	--

2. Property Owner (current owner information)

APPLICANT/BUSINESS NAME SARBANAND ENTERPRISES LLC		PHONE NO. 661-565-6421	ADDITIONAL CONTACT NO.
ADDRESS 786 RD 188			
CITY DELANO	STATE CA	ZIP 93215	E-MAIL

If the current property owner is not the permit holder of record, it is recommended that an assignment be filed with the Department. ***Each permit holder of record must sign this form.***

3. Permit holder of record (this may, or may not, be the current property owner)

PERMIT HOLDER OF RECORD SARBANAND ENTERPRISES LLC			
ADDRESS 786 RD 188			
CITY DELANO	STATE CA	ZIP 93215	

ADDITIONAL PERMIT HOLDER OF RECORD N/A		
ADDRESS		
CITY	STATE	ZIP

Received by OWRD

4. Date of Site Inspection:

September 11, 2024

NOV 04 2024

5. Person(s) interviewed and description of their association with the project:

Salem, OR

NAME	DATE	ASSOCIATION WITH THE PROJECT
Matt Hoezee	9/11/2024	Regional Ranch Manager

6. County

Yamhill

7. If any property described in the place of use of the permit final order is excluded from this report, identify the owner of record for that property (ORS 537.230(5)):

OWNER OF RECORD N/A		
ADDRESS		
CITY	STATE	ZIP

Add additional tables for owners of record as needed

**SECTION 2
SIGNATURES**

CWRE Statement, Seal and Signature

The facts contained in this Claim of Beneficial Use are true and correct to the best of my knowledge.



CWRE NAME Robyn Cook, GSI Water Solutions, Inc.		PHONE NO. 971-200-8505	ADDITIONAL CONTACT NO.	
ADDRESS 650 NE Holladay Street, Suite 900				
CITY Portland	STATE OR	ZIP 97232	E-MAIL rcook@gsiws.com	

Permit Holder's of Record Signature or Acknowledgement

Each permit or transfer holder of record must sign this form in the space provided below.

The facts contained in this Claim of Beneficial Use are true and correct to the best of my knowledge. I request that the Department issue a water right certificate.

SIGNATURE	PRINT OR TYPE NAME	TITLE	DATE
	Matt Hoezee	Regional Ranch Manager	10-22-24

Received by OWRD
NOV 04 2024
Salem, OR

**SECTION 3
CLAIM DESCRIPTION**

1. Reservoir source and, if from surface water, the tributary:

RESERVOIR NAME OR NUMBER	SOURCE	TRIBUTARY
South Airport Pond 1 (-123.1465140, 45.1857144)	Runoff	South Yamhill River

2. Developed use(s), period of use, and acre foot (af) for each use:

RESERVOIR NAME OR NUMBER	USES	SEASON OR MONTHS WHEN WATER WAS APPROPRIATED FOR STORAGE	VOLUME STORED (AF)
South Airport Pond 1	Multiple Purpose	November 1-June 30	30.0 AF
Total Quantity of Water Stored			30.0 AF

3. Provide a general narrative description of the distribution works. This description must trace the water system from each point of diversion to the reservoir:

South Airport Pond 1 is filled with runoff that drains from the surrounding area.

Reminder: The map associated with this claim must identify the location of the point(s) of diversion, Donation Land Claims (DLC), Government Lots (GLot), and Quarter-Quarters (QQ).

4. Variations:

Was the use developed differently from what was authorized by the permit, permit amendment final order, or extension final order? If yes, describe below. YES NO

(e.g. "The permit allowed the development of three reservoirs. The permit holder only developed one of the reservoirs." or "The permit allowed for the storage of 9 acre feet of water. The reservoir was developed to hold 5.2 acre feet.")

This claim of beneficial use report more accurately describes the location of the Dam.

5. Claim Summary:

RESERVOIR NAME OR #	MAXIMUM STORAGE AUTHORIZED BY PERMIT (AF)	MAXIMUM STORAGE DEVELOPED (AF)
South Airport Pond 1	30.0	30.0

Received by OWRD
NOV 04 2014
Salem, OR

SECTION 4 SYSTEM DESCRIPTION

Are there multiple reservoirs? YES NO

If "YES" you will need to copy and complete Sections A through E for each reservoir.

Reservoir Name or Number this section describes (only needed if there is more than one):

South Airport Pond 1

A. Reservoir Location

1. Is the reservoir on-channel? YES NO

2. Provide dam outlet location and/or point of diversion(s).

TWP	RNG	MER	SEC	QQ	GLOT	DLC	MEASURED DISTANCES
4S	4W	WM	35	NENW	-	67	195 feet South and 2,525 feet East from the NW corner of Section 35

Reminder: The map associated with this claim must identify Donation Land Claims (DLC), Government Lots (Glot), and Quarter-Quarters (QQ).

B. Diversion and Delivery System Information

Provide the following information concerning the diversion and delivery system. Information provided must describe the equipment used to transport the water from the point(s) of diversion to the reservoir.

1. Is a pump used? YES NO

If "NO" items 2 through item 5 may be deleted. Items 2 through 5 were deleted.

6. Additional notes or comments related to the system:

Received by OWRD

None.

NOV 04 2024

Salem, OR

C. Gravity Flow Pipe

(THE DEPARTMENT TYPICALLY USES THE HAZEN-WILLIAM'S FORMULA FOR A GRAVITY FLOW PIPE SYSTEM)

1. Does the system involve a gravity flow pipe? YES NO

If "NO", items 2 through 4 relating to this section may be deleted. Items 2 through 4 were deleted.

D. Gravity Flow Canal or Ditch

(THE DEPARTMENT TYPICALLY USES MANNING'S FORMULA FOR CANALS AND DITCHES)

1. Is a gravity flow canal or ditch used to convey the water as part of the distribution system? YES NO

If "NO", items 2 through 4 relating to this section may be deleted. Items 2 through 4 were deleted.

E. Reservoir

1. Does the reservoir require the submittal of as-built plans and specifications? **YES** NO

If "YES", answer item 2; items 3 through 8 relating to this section may be deleted.
 If "NO", skip items 2; answer items 3 through 8.

2. Complete the table:

HAVE THE DOCUMENTS BEEN SUBMITTED? YES OR NO	WHEN WERE THE DOCUMENTS SUBMITTED?	HAVE THEY BEEN APPROVED BY THE DEPARTMENT?	NUMBER OF ACRE FEET STORED
N/A			

3. If the reservoir stores less than 9.2 acre-feet of water or if the dam is less than 10 feet in height, and as-built plans and specifications are not required, complete the table and items 4 through 8.

MAXIMUM DEPTH	AVERAGE DEPTH	SURFACE AREA (IN ACRES)	VOLUME (IN ACRE FEET)
6.4 ft	6.4 ft	4.7 ac	30.0

4. Provide reservoir volume calculations:

6.4 feet (depth) * 4.7 acres (surface area) = 30.0 acre-feet (volume)

5. Provide the following information concerning the physical characteristics of the dam:

CREST WIDTH (W)	DAM HEIGHT AT CENTERLINE (H)	DISTANCE FROM DOWNSTREAM TOP OF DAM TO DOWNSTREAM TOE (L)	DISTANCE FROM UPSTREAM TOP OF DAM TO UPSTREAM TOE (U)	WATER LEVEL AT INSPECTION	DOWN-STREAM SLOPE	UP-STREAM SLOPE
15ft	9.5ft	7.5ft	7.5ft	13ft	1.26	1.26

6. Provide a drawing showing the cross section of the dam at the maximum section indicating details and dimensions. The drawing should be drawn at a standard even scale.

See Attachment B – Reservoir Cross Section

Received by **OWRL**
 NOV 04 2024
 Salem, OR

7. Describe the outlet works (size and type of the outlet conduit and location):

A 36 inch galvanized steel outlet pipe is installed through the berm to allow draining of the reservoir when needed.

8. Describe the emergency spillway (dimensions and location):

BOTTOM WIDTH (W)	TOP WIDTH (L)	SPILLWAY DEPTH (H)
N/A		

Received by OWRD
NOV 04 2024
Salem, OR

NOV 04 2024

SECTION 5 CONDITIONS

Salem, OR

All conditions contained in the permit, permit amendment, or any extension final order shall be addressed. Reports that do not address all performance related conditions will be returned.

1. Time Limits:

Permits and any extension final orders contain any or all of the following dates; the date when the actual construction work was to begin, the date when the construction was to be completed, and the date when the complete application of water to the proposed was to be completed. These dates may be referred to as ABC dates. Describe how the water user has complied with each of the development timelines established in the permit or extension final order:

	DATE FROM PERMIT	DATE ACCOMPLISHED*	DESCRIPTION OF ACTIONS TAKEN BY WATER USER TO COMPLY WITH THE TIME LIMITS
ISSUANCE DATE	11/21/17		
BEGIN CONSTRUCTION (A)	11/21/22	Summer 2018	Began construction of pond.
COMPLETE CONSTRUCTION (B)	Not listed in permit.	Summer 2018	Complete construction of pond.
COMPLETE APPLICATION OF WATER (C)	11/21/22	June 2019	Pond was filled.

* must be within period between permit or any extension final order issuance and the date to completely apply water

2. Is there an extension final order(s)? YES NO

3. Measurement Conditions:

a. Does the permit, permit amendment, or any extension final order require the installation of a meter or approved measuring device? YES NO

If "NO", items b through f relating to this section may be deleted.

Reminder: If a meter or approved measuring device was required, the COBU map must indicate the location of the device in relation to the point of diversion.

b. Has a meter been installed? YES NO

c. Meter Information

POD NAME OR #	MANUFACTURER	SERIAL #	CONDITION (WORKING OR NOT)	CURRENT METER READING	DATE INSTALLED
N/A					

If a meter has been installed, items d through f relating to this section may be deleted.

d. If a meter has not been installed, has a suitable measuring device been installed and approved by the Department? YES* NO

***A staff gage capable of measuring the entire range of stage for South Airport Pond 1 is required and has been installed. It is not required that the gage be approved by the Department.**

e. If "YES", provide a copy of the letter approving the device, if available. If the letter is not available provide the name and title of the Water Resources Department employee approving the measuring device, and the approximate date of the approval:

Received by OWRD

NAME	TITLE	APPROXIMATE DATE
N/A		NOV 04 2024

Salem, OR

4. Recording and reporting conditions

a. Is the water user required to report the water use to the Department? **YES** **NO**

If "NO", item b relating to this section may be deleted. Item b was deleted.

5. Outlet Pipe

a. Is the water user required to install a minimum 8" outlet pipe/conduit? **YES** **NO**

If "NO", items b through c relating to this section may be deleted.

b. Has the outlet pipe been installed? **YES** **NO**

If "YES", items c relating to this section may be deleted. Item c was deleted.

6. Fish Screening

a. Are any points of diversion required to be screened to prevent fish from entering the point of diversion? **YES** **NO**

If "NO", items b through e relating to this section may be deleted. Items b through e were deleted.

7. By-pass Devices

a. Are any points of diversion required to have a by-pass device to prevent fish from entering the point of diversion? **YES** **NO**

If "NO", items b and c relating to this section may be deleted. Items b and c were deleted.

See Attachment C – Fish Passage Letter

8. Other conditions required by permit, permit amendment final order, or extension final order

a. Was the water user required to restore the riparian area if it was disturbed? **YES** **NO**

b. Was a fishway required? **YES** **NO**

c. Was submittal of a letter from an engineer required prior to storage of water? **YES** **NO**

d. Was submittal of a water management and conservation plan required? **YES** **NO**

e. Other conditions? **YES** **NO**

If "YES" to any of the above, identify the condition and describe the water user's actions to comply with the condition(s):

8a: No riparian areas were disturbed during pond construction, so no restoration was required.
8e: Live flow is passed outside of the storage season.

SECTION 6
ATTACHMENTS

Provide a list of any additional documents you are attaching to this report:

ATTACHMENT NAME	DESCRIPTION
Attachment A	Permit R-15271
Attachment B	Reservoir Cross Section
Attachment C	Fish Passage Letter
Attachment D	COBU Map

Received by OWRD
NOV 04 2024
Salem, OR

Recd

NO.

Salem, OR

SECTION 7

CLAIM OF BENEFICIAL USE MAP

The Claim of Beneficial Use Map must be submitted with this claim. Claims submitted without the Claim of Beneficial Use map will be returned. The map shall be submitted on poly film at a scale of 1" = 1320 feet, 1" = 400 feet, or the original full-size scale of the county assessor map for the location.

Provide a general description of the survey method used to prepare the map. Examples of possible methods include, but are not limited to, a traverse survey, GPS, or the use of aerial photos. If the basis of the survey is an aerial photo, provide the source, date, series and the aerial photo identification number.

The reservoir was visited during the site inspection. The extent of the system was located using aerial imagery (Google Earth, April 2023), a handheld GPS, and a field survey completed during the site inspection. The map was created using Geographic Information System (GIS) software and spatial datasets obtained from Bureau of Land Management (BLM), Environmental Systems Research Institute (ESRI), Oregon Water Resources Department (OWRD), and United States Geological Survey (USGS). Additional data and information specific to the use of water under the water right described in this Claim of Beneficial Use report were obtained from the water right holder.

Map Checklist

Please be sure that the map you submit includes ALL the items listed below.

(Reminder: Incomplete maps and/or claims may be returned.)

- Map on polyester film.
- Appropriate scale (1" = 400 feet, 1" = 1320 feet, or the original full-size scale of the county assessor map)
- Township, Range, Section, Donation Land Claims, and Government Lots
- N/A If irrigation, number of acres irrigated within each projected Donation Land Claims, Government Lots, Quarter-Quarters
- N/A Locations of fish screens and/or fish by-pass devices in relationship to point of diversion
- Locations of meters and/or measuring devices in relationship to point of diversion
- N/A Conveyance structures illustrated (pumps, reservoirs, pipelines, ditches, etc.)
- Point(s) of diversion or appropriation (illustrated and coordinates)
- Tax lot boundaries and numbers
- Source illustrated if surface water
- Disclaimer ("This map is not intended to provide legal dimensions or locations of property ownership lines")
- Application and permit number or transfer number
- North arrow
- Legend
- CWRE stamp and signature

Received by OWRD

NOV 04 2024

Salem, OR

Received by OWRD

NOV 04 2024

Salem, OR

Attachment A

Permit R-15271

Claim of Beneficial Use Report - SARBANAND ENTERPRISES LLC

STATE OF OREGON

COUNTY OF YAMHILL

PERMIT TO STORE PUBLIC WATERS

THIS PERMIT IS HEREBY ISSUED TO:

SARBANAND ENTERPRISES LLC
786 RD 188
DELANO CA 93215

Received by OWRD

NOV 04 2024

Salem, OR

The specific limits and conditions of the use are listed below.

APPLICATION FILE NUMBER: R-88417

SOURCE OF WATER: RUNOFF, TRIBUTARY TO SOUTH YAMHILL RIVER

STORAGE FACILITY: SOUTH AIRPORT POND #1

MAXIMUM VOLUME: 30.0 ACRE-FEET

DATE OF PRIORITY: JUNE 14, 2017

WATER MAY BE APPROPRIATED AS FOLLOWS: NOVEMBER 1 THROUGH JUNE 30

USE: MULTIPLE PURPOSE

Dam Location/Authorized Point of Diversion:

Twp	Rng	Mer	Sec	Q-Q	Measured Distances
4 S	4 W	WM	35	NW NE	510 FEET SOUTH AND 2280 FEET WEST FROM NE CORNER, SECTION 35

The Area To Be Submerged:

Twp	Rng	Mer	Sec	Q-Q
4 S	4 W	WM	35	NW NE

Measurement Devices, and Recording/Reporting of Annual Water Storage Conditions:

- A. Before water use may begin under this permit, a staff gage that measures the entire range and stage between full reservoir level and dead-pool storage must be installed in the reservoir. If no dead-pool, the gage must measure the full depth of the reservoir. The permittee shall maintain the device in good working order.
- B. The permittee shall allow the watermaster access to the device; provided however, where any device is located within a private structure, the watermaster shall request access upon reasonable notice.
- C. The Director may require the permittee to keep and maintain a record of the volume of water stored, and may require the permittee to report water-storage on a periodic schedule as established by the Director. In addition, the Director may require the permittee to

report general water-use information, the periods of water use and the place and nature of use of water under the permit.

- D. The Director may provide an opportunity for the permittee to submit alternative measuring and reporting procedures for review and approval.

The storage of water allowed herein is subject to the installation and maintenance of an outlet pipe (with a minimum diameter of 8" for any in-channel reservoir). This requirement may be waived if the Department determines other means have been provided to evacuate water when necessary.

The permittee shall pass all live flow outside the storage season described above.

The Director may require the user to measure inflow and outflow, above and below the reservoir respectively, to ensure that live flow is not impeded outside the storage season. Measurement devices and their implementation must be acceptable to the Director, and the Director may require that data be recorded on a specified periodic basis and reported to the Department annually or more frequently.

The permittee shall not construct, operate, or maintain any dam or artificial obstruction to fish passage in the channel of the subject stream without providing a fishway to ensure adequate upstream and downstream passage for fish, unless the permittee has requested and been granted a fish passage waiver by the Oregon Fish and Wildlife Commission. The permittee is hereby directed to contact an Oregon Department of Fish and Wildlife (ODFW) Fish Passage Coordinator, before beginning construction of any in-channel obstruction.

Notwithstanding that ODFW has made a determination that fish screens are not necessary at the time of permit issuance, the permittee may be required in the future to install, maintain, and operate fish-screening devices to prevent fish from entering the proposed diversion.

This permit allows an annual appropriation (not to exceed the specified volume). This permit does not provide for the appropriation of water for out-of-reservoir uses, the maintenance of the water level or maintaining a suitable freshwater condition. If any water is to be used for out-of-reservoir purposes, a secondary water right is required. If any additional live flow is to be appropriated to maintain either the water level or a suitable freshwater condition, an additional water right is required.

STANDARD CONDITIONS

1. Failure to comply with any of the provisions of this permit may result in action including, but not limited to, restrictions on the use, civil penalties, or cancellation of the permit.
2. This permit is for the beneficial use of water without waste. The water user is advised that new regulations may require the use of best practical technologies or conservation practices to achieve this end.
3. By law, the land use associated with this water use must be in compliance with statewide land-use goals and any local acknowledged land-use plan.
4. The use of water allowed herein may be made only at times when sufficient water is available to satisfy all prior rights, including prior rights for maintaining instream flows.

5. If the riparian area is disturbed in the process of developing a point of diversion, the permittee shall be responsible for restoration and enhancement of such riparian area in accordance with ODFW's Fish and Wildlife Habitat Mitigation Policy OAR 635-415. For purposes of mitigation, the ODFW Fish and Wildlife Habitat Mitigation Goals and Standards, OAR Chapter 635, Division 415, shall be followed.
6. If the volume of the completed reservoir is 9.2 acre feet or more and a dam is used to impound the water, the height of the dam shall be less than 10.0 feet.
7. Construction of the water system shall begin within five years of the date of permit issuance. The deadline to begin construction may not be extended. This permit is subject to cancellation proceedings if the begin construction deadline is missed.
8. The permitted volume of water shall be stored within five years of the date of permit issuance. If additional time is needed, the permittee may submit an application for extension of time, which may be approved based upon the merit of the application.
9. Within one year after storage of water, the permittee shall submit a claim of beneficial use to the Oregon Water Resources Department.
10. The claim of beneficial use shall be prepared by a Certified Water Right Examiner in conformance with the requirements of OAR 690-014 if an associated secondary permit exists for the use of stored water under this permit, or if the reservoir capacity is equal to or greater than 9.2 acre-feet.
11. If no secondary permit exists and the reservoir capacity is less than 9.2 acre-feet of water, the claim of beneficial use need not be prepared by a Certified Water Right Examiner. The information submitted to the Oregon Water Resources Department shall include:
 - a. the dimensions of the reservoir;
 - b. the maximum capacity of the reservoir in acre-feet; and
 - c. a map identifying the location of the reservoir prepared in compliance with Water Resource Department standards.

Issued November 21 2017

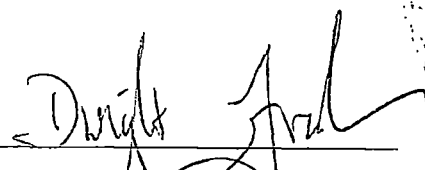
Dwight French, Water Right Services Division Administrator
for Thomas M. Byler, Director

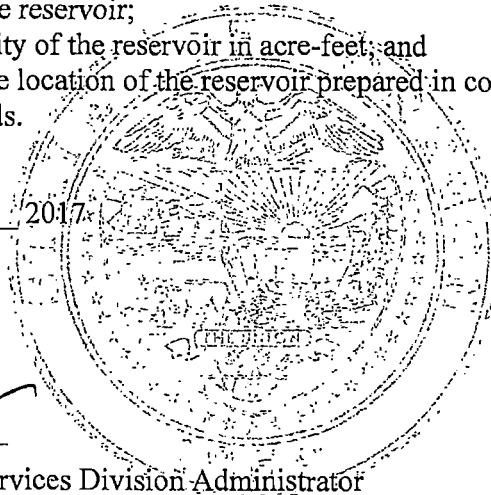

Received by OWRD

NOV 04 2024

Salem, OR

Received by OWRD

NOV 04 2024

Salem, OR



Attachment B

Reservoir Cross Section

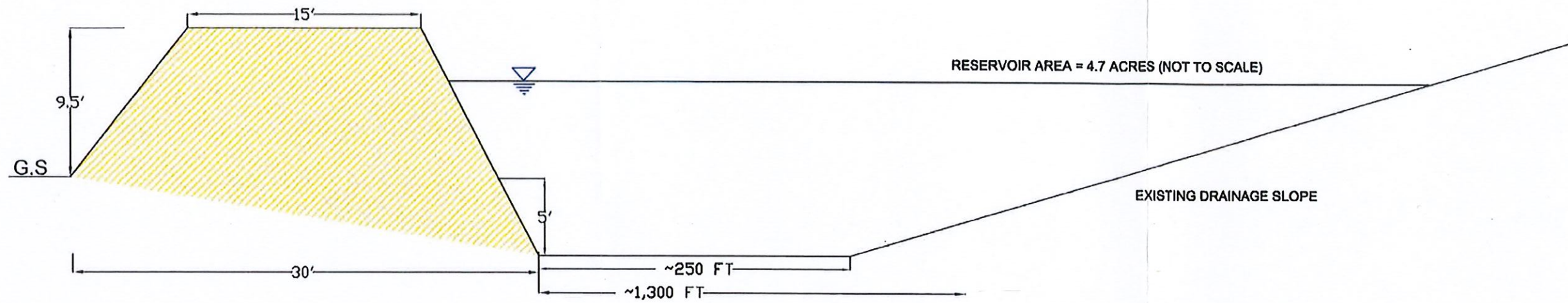
Claim of Beneficial Use Report - SARBANAND ENTERPRISES LLC



LEGEND

-  IMPOUNDED SURFACE RUNOFF
-  RESERVOIR BERM
- G.S. EXISTING GROUND SURFACE

DISCLAIMER:
THIS DRAWING IS INTENDED AS A CONCEPTUAL DRAWING FOR THE SOLE
PURPOSE OF APPLYING FOR A WATER RIGHT. THIS IS NOT A DESIGN DRAWING.

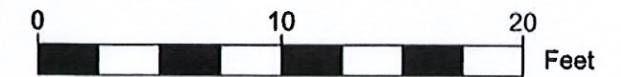

NOT FOR CONSTRUCTION

CLIENT:	SARBANAND ENTERPRISES	DWN BY:	SK	PROJECT	SOUTH AIRPORT POND #1 0562.001
		CHCK'D BY:		TITLE	PROPOSED RESERVOIR CROSS SECTIONS
		DATUM:			Received by
		PROJECTION:			NOV 04 2024
		SCALE:	AS SHOWN		



NOV 04 2024

Salem, OR

Received by OWRD

NOV 04 2024

Salem, OR

Attachment C

Fish Passage Letter

Claim of Beneficial Use Report - SARBANAND ENTERPRISES LLC

Kim Grigsby

From: CLARK Gerald E * WRD <Gerald.E.Clark@oregon.gov>
Sent: Thursday, May 10, 2018 2:44 PM
To: MURTAGH Tom
Subject: RE: Water right Permits R-15271 and R-15272

Tom,

Thank you for the information. I will print it out and place it in the appropriate files.

Gerry

Gerry Clark
Water Right Services Division
Water Resources Department
725 Summer Street NE, Suite A
Salem, Oregon 97301

Phone: 503-986-0811

From: Tom Murtagh [mailto:Tom.Murtagh@state.or.us]
Sent: Thursday, May 10, 2018 10:15 AM
To: CLARK Gerald E
Subject: Water right Permits R-15271 and R-15272

Gerry; This email is to confirm my original evaluation of the two water storage permit requests (R-15271 and R-15272) proposed on the Munger Property in Yamhill County. Due to these two pond's location in the channel above the 100 year flood plain, and the conclusion that native migratory fish do not currently have, or did not historically have, access to this reach of the waterway, ODFW confirms that fish passage will not be a requirement for these two projects. ODFW does request, however, that the land owner consider planting trees and other native vegetation around the ponds where feasible to offset thermal increases to impounded water, a potential detriment to the Yamhill River, a DEQ 303d listed system. Thanks, and please contact me as needed for any clarification or further discussion. Tom.

Tom Murtagh
District Fish Biologist
ODFW
17330 SE Evelyn Street
Clackamas, OR 97015
(W) 971-673-6044; (C) 971-678-4871
tom.murtagh@state.or.us

Received by [unclear]

NOV 04 2018

Salem, OR

Received by OWRD

NOV 04 2024

Salem, OR

Attachment D

COBU Map

Claim of Beneficial Use Report - SARBANAND ENTERPRISES LLC

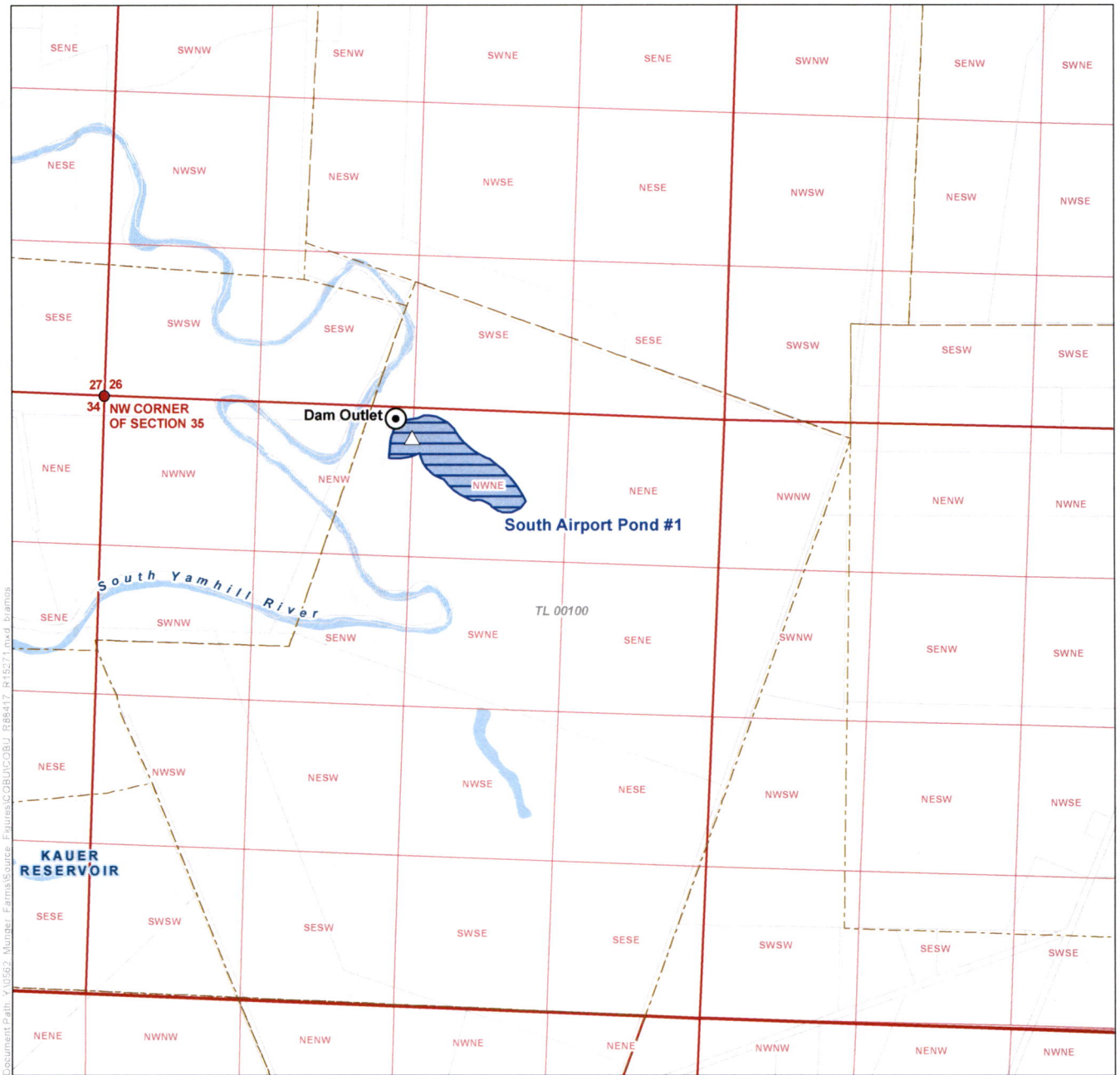

Document Path: X:\3562_Munger_Farms\Source_Figures\COB\COBU_B88417_R15271.mxd, frames

LEGEND

- Point of Diversion (POD)
- Staff Gage
- South Airport Pond #1
- Tax Lot
- Watercourse
- Waterbody

Claim of Beneficial Use Map
Sarbanand Enterprises, LLC.
Application R-88417; Permit R-15271
 Township 4 South, Range 4 West (W.M.)

Received by OWRD

NOV 04 2024

Salem, OR

CERTIFIED WATER RIGHTS EXAMINER STAMP

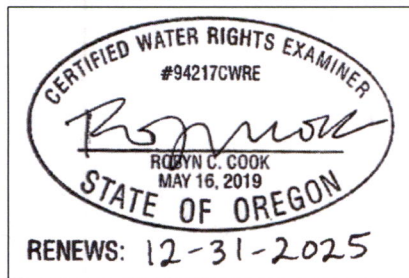

POA LOCATION DESCRIPTION

Dam Outlet
 Located 195 feet South and 2,525 feet East from the NW corner of Section 35, Township 4 South, Range 4 West (W.M.) (-123.1465140, 45.1857144)

DISCLAIMER
 This map was prepared for the purpose of identifying the location of a water right only and it is not intended to provide legal dimensions or location of property ownership lines.

Date: October 3, 2024
 Data Sources: BLM, ESRI, OWRD, USGS

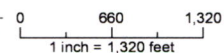



October 30, 2024

Gerry Clark
Oregon Water Resources Department
725 Summer Street NE, Suite A
Salem, Oregon 97301-1271

RE: Claim of Beneficial Use for Permit R-15271 (Application R-88417)

Gerry:

On behalf of Sarbanand Enterprises LLC, please find enclosed a Claim of Beneficial Use report for Permit R-15271.

Please do not hesitate to contact me at 541-753-0933 with questions about the enclosed COBU.

Sincerely,

A handwritten signature in blue ink that reads "Zach Pike-Urlacher".

Zach Pike-Urlacher
Water Resources Consultant

A handwritten signature in blue ink that reads "Robyn Cook".

Robyn Cook, RG, PG, CWRE
Principal Hydrologist

Enclosures:
Claim of Beneficial Use for Permit R-15271 and \$230 fee

Received by OWRD

NOV 04 2024

Salem, OR

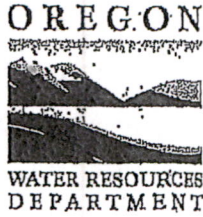

Received by OWRD
NOV 04 2024
Salem, OR

Date Received (Date Stamp Here)

OWRD Over-the-Counter Submission Receipt

Applicant Name(s) & Address: Sarbanand Enterprises LLC
786 Rd 188 Delano CA 93215

Transaction Type: CRU

Fees Received: \$ 230

Cash Check: Check No. 09669
Name(s) on Check: Same as Above

Thank you for your submission. Oregon Water Resources Department (Department) staff will review your submittal as soon as possible.

If your submission is determined to be complete, you will receive a receipt for the fees paid and an acknowledgement letter stating your submittal is complete.

If determined to be incomplete, your submission and the accompanying fees will be returned with an explanation of deficiencies that must be addressed in order for the submittal to be accepted.

If you have any questions, please feel free to contact the Department's Customer Service staff at 503-986-0801 or 503-986-0810.

Sincerely,
OWRD Customer Service Staff

Submission received by: Nick Reece
(Name of OWRD staff)

Instructions for OWRD staff:

- Complete this Submission Receipt and make two (2) copies. Place one copy with the check/cash; and place the other copy with the submission (i.e., the application or other document).
- Date-stamp all pages. (NOTE: Do not stamp check.)
- Give this original Submission Receipt to the applicant.
- Record Submission Receipt information on the "RECEIVED OVER THE COUNTER" log sheet.
- Fold and put one copy of the Submission Receipt with check/cash into the Safe slot. Place the other copy of the Submission Receipt with submission (application/other document) in the top drawer of filing cabinet.