



Form A

NOTICE OF BEGINNING OF CONSTRUCTION

I, State Board of Higher Education, the holder of Permit No. 25233 & 25234

to appropriate the public waters of the state of Oregon, began the actual construction of the works described therein on the 20th day of November, 1958.

Remarks: Eugene for the construction of the pumping station, and to Fairbanks-Morse of Portland for the construction of the two pumps required. Actual work has begun on the remodeling of gates and on dewatering of the upper channel in preparation for excavation; up to the date of this statement, and any additional information which may tend to show the beginning of work in good faith.

three men have been employed in this work.

IN WITNESS WHEREOF, I have hereunto set my hand this first day of December, 1958

J. O. Lindstrom, Business Manager, University

of Oregon, Eugene, Oregon (Address) on behalf of the State Board of Higher Education. Fill out, detach, and mail to the State Engineer, Salem, Oregon, when construction work is begun.

State Printing 92284

RECEIVED DEC 2 1958 STATE ENGINEER SALEM, OREGON

Form B

NOTICE OF COMPLETION OF CONSTRUCTION

I, State Board of Higher Education, the holder of Permit No. 25234

to appropriate the public waters of the state of Oregon, completed the construction of the works described therein on the 20th day of May, 1959.

Remarks: If the works have less capacity than described in the permit, or you have definitely abandoned part of the proposed development, you should so state in order that our records may not be unnecessarily encumbered.

IN WITNESS WHEREOF, I have hereunto set my hand this 21st day of May, 1959

J. O. Lindstrom, Business Manager of the University of Oregon, Eugene, Oregon, on behalf of the State Board of Higher Education.

(Signature of Applicant) Fill out, detach, and mail to the State Engineer, Salem, Oregon, when construction work is completed.

RECEIVED MAY 22 1959 STATE ENGINEER SALEM, OREGON

Permit  
**RECEIVED**  
SEP 16 1957  
STATE ENGINEER  
SALEM, OREGON

Permit No. ....

**\*APPLICATION FOR PERMIT**

# To appropriate the Public Waters of the State of Oregon

I, State Board of Higher Education  
(Name of applicant)

of Eugene  
(Mailing address)

State of Oregon, do hereby make application for a permit to appropriate the following described public waters of the State of Oregon, **SUBJECT TO EXISTING RIGHTS:**

If the applicant is a corporation, give date and place of incorporation .....

1. The source of the proposed appropriation is Willamette River  
(Name of stream)

....., a tributary of Columbia River

2. The amount of water which the applicant intends to apply to beneficial use is 50

cubic feet per second. ....  
(If water is to be used from more than one source, give quantity from each)

\*\*3. The use to which the water is to be applied is Recreation: Swimming, boating and  
(Irrigation, power, mining, manufacturing, domestic supplies, etc.)

scenic value.

4. The point of diversion is located ..... ft. .... and ..... ft. .... from the  
(N. or S.) (E. or W.)

corner of 930 feet S 20° E from the center of Section 33  
(Section or subdivision)

.....  
(If preferable, give distance and bearing to section corner)

.....  
(If there is more than one point of diversion, each must be described. Use separate sheet if necessary)

being within the NW 1/4, SE 1/4 of Sec. 33, Tp. 17 S  
(Give smallest legal subdivision) (N. or S.)

R. 3 W, W. M., in the county of Lane  
(E. or W.)

5. The Canal and Pipe Line to be 10,700 feet  
(Main ditch, canal or pipe line) (Miles or feet)

in length, terminating in the SW 1/4, SW 1/4 of Sec. 29, Tp. 17 S  
(Smallest legal subdivision) (N. or S.)

R. 3 W W. M., the proposed location being shown throughout on the accompanying map.  
(E. or W.)

## DESCRIPTION OF WORKS

### Diversion Works—

6. (a) Height of dam None feet, length on top ..... feet, length at bottom

..... feet; material to be used and character of construction .....  
(Loose rock, concrete, masonry,

rock and brush, timber crib, etc., wasteway over or around dam)

(b) Description of headgate None  
(Timber, concrete, etc., number and size of openings)

(c) If water is to be pumped give general description It is planned to install two 11,250  
(Size and type of pump)

gpm propeller type pumps with 50 hp motors, operating against a total head of  
(Size and type of engine or motor to be used, total head water is to be lifted, etc.)

12.5 feet, in an outdoor type pump station, discharging into the existing mill race.

\*A different form of application is provided where storage works are contemplated.

\*\*Application for permits to appropriate water for the generation of electricity, with the exception of municipalities, must be made to the Hydroelectric Commission. Either of the above forms may be secured, without cost, together with instructions by addressing the State Engineer, Salem, Oregon.







PERMIT

STATE OF OREGON, }  
County of Marion, } ss.

This is to certify that I have examined the foregoing application and do hereby grant the same, SUBJECT TO EXISTING RIGHTS and the following limitations and conditions:

The right herein granted is limited to the amount of water which can be applied to beneficial use and shall not exceed ..... cubic feet per second measured at the point of diversion from the stream, or its equivalent in case of rotation with other water users, from .....

The use to which this water is to be applied is Recreational, including swimming, boating and scenic enhancement.

If for irrigation, this appropriation shall be limited to ..... of one cubic foot per second .....

This use of water hereby authorized is permissive only and shall be subordinate to all future appropriations for domestic, municipal, irrigation, and industrial uses and to appropriations for storage for such uses.

and shall be subject to such reasonable rotation system as may be ordered by the proper state officer.

The priority date of this permit is .....

Actual construction work shall begin on or before ..... and shall thereafter be prosecuted with reasonable diligence and be completed on or before .....

Complete application of the water to the proposed use shall be made on or before .....

WITNESS my hand this ..... day of ....., 19 .....

STATE ENGINEER

Permits for power development are subject to the payment of annual fees as provided in sections 1 and 2, chapter 74, Oregon Laws 1933.

Application No. ....  
Permit No. ....

**PERMIT**  
TO APPROPRIATE THE PUBLIC  
WATERS OF THE STATE  
OF OREGON

Division No. .... District No. ....

This instrument was first received in the office of the State Engineer at Salem, Oregon, on the ..... day of ....., 19 ....., at ..... o'clock ..... M.

Returned to applicant: .....

Corrected application received: .....

Approved: .....

Recorded in book No. .... of  
Permits on page .....

STATE ENGINEER

Drainage Basin No. .... Page .....

Fees Paid .....

14-23

Permit No. 25234

Application No. 31913

County Lane

### Proof of Appropriation of Water

- 1. Name State Board of Higher Education 2. Address Eugene, Oregon
- 3. Source of supply Willamette River  
Tributary of Columbia River
- 4. Amount of water 36.8 c.f.s. 5. Priority date September 30, 1957
- 6. Use Recreational, including swimming, boating and scenic enhancement.
- 7. Location of point of diversion Lot 4 (NW 1/4 SE 1/4) Sec. 33, Twp. 17 S., Range 3 W., W. M.  
(Legal Subdivision)
- 8. The description of land given below corresponds to that found in your permit covering land to be irrigated, or, if for other purposes, the place of use.

| Township<br>Willamette Meridian | Range | Section | Legal Subdivision                         | No. Acres<br>Actually Irrigated |
|---------------------------------|-------|---------|---|---------------------------------|
| 17 S.                           | 3 W.  | 32      | S 1/2 NE 1/4; SE 1/4 NW 1/4; N 1/2 SE 1/4 | recreation                      |
|                                 |       | 33      | N 1/2 S 1/2                               | recreation                      |
|                                 |       |         | <u>USE</u>                                |                                 |

This use of water hereby authorized is permissive only and shall be subordinate to all future appropriations for domestic, municipal, irrigation and industrial uses and to appropriations for storage for such uses. The intakes to the pumping plant at the diversion point shall be properly screened to prevent the entry of fish into the pumps and the permittee shall cooperate with fisheries agencies of the State of Oregon in installation of a barrier at the point where the water is returned to the Willamette River if such measure is later determined by said fisheries/agencies to be necessary.

I have read the above and foregoing proof of appropriation of water; I know the contents thereof, and that the facts therein stated are true.

IN WITNESS WHEREOF, I have hereunto set my hand this ..... day of .....

19.....

Insp. May 12 '61 m. B

Dist. This water is to be used for irrigation



Info - Mr. Monte Gill

Report - See report on previous inspo for Heating Plant  
Same Pumps

May 12, 1961

Myron Bish

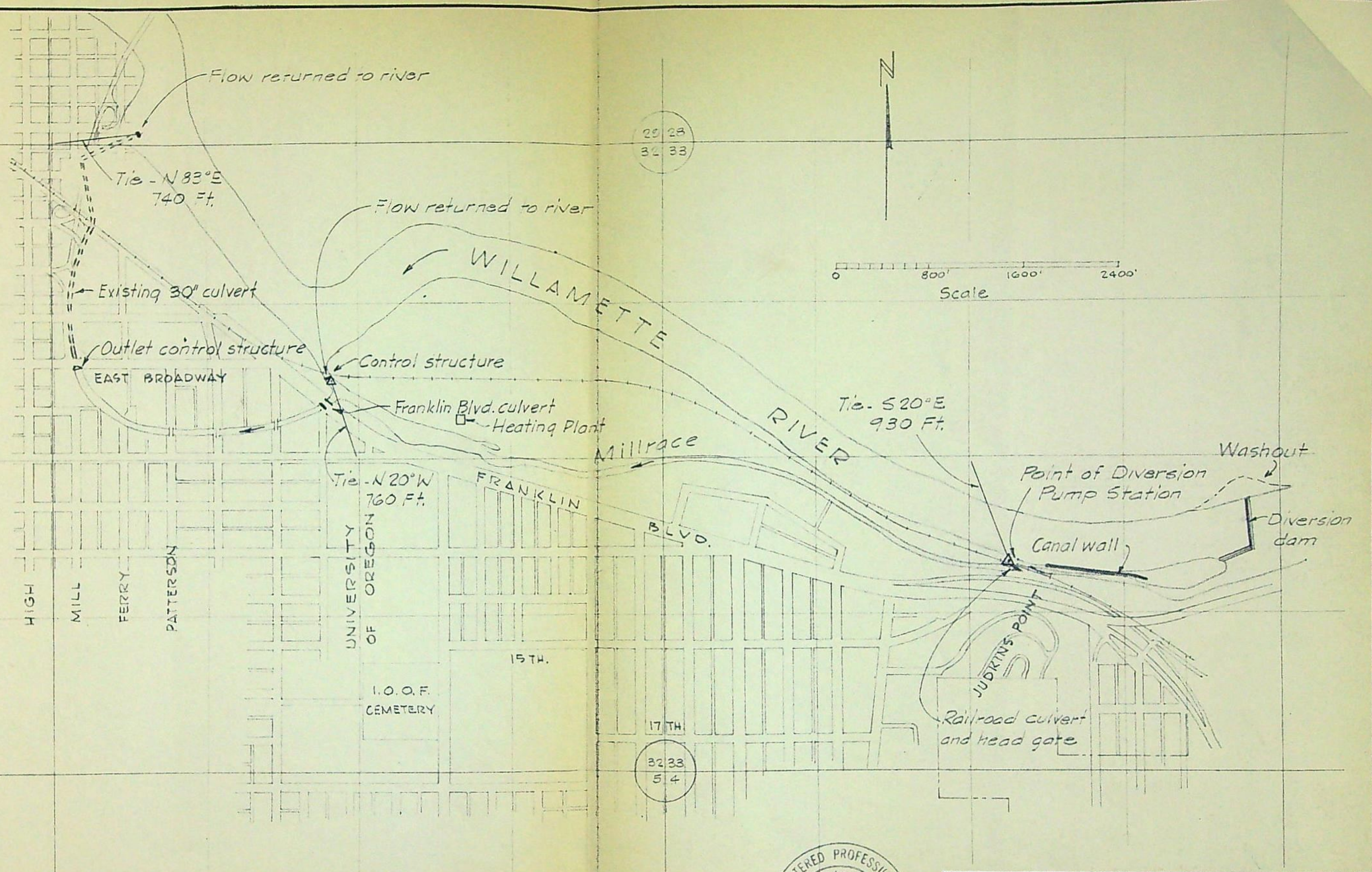

T 185, R 3W

Application No. 31913  
 Permit No. 25234



|                      |   |              |
|----------------------|---|--------------|
| UNIVERSITY OF OREGON |   |              |
| WATER RIGHT PERMIT   |   |              |
| MILL RACE            |   |              |
| SCALE NOTED          | AUGUST 21, 1957   | SHEET 1 OF 1 |
| AJG                  | CORNELL, HOWLAND, HAYES & MERRYFIELD<br>CORVALLIS, OREGON | E896-5       |

STATE OF OREGON

COUNTY OF LANE

RECEIVED  
DEC 26 1961  
STATE ENGINEER  
HEM. OREGON

CERTIFICATE OF WATER RIGHT

This Is to Certify, That STATE BOARD OF HIGHER EDUCATION

of Eugene, State of Oregon, has made proof to the satisfaction of the STATE ENGINEER of Oregon, of a right to the use of the waters of Willamette River

a tributary of Columbia River for the purpose of recreational, including swimming, boating and scenic enhancement under Permit No. 25234 of the State Engineer, and that said right to the use of said waters has been perfected in accordance with the laws of Oregon; that the priority of the right hereby confirmed dates from September 30, 1957

that the amount of water to which such right is entitled and hereby confirmed, for the purposes aforesaid, is limited to an amount actually beneficially used for said purposes, and shall not exceed 36.8 cubic feet per second

or its equivalent in case of rotation, measured at the point of diversion from the stream. The point of diversion is located in the Lot 4 (NW 1/4 SE 1/4) Section 33, T. 17 S., R. 3 W., W.M.

The amount of water used for irrigation, together with the amount secured under any other right existing for the same lands, shall be limited to ----- of one cubic foot per second per acre,

and shall conform to such reasonable rotation system as may be ordered by the proper state officer.

A description of the place of use under the right hereby confirmed, and to which such right is appurtenant, is as follows:

S 1/2 NE 1/4  
SE 1/4 NW 1/4  
N 1/2 SE 1/4  
Section 32  
N 1/2 S 1/2  
Section 33  
T. 17 S., R. 3 W., W.M.

This use of water hereby authorized is permissive only and shall be subordinate to all future appropriations for domestic, municipal, irrigation and industrial uses and to appropriations for storage for such uses. The intakes to the pumping plant at the diversion point shall be properly screened to prevent the entry of fish into the pumps and the permittee shall cooperate with fisheries agencies of the State of Oregon in installation of a barrier at the point where the water is returned to the Willamette River if such measure is later determined by said fisheries agencies to be necessary.

The right to the use of the water for the purposes aforesaid is restricted to the lands or place of use herein described.

THIS IS A DRAFT OF WATER RIGHT CERTIFICATE

See other side for instructions and final proof to be executed by permittee.

EW  
12/18/61

STATE OF OREGON  
STATE ENGINEER  
WATER RESOURCES DEPARTMENT  
SALEM

251 FINANCE BUILDING  
170 12TH STREET S. E.

REFER TO FILE NO. 31913

State Board of Higher Education  
Eugene  
Oregon

RECEIVED

DEC 20 1961

UNIVERSITY OF OREGON  
BUSINESS OFFICE

Gentlemen:

On the reverse side of this paper is a copy of a draft of water right certificate to confirm the right under Permit No. 25234. You are requested to examine this draft and if you find it correctly describes the appropriation of water made, execute the following final proof. A fee of \$1.00 is required for recording your certificate of water right in the office of the County Clerk. The fee of \$1.00, together with this signed draft, must be returned to the State Engineer.

Very truly yours,

LEWIS A. STANLEY  
State Engineer

FINAL PROOF

I have read the draft of water right certificate shown on the reverse side of this paper and as final proof of appropriation of water I hereby certify that the water has been used as described in said draft.

December 21, 1961  
(Date)

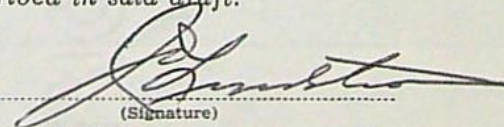
  
(Signature)  
J. O. Lindstrom, Business Manager  
University of Oregon

STATE OF OREGON  
COUNTY OF LANE  
CERTIFICATE OF WATER RIGHT

**This Is to Certify, That** STATE BOARD OF HIGHER EDUCATION

of Eugene, State of Oregon, has made proof to the satisfaction of the STATE ENGINEER of Oregon, of a right to the use of the waters of Willamette River

a tributary of Columbia River for the purpose of recreational, including swimming, boating and scenic enhancement under Permit No. 25234 of the State Engineer, and that said right to the use of said waters has been perfected in accordance with the laws of Oregon; that the priority of the right hereby confirmed dates from September 30, 1957

that the amount of water to which such right is entitled and hereby confirmed, for the purposes aforesaid, is limited to an amount actually beneficially used for said purposes, and shall not exceed 36.8 cubic feet per second

or its equivalent in case of rotation, measured at the point of diversion from the stream. The point of diversion is located in the Lot 4 (NW $\frac{1}{4}$  SE $\frac{1}{4}$ ) Section 33, T. 17 S., R. 3 W., W.M.

The amount of water used for irrigation, together with the amount secured under any other right existing for the same lands, shall be limited to \_\_\_\_\_ of one cubic foot per second per acre,

and shall conform to such reasonable rotation system as may be ordered by the proper state officer.

A description of the place of use under the right hereby confirmed, and to which such right is appurtenant, is as follows:

S $\frac{1}{2}$  NE $\frac{1}{4}$   
SE $\frac{1}{4}$  NW $\frac{1}{4}$   
N $\frac{1}{2}$  SE $\frac{1}{4}$   
Section 32  
N $\frac{1}{2}$  S $\frac{1}{2}$   
Section 33  
T. 17 S., R. 3 W., W.M.

This use of water hereby authorized is permissive only and shall be subordinate to all future appropriations for domestic, municipal, irrigation and industrial uses and to appropriations for storage for such uses. The intakes to the pumping plant at the diversion point shall be properly screened to prevent the entry of fish into the pumps and the permittee shall cooperate with fisheries agencies of the State of Oregon in installation of a barrier at the point where the water is returned to the Willamette River if such measure is later determined by said fisheries agencies to be necessary.

The right to the use of the water for the purposes aforesaid is restricted to the lands or place of use herein described.

WITNESS the signature of the State Engineer, affixed

this date, FEBRUARY 16 1962

LEWIS A. STANLEY

State Engineer

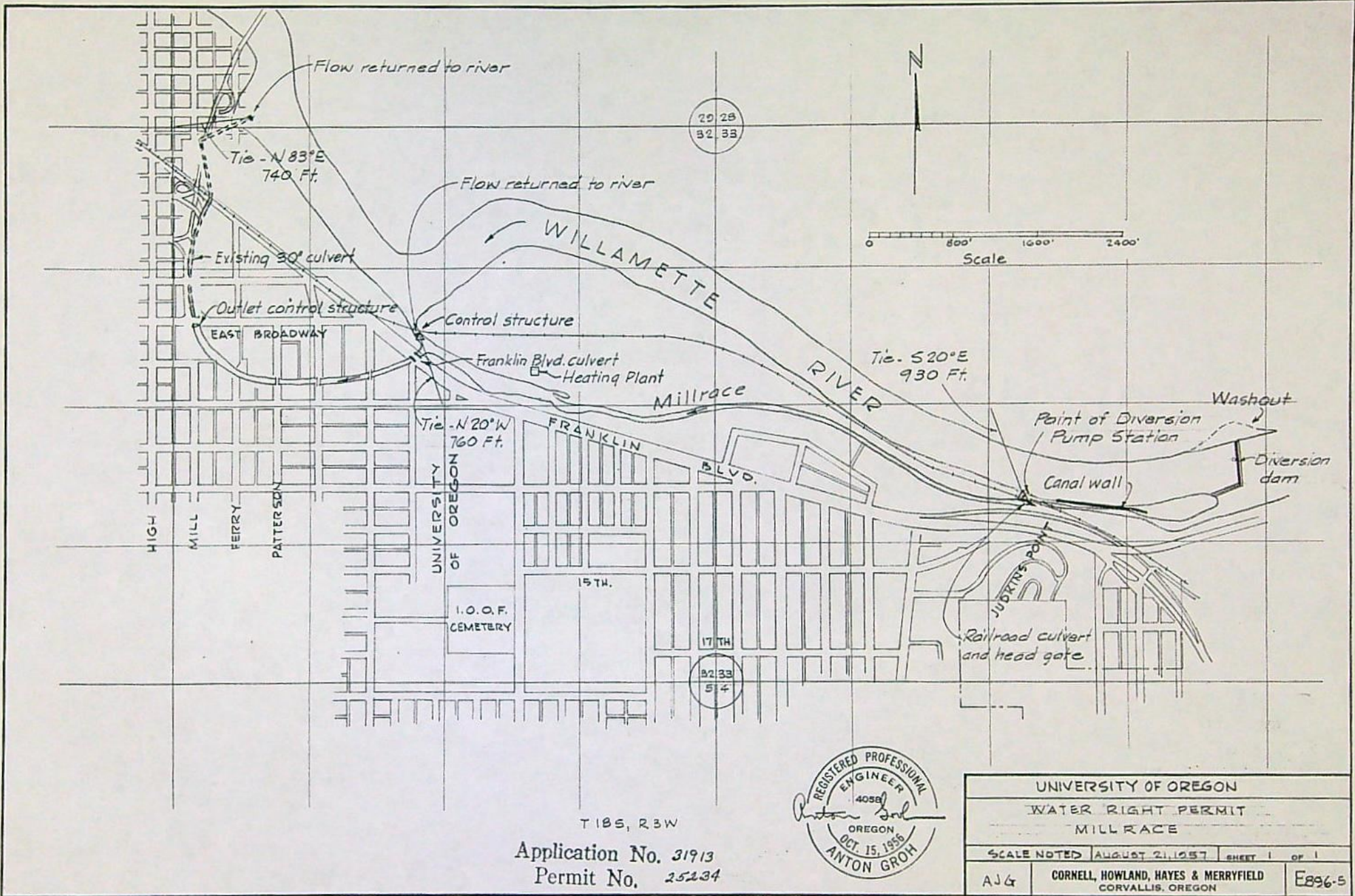

29 28  
32 33

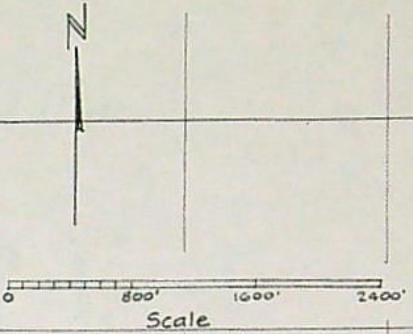

T 18 S, R 3 W

Application No. 31913  
Permit No. 25234



|                      |   |              |
|----------------------|---|--------------|
| UNIVERSITY OF OREGON |   |              |
| WATER RIGHT PERMIT   |   |              |
| MILL RACE            |   |              |
| SCALE NOTED          | AUGUST 21, 1957   | SHEET 1 OF 1 |
| AJG                  | CORNELL, HOWLAND, HAYES & MERRYFIELD<br>CORVALLIS, OREGON | EB96-5       |

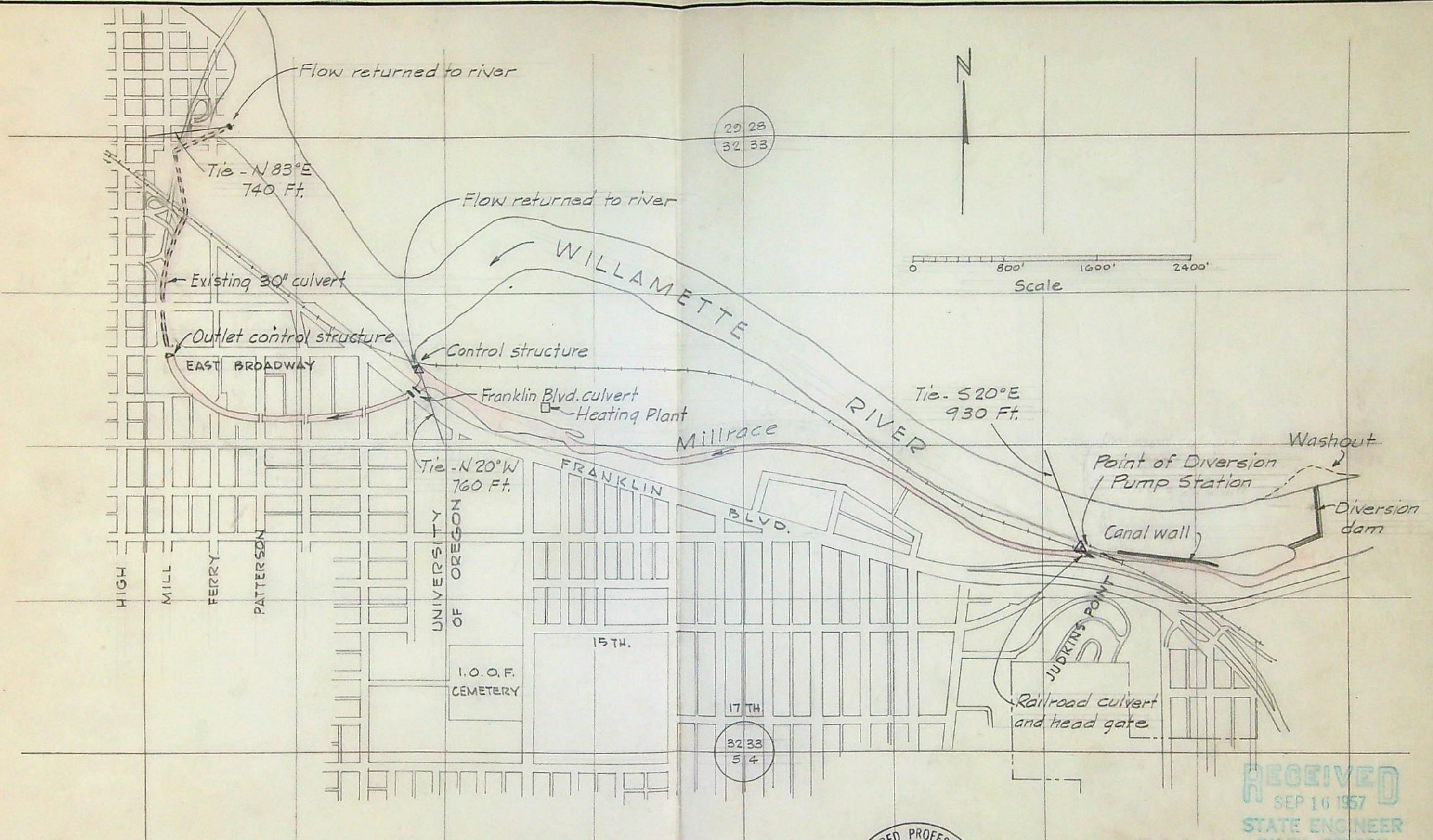

29 28  
32 33

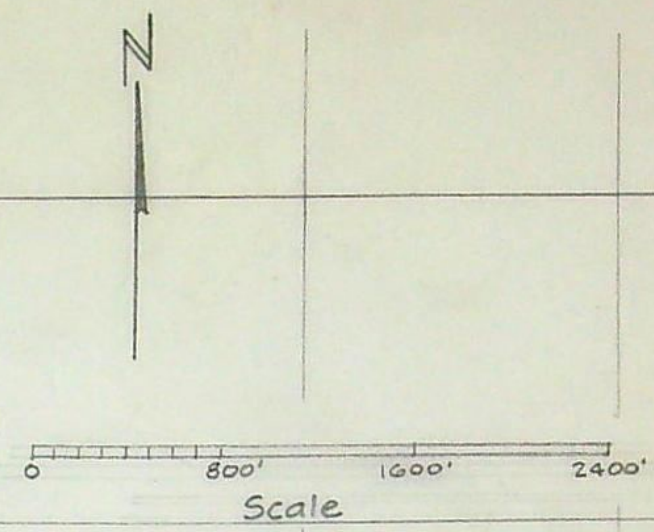

32 33  
5 4



RECEIVED  
SEP 16 1957  
STATE ENGINEER  
SALEM, OREGON

T 185, R 3W  
Application No. 31913  
Permit No. 25234

|                      |   |              |
|----------------------|---|--------------|
| UNIVERSITY OF OREGON |   |              |
| WATER RIGHT PERMIT   |   |              |
| MILL RACE            |   |              |
| SCALE NOTED          | AUGUST 21, 1957   | SHEET 1 OF 1 |
| AJG                  | CORNELL, HOWLAND, HAYES & MERRYFIELD<br>CORVALLIS, OREGON | E896-5       |

September 24, 1957

M E M O R A N D U M

Applications submitted by the State Board of Higher Education covering 50 c.f.s. from the Willamette River for recreation, swimming boating and scenic value and 13.2 c.f.s. from the Willamette River for condenser cooling in the University of Oregon heating plant were discussed with Jim Howland on the telephone this date. He advised he will obtain further information concerning the quantity of water required for the condenser <sup>cooling</sup> flume and justification of the quantity required, and submit it to this office. He will also advise the college concerning the required fees.

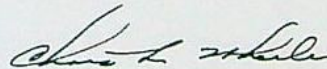

Chris L. Wheeler

CIW:eh



4 BUILDING  
STREET, S.E.

STATE OF OREGON  
STATE ENGINEER  
WATER RESOURCES DEPARTMENT  
SALEM

REFER TO  
FILE NO. 31913

November 23, 1960

State Board of Higher Education  
Eugene, Oregon

Gentlemen:

This will acknowledge receipt of your notice to the effect that complete application of water has been made under Permit No. 25234.

Pursuant to your report and in line with the general practice of this office a survey will be made at a later date. After this survey, proof may be made and certificate issued covering the actual use of water as found by the engineer. In case of irrigation, any lands described in the permit that have not been irrigated will be automatically eliminated from the water right.

In the meantime, the permit which you hold will be valid evidence of the water right in question so long as you continue to use the water.

Very truly yours,

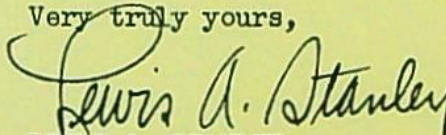

LEWIS A. STANLEY  
State Engineer

Form 128

vmf

UNIVERSITY OF OREGON  
DEPARTMENT OF PHYSICAL PLANT  
EUGENE, OREGON

November 21, 1960

Mr. Lewis A. Stanley, Engineer  
Hydroelectric Commission  
Salem, Oregon

RECEIVED  
NOV 23 1960

Subject: Permit No. 25234.

STATE ENGINEER  
SALEM, OREGON

Dear Mr. Stanley:

This letter will confirm my telephone conversation of this date with one of the staff in your office concerning the above numbered permit.

Your card addressed to the State Board of Higher Education has been sent to this office, and since I am unable to locate the original permit with the Form C attached, I am taking this means of informing you that we have completed the application of water to the proposed use. Completion date of the project was June, 1959.

Sincerely,

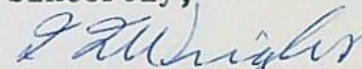

I. I. Wright, Director  
Department of Physical Plant

cc - Mr. H. A. Bork  
Mr. J. O. Lindstrom

May 25, 1959

State Board of Higher Education  
Eugene, Oregon

**Gentlemen:** This acknowledges receipt of Form B, being notice of completion of construction under Permit No. 25234.

The report has been filed with other matter pertaining to the permit, which is in good standing until October 1, 1960, when, under its terms, all the water which it is intended to use at any time should be used to the full extent intended.

Very truly yours,

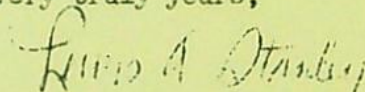

LEWIS A. STANLEY  
State Engineer

Form 119  
Dlf.

31912  
31913

December 8, 1958

State Board of Higher Education  
Eugene, Oregon

Gentlemen:

This acknowledges receipt of Form A, being notice of the beginning of construction under Permit No. 25233 and 25234.

The report has been filed with other matter pertaining to the permit, which is in good standing until October 1, 1959, when, under its terms, construction should be completed.

Very truly yours,

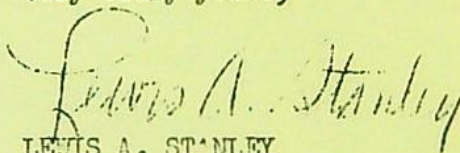

LEWIS A. STANLEY  
State Engineer

Form 118  
Dir.

UNIVERSITY OF OREGON  
OFFICE OF THE BUSINESS MANAGER  
EUGENE, OREGON

December 1, 1958

Mr. Lewis A. Stanley  
State Engineer  
170 12th Street, S. E.  
Salem, Oregon

RECEIVED  
DEC 2 1958  
STATE ENGINEER  
SALEM, OREGON

Dear Mr. Stanley:

I am sending you herewith Form A, Notice of Beginning of Construction, in connection with Permits Nos. 25233 and 25234 which allow the State Board of Higher Education to appropriate waters of the Willamette River for the rehabilitation of the Eugene millrace.

Sincerely,

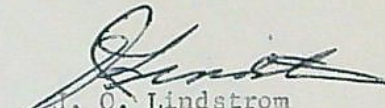
  
J. O. Lindstrom  
Business Manager

31913

February 10, 1958

State Board of Higher Education  
Eugene  
Oregon

Gentlemen:

blueprint.

31913, Permit No. 25234 with

31912  
31913

January 27, 1958

Mr. J. O. Lindstrom  
Business Manager  
University of Oregon  
Eugene, Oregon

Dear Mr. Lindstrom:

I have issued the permits on the two applications of the State Board of Higher Education to appropriate the waters of the Willamette River. Application No. 31913 has been granted in the amount of 36.8 cubic feet per second for recreational: including swimming, boating and scenic value. Application No. 31912 has been approved in the amount of 13.2 cubic feet per second for condenser cooling in the University of Oregon heating plant.

It will be a few days before the permits can be processed in this office and forwarded to you. In the meantime you are authorized as far as this office is concerned to proceed with the construction of the project.

Very truly yours,

LEWIS A. STANLEY  
State Engineer

LAS:eh

*Chris*

UNIVERSITY OF OREGON  
OFFICE OF THE BUSINESS MANAGER  
EUGENE, OREGON

January 23, 1958

Mr. Lewis A. Stanley  
State Engineer  
Water Resources Department  
251 Finance Building  
170 Twelfth Street, S.E.  
Salem, Oregon

RECEIVED  
JAN 27 1958  
STATE ENGINEER  
SALEM, OREGON

RE: University of Oregon Millrace Permits

Dear Mr. Stanley:

I have your letter of January 22nd concerning the University of Oregon's two pending applications for use of the millrace stream. The requirement you outline in your letter is satisfactory with us and we would appreciate receiving the permits so we may go forward with the project.

Thank you very much for your attention.

Sincerely yours,

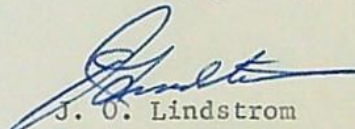
  
J. O. Lindstrom  
Business Manager



SIONERS:

JOHNSON, CHAIRMAN, ASTORIA  
W. MAHAFFY, COOS BAY  
PALMER, PORTLAND



STATE OF OREGON  
FISH COMMISSION OF OREGON  
307 STATE OFFICE BLDG., 1400 S. W. 5TH AVENUE  
PORTLAND 1

January 23, 1958

Mr. Lewis A. Stanley  
State Engineer  
Salem, Oregon

RECEIVED  
JAN 24 1958  
STATE ENGINEER  
SALEM, OREGON

Dear Mr. Stanley:

After our telephone call of yesterday regarding re-activation of the University of Oregon millrace, I checked with our files and the Game Commission files to determine whether we had written your office regarding this. Attached is a copy of a joint letter by the Fish and Game Commissions dated December 30th which cleared both offices. It is possible that the letter was lost enroute.

Very truly yours,

*L. Dean Marriage*

L. DEAN MARRIAGE  
WATER RESOURCES ANALYST

enc: 1

31912 + 3

January 22, 1958

Mr. J. O. Lindstrom  
Business Manager  
University of Oregon  
Eugene, Oregon

Dear Mr. Lindstrom:

Following my telephone conversation with you this morning I talked with Mr. Marriage of the Oregon Fish Commission, who had not yet advised us concerning requirements for the protection of fish in the proposed diversion from the Willamette River under Applications 31912 and 31913. Mr. Marriage stated over the telephone that he has discussed this matter with your engineers and is convinced that no injury to the fishery of the Willamette River will result providing the intake to the pumps is properly screened. He thinks there may be a possibility that at some future time some sort of rack may be required at the point where the water is returned to the Willamette River to prevent fish from going up the tailrace channel and dead ending.

I propose to issue the permits on these two pending applications in the very near future and to include in them the requirement approximately as follows:

The intakes to the pumping plant at the diversion point from the Willamette River should be properly *shall* screened to prevent the entry of fish into the pumps and the permittee shall cooperate with fisheries agencies of the State of Oregon in installation of a barrier at the point where the water is returned to the Willamette River if such measure is later determined by said fisheries agencies to be necessary.

If you have any objections to the inclusion of this provision in the permits, please advise.

Very truly yours,

LEWIS A. STANLEY, State Engineer

LAS:VR

MEMBERS:  
JOHNSON, CHAIRMAN, ASTORIA  
W. MAHAFFY, COOS BAY  
PALMER, PORTLAND



STATE OF OREGON  
FISH COMMISSION OF OREGON  
307 STATE OFFICE BLDG., 1400 S. W. 5TH AVENUE  
PORTLAND 1

RECEIVED  
JAN 7 1958  
STATE ENGINEER  
SALEM, OREGON

December 30, 1957

Mr. Lewis A. Stanley  
State Engineer  
Salem, Oregon

Dear Mr. Stanley:

Reference is made to the University of Oregon's application for a water right for 50 c.f.s. from the Willamette River to reactivate the millrace which runs through the University of Oregon campus and the City of Eugene.

Since our letter of October 14, 1957 we have met with representatives of the University of Oregon and Cornell, Howland, Hayes and Merryfield in an effort to reach a better understanding of their plans. On December 23 a field inspection of the project area was made and it was concluded that the main problem would be keeping those fish present in the Willamette River, principally downstream migrants, from being passed through the pump that will supply the water for the millrace.

There are at least two other possible trouble spots which should be pointed out. There is a possibility that upstream migrants (anadromous fish) may be attracted into the spillway canal and "dead-ended". There is a similar possibility that this may also occur at the outfall of the millrace represented by an existing 30" culvert which empties into the Willamette River in the vicinity of the Eugene Water and Electric Board's plant at the Ferry Street Bridge. On these two matters and possibly others we would like to take a "wait and see" attitude to see if any trouble develops with anadromous fish.

We can see no major objections to the granting of this water right provided there can be a clause inserted which would insure cooperation of the applicant with the State fisheries agencies in solving those fisheries problems which are now apparent to us and those which may develop at a future date as a result of the operation.

Very truly yours,

*John I. Hodges*  
JOHN I. HODGES  
ACTING STATE FISHERIES DIRECTOR  
*P. W. Schneider*  
P. W. SCHNEIDER, DIRECTOR  
OREGON STATE GAME COMMISSION

31912  
31913

December 31, 1957

Mr. James C. Howland  
Consulting Engineer  
1600 Western Avenue  
Corvallis, Oregon

Dear Mr. Howland:

In response to your letter of December 27, I have not heard from the State Fish Commission concerning the withdrawal of their protest in regard to application Numbers 31912 and 31913; however, I assume from your letter that I will be receiving notice of the fact that it wishes to do so in the very near future.

On receipt of this notice we can proceed towards issuance of the permits.

Very truly yours,

LEWIS A. STANLEY  
State Engineer

By  
Chris L. Wheeler, Assistant

CLW:eh  
cc: State Fish Commission

# CORNELL, HOWLAND, HAYES & MERRYFIELD

*Consulting Engineers* .....

1600 WESTERN AVENUE CORVALLIS, OREGON TELEPHONE PLAZA 3-6638

December 27, 1957

SANITARY  
HYDRAULIC  
ELECTRICAL  
STRUCTURAL  
MECHANICAL  
FOUNDATION

BOISE OFFICE:  
IDAHO BUILDING  
BOISE, IDAHO  
TELEPHONE 3-5221

Mr. Chris L. Wheeler  
Office of the State Engineer  
State Office Building  
Salem, Oregon

RECEIVED  
DEC 30 1957  
STATE ENGINEER  
SALEM, OREGON

IN REPLY PLEASE REFER TO:

Dear Mr. Wheeler:

The University of Oregon has made application to your office for a permit to use water from the Willamette River in the Eugene Mill Race and for cooling at the University Power Plant. On September 27, 1957, we transmitted to you a University of Oregon Student Union Fund check for \$164.00 to cover the filing fees for these applications. Subsequent to this time, we understood that the issuance of a permit had been delayed in view of questions raised by the Oregon State Fish Commission and the Oregon State Game Commission concerning protection of the fish life of the river. On December 9, 1957, there was a meeting in our office in Corvallis attended by Mr. L. Dean Marriage, Water Resource Analyst, Oregon State Fish Commission; Mr. William E. Pitney, Oregon State Game Commission; Mr. I. I. Wright, University of Oregon; and members of our staff. At this meeting the representatives of the fishery agencies indicated that they felt that they could indicate approval of the project subject to their approving final construction plans.

We are advised by Mr. J. O. Lindstrom, Business Manager of the University of Oregon, that the agreement between the City of Eugene, the Eugene Water and Electric Board, and the State Board of Higher Education for the operation of the mill race has been signed and they are anxious to proceed with the project. We would appreciate your notifying us at such time as the application is cleared for the issuance of a permit or advising us of anything further needed on the application. By copy of this letter we are asking Mr. Marriage and Mr. Pitney if they are able to submit their conditional approval to you, if this has not already been done.



Mr. Chris L. Wheeler

-2-

December 27, 1957

Thank you very much for your help in this matter.

Very truly yours,

CORNELL, HOWLAND, HAYES & MERRYFIELD

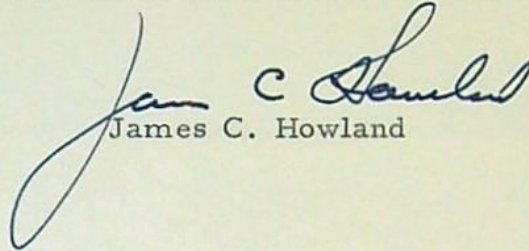
A handwritten signature in cursive script that reads 'James C. Howland'. The signature is written in dark ink and is positioned above the printed name.

James C. Howland

JCH/f

cc: Mr. L. Dean Marriage  
Mr. William E. Pitney  
Mr. J. O. Lindstrom

FISH COMMISSION OF OREGON

307 STATE OFFICE BUILDING  
1400 S. W. 5TH AVENUE  
PORTLAND 1, OREGON

31912  
31913

October 17, 1957

University of Oregon  
State Board of Higher Education  
Eugene, Oregon

RECEIVED  
OCT 21 1957  
STATE ENGINEER  
SALEM, OREGON

Gentlemen:

Enclosed is a copy of our letter to the State Engineer regarding your application for water right of 63.2 cubic feet per second from the Willamette River. Our reason for intervention is to see that adequate safeguards are provided for the anadromous fish occurring in the Willamette River. When your plans are sufficiently advanced in detail we would appreciate receiving a description of the proposed project from your office so that we may review them.

Feel free to contact this office for further information if needed.

Very truly yours,

JOHN I. MOGENSEN  
ACTING STATE FISHERIES DIRECTOR

enc: 1

LDM:hw

cc: State Engineer ✓  
Ernie Jeffries  
Game Commission  
H. C. Warren

COPY

31912  
31913

October 17, 1957

University of Oregon  
Office of the Business Manager  
Eugene, Oregon

Attention: Mr. J. O. Lindstrom, Business Manager

Gentlemen:

This will acknowledge receipt of Mr. Howland's letter of September 27, concerning the use of water for condenser cooling as applied for in your Application No. 31912 and the University's check in the amount of \$164, for which our receipts No. 13441 and 13442 are enclosed. The applications now appear to be in satisfactory form for approval by issuance of a permit.

The Oregon State Fish Commission has requested that action on these applications be delayed until they have had an opportunity to discuss this matter with you to determine if it will be detrimental to the fish program. You should be hearing from them very shortly and I assume that you will be able to iron out any difficulties.

Very truly yours,

LEWIS A. STANLEY  
State Engineer

By  
Chris L. Wheeler, Assistant

CLW:ld  
enc. receipts  
cc: James C. Howland



September 25, 1957

Mr. J. O. Lindstrom  
Business Manager  
University of Oregon  
Eugene, Oregon

Dear Mr. Lindstrom:

This will acknowledge receipt of your letter of September 13 transmitting applications for appropriation of water from the Willamette River for recreation, swimming, boating, scenic value and condenser cooling in the university heating plant and print to accompany the applications.

The applications cannot be filed until the statutory fees are received. These fees will depend in part upon the quantity of water for condenser cooling. I have discussed this matter with Mr. Howland and you should be hearing from him in the future regarding it.

Very truly yours,

LEWIS A. STANLEY  
State Engineer

By  
Chris L. Wheeler, Assistant

CLW:eh