

Request for Assignment By Proof of Ownership (If Water Right Holder is Not Available)



Oregon Water Resources Department
725 Summer Street NE, Suite A
Salem, Oregon 97301-1266
(503) 986-0900
www.oregon.gov/owrd

If the Department determines that the application is incomplete, fees have not been paid, or the required documents are not acceptable, the application and all fees submitted will be returned to the applicant.

If for multiple rights, a separate form and fee for each right will be required.

I, Marcia Harris Trust, Marcia Harris Trustee
(Name of Party Requesting Assignment)

PO Box 326 Aurora, OR 97002 503-341-2333
(Mailing Address) (City) (State) (Zip) (Phone #)

- hereby request assignment of an entire application/permit/transfer order /limited license/groundwater statement;
- hereby request assignment of a portion of application/permit/transfer order/limited license/groundwater statement; *(You must include a map showing the portion of the application/permit/ transfer order /limited license/groundwater statement to be assigned.)*

Application # G-15106 ; Permit # G-13885 ; Transfer Order # NA ;

Limited License # NA ; Groundwater Statement # NA ;

Randy and Marcie Harris
(Name of Current Holder of Record)

26758 S. Bolland Rd. Canby, OR 91013 503-641-2333
(Mailing Address) (City) (State) (Zip) (Phone #)

Note: Write the initials (first letters) of your first and last names at the spots indicated below _____.

- 1) MH I certify that I am the current owner of the property described in this application, permit, transfer order, limited license, or groundwater statement. I have attached proof of ownership that may include but not be limited to: a copy of the deed to the land, a copy of a land sales contract, a court order or decree, documentation of survivorship of property held jointly. The Department cannot accept a copy of a taxstatement.
- 2) MH I have the legal right to request assignment under OAR 690-310-0280 and 690-320-0060.
- 3) MH I have not been able to contact the owner(s) of record for the above referenced transaction. I have attached proof acceptable to the Department that notice of the assignment has been given or attempted for each identified property owner not a party to the assignment. ORS 537.220(2) Failure to submit this proof will result in the return of your request. (Proof may include but not be limited to: a copy of returned certified mailing, copy of a Death Certificate, or a court order.)
- 4) MH I further certify that the information provided herein is true and correct to the best of my knowledge.

Witness my hand this 15 day of OCTOBER, 2024.
(Day) (Month) (Year)

Signature of Party Requesting Assignment Marcie Harris

Failure to provide any of the required information will result in the return of your application.

Part Assign by Proof - Approve
MSB 11-1-2024

This certifies assignment and record change at Oregon Water Resources Department effective 8:00 a.m. on date of receipt at Salem, Oregon.
Fee receipt # 144082
For Director by Mary F. Bjork, Program Analyst in Water Rights Division. MSB

The completed "Request for Assignment" form must be submitted to the Department along with the recording fee of \$120.

Received
OCT 29 2024
OWRD

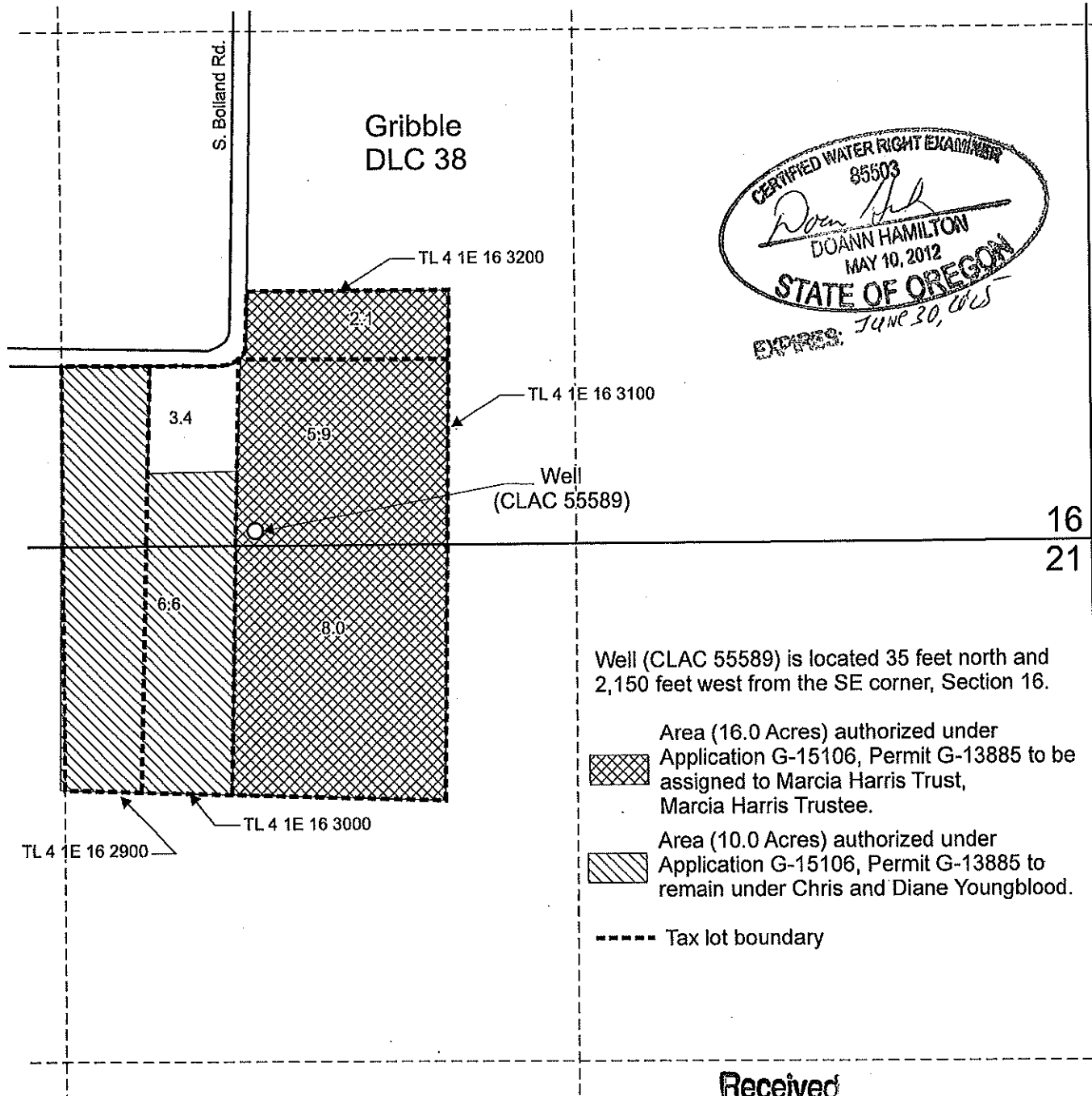

T.4S. R.1E. Sec. 16 & 21, W.M.



CERTIFIED WATER RIGHT EXAMINER
 85503
Doann Hamilton
 DOANN HAMILTON
 MAY 10, 2012
 STATE OF OREGON
 EXPIRES: JUNE 30, 2025

16
 21

Well (CLAC 55589) is located 35 feet north and 2,150 feet west from the SE corner, Section 16.

-  Area (16.0 Acres) authorized under Application G-15106, Permit G-13885 to be assigned to Marcia Harris Trust, Marcia Harris Trustee.
-  Area (10.0 Acres) authorized under Application G-15106, Permit G-13885 to remain under Chris and Diane Youngblood.
- Tax lot boundary

Received

OCT 29 2024

OWRD



Scale: 1" = 400'

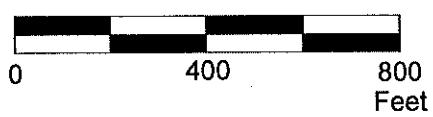

This map was prepared for the purpose of identifying the location of a water right only and is not intended to provide legal dimensions or location of property ownership lines.

Assignment Map
 Application G-15106, Permit G-13885

Marcie Harris
 T.4S. R.1E. Sec. 16 & 21, W.M.

Pacific Hydro-Geology Inc.

10/2024

HarrisG-15106COBUMap.cdr