



# T30S R46E, WM MALHEUR COUNTY, OR

- Well
- - - - USGS Intermittent Stream/Canal
- Pipeline
-  Place of Use Supplemental Irrigation (IS)
-  Section
- - - - Quarter Quarter
-  Tax Lot

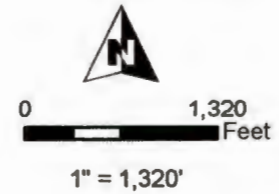

**Well Locations :**

- #1: 10' N, 1520' W of E 1/4 Cor Sec 8
- #2: 150' N, 2600' E of E 1/4 Cor Sec 8

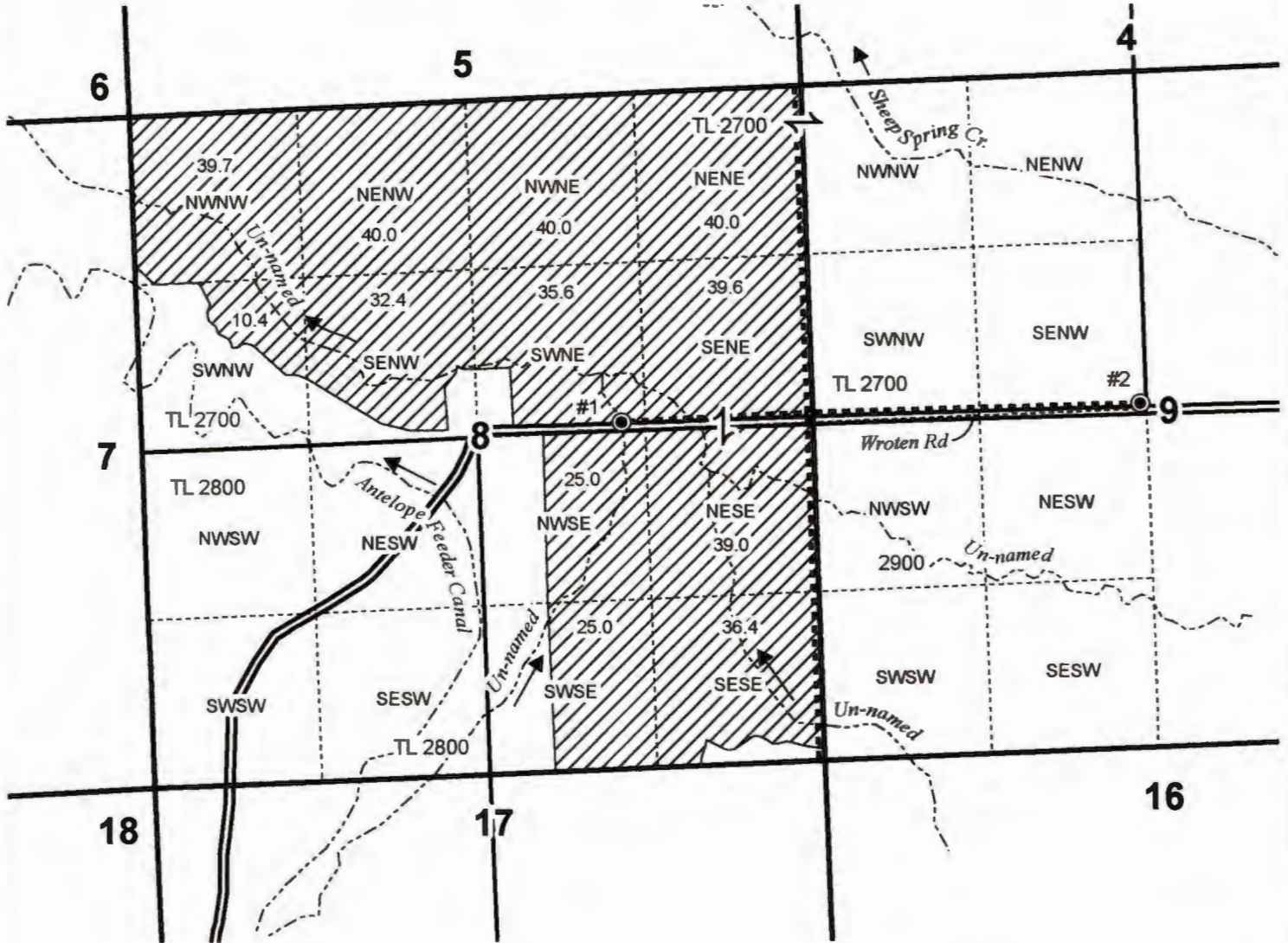

Received

NOV 12 2024

OWRD



**GROUNDWATER APPLICATION MAP  
SCOWN RANCH**

Date: 10/30/2024

This map is not intended to provide legal dimensions or locations of property ownership lines.

**WATER RIGHT SERVICES, LLC**  
 PO BOX 1830, BEND, OR 97709  
**WWW.OREGONWATER.US** CCB # 197121  
 johnshort@usa.com 541-389-2837