

18487 S. Valley Vista Rd.
Mulino, Oregon 97042
(503) 632-5016 Phone
(503) 632-5983 Fax

Pacific Hydro-Geology Inc.

Memo

E-RECEIVED
OCT 03 2024
OWRD

To: Oregon Water Resources Department / Lucinda Vranizan
From: Doann Hamilton, CWRE
CC:
Date: October 3, 2024
Re: Application G-19256.

The initial review (IR) for our client Tuan Tiet was issued September 20, 2024 for Application G-19256. According to the IR additional information was requested. One item was for the map to be revised with mainlines. Attached is the second corrected map to reflect this change.



T.4S. R.2E. Sec. 32 & 33, and T.5S. R.2E. Sec. 4 & 5, W.M.

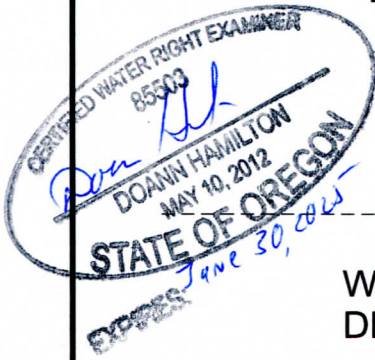

E-RECEIVED
OCT 03 2024
OWRD

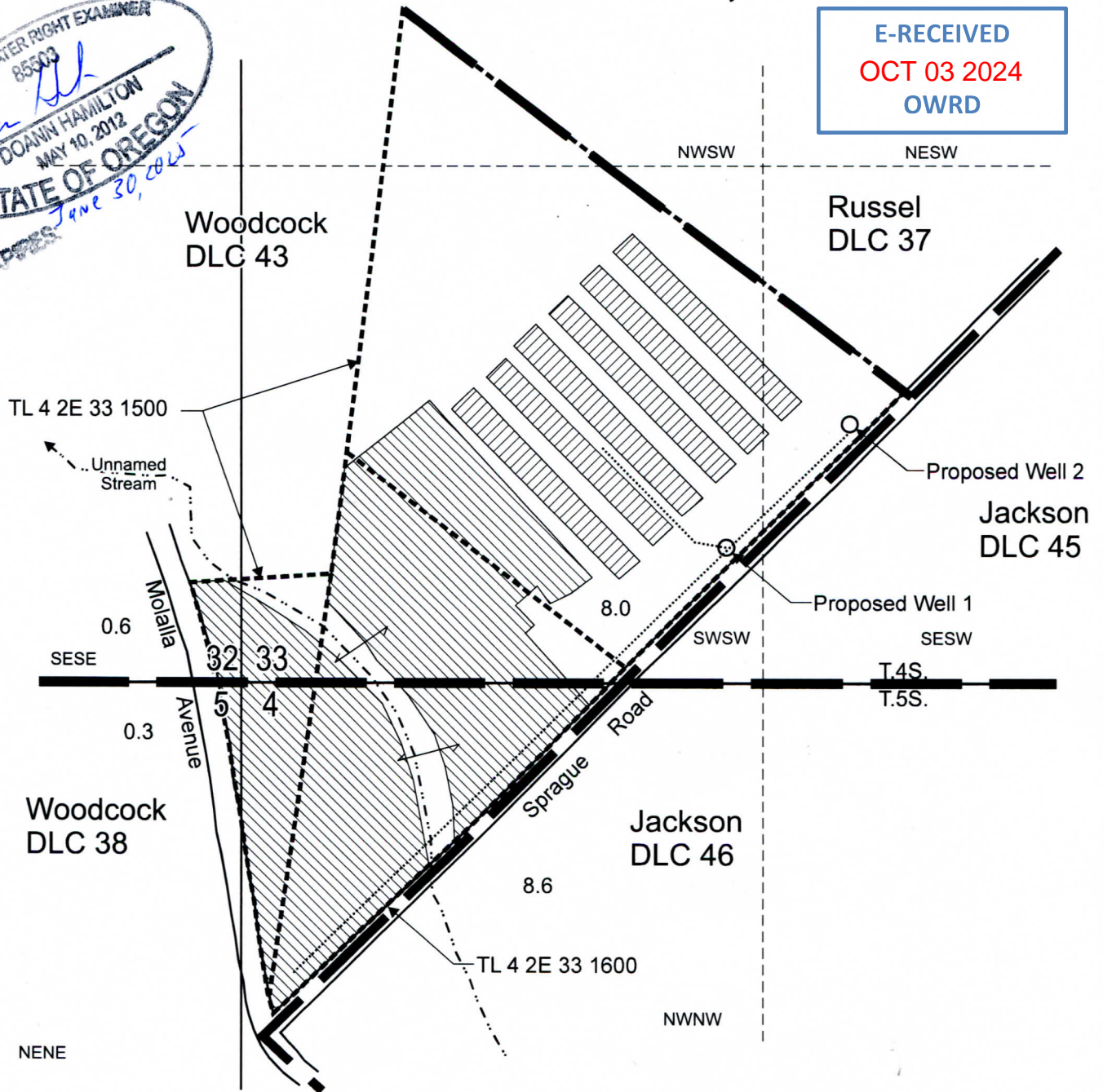

Proposed Well 1 is located 345 feet north and 1,230 feet east from the SW corner, Section 33.
Proposed Well 2 is located 660 feet north and 1,540 feet east from the SW corner, Section 33.

- Area (17.5 Acres) to be covered under nursery operations.
- Proposed Commercial Use
- Tax lot boundary
- Donation Land Claim boundary
- Water main line

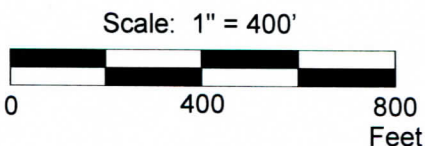

This map was prepared for the purpose of identifying the location of a water right only and is not intended to provide legal dimensions or location of property ownership lines.

Water Right Application Map

Pacific Hydro-Geology Inc.

02/2022
Rev. 09/2024
Rev2. 10/2024

Tuan Tiet
T.4S. R.2E. Sec. 32 & 33,
T.5S. R.2E. Sec. 4 & 5, W.M.