

83062

Permit No. _____

Certificate No. _____

97415

Stream Index, Page No. _____

See file P-74349

Date filed _____

Priority _____

Action suspended until _____

Return to applicant _____

Date of approval _____

CONSTRUCTION

Date for beginning _____

Date for completion _____

Extended to _____

Date for application of water _____

Extended to _____

PROSECUTION OF WORK

Form "A" filed _____

Form "B" filed _____

Form "C" filed _____

FINAL PROOF

Blank mailed _____

Proof received _____

Date Certificate issued _____

[illegible]

	Cert. Fee	

[illegible]

ASSIGNMENTS

Date:

To Whom

Address

Volume

Page

REMARKS



P 74349

Oregon Water Resources Department Notice of Exempt Reservoir

For reservoirs built before January 1, 1995, that:

- Store less than 9.2 acre-feet of water, or
- Have a dam less than 10 feet high.

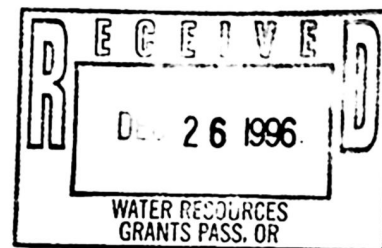

The deadline for submitting a Notice of Exempt Reservoir is January 31, 1997.

Landowner: CLEMENS, LELAND P. TRUSTS
Last name First name MIAuthorized Agent: _____
Last name First name MIAddress: P.O. BOX 6817
BROOKINGSCity OR State Zip 97415Phone: 541 469 6267FAX: (SAME AS ABOVE BUT WE MUST BE HOME) Home Work
E-Mail Address: CLEMENS@HARBORSIDE.COMA. County of use: CURRY B. River basin (see reverse): S. COAST

C. Legal description of reservoir location:

Township	Range	Section	Quarter/Quarter	Tax Lot #
41 S	12 W	7	1/4 GOV. LOT	00800

D. Name, if any, of reservoir: _____ E. Reservoir in existence since: DEEPEND IN 1992 ? 1 1 BUT
MM DD YYF. Source of water: SPRING which flows into WINCHUCK
Name of river or creek Name of river or creekG. Maximum height of dam: NO DAM feet.H. Quantity of water stored in reservoir at maximum capacity (see reverse): 0.8 acre-feet.I. Water stored in reservoir is used for (see reverse): ENVIRONMENTAL BENEFITS

J. Rate and area of use—Refer to chart on the back of this form. For each type of water use listed in Item I., show the quantity of water used and, if applicable, the number of acres on which water is used.

BEFORE YOU SIGN AND SUBMIT THIS APPLICATION... HAVE YOU:

- ☐ Answered each question on this form as completely as possible?
- ☐ Attached a legible map showing township, section, range, quarter-quarter & tax lot number?

By my signature below, I swear that all statements made and information provided in this application are true to the best of my knowledge.

Leland P. Clemens LELAND P. CLEMENS TRUSTEE 12/18/96
(Signature of Landowner/Agent) (Printed name and title) (Date)For Department Use P-83062 File # Date received 10-95

Oregon's major river basins:

- | | | |
|---------------|-----------------|--------------|
| 1-North Coast | 8-Grande Ronde | 15-Rogue |
| 2-Willamette | 9-Powder | 16-Umpqua |
| 3-Sandy | 10-Malheur | 17-S. Coast |
| 4-Hood | 11-Owyhee | 18-Mid Coast |
| 5-Deschutes | 12-Malheur L. | 19-Columbia |
| 6-John Day | 13-Goose/Summer | 20-Snake |
| 7-Umatilla | 14-Klamath | |

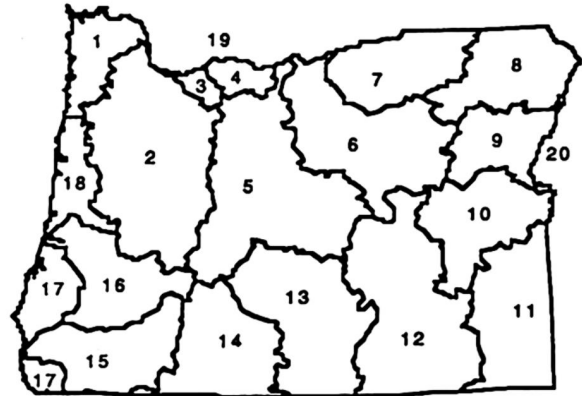

One acre-foot is the volume of water that would cover one acre with one foot of water. To find out how much water your pond stores, multiply the surface area by the average depth. This will give you a rough estimate of cubic feet. One acre-foot equals 43,560 cubic feet. You can submit a Notice of Exempt Reservoir if your pond stores less than 400,752 cubic feet $43,560 \times 9.2$.

Rate and Area of Use

cfs-cubic feet per second

gpm-gallons per minute

Agriculture, Land Management

Gen. Agriculture	cfs/gpm	# acres	Cranberry	cfs/gpm	# acres
Irrigation	cfs/gpm	# acres	Nursery Operatn.	cfs/gpm	# acres
Stockwater	cfs/gpm	# acres	Temp. Control	cfs/gpm	# acres
Aquatic Life	cfs/gpm	# acres	Forest/Range Mgt	cfs/gpm	# acres
Other:	cfs/gpm	# acres	Other:	cfs/gpm	# acres

Industrial/Commercial Uses

Industrial	cfs/gpm	_____	Commercial	cfs/gpm	_____
Fire Protection	cfs/gpm	_____	Mining	cfs/gpm	_____
Power Dev.	cfs/gpm	_____	Other:	cfs/gpm	_____

Drinking Water Supply

Human Consumption	cfs/gpm	_____	Domestic	cfs/gpm	_____
Domestic	cfs/gpm	_____	Other:	cfs/gpm	_____
Expanded	cfs/gpm	_____			

Community Water Supply

Municipal	cfs/gpm	_____	Quasi-Municipal	cfs/gpm	_____
Group Domestic	cfs/gpm	_____	Storm Water Mgt	cfs/gpm	_____
Other:	cfs/gpm	_____	Other:	cfs/gpm	_____

Environmental Benefits

Pollution Abatement	cfs/gpm	_____	Recreation	cfs/gpm	_____
Wetland Enhancement ✓	cfs/gpm	○	Wildlife ✓	cfs/gpm	○
Other: DESILTING	cfs/gpm	○	Other:	cfs/gpm	_____

NOTE =
 SEC. 7 IS WIDE
 SECTION, W GOVT
 LOTS ON WEST SIDE
 NO 1/4 1/4

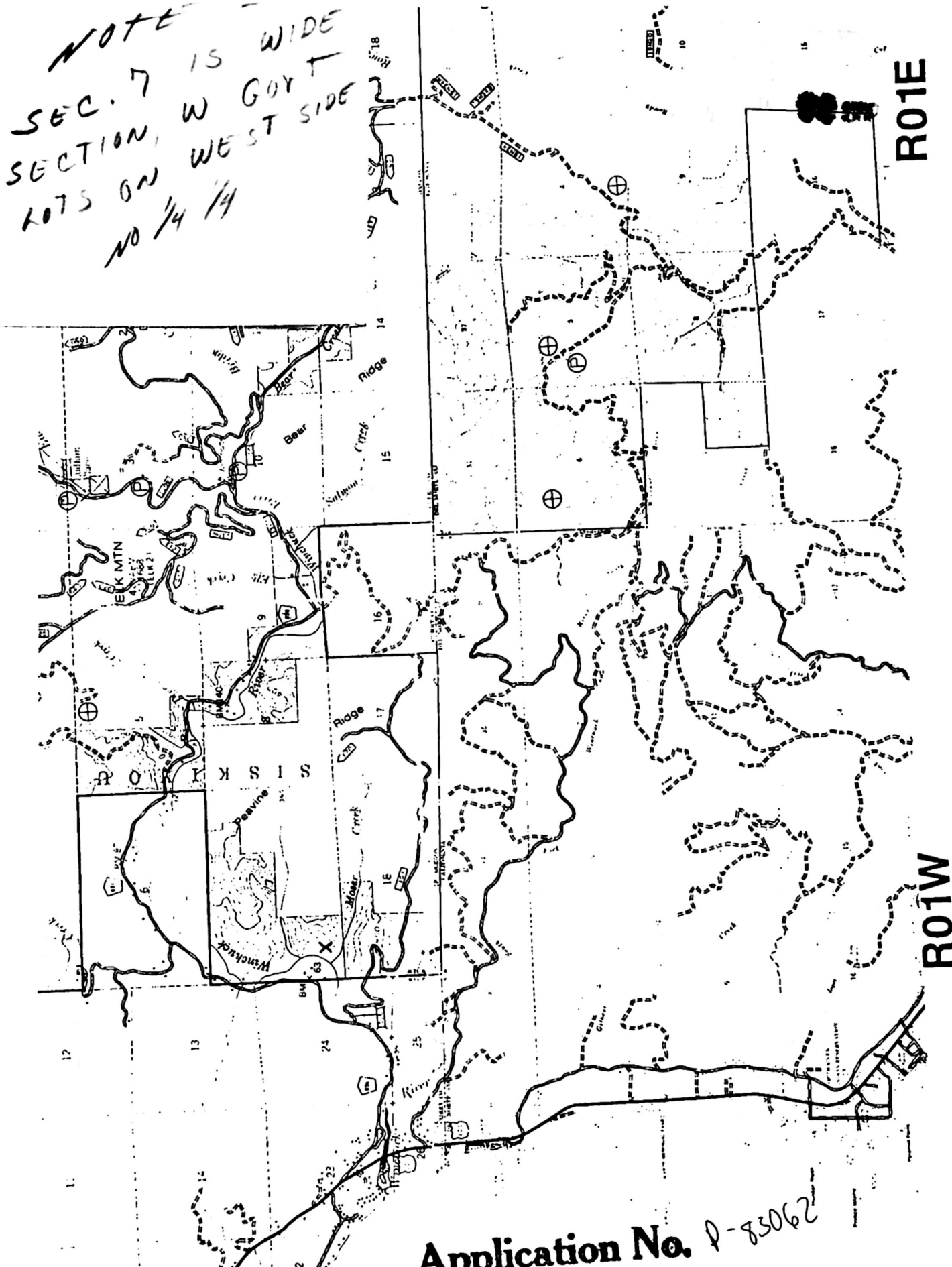

R01E

R01W

X = POND SITE

Application No. P-85062
 Permit No.

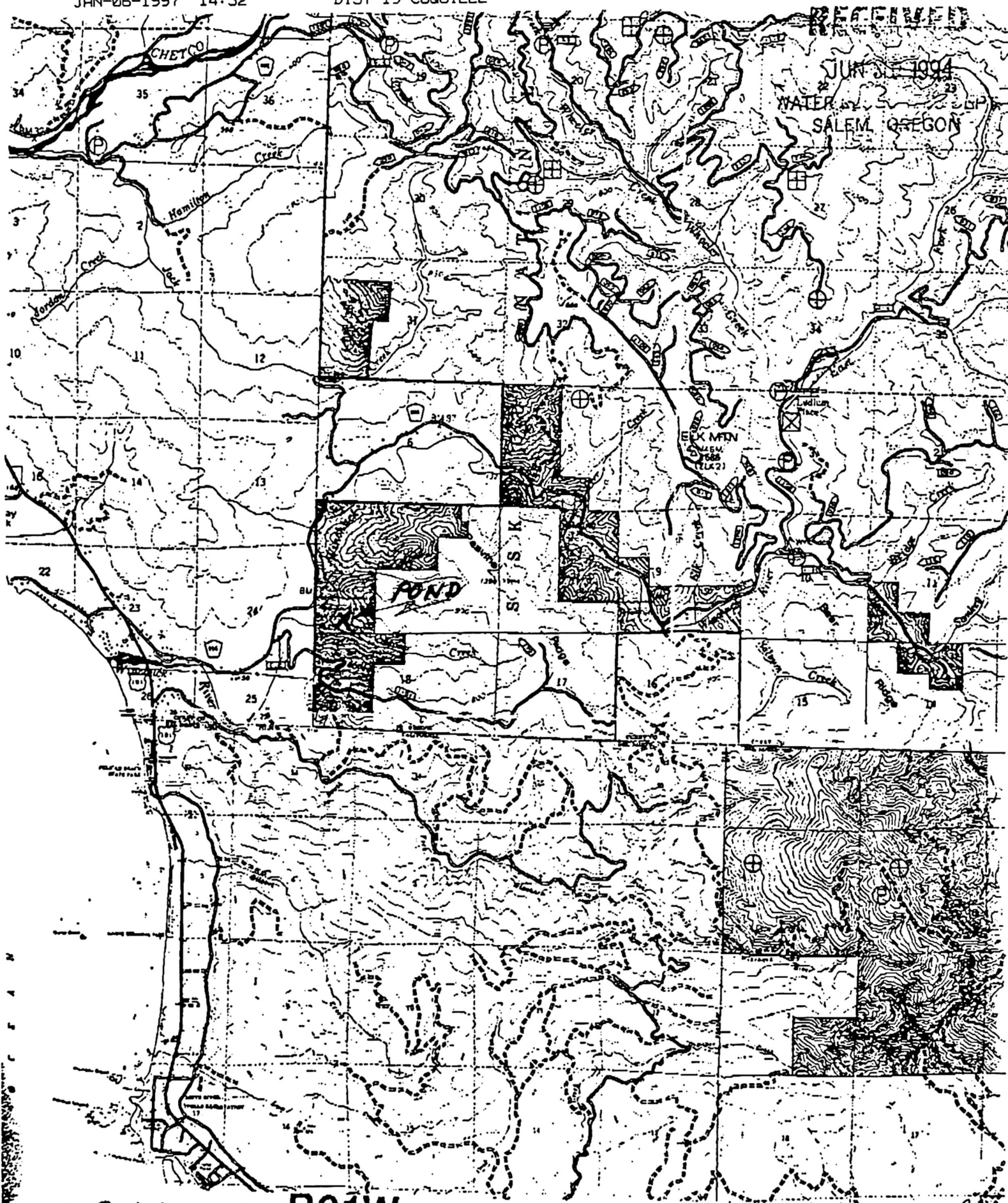

T41S; R12W, Sec 7H R01W

Tx Lt 800

X = POND SITE

Appli. #

P74349

Application No. P-83062

Permit No.

P7434



INTERIOR—GEOLOGICAL SURVEY

Permit No. _____

8-83062



P74349

HB 2376 EXEMPT NOTICE
COMPLETENESS CHECKLIST

- ☒ Landowner name and address*
- ☒ A. County of use
- ☒ B. River basin
- ☒ C. Legal description of reservoir location*
(Includes quarter-quarter section and tax lot)
- ☒ D. Reservoir name
- ☒ E. Date of construction
- ☒ F. Source of water and tributary*
- ☒ G. Dam height
- ☒ H. Quantity of water stored*
- ☒ I. Use of water
- ☐ J. Rate and area of use (if any)
- ☒ Signature of Landowner/agent
- ☒ Map showing Township, Range, Section, Quarter-quarter section and Tax Lot* and general location of pond.

(HB 2153 P74349)

Date Received 12/26/96Received By Lou

* MINIMUM REQUIREMENT TO FILE

C:\wp51\pondchk