

**T16S R10E, WM
DESCHUTES COUNTY, OR**

E-RECEIVED
October 4, 2022
OWRD

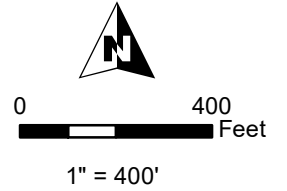
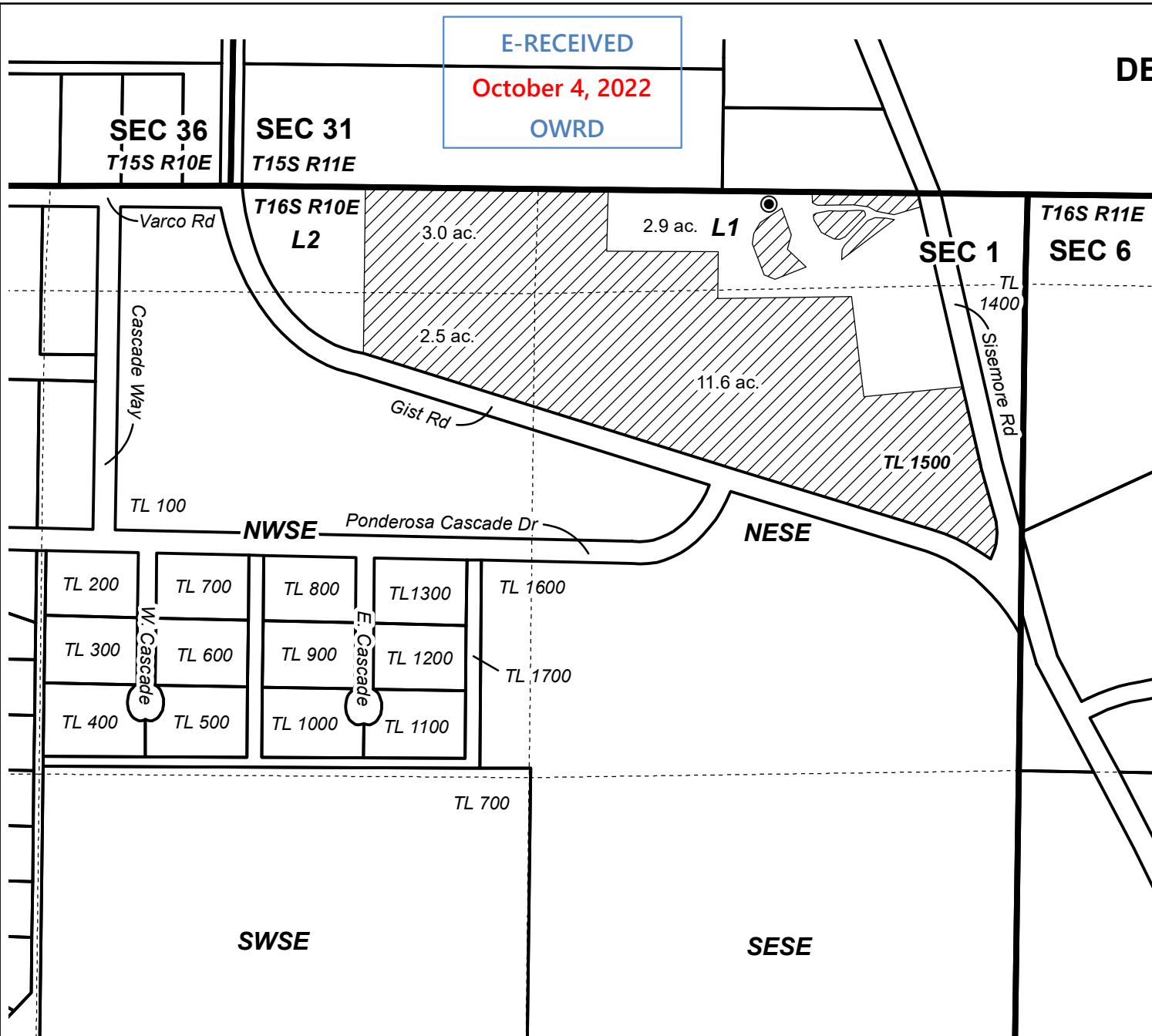

- Well
- POU IR
- Township
- Section
- Quarter Quarter
- Tax Lot

Well Location:
30' S, 700' W of NE Cor Sec 1
T16S R10E, W.M.



**GROUNDWATER APPLICATION MAP
NANCY KERKVLIT**

Date: 10/4/2022

This map is not intended
to provide legal dimensions
or locations of property
ownership lines.

WATER RIGHT SERVICES, LLC
PO BOX 1830, BEND, OR 97709
WWW.OREGONWATER.US CCB # 197121
johnshort@usa.com 541-389-2837