

An open pond (dug sump) irrigates 7.16 acres near ^(Chico River mouth) Pacific Ocean in Curry County.

STATE OF OREGON

COUNTY OF

CURRY

CERTIFICATE OF WATER RIGHT

This Is to Certify, That

GENEVRA E. LINDEBORG

of Rt. 1, Box 31, Brookings , State of Oregon 97415 , has
a right to the use of the waters of Harbor Ground Water Reservoir through a well.

a tributary of -----

irrigation of 6.0 acres

for the purpose of

and that said right has been confirmed by decree of the Circuit Court of the State of Oregon for
Curry County, and the said decree entered of record at Salem, in the Order Record of
the WATER RESOURCES DIRECTOR, in Volume 18 , at page 264 ; that the priority of the right
thereby confirmed dates from 1952

that the amount of water to which such right is entitled, for the purposes aforesaid, is limited to an
amount actually beneficially used for said purposes, and shall not exceed 0.075 cubic foot per
second.

The point of diversion is located in the NW $\frac{1}{4}$ SW $\frac{1}{4}$, as projected within J. Taggart DLC 40,
Section 9, T. 41 S., R. 13 W., W.M. Well located 440 feet North and 1980 feet
West from the SE corner J. Taggart DLC 40.

A description of the place of use under the right, and to which such right is appurtenant, is as
follows:

6.0 acres NW $\frac{1}{4}$ SW $\frac{1}{4}$
as projected within J. Taggart DLC 40
Section 9
T. 41 S., R. 13 W., W. M.

And said right shall be subject to all other conditions and limitations contained in said decree.
The right to the use of the water for the purposes aforesaid is restricted to the lands or place of use herein
described.

WITNESS the signature of the Water Resources Director, affixed

this date

November 25 , 19 80

Water Resources Director

Recorded in State Record of Water Right Certificates, Volume 43 , page 49753

Name and Postoffice Address of Appropriator	Date of Relative Priority	Amount Cubic Feet Per Second	Number Acres	Use	Name of Ditch	Stream	Description of Land or Place of Use
¹⁵¹ ANDERSON, V. E. P. O. Box 2033 Harbor, Oregon 97415 (Proof No. 1) (See Finding 15)	July 1951	0.13 (58 gpm)	10.4	Irrigation	Well and pump	Harbor Ground Water Reservoir	10.4 acres NW $\frac{1}{4}$ SE $\frac{1}{4}$ as projected within E. O'Laughlin DLC 42 Section 9 T. 41 S., R. 13 W., W.M.
¹⁵² HASTINGS BULB GROWERS, INC. by President Robert K. Hastings P. O. Box 2155 Harbor, Oregon 97415 (Proof No. 2) (See Finding 16)	July, 1955	0.178 (80 gpm)	23.1	Irrigation	Well and pump	Harbor Ground Water Reservoir	0.2 acre NW $\frac{1}{4}$ NW $\frac{1}{4}$ 19.7 acres SW $\frac{1}{4}$ NW $\frac{1}{4}$ 0.8 acre SE $\frac{1}{4}$ NW $\frac{1}{4}$ 2.4 acres NW $\frac{1}{4}$ SW $\frac{1}{4}$ all as projected within R. Johnson DLC 43 Section 15 T. 41 S., R. 13 W., W.M.
¹⁵³ LINDEBORG, Genevra E. Rt.1, Box 31 Brookings, Oregon 97415 (Proof No. 3) (See Finding 17)	1952	0.075 (34 gpm)	6.0	Irrigation	Well and pump (dug 5 feet deep 40x50 feet)	Harbor Ground Water Reservoir	6.0 acres NW $\frac{1}{4}$ SW $\frac{1}{4}$ as projected within J. Taggart DLC 40 Section 9 T. 41 S., R. 13 W., W.M.
¹⁵⁴ PENTER, Gerald E. and June Rt.1, Box 52-B Brookings, Oregon 97415 (Proof No. 4) (See Finding 18)	July 1954 T-4517	0.075 (34 gpm) P.Q.A.	6.0	Irrigation	Well and pump	Harbor Ground Water Reservoir	3.2 acres SE $\frac{1}{4}$ SW $\frac{1}{4}$ 2.8 acres SW $\frac{1}{4}$ SE $\frac{1}{4}$ both as projected within T. Sharp DLC 41 Section 9 T. 41 S., R. 13 W., W.M.
¹⁵⁵ RIGDON, Isabelle P.O. Box 2436 Harbor, Oregon 97415 (Proof No. 5) (See Finding 19)	October 1951	0.111 (50 gpm)	11.3	Irrigation	Well and pump	Harbor Ground Water Reservoir	5.8 acres SW $\frac{1}{4}$ NW $\frac{1}{4}$ as projected within R. Johnson DLC 43 Section 15 5.5 acres Lot 3 (SE $\frac{1}{4}$ NE $\frac{1}{4}$) Section 16 T. 41 S., R. 13 W., W.M.
¹⁵⁶ ROSE, Antone G. and Joan M. P.O. Box 2043 Hwy. 101-S Harbor, Oregon 97415 (Proof No. 6) (See Finding 20)	1944	0.171 (77 gpm)	13.7	Irrigation	Well and pump (dug 26 feet deep 5x6 feet)	Harbor Ground Water Reservoir	0.4 acre SW $\frac{1}{4}$ SE $\frac{1}{4}$ 9.8 acres SE $\frac{1}{4}$ SE $\frac{1}{4}$ both as projected within T. Sharp DLC 41 Section 9 3.5 acres Lot 4 (NW $\frac{1}{4}$ NE $\frac{1}{4}$) Section 16 T. 41 S., R. 13 W., W.M.
¹⁵⁷ STRAHM, Harve Joel P.O. Box 2216 Harbor, Oregon 97415 (Proof No. 7) (See Finding 21)	Aug. 10, 1952	0.121 (54 gpm)	9.7	Irrigation	Well and pump (dug 23 feet deep 20 x 30 feet)	Harbor Ground Water Reservoir	2.8 acres Lot 2 (SW $\frac{1}{4}$ SW $\frac{1}{4}$) 1.5 acres Lot 2 (SE $\frac{1}{4}$ SW $\frac{1}{4}$) 5.4 acres SE $\frac{1}{4}$ SW $\frac{1}{4}$ as projected within T. Sharp DLC 41 Section 9 T. 41 S., R. 13 W., W.M.
¹⁵⁸ WATT, Cecil 707 Wedgewood Lane Rt. 1 Brookings, Oregon 97415 (Proof No. 8) (See Finding 22)	May, 1948	0.148 (66 gpm)	11.8	Irrigation	Well and pump	Harbor Ground Water Reservoir	1.8 acres SW $\frac{1}{4}$ SW $\frac{1}{4}$ as projected within T. Sharp DLC 41 1.8 acres SW $\frac{1}{4}$ SW $\frac{1}{4}$ as projected within E. O'Laughlin DLC 42 Section 10 6.3 acres NW $\frac{1}{4}$ NW $\frac{1}{4}$ as projected within E. O'Laughlin DLC 42 1.9 acres NW $\frac{1}{4}$ NW $\frac{1}{4}$ as projected within R. Johnson DLC 43 Section 15 T. 41 S., R. 13 W., W.M.

The Water Resources Department classified 23.1 acres of lily bulbs as irrigated, being 0.2 acres in the NW $\frac{1}{4}$ NW $\frac{1}{4}$, 19.7 acres in the SW $\frac{1}{4}$ NW $\frac{1}{4}$, 0.8 acre in the SE $\frac{1}{4}$ NW $\frac{1}{4}$, 2.4 acres in the NW $\frac{1}{4}$ SW $\frac{1}{4}$, Section 15, Township 41 South, Range 13 West, W. M. Water is diverted from a drilled 8 inch diameter cased well with a Johnson 2 $\frac{1}{2}$ inch discharge turbine pump, powered with a 5 horsepower electric motor. The well is located 1030 feet north and 2300 feet west from the SE corner, R. Johnson D.L.C. No. 43, being within the SW $\frac{1}{4}$ NW $\frac{1}{4}$, as projected within the R. Johnson D.L.C. No. 43, Section 15, Township 41 South, Range 13 West, W. M. The distribution system consists of 440 feet of 5 inch diameter aluminum pipe, 5200 feet of 4 inch diameter pipe, 3960 feet of 3 inch diameter aluminum pipe, and 35 Rainbird No. 30 sprinklers with 5/32 inch nozzles, 15 Rainbird No. 30 sprinklers with 1/8 inch nozzles, and 33 Rainbird No. 40 sprinklers with 5/32 inch nozzles. A maximum of 15 sprinklers are operated at one time. The ground elevation at the well site is 87.95 feet. The reported number of acres irrigated in one irrigation season is one-half the claimed acreage or 11.6 acres.

It appears this claimed right should be limited to a rate of diversion of not to exceed 0.178 cubic foot per second (80 gallons per minute) of ground water for irrigation of 23.1 acres with a date of priority of July, 1955. Any other use of water the claimant may have referred to in his claim is hereby denied as the claimant did not make a specific claim for use. Any other use of water (farm purposes or processing planting stock) other than irrigation would be an exempt use not requiring a filing for a right in an amount not exceeding 5 thousand gallons per day for any single industrial or commercial purpose under ORS 537.545. Claimant's rights are more particularly set out and described in the tabulation of water rights under finding 36 herein.

-17-

GENEVRA E. LINDEBORG

The Registration Statement was filed under Registration No. GR-84 in the name of Tony Olsen and Clara E. Olsen, claiming an appropriation of 1.0 cubic foot per second for the irrigation of 7.16 acres within the NW $\frac{1}{4}$ SW $\frac{1}{4}$, Section 9, Township 41 South, Range 13 West, W. M. for which Certificate of Registration No. GR-71 was issued. Construction work is claimed to have begun in 1952. The use of water is described as being from a dug sump well 50 feet long, 40 feet wide, and 5 feet deep, located 800 feet south and 1075 feet east from the west $\frac{1}{4}$ corner, Section 9, being within the NW $\frac{1}{4}$ SW $\frac{1}{4}$, Section 9, Township 41 South, Range 13 West, W. M. The sump or infiltration trench is described as being open.

Genevra E. Lindeborg of Route 1, Box 31, Brookings, Oregon submitted proof No.3, claiming a right to the use of the ground waters of Harbor Reservoir under an initiation date of 1952 for 120 gallons per minute through a dug sump well 50 feet long, 40 feet wide, and 5 feet deep, located within the NW $\frac{1}{4}$ SW $\frac{1}{4}$, Section 9, Township 41 South, Range 13 West, W. M. The use claimed is for irrigation of 6 acres of lily bulb crops, strawberries, potatoes, and corn, located in the NW $\frac{1}{4}$ SW $\frac{1}{4}$ of the said section. The claimant lists the well capacity as 450 gallons per minute.

The Water Resources Department classified 6 acres of lily bulbs as irrigated within the NW $\frac{1}{4}$ SW $\frac{1}{4}$, Section 9, Township 41 South, Range 13 West, W. M. Water is diverted from a dug sump well 50 feet long and 40 feet wide and 5 feet deep with an electric 3 horsepower 2 X 2 $\frac{1}{2}$ inch centrifugal pump. The sump well is located 440 feet north and 1980 feet west from the SE corner, J. Taggart D.L.C. 40, being within the NW $\frac{1}{4}$ SW $\frac{1}{4}$, Section 9, Township 41 South, Range 13 West, W. M. Water is pumped through 750 feet of 3 inch diameter aluminum pipe, 780 feet of 2 inch diameter aluminum pipe, and 14 Rainbird No. 30 sprinklers with 5/32 X 3/32 inch nozzles. All 14 sprinklers are operated at one time. The ground elevation at the well site is 81.12 feet. One-half of the 6 acres is said to be the average acreage irrigated in any one irrigation season.

It appears this claimed right should be limited to a rate of diversion of not to exceed 0.075 cubic foot per second (34 gallons per minute) of ground water for irrigation of 6 acres with a date of priority of 1952. Claimant's rights are more particularly set out and described in the tabulation of water rights under finding 36 herein.

-18-

GERALD E. & JUNE PENTER

The Registration Statement was filed under Registration No. GR-4108 in the name of E. L. Rigdon, claiming an appropriation of 90 gallons per minute for the irrigation of 6 acres, being 2 acres in the SE $\frac{1}{4}$ SW $\frac{1}{4}$, 4 acres in the SW $\frac{1}{4}$ SE $\frac{1}{4}$, Section 9, Township 41 South, Range 13 West, W. M. for which Certificate of Registration No. GR-3694 was issued. Construction work is claimed to have begun in June 1954. The use of water is described as being from a drilled well 69 feet deep, 8 inches in diameter, located 40 feet southwest from D.L.C. 40 being within SW $\frac{1}{4}$ SE $\frac{1}{4}$, Section 9, Township 41 South, Range 13 West, W. M. The well casing is described in the Registration Statement as being perforated from 40 feet to 69 feet.

Gerald E. & June Penter of Route 1, Box 52-B, Brookings, Oregon submitted proof No. 4 claiming a right to the use of the ground waters of Harbor Reservoir under an

RECEIVED

JAN 18 1956
STATE ENGINEER
SALMON, OREGON

REGISTRATION NO. GR-84

DATE NO. GR-71

Registration Statement

OF CLAIMANT OF RIGHT TO APPROPRIATE GROUND WATER

(Under Chapter 708, Oregon Laws 1955.)

TO THE STATE ENGINEER OF OREGON:

I, Tony Olsen and Clara E. Olsen

of Harbor County of Curry

State of OREGON, do hereby make application for a certificate of registration as evidence of a right to appropriate ground water.

1. Source from which water is withdrawn is in infiltration to open pond
(Flowing well, pump well, infiltration trench, or tunnel)

2. Location is: 3 Miles from Brookings Ore
(Approximate distance and direction from nearest city or town)

and is more particularly described as follows:

In Donation Land Claim No. 40

(a) South 800.0 feet and East 1075.0 feet from the 1/4 section corner on the West side of Section
being within NW 1/4 of the SW 1/4 of Sec. 9, Twp. 41 S, Rge. 13 W
(Smallest legal subdivision) (N. or S.) (E. or W.)

or (b) within limits of recorded platted property, town or city:

in Lot _____, Block _____ of _____
(Name of plat or addition)

County of _____
(If within city or town, give name)

3. Construction Work was begun on 1952; was completed on 1952
(Date) (Date)

and the ground water claimed was first used for the purposes set out below on 1952
(Date)

since which time the water has been used During fall growing season only
(Continuously or intermittently)

from 1952 to Dec. 1955
(Date) (Date)

4. Quantity of water claimed and used is 10 G.F.S. during irrigating periods
feet per year, (gallons per minute)

5. Purpose or Purposes for which water is used Irrigation. Commercial plantings of lily bulbs etc.
(Domestic, irrigation, municipal, manufacturing, industrial, etc.)

6. Description of Well: Depth None feet. Type Dug Sump
(Dug or drilled)
diameter _____ inches. Elevation of ground at well site 100 feet, mean sea level
(As near as known)
Depth to water table _____ feet.

7. Capacity of Well: _____ g.p.m. with _____ feet drawdown
_____ g.p.m. with _____ feet drawdown

Date of test _____

If Flowing Well: Measured discharge _____ g.p.m. on _____
(Date)

Shut-in pressure at ground surface _____ lbs. per sq. in. on _____
(Date)

Water is controlled by _____
(Cap, valve, etc.)

inch diameter None from to feet

inch diameter from to feet

inch diameter from to feet

inch diameter from to feet

Describe and show depth of shoe, plug, adapter, liner or other details:

9. Perforated Casings or Screens:

None from to
(Number per foot and size of perforations, or describe screen) from to
from to
from to
from to

10. Log of Well: (Describe each stratum or formation clearly, indicate if water bearing, and give thickness and depth as indicated.)

[illegible]

GR- 71 A

If log of well is not available, give name and address of driller. _____

11. Infiltration Trench: Covered or open OPEN

Dimensions: Length 50 ft. Minimum depth 5 ft. Maximum depth ft.

Bottom width 40 ft. Discharge 450 g.p.m. Date of test none

12. Tunnel: Type of lining —

Dimensions: _____
(Length, course, and cross sectional size)

Position of water bearing stratum with reference to portal of tunnel

Log of tunnel: (Preceding table for log of well may be used, if desired. Give footage from portal and character of materials, as pertinent.)

- ### 13. Pumping Equipment:

(a) Pump 3" Centrifugal Capacity _____ g.p.m.

(b) Motor 5 H.P. Electric single phase

14. Location of area irrigated or to be irrigated, or place of use if for purposes other than irrigation.

[illegible]

15. If the ground water supply is supplemental to an existing water supply, identification of any application for a permit, permit, certificate or adjudicated right to appropriate water made or held by the registrant

Township 41 S Range 18 W W.M.
North

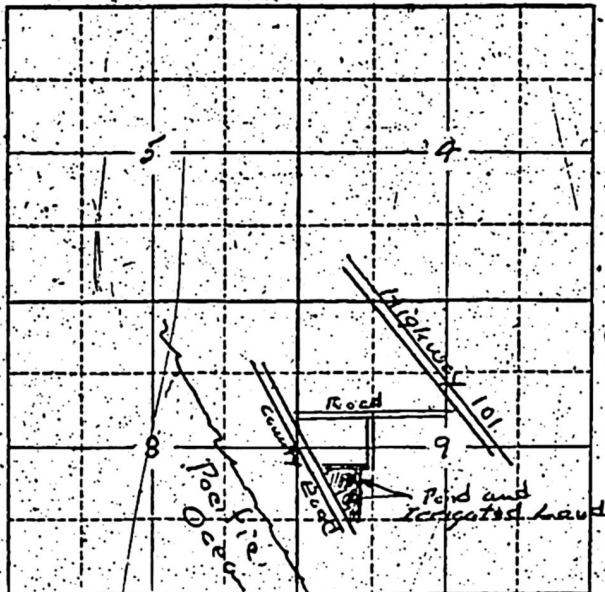

Locate well and acreage of irrigated land on plat.
Scale: 2" = 1 Mile

STATE OF OREGON

County of Curry

I, Tony Olsen and Clara E. Olsen, being first duly sworn, do hereby certify that I have read the foregoing Registration Statement and that all of the items therein contained are true to the best of my knowledge and belief.

Tony Olsen
Clara E. Olsen
(Signature of Registrant)

Subscribed and sworn to before me this 5 day of January, 1956

My commission expires Apr 7 1958

Harriet E. Payne
(Notary Public)

(SEAL)

CERTIFICATE OF REGISTRATION

STATE OF OREGON

County of Marion

This is to certify that the foregoing Registration Statement was received in the office of the State Engineer on the 10th day of January, 1956, at 8:00 o'clock A. M. and has been duly recorded in said office in Book No. 1 of Registration Statements on page 71

Construction shall be completed by 1956, and the water completely applied to beneficial use by 1956

Witness my hand this 24th day of February, 1956

Elmer A. Stanley
(State Engineer)

By _____
(Deputy)

GR-71 C

June 13, 1958

Mr. Tony Olsen
Harbor, Oregon

Dear Mr. Olsen:

Pursuant to your request enclosed is an application blank and a copy of the Rules and Regulations of the State Engineer, in which you will find instructions for preparing the application, requirements of the accompanying map and a complete list of the statutory fees.

I believe that if you have a properly written right of way easement and rental agreement concerning use of the water you could protect yourself against a permanent right. For added protection I believe the permit should be taken out in your name and should not be allowed to ripen into a certificate, but that you should authorize its cancelation prior to that time.

This would be simple enough to take care of providing the use did not exceed two years.

For full information regarding the possibility of securing a permanent right of way and for assistance in having such an agreement written, I can only suggest that you contact your attorney.

Very truly yours,

LEWIS A. STANLEY
State Engineer

By
Chris L. Wheeler, Assistant

CLW:eh
enclosures - 2

File # Gr-84 Tony Olsen & Ethel Olsen

Harbor, Oregon.
June 5, 1958.

State Water Dept.
State Engineer
Attention Trevor Jones
Salem, Oregon.

Dear Mr. Jones.

Received your answer to my letter in regard to letting my neighbor temporarily using my sump for irrigating his lillies for the year 1958 and presumably 1959. By that time he should be able to build his own sump or something on his own place.

I would be willing to give him a permit or I mean get a permit so I could let him have water for that length of time if it would not obligate me to give him water for any longer period of time. There was to be no charge for this water only one dollar to bind the obligation if it can be done with out endangering my own water right or making me become liable for furnishing water to him in case he does not go ahead and make other arrangements later as he has agreed to do.

I am writing to the state district attorney to see where and how I can find out my water rights and how this could be done so as not to by accident give him leaway for asking or trying to force a permanent use of water as there is not enough here. I just am not using it this year as my ground is resting after having been planted for several years and as a neighbor I would be willing to let him use it under this temporary set up.

There would not hardly be as much water used as I was in the habit of using as he only has a little over two acres; they would not water any oftener than I did as it is the same type crop and over watering damages the bulbs.

Would you please send me the papers to fill out for the permit and by that time I probably will have heard how I can go about the pipe line situation to protect myself.

Yours truly,

Tony Olsen

June 3, 1958

Mr. Tony Olsen
Harbor
Oregon

Dear Mr. Olsen:

I assume the pond you refer to in your letter dated May 27, 1958, is that described in your Ground Water Registration Certificate GR-71.

To irrigate any additional land from the sump other than that irrigated prior to August 3, 1955, would require a permit from the State Engineer to appropriate ground water. Any arrangement you make with your neighbor as to crossing your land with a pipe line is not within the jurisdiction of the State Engineer. To legally appropriate either ground or surface water for irrigation as described would require a permit.

Very truly yours,

LEWIS A. STANLEY
State Engineer

By
Trevor Jones, Assistant

TJ:pm

CR-84

Harbor, Oregon.
May 27, 1958.

State Water Department.
Salem, Oregon.

RECEIVED
MAY 28 1958
STATE WATER DEPARTMENT
SALEM, OREGON

Gentlemen:

I would like to have what information you can give me about use of my water pond which I use for my own irrigation of my nine and a half acre place.

I do not wish to lose any of my water rights as the pond is only large enough for very limited irrigation five or six times during the year and is ordinarily used altogether by me.

This year I have a neighbor who was going to make arrangements to water with another man but they had some kind of difficulty and it did not work out. Will it affect my water rights in any way if I let him use water from my pond this one year till he can work out some pond on his own place. There seems to have been some arguments arise over such situations and I do not have enough for here; but this year I was not planning on using the water and because he has not made his own arrangements for digging his own pond earlier, as he should have, it is now quite late for him to get it done to use this year. Whether there was some reason about water rights that entered into the picture that stopped him from working with other neighbor I do not know. I have been told that he has not always been to straight forward in some deals but this could be true or headway. I like to keep on a friendly basis with neighbors even though we have no social relation with them.

I did want to protect my rights in every way I could and if I let him use the water should there be some kind of charge for my protection or just a drawn up agreement that I am for neighborly reasons letting him have water for this summer. I wondered to about letting him put his movable pipe across my land from the road and into the pond with his own pump as that was what he wishes to do. This pond fills in from spring on my place which is separated from him by another neighbor and he is also on opposite side of road from my place. This pond only fills in fast enough to irrigate five or six acres five or six times between May and September so you can see it is not large enough only for minor irrigation and would not be large enough to lose any water right in it.

5106

I did not know where to inquire otherwise and be sure that it was correct.

Yours truly,

Wm. Olsen

February 25, 1956

Mr. Tony Olsen
Harbor
Oregon

Dear Mr. Olsen:

Enclosed find Certificate of Registration No. CR-84
Registration Statement No. CR-71
Annual Well Report Form

PLEASE READ CAREFULLY THE FOLLOWING INSTRUCTIONS:

Your Registration Statement and the attached Certificate of Registration have been recorded in this office. You should hold this original document as evidence of your claim for water rights.

The Registration Statement and the Certificate of Registration is each a part of the same document. The Certificate of Registration is found on the last page of the Registration Statement.

As provided in ORS 537.610, you, the registrant, are now, prima facie, entitled to the right to appropriate the ground water and apply it to beneficial use to the extent and in the manner disclosed in the recorded Registration Statement until such time as the final water rights are determined by adjudication.

Each holder of a Certificate of Registration is required by law to file an annual well report with this office. This report must give water level measurements, an estimate of the quantity of water pumped, and other information concerning our ground-water resources. For your convenience, we are transmitting a report form so that you will be able to record the necessary information as it is obtained. These reports must be filed at the end of the water year, September 30, 1956. Additional report forms for next year will be mailed to you at a later date.

If your land is sold, an assignment of this registration document to the new owner should be recorded in this office. Assignment blanks will be furnished upon request.

Very truly yours,

Lewis A. Stanley

LEWIS A. STANLEY
State Engineer

January 19, 1956

Mr. Tony Olsen
Box 34
Harbor, Oregon

Dear Mr. Olsen:

This will acknowledge receipt of your well registration statement and checks for fees in the amount of \$15.00. Please find enclosed our receipt No. 5826 for the above amount.

Your statement is in good form and has been filed with others awaiting certification.

Very truly yours,

LEWIS A. STANLEY
State Engineer

By
Wm. S. Bartholomew
Geologist

WSB:bw
Enc. 1



STATE OF OREGON

STATE ENGINEER
WATER RESOURCES DEPARTMENT
SALEM

January 11, 1956

REFER TO
FILE NO. _____

Mr. Tony Olsen
Box 34
Harbor, Oregon

Dear Mr. Olsen:

This office is in receipt of your registration statement and check No. 96-177 in the amount of \$5.00. We are unable to hold or assign your registration statement a registration number without receipt of the required \$15.00 fee. For your registration, this fee is determined as follows:

Examination fee.\$10.00
Recording fee.	5.00
Total fee.\$15.00

Please find enclosed a copy of Rules and Regulations. This booklet contains information pertaining to the use of ground water and related fees.

It is best to keep the statement and fees together; therefore, we are returning both of these items to you. We ask that you resubmit the statement with your \$15.00 fee to this office, and upon receipt we will issue your Certificate of Registration.

Very truly yours,

LEWIS A. STANLEY
State Engineer

Wm. S. Bartholomew

By
Wm. S. Bartholomew
Geologist

RECEIVED
JAN 18 1956
STATE ENGINEER
SALEM, OREGON

WSB:bw
Encl.

Dear Sir,

*Sorry about this some one told us. it was 5.00 and I made
out a check for that, and after I got your letter I found it on the
desk and I was with checker Tony Olsen
Hart*

January 11, 1956

Mr. Tony Olsen
Box 34
Harbor, Oregon

Dear Mr. Olsen:

This office is in receipt of your registration statement and check No. 96-177 in the amount of \$5.00. We are unable to hold or assign your registration statement a registration number without receipt of the required \$15.00 fee. For your registration, this fee is determined as follows:

Examination fee.\$10.00
Recording fee.	5.00
Total fee.\$15.00

Please find enclosed a copy of Rules and Regulations. This booklet contains information pertaining to the use of ground water and related fees.

It is best to keep the statement and fees together; therefore, we are returning both of these items to you. We ask that you resubmit the statement with your \$15.00 fee to this office, and upon receipt we will issue your Certificate of Registration.

Very truly yours,

LEWIS A. STANLEY
State Engineer

By
Wm. S. Bartholomew
Geologist

WSB:bw
Encl.

Application No. GR-84
Permit No. _____
Reg. Certificate No. GR-71
Well No. 1

1954

ANNUAL REPORT ON WELLS

(ORS 537.715 requires that an annual report for each well be submitted to the State Engineer, Salem, Oregon)

Report covers period from October 1 to September 30 of following year.

1. Have any changes been made in the well or pump during the past year? _____
If so, explain: No
2. What was the maximum pumping rate at any time during the past year? 100 gpm
Date June 1 - 54 Observed drawdown 3 ft feet
3. In your opinion is the level of water in this well affected by other pumping operations in your vicinity? No Explain: This is a Pond
Unbonded 40 ft wide a 60 ft long fed by springs on mountain
4. If an irrigation well, how many acres were irrigated this past season? 3 aacs
What date did pumping begin? June Cease? Sept 1 - 54
Number of days of pump operation 10 Average pumping rate 100 gpm
Depth to water while pumping, _____ feet below land surface. Date _____
5. Power consumption for entire year or season about 3000 kWh Kwh
6. Quantity of water pumped during year or season about 6000 (gallons or acre-feet)
7. What was the cost of pumping per acre irrigated? _____
8. Do you consider use of water from this source profitable? Yes
9. Will you operate this well next season? Yes
10. Measured water levels (one measurement in spring and one in fall)
_____ feet below land surface. Date of measurement June 1 - 54
_____ feet below land surface. Date of measurement Sept 1 - 54
Additional water level measurements:

Feet below land surface	Date	Remarks
_____	_____	_____
_____	_____	_____
_____	_____	_____
11. Remarks: We paid 37.50 for turning on the Elsie and we use about 19 dollars worth the monthly bill 8.625 gas as much as I know we got 3 bills and that is taken out of the 37.50. so that is about 19 worth
We thought we irrigated a bout 10 acres and about 6 hrs at a time
Date Dec 21
Report prepared by Tony + Ethel Olsen

(See other side)

ATTENTION WELL OWNERS

Ground water is one of our most valuable resources, and you, the well owner, have a personal responsibility in helping to preserve these resources so that they will still be available for future generations. Your most important duty in this regard is the keeping of accurate records of changes in water levels, quantities of water pumped, and all other changes in the characteristics of our ground-water resources. It is chiefly through your observations that we know what is happening and are able to prevent depletion or contamination of our ground-water supplies.

The measurement of water levels in wells is the only way we can tell if the ground-water resources of an area are being depleted. For that reason, water level measurements given in your annual reports should be as accurate as possible.

We will be glad to supply you with any information we have in regard to methods of measuring water levels, or in measuring quantities of water pumped. Your cooperation in making the annual well report a document of value will be greatly appreciated.

8 R-84

November 16, 1955

Mr. T. Olsen
Harbor
Oregon

Dear Mr. Olsen:

Persuant to your request of November 9, 1955
we are transmitting herewith a Registration Statement
and a sheet of instructions.

Very truly yours,

Lewis A. Stanley
State Engineer

By

Wm. S. Bartholomew
Geologist

WSB:pb

Enc.

Harba, Oregon

State Engineer of Oregon
Hon Sir

RECEIVED
JUL 1 1955
STATE ENGINEER
SALEM OFFICE

We have a water Pond. we have made on our place. and we wish to know how to go a bout registering it.

We dug it for irrigating like's now it would have to be registered in both our names. its 40 feet wide and 60 feet long and 15 feet deep. so it holds lots of water and never goes dry. fed by spring in the bottom of it.

Hoping to hear soon.
notice the little pic in Oregon Farmer

Yours Truly

Tony + Ethel Olsen