

4/13W-16B

Name Alvin & Edna Woodruff
 By Box 2
 Address Harbor
Curry Co.

Application No. GR 1523Certificate No. GR 1626MODIFIED see Decree V. 18 P. 238 Cert. No. 49756Stream Index, Page No. 75-88Partially cancelled - sp. or Rec. Vol. 30 P. 187~~CANCELLED~~~~AUG 2 1952~~~~Partial Cancellation Vol. 32 Pg. 184~~Date filed June 6, 1958 8:00 AMTentative priority 1944

Action suspended until _____

Well log filed _____

CONSTRUCTION

Date for completion _____

Extended to _____

Date for application of water _____

Extended to _____

PROSECUTION OF WORK

Form "B" filed _____

Form "C" filed _____

FEES PAID

| Date | Amount | Receipt No. |
|--------|--------|-------------|
| 6/6/58 | 15- | 16744 |
| | | |
| | | |
| | | |

FEES REFUNDED

| Date | Amount | Check No. |
|------|--------|-----------|
| | | |
| | | |

ASSIGNMENTS

| Date | To Whom | Address | Volume | Page |
|------|---------|---------|--------|------|
| | | | | |
| | | | | |
| | | | | |

REMARKS

A well irrigates 16.5 acres near Pacific Ocean - Curry County

STATE OF OREGON

COUNTY OF

CURRY

CERTIFICATE OF WATER RIGHT

This Is to Certify, That ANTONE G. & JOAN M. ROSE

of P. O. Box 2043, Hwy. 101-S, Harbor, State of Oregon 97415, has
a right to the use of the waters of Harbor Ground Water Reservoir through a well

a tributary of ----- for the purpose of
irrigation of 13.7 acres

and that said right has been confirmed by decree of the Circuit Court of the State of Oregon for
Curry County, and the said decree entered of record at Salem, in the Order Record of
the WATER RESOURCES DIRECTOR, in Volume 18, at page 264; that the priority of the right
thereby confirmed dates from 1944

that the amount of water to which such right is entitled, for the purposes aforesaid, is limited to an
amount actually beneficially used for said purposes, and shall not exceed 0.171 cubic foot per
second.

The point of diversion is located in the Lot 4 (NW $\frac{1}{4}$ NE $\frac{1}{4}$), Section 16, T. 41 S., R. 13 W.,
W.M. Well located 220 feet south and 1450 feet West from the NE corner Section
16.

A description of the place of use under the right, and to which such right is appurtenant, is as
follows:

0.4 acre SW $\frac{1}{4}$ SE $\frac{1}{4}$
9.8 acres SE $\frac{1}{4}$ SE $\frac{1}{4}$
both as projected within T. Sharp DLC 41
Section 9

3.5 acres Lot 4 (NW $\frac{1}{4}$ NE $\frac{1}{4}$)
Section 16
T. 41 S., R. 13 W., W. M.

And said right shall be subject to all other conditions and limitations contained in said decree.
The right to the use of the water for the purposes aforesaid is restricted to the lands or place of use herein
described.

WITNESS the signature of the Water Resources Director, affixed

this date November 25, 1980

Water Resources Director

Recorded in State Record of Water Right Certificates, Volume 43, page 49756

| Name and Postoffice Address of Appropriator | Date of Relative Priority | Amount Cubic Feet Per Second | Number Acres | Use | Name of Ditch | Stream | Description of Land or Place of Use |
|--|---------------------------|------------------------------|--------------|------------|---|-------------------------------|---|
| ¹⁵¹ ANDERSON, V. E. P. O. Box 2033 Harbor, Oregon 97415 (Proof No. 1) (See Finding 15) | July 1951 | 0.13 (58 gpm) | 10.4 | Irrigation | Well and pump | Harbor Ground Water Reservoir | 10.4 acres NW $\frac{1}{4}$ SE $\frac{1}{4}$ as projected within E. O'Laughlin DLC 42 Section 9 T. 41 S., R. 13 W., W.M. |
| ¹⁵² HASTINGS BULB GROWERS, INC. by President Robert K. Hastings P. O. Box 2155 Harbor, Oregon 97415 (Proof No. 2) (See Finding 16) | July, 1955 | 0.178 (80 gpm) | 23.1 | Irrigation | Well and pump | Harbor Ground Water Reservoir | 0.2 acre NW $\frac{1}{4}$ NW $\frac{1}{4}$ 19.7 acres SW $\frac{1}{4}$ NW $\frac{1}{4}$ 0.8 acre SE $\frac{1}{4}$ NW $\frac{1}{4}$ 2.4 acres NW $\frac{1}{4}$ SW $\frac{1}{4}$ all as projected within R. Johnson DLC 43 Section 15 T. 41 S., R. 13 W., W.M. |
| ¹⁵³ LINDEBORG, Geneva E. Rt.1, Box 31 Brookings, Oregon 97415 (Proof No. 3) (See Finding 17) | 1952 | 0.075 (34 gpm) | 6.0 | Irrigation | Well and pump (dug 5 feet deep 40x50 feet) | Harbor Ground Water Reservoir | 6.0 acres NW $\frac{1}{4}$ SW $\frac{1}{4}$ as projected within J. Taggart DLC 40 Section 9 T. 41 S., R. 13 W., W.M. |
| ¹⁵⁴ PENTER, Gerald E. and June Rt.1, Box 52-B Brookings, Oregon 97415 (Proof No. 4) (See Finding 18) | July 1954 T-4517 | 0.075 (34 gpm) PQA. | 6.0 | Irrigation | Well and pump | Harbor Ground Water Reservoir | 3.2 acres SE $\frac{1}{4}$ SW $\frac{1}{4}$ 2.8 acres SW $\frac{1}{4}$ SE $\frac{1}{4}$ both as projected within T. Sharp DLC 41 Section 9 T. 41 S., R. 13 W., W.M. |
| ¹⁵⁵ RIGDON, Isabelle P.O. Box 2436 Harbor, Oregon 97415 (Proof No. 5) (See Finding 19) | October 1951 | 0.111 (50 gpm) | 11.3 | Irrigation | Well and pump | Harbor Ground Water Reservoir | 5.8 acres SW $\frac{1}{4}$ NW $\frac{1}{4}$ as projected within R. Johnson DLC 43 Section 15 5.5 acres Lot 3 (SE $\frac{1}{4}$ NE $\frac{1}{4}$) Section 16 T. 41 S., R. 13 W., W.M. |
| ¹⁵⁶ ROSE, Antone G. and Joan M. P.O. Box 2043 Hwy. 101-S Harbor, Oregon 97415 (Proof No. 6) (See Finding 20) | 1944 | 0.171 (77 gpm) | 13.7 | Irrigation | Well and pump (dug 26 feet deep 5x6 feet) | Harbor Ground Water Reservoir | 0.4 acre SW $\frac{1}{4}$ SE $\frac{1}{4}$ 9.8 acres SE $\frac{1}{4}$ SE $\frac{1}{4}$ both as projected within T. Sharp DLC 41 Section 9 3.5 acres Lot 4 (NW $\frac{1}{4}$ NE $\frac{1}{4}$) Section 16 T. 41 S., R. 13 W., W.M. |
| ¹⁵⁷ STRAHM, Harve Joel P.O. Box 2216 Harbor, Oregon 97415 (Proof No. 7) (See Finding 21) | Aug. 10, 1952 | 0.121 (54 gpm) | 9.7 | Irrigation | Well and pump (dug 23 feet deep 20 x 30 feet) | Harbor Ground Water Reservoir | 2.8 acres Lot 2 (SW $\frac{1}{4}$ SW $\frac{1}{4}$) 1.5 acres Lot 2 (SE $\frac{1}{4}$ SW $\frac{1}{4}$) 5.4 acres SE $\frac{1}{4}$ SW $\frac{1}{4}$ as projected within T. Sharp DLC 41 Section 9 T. 41 S., R. 13 W., W.M. |
| ¹⁵⁸ WATT, Cecil 707 Wedgewood Lane Rt. 1 Brookings, Oregon 97415 (Proof No. 8) (See Finding 22) | May, 1948 | 0.148 (66 gpm) | 11.8 | Irrigation | Well and pump | Harbor Ground Water Reservoir | 1.8 acres SW $\frac{1}{4}$ SW $\frac{1}{4}$ as projected within T. Sharp DLC 41 1.8 acres SW $\frac{1}{4}$ SW $\frac{1}{4}$ as projected within E. O'Laughlin DLC 42 Section 10 6.3 acres NW $\frac{1}{4}$ NW $\frac{1}{4}$ as projected within E. O'Laughlin DLC 42 1.9 acres NW $\frac{1}{4}$ NW $\frac{1}{4}$ as projected within R. Johnson DLC 43 Section 15 T. 41 S., R. 13 W., W.M. |

well is claimed to have been constructed in August, 1969 to replace the original well described under the Registration Statement No. GR-4109. The claimant describes the location of the new well as being 450 feet north from the old well. The use claimed is for irrigation of 11.3 acres of lily bulb crops being 5.8 acres in the SW $\frac{1}{4}$ NW $\frac{1}{4}$, Section 15, 5.5 acres in the SE $\frac{1}{4}$ NE $\frac{1}{4}$, Section 16, Township 41 South, Range 13 West, W. M. The claimant lists the pump rating as 50 gallons per minute.

The Water Resources Department classified 11.3 acres of lily bulbs as irrigated, being 5.8 acres in the SW $\frac{1}{4}$ NW $\frac{1}{4}$, Section 15 and 5.5 acres in Lot 3 (SE $\frac{1}{4}$ NE $\frac{1}{4}$) Section 16, Township 41 South, Range 13 West, W. M. Water is diverted from an 8 inch diameter drilled well with a 2 inch discharge submersible pump, powered with a 3 horsepower Franklin electric motor. The new well, which replaced the original well described under the registration statement No. GR-4109, is located 1670 feet south and 90 feet east from the NW corner, Section 15, being within the SW $\frac{1}{4}$ NW $\frac{1}{4}$, Section 15, Township 41 South, Range 13 West, W. M. The original well described under the registration statement reportedly has not been used since about 1968. Water is pumped through 520 feet of 3 inch diameter aluminum pipe, 1260 feet of 2 inch diameter aluminum and plastic pipe, and 19 Rainbird No. 30 sprinklers. A maximum of eight sprinklers are operated at one time. The ground elevation at the new well site is 73.80 feet and at the old well site, is 68.49 feet. Approximately one-half of the 11.3 acres is said to be irrigated in any one irrigation season.

It appears that this claimed right should be limited to a rate of diversion of not to exceed 0.111 cubic foot per second (50 gallons per minute) of ground water through the new well, constructed in 1969 for irrigation of 11.3 acres, with a date of priority of October, 1951. Claimant's rights are more particularly set out and described in the tabulation of water rights under finding 36 herein.

-20-

ANTONE G. & JOAN M. ROSE

The Registration Statement was filed under Registration No. GR-1676 in the name of Alvin Woodruff and Edna Woodruff, claiming an appropriation of 110 gallons per minute for the irrigation of 16.5 acres, being 13 acres in the SE $\frac{1}{4}$ SE $\frac{1}{4}$, Section 9 and 3.5 acres in the NW $\frac{1}{4}$ NE $\frac{1}{4}$, Section 16, Township 41 South, Range 13 West, W. M. for which Certificate of Registration No. GR-1626 was issued. The date construction work was begun is not known but is claimed to have been completed in 1944. The use of water is described as being

from a dug well 26 feet deep with a diameter of 5 X 6 feet, located 250 feet south and 1480 feet west from the NE corner Section 16, being within the NW $\frac{1}{4}$ NE $\frac{1}{4}$, Section 16, Township 41 South, Range 13 West, W. M.

Antone G. Rose and Joan M. Rose of P.O. Box 2043, Hwy. 101 South, Harbor, Oregon, submitted proof No. 6 claiming a right to the use of the ground waters of the Harbor Reservoir under an initiation date of 1944, for 110 gallons per minute through a dug well 26 feet deep and 5 X 6 feet in diameter, located within Lot 4 (NW $\frac{1}{4}$ NE $\frac{1}{4}$) Section 16, Township 41 South, Range 13 West, W. M. The use claimed is for irrigation of 13.7 acres of lily bulb crops being 0.4 acre in the SW $\frac{1}{4}$ SE $\frac{1}{4}$, 9.8 in the SE $\frac{1}{4}$ SE $\frac{1}{4}$, Section 9, 3.5 acres in Lot 4 (NW $\frac{1}{4}$ NE $\frac{1}{4}$) Section 16, Township 41 South, Range 13 West, W. M. The claimant lists the pump rating as 110 gallons per minute.

On December 15, 1977, the Water Resources Director entered an Administrative Order providing for the cancellation of part of the ground water Registration No. GR-1676 Certificate No. GR-1626. The cancellation order was based on affidavits submitted by Allen and Edna Woodruff and Norman C. and Janet L. Yock, owners of part of the lands claimed in the said ground water registration. The order provided for the cancellation of 3.4 acres in the SE $\frac{1}{4}$ SE $\frac{1}{4}$, Section 9, Township 41 South, Range 13 West, W. M. and the use of 23 gallons per minute of water from the well. From an examination of the adjudication map, it appears that only 2.8 acres of the said ground water registration are appurtenant to the area considered in the cancellation affidavits.

It appears the remainder of the claimed acreage in the registration claim, 13.7 acres, would be appurtenant to the lands owned by the claimants, Antone G. & Joan M. Rose.

The Water Resources Department classified 13.7 acres of lily bulbs as irrigated, being 0.4 acre in the SW $\frac{1}{4}$ SE $\frac{1}{4}$, 9.8 acres in the SE $\frac{1}{4}$ SE $\frac{1}{4}$, Section 9, 3.5 acres in Lot 4 (NW $\frac{1}{4}$ NE $\frac{1}{4}$) Section 16, Township 41 South, Range 13 West, W. M. Water is diverted from a boarded-over dug well with a Berkley 2 $\frac{1}{2}$ X 2 inch centrifugal pump, powered with a 7.5 horsepower electric motor. The well is located 220 feet south and 1450 feet west from the NE corner Section 16, being within Lot 4 (NW $\frac{1}{4}$ NW $\frac{1}{4}$), Section 16, Township 41 South, Range 13 West, W. M. Water is pumped through 1020 feet of 2 inch diameter aluminum pipe, 1230 feet of 3 inch diameter aluminum pipe, and 14 Rainbird No. 30 sprinklers with 5/32 X 1/8 inch nozzles. A maximum of 12 sprinklers are operated at one time. The ground elevation at the well site is 82.07 feet.

It appears this claimed right should be limited to a rate of diversion of not to exceed 0.171 cubic foot per second (77 gallons per minute) of ground water for irrigation

of 13.7 acres with a date of priority of 1944. Claimant's rights are more particularly set out and described in the tabulation of water rights under finding 36 herein.

-21-

HARVE JOEL STRAHM

The Registration Statement was filed under Registration No. GR-2125 in the name of Joe Knutsen, claiming an appropriation of 90 gallons per minute for the irrigation of 10.4 acres, being 5.0 acres in the SW $\frac{1}{4}$ SW $\frac{1}{4}$, 5.4 in the SE $\frac{1}{4}$ SW $\frac{1}{4}$, Section 9, Township 41 South, Range 13 West, W. M. for which Certificate of Registration No. GR-3954 was issued. The date construction work was begun is unknown but is claimed to have been completed on August 10, 1952. The use of water is described as being from a sump well 25 to 30 feet deep and 20 feet wide by 30 feet long, located 1800 feet south and 1100 feet east from the West $\frac{1}{4}$ corner, Section 9, being within SW $\frac{1}{4}$ SW $\frac{1}{4}$, Section 9, Township 41 South, Range 13 West, W. M.

Harve Joel Strahm of P.O. Box 2216, Harbor, Oregon submitted proof No. 7 claiming a right to the use of the ground waters of Harbor Reservoir under an initiation date of August 10, 1952 for 85 gallons per minute thru a dug well 23 feet deep, 20 feet wide and 30 feet long, located within Lot 2 (SE $\frac{1}{4}$ SW $\frac{1}{4}$), Section 9, Township 41 South, Range 13 West, W. M. The use claimed is for irrigation of 9.7 acres of lily bulb crops being 2.8 acres in the SW $\frac{1}{4}$ SW $\frac{1}{4}$ and 6.9 acres in the SE $\frac{1}{4}$ SW $\frac{1}{4}$ of the said section. The claimant lists the well rating as 85 gallons per minute.

The Water Resources Department classified 9.7 acres of lily bulbs as irrigated, being 2.8 acres in Lot 2 (SW $\frac{1}{4}$ SW $\frac{1}{4}$), 1.5 acres in Lot 2 (SE $\frac{1}{4}$ SW $\frac{1}{4}$), 5.4 acres in SE $\frac{1}{4}$ SW $\frac{1}{4}$ as projected within T. Sharp, D.L.C. 41, Section 9, Township 41 South, Range 13 West, W. M. Water is diverted from a dug sump well with a Cornell 2 X 1 $\frac{1}{2}$ inch centrifugal pump powered by a 5 horsepower electric motor. The sump well is covered with a concrete dome and has a drain installed 7 feet below land surface to prevent winter overflow of the sump. The summer surface water level of the sump is said to be 10 feet below land surface. The well is located 350 feet south and 70 feet west from the NW corner T. Sharp D.L.C. 41, being within Lot 2 (SE $\frac{1}{4}$ SW $\frac{1}{4}$), Section 9, Township 41 South, Range 13 West, W. M. Water is pumped through 640 feet of 2 inch diameter aluminum pipe, 520 feet of 3 inch diameter aluminum pipe, and 16 Rainbird No. 30 and No. 40 sprinklers with 5/32 X 3/32 inch nozzles. All 14 sprinklers are operated at one time. The ground elevation at the well site is 77.27 feet.

RECEIVED
MAY 9 1958

STATE ENGINEER
SALEM, OREGON

Registration Statement

Registration No. GR-1676

Certificate No. GR-1626

OF CLAIMANT OF RIGHT TO APPROPRIATE GROUND WATER

TO THE STATE ENGINEER OF OREGON:

I, Alvin Woodruff and Edna Woodruff, husband and wife
of Box 2, Harbor, Oregon County of Curry
(Mailing address)
State of Oregon, do hereby make application for a certificate of registration as evidence
of a right to appropriate ground water.

1. Source from which water is withdrawn is Pump Well
(Flowing well, pump well, infiltration trench, or tunnel)

2. Location is: 1 1/2 mile from Harbor, Oregon
(Approximate distance and direction from nearest city or town)

and is more particularly described as follows:

(a) 1480 feet West and 250 feet South of NE corner Section 16
(Give distance and bearing to corner of section or other legal subdivision)
being within NW 1/4 NE 1/4 of Sec. 16, Twp. 41 South, Rge. 13 West
(Standard legal subdivision) (T, or S.) (R, or W.)

or (b) within limits of recorded platted property, town or city:

in Lot _____, Block _____ of _____
(Name of plat or addition)
County of _____
(If within city or town, give name)

3. Construction Work was begun on UNKNOWN; was completed on 1944
(Date) (Date)

and the ground water claimed was first used for the purposes set out below on 1944
(Date)

since which time the water has been used Continuously
(Continuously or intermittently)

from 1944 to 1958
(Date) (Date)

4. Quantity of water claimed and used is 110 gallons per minute; _____ acre
feet per year.

5. Purpose or Purposes for which water is used Irrigation
(Domestic, irrigation, municipal, manufacturing, industrial, etc.)

6. Description of Well: Depth 26 feet. Type Dug
(Dug or drilled)
diameter 5' x 6' 2322 Elevation of ground at well site 50 feet, mean sea level.
(As near as known)
Depth to water table 12 feet.

7. Capacity of Well: 110 g.p.m. with 25 feet drawdown. Can pump dry in fall
_____ g.p.m. with _____ feet drawdown.

Date of test Have pumped dry in two hours during dry periods for two years

If Flowing Well: Measured discharge _____ g.p.m. on _____
(Date)

Shut-in pressure at ground surface _____ lbs. per sq. in. on _____
(Date)

Water is controlled by _____
(Cap, valve, etc.)

_____ inch diameter _____ from _____ to _____ feet

_____ inch diameter _____ from _____ to _____ feet

_____ inch diameter _____ from _____ to _____ feet

_____ inch diameter _____ from _____ to _____ feet

Well is not lined and is dug in clay 5ft by 6 ft.

Number per foot and size of perforations, or describe screen.

[illegible]

If log of well is not available, give name and address of driller. _____

11. Infiltration Trench: Covered or open _____

Dimensions: Length _____ ft. Minimum depth _____ ft. Maximum depth _____ ft.

Bottom width _____ ft. Discharge _____ g.p.m. Date of test _____

12. Tunnel: Type of lining _____

*Dimensions: _____

"(Length, curve, and cross sectional area)

Position of water bearing stratum with reference to portal of tunnel _____

Log of tunnel: (Preceding table for log of well may be used, if desired. Give footage from portal and character of materials, as pertinent.)

13. **Pumping Equipment:**

2" inlet 1 1/2" outlet

(a) Pump 7 1/2 horse electric centrifugal pump Capacity 150 g.p.m.

(date, type and size)

(b) Motor Electric 7 1/2 horse power

(Type and horsepower)

14. Location of area irrigated or to be irrigated, or place of use if for purposes other than irrigation.

[illegible]

15. If the ground water supply is supplemental to an existing water supply, identification of any application for a permit, permit, certificate or adjudicated right to appropriate water made or held by the registrant.

Township 41S Range 13W W.M.
North

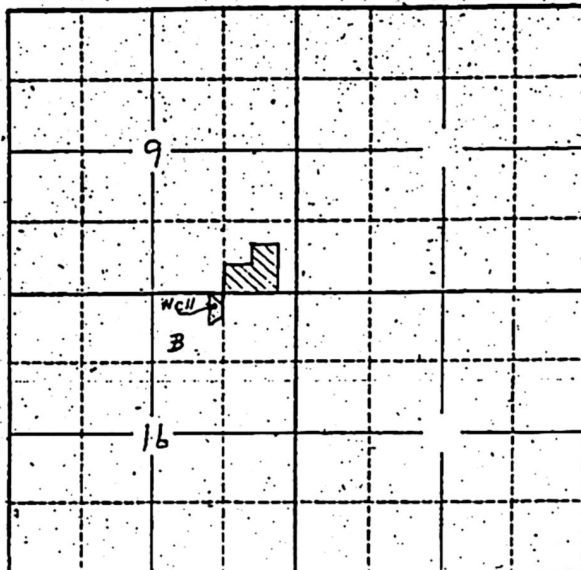

Locate well and acreage of irrigated land on plat.

Scale: 2" = 1 Mile

STATE OF OREGON

County of Curry }

I, Alvin Woodruff, being first duly sworn, do hereby certify that I have read the foregoing Registration Statement and that all of the items therein contained are true to the best of my knowledge and belief.

Subscribed and sworn to before me this 7th day of May, 1958

My commission expires 1/4/61

(SEAL)

Alvin Woodruff
(Signature of Registrant)

Edna Woodruff

Sylvia J. Kuse
(Notary Public)

CERTIFICATE OF REGISTRATION

STATE OF OREGON

County of Marion }

This is to certify that the foregoing Registration Statement was received in the office of the State Engineer on the 6th day of June, 1958, at 800 o'clock A M. and has been duly recorded in said office in Book No. 8 of Registration Statements on page GR-1626

Witness my hand this 7th day of January, 1959

Laura A. Stanley
(State Engineer)

By

(Deputy)

GR-1626

Alvin Woodruff
Box 2
Harrison, Ore

5140

5140



5140

State Engineer
251 Finance Bldg.
170-12th St. S.E.
Salem, Oregon

Part Canceled Sp. Or. Vol. 30 P. 187
Entered Dec. 15, 1977
Correct Mark Records

| | | | | |
|-----|---|--------------|----------------|----------------------------|
| ___ | Index Cards | ✓ | CAS | Str. Index map |
| ___ | Decree-vault | ✓ | CAS | Str. Index list |
| ___ | Decree-safe | ✓ | CAS | Name Chainindex |
| ___ | Cert. of W/R | ✓ | ___ | X Ref. Chainindex |
| ✓ | MD Plat Cards | ✓ | CAS | Permit GR Claim |
| ✓ | CAS Sp. Or. Vol <u>22</u> , <u>184</u> | ✓ | CAS | Per. or G.R. File |

Orders to:

| | | | | |
|-----|----------------|----------------------------|-----|--|
| ✓ | CAS | Order Book | ___ | Adj. Folder |
| ___ | ___ | County Clerk | ✓ | CAS Permit Folder GR |
| ✓ | CAS | Watermaster # <u>15</u> | ___ | Form 101 sent |
| ___ | ___ | Party Submitting Affidavit | ✓ | CAS Watermaster Div. |

BEFORE THE WATER RESOURCES DIRECTOR OF OREGON

Curry County

IN THE MATTER OF THE CANCELLATION)
OF A GROUND WATER REGISTRATION)
CLAIMED RIGHT IN THE NAMES OF)
ALVIN AND EDNA WOODRIF _ _ _ _ _)

O R D E R
Amending Prior Order

On August 23, 1972, the State Engineer entered an administrative order providing for the cancellation of a ground water registration claimed right described in the certificate of registration recorded in Volume 8, Page 1626, Ground Water Registration Records.

The proceedings for cancellation of said claimed right was initiated by affidavits submitted by Alvin and Edna Woodruff, and Norman C. and Janet L. Yock.

Subsequent to the entry of the State Engineer's administrative order on August 23, 1972, it was determined that Alvin and Edna Woodruff, and Norman C. and Janet L. Yock were not the sole owners and contract purchasers of all the lands to which said claimed right is appurtenant.

That portion of said claimed right for the use of 23.0 gallons of water per minute from the well for the irrigation of 3.4 acres in SE $\frac{1}{4}$ SE $\frac{1}{4}$ of Section 9, Township 41 South, Range 13 West, W. M., was owned by Alvin and Edna Woodruff and was being purchased under contract by Norman C. and Janet L. Yock.

That portion of said claimed right for the use of 87.0 gallons of water per minute from the well for the irrigation of 9.6 acres in SE $\frac{1}{4}$ SE $\frac{1}{4}$ of Section 9 and 3.5 acres in NW $\frac{1}{4}$ NE $\frac{1}{4}$ of Section 16, Township 41 South, Range 13 West, W. M., was not owned and under contract to purchase by the affiants and, therefore, should not have been cancelled pursuant to the affidavit.

Therefore, the administrative order of the State Engineer, entered August 23, 1972 providing for the cancellation of the claimed right in question should be amended to provide for cancellation of only that portion of the said claimed right appurtenant to lands owned by Alvin and Edna Woodruff and being purchased under contract by Norman C. and Janet L. Yock.

NOW, THEREFORE, it hereby is ORDERED that the administrative order of the State Engineer, entered August 23, 1972, and recorded at Page 184, Volume 22, Special Order Record, be and the same hereby is amended to read as follows:

"On May 18, 1972, Alvin and Edna Woodruff submitted an affidavit that they are the owners and Norman C. and Janet L. Yock submitted an affidavit that they are the contract purchasers of certain real property and a certain ground water registration claimed right appurtenant thereto; and that they have abandoned any and all interest in and to the certain claimed right and request the same to be canceled."

"The claimed right in question is that portion of the right described by the certificate of registration recorded at Page 1626, Volume 8, Ground Water Registration Records, for the use of 23.0 gallons of water per minute from a well, with a date of reclamation of 1944, for the irrigation of 3.4 acres in SE¼ of Section 9, Township 41 South, Range 13 West, W. M."

"It is FURTHER ORDERED that said claimed right, being a portion of the right described by the certificate of registration recorded at Page 1626, Volume 8, Ground Water Registration Records, is canceled."

Dated at Salem, Oregon, this 15th day of December, 1977.

James E. Sexson
Director

BEFORE THE STATE ENGINEER OF OREGON

Curry County

IN THE MATTER OF THE)
CANCELATION OF A GROUND)
WATER REGISTRATION CLAIMED)
RIGHT IN THE NAMES OF)
ALVIN AND EDNA WOODRUFF, AND)
NORMAN C. AND JANET L. YOCK)

O R D E R

On May 18, 1972, Alvin Woodruff and Edna Woodruff submitted an affidavit that they are the owners of lands and Norman C. and Janet L. Yock submitted an affidavit that they are the contract purchasers of the lands claimed to have been irrigated as described in a certificate of registration; that they have abandoned said claim of water right and request the same be canceled.

The claimed right is for the use of not to exceed 110 gallons per minute from a pump well located within the NW $\frac{1}{4}$ NE $\frac{1}{4}$ of Section 16, Township 41 South, Range 13 West, W.M., with a date of reclamation of 1944, for the irrigation of 13.0 acres in the SE $\frac{1}{4}$ SE $\frac{1}{4}$ of Section 9, and 3.5 acres in the NW $\frac{1}{4}$ NE $\frac{1}{4}$ of Section 16, all being within Township 41 South, Range 13 West, W.M., and is described in the certificate of registration recorded in Volume 8, page 1626, Ground Water Registration Records.

NOW, THEREFORE, it is hereby ORDERED that the claim of a water right for the use of not to exceed 110 gallons per minute from a pump well located within the NW $\frac{1}{4}$ NE $\frac{1}{4}$ of Section 16, Township 41 South, Range 13 West, W.M., with a date of reclamation of 1944, for the irrigation of 13.0 acres in the SE $\frac{1}{4}$ SE $\frac{1}{4}$ of Section 9, and 3.5 acres in the NW $\frac{1}{4}$ NE $\frac{1}{4}$ of Section 16, all being within Township 41 South, Range 13 West, W.M., is canceled.

Dated at Salem, Oregon this 23rd day of August, 1972.

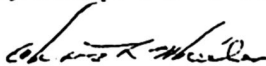
CHRIS L. WHEELER
State Engineer

AFFIDAVIT

RECEIVED
MAY 18 1972
STATE ENGINEER
SALEM, OREGON

STATE OF OREGON)
) ss.
County of Curry)

We, Norman C. and Janet L. York, being first duly sworn, depose and say that we are the contract purchasers of the lands described on the attached legal description and a portion of a Ground Water Registration appurtenant thereto, which is for the appropriation of a claimed 110 gallons per minute of water from a pump well for the irrigation of 13 acres in the SE $\frac{1}{4}$ SE $\frac{1}{4}$, within Section 9, and 3.5 acres in the NW $\frac{1}{4}$ NE $\frac{1}{4}$, within Section 16, all being within Township 41 South, Range 13 West, W.M., as evidenced by Ground Water Registration Number GR-1676, Certificate Number GR-1626, under date of claimed priority of 1944; that we have abandoned that portion within the affected legal description, and request that portion to be cancelled.

IN WITNESS WHEREOF, we have hereunto set our hands this 27 day of April, 19 72.

Norman C. York
Janet L. York

Subscribed and sworn to before me this 27 day of April, 19 72.

M. John Thompson
Notary Public of Oregon

My Commission expires 4-18-76

A tract of land lying within the SE $\frac{1}{4}$ of the SE $\frac{1}{4}$ of SEction 9, Township 41 South, Range 13 West, W.M., more particularly described as follows:

Beginning at an iron pipe which bears N. 32.7 feet and West 358.1 feet from an iron pipe marking the SE Corner of said Section 9, Township 41 South, Range 13 West, W.M.; Thence West a distance of 374.5 feet; Thence North a distance of 399.5 feet; Thence East a distance of 374.5 feet; Thence South a distance of 399.5 feet to the point of beginning.

AFFIDAVIT

RECEIVED
MAY 18 1972
STATE ENGINEER
SALEM, OREGON

STATE OF OREGON)
) ss.
County of Tully)

We, Alvin Woodruff and Edna Woodruff, being first duly sworn, depose and say that we are the legal owners of the lands described on the attached legal description and a portion of a Ground Water Registration appurtenant thereto, which is for the appropriation of a claimed 110 gallons per minute of water from a pump well for the irrigation of 13 acres in the SE $\frac{1}{4}$ SE $\frac{1}{4}$, within Section 9, and 3.5 acres in the NW $\frac{1}{4}$ NE $\frac{1}{4}$, within Section 16, all being within Township 41 South, Range 13 West, W.M., as evidenced by Ground Water Registration Number GR-1676, Certificate Number GR-1626, under date of claimed priority of 1944; that we have abandoned that portion within the affected legal description, and request that portion to be cancelled.

IN WITNESS WHEREOF, we have hereunto set our hands this 12th day of May, 19 72.

Alvin Woodruff
Edna Woodruff

Subscribed and sworn to before me this 12th day of May, 19 72

Karl M. Davis
Notary Public of Oregon

My Commission expires 10-21-75

A tract of land lying within the SE $\frac{1}{4}$ of the SE $\frac{1}{4}$ of Section 9, Township 41 South, Range 13 West, W.M., more particularly described as follows:

Beginning at an iron pipe which bears N. 32.7 feet and West 358.1 feet from an iron pipe marking the SE Corner of Said Section 9, Township 41 South, Range 13 West, W.M.; Thence West a distance of 374.5 feet; Thence North a distance of 399.5 feet; Thence East a distance of 374.5 feet; Thence South a distance of 399.5 feet to the point of beginning.

Township 41 S Range 13 W W.M.
North

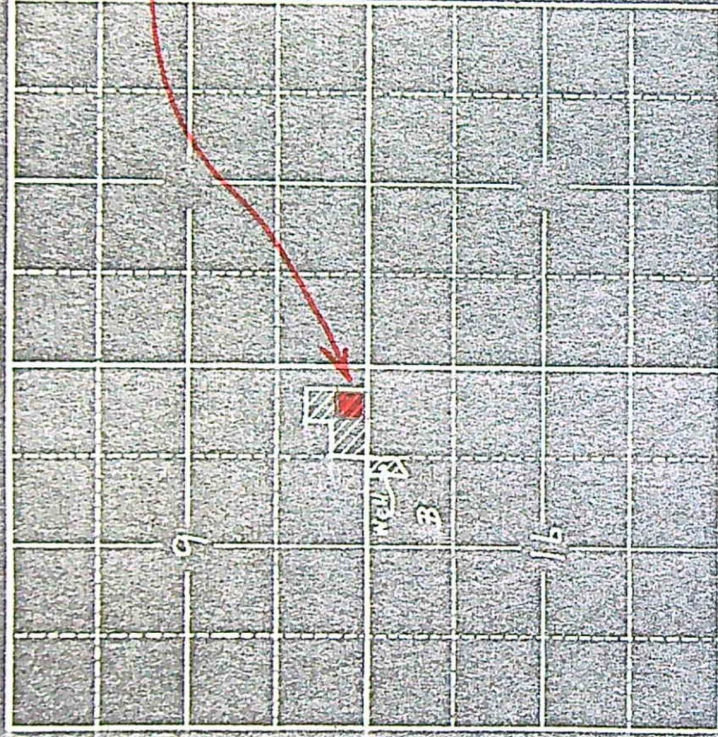

Property by
L.D. in Affidavit
received
May 18, 1972

Locate well and acreage of irrigated land on plat.

Scale: 2" = 1 Mile

STATE OF OREGON

County of Curry

I, Alvin Woodruff

being first duly sworn, do hereby certify that I have read the foregoing Registration Statement and that all of the items therein contained are true to the best of my knowledge and belief.

Subscribed and sworn to before me this 12th day of May, 1958.

My commission expires 1/4/61

(SEAL)

Alvin Woodruff
Edward Woodruff
Refugio J. Rios
(Notary Public)

CERTIFICATE OF REGISTRATION

STATE OF OREGON

County of Marion

This is to certify that the foregoing Registration Statement was received in the office of the State Engineer on the 6th day of June, 1958, at 8⁰⁰ o'clock A. M. and has been duly recorded in said office in Book No. 8 of Registration Statements on page GR-1626.

Witness my hand this 7th day of January, 1959.

Lawrence J. Stanley
(State Engineer)

By

GR-1626



Water Resources Department
MILL CREEK OFFICE PARK

555 13th STREET N.E., SALEM, OREGON 97310

PHONE 378-3066

File No. GR-1676

February 15, 1978

M. John Youngquist
Watermaster District #15
Justice Building Rm 104
Roseburg, OR 97470

Dear John:

Enclosed is a copy of the Special Order recorded in Volume 30,
at Page 187 which amends the prior order recorded in Volume 22,
at Page 184.

Sincerely

Wayne J. Overcash
Water Rights Engineer

WJO:cah

COPY

GR-1676

October 3, 1972

Alvin and Edna Woodruff
Box 2
Harbor, Oregon 97415

Dear Sir and Madam:

Enclosed is a copy of the order entered August 23, 1972, canceling Ground Water Registration Claim No. GR-1626 as requested in your affidavit.

Our records have been changed and this claim will be of no force or effect.

Very truly yours,

Trevor Jones
Assistant

TJ:ds
Enclosure

GR-1676

January 13, 1959

Alvin and Edna Woodruff
Box 2
Harbor, Oregon

Dear Sir and Madam:

GR-1676
GR-1626

GR-1676

June 9, 1958

Alvin and Edna Woodruff
Box 2
Harbor, Oregon

Dear Mr. and Mrs. Woodruff:

This will acknowledge the receipt of your water well report and registration fees in the amount of \$15 for which our receipt 16744 is enclosed.

After we have had an opportunity to examine your statement, we will communicate with you further.

Very truly yours,

LEWIS A. STANLEY
State Engineer

By
Wm. S. Bartholomew
Geologist

ls
Enc.

222
May 26, 1958

Alvin Woodruff
Box 2
Harbor, Oregon

Dear Mr. Woodruff:

This will acknowledge receipt of your well registration statement, which appears to be in good order. However, before this statement can be filed and certified it is required that we receive a fee for registration and recording. The fee is computed as follows:

\$10 examination fee
\$ 5 recording fee for the irrigation of up to
and including 30 acres of land
\$15 Total

We will file and process your statement for certification upon receipt of the \$15 registration fee.

Very truly yours,

LEWIS A. STANLEY
State Engineer

By
Wm. S. Bartholomew
Geologist

WSD:ls



G - 5664

R.R. 1676

On May 18, 1972, an affidavit was submitted by Alvin and Edna Woodriff, Owners and from Norman C. and Janet L. Yock, contract purchasers authorizing cancelation of a portion of the G.R. Cert. ~~1666~~ 1626 having a claimed priority of 1944.

The reason for this cancelation was to accomodate a new ~~gwm~~ groundwater filing: App. # G - 5664, Permit # G - 5691, submitted November 18, 1971 for irrigation of 3.5 acres.

On August 23, 1972, an order was entered canceling the entire groundwater Registration, which represented all of 16.5 acres, being Spec. Or. Vol. 22, pg. 184.

Apparently this order should be rescinded and a new order entered canceling only the 3.5 acres in the $SE\frac{1}{4}SE\frac{1}{4}$ of Sec. 9. T. 41 S., R. 13 W., W.M., as described in the attached page to each of the affidavits.

This will leave a remaining registration right for the irrigation of 9.5 acres in the $SE\frac{1}{4}SE\frac{1}{4}$, Sec. 9 and 3.5 acres in the $NW\frac{1}{4}NE\frac{1}{4}$ of Sec. 16, T. 41 S., R. 13 W., W.M.

9/4/75 w.a.carr

Need to
Return please

Alvin Woodliff
Box 2
Harbor Ore.

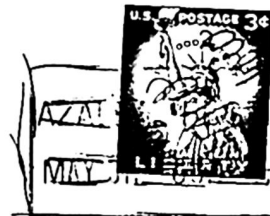

State Engineers.

251 Finance Building
170. 12th St. S.E.
Salem Oregon

W. C. D.

RECEIVED

APR 7 1958

STATE ENGINEER
SALEM, OREGON

Harbor, Ore.

April 3, 58.

JR-1676

Dear Sir,

I would like to
register an irrigation well,
and would like to have
the necessary forms.

Thank you.

Yours
Alvin Woodruff

Box 2

Harbor,
Ore.

m/4.7.58-ls