



July 5, 2024

Ms. Tonya Miller  
Oregon Water Resources Department  
725 Summer Street NE, Suite A  
Salem, OR 97301

**Subject:** Ownership Update for Certificate 86711 (Application S-45818)

Dear Ms. Miller:

On behalf of the current landowner, Johnson Creek Cranberries LLC, please find enclosed an Ownership Update for Certificate 86711.

Please do not hesitate to contact me with questions about this request or the materials enclosed.

Respectfully submitted,

A handwritten signature in blue ink, appearing to read 'Theodore Ressler', is written over a light blue horizontal line.

Theodore Ressler, RG, CWRE  
Summit Water Resources, LLC

Enclosures:

Attachment 1: Ownership Update for Certificate 86711

Attachment 2: Ownership Update Map for Certificate 86711

Cc: Craig Briggs  
John Briggs

**Attachment 1**  
**Water Right Information**

---



**Oregon Water Resources Department**  
 725 Summer Street NE, Suite A  
 Salem, Oregon 97301  
 (503) 986-0900  
[www.oregon.gov/OWRD](http://www.oregon.gov/OWRD)

## Ownership Update for Certificated Rights Only

### NO FEES ARE REQUIRED TO SUBMIT THIS FORM

**NOTICE:** A certificate of water right typically stays with the land. To track water right ownership, the Department requests that this form be submitted to the Department. **To update multiple rights, a separate form is required for each right.** If you have any questions about this form, please contact your local watermaster, or call the Water Resources Department at (503) 986-0900.

Note: Use the [assignment](#) form to change ownership on pending applications, permits, transfers, groundwater registrations, or limited licenses.

Current Landowner Information					
Name:	Johnson Creek Cranberries LLC				
Mailing Address:	PO Box 399				
City:	Coquille	State:	OR	Zip:	97423
Phone:	360-823-9238	Email:	johnsoncreekcranberries@gmail.com		

Property Information					
County:	COOS	Township:	29S	Range:	14W
Tax Lot #:	500	Section:	8		
Street Address of Water Right:	88563 CIRCLE CITY LN, BANDON, OR 97411				
<b>Water Right Information</b>					
Application:	S-45818				
Permit:	S-34190				
Certificate:	86711				
Are all the lands associated with this water right owned by the requestor?				<input type="checkbox"/> Yes	<input checked="" type="checkbox"/> No
(If no, include a map showing the portion of the water right involved) <a href="#">Attachment 2</a>					

Signature and Date		
Name of individual completing form:	John Briggs or Craig Briggs	
Phone or email:	360-936-0351 or 360-823-9238	Date: 2/18/2025
Signature of requestor:	Signed by: 	

The Department does not change names on water right certificates. This form will be placed in the file for future reference only. If mailed, the Department will not provide acknowledgment of receipt.

This form can be mailed to the address above or sent by email to [wrd\\_dl\\_customerservice@water.oregon.gov](mailto:wrd_dl_customerservice@water.oregon.gov)

## STATE OF OREGON

## COUNTY OF COOS

## CERTIFICATE OF WATER RIGHT

## THIS CERTIFICATE ISSUED TO

RAY F. HOPPER  
RT 1 BOX 2061  
BANDON OR 97411

ROBERT M. AND DORIS LOFTIN  
88551 CIRCLE CITY LANE  
BANDON OR 97411-9293

confirms the right to use the waters of JOHNSON CREEK, tributary to PACIFIC OCEAN for SUPPLEMENTAL FROST CONTROL, IRRIGATION, AND HARVESTING OF CRANBERRIES FOR 5.8 ACRES.

This right was perfected under Permit 34190. The date of priority is FEBRUARY 27, 1969. The amount of water to which this right is entitled is limited to an amount actually used beneficially, and shall not exceed 0.18 CUBIC FOOT PER SECOND (CFS), BEING 0.11 CFS FOR SUPPLEMENTAL FROST CONTROL, 0.07 CFS FOR SUPPLEMENTAL IRRIGATION, AND 0.18 CFS FOR SUPPLEMENTAL HARVESTING OF CRANBERRIES, if available at the authorized point of diversion, or its equivalent in case of rotation, measured at the point of diversion.

The point of diversion is located as follows:

Twp	Rng	Mer	Sec	Q-Q	Measured Distances
29 S	14 W	WM	9	SW NW	1415 FEET SOUTH & 824 FEET EAST FROM NE CORNER, SECTION 8

The amount of water used for irrigation, together with the amount secured under any other right existing for the same lands, is limited to a diversion of ONE-FORTIETH of one cubic foot per second, or its equivalent for each acre irrigated, and shall be further limited to a diversion of not to exceed 3.0 acre-feet per acre for each acre irrigated during the irrigation season of each year for cranberries. If for the irrigation of any other crop, this appropriation shall be limited to ONE-EIGHTIETH of one cubic foot per second or its equivalent for each acre irrigated and shall be further limited to a diversion of not to exceed 2.5 acre feet per acre for each acre irrigated during the irrigation season of each year.

The use shall conform to such reasonable rotation system as may be ordered by the proper state officer.

A description of the place of use to which this right is appurtenant is as follows:

Twp	Rng	Mer	Sec	Q-Q	Acres
29 S	14 W	WM	8	SE NE	5.8

**NOTICE OF RIGHT TO RECONSIDERATION OR JUDICIAL REVIEW**

This is an order in other than a contested case. This order is subject to judicial review under ORS 183.484. Any petition for judicial review must be filed within the 60-day time period specified by ORS 183.484(2). Pursuant to ORS 536.075 and OAR 137-004-0080, you may either petition for judicial review or petition the Director for reconsideration of this order. A petition for reconsideration may be granted or denied by the Director, and if no action is taken within 60 days following the date the petition was filed, the petition shall be deemed denied.

The quantity of water diverted at the new point of diversion, shall not exceed the quantity of water available at the original point of diversion, excluding any substantial inflow between the original and new point of diversion. The original point of diversion location from Johnson Creek is as follows:

Twp	Rng	Mer	Sec	Q-Q	Measured Distances
29 S	14 W	WM	5	SE SE	1452.63 FEET NORTH & 172.89 FEET EAST FROM NE 1/16 CORNER, SECTION 8

The water user shall maintain and operate a headgate or valve, and an in-line flow meter, weir, or other suitable device for measuring and recording the quantity of water diverted.

When required by the Department, the water user shall install and maintain weirs or other suitable devices reasonably necessary for measuring and recording the quantity of water available at the original point of diversion and any substantial inflow to Johnson Creek between the original and new points of diversion. The type and plans of the measuring devices must be approved by the Department prior to beginning construction and shall be installed under the general supervision of the Department.

This certificate is issued to confirm a change in POINT OF DIVERSION approved by an order of the Water Resources Director entered October 5, 1994, at Special Order Volume 48, Page 316, approving Transfer Application 7029, and supersedes Certificate 48120, State record of Water Right Certificates.

The right to the use of the water for the above purpose is restricted to beneficial use on the lands or place of use described.

Issued JAN 28 2011

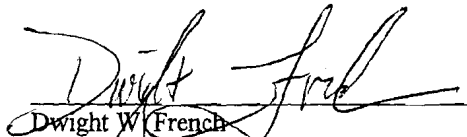
  
Dwight W. French  
Administrator Water Rights and Adjudications, for  
Phillip C. Ward, Director

**Attachment 2**  
**Ownership Update Map**

---



Ownership Update for Certificate 86711

FINAL PROOF SURVEY MAP  
located in the SW 1/4 NW 1/4 of Section 9  
and the SE 1/4 NE 1/4 of Section 8,  
Township 29 South, Range 14 West, W.M.  
Coos County, Oregon  
Transfer 7027, T-7028, & T-7029

RECEIVED

SEP - 4 1997  
WATER RESOURCES DEPT.  
SALEM, OREGON

Prepared For: Ben & Rebecca Flugstad  
Prepared By: Dennis Goude  
Date Surveyed: July 17, 1997

NOTE:  
The P.O.D. is an in-stream  
10 HP pump. Located 1415  
feet South and 824 feet  
East of the Northeast  
corner of Section 8,  
Township 29 South Range  
14 West, W.M.

13.8ac.  
SE 1/4 NE 1/4

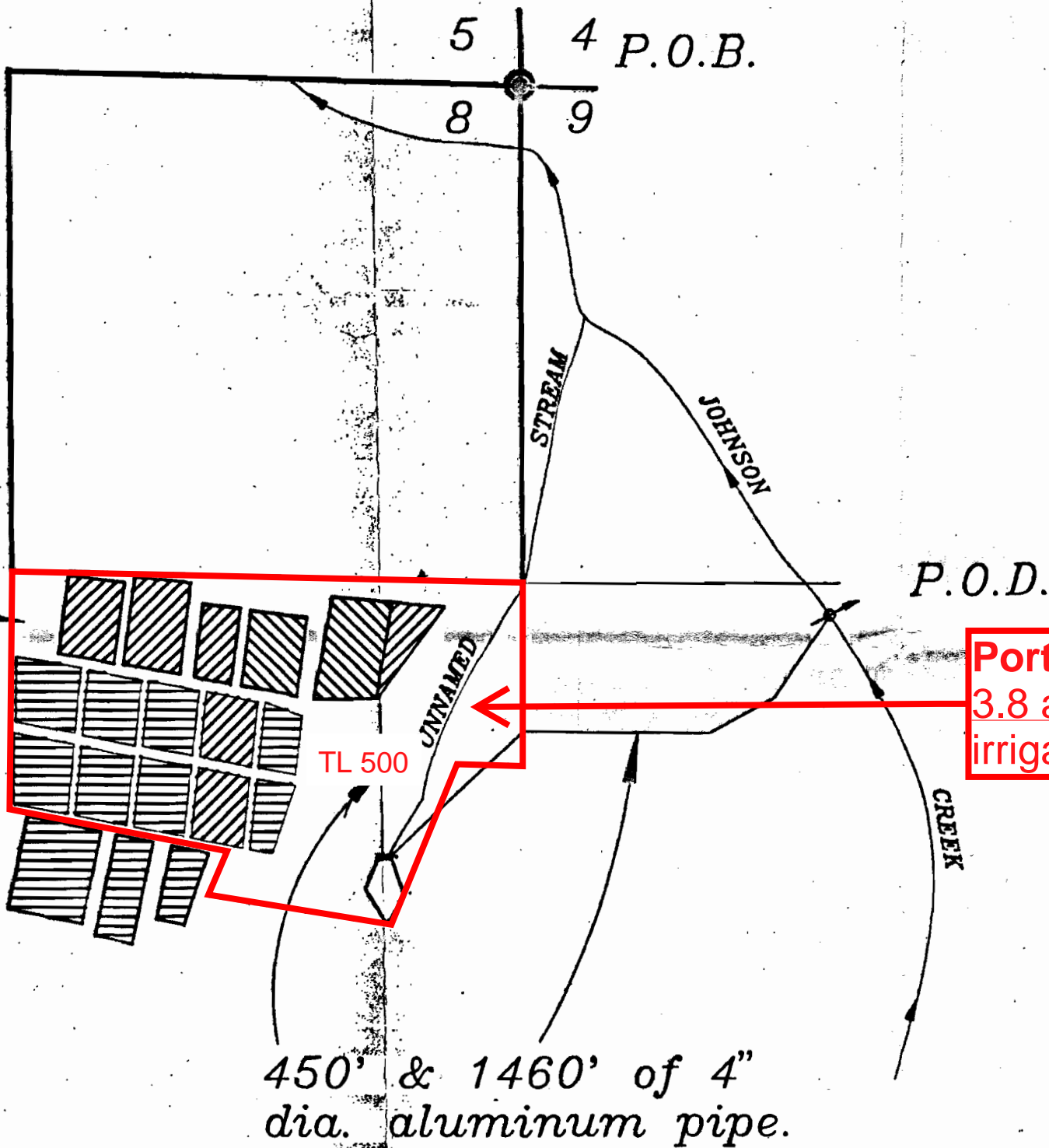

Portion of Cert. 86711 located on TL 500  
3.8 acres of supplemental frost control,  
irrigation, and harvesting of cranberries

LEGEND

P.O.B.  
P.O.D.  
PIPE  
STREAM  
IRRIGATED  
AREA

T-7027	4.3 ac.		Cert. 86712
T-7028	2.5 ac.		Cert. 86710
T-7029	5.8 ac.		Cert. 86711

SCALE  
1"=400'

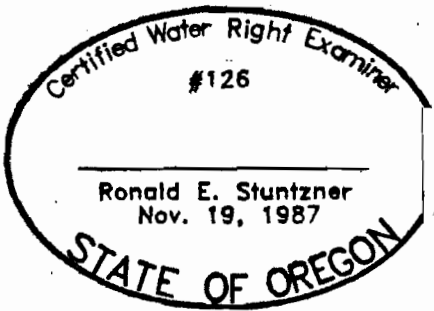

EXAMINERS DISCLAIMER STATEMENT  
The preparation of this map was for the purpose of  
identifying the location of the Water Right only and  
has no intent to provide dimensions or location of  
property ownership lines.

Stuntzner Engineering  
& Forestry, L.L.C.

ENGINEERING • LAND SURVEYING • FORESTRY  
PLANNING • WATER RIGHTS

705 South 4th St.  
Post Office Box 118  
Coos Bay, Oregon 97420  
Phone: (541) 267-2872  
Fax: (541) 267-0588

Drawn By: Dennis Goude	Date: August 27, 1997
Checked By: Tom Wilczek	Drawing No.: 97-171
Designed By:	Revised:
Job Name: Flugstad	Sheet 1 of 1