

**SURFACE WATER REGISTRATION CHECKLIST**

(received after July 18, 1990)

CHECK BASIN MAP See NAME Southern # 17 UNADJUDICATED AREA ? yes  
Comer  
RECEIPT # 95269 S W R NUMBER 151  
CHECK ENCLOSURES See PRELIMINARY DATA BASE ENTRY Done  
ACKNOWLEDGEMENT LETTER See ENTER ON STREAM INDEX \_\_\_\_\_  
CHECK QUADRANGLE MAP CAR CHECK GLO PLATS \_\_\_\_\_  
WATERMASTER CHECKLIST \_\_\_\_\_ PUBLIC NOTICE PUBLICATION See

**FORM REVIEW**

\_\_\_\_\_ blanks filled in  
\_\_\_\_\_ signed  
\_\_\_\_\_ date received stamped

**MAP REVIEW**

✓ source and trib  
\_\_\_\_\_ diversion point location  
\_\_\_\_\_ conveyances (pipes, ditch, etc.)  
\_\_\_\_\_ place of use  
✓ scale  
✓ township, range, section  
✓ north arrow  
✓ CWRE stamp  
✓ disclaimer  
\_\_\_\_\_ date survey was performed  
\_\_\_\_\_ P.O.B. of survey  
\_\_\_\_\_ dimensions and capacity of diversion system  
✓ "beneficial use" type title  
✓ "permanent-quality" paper

WATER RIGHT RECORD CHECK \_\_\_\_\_ FIELD INSPECTION \_\_\_\_\_  
FINAL FILE REVIEW \_\_\_\_\_ FINAL DATA BASE ENTRY \_\_\_\_\_  
ENTER ON PLAT CARDS \_\_\_\_\_

October 4, 1993

WATER  
RESOURCES  
DEPARTMENT

JAMES F GOSSON  
580 S STATE ST  
SUTHERLIN OR 97479

RE: SWR-151

Dear Jim,

This will acknowledge the receipt of the information I requested in regards to the pre-1909 vested water right claim in the name of JACKSON RANCH INC. Thanks for your prompt attention to this matter.

Sincerely,



Don Knauer  
Adjudication Specialist

j:\w\slc\1\swr-0151.002



3850 Portland Rd NE  
Salem, OR 97310  
(503) 378-3739  
FAX (503) 378-8130

June 28, 1993

JAMES F. GOSSON  
580 S STATE STREET  
SUTHERLIN OR 97479-9536

RE: File# **SWR-151**

DEAR JAMES F. GOSSON,

The Water Resources Department (WRD) received a little over 500 surface water registration statements in December, 1992. All of the files have been set up and receipts for the fees have been sent. The next step is to insure the maps received in support of the claims are acceptable based on Oregon Revised Statutes (ORS) and Oregon Administrative Rules (OAR).

I am returning the map you prepared for Milton P. Smith. You will find the item which requires completion or correction shown below. I have the description followed by the ORS or OAR site and paraphrased statute or rule.

place of use (¼ ¼)

ORS 539.240 (2) (d) (B) "The location of place of use by quarter-quarter section..." You need to identify those ¼ ¼'s in which the livestock water.

You must return the map before the claim can be processed. If you cannot have the map to the WRD within 60 days, please inform me as to when it can be expected. Please mark all correspondence with the file number.

As always, if you have any questions, please give me a call.

Sincerely,



Don Knauer  
Adjudication Specialist

Enclosures

J:\WP51\SWR\CLAIMANT\1\SWR-0151.00M



3850 Portland Rd NE  
Salem, OR 97310  
(503) 378-3739  
FAX (503) 378-8130

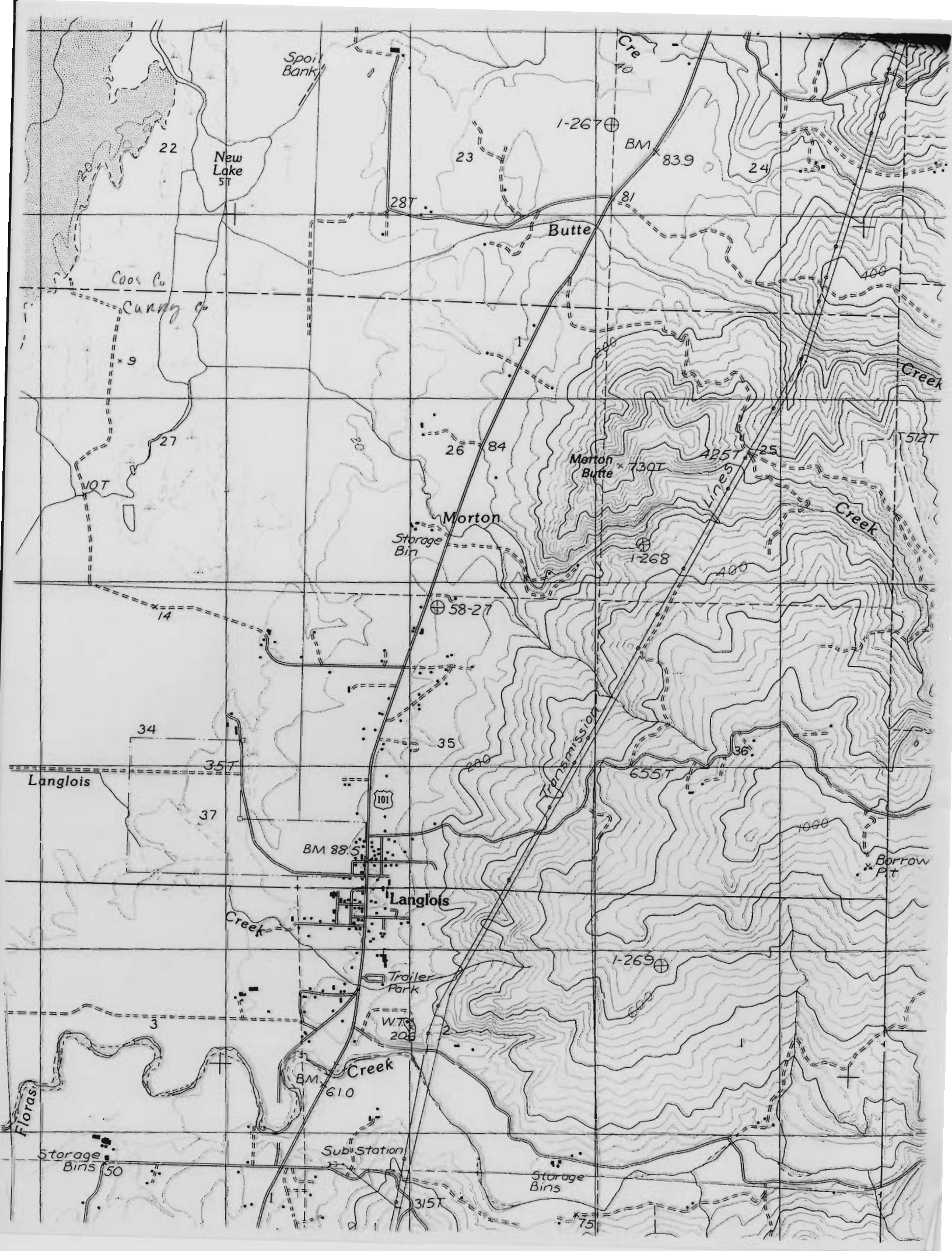

January 20, 1993

MILTON P SMITH  
PO BOX 6  
LANGLOIS OR 97450

Dear MR SMITH,

This will acknowledge that your Surface Water Registration Statement in the name of MILTON P SMITH has been received by our office. The fees in the amount of \$200.00 have been received and our receipt #95269 is enclosed. Your registration statement has been numbered SWR-151.

Our office will review your form and map in the near future. If necessary we will schedule a meeting with you that will include a site inspection. If there are problems with your form we are usually able to take care of them during our visit. We will be able to answer any questions you might have about the adjudication process at that time.

Please feel free to contact this office if you have any questions.

Sincerely,

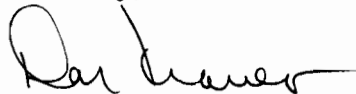

Don Knauer  
Adjudication Specialist

Enclosure

C:\WP51\SWR\CLAIMANT\SWR-0151.001



3850 Portland Rd NE  
Salem, OR 97310  
(503) 378-3739  
FAX (503) 378-8130





**JAMES F. GOSSON** Consulting Engineer

CIVIL ENGINEER  
LAND SURVEYOR  
WATER RIGHTS EXAMINER

580 South State Street  
Sutherlin, Oregon 97479

(503) 459-2243

September 30, 1993

Oregon Water Resources Department  
3850 Portland Road, N.E.  
Salem, Oregon 97310

Attention: Don Knauer

Re: SWR - 151 (Smith)

In response to your letter of June 28, 1993, enclosed is a supplemental sheet listing the place of use by 1/4 1/4 section.

Please contact me if you need additional information.

Very truly yours,

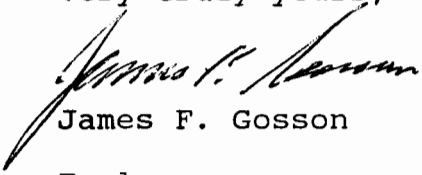
  
James F. Gosson

Enclosures

JFG/b  
b:95-182

**RECEIVED**  
OCT 01 1993  
WATER RESOURCES DEPT.  
SALEM, OREGON



REGISTRATION STATEMENT MAP  
PRE-1909 VESTED WATER RIGHT CLAIM

IN THE NAME OF MILTON SMITH

SECTIONS 23 & 26, TOWNSHIP 30 SOUTH, RANGE 15 WEST, W.M.

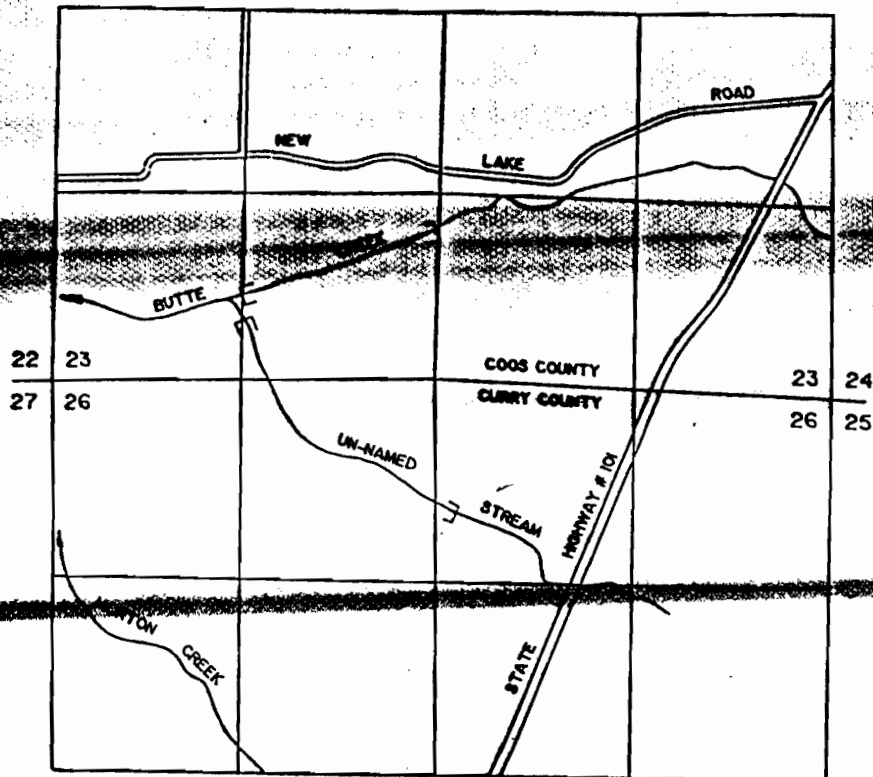

[-] STOCKWATERING LIMITS

WATER RESOURCES DEPT.  
SALEM, OREGON

DEC 18 1992

RECEIVED

THE PURPOSE OF THIS MAP IS TO IDENTIFY THE LOCATION OF THE  
WATER RIGHT. IT IS NOT INTENDED TO PROVIDE INFORMATION  
RELATIVE TO THE LOCATION OF PROPERTY OWNERSHIP BOUNDARY LINES.

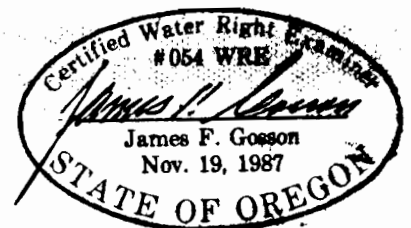

January 27, 1993

JAN 27 1993

Don Knauer

Dear Mr. Knauer,

Enclosed is additional information for Surface Water Registration Statement number SWR-151. Hopefully these copies of Real and Personal Property Tax forms will be of use to you in preparation of the livestock Water Right.

Thank you.

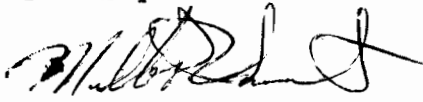

Milton P. Smith

State of Oregon        )  
                          )        SS  
County of Coos        )

Reed Adelbert Gallier, Jr. being first duly sworn, makes this his affidavit and states:

My name is Reed Adelbert Gallier, Jr.

I am a nephew of Edmund Gallier, deceased, and his wife Edith Gallier, deceased, who was the daughter of Wallace Pomeroy and who had a dairy on New Lake Road, West of Highway 101 (then Roosevelt Highway).

In 1929, when I was an 8-year old boy my mother and father operated a restaurant in Bandon, Oregon. Because of the demands of the business on their time they would send me down to Mr. Pomeroy's dairy to stay with him on weekends and during the summer. I remember I would "get in" the cows (Jerseys) in the dark and we would milk them, putting the milk in cans on a platform out by the road where they would be picked up by the "milk truck".

I remember part of my duties was to clean the manure out of the barn. We then milked again in the evening.

I recall that my Aunt Edith used to tell stories about how she had to help with the milking and the chickens in the early morning before they saddled her horse for her ride to school in Langlois. She also was required to assist with the evening milking. I remember this to be remarkable because she was only 9 years old. She was born in 1901.

When I was there in the summer I recall helping with the haying and manure spreading on the pastures. Mr. Pomeroy had a brother who had a dairy about a quarter section to the West, which cornered on a section corner.

Further Affiant saith not.

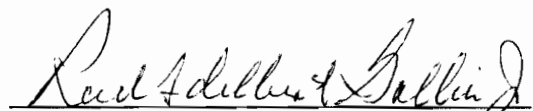
  
Reed Adelbert Gallier, Jr.

The foregoing was subscribed and sworn to before me by Reed Adelbert Gallier, Jr this 11th day of December, 1992.

  
Faith H. Sherrill  
Notary Public



CONTINUING ASSESSMENT ROLL OF TAXABLE REAL PROPERTIES OF COOS

|                          |   |  |  |             |         |                |
|--------------------------|---|--|--|-------------|---------|----------------|
| ORIGINAL RECORD<br>17463 | Parcel #14, Serial Number 17700 (Per 17944) |  | DESCRIPTION OF PROPERTY                                |             |         |                |
|                          |   |  | SUBDIVISION  | PLOT NUMBER | SECTION | TOWNSHIP SOUTH |
|                          |   |  | Lots 3,6   | 6           | 23      | 30             |
|                          |   |  | Sec. 1.3 acres County Road<br>Sec. 0.92 acre Tax Lot 5 |             |         |                |

| YEAR OF ASSESSMENT | GRID SQUARE |     | NAME OF OWNER | TOTAL ACRES | ACREAGE AND VALUES |       |                    |       |              |       |                         |                                |             |
|--------------------|-------------|-----|---------------|-------------|--------------------|-------|--------------------|-------|--------------|-------|-------------------------|--------------------------------|-------------|
|                    | 74          | 309 |               |             | TILLABLE ACRES     | VALUE | NON-TILLABLE ACRES | VALUE | TINNER ACRES | VALUE | STRUCTURAL IMPROVEMENTS | APPROX MACHINERY AND EQUIPMENT | TOTAL VALUE |
| 1943               | 74          | 309 | W.P. Pomery   |             |                    |       |                    |       |              |       |                         |                                |             |
| 17463              | 74          | 309 | W.P. Pomery   | 779.20      | 16.44              | 1365  | 62.76              | 125   |              | 140   |                         | 1740                           |             |
|                    |             |     |               |             |                    |       |                    |       |              |       |                         |                                |             |
|                    |             |     |               |             |                    |       |                    |       |              |       |                         |                                |             |

RECEIVED

JAN 29 1993

WATER RESOURCES DEPT.  
SALEM, OREGON

CONTINUING ASSESSMENT ROLL OF TAXABLE REAL PROPERTIES OF CO

A BLANK ENTRY INDICATES THE PRIOR YEAR'S VALUE HAS BEEN CARRIED FORWARD SERIAL NUMBER

RECEIVED

18699-1

JAN 29 1993

WATER RESOURCES DEPT.  
SALEM, OREGON

DESCRIPTION OF PROPERTY

MUNICIPALITY

TAX LOT NUMBER

SECTION

TOWNSHIP

6-1

23

3

*Over for 1971*

YEAR OF ASSESSMENT  
DEED RECORD  
V.L. PAGE

NAME OF OWNER

TOTAL ACRES

ACREAGE AND VALUES

TILLABLE ACRES

VALUE

NON-TILLABLE ACRES

VALUE

TIMBER ACRES

VALUE

STRUCTURAL IMPROVEMENTS

AFFIXED MACHINERY AND EQUIPMENT

TOTAL VALUE

| YEAR OF ASSESSMENT | DEED RECORD V.L. | PAGE | NAME OF OWNER        | TOTAL ACRES | TILLABLE ACRES | VALUE | NON-TILLABLE ACRES | VALUE      | TIMBER ACRES | VALUE | STRUCTURAL IMPROVEMENTS | AFFIXED MACHINERY AND EQUIPMENT | TOTAL VALUE |
|--------------------|------------------|------|----------------------|-------------|----------------|-------|--------------------|------------|--------------|-------|-------------------------|---------------------------------|-------------|
| 1954               | 229              | 174  | Paul & Lois B. Smith | 58.09       | 16.44          | 1165  | 41.65              | 240        |              |       | 525                     |                                 | 1930        |
| 1955               |                  |      |                      |             |                | 990   |                    | 240        |              |       | 525                     |                                 | 1750        |
| 1956               |                  |      |                      |             |                | 816   |                    | 257        |              |       | 562                     |                                 | 1635        |
| 1957               |                  |      |                      |             |                | 776   |                    | 237        |              |       | 562                     |                                 | 1635        |
| 1957               |                  |      |                      |             |                | 734   |                    | 237        |              |       | 562                     |                                 | 1635        |
| 1958               |                  |      |                      |             |                |       |                    | 650        |              | 25    | 410                     |                                 | 1085        |
| 1961               |                  |      |                      |             |                |       |                    | 785        |              | 30    | 490                     |                                 | 1300        |
| 1961               |                  |      |                      |             |                |       |                    | 785        |              | 30    | 490                     |                                 | 1300        |
| 1961               |                  |      |                      |             |                |       |                    | 785        |              | 30    | 380                     |                                 | 1195        |
| 1962               |                  |      |                      |             |                |       |                    | 790        |              | 30    | 380                     |                                 | 1,200       |
| 1962               |                  |      |                      |             |                |       |                    | 790        |              |       | 380                     |                                 | 1,170       |
| 1967               |                  |      |                      |             |                |       |                    | 3030       |              |       | 380                     |                                 | 3,410       |
| 1968               |                  |      |                      |             |                |       |                    | LAND VALUE | TIMBER VALUE |       | STRUCTURAL IMPROVEMENTS |                                 | LAND VALUE  |
| 1968               |                  |      |                      |             |                |       |                    | 12,110     |              |       |                         |                                 | 1,500       |
| 1970               |                  |      |                      |             |                |       |                    | 12,110     |              |       |                         |                                 | 1,500       |

*Over for 1971*

BARGAIN AND SALE DEED

LOIS B. SMITH, a widow, Grantor, conveys to LOIS B. SMITH, MILTON P. SMITH, and CAROL L. SMITH, not as tenants in common but with full rights of survivorship, Grantee, all of her right, title and interest in that real property situated in COOS County, State of Oregon, described as

The South half of Lot 3 and Lot 6 in Section 23, Township 30 South, Range 15 West of the Willamette Meridian in Coos County, Oregon, except the County Road and except a parcel of land beginning at a point in West line of Government Lot 3, Section 23, Township 30 South, Range 15 West of the Willamette Meridian where the same intersects the South line of New Lake County Road; thence East 132 feet; thence South 297 feet; thence South 76<sup>0</sup> 00' West 136 feet, more or less, to a point due South of beginning; thence North 330 feet along the west line of said Government Lot 3 to beginning, containing 0.92 acre.

No consideration has been given or paid for this transfer, the purpose being to make a change in vesting.

THIS INSTRUMENT WILL NOT ALLOW USE OF THE PROPERTY DESCRIBED IN THIS INSTRUMENT IN VIOLATION OF APPLICABLE LAND USE LAWS AND REGULATIONS. BEFORE SIGNING OR ACCEPTING THIS INSTRUMENT, THE PERSON ACQUIRING FEE TITLE TO THE PROPERTY SHOULD CHECK WITH THE APPROPRIATE CITY OR COUNTY PLANNING DEPARTMENT TO VERIFY APPROVED USES.

Until a change is requested, all tax statements are to be sent to the Grantor at the following address:

Return to: LOIS B. SMITH, PO Box 96, Langlois, OR 97450.

Dated this 9<sup>th</sup> day of ~~August~~ <sup>SEPTEMBER</sup>, 1991.

Grantor:

Lois B Smith  
LOIS B. SMITH, a widow

91-09-0328  
State of Oregon  
County of Coos  
I, Mary Ann Wilson, County Clerk, certify the within instrument was filed for record at  
10:51 AM Sept 10, 1991  
By Mary Ann Wilson Deputy  
#pages 2 STATE OF OREGON 38

RECEIVED

JAN 29 1993

WATER RESOURCES L  
SALEM, OREGON

STATE OF OREGON            )  
                                  )  
County of Curry            )        ss.

On the date last above, personally appeared the above-name LOIS B. SMITH, a widow, and acknowledged the foregoing instrument to be her voluntary act. Before me:

*Richard E. Aufranc*  
Notary Public for Oregon,  
My commission expires: 1-27-95

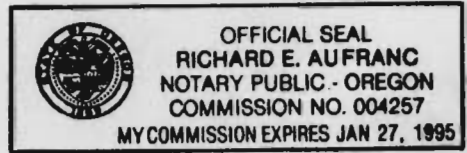

After recording, return to:

LOIS B. SMITH, PO Box 96, Langlois, OR 97450.

COOS COUNTY, OREGON  
 ABSTRACT OF  
 ASSESSMENT & TAX ROLL

1903 1915 1937-38  
 1904 1919 1938-39  
 1905 1924 1942  
 1910 1928 1943  
 1933 1954

| Tax Year | Assess&Tax/<br>Pers. Prop.<br>Roll | Assess&Tax<br>Roll | Personal<br>Property<br>Roll | Vol. No. | Pg. No. | NAME | School<br>Dist. | Sec | Twsp. | Range | LAND DESCRIPTION |
|----------|------------------------------------|--------------------|------------------------------|----------|---------|------|-----------------|-----|-------|-------|------------------|
|          | ✓                                  |                    |                              | 2        | 110     |      | 46              |     |       |       |                  |

| # Acres<br>Tillable<br>Land | \$ of<br>Tillable<br>Land | # Acres<br>Non-Till.<br>Land | \$ of<br>Non-Till.<br>Land | \$ of<br>Bldg &<br>Other Imp. | \$ of<br>Rolling<br>Stock | \$ of Steamboats,<br>Sailboats, Stationery<br>Engines & Manufact'g<br>Machinery | \$ of<br>Merch'ndise &<br>Stock in Trade | Farming Implements<br>Wagons, Carriages<br>Etc. | Household<br>Furniture,<br>Watches,<br>Jewelry Etc. | # of<br>Horses &<br>Mules | \$ of<br>Horses &<br>Mules | # of<br>Cattle | \$ of<br>Cattle | # of<br>Sheep &<br>Goats | \$ of<br>Sheep &<br>Goats | # of<br>Swine | \$ of<br>Swine |
|-----------------------------|---------------------------|------------------------------|----------------------------|-------------------------------|---------------------------|---|--|---|---|---------------------------|----------------------------|----------------|-----------------|--------------------------|---------------------------|---------------|----------------|
|                             |                           | 20<br>100                    | 40<br>250                  | 50                            |                           |   |  |   |   |                           |                            |                |                 |                          |                           |               |                |

Date 1/4/93 Supervisor J Anglin

COOS COUNTY, OREGON  
 ABSTRACT OF  
 ASSESSMENT & TAX ROLL

1937-38

| Tax Year | Assess&Tax/<br>Pers. Prop.<br>Roll | Assess&Tax<br>Roll | Personal<br>Property<br>Roll | Vol. No. | Pg. No. | NAME | School<br>Dist. | Sec | Twsp. | Range | LAND DESCRIPTION |
|----------|------------------------------------|--------------------|------------------------------|----------|---------|------|-----------------|-----|-------|-------|------------------|
|          |                                    |                    |                              |          |         |      |                 |     |       |       |                  |

| # Acres<br>Tillable<br>Land | \$ of<br>Tillable<br>Land | # Acres<br>Non-Till.<br>Land | \$ of<br>Non-Till.<br>Land | \$ of<br>Bldg &<br>Other Imp. | \$ of<br>Rolling<br>Stock | \$ of Steamboats,<br>Sailboats, Stationery<br>Engines & Manufact'g<br>Machinery | \$ of<br>Merch'ndise &<br>Stock in Trade | Farming Implements<br>Wagons, Carriages<br>Etc. | Household<br>Furniture,<br>Watches,<br>Jewelry Etc. | # of<br>Horses &<br>Mules | \$ of<br>Horses &<br>Mules | # of<br>Cattle | \$ of<br>Cattle | # of<br>Sheep &<br>Goats | \$ of<br>Sheep &<br>Goats | # of<br>Swine | \$ of<br>Swine |
|-----------------------------|---------------------------|------------------------------|----------------------------|-------------------------------|---------------------------|---|--|---|---|---------------------------|----------------------------|----------------|-----------------|--------------------------|---------------------------|---------------|----------------|
|                             |                           |                              |                            |                               |                           |   |  |   |   |                           |                            |                |                 |                          |                           |               |                |

Date \_\_\_\_\_ Supervisor \_\_\_\_\_



State of Oregon

SS

County of Coos

I, hereby certify that I have compared this abstract with the original record on file in my office and custody, and that it is a true and correct abstract of that original.

Dated this 4<sup>th</sup> day of Jan, 1993.

COOS COUNTY TAX DEPARTMENT

By Robert Vance

COOS COUNTY, OREGON  
 ABSTRACT OF  
 ASSESSMENT & TAX ROLL

| Tax Year                    | Assess&Tax/<br>Pers. Prop.<br>Roll | Assess&Tax<br>Roll           | Personal<br>Property<br>Roll | Vol. No.                      | Pg. No.                   | NAME  | School<br>Dist.                          | Sec   | Twsp.   | Range                     | LAND DESCRIPTION                            |                |                 |                          |                           |               |                |
|-----------------------------|------------------------------------|------------------------------|------------------------------|-------------------------------|---------------------------|---|--|---|---|---------------------------|---|----------------|-----------------|--------------------------|---------------------------|---------------|----------------|
| 1994                        | ✓                                  |                              |                              | 2                             | 80                        | Shirley   |  |   |   |                           | Lots 246<br>234 & 106<br>230-715<br>230-725 |                |                 |                          |                           |               |                |
| # Acres<br>Tillable<br>Land | \$ of<br>Tillable<br>Land          | # Acres<br>Non-Till.<br>Land | \$ of<br>Non-Till.<br>Land   | \$ of<br>Bldg &<br>Other Imp. | \$ of<br>Rolling<br>Stock | \$ of Steamboats,<br>Sailboats, Stationery<br>Engines & Manufact'g<br>Machinery | \$ of<br>Merch'ndise &<br>Stock in Trade | Farming Implements<br>Wagons, Carriages<br>Etc. | Household<br>Furniture,<br>Watches,<br>Jewelry Etc. | # of<br>Horses &<br>Mules | \$ of<br>Horses &<br>Mules                  | # of<br>Cattle | \$ of<br>Cattle | # of<br>Sheep &<br>Goats | \$ of<br>Sheep &<br>Goats | # of<br>Swine | \$ of<br>Swine |
| 160                         |                                    | 76                           | 55                           | 200                           |                           |   |  |   |   | 0                         | 60  | 1              | 20              |                          |                           | 2             | 7              |

Date 12/21/92 Supervisor Jamie Anglin

COOS COUNTY, OREGON  
 ABSTRACT OF  
 ASSESSMENT & TAX ROLL

JAN 4 1993

| Tax Year                    | Assess&Tax/<br>Pers. Prop.<br>Roll | Assess&Tax<br>Roll           | Personal<br>Property<br>Roll | Vol. No.                      | Pg. No.                   | NAME  | School<br>Dist.                          | Sec   | Twsp.   | Range                     | LAND DESCRIPTION           |                |                 |                          |                           |               |                |
|-----------------------------|------------------------------------|------------------------------|------------------------------|-------------------------------|---------------------------|---|--|---|---|---------------------------|----------------------------|----------------|-----------------|--------------------------|---------------------------|---------------|----------------|
| 1994                        | ✓                                  |                              |                              |                               |                           | Shirley   | 46                                       | 22  | 30  | 1                         | 230-715<br>230-725         |                |                 |                          |                           |               |                |
| # Acres<br>Tillable<br>Land | \$ of<br>Tillable<br>Land          | # Acres<br>Non-Till.<br>Land | \$ of<br>Non-Till.<br>Land   | \$ of<br>Bldg &<br>Other Imp. | \$ of<br>Rolling<br>Stock | \$ of Steamboats,<br>Sailboats, Stationery<br>Engines & Manufact'g<br>Machinery | \$ of<br>Merch'ndise &<br>Stock in Trade | Farming Implements<br>Wagons, Carriages<br>Etc. | Household<br>Furniture,<br>Watches,<br>Jewelry Etc. | # of<br>Horses &<br>Mules | \$ of<br>Horses &<br>Mules | # of<br>Cattle | \$ of<br>Cattle | # of<br>Sheep &<br>Goats | \$ of<br>Sheep &<br>Goats | # of<br>Swine | \$ of<br>Swine |
| 40                          |                                    | 40                           |                              |                               |                           |   |  |   | 60  | 1                         | 20                         | 14             | 20              |                          |                           | 2             | 7              |

Date 12/21/92 Supervisor Jamie Anglin

State of Oregon

SS

County of Coos

I, hereby certify that I have compared this abstract with the original record on file in my office and custody, and that it is a true and correct abstract of that original.

Dated this 4<sup>th</sup> day of January, 1993.

COOS COUNTY TAX DEPARTMENT

BY Roberta Vance

COOS COUNTY, OREGON  
 ABSTRACT OF  
 ASSESSMENT & TAX ROLL

| Tax Year                    | Assess&Tax/<br>Pers. Prop.<br>Roll | Assess&Tax<br>Roll           | Personal<br>Property<br>Roll | Vol. No.                      | Pg. No.                   | NAME  | School<br>Dist.                          | Sec   | Twsp.   | Range                     | LAND DESCRIPTION           |                |                 |                          |                           |               |                |  |
|-----------------------------|------------------------------------|------------------------------|------------------------------|-------------------------------|---------------------------|---|--|---|---|---------------------------|----------------------------|----------------|-----------------|--------------------------|---------------------------|---------------|----------------|--|
| 1992                        |                                    |                              | X                            | 1                             | 122                       | WP  | 116                                      |   |   |                           | /                          |                |                 |                          |                           |               |                |  |
| # Acres<br>Tillable<br>Land | \$ of<br>Tillable<br>Land          | # Acres<br>Non-Till.<br>Land | \$ of<br>Non-Till.<br>Land   | \$ of<br>Bldg &<br>Other Imp. | \$ of<br>Rolling<br>Stock | \$ of Steamboats,<br>Sailboats, Stationery<br>Engines & Manufact'g<br>Machinery | \$ of<br>Merch'ndise &<br>Stock in Trade | Farming Implements<br>Wagons, Carriages<br>Etc. | Household<br>Furniture,<br>Watches,<br>Jewelry Etc. | # of<br>Horses &<br>Mules | \$ of<br>Horses &<br>Mules | # of<br>Cattle | \$ of<br>Cattle | # of<br>Sheep &<br>Goats | \$ of<br>Sheep &<br>Goats | # of<br>Swine | \$ of<br>Swine |  |
|                             |                                    |                              |                              |                               |                           |   |  | 20  | 50  | 2                         | 20                         | 15             | 5.5             |                          |                           | 2             | 5              |  |

Date 12/21/92 Supervisor Janice Anglin

COOS COUNTY, OREGON  
 ABSTRACT OF  
 ASSESSMENT & TAX ROLL

1993

| Tax Year                    | Assess&Tax/<br>Pers. Prop.<br>Roll | Assess&Tax<br>Roll           | Personal<br>Property<br>Roll | Vol. No.                      | Pg. No.                   | NAME  | School<br>Dist.                          | Sec   | Twsp.   | Range                     | LAND DESCRIPTION           |                |                 |                          |                           |               |                |  |
|-----------------------------|------------------------------------|------------------------------|------------------------------|-------------------------------|---------------------------|---|--|---|---|---------------------------|----------------------------|----------------|-----------------|--------------------------|---------------------------|---------------|----------------|--|
| 1993                        |                                    |                              | X                            | 1                             | 122                       | WP  | 46                                       |   |   |                           | /                          |                |                 |                          |                           |               |                |  |
| # Acres<br>Tillable<br>Land | \$ of<br>Tillable<br>Land          | # Acres<br>Non-Till.<br>Land | \$ of<br>Non-Till.<br>Land   | \$ of<br>Bldg &<br>Other Imp. | \$ of<br>Rolling<br>Stock | \$ of Steamboats,<br>Sailboats, Stationery<br>Engines & Manufact'g<br>Machinery | \$ of<br>Merch'ndise &<br>Stock in Trade | Farming Implements<br>Wagons, Carriages<br>Etc. | Household<br>Furniture,<br>Watches,<br>Jewelry Etc. | # of<br>Horses &<br>Mules | \$ of<br>Horses &<br>Mules | # of<br>Cattle | \$ of<br>Cattle | # of<br>Sheep &<br>Goats | \$ of<br>Sheep &<br>Goats | # of<br>Swine | \$ of<br>Swine |  |
|                             |                                    |                              |                              |                               |                           |   |  |   |   | 4                         | 200                        | 14             | 270             |                          | 65                        |               | 100            |  |

Date 12/21/92 Supervisor Janice Anglin

State of Oregon

SS

County of Coos

I, hereby certify that I have compared this abstract with the original record on file in my office and custody, and that it is a true and correct abstract of that original.

Dated this 4<sup>th</sup> day of January, 1993.

COOS COUNTY TAX DEPARTMENT

By Roberta Vance

COOS COUNTY, OREGON  
 ABSTRACT OF  
 ASSESSMENT & TAX ROLL

| Tax Year | Assess&Tax/<br>Pers. Prop.<br>Roll | Assess&Tax<br>Roll | Personal<br>Property<br>Roll | Vol. No. | Pg. No. | NAME         | School<br>Dist. | Sec | Twsp. | Range | LAND DESCRIPTION |
|----------|------------------------------------|--------------------|------------------------------|----------|---------|--------------|-----------------|-----|-------|-------|------------------|
| 1925     |                                    |                    | ✓                            | 1        | 163     | 9. [unclear] | 46              |     |       |       | /                |

| # Acres<br>Tillable<br>Land | \$ of<br>Tillable<br>Land | # Acres<br>Non-Till.<br>Land | \$ of<br>Non-Till.<br>Land | \$ of<br>Bldg &<br>Other Imp. | \$ of<br>Rolling<br>Stock | \$ of Steamboats,<br>Sailboats, Stationery<br>Engines & Manufact'g<br>Machinery | \$ of<br>Merch'ndise &<br>Stock in Trade | Farming Implements<br>Wagons, Carriages<br>Etc. | Household<br>Furniture,<br>Watches,<br>Jewelry Etc. | # of<br>Horses &<br>Mules | \$ of<br>Horses &<br>Mules | # of<br>Cattle | \$ of<br>Cattle | # of<br>Sheep &<br>Goats | \$ of<br>Sheep &<br>Goats | # of<br>Swine | \$ of<br>Swine |
|-----------------------------|---------------------------|------------------------------|----------------------------|-------------------------------|---------------------------|---|--|---|---|---------------------------|----------------------------|----------------|-----------------|--------------------------|---------------------------|---------------|----------------|
| -                           | -                         | -                            | -                          | -                             | -                         | 275   | -  | 50  | -   | 2                         | 200                        | 87             | 200             | -                        | -                         | 1             | 25             |

Date 12/2/25 Supervisor J. Burt

COOS COUNTY, OREGON  
 ABSTRACT OF  
 ASSESSMENT & TAX ROLL

JAN 6 1933

| Tax Year | Assess&Tax/<br>Pers. Prop.<br>Roll | Assess&Tax<br>Roll | Personal<br>Property<br>Roll | Vol. No. | Pg. No. | NAME   | School<br>Dist. | Sec | Twsp. | Range | LAND DESCRIPTION      |
|----------|------------------------------------|--------------------|------------------------------|----------|---------|--------|-----------------|-----|-------|-------|-----------------------|
| 1925     | -                                  | ✓                  | -                            | 2        | 201     | Pomroy | 46              | 33  | 30    | 15    | S 24 N 21 W<br>R 15 E |

| # Acres<br>Tillable<br>Land | \$ of<br>Tillable<br>Land | # Acres<br>Non-Till.<br>Land | \$ of<br>Non-Till.<br>Land | \$ of<br>Bldg &<br>Other Imp. | \$ of<br>Rolling<br>Stock | \$ of Steamboats,<br>Sailboats, Stationery<br>Engines & Manufact'g<br>Machinery | \$ of<br>Merch'ndise &<br>Stock in Trade | Farming Implements<br>Wagons, Carriages<br>Etc. | Household<br>Furniture,<br>Watches,<br>Jewelry Etc. | # of<br>Horses &<br>Mules | \$ of<br>Horses &<br>Mules | # of<br>Cattle | \$ of<br>Cattle | # of<br>Sheep &<br>Goats | \$ of<br>Sheep &<br>Goats | # of<br>Swine | \$ of<br>Swine |
|-----------------------------|---------------------------|------------------------------|----------------------------|-------------------------------|---------------------------|---|--|---|---|---------------------------|----------------------------|----------------|-----------------|--------------------------|---------------------------|---------------|----------------|
| 4                           | 500                       | 2                            | 350                        | 150                           | -                         | -   | -  | -   | -   | -                         | -                          | -              | -               | -                        | -                         | -             | -              |

Date 12/2/25 Supervisor J. Burt

State of Oregon

SS

County of Coos

I, hereby certify that I have compared this abstract with the original record on file in my office and custody, and that it is a true and correct abstract of that original.

Dated this 4<sup>th</sup> day of January, 1993.

COOS COUNTY TAX DEPARTMENT

BY Roberta Vance

COOS COUNTY, OREGON  
 ABSTRACT OF  
 ASSESSMENT & TAX ROLL

| Tax Year                    | Assess&Tax/<br>Pers. Prop.<br>Roll | Assess&Tax<br>Roll           | Personal<br>Property<br>Roll | Vol. No.                      | Pg. No.                   | NAME  | School<br>Dist.                          | Sec   | Twsp.   | Range                     | LAND DESCRIPTION           |                |                 |                          |                           |               |                |
|-----------------------------|------------------------------------|------------------------------|------------------------------|-------------------------------|---------------------------|---|--|---|---|---------------------------|----------------------------|----------------|-----------------|--------------------------|---------------------------|---------------|----------------|
| 1992                        |                                    | ✓                            |                              | 3                             | 152                       |   | 46                                       | 23  | 30  | 15                        |                            |                |                 |                          |                           |               |                |
| # Acres<br>Tillable<br>Land | \$ of<br>Tillable<br>Land          | # Acres<br>Non-Till.<br>Land | \$ of<br>Non-Till.<br>Land   | \$ of<br>Bldg &<br>Other Imp. | \$ of<br>Rolling<br>Stock | \$ of Steamboats,<br>Sailboats, Stationery<br>Engines & Manufact'g<br>Machinery | \$ of<br>Merch'ndise &<br>Stock in Trade | Farming Implements<br>Wagons, Carriages<br>Etc. | Household<br>Furniture,<br>Watches,<br>Jewelry Etc. | # of<br>Horses &<br>Mules | \$ of<br>Horses &<br>Mules | # of<br>Cattle | \$ of<br>Cattle | # of<br>Sheep &<br>Goats | \$ of<br>Sheep &<br>Goats | # of<br>Swine | \$ of<br>Swine |
| 40                          | 142                                | 3                            | 100                          |                               |                           |   |  |   |   |                           |                            |                |                 |                          |                           |               |                |

Date 12/21/92 Supervisor Janice Anglin

COOS COUNTY, OREGON  
 ABSTRACT OF  
 ASSESSMENT & TAX ROLL

| Tax Year                    | Assess&Tax/<br>Pers. Prop.<br>Roll | Assess&Tax<br>Roll           | Personal<br>Property<br>Roll | Vol. No.                      | Pg. No.                   | NAME  | School<br>Dist.                          | Sec   | Twsp.   | Range                     | LAND DESCRIPTION           |                |                 |                          |                           |               |                |
|-----------------------------|------------------------------------|------------------------------|------------------------------|-------------------------------|---------------------------|---|--|---|---|---------------------------|----------------------------|----------------|-----------------|--------------------------|---------------------------|---------------|----------------|
|                             |                                    |                              | ✓                            | 1                             | 110                       |   |  |   |   |                           |                            |                |                 |                          |                           |               |                |
| # Acres<br>Tillable<br>Land | \$ of<br>Tillable<br>Land          | # Acres<br>Non-Till.<br>Land | \$ of<br>Non-Till.<br>Land   | \$ of<br>Bldg &<br>Other Imp. | \$ of<br>Rolling<br>Stock | \$ of Steamboats,<br>Sailboats, Stationery<br>Engines & Manufact'g<br>Machinery | \$ of<br>Merch'ndise &<br>Stock in Trade | Farming Implements<br>Wagons, Carriages<br>Etc. | Household<br>Furniture,<br>Watches,<br>Jewelry Etc. | # of<br>Horses &<br>Mules | \$ of<br>Horses &<br>Mules | # of<br>Cattle | \$ of<br>Cattle | # of<br>Sheep &<br>Goats | \$ of<br>Sheep &<br>Goats | # of<br>Swine | \$ of<br>Swine |
|                             |                                    |                              |                              |                               |                           |   |  |   |   |                           |                            | 8              | 200             |                          |                           |               |                |

Date 12/21/92 Supervisor Janice Anglin



State of Oregon

ss

County of Coos

I, hereby certify that I have compared this abstract with the original record on file in my office and custody, and that it is a true and correct abstract of that original.

Dated this 4<sup>th</sup> day of January, 1993.

COOS COUNTY TAX DEPARTMENT

By Roberta Lance

COOS COUNTY, OREGON  
 ABSTRACT OF  
 ASSESSMENT & TAX ROLL

| Tax Year | Assess&Tax/<br>Pers. Prop.<br>Roll | Assess&Tax<br>Roll | Personal<br>Property<br>Roll | Vol. No. | Pg. No. | NAME | School<br>Dist. | Sec | Twsp. | Range | LAND DESCRIPTION |
|----------|------------------------------------|--------------------|------------------------------|----------|---------|------|-----------------|-----|-------|-------|------------------|
| 1991     |                                    |                    | 6                            | 1        | 110     |      |                 |     |       |       |                  |

| # Acres<br>Tillable<br>Land | \$ of<br>Tillable<br>Land | # Acres<br>Non-Till.<br>Land | \$ of<br>Non-Till.<br>Land | \$ of<br>Bldg &<br>Other Imp. | \$ of<br>Rolling<br>Stock | \$ of Steamboats,<br>Sailboats, Stationery<br>Engines & Manufact'g<br>Machinery | \$ of<br>Merch'ndise &<br>Stock in Trade | Farming Implements<br>Wagons, Carriages<br>Etc. | Household<br>Furniture,<br>Watches,<br>Jewelry Etc. | # of<br>Horses &<br>Mules | \$ of<br>Horses &<br>Mules | # of<br>Cattle | \$ of<br>Cattle | # of<br>Sheep &<br>Goats | \$ of<br>Sheep &<br>Goats | # of<br>Swine | \$ of<br>Swine |
|-----------------------------|---------------------------|------------------------------|----------------------------|-------------------------------|---------------------------|---|--|---|---|---------------------------|----------------------------|----------------|-----------------|--------------------------|---------------------------|---------------|----------------|
|                             |                           |                              |                            |                               |                           |   |  |   |   |                           |                            |                |                 |                          |                           |               |                |

Date 1-4-93 Supervisor R Kimball

COOS COUNTY, OREGON  
 ABSTRACT OF  
 ASSESSMENT & TAX ROLL

| Tax Year | Assess&Tax/<br>Pers. Prop.<br>Roll | Assess&Tax<br>Roll | Personal<br>Property<br>Roll | Vol. No. | Pg. No. | NAME | School<br>Dist. | Sec | Twsp. | Range | LAND DESCRIPTION |
|----------|------------------------------------|--------------------|------------------------------|----------|---------|------|-----------------|-----|-------|-------|------------------|
| 1991     |                                    |                    |                              | 3        |         |      | 46              |     | 2     |       |                  |

| # Acres<br>Tillable<br>Land | \$ of<br>Tillable<br>Land | # Acres<br>Non-Till.<br>Land | \$ of<br>Non-Till.<br>Land | \$ of<br>Bldg &<br>Other Imp. | \$ of<br>Rolling<br>Stock | \$ of Steamboats,<br>Sailboats, Stationery<br>Engines & Manufact'g<br>Machinery | \$ of<br>Merch'ndise &<br>Stock in Trade | Farming Implements<br>Wagons, Carriages<br>Etc. | Household<br>Furniture,<br>Watches,<br>Jewelry Etc. | # of<br>Horses &<br>Mules | \$ of<br>Horses &<br>Mules | # of<br>Cattle | \$ of<br>Cattle | # of<br>Sheep &<br>Goats | \$ of<br>Sheep &<br>Goats | # of<br>Swine | \$ of<br>Swine |
|-----------------------------|---------------------------|------------------------------|----------------------------|-------------------------------|---------------------------|---|--|---|---|---------------------------|----------------------------|----------------|-----------------|--------------------------|---------------------------|---------------|----------------|
| 76                          |                           |                              |                            |                               |                           |   |  |   |   |                           |                            |                |                 |                          |                           |               |                |

Date 1-4-93 Supervisor R Kimball

State of Oregon  
ss  
County of Coos

I, hereby certify that I have compared this abstract with the original record on file in my office and custody, and that it is a true and correct abstract of that original.

Dated this 4th day of January, 1993.

COOS COUNTY TAX DEPARTMENT

BY Robert Vance

COOS COUNTY, OREGON  
 ABSTRACT OF  
 ASSESSMENT & TAX ROLL

| Tax Year                    | Assess&Tax/<br>Pers. Prop.<br>Roll | Assess&Tax<br>Roll           | Personal<br>Property<br>Roll | Vol. No.                      | Pg. No.                   | NAME  | School<br>Dist.                          | Sec   | Twsp.   | Range                     | LAND DESCRIPTION           |                |                 |                          |                           |               |                |
|-----------------------------|------------------------------------|------------------------------|------------------------------|-------------------------------|---------------------------|---|--|---|---|---------------------------|----------------------------|----------------|-----------------|--------------------------|---------------------------|---------------|----------------|
|                             |                                    | ✓                            |                              |                               |                           |   | 46                                       |   |   |                           |                            |                |                 |                          |                           |               |                |
| # Acres<br>Tillable<br>Land | \$ of<br>Tillable<br>Land          | # Acres<br>Non-Till.<br>Land | \$ of<br>Non-Till.<br>Land   | \$ of<br>Bldg &<br>Other Imp. | \$ of<br>Rolling<br>Stock | \$ of Steamboats,<br>Sailboats, Stationery<br>Engines & Manufact'g<br>Machinery | \$ of<br>Merch'ndise &<br>Stock in Trade | Farming Implements<br>Wagons, Carriages<br>Etc. | Household<br>Furniture,<br>Watches,<br>Jewelry Etc. | # of<br>Horses &<br>Mules | \$ of<br>Horses &<br>Mules | # of<br>Cattle | \$ of<br>Cattle | # of<br>Sheep &<br>Goats | \$ of<br>Sheep &<br>Goats | # of<br>Swine | \$ of<br>Swine |
|                             |                                    | 6.25                         |                              |                               |                           |   |  |   |   |                           |                            |                |                 |                          |                           |               |                |

Date 1-4-93 Supervisor R. Kimball

COOS COUNTY, OREGON  
 ABSTRACT OF  
 ASSESSMENT & TAX ROLL

| Tax Year                    | Assess&Tax/<br>Pers. Prop.<br>Roll | Assess&Tax<br>Roll           | Personal<br>Property<br>Roll | Vol. No.                      | Pg. No.                   | NAME  | School<br>Dist.                          | Sec   | Twsp.   | Range                     | LAND DESCRIPTION           |                |                 |                          |                           |               |                |
|-----------------------------|------------------------------------|------------------------------|------------------------------|-------------------------------|---------------------------|---|--|---|---|---------------------------|----------------------------|----------------|-----------------|--------------------------|---------------------------|---------------|----------------|
|                             |                                    |                              | ✓                            | 1                             |                           |   | <del>46</del><br>54                      |   |   |                           |                            |                |                 |                          |                           |               |                |
| # Acres<br>Tillable<br>Land | \$ of<br>Tillable<br>Land          | # Acres<br>Non-Till.<br>Land | \$ of<br>Non-Till.<br>Land   | \$ of<br>Bldg &<br>Other Imp. | \$ of<br>Rolling<br>Stock | \$ of Steamboats,<br>Sailboats, Stationery<br>Engines & Manufact'g<br>Machinery | \$ of<br>Merch'ndise &<br>Stock in Trade | Farming Implements<br>Wagons, Carriages<br>Etc. | Household<br>Furniture,<br>Watches,<br>Jewelry Etc. | # of<br>Horses &<br>Mules | \$ of<br>Horses &<br>Mules | # of<br>Cattle | \$ of<br>Cattle | # of<br>Sheep &<br>Goats | \$ of<br>Sheep &<br>Goats | # of<br>Swine | \$ of<br>Swine |
|                             |                                    |                              |                              |                               |                           | 150   |  |   |   |                           |                            | 14             |                 |                          |                           |               |                |

Date 1-4-93 Supervisor R. Kimball

State of Oregon

SS

County of Coos

I, hereby certify that I have compared this abstract with the original record on file in my office and custody, and that it is a true and correct abstract of that original.

Dated this 4<sup>th</sup> day of January, 1993.

COOS COUNTY TAX DEPARTMENT

BY Roberta Vance

COOS COUNTY, OREGON  
 ABSTRACT OF  
 ASSESSMENT & TAX ROLL

| Tax Year                    | Assess&Tax/<br>Pers. Prop.<br>Roll | Assess&Tax<br>Roll           | Personal<br>Property<br>Roll | Vol. No.                      | Pg. No.                   | NAME  | School<br>Dist.                          | Sec   | Twsp.   | Range                     | LAND DESCRIPTION           |                |                 |                          |                           |               |                |  |
|-----------------------------|------------------------------------|------------------------------|------------------------------|-------------------------------|---------------------------|---|--|---|---|---------------------------|----------------------------|----------------|-----------------|--------------------------|---------------------------|---------------|----------------|--|
|                             |                                    |                              |                              |                               |                           |   |  |   |   |                           |                            |                |                 |                          |                           |               |                |  |
|                             |                                    |                              |                              |                               |                           |   |  |   |   |                           |                            |                |                 |                          |                           |               |                |  |
| # Acres<br>Tillable<br>Land | \$ of<br>Tillable<br>Land          | # Acres<br>Non-Till.<br>Land | \$ of<br>Non-Till.<br>Land   | \$ of<br>Bldg &<br>Other Imp. | \$ of<br>Rolling<br>Stock | \$ of Steamboats,<br>Sailboats, Stationery<br>Engines & Manufact'g<br>Machinery | \$ of<br>Merch'ndise &<br>Stock in Trade | Farming Implements<br>Wagons, Carriages<br>Etc. | Household<br>Furniture,<br>Watches,<br>Jewelry Etc. | # of<br>Horses &<br>Mules | \$ of<br>Horses &<br>Mules | # of<br>Cattle | \$ of<br>Cattle | # of<br>Sheep &<br>Goats | \$ of<br>Sheep &<br>Goats | # of<br>Swine | \$ of<br>Swine |  |
| 12                          | 1245                               | 6                            | 425                          | 200                           |                           |   |  |   |   |                           |                            |                |                 |                          |                           |               |                |  |

Date 1-4-93 Supervisor R. Kimball

COOS COUNTY, OREGON  
 ABSTRACT OF  
 ASSESSMENT & TAX ROLL

JAN

| Tax Year                    | Assess&Tax/<br>Pers. Prop.<br>Roll | Assess&Tax<br>Roll           | Personal<br>Property<br>Roll | Vol. No.                      | Pg. No.                   | NAME  | School<br>Dist.                          | Sec   | Twsp.   | Range                     | LAND DESCRIPTION           |                |                 |                          |                           |               |                |  |
|-----------------------------|------------------------------------|------------------------------|------------------------------|-------------------------------|---------------------------|---|--|---|---|---------------------------|----------------------------|----------------|-----------------|--------------------------|---------------------------|---------------|----------------|--|
|                             |                                    |                              |                              |                               |                           |   |  |   |   |                           |                            |                |                 |                          |                           |               |                |  |
|                             |                                    |                              |                              |                               |                           |   |  |   |   |                           |                            |                |                 |                          |                           |               |                |  |
| # Acres<br>Tillable<br>Land | \$ of<br>Tillable<br>Land          | # Acres<br>Non-Till.<br>Land | \$ of<br>Non-Till.<br>Land   | \$ of<br>Bldg &<br>Other Imp. | \$ of<br>Rolling<br>Stock | \$ of Steamboats,<br>Sailboats, Stationery<br>Engines & Manufact'g<br>Machinery | \$ of<br>Merch'ndise &<br>Stock in Trade | Farming Implements<br>Wagons, Carriages<br>Etc. | Household<br>Furniture,<br>Watches,<br>Jewelry Etc. | # of<br>Horses &<br>Mules | \$ of<br>Horses &<br>Mules | # of<br>Cattle | \$ of<br>Cattle | # of<br>Sheep &<br>Goats | \$ of<br>Sheep &<br>Goats | # of<br>Swine | \$ of<br>Swine |  |
|                             |                                    |                              |                              |                               |                           |   |  |   |   |                           |                            |                |                 |                          |                           |               |                |  |

Date 1-4-93 Supervisor R. Kimball

State of Oregon

SS

County of Coos

I, hereby certify that I have compared this abstract with the original record on file in my office and custody, and that it is a true and correct abstract of that original.

Dated this 4<sup>th</sup> day of January, 1993.

COOS COUNTY TAX DEPARTMENT

BY Robert Vance

COOS COUNTY, OREGON  
 ABSTRACT OF  
 ASSESSMENT & TAX ROLL

| Tax Year                    | Assess&Tax/<br>Pers. Prop.<br>Roll | Assess&Tax<br>Roll           | Personal<br>Property<br>Roll | Vol. No.                      | Pg. No.                   | NAME  | School<br>Dist.                          | Sec   | Twsp.   | Range                     | LAND DESCRIPTION           |                |                 |                          |                           |               |                |
|-----------------------------|------------------------------------|------------------------------|------------------------------|-------------------------------|---------------------------|---|--|---|---|---------------------------|----------------------------|----------------|-----------------|--------------------------|---------------------------|---------------|----------------|
|                             |                                    |                              |                              |                               |                           |   |  |   |   |                           |                            |                |                 |                          |                           |               |                |
| # Acres<br>Tillable<br>Land | \$ of<br>Tillable<br>Land          | # Acres<br>Non-Till.<br>Land | \$ of<br>Non-Till.<br>Land   | \$ of<br>Bldg &<br>Other Imp. | \$ of<br>Rolling<br>Stock | \$ of Steamboats,<br>Sailboats, Stationery<br>Engines & Manufact'g<br>Machinery | \$ of<br>Merch'ndise &<br>Stock in Trade | Farming Implements<br>Wagons, Carriages<br>Etc. | Household<br>Furniture,<br>Watches,<br>Jewelry Etc. | # of<br>Horses &<br>Mules | \$ of<br>Horses &<br>Mules | # of<br>Cattle | \$ of<br>Cattle | # of<br>Sheep &<br>Goats | \$ of<br>Sheep &<br>Goats | # of<br>Swine | \$ of<br>Swine |
|                             |                                    |                              |                              |                               |                           |   |  |   |   |                           |                            |                |                 |                          |                           |               |                |

Date 1-4-93 Supervisor R. Kimball

COOS COUNTY, OREGON  
 ABSTRACT OF  
 ASSESSMENT & TAX ROLL

1993

| Tax Year                    | Assess&Tax/<br>Pers. Prop.<br>Roll | Assess&Tax<br>Roll           | Personal<br>Property<br>Roll | Vol. No.                      | Pg. No.                   | NAME  | School<br>Dist.                          | Sec   | Twsp.   | Range                     | LAND DESCRIPTION           |                |                 |                          |                           |               |                |
|-----------------------------|------------------------------------|------------------------------|------------------------------|-------------------------------|---------------------------|---|--|---|---|---------------------------|----------------------------|----------------|-----------------|--------------------------|---------------------------|---------------|----------------|
|                             |                                    | ✓                            |                              |                               |                           |   |  |   |   |                           |                            |                |                 |                          |                           |               |                |
| # Acres<br>Tillable<br>Land | \$ of<br>Tillable<br>Land          | # Acres<br>Non-Till.<br>Land | \$ of<br>Non-Till.<br>Land   | \$ of<br>Bldg &<br>Other Imp. | \$ of<br>Rolling<br>Stock | \$ of Steamboats,<br>Sailboats, Stationery<br>Engines & Manufact'g<br>Machinery | \$ of<br>Merch'ndise &<br>Stock in Trade | Farming Implements<br>Wagons, Carriages<br>Etc. | Household<br>Furniture,<br>Watches,<br>Jewelry Etc. | # of<br>Horses &<br>Mules | \$ of<br>Horses &<br>Mules | # of<br>Cattle | \$ of<br>Cattle | # of<br>Sheep &<br>Goats | \$ of<br>Sheep &<br>Goats | # of<br>Swine | \$ of<br>Swine |
|                             |                                    |                              |                              |                               |                           |   |  |   |   |                           |                            |                |                 |                          |                           |               |                |

Date 1-4-93 Supervisor R. Kimball



State of Oregon

ss

County of Coos

I, hereby certify that I have compared this abstract with the original record on file in my office and custody, and that it is a true and correct abstract of that original.

Dated this 4<sup>th</sup> day of January, 1993.

COOS COUNTY TAX DEPARTMENT

By Roberta Vance

RECEIVED

DEC 18 1992

WATER RESOURCES DEPT.  
SALEM, OREGON

To: Oregon Water Resources Department  
Salem OR 97310

From: Lois Smith  
Box 96 Langlois OR 97450

Subject: Livestock and Water Use

My husband, the late Paul Smith, and I bought the remainder of the Wallace Pomeroy property from Art Aldropp. Aldropp had sold part of the property before we contracted to buy in 1951.

Wallace Pomeroy homesteaded this property in 1902. I have lived in this area all my life and knew and went to school with neices and nephews of Mr. Pomeroy. I visited Wallace with these "kids" and horses and cows were on place.

After we got this place, Court Guerin, Wallace's brother in law, visited us and told us he helped Wallace build the barn. Court said he helped Wallace with his hay almost every year; this was before tractors and balers. Horses were used exclusively. We have the hay fork that was used to pull the hay into the mow.

Mr. Pomeroy had livestock on this place until he sold the stock and farm to Clayton. Aldropp did not milk but leased the farm to Ted Bierman. We bought the milk cows with the place then either sold or traded the dairy cows for beef stock. We have had livestock on the place from 1951 to the present time.

Unfortunately, all three different cheese factories in this area that received milk from this place have all burned so no milk records are available. The farmers income and living from this farm have been from livestock and it has been operated as a farm since it was first homesteaded by Wallace Pomeroy in 1902.

*Lois B Smith*

Lois B . Smith

Signed and attested before me this 15 day of December 1992



*Marcy Patridge*

NOTARY PUBLIC for the State of Oregon  
Coos County

RECEIVED

DEC 18 1992

WATER RESOURCES DEPT.  
SALEM, OREGON

*Nov 30, 1992*

To whom it may concern:

In the spring of 1965 while my father Paul Smith and I were removing the milking stanchions from the old barn on the Wallace Pomeroy homestead on New Lake Road I observed the year of 1903 carved into a board. The board was rough sawn and whitewashed but slightly buggy and rotten. We were replacing the stanchions with box stalls for horses.

Sincerely,

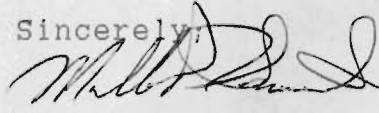

Milton P. Smith

RECEIVED

DEC 18 1992

WATER RESOURCES DEPT.  
SALEM, OREGON

5525 Royal Avenue  
Eugene, Oregon 97402-9314  
December 1, 1992

TO WHOM IT MAY CONCERN:

This letter is in verification that the area in question had livestock on the property several years prior to 1909, as well as, on the adjoining farms.

My father, Milton F. Brown, told me why his thumb joints were enlarged and had calluses on them.

When he was ten years old in the summer of 1903, he worked for Wallace Pomeroy for three months. Mr. Pomeroy had a farm on the New Lake Road and some of the duties my father had were milking cows. The older boys told Dad "men" milked "Swiss fashion" which is pressing the bent thumb against the teats.

After my father learned how to milk on the Pomeroy farm, he milked for other farmers in the area. His thumb joints remained enlarged and callused all his life but no longer sore and blistered like they were when he started milking for Pomeroy.

Sincerely,

*Dorothy Brown Doane*

Dorothy Brown Doane  
5525 Royal Avenue  
Eugene, Oregon 97402-9314  
(503) 689-0289

**Steve Anderson**

ATTORNEY AT LAW  
3295 TRIANGLE DR. S.E. #200  
Salem, Oregon 97302  
TELEPHONE 362-3455

November 10, 1992

Secretary  
VIDA E. GREGORY

**RECEIVED**

**DEC 18 1992**

**WATER RESOURCES DEPT.  
SALEM, OREGON**

Mrs. Paul Smith  
94421 New Lake Road  
P.O. Box 96  
Langlois, Oregon 97450-0096

Dear Lois:

I wish I could recollect enough specifically to help.

When I was about 10 or 11 years old, I had a trap line from the highway down the creek to Uncle Wallace's house. I got off the school bus, went down the creek and stayed over night with him. Aunt Mamie was deceased. I remember he used to talk about how many wild animals there were on the place when he and aunt Mamie first got there, and that they'd had to clear off some of the land to have pasture.

It isn't very precise, but like you, I have no doubt that they certainly had livestock when they first homesteaded.

Hope this helps a little.

Cordially,

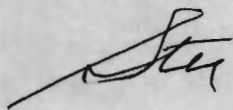

RECEIVED

DEC 18 1992

WATER RESOURCES DEPT.  
SALEM, OREGON

Bl 74  
Pg 307

11663.

THE UNITED STATES OF AMERICA,

HOMESTEAD CERTIFICATE NO. 5269:  
APPLICATION 0195

: TO ALL TO WHOM THESE PRESENTS SHALL COME, GREETING

WHEREAS There has been deposited in the General Land Office of the United States, a Certificate of the Register of the Land Office at Roseburg, Oregon, whereby it appears that, pursuant to the Act of Congress approved 20th May, 1862, "To Secure Homesteads to Actual Homesteaders to Actual Settlers on the Public Domain," and the acts supplemental thereto, the claim of Wallace Pomeroy has been established and duly consummated, in conformity to law, for the Lots numbered three and six of Section twenty-three and the Lots numbered two and three of Section twenty-six in Township thirty South of Range fifteen West of Tillamette Meridian in

Oregon containing one hundred and sixty acres, according to the Official Plat of the Survey of the said Land, returned to the General Land Office by the Surveyor General:

NOW KNOW YE, that there is, therefore, granted by the United States unto the said Wallace Pomeroy the tract of Land above described:

TO HAVE AND TO HOLD the said tract of Land, with the appurtenances thereof, unto the said Wallace Pomeroy, and to his heirs and assigns forever; subject to any vested and accrued water rights for mining, agricultural, manufacturing, or other purposes, and rights to ditches and reservoirs used in connection with such water rights, as may be recognized and acknowledged by the local customs, laws, and decisions of courts, and also subject to the right of the proprietor of a vein or lode to extract and remove his ore therefrom, should the same be found to penetrate or intersect the premises hereby granted, as provided by law. And there is reserved from the lands hereby granted, a right of way thereon for ditches or canals constructed by the authority of the United States.

IN TESTIMONY WHEREOF I, Theodore Roosevelt, President of the United States of America, have caused these letters to be made Patent, and the seal of the General Land Office to be hereunto affixed.

GIVEN under my hand, at the City of Washington, the third day of July, in the year of our Lord one thousand nine hundred and two and of the Independence of the United States the one hundred and twenty-sixth.

RECORDED Oregon, Vol. 83, Page 442.

By the President: T. Roosevelt,  
By F. M. McKean, Secretary,  
C. H. Brush,

Recorded December 5, 1916, 1:15 P.M.  
Robt. R. Watson, County Clerk.

Recorder of the General Land Office.  
(Seal: United States General Land Office.)

3k  
141/68  
2

2108- KNOW ALL MEN BY THESE PRESENTS, that whereas the hereinafter described property has been heretofore acquired by Coos County, a body politic and corporate of the State of Oregon, pursuant to certain tax foreclosure proceedings commenced and prosecuted to final determination in the Circuit Court of the State of Oregon, in and for the County of Coos, and said property having been duly sold to said Coos County, Oregon, for delinquent taxes pursuant to judgment and decree of said Circuit Court and whereas said County has heretofore duly received a deed for such property,

And whereas, the County Court of Coos County, Oregon, has deemed it for the best interest of Coos County to sell the same and did upon the 30th day of July 1941, duly make and enter an order in Volume 17, commencing on page 78, directing the Sheriff of Coos County, Oregon, to sell such property and fixing the price for which said property should be sold,

And whereas, said Sheriff did upon receipt of said order publish in the Coos Bay Times, a newspaper of general circulation and a legal newspaper in which to publish such a notice, and printed and published in said Coos County, State of Oregon, a notice of the sale of said property for four consecutive weekly publications prior to said sale, which notice did state the time and place of sale of said property; the first publication of said notice being on the 14th day of August, 1941, and the last publication thereof being on the 11th day of September, 1941,

And whereas, no redemption has been made of any of said property and the title thereto is in the name of Coos County, Oregon,

And whereas, on the 13th day of September, 1941, pursuant to said published notice the Sheriff of Coos County, Oregon, offered for sale the following described property in accordance with the order made by the County Court of Coos County, Oregon, as above stated, and that there were no bids for said property at that time or at any postponed sale of said property by the said Sheriff,

And whereas, thereafter on the 6th day of October 1941, the County Court of Coos County, Oregon, fixed a new price for said property,

NOW THEREFORE, Coos County, Oregon, by and through E. L. Peterson County Judge of Coos County, Oregon, and R. H. Lawhorn and Lars P. Peterson, County Commissioners of said Coos County, Oregon, for and in consideration of One Hundred Fifty and No/100 Dollars, lawful money of the United States of America, receipt whereof is hereby acknowledged, has granted, bargained, sold, conveyed, and quitclaimed, and by these presents does grant, bargain, sell, convey, and quitclaim unto Edith M. Gallier and her heirs and assigns, all the right, title, or interest of Coos County, Oregon, of, in, or to all the following described real property, situated in the County of Coos, State of Oregon, to-wit:

The Southeast quarter of the Northwest quarter of Section 23, Township 30 South, Range 15 West of Willamette Meridian, Coos County, Oregon.

To HAVE AND TO HOLD, the above described premises unto the said grantee, her heirs and assigns forever.

IN WITNESS WHEREOF, Said Coos County, Oregon, has caused this deed to issue by and through its County Judge and Commissioners, this 6th day of October 1941, pursuant to Section 100, Code 1930, as amended by Chapter 220, Oregon Laws for 1931.

**RECEIVED**

Executed in the presence of: \_\_\_\_\_  
DEC 18 1941

COOS COUNTY DEPT.  
SALEM, OREGON

COOS COUNTY, a body politic and corporate of the State of Oregon  
By E. L. Peterson ) seal(  
County Judge of Coos County, Oregon.  
By R. H. Lawhorn ) seal(  
County Commissioner of Coos County, Oregon.  
By Lars P. Peterson ) seal(  
County Commissioner of Coos County, Oregon.

32  
1491439

RECEIVED

DEC 18 1992

WATER RESOURCES DEPT  
SALEM, OREGON

9850 -- KNOW ALL MEN BY THESE PRESENTS, That we, Edith M. Gallier and E. W. Gallier, her husband, of Coos County State of Oregon, in consideration of Ten Dollars and other valuable consideration, said consideration being less than \$100.00, to us paid by W. P. Pomeroy, of Coos County, State of Oregon, have bargained and sold, and by these presents do grant, bargain, sell and convey unto said W. P. Pomeroy, his heirs and assigns, all the following bounded and described real property, situated in the County of Coos and State of Oregon, to-wit:

The Southeast quarter of the Northwest quarter of Section 23, Township 30 South, of Range 15 West of the Willamette Meridian, in Coos County, Oregon; together with all and singular the tenements, hereditaments and appurtenances thereto belonging or in anywise appertaining, and also all our estate, right, title and interest in and to the same, including dower and claims of dower.

To Have and to Hold, the above described and granted premises unto the said W. P. Pomeroy, his heirs and assigns forever. And we, Edith M. Gallier and E. W. Gallier, grantors above named do covenant to and with W. P. Pomeroy, the above named grantee his heirs and assigns that we are lawfully seized in fee simple of the above granted premises, that the above granted premises are free from all incumbrances, and that we will and our heirs, executors and administrators, shall warrant and forever defend the above granted premises, and every part and parcel thereof, against the lawful claims and demands of all persons whomsoever.

In Witness Whereof, we the grantors above named, have hereunto set our hands and seals this 10th day of November, 1943.

Edith M. Gallier )Seal(  
G. W. Gallier )Seal(

STATE OF OREGON )  
County of Coos )

ss. BE IT REMEMBERED, That on this 12th day of November,

A.D., 1943, before me, the undersigned, a Notary Public in and for said County and State, personally appeared the within named Edith M. Gallier, and E. W. Gallier, her husband who are known to me to be the identical individuals described in and who executed the within instrument and acknowledged to me that they executed the same freely and voluntarily.

IN TESTIMONY WHEREOF, I have hereunto set my hand and official seal the day and year last above written.

Geo. L. Coburn  
Notary Public for Oregon  
My Commission Expires July 17, 1946.  
(Notarial Seal)

Recorded January 10, 1944: 2:45 P.M.  
L. W. Oddy, County Clerk.

9851 -- KNOW ALL MEN BY THESE PRESENTS, That I, W. P. Pomeroy, a widower, in consideration of Ten Dollars, and other valuable consideration to me paid by W. L. Clayton and Audrey W. Clayton, husband and wife, do hereby grant, bargain, sell and convey unto said W. L. Clayton and Audrey W. Clayton husband and wife, as tenants in the entirety, their heirs and assigns, all the following real property, with the tenements, hereditaments and



9851 -- KNOW ALL MEN BY THESE PRESENTS, That I, W. P. Pomeroy, a widower, in consideration of Ten Dollars, and other valuable consideration to me paid by W. L. Clayton and Audrey W. Clayton, husband and wife, do hereby grant, bargain, sell and convey unto said W. L. Clayton and Audrey W. Clayton husband and wife, as tenants in the entirety, their heirs and assigns, all the following real property, with the tenements, hereditaments and appurtenances situated in the State of Oregon, bounded and described as follows, to-wit:

The Southeast quarter of the Northwest quarter and Lots three and six in Section 23, Township 30, South, of Range 15 West of the Willamette Meridian, in Coos County, Oregon.

Lots two and three in Section 26, Township 30, South, of Range 15, West of the Willamette Meridian, in Curry County, Oregon

Also the following described personal property now on said premises above described, to-wit: Five coming 2-year old heifers, two milk cows, and thirty hogs, this day delivered to grantees, and personal property

To Have and to Hold, the above described and granted premises and person

property unto the said W. L. Clayton and Audrey W. Clayton, husband and wife, as tenants in the entirety, their heirs and assigns forever.

And I, W. P. Pomeroy, the grantor above named do covenant to and with the above named grantees, their heirs and assigns that I am lawfully seized in fee simple of the above granted premises, that the above granted premises are free from all incumbrances and that I will and my heirs, executors and administrators, shall warrant and forever defend the above granted premises, and every part and parcel thereof, against the lawful claims and demands of all persons whomsoever.

Witness my hand and seal this 10th day of November, 1943.

\$6.60 Documentary Stamps Cancelled. W. P. Pomeroy )Seal(

STATE OF OREGON )  
County of Coos ) ss. BE IT REMEMBERED, That on this 10th day of November, A. D., 1943, before me, the undersigned, a Notary Public in and for said County and State, personally appeared the within named W. P. Pomeroy, a widower, who is known to me to be the identical individual described in and who executed the within instrument and acknowledged to me that he executed the same freely and voluntarily.

IN TESTIMONY WHEREOF, I have hereunto set my hand and official seal the day and year last above written.

Recorded Jan. 10, 1944; 2:45 P. M  
L. W. Oddy, County Clerk.  
Grantee - Langlois, Oregon

O. C. Sanford  
Notary Public for Oregon  
My Commission expires Sept. 29, 1943.  
(Notarial Seal)

RECEIVED

DEC 18 1943

WATER RESOURCES DEPT.  
SALEM, OREGON

149-441

108 0-00

4

KNOW ALL MEN BY THESE PRESENTS, That W. L. Clayton and Audrey W. Clayton, husband and wife, of Coos County, Oregon,

in consideration of Ten 00/100 Dollars, and other valuable considerations, to them paid by Art Aldron and/or Mimi Aldron (husband and wife) of Lane Co., Curry County, Oregon, do hereby grant, bargain, sell and convey unto said Art Aldron and Mimi Aldron, their

heirs and assigns, all the following real property, with the tenements, hereditaments and appurtenances, situated in the County of Coos and State of Oregon, bounded and described as follows, to-wit:

The southeast quarter of the Northwest quarter and Lots three and six in Section 27, Town 13 South, of Range 15 west of the Willamette Meridian, in Coos County, Oregon.



To Have and to Hold, the above described and granted premises unto the said Art Aldron and/or Mimi Aldron, their

heirs, and assigns forever

And W. L. Clayton and Audrey W. Clayton

the grantors above named do covenant to and with the above named grantee & their heirs and assigns that they are lawfully seized in fee simple of the above granted premises, that the above granted premises are free from all incumbrances.

and that they will and their heirs, executors and administrators, shall warrant and forever defend the above granted premises, and every part and parcel thereof, against the lawful claims and demands of all persons whomsoever.

Witness our hands and seal this 23rd day of March, 1947

Executed in the Presence of

*John Nielson*

*W. L. Clayton*

STATE OF OREGON,

County of Coos } ss.

BE IT REMEMBERED, That on this 23rd day of March, A. D. 1947, before me, the undersigned, a Notary Public in and for said County and State, personally appeared the within named W. L. Clayton and Audrey W. Clayton, husband and wife, who are known to me to be the identical individual(s) described in and who executed the within instrument and acknowledged to me that they executed the same freely and voluntarily.

IN TESTIMONY WHEREOF, I have hereunto set my hand and seal the day and year last above written.

*John Nielson*  
Notary Public for Oregon.

My Commission Expires April 27, 1947

Recorded June 18, 1947, 9:30 a.m.  
I. W. Oddy, County Clerk

RECEIVED

DEC 18 1992

RESOURCES DEPT.  
ALEM, OREGON

6<sup>1</sup> No. 3 Name W.P. Pomeroy Address Langlois 15<sup>17</sup> ✓  
 12<sup>16</sup> 19

| Vol. 74<br>74 | Page 307<br>309 | Description                                      | Sec. | Twp. | Range | Acres Till.      | Value      | Acres Not Till   | Value      | Improvements | Gross  | S.D. No.                             | R.D. No. | Town           |
|---------------|-----------------|--|------|------|-------|------------------|------------|------------------|------------|--------------|--|--------------------------------------|----------|----------------|
|               |                 | <del>Ac+700</del> Lot 3-6                        | 23   | 30   | 15    | 4                | 400<br>200 | 116              | 350        | 100          | 850<br>650   | 46                                   | 72       | PORT OF BANDON |
|               |                 |  |      |      |       | 7                | 320<br>630 | 111<br>113       | 470<br>340 |              | 770<br>1070  |                                      |          |                |
|               |                 | Less Co. Rd. 1 <sup>30</sup> A. Vol. 86 P. 25    |      |      |       | 16 <sup>40</sup> | 1480       | 20<br>102        | 640        | 100          | 2120   |                                      |          | U.S. NO. 1     |
|               |                 | Less part sold. V132 PAR 6 (Slp-33) 0.92 AC. T-5 |      |      |       | 16 <sup>44</sup> | 1410       | 65 <sup>20</sup> | 470        | 153          | 2020   |                                      |          | PORT OF BANDON |
|               |                 |  |      |      |       | 15 <sup>22</sup> | 1213       | 62               | 76         | 140-37       | 2005-37  |                                      |          |                |
|               |                 |  |      |      |       | 16 <sup>44</sup> | 1225       | 37               |            | 150-A        | 1820-28<br>1990-39<br>1730-40<br>1740-41                             |                                      |          |                |
|               |                 |  |      |      |       |                  | 1165       |                  |            |              |  |                                      |          |                |
|               |                 | <6 A. bottom @ 100; 12 Hill @ 30> 19=0           |      |      |       |                  |            |                  |            |              |  |                                      |          |                |
|               |                 | Patent lots 3-6 & Ben. Fr. Cape S E 1/4 NW 1/4   |      |      |       |                  |            |                  |            |              | 94 Ac. 1/1 Till Bo<br>733 " Cd Slope<br>643 " Br. Bo<br>56.83 " Hill | 100-910<br>25-255<br>15-233<br>3-170 |          |                |
|               |                 |  |      |      |       |                  |            |                  |            |              | 7920   |                                      |          | 1540           |

79.20 m/l

RECEIVED  
 DEC 18 1992  
 WATER RESOURCES DEPT.  
 SALEM, OREGON

RECEIVED

DEC 18 1992

COMPALED

RESOURCES DEP  
SALEM, OREGON

TO  
ART ALDROPP, et ux

KNOW ALL MEN BY THESE PRESENTS, That W. L. Clayton and Audrey W. Clayton, husband and wife, of Coos County, Oregon, in consideration of Ten 00/100 Dollars, and other valuable considerations, to them paid by Art Aldropp and/or Mimi Aldropp (husband and wife) of Langlois, Curry County, Oregon, do hereby grant, bargain, sell and convey unto said Art Aldropp and Mimi Aldropp, their heirs and assigns, all the following real property, with the tenements, hereditaments and appurtenances, situated in the County of Curry and State of Oregon, bounded and described as follows, to-wit:

Lots two and three in Section 26, Township 30 South, of Range 15 west of the Willamette meridian in Curry County, Oregon.

To Have and to Hold, the above described and granted premises unto the said Art Aldropp and Mimi Aldropp, their heirs and assigns forever

And W. L. Clayton and Audrey W. Clayton, the grantors above named do covenant to and with the above named grantees their heirs and assigns that they are lawfully seized in fee simple of the above granted premises, that the above granted premises are free from all incumbrances, and that they will and their heirs, executors and administrators, shall warrant and forever defend the above granted premises, and every part and parcel thereof, against the lawful claims and demands of all persons whomsoever

Witness our hands and seals this 28th day of March, 1945.

W. L. Clayton (Seal)

Audrey W. Clayton (Seal)

Executed in the Presence of

John Nielson

STATE OF OREGON, )  
                          ) ss.  
County of Coos     )

BE IT REMEMBERED, That on this 28th day of March, A.D. 1945, before me, the undersigned, a notary public in and for said county and State, personally appeared the within named W. L. Clayton and Audrey W. Clayton, husband and wife, who are known to me to be the identical individuals described in and who executed the within instrument and acknowledged to me that they executed the same freely and voluntarily.

IN TESTIMONY WHEREOF, I have hereunto set my hand and seal the day and year last above written.

(Notary Seal)

John Nielson  
Notary Public for Oregon.  
My Commission Expires April 21, 1947

Filed and recorded April 4, 1945. Oleta A. Walker, Clerk.

RECEIVED  
DEC 18 1992

COMPARED

TO  
W. L. CLAYTON AND AUDREY CLAYTON

KNOW ALL MEN BY THESE PRESENTS, That I. W. P. Pomeroy, a widower, in consideration of Ten Dollars, and other valuable consideration to me paid by W. L. Clayton and Audrey W. Clayton, husband and wife, do hereby grant, bargain, sell and convey unto said W. L. Clayton and Audrey W. Clayton, husband and wife, as tenants in the entirety, their heirs and assigns, all the following real property, with the tenements, hereditaments and appurtenances situated in the State of Oregon, bounded and described as follows, to-wit:

The Southeast quarter of the Northwest quarter and Lots three and six in Section 23, Township 30 South, of Range 15 West of the Willamette Meridian, in Coos County, Oregon.

Lots two and three in Section 26, Township 30 South, of Range 15 West of the Willamette Meridian, in Curry County, Oregon.

Also the following described personal property now on said premises above described, to-wit: Five coming 2-year old heifers, two milk cows, and thirty hens, this day delivered to grantees.

\$6.60 Documentary stamps affixed and cancelled.

To Have and to Hold, the above described and granted premises and personal property unto the said W. L. Clayton and Audrey W. Clayton, husband and wife, as tenants in the entirety, their heirs and assigns forever.

And I, W. P. Pomeroy, the grantor above named do covenant to and with the above named grantees, their heirs and assigns that I am lawfully seized in fee simple of the above granted premises, that the above granted premises are free from all incumbrances, and that I will and my heirs, executors and administrators, shall warrant and forever defend the above granted premises, and every part and parcel thereof, against the lawful claims and demands of all persons whomsoever.

Witness my hand and seal this 10th day of November, 1943.

W. P. Pomeroy (SEAL)

STATE OF OREGON, )  
                          )ss.  
County of Coos   )

BE IT REMEMBERED, That on this 10th day of November A.D. 1943, before me, the undersigned, a Notary Public in and for said County and State, personally appeared the within named W. P. Pomeroy, a widower, who is known to me to be the identical individual described in and who executed the within instrument and acknowledged to me that he executed the same freely and and voluntarily.

IN TESTIMONY WHEREOF, I have hereunto set my hand and official seal the day and year last above written.

O. C. Sanford  
Notary Public for Oregon.  
My Commission Expires Sept. 29, 1943.

NOTARY SEAL

Filed and recorded March 15, 1944. Oleta A. Walker, Clerk

KNOW ALL MEN BY THESE PRESENTS, that we, Art Aldropp and Mimi Aldropp, husband and wife, Grantors, in consideration of Ten Dollars (\$10.00) and other good and valuable consideration to us paid by Paul Smith and Lois B. Smith, husband and wife, Grantees, do hereby grant, bargain, sell, and convey unto the said Grantees, as tenants by the entirety, all the following property, to wit:

Beginning at a point 210.69 feet North of the Southwest corner of Lot 2 in Section 26, Township 30 South, Range 15 West of the Willamette Meridian and proceeding in a Northerly direction North 24° 29' East a distance of 1109.2 feet to the intersection of said Northerly line with the Section line between Sections 23 and 26, of said Township and Range; thence West 427.6 feet to the Northwest corner of said Lot 2; thence South 1025.8 feet to the place of beginning, containing 5.4 acres. Also, all of Lot 3, except two acres, more or less, in Section 26, Township 30 South, Range 15 West of the Willamette Meridian, beginning at the Southwest corner of said Lot 3 and running thence Northerly in the West boundary of said Lot 3 for a distance of 416 feet; thence Easterly and parallel to South boundary of said Lot 3 a distance of 208 feet; thence Southerly and parallel to West boundary of said Lot 3 a distance of 416 feet to a point on the South boundary of said Lot 3; thence Westerly a distance of 208 feet, following the south boundary of said Lot 3 to the point of beginning. Excepting a 30 foot easement North of and adjacent to the South boundary of Lot 3, Section 26, Township 30 South, Range 15, from the East boundary of the above described two acre tract and extending to the East boundary of said Lot 3; also excepting a parcel beginning at the interior one-eighth corner common to the said Lots 2 and 3 thence North 01° 32' East 210.69 feet; thence South 24° 29' West to the South line of Lot 3; thence South 84° 53' East to the place of beginning.

We, the Grantors, covenant to and with the Grantees that we are lawfully seized in fee simple of the above granted premises free from all encumbrances without exception; that we will, and our heirs, executors, administrators, and assigns shall, warrant and forever defend the same, and every part thereof, against the lawful claims and demands of all persons whomsoever.

WITNESS our hands and seals this 3<sup>rd</sup> day of July, 1953.



Mimi Aldropp (SEAL)  
Art Aldropp (SEAL)

RECEIVED  
DEC 3 1992

WATER RESOURCES DEPT  
SALEM OREGON

STATE OF OREGON }  
County of Curry } ss.

VOL. 40 Page 213

On the 3<sup>rd</sup> day of July, 1953, there appeared before me the aforementioned Art Aldropp, and on the 3<sup>rd</sup> day of July, 1953, there appeared before me the aforementioned Mimi Aldropp, both of whom personally acknowledged to me that they executed the foregoing instrument freely and voluntarily for the uses and purposes therein set forth.

Witness my hand and official seal this 3<sup>rd</sup> day of July,



Myron C. Jones

Notary Public for Oregon

My Commission expires 5/28/55

RECEIVED  
DEC 1992  
WATER RESOURCES DEPT  
SALEM, OREGON

RECORDED: Sept. 4 1953  
Oleta A. Walker, County Clerk

## BARGAIN AND SALE DEED

LOIS B. SMITH, a widow, Grantor, conveys to LOIS B. SMITH, MILTON P. SMITH, and CAROL L. SMITH, not as tenants in common but with full rights of survivorship, Grantee, all of her right, title and interest in that real property situated in CURRY County, State of Oregon, described as

## PARCEL 1:

Beginning at a point which is South  $01^{\circ} 32'$  West 1025.81 feet from the Northwest corner of Government Lot Two (2) in Section Twenty-six (26), Township Thirty (30) South, Range Fifteen (15) West, Willamette Meridian, Curry County, Oregon; thence North  $24^{\circ} 29'$  East 1109.2 feet to the North line of said Section 26; thence North  $87^{\circ} 43'$  West 427.6 feet to the Northwest corner of Government Lot 2 of said Section 26; thence South  $01^{\circ} 32'$  West 1025.81 feet to the place of beginning, containing 5.4 acres, more or less,

Also, all of Government Lot Three (3) in Section 26, Township 30 South, Range 15 West, excepting two acres, more or less, which excepted parcel is described as follows: Beginning at the Southwest corner of said Government Lot 3; thence Northerly along the West line of said Lot 3 a distance of 416 feet; thence Easterly and parallel to the South boundary line of said Lot 3 a distance of 208 feet; thence Southerly, parallel to the West boundary of said Lot 3 a distance of 416 feet to the South line of said Lot 3; thence Westerly 208 feet to the point of beginning; Also excepting an easement over a strip of land 30ft in width lying northerly of and adjacent to the South line of said Lot 3, which 30 foot strip extends from the East boundary line of the above described 2 acre tract to the East boundary line of said Government Lot 3; Also excepting the following described parcel: Beginning at a point on the East line of Government Lot 3 which is South  $01^{\circ} 32'$  West 1025.81 feet from the Northeast corner of said Government Lot 3; thence South  $24^{\circ} 29'$  West to the South line of said Government Lot 3; thence Easterly to the Southeast corner of said Lot 3; thence Northerly 240.69 feet to the point of beginning.

DEC 18 1992

PATER RESOURCES, LLC  
SALEM, OREGON



PARCEL 2:

That certain real property described in deed recorded in Volume 34, page 246-47, Deed Records of Curry County, Oregon, excepting however that certain real property described in Deed recorded in Volume 55, page 7, Deed Records of Curry County, Oregon.

PARCEL 3:

The Northern 60 feet of the following described parcel:

A parcel of land on the West side of U. S. Highway 101 in Section Twenty six (26), Township Thirty (30) South, Range Fifteen (15) West of the Willamette Meridian in Curry County, Oregon, and more accurately described as follows:

Beginning at a point which is South 01° 32' West 1025.81 feet from the Northwest Corner of Lot No. 2, Township 30 South, Range 15 West of the Willamette Meridian;

- thence South 85° 33' East 1035.4 feet;
- thence South 24° 29' West 236.8 feet;
- thence North 84° 53' West 943.8 feet;
- thence North 01° 32' East 210.69 feet to the point of beginning.

No consideration has been given or paid for this transfer, the purpose being to make a change in vesting.

THIS INSTRUMENT WILL NOT ALLOW USE OF THE PROPERTY DESCRIBED IN THIS INSTRUMENT IN VIOLATION OF APPLICABLE LAND USE LAWS AND REGULATIONS. BEFORE SIGNING OR ACCEPTING THIS INSTRUMENT, THE PERSON ACQUIRING FEE TITLE TO THE PROPERTY SHOULD CHECK WITH THE APPROPRIATE CITY OR COUNTY PLANNING DEPARTMENT TO VERIFY APPROVED USES.

Until a change is requested, all tax statements are to be sent to the Grantor at the following address:

LOIS B. SMITH, PO Box 96, Langlois, OR 97450.

Dated this 9<sup>th</sup> day of ~~August~~<sup>SEPTEMBER</sup>, 1991.

Grantor:

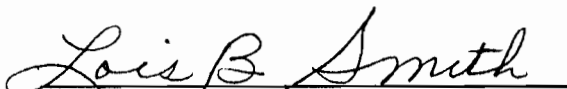
  
LOIS B. SMITH, a widow

RECORDED  
DEC 18 1992

WATER RESOURCES DEPT  
SALEM, OREGON

STATE OF OREGON        )  
                              )  
County of Curry        )        ss.

On the date last above, personally appeared the above-name LOIS B. SMITH, a widow, and acknowledged the foregoing instrument to be his/her voluntary act. Before me:

*Richard E. Aufranc*  
Notary Public for Oregon,  
My commission expires: 1-27-95

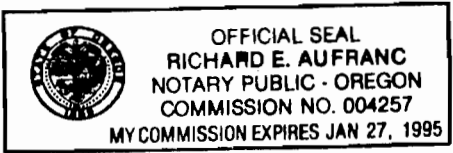

After recording, return to:

LOIS B. SMITH, PO Box 96, Langlois, OR 97450.

RECORDED

DEC 18 1992

WATER RESOURCES DEPT  
SALEM, OREGON

STATE OF OREGON }  
COUNTY OF CURRY } ss

'91 SEP 11 AM 10 14

ELAINE JOY  
CURRY COUNTY CLERK

I hereby certify that the within Instrument was received and duly recorded in the OFFICIAL RECORDS OF CURRY COUNTY:

By: *JD* Deputy  
Fee: \$40.00 Pgs: 3

1991  
Instrument 91 04834

RECEIVED

DEC 18 1959

SCHEDULE F  
(Form 1040)

U. S. Treasury Department—Internal Revenue Service  
**SCHEDULE OF FARM INCOME AND EXPENSES**

(Compute Social Security Self-Employment Tax on page 3)  
Attach this schedule to your Income Tax Return, Form 1040

1959

WATER RESOURCES DEPT  
SALEM, OREGON

For Calendar Year 1959, or other taxable year beginning 111, 1959, and ending 111, 1960  
Name and Address as shown on page 1, Form 1040

PAUL AND LOIS B SMITH LANGLOIS OREGON

**FARM INCOME FOR TAXABLE PERIOD—CASH RECEIPTS AND DISBURSEMENTS METHOD**

(Report receipts from sale of livestock held primarily for sale in the applicable column below. Do not include other sales of livestock such as those held for draft, breeding, or dairy purposes; report such sales on Schedule D (Form 1040))

| SALES OF LIVESTOCK AND PRODUCE RAISED                                   |          |            |                  |          | OTHER FARM INCOME |   |            |
|---|----------|------------|------------------|----------|-------------------|---|------------|
| Kind  | Quantity | 1. Amount  | Kind             | Quantity | 2. Amount         | Items                                   | 3. Amount  |
| Cattle  |          | \$ 1144.91 | Dairy products   |          | \$                | Mdse. rec'd for produce                 | \$         |
| Horses  |          |            | Eggs             |          |                   | Machine work                            | 792.25     |
| Mules   |          |            | Meat products    |          |                   | Breeding fees                           |            |
| Sheep   |          |            | Poultry, dressed |          |                   | Wood and lumber                         |            |
| Swine   |          |            | Wool             |          |                   | Other forest products                   |            |
| Poultry   |          |            | Honey            |          |                   | Agricultural program payments           |            |
| Bees  |          |            | Sirup and sugar  |          |                   | Patronage dividends, rebates or refunds |            |
| Grain   |          |            | Other (specify): |          |                   | Other (specify):                        |            |
| Hay   |          |            |                  |          |                   |   |            |
| Cotton  |          |            |                  |          |                   |   |            |
| Tobacco   |          |            |                  |          |                   |   |            |
| Vegetables  |          |            |                  |          |                   |   |            |
| Fruits and nuts   |          |            |                  |          |                   |   |            |
| Total of Columns 1, 2, and 3. Enter here and on line 1 of summary below |          |            |                  |          |                   |   | \$ 1937.16 |

**SALES OF PURCHASED LIVESTOCK AND OTHER PURCHASED ITEMS**

| a. Description                           | b. Date acquired | c. Amount received | d. Cost or other basis | e. Profit (or loss) |
|--|------------------|--------------------|------------------------|---------------------|
| CATTLE (2 DIED)                          | 1959             | \$ NONE            | \$ 270-                | \$ (270-)           |
| Total (enter on line 2 of summary below) |                  |                    |                        | \$ (270-)           |

**FARM EXPENSES FOR TAXABLE YEAR (See Instructions)**

(Do not include personal or living expenses or expenses not attributable to production of farm income, such as taxes, insurance, repairs, etc., on your dwelling)

| Items  | 1. Amount | Items                   | 2. Amount | Items                          | 3. Amount  |
|--|-----------|-------------------------|-----------|--------------------------------|------------|
| Labor hired  | \$ 146.25 | Veterinary, medicine    | \$        | Freight, trucking              | \$         |
| Feed purchased   | 288.86    | Gasoline, fuel, oil     | 144.79    | Amortization                   |            |
| Seed, plants purchased   | 140.74    | Storage, warehousing    |           | Conservation expenses          |            |
| Machine hire   | 100-      | Taxes                   | 177.71    | Other farm expenses (specify): |            |
| Supplies purchased   |           | Insurance               | 21.85     | PICKUP EXP 50%                 | 280.66     |
| Repairs, maintenance   | 285.93    | Farm interest           |           | CAR EXP 50%                    | 146.06     |
| Breeding fees  |           | Utilities \$0.90        | 74.40     | TRACTOR REPAIR                 | 138.39     |
| Fertilizers, lime  | 571.68    | Rent of farm, pasturage |           |                                |            |
| Total of Columns 1, 2, and 3. Enter here and on line 4 of summary below (cash method) or line 6, page 2 (accrual method) |           |                         |           |                                |            |
|  |           |                         |           |                                | \$ 2537.32 |

**SUMMARY OF INCOME AND DEDUCTIONS—CASH RECEIPTS AND DISBURSEMENTS METHOD**

|  |              |                                     |            |
|--|--------------|-------------------------------------|------------|
| 1. Sale of livestock and produce raised and other farm income  | \$ 1937.16   | 4. Farm expenses (from above)       | \$ 2537.32 |
| 2. Profit (or loss) on sale of purchased livestock and other purchased items   | (270-)       | 5. Depreciation (from page 2)       | 1831.74    |
| 3. Gross Profits*  | \$ 1667.16   | 6. Other farm deductions (specify): |            |
| 7. Total Deductions  | \$ 4369.06   |                                     |            |
| 8. Net farm profit (or loss) (line 3 minus line 7). Enter here and on line 9, page 1, Form 1040. Make your computation of self-employment income and the self-employment tax on page 3 of this schedule. | \$ (2701.90) |                                     |            |

\* Use this amount for optional method of computing net earnings from self-employment. (See line 13, page 3.)

48-16-78308-1

RECEIVED

DEC 18 1992

1984 RESOURCES DEP. SALEM, OREGON

SCHEDULE F (Form 1040) U.S. Treasury Department Internal Revenue Service

SCHEDULE OF FARM INCOME AND EXPENSES

(Compute social security self-employment tax on Schedule F-1 (Form 1040)) Attach this schedule to your income tax return, Form 1040

Name and address as shown on Form 1040. PAUL AND LOIS B SMITH LANGLOIS OREGON
Business name and address SAME
Location of farm(s) and number of acres in each farm SAME
Employer identification number

FARM INCOME FOR TAXABLE YEAR—CASH RECEIPTS AND DISBURSEMENTS METHOD

PART I. Report receipts from sale of livestock held primarily for sale in the applicable column below. (Do not include other sales of livestock held for draft, breeding, or dairy purposes; report such sales on Schedule D (Form 1040))

Table with columns: SALES OF MARKET LIVESTOCK AND PRODUCE RAISED AND HELD PRIMARILY FOR SALE (Kind, Quantity, 1. Amount) and OTHER FARM INCOME (Items, 3. Amount). Includes entries for Cattle, Eggs, Meat products, Poultry, etc.

Total of columns 1, 2, and 3. Enter here and on line 1 of Part IV below \$ 922.50

PART II. SALES OF PURCHASED LIVESTOCK AND OTHER ITEMS PURCHASED FOR RESALE

Table with columns: a. Description, b. Date acquired, c. Amount received, d. Cost or other basis, e. Profit (or loss). Includes entry for CATTLE.

Totals (enter amount from column e, on line 2 of Part IV below) \$ 289.73 \$ 220.58 \$ 69.15

PART III. FARM EXPENSES FOR TAXABLE YEAR (see instructions)

(Do not include personal or living expenses or expenses not attributable to production of farm income, such as taxes, insurance, repairs, etc., on your dwelling)

Table with columns: 1. Amount, 2. Amount, 3. Amount. Includes entries for Labor hired, Repairs, maintenance, Interest, Feed purchased, Seed, plants purchased, Fertilizers, lime, Machine hire, Supplies purchased, Breeding fees, Veterinary, medicine, Gasoline, fuel, oil, Storage, warehousing, Taxes, Insurance, Utilities, Rent of farm, pasture, Freight, trucking, Conservation expenses, Retirement plans, etc., Other (specify): FEED LIG., PERIODICALS, DUES & SUB, TELEPHONE, AUTO EXP. 50%.

Total of columns 1, 2, and 3. Enter here and on line 4 of Part IV below (cash method) or line 6, Part VII (accrual method) \$ 3207.45

PART IV. SUMMARY OF INCOME AND DEDUCTIONS—CASH RECEIPTS AND DISBURSEMENTS METHOD

Summary table with 8 rows: 1. Sale of livestock and produce raised and other farm income \$ 922.50; 2. Profit (or loss) on sale of purchased livestock and other purchased items 69.15; 3. Gross profits\* \$ 991.65; 4. Farm expenses (from Part III) \$ 3207.45; 5. Depreciation (from Part V) 807.81; 6. Other farm deductions (specify); 7. Total deductions \$ 4015.26; 8. Net farm profit (or loss) (subtract line 7 from line 3). Enter here and on line 7, Part II, page 2, Form 1040. Make your computation of self-employment income and the self-employment tax on Schedule F-1. \$ (3023.61)

\* Use this amount for optional method of computing net earnings from self-employment. (See line 3, Schedule F-1 (Form 1040))

# Farm Income and Expenses

(Compute social security self-employment tax on Schedule SE)

▶ See separate instructions.  
▶ If you use this schedule, attach it to Form 1040.

1969 DEC 18 192  
WATER RESOURCES DE  
SALEM, OREGON

Name as shown on Form 1040

*Paul & Lois B. Smith*

Social security number

*530 01 9188*

Business name and address

Location of farm(s) and number of acres in each farm *Lenglais, Oregon*

If you filed Form 943, enter employer identification number here

### Part I Farm Income—Cash Receipts and Disbursements Method

Do not include sale of livestock held for draft, breeding, or dairy purposes; report such sales on Schedule D.

#### Sales of Purchased Livestock and Other Items Purchased for Resale

| a. Description | b. Amount received | c. Cost or other basis | d. Profit (or loss) |
|----------------|--------------------|------------------------|---------------------|
| 1 Livestock:   | \$                 | \$                     | \$                  |
| 2 Other items: |                    |                        |                     |
| 3 Totals       | \$                 | \$                     | \$                  |

#### Sales of Market Livestock and Produce Raised and Held Primarily for Sale and Other Farm Income

| Kind                 | Quantity | Amount           |
|----------------------|----------|------------------|
| 4 Cattle             |          | <i>\$3102.78</i> |
| 5 Beef calves        |          |                  |
| 6 Sheep              |          |                  |
| 7 Swine              |          |                  |
| 8 Poultry            |          |                  |
| 9 Dairy products     |          |                  |
| 10 Eggs              |          |                  |
| 11 Wool              |          |                  |
| 12 Cotton            |          |                  |
| 13 Tobacco           |          |                  |
| 14 Vegetables        |          |                  |
| 15 Grain             |          |                  |
| 16 Fruits and nuts   |          |                  |
| 17 Other (specify):  |          |                  |
| <i>HORSES</i>        |          | <i>800 -</i>     |
| <i>MILK HAULING</i>  |          | <i>16347.97</i>  |
| <i>BREEDING FEES</i> |          | <i>100 -</i>     |

OTHER FARM INCOME

|   |  |                   |
|---|--|-------------------|
| 18 Machine work   |  |                   |
| 19 Patronage dividends                                  |  |                   |
| 20 Per-unit retains                                     |  |                   |
| 21 Agricultural program payments:                       |  |                   |
| (1) Cash  |  |                   |
| (2) Materials and services                              |  |                   |
| 22 Commodity Credit loans under election (or forfeited) |  |                   |
| 23 Federal gasoline tax credit                          |  |                   |
| 24 State gasoline tax refund                            |  |                   |
| 25 Other (specify):                                     |  |                   |
| 26 Add lines 4 through 25                               |  | <i>\$20350.75</i> |
| 27 Amount from line 3, column d, above                  |  |                   |
| 28 Gross profit* (add lines 26 and 27)                  |  | <i>\$20350.75</i> |

52 Net farm profit (or loss) (subtract line 51 from line 28). Enter here and include in total on line 14, Form 1040. ALSO enter on Schedule SE, Part II, line 1a

*\$ 8185.96*

### Part II Farm Deductions

Do not include personal or living expenses not attributable to production of farm income, such as taxes, insurance, repairs, etc., on your dwelling.

| Items   | Amount            |
|---|-------------------|
| 29 Labor hired  | <i>\$ 1345 -</i>  |
| 30 Repairs, maintenance   | <i>35.65</i>      |
| 31 Interest   | <i>285 -</i>      |
| 32 Rent of farm, pasture  |                   |
| 33 Feed purchased   | <i>383.16</i>     |
| 34 Seed, plants purchased   |                   |
| 35 Fertilizers, lime  | <i>72.20</i>      |
| 36 Machine hire   | <i>128 -</i>      |
| 37 Supplies purchased   | <i>526.75</i>     |
| 38 Breeding fees  |                   |
| 39 Veterinary, medicine   | <i>204.40</i>     |
| 40 Gasoline, fuel, oil  |                   |
| 41 Storage, warehousing   |                   |
| 42 Taxes  | <i>378.59</i>     |
| 43 Insurance  | <i>747 -</i>      |
| 44 Utilities  | <i>70.06</i>      |
| 45 Freight, trucking  |                   |
| 46 Conservation expenses  |                   |
| 47 Retirement plans, etc. (other than your share — See separate instructions) |                   |
| 48 Other (specify):   |                   |
| <i>ADVERTISING</i>  | <i>34.52</i>      |
| <i>TELEPHONE</i>  | <i>215.99</i>     |
| <i>HORSE-SHOEING</i>  | <i>42 -</i>       |
| <i>FEES-LIC REGISTER</i>  | <i>106.50</i>     |
| <i>ACCOUNTING</i>   | <i>75 -</i>       |
| <i>BRONCO PICKUP EXP.</i>   | <i>1463.76</i>    |
| <i>AUTO EXPENSE</i>   | <i>354.20</i>     |
| <i>TRUCK EXPENSE</i>  | <i>3218.89</i>    |
| 49 Add lines 29 through 48  | <i>\$ 9686.67</i> |
| 50 Depreciation (from line 54, Part III)                                      | <i>2478.12</i>    |
| 51 Total deductions. Add lines 49 and 50                                      | <i>\$12164.79</i> |

\* Use this amount for optional method of computing net earnings from self-employment. (See line 3, Part II, Schedule SE.)

Name(s) as shown on Form 1040: Paul + Lois B. Smith  
 Social security number: 530 01 8188  
 Business name and address: Laaglan, Oregon  
 Location of farm(s) and number of acres in each farm: same  
 Employer identification number (See instructions): None  
 SALEM, OREGON

**Part I Farm Income—Cash Receipts and Disbursements Method**  
Do not include sales of livestock held for draft, breeding, sport, or dairy purposes; report such sales on Form 4797.

**Sales of Purchased Livestock and Other Items Purchased for Resale**

| a. Description  | b. Amount received | c. Cost or other basis |
|---|--------------------|------------------------|
| 1 Livestock:  | \$                 | \$                     |
| 2 Other items:  |                    |                        |
| 3 Totals  | \$                 | \$                     |
| 4 Profit or (loss), subtract line 3, column c from line 3, column b |                    | \$                     |

**Sales of Market Livestock and Produce Raised and Held Primarily for Sale and Other Farm Income**

| Kind  | Quantity | Amount      |
|---|----------|-------------|
| 5 Cattle  |          | \$ 1920 65  |
| 6 Calves  |          |             |
| 7 Sheep   |          |             |
| 8 Swine   |          |             |
| 9 Poultry   |          |             |
| 10 Dairy products   |          |             |
| 11 Eggs   |          |             |
| 12 Wool   |          |             |
| 13 Cotton   |          |             |
| 14 Tobacco  |          |             |
| 15 Vegetables   |          |             |
| 16 Grain  |          |             |
| 17 Fruits and nuts  |          |             |
| 18 Other (specify):<br>BREEDING FEES 200 -<br>HORSE SHOW JUDGING 50 - |          |             |
| <b>OTHER FARM INCOME</b>  |          |             |
| 19 Machine work   |          |             |
| 20 (a) Patronage dividends (See Sch. F instructions)                  |          |             |
| (b) Per-unit retains (See Sch. F instructions)                        |          |             |
| 21 Nonpatronage distributions from exempt cooperatives                |          |             |
| 22 Agricultural program payments:<br>(1) Cash                         |          |             |
| (2) Materials and services  |          |             |
| 23 Commodity credit loans under election (or forfeited)               |          |             |
| 24 Federal gasoline tax credit  |          |             |
| 25 State gasoline tax refund  |          |             |
| 26 Other (specify):<br>MILK HAULING FORM 1099                         |          | 14688 48    |
| 27 Add lines 5 through 26   |          | \$ 16859 13 |
| 28 Gross profit *(add lines 4 and 27)                                 |          | \$ 16859 13 |

**Part II Farm Deductions—For Cash and Accrual Method Taxpayers**

Do not include personal or living expenses not attributable to production of farm income, such as taxes, insurance, repairs, etc., on your dwelling.

| Items  | Amount      |
|--|-------------|
| 29 Labor hired   | \$ 622 15   |
| 30 Repairs, maintenance  | 1328 25     |
| 31 Interest  |             |
| 32 Rent of farm, pasture   | 100 -       |
| 33 Feed purchased  | 870 24      |
| 34 Seed, plants purchased  | 289 18      |
| 35 Fertilizers, lime   | 532 37      |
| 36 Machine hire  | 200 -       |
| 37 Supplies purchased  | 105 76      |
| 38 Breeding fees   |             |
| 39 Veterinary, medicine  | 400 35      |
| 40 Gasoline, fuel, oil   | 1996 30     |
| 41 Storage, warehousing  |             |
| 42 Taxes   | 301 34      |
| 43 Insurance   | 1108 44     |
| 44 Utilities   | 71 37       |
| 45 Freight, trucking   |             |
| 46 Conservation expenses   |             |
| 47 Land clearing expenses  |             |
| 48 Pension and profit-sharing plans (see Sch. F instructions)  |             |
| 49 Employee benefit programs other than line 48 (see Sch. F instructions)  |             |
| 50 Other (specify):<br>TELEPHONE 266 -<br>ACCOUNTING 75 -<br>OFFICE SUPPLIES 8 25<br>TRUCK TIRES 501 94<br>PAYROLL INSURANCE 100 -<br>FEES LICENSES 368 34<br>NEWS SUBSCRIPTIONS 415 02<br>ADVERTISING 30 -<br>HORSE TRAINING BOARD 290 -<br>PICKUP-BRONCO CAR EXP 1497 08 |             |
| 51 Add lines 29 through 50   | \$ 11482 38 |
| 52 Depreciation (from line 59, Part III)   | 2851 71     |
| 53 Total deductions. Add lines 51 and 52   | \$ 14334 09 |
| 54 Net farm profit or (loss) (subtract line 53 from 28). Enter here and on Form 1040, line 32. ALSO enter on Schedule SE, Part I, line 1(a)  | \$ 2525 04  |

\* Use amount on line 28 for optional method of computing net earnings from self-employment. (See Schedule SE, Part I, line 3.)

# Farm Income and Expenses

▶ Attach to Form 1040, Form 1041, or Form 1065.  
▶ See Instructions for Schedule F (Form 1040).

**1979** DEC 18 1992  
16

Name of proprietor(s)

PAUL & LOIS B SMITH 530-01-0188

Social security number

WATER RESOURCES  
SALEM, OREGON

Farm name and address ▶ Box 96 WANAPOIS OR

Employer identification number (see instructions)  
913 016 1517 1319 12

**Part I Farm Income—Cash Method**  
Do not include sales of livestock held for draft, breeding, sport, or dairy purposes; report these sales on Form 4797.

| Sales of Livestock and Other Items You Bought for Resale                       |             |                        |
|--|-------------|------------------------|
| a. Description   | b. Amount   | c. Cost or other basis |
| 1 Livestock ▶ <u>7 STEERS</u>  | <u>3335</u> | <u>3000</u>            |
| 2 Other items ▶  |             |                        |
| 3 Totals . . . . .   | <u>3335</u> | <u>3000</u>            |
| 4 Profit or (loss), subtract line 3, column c, from line 3, column b . . . . . |             | <u>335</u>             |

**Sales of Livestock and Produce You Raised and Other Farm Income**

| Kind  | Amount       |
|---|--------------|
| 5 Cattle . . . . .  | <u>6907</u>  |
| 6 Calves . . . . .  |              |
| 7 Sheep . . . . .   |              |
| 8 Swine . . . . .   |              |
| 9 Poultry . . . . .   |              |
| 10 Dairy products . . . . .                                       |              |
| 11 Eggs . . . . .   |              |
| 12 Wool . . . . .   |              |
| 13 Cotton . . . . .   |              |
| 14 Tobacco . . . . .  |              |
| 15 Vegetables . . . . .   |              |
| 16 Soybeans . . . . .   |              |
| 17 Corn . . . . .   |              |
| 18 Other grains . . . . .   |              |
| 19 Hay . . . . .  |              |
| 20 Straw . . . . .  |              |
| 21 Fruits and nuts . . . . .                                      |              |
| 22 Machine work . . . . .   |              |
| 23 Patronage dividends . . . . .                                  |              |
| 24 Per-unit retains . . . . .                                     |              |
| 25 Nonpatronage distributions from exempt cooperatives . . . . .  |              |
| 26 Agricultural program payments: a Cash . . . . .                |              |
| b Materials and services . . . . .                                |              |
| 27 Commodity credit loans under election (or forfeited) . . . . . |              |
| 28 Federal gasoline tax credit . . . . .                          |              |
| 29 State gasoline tax refund . . . . .                            |              |
| 30 Other (specify) . . . . .                                      |              |
| <u>MILK HAULING (0.99MISC)</u>                                    | <u>13713</u> |
| 31 Add lines 5 through 30 . . . . .                               | <u>20620</u> |
| 32 Gross profits* (add lines 4 and 31) . . . . .                  | <u>20955</u> |

**Part II Farm Deductions—Cash and Accrual Method**  
Do not include personal or living expenses (such as taxes, insurance, repairs, etc., on your home), which do not produce farm income. Reduce the amount of your farm deductions by any reimbursement before entering the deduction below.

| Items   | Amount       |
|---|--------------|
| 33 a Labor hired . . . . .                                | <u>120</u>   |
| b Jobs credit . . . . .                                   |              |
| c WIN credit . . . . .                                    |              |
| d Total credits . . . . .                                 |              |
| e Balance (subtract line 33d from line 33a) . . . . .     | <u>120</u>   |
| 34 Repairs, maintenance . . . . .                         | <u>2818</u>  |
| 35 Interest . . . . .                                     | <u>1879</u>  |
| 36 Rent of farm, pasture . . . . .                        | <u>100</u>   |
| 37 Feed purchased . . . . .                               | <u>542</u>   |
| 38 Seeds, plants purchased . . . . .                      |              |
| 39 Fertilizers, lime, chemicals . . . . .                 |              |
| 40 Machine hire . . . . .                                 |              |
| 41 Supplies purchased . . . . .                           | <u>741</u>   |
| 42 Breeding fees . . . . .                                |              |
| 43 Veterinary fees, medicine . . . . .                    | <u>560</u>   |
| 44 Gasoline, fuel, oil . . . . .                          | <u>5274</u>  |
| 45 Storage, warehousing . . . . .                         |              |
| 46 Taxes . . . . .  | <u>287</u>   |
| 47 Insurance . . . . .                                    | <u>1385</u>  |
| 48 Utilities . . . . .                                    | <u>58</u>    |
| 49 Freight, trucking . . . . .                            |              |
| 50 Conservation expenses . . . . .                        |              |
| 51 Land clearing expenses . . . . .                       |              |
| 52 Pension and profit-sharing plans . . . . .             |              |
| 53 Employee benefit programs other than line 52 . . . . . |              |
| 54 Other (specify) ▶ <u>SCHEDULE</u>                      | <u>227</u>   |
| <u>TAX PREP</u>   | <u>140</u>   |
| <u>OFFICE SUPPLIES</u>                                    | <u>25</u>    |
| <u>TRAVEL &amp; ENT.</u>                                  | <u>117</u>   |
| <u>SUBSCRIPTIONS</u>                                      | <u>133</u>   |
| <u>ADVERTISING</u>  | <u>10</u>    |
| <u>REGISTRY</u>   | <u>50</u>    |
| <u>LICENSES &amp; FEES</u>                                | <u>236</u>   |
| 55 Add lines 33e through 54 . . . . .                     | <u>14757</u> |
| 56 Depreciation (from Part III, line 62) . . . . .        | <u>1931</u>  |
| 57 Total deductions (add lines 55 and 56) . . . . .       | <u>16688</u> |

58 Net farm profit or (loss) (subtract line 57 from line 32). If a profit, enter on Form 1040, line 19, and on Schedule SE, Part I, line 1a. If a loss, go on to line 59. (Fiduciaries and partnerships, see the Instructions.) . . . . . **58** 4267

59 If you have a loss, do you have amounts for which you are not "at risk" in this farm (see Instructions)? . . . . .  Yes  No

\*Use amount on line 32 for optional method of computing net earnings from self-employment. (See Schedule SE, Part I, line 3.) 87-0128317

**SCHEDULE F  
(Form 1040)**

Department of the Treasury  
Internal Revenue Service (0)

**Farm Income and Expenses**

▶ Attach to Form 1040, Form 1041, or Form 1065.  
▶ See Instructions for Schedule F (Form 1040).

OMB No. 1545-0074

**1984**

DEC 18 1992

WATER RESOURCES DEPT  
14 SALEM, OREGON

Name of proprietor(s)

PAUL & LOIS B SMITH

Social security number (SSN)

530 01 8188

If you disposed of commodities received under the payments-in-kind (PIK) program, check the box(es) that apply:

Feed for livestock,  Sold and reported in income.

Employer ID number (NOT SSN)

**Part I Farm Income—Cash Method**

Do not include sales of livestock held for draft, breeding, sport, or dairy purposes; report these sales on Form 4797.

**Sales of Livestock and Other Items You Bought for Resale**

| a. Description   | b. Amount | c. Cost or other basis |
|--|-----------|------------------------|
| 1 Livestock ▶  |           |                        |
| 2 Other items ▶  |           |                        |
| 3 Totals   |           |                        |
| 4 Profit or (loss), subtract line 3, column c, from line 3, column b ▶ |           |                        |

**Part II Farm Deductions—Cash or Accrual Method**

Do not include personal or living expenses (such as taxes, insurance, repairs, etc., on your home), which do not produce farm income. Reduce the amount of your farm deductions by any reimbursement before entering the deduction below.

| Items  | Amount |
|--|--------|
| 32 a Labor hired   | 221    |
| b Jobs credit  | ( )    |
| c Balance (subtract line 32b from line 32a)                  | 221    |
| 33 Repairs, maintenance                                      | 137    |
| 34 Interest  |        |
| 35 Rent of farm, pasture                                     |        |
| 36 Feed purchased  | 259    |
| 37 Seeds, plants purchased                                   |        |
| 38 Fertilizers, lime, chemicals                              |        |
| 39 Machine hire  | 130    |
| 40 Supplies purchased  | 433    |
| 41 Breeding fees   |        |
| 42 Veterinary fees, medicine                                 | 496    |
| 43 Gasoline, fuel, oil                                       |        |
| 44 Storage, warehousing                                      |        |
| 45 Taxes   |        |
| 46 Insurance   | 698    |
| 47 Utilities   | 120    |
| 48 Freight, trucking   |        |
| 49 Conservation expenses                                     |        |
| 50 Land clearing expenses (see instructions for limitations) |        |
| 51 Pension and profit-sharing plans                          |        |
| 52 Employee benefit programs other than line 51              |        |
| 53 Depreciation and Section 179 deduction (from Form 4562)   | 3614   |
| 54 Other (specify) ▶   |        |
| PROF SERV  | 158    |
| TRANSFER FEE   | 70     |
| TELEPHONE  | 140    |
| DUES/PUBL  | 370    |
| AUTO/TRUCK   | 1262   |
| OFFICE SUPP.   | 30     |
| 55 Total deductions (add lines 32c through 54)               | 7970   |

**Sales of Livestock and Produce You Raised and Other Farm Income**

| Kind  | Amount |
|---|--------|
| 5 Cattle and calves                                     | 5312   |
| 6 Sheep   |        |
| 7 Swine   |        |
| 8 Poultry   |        |
| 9 Dairy products  |        |
| 10 Eggs   |        |
| 11 Wool   |        |
| 12 Cotton   |        |
| 13 Tobacco  |        |
| 14 Vegetables   |        |
| 15 Soybeans   |        |
| 16 Corn   |        |
| 17 Other grains   |        |
| 18 Hay and straw  |        |
| 19 Fruits and nuts                                      |        |
| 20 Machine work   |        |
| 21 a Patronage dividends                                |        |
| b Less: Nonincome items                                 |        |
| c Net patronage dividends                               |        |
| 22 Per-unit retains                                     |        |
| 23 Nonpatronage distributions from exempt cooperatives  |        |
| 24 Agricultural program payments: a Cash                |        |
| b Materials and services                                |        |
| 25 Commodity credit loans under election (or forfeited) |        |
| 26 Federal gasoline tax credit                          |        |
| 27 State gasoline tax refund                            |        |
| 28 Crop insurance proceeds                              |        |
| 29 Other (specify) ▶ <u>2 HORSES</u>                    | 3000   |
| 30 Add amounts in column for lines 5 through 29         |        |
| 31 Gross profits (add lines 4 and 30)                   | 8312   |

56 Net farm profit or (loss) (subtract line 55 from line 31). If a profit, enter on Form 1040, line 19, and on Schedule SE, Part I, line 1. If a loss, you MUST go on to line 57. (Fiduciaries and partnerships, see the Instructions.)

56 184

57 If you have a loss, you MUST answer this question: "Do you have amounts for which you are not at risk in this farm (see Instructions)?"  Yes  No  
If "Yes," you MUST attach Form 6198. If "No," enter the loss on Form 1040, line 19, and on Schedule SE, Part I, line 1.



# Farm Income and Expenses

▶ Attach to Form 1040, Form 1041, or Form 1065.  
▶ See Instructions for Schedule F (Form 1040).

**1989**  
DEC 18 1992  
14

|   |  |   |
|---|--|---|
| Name of proprietor<br><b>PAUL SMITH</b>   |  | Social security number (SSN)<br><b>530-01-8188</b>  |
| A Principal Product (Describe in one or two words your principal crop or activity for the current tax year.)<br><b>CATTLE</b>           |  | B Agricultural Activity Code (from Part IV) ▶ <b>260</b>  |
| C Accounting Method:<br><input checked="" type="checkbox"/> Cash <input type="checkbox"/> Accrual                                       |  | D Employer ID no. (Not SSN)   |
| E Did you make an election in a prior year to include Commodity Credit Corporation loan proceeds as income in that year? . . .          |  | <input type="checkbox"/> Yes <input checked="" type="checkbox"/> No   |
| F Did you "materially participate" in the operation of this business during 1989? (If "No," see Instructions for limitation on losses.) |  | <input checked="" type="checkbox"/> Yes <input type="checkbox"/> No   |
| G Do you elect, or did you previously elect, to currently deduct certain preproductive period expenses? (See Instructions.) . . . . .   |  | <input checked="" type="checkbox"/> Does not apply <input type="checkbox"/> Yes <input type="checkbox"/> No |

If you choose to revoke a prior election for animals, see the Instructions.

**Part I Farm Income – Cash Method – Complete Parts I and II** (Accrual method taxpayers complete Parts II and III, and line 11 of Part I.)  
Do not include sales of livestock held for draft, breeding, sport, or dairy purposes; report these sales on Form 4797.

|    |   |    |  |        |
|----|---|----|--|--------|
| 1  | Sales of livestock and other items you bought for resale . . . . .  | 1  |  |        |
| 2  | Cost or other basis of livestock and other items you bought for resale . . . . .  | 2  |  |        |
| 3  | Subtract line 2 from line 1 . . . . .   | 3  |  |        |
| 4  | Sales of livestock, produce, grains, and other products you raised . . . . .  | 4  |  | 7,403. |
| 5a | Total cooperative distributions (Form(s) 1099-PATR) . . . . .   | 5a |  |        |
| 5b | Taxable amount . . . . .  | 5b |  |        |
| 6a | Agricultural program payments (see instructions) . . . . .  | 6a |  |        |
| 6b | Taxable amount . . . . .  | 6b |  |        |
| 7  | Commodity Credit Corporation (CCC) loans:   |    |  |        |
| a  | CCC loans reported under election (see Instructions) . . . . .  | 7a |  |        |
| b  | CCC loans forfeited or repaid with certificates . . . . .   | 7b |  |        |
| 7c | Taxable amount . . . . .  | 7c |  |        |
| 8  | Crop insurance proceeds and certain disaster payments (see Instructions):   |    |  |        |
| a  | Amount received in 1989 . . . . .   | 8a |  |        |
| 8b | Taxable amount . . . . .  | 8b |  |        |
| c  | If election to defer to 1990 is attached, check here ▶ <input type="checkbox"/> 8d Amount deferred from 1988 . . . . .  | 8d |  |        |
| 9  | Custom hire (machine work) income . . . . .   | 9  |  | 400.   |
| 10 | Other income, including Federal and state gasoline or fuel tax credit or refund (see Instructions) . . . . .  | 10 |  |        |
| 11 | Add amounts in the right column for lines 3 through 10. If accrual method taxpayer, enter the amount from page 2, line 51. This is your <b>gross income</b> . . . . . ▶ | 11 |  | 7,803. |

**Part II Farm Expenses – Cash and Accrual Method** (Do not include personal or living expenses such as taxes, insurance, repairs, etc., on your home.)

|    |  |     |                                     |                                 |
|----|--|-----|-------------------------------------|---------------------------------|
| 12 | Breeding fees . . . . .  | 12  |                                     |                                 |
| 13 | Chemicals . . . . .  | 13  |                                     |                                 |
| 14 | Conservation expenses (you must attach Form 8645) . . . . .  | 14  |                                     |                                 |
| 15 | Custom hire (machine work) . . . . .   | 15  | 205.                                |                                 |
| 16 | Depreciation and section 179 deduction not claimed elsewhere (from Form 4562) . . . . .  | 16  | 3,951.                              |                                 |
| 17 | Employee benefit programs other than on line 25 . . . . .  | 17  |                                     |                                 |
| 18 | Feed purchased . . . . .   | 18  | 238.                                |                                 |
| 19 | Fertilizers and lime . . . . .   | 19  |                                     |                                 |
| 20 | Freight and trucking . . . . .   | 20  |                                     |                                 |
| 21 | Gasoline, fuel, and oil . . . . .  | 21  | 1,141.                              |                                 |
| 22 | Insurance (other than health) . . . . .  | 22  | 953.                                |                                 |
| 23 | Interest:  |     |                                     |                                 |
| a  | Mortgage (paid to banks, etc.) . . . . .   | 23a |                                     |                                 |
| b  | Other . . . . .  | 23b |                                     |                                 |
| 24 | Labor hired (less jobs credit) . . . . .   | 24  |                                     | 250.                            |
| 25 | Pension and profit-sharing plans . . . . .   | 25  |                                     |                                 |
| 26 | Rent or lease:   |     |                                     |                                 |
| a  | Machinery and equipment . . . . .  | 26a |                                     |                                 |
| b  | Other (land, animals, etc.) . . . . .  | 26b |                                     |                                 |
| 27 | Repairs and maintenance . . . . .  | 27  |                                     | 767.                            |
| 28 | Seeds and plants purchased . . . . .   | 28  |                                     |                                 |
| 29 | Storage and warehousing . . . . .  | 29  |                                     |                                 |
| 30 | Supplies purchased . . . . .   | 30  |                                     | 554.                            |
| 31 | Taxes . . . . .  | 31  |                                     | 628.                            |
| 32 | Utilities (see Instructions) . . . . .   | 32  |                                     | 450.                            |
| 33 | Veterinary fees and medicine . . . . .   | 33  |                                     | 935.                            |
| 34 | Other expenses (specify):  |     |                                     |                                 |
| a  | DUES PUBS . . . . .  | 34a |                                     | 182.                            |
| b  | LICENSES . . . . .   | 34b |                                     | 49.                             |
| c  | OFFICE . . . . .   | 34c |                                     | 41.                             |
| d  | RECORD FEE . . . . .   | 34d |                                     | 20.                             |
| e  |  | 34e |                                     |                                 |
| 35 | Add amounts on lines 12 through 34e. These are your <b>total expenses</b> . . . . . ▶  | 35  |                                     | 10,364.                         |
| 36 | <b>Net farm profit or (loss)</b> . Subtract line 35 from line 11. If a profit, enter on Form 1040, line 19, and on Sch. SE, line 1. If a loss, you <b>MUST</b> go on to line 37. (Fiduciaries and partnerships, see Instructions.) . . . . . | 36  |                                     | -2,561.                         |
| 37 | If you have a loss, you <b>MUST</b> check the box that describes your investment in this activity (see instructions) . . . . .   | 37a | <input checked="" type="checkbox"/> | All investment is at risk.      |
|    |  | 37b | <input type="checkbox"/>            | Some investment is not at risk. |
|    | If you checked 37a, enter the loss on Form 1040, line 19, and Schedule SE, line 1.<br>If you checked 37b, you <b>MUST</b> attach Form 6198.  |     |                                     |                                 |

Year 1906  
 4 Curry County  
 30-15

Township 30 S. R. 15 W.

DEC 18 1992  
 WATER RESOURCES DEPT.  
 SALEM, OREGON

ASSESSMENT

| POSTOFFICE ADDRESS | NAME OF TAXPAYER       | DESCRIPTION OF LAND  | Section | Township | Range | No. of Acres of Tillable Land | Value of Tillable Land | No. of Acres Non-Tillable Land | Value of Non-Tillable Land | Value of Improvements on Deeded or Patented Land | NAME OF RECORDED TOWN OR CITY | Lot No. | Block No. |
|--------------------|------------------------|--|---------|----------|-------|-------------------------------|------------------------|--------------------------------|----------------------------|--|-------------------------------|---------|-----------|
|                    | Langlois McConnell J W | N <sup>2</sup> NE <sup>4</sup> , NE <sup>4</sup> NW <sup>4</sup> , SE <sup>4</sup> NE <sup>4</sup>   | 25      |          |       |                               |                        | 120                            | 240                        |  |                               |         |           |
|                    | Wilson A. G.           | E <sup>2</sup> SE <sup>4</sup> SW <sup>4</sup> NE <sup>4</sup> , SE <sup>4</sup> NW <sup>4</sup><br>W <sup>2</sup> NW <sup>4</sup>   | 25      |          |       |                               |                        | 200                            | 500                        | 150  |                               |         |           |
|                    | Clausen J.             | Lots 1, 8  | 26      |          |       | 7                             | 105                    | 154                            | 616                        | 300  |                               |         |           |
|                    | Stancliff M. E.        | E <sup>2</sup> SW <sup>4</sup> , SW <sup>4</sup> SW <sup>4</sup>   | 26      |          |       |                               |                        | 160                            | 640                        |  |                               |         |           |
|                    | Conroy W.              | Lots 2-3   | 26      |          |       |                               |                        | 872                            | 243                        |  |                               |         |           |
|                    | Marshall Etta          | Lots 5-6-7-10 SW <sup>4</sup> SW <sup>4</sup>  | 26      |          |       |                               |                        | 202                            | 606                        |  |                               |         |           |
|                    | Thorsbaven E.          | E <sup>2</sup> SW <sup>4</sup> , NW <sup>4</sup> SW <sup>4</sup> , Lot 11  | 26      |          |       | 4                             | 180                    | 156                            | 936                        | 300  |                               |         |           |
|                    | McKellan W.            | Lot 4<br>N <sup>2</sup> NE <sup>4</sup>  | 26      |          |       |                               |                        | 12022                          | 726                        |  |                               |         |           |
|                    | Marshall W. S.         | S <sup>2</sup> , NW <sup>4</sup> , S <sup>2</sup> NE <sup>4</sup> ,<br>Lot 1, E <sup>2</sup> SE <sup>4</sup> ,<br>1/2 NE <sup>4</sup> ,  | 27      |          |       |                               |                        |                                |                            |  |                               |         |           |
|                    |                        | 1/2 N <sup>2</sup>   | 28      |          |       | 40                            | 1400                   | 975                            | 7800                       | 500  |                               |         |           |
|                    |                        | SE <sup>4</sup> , S <sup>2</sup> NE <sup>4</sup> , E <sup>2</sup> SW <sup>4</sup> Lot 1  | 33      |          |       |                               |                        |                                |                            |  |                               |         |           |
|                    | Thrift - J. F.         | S <sup>2</sup> , S <sup>2</sup> N <sup>2</sup>   | 34      |          |       | 150                           | 6750                   | 702                            | 7020                       | 2000   |                               |         | P.O.      |
|                    | Bosser E.              | N <sup>2</sup> NW <sup>4</sup> , W <sup>2</sup> NE <sup>4</sup> , less 14 a to Mrs E Cheever<br>NW <sup>4</sup> , 8 a in N <sup>2</sup> SW <sup>4</sup> , as described on page 431 of Rec. deels | 35      |          |       |                               |                        | 309                            | 927                        | 600  |                               |         |           |
|                    | Guerin Bros.           | N <sup>2</sup> SW <sup>4</sup> ; S <sup>2</sup> NW <sup>4</sup>  | 35      |          |       | 4                             | 150                    | 233                            | 1118                       | 500  |                               |         |           |
|                    | Cheever Mrs E          | in SW <sup>4</sup> NE <sup>4</sup> , 14 a from E Bosser  | 35      |          |       |                               |                        | 14                             | 56                         |  |                               |         |           |
|                    | Willard Helen          | Double Sec Page 10 line 6  |         |          |       |                               |                        |                                |                            |  | Daryville                     | 1       | 1         |
|                    | Simons J F.            | 1/2 2 adjoining Daryville<br>Corm. at a point on N. line of Sec <sup>4</sup> where Boundary of P.O. Road   |         |          |       |                               |                        | 12                             | 55                         | 25   |                               |         |           |
|                    | Hargraves Annie        | Crossed land line E 1/2 sec 35 yds W 1/2 140 yds N 1/2 25 yds to line of sec 35  |         |          |       |                               |                        | 1                              | 30                         | 500  | Langlois                      | 3       | 2         |
|                    | Bosser Mary            | From Andrew Bosser   |         |          |       |                               |                        |                                |                            |  |                               |         |           |
|                    | Langlois F. M.         | Tract SW <sup>4</sup> SW <sup>4</sup>  | 35      |          |       | 15                            | 225                    | 67                             | 513                        | 700  | P.O.                          |         |           |
|                    |                        |  |         |          |       |                               |                        |                                |                            |  |                               |         |           |

taxes  
 3.40 Interest  
 + 54  
 3.94 - 1907  
 2.28 1910