

Application for a Permit to Use Surface Water



Oregon Water Resources Department
725 Summer Street NE, Suite A
Salem, Oregon 97301-1266
503-986-0900
www.oregon.gov/OWRD

SECTION 1: APPLICANT INFORMATION AND SIGNATURE

Applicant

NAME John Kabot		PHONE (HM) (619) 857-2000	
PHONE (WK)	CELL (619) 857-2000	FAX	
MAILING ADDRESS 1267 Fish Hatchery Road			
CITY Grants Pass	STATE OR	ZIP 97527	E-MAIL * johnkabot@yahoo.com

Organization

NAME		PHONE	FAX
MAILING ADDRESS			CELL
CITY	STATE	ZIP	E-MAIL *

Agent – The agent is authorized to represent the applicant in all matters relating to this application.

AGENT / BUSINESS NAME		PHONE	FAX
MAILING ADDRESS			CELL
CITY	STATE	ZIP	E-MAIL *

Note: Attach multiple copies as needed

* By providing an e-mail address, consent is given to receive all correspondence from the Department electronically. (Paper copies of the proposed and final order documents will also be mailed.)

By my signature below I confirm that I understand:

- I am asking to use water specifically as described in this application.
- Evaluation of this application will be based on information provided in the application.
- I cannot legally use water until the Water Resources Department issues a permit.
- The Department encourages all applicants to wait for a permit to be issued before beginning construction of any proposed diversion. Acceptance of this application does not guarantee a permit will be issued.
- If I begin construction prior to the issuance of a permit, I assume all risks associated with my actions.
- If I receive a permit, I must not waste water.
- If development of the water use is not according to the terms of the permit, the permit can be cancelled.
- The water use must be compatible with local comprehensive land use plans.
- Even if the Department issues a permit, I may have to stop using water to allow senior water right holders to receive water to which they are entitled.

I (we) affirm that the information contained in this application is true and accurate

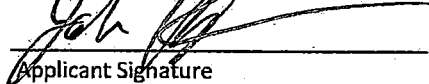
	John Kabot	2/10/25
Applicant Signature	Print Name and Title if applicable	Date
_____	_____	_____
Applicant Signature	Print Name and Title if applicable	Date

For Department Use: App. Number: _____

Surface Water — Page 1
Rev. 07/21

Received by OWRD

FEB 27 2025

Salem, OR

SECTION 2: PROPERTY OWNERSHIP

Please indicate if you own all the lands associated with the project from which the water is to be diverted, conveyed, and used.

- YES, there are no encumbrances.
- YES, the land is encumbered by easements, rights of way, roads or other encumbrances.
- NO, I have a recorded easement or written authorization permitting access.
- NO, I do not currently have written authorization or easement permitting access.
- NO, written authorization or an easement is not necessary, because the only affected lands I do not own are state-owned submersible lands, and this application is for irrigation and/or domestic use only (ORS 274.040).
- NO, because water is to be diverted, conveyed, and/or used only on federal lands.

Affected Landowners: List the names and mailing addresses of all owners of any lands that are not owned by the applicant and that are crossed by the proposed ditch, canal or other work, even if the applicant has obtained written authorization or an easement from the owner. (Attach additional sheets if necessary).

Legal Description: You must provide the legal description of: 1. The property from which the water is to be diverted, 2. Any property crossed by the proposed ditch, canal or other work, and 3. Any property on which the water is to be used as depicted on the map.

SECTION 3: SOURCE OF WATER

A. Proposed Source of Water

Provide the commonly used name of the water body from which water will be diverted, and the name of the stream or lake it flows into (if unnamed, say so), and the locations of the point of diversion (POD):

Source 1: Slate Creek	Tributary to: Applegate River
TRSQQ of POD: T37S R7W Section 10 SE/SW	
Source 2:	Tributary to:
TRSQQ of POD:	

If any source listed above is stored water that is authorized under a water right permit, certificate, or decree, attach a copy of the document or list the document number (for decrees, list the volume, page and/or decree name).

Received by OWRD
FEB 27 2025
Salem, OR

B. Applications to Use Stored Water

Do you, or will you, own the reservoir(s) described in Section 3A above?

Yes. No. (Enclose a copy of your written notification to the operator of the reservoir of your intent to file this application, which should have been mailed or delivered to the operator.)

If all sources listed in Section 3A are stored water, the Department will review your application using the expedited process provided in ORS 537.147, unless you check the box below. Please see the instruction booklet for more information.

By checking this box, you are requesting that the Department process your application under the standard process outlined in ORS 537.150 and 537.153, rather than the expedited process provided by ORS 537.147. To file an application under the standard process, you must enclose the following:

- A copy of a signed non-expired contract or other agreement with the owner of the reservoir (if not you) to impound the volume of water you propose to use in this application.
- A copy of your written agreement with the party (if any) delivering the water from the reservoir to you.

SECTION 4: SENSITIVE, THREATENED OR ENDANGERED FISH SPECIES PUBLIC INTEREST INFORMATION

This information must be provided for your application to be accepted as complete. The Water Resources Department will determine whether the proposed use will impair or be detrimental to the public interest with regard to sensitive, threatened or endangered fish species.

Received by OWRD

FEB 27 2025

Salem, OR

To answer the following questions, use the map provided in Attachment 3 or the link below to determine whether the proposed point of diversion (POD) is located in an area where the Upper Columbia, the Lower Columbia, and/or the Statewide public interest rules apply.

For more detailed information, click on the following link and enter the T,R,S,QQ or the Lat/Long of a POD and click on "Submit" to retrieve a report that will show which section, if any, of the rules apply:

https://apps.wrd.state.or.us/apps/misc/lkp_trsqg_features/

If you need help to determine in which area the proposed POD is located, please call the customer service desk at (503) 986-0900.

Upper Columbia - OAR 690-033-0115 thru -0130

Is the POD located in an area where the Upper Columbia Rules apply?

Yes No

If yes, you are notified that the Water Resources Department will consult with numerous federal, state, local and tribal governmental entities so it may determine whether the proposed use is consistent with the "Columbia River Basin Fish and Wildlife Program" adopted by the Northwest Power Planning Council in 1994 for the protection and recovery of listed fish species. The application may be denied, heavily conditioned, or if appropriate, mitigation for impacts may be needed to obtain approval for the proposed use.

If yes,

- I understand that the proposed use does not involve appropriation of direct streamflow during the time period April 15 to September 30, except as provided in OAR 690-033-0140.
- I understand that I will install, operate and maintain a fish screen and fish passage as listed in ORS 498.301 through 498.346, and 509.580 through 509.910, to the specifications and extent required by Oregon Department of Fish and Wildlife, prior to diversion of water under any permit issued pursuant to this application.
- I understand that the Oregon Department of Environmental Quality will review my application to determine if the proposed use complies with existing state and federal water quality standards.
- I understand that I will install and maintain water use measurement and recording devices as required by the Water Resources Department, and comply with recording and reporting permit condition requirements.

Lower Columbia - OAR 690-033-0220 thru -0230

Is the POD located in an area where the Lower Columbia rules apply?

Yes No

If yes, you are notified that that the Water Resources Department will determine, by reviewing recovery plans, the Columbia River Basin Fish and Wildlife Program, and regional restoration programs applicable to threatened or endangered fish species, in coordination with state and federal agencies, as appropriate, whether the proposed use is detrimental to the protection or recovery of a threatened or endangered fish species and whether the use can be conditioned or mitigated to avoid the detriment.

If a permit is issued, it will likely contain conditions to ensure the water use complies with existing state and federal water quality standards; and water use measurement, recording and reporting required by the Water Resources Department. The application may be denied, or if appropriate, mitigation for impacts may be needed to obtain approval of the proposed use.

If yes, provide the following information (the information must be provided with the application to be considered complete).

Yes No The proposed use is for more than one cubic foot per second (448.8 gpm) and is not subject to the requirements of OAR 690, Division 86 (Water Management and Conservation Plans).

If yes, provide a description of the measures to be taken to assure reasonably efficient water use:

Statewide - OAR 690-033-0330 thru -0340

Is the POD located in an area where the Statewide rules apply?

Yes No

If yes, the Water Resources Department will determine whether the proposed use will occur in an area where endangered, threatened or sensitive fish species are located. If so, the Water Resources Department, Department of Fish and Wildlife, Department of Environmental Quality, and the Department of Agriculture will recommend conditions required to achieve "no loss of essential habitat of threatened and endangered (T&E) fish species," or "no net loss of essential habitat of sensitive (S) fish species." If conditions cannot be identified that meet the standards of no loss of essential T & E fish habitat or no net loss of essential S fish habitat, the agencies will recommend denial of the application unless they conclude that the proposed use would not harm the species.

Received by OWRD

FEB 27 2025

Salem, OR

SECTION 5: WATER USE

Provide the amount of water you propose to use from each source, for each use, in cubic feet-per-second (cfs) or gallons-per-minute (gpm). If the proposed use is from storage, provide the amount in acre-feet (af):
 (1 cfs equals 448.8 gpm. 1 acre-foot equals 325,851 gallons or 43,560 cubic feet)

SOURCE	USE	PERIOD OF USE	AMOUNT
Slate Creek	human consumption	year round	5.0 <input type="checkbox"/> cfs <input checked="" type="checkbox"/> gpm <input type="checkbox"/> af
			<input type="checkbox"/> cfs <input type="checkbox"/> gpm <input type="checkbox"/> af
			<input type="checkbox"/> cfs <input type="checkbox"/> gpm <input type="checkbox"/> af
			<input type="checkbox"/> cfs <input type="checkbox"/> gpm <input type="checkbox"/> af

Please indicate the number of primary, supplemental and/or nursery acres to be irrigated.
 Primary: _____ Acres Supplemental: _____ Acres Nursery Use: _____ Acres
 If supplemental acres are listed, provide the Permit or Certificate number of the underlying primary water right(s): _____
 Indicate the maximum total number of acre-feet you expect to use in an irrigation season: _____

- If the use is municipal or quasi-municipal, attach Form M
- If the use is domestic, indicate the number of households: One
- If the use is mining, describe what is being mined and the method(s) of extraction:

SECTION 6: WATER MANAGEMENT

Received by OWRD
 FEB 27 2025
 Salem, OR

A. Diversion and Conveyance

What equipment will you use to pump water from your source?

- Pump (give horsepower and type): 1.5 HP centrifugal
- Other means (describe):

Provide a description of the proposed means of diversion, construction, and operation of the diversion works and conveyance of water. electric pump with foot valve in stream piped to pressure tank to home site

B. Application Method

What equipment and method of application will be used? (e.g., drip, wheel line, high-pressure sprinkler) in house use only

C. Conservation

Please describe why the amount of water requested is needed and measures you propose to: prevent waste; measure the amount of water diverted; prevent damage to public uses of affected surface waters. Water use is for a family of 4-5 people. There will be no waste as it will be a fully piped and closed system for in house use. System will be installed according to code. The amount of water used will be limited to in house use so will not exceed what is allowed

SECTION 7: RESOURCE PROTECTION

In granting permission to use water from a stream or lake, the state encourages, and in some instances requires, careful control of activities that may affect the waterway or streamside area. See instruction guide for a list of possible permit requirements from other agencies. Please indicate any of the practices you plan to undertake to protect water resources:

- Diversion will be screened per ODFW specifications in ORS 498.301 through 498.346 to prevent uptake of fish and other aquatic life.
Describe planned actions:
- Excavation or clearing of banks will be kept to a minimum to protect riparian or streamside areas.
Note: If disturbed area is more than one acre, applicant should contact the Department of Environmental Quality to determine if a 1200C permit is required.
Describe planned actions and additional permits required for project implementation: No clearing or excavation necessary
- Operating equipment in a water body will be managed and timed to prevent damage to aquatic life.
Describe planned actions and additional permits required for project implementation: no equipment in stream
- Water quality will be protected by preventing erosion and run-off of waste or chemical products.
Describe planned actions: No run-off as this is in house use with any waste processed through a septic system
- List other federal and state permits or contracts to be obtained, if a water right permit is granted. None

SECTION 8: PROJECT SCHEDULE

- a) Date construction will begin: when permit issued
- b) Date construction will be completed: 5 years after permit issued
- c) Date beneficial water use will begin: 5 years after permit issued

SECTION 9: WITHIN A DISTRICT

Check here if the point of diversion or place of use are located within or are served by an irrigation or other water district. NA

Irrigation District Name NA	Address	
City	State	Zip

SECTION 10: REMARKS

Use this space to clarify any information you have provided in the application. (Attach additional sheets if necessary). See attached remarks

Received by OWRD
FEB 27 2025
Salem, OR

Minimum Requirements Checklist

Minimum Requirements (OAR 690-310-0040, OAR 690-310-0050 & ORS 537.140)

Include this checklist with the application

Check that each of the following items is included. The application will be returned if all required items are not included. If you have questions, please call the Water Rights Customer Service Group at (503) 986-0900.

Please submit the original application and signatures to the Water Resources Department. Applicants are encouraged to keep a copy of the completed application.

- SECTION 1: Applicant Information and Signature
- SECTION 2: Property Ownership
- SECTION 3: Source of Water
- SECTION 4: Sensitive, Threatened or Endangered Fish Species Public Interest Information
- SECTION 5: Water Use
- SECTION 6: Water Management
- SECTION 7: Resource Protection
- SECTION 8: Project Schedule
- SECTION 9: Within a District
- SECTION 10: Remarks

Include the following additional items:

- Land Use Information Form with approval and signature of local planning department (*must be an original*) or signed receipt.
- Provide the legal description of: (1) the property from which the water is to be diverted, (2) any property crossed by the proposed ditch, canal or other work, and (3) any property on which the water is to be used as depicted on the map.
- Fees - Amount enclosed: \$ 2,110.00
See the Department's Fee Schedule at www.oregon.gov/owrd or call (503) 986-0900.

Map that includes the following items:

- Permanent quality and drawn in ink
- Even map scale not less than 4" = 1 mile (example: 1" = 400 ft, 1" = 1320 ft, etc.)
- North Directional Symbol
- Township, Range, Section, Quarter/Quarter, Tax Lots
- Reference corner on map
- Location of each diversion, by reference to a recognized public land survey corner (distances north/south and east/west)
- Indicate the area of use by Quarter/Quarter and tax lot identified clearly.
- Number of acres per Quarter/Quarter and hatching to indicate area of use if for primary irrigation, supplemental irrigation, or nursery
- Location of main canals, ditches, pipelines or flumes (if well is outside of the area of use)
pipeline location not known at this time

Received by OWRD

FEB 27 2025

Salem, OR

Section 10: Remarks

Subject property, 10787 Redwood Hwy Wilderville , Or 97543,
37-07-10-C0 Tax Lot # 800(Full Legal Description has been provided)
This property has an old shared well that has been abandon due to very low production and poor water quality. Due to the long narrow layout of the property; this property is located directly adjacent to a 4 lane passing lane on Redwood Hwy, the Oregon Department of Transportation has a large easement along the whole length of the North side of property, there is a large main PP&L power transmission lines that run all the way down thru the middle of the property and Slate Creek runs along the South edge of the property, along with the septic system, there is no room to get a well drilling rig in to drill a new well.

o Attached is an estimate for water delivery, this would not be convenient nor cost effective.

Received by OWRD

FEB 27 2025

Salem, OR

RECEIVED

JO CO - PLANNING

Water-Use Permit Application Processing

1. Completeness Determination

The Department evaluates whether the application and accompanying map contain all of the information required under OAR 690-310-0040 and OAR 690-310-0050. The Department also determines whether the proposed use is prohibited by statute. If the Department determines that the application is incomplete, all fees have not been paid, or the use is prohibited by statute, the application and all fees submitted are returned to the applicant.

2. Initial Review

The Department reviews the application to determine whether water is available during the period requested, whether the proposed use is restricted or limited by rule or statute, and whether other issues may preclude approval of or restrict the proposed use. An Initial Review (IR) containing preliminary determinations is mailed to the applicant. The applicant has 14 days from the mailing date to withdraw the application from further processing and receive a refund of all fees paid minus \$310. The applicant may put the application on hold for up to 180 days and may request additional time if necessary.

3. Public Notice

Within 7 days of the mailing of the initial review, the Department gives public notice of the application in the weekly notice published by the Department at www.oregon.gov/owrd. The public comment period is 30 days from publication in the weekly notice.

Received by OWRD
FEB 27 2025
Salem, OR

4. Proposed Final Order Issued

The Department reviews any comments received, including comments from other state agencies related to the protection of sensitive, threatened or endangered fish species. Within 60 days of completion of the IR, the Department issues a Proposed Final Order (PFO) explaining the proposed decision to deny or approve the application. A PFO proposing approval of an application will include a draft permit, and may request additional information or outstanding fees required prior to permit issuance.

5. Public Notice

Within 7 days of issuing the PFO, the Department gives public notice in the weekly notice. Notice includes information about the application and the PFO. Protest must be received by the Department within 45 days after publication of the PFO in the weekly notice. Anyone may file a protest. The protest filing fee is \$480.00 for the applicant and \$950.00 for non-applicants. Protests are filed on approximately 10 percent of Proposed Final Orders. If a protest is filed the Department will attempt to settle the protest but will schedule a contested case hearing if necessary.

6. Final Order Issued

If no protests are filed, the Department can issue a Final Order within 60 days of the close of the period for receiving protest. If the application is approved, a permit is issued. The permit specifies the details of the authorized use and any terms, limitations or conditions that the Department deems appropriate



Application #: _____

Application Supplement for Human Consumption & Livestock Uses

For water use permit applications within or above scenic waterways, or from streams for which water is not available due to required instream flows, the Department may issue limited permits for human consumption and livestock uses. Human consumption use is limited to 500 gallons per day for indoor use only for drinking, cooking, and sanitation, and does not include other uses such as lawn or garden watering or other related water uses.

In order to issue a permit to you for human consumption or livestock use, the Department must find that you cannot reasonably obtain water from any other source. For human consumption, an additional finding must be made that denial of the water right would result in loss of reasonable expectations for use of your property. For livestock use, additional findings must be made that issuance of a permit is necessary to prevent the livestock from watering in or along the stream bed and that you have excluded livestock from the stream and the adjacent riparian zone.

Please answer the following questions, and sign and return this form to Oregon Water Resources Department, 725 Summer St NE Ste A, Salem OR 97301-1266. You may also email the signed form to your caseworker.

1. Can you reasonably obtain water from any other source? YES NO

If not, please describe why each of the following options are not reasonable:

- a. Groundwater, such as a well on yours or a neighbor=s property. (If expense is the reason groundwater is not reasonable, please provide two estimates of the cost.)
Neighbor well - salty and no usable amount of water - abandoned
- b. Securing stored water from upstream reservoirs.
No Reservoirs available
- c. Trucking water. (If expense is the reason this option is not reasonable, please provide a copy of an estimate of the cost of trucking water.)
Not reasonable. See estimate

Received by OWRD
FEB 27 2025
Salem, OR

d. Community or municipal water suppliers.

None available

e. Tying in to a neighboring property's spring.

None available for use

g. Transferring existing water rights to your proposed use(s).

Know of no water rights available to transfer

Please identify any other alternate water sources you have considered, and why they are not feasible:

Rain water not available when needed

2. If you are seeking a permit for **human consumption use**, would denial of your application result in loss of reasonable expectations for use of your property?

YES NO NOT APPLICABLE

If so, please describe how:

Need to show legal source of water in order to develop property

3. If you are seeking a permit for **livestock use**, is the proposed use necessary to prevent the livestock from watering in or along the stream bed?

YES NO NOT APPLICABLE

4. If you are seeking a permit for **livestock use**, have you excluded livestock from the stream and the adjacent riparian zone?

YES NO NOT APPLICABLE

Applicant Signature: 

Date: 2/10/25

Applicant Signature: _____

Date: _____

Received by OWRD

FEB 27 2025

Salem, OR

Land Use Information Form

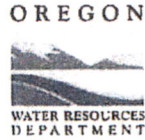

Oregon Water Resources Department
 725 Summer Street NE, Suite A
 Salem, Oregon 97301-1266
 (503) 986-0900
 www.oregon.gov/OWRD

NAME John Kabot			PHONE 619-857-2000	
MAILING ADDRESS 1267 Fish Hatchery Rd				
CITY Grants Pass	STATE OR	ZIP 97527	EMAIL john.kabot@yahoo.com	

A. Land and Location

Please include the following information for all tax lots where water will be diverted (taken from its source), conveyed (transported), and/or used or developed. Applicants for municipal use, or irrigation uses within irrigation districts, may substitute existing and proposed service-area boundaries for the tax-lot information requested below.

Township	Range	Section	¼ ¼	Tax Lot #	Plan Designation (e.g., Rural Residential/RR-5)	Water to be:	Proposed Land Use:
37	07	10	C0	800	RR-2.5	<input checked="" type="checkbox"/> Diverted <input type="checkbox"/> Conveyed <input type="checkbox"/> Used	Residential
						<input type="checkbox"/> Diverted <input type="checkbox"/> Conveyed <input type="checkbox"/> Used	
						<input type="checkbox"/> Diverted <input type="checkbox"/> Conveyed <input type="checkbox"/> Used	
						<input type="checkbox"/> Diverted <input type="checkbox"/> Conveyed <input type="checkbox"/> Used	

List all counties and cities where water is proposed to be diverted, conveyed, and/or used or developed:

Josephine County - Wilderville

NOTE: A separate Land Use Information Form must be completed and submitted for each county and city, as applicable.

B. Description of Proposed Use

Type of application to be filed with the Oregon Water Resources Department:

- Permit to Use or Store Water
 Water Right Transfer
 Permit Amendment or Ground Water Registration Modification
 Limited Water Use License
 Exchange of Water
 Allocation of Conserved Water

Source of water: Reservoir/Pond Ground Water Surface Water (name) **glate Creek**

Estimated quantity of water needed: **300-400** cubic feet per second gallons per minute acre-feet per day

Intended use of water: Irrigation Commercial Industrial Domestic for **4-5** household(s)
 Municipal Quasi-Municipal Instream Other _____

Briefly describe:

Subject property has a shared well that has been abandon due to very low production & poor quality of water. Due to the layout of the land, location of the septic system, creek & overhead power transmission lines going up the middle of the whole property, there is no room to drill a new well.

Note to applicant: For new water right applications only, if the Land Use Information Form cannot be completed while you wait, please have a local government representative sign the receipt on the bottom of page 4 and include it with the application filed with the Oregon Water Resources Department.

See Page 4 →

RECEIVED

For Local Government Use Only

The following section must be completed by a planning official from each county and city listed unless the project will be located entirely within the city limits. In that case, only the city planning agency must complete this form. This deals only with the local land use plan. Do not include approval for activities such as building or grading permits.

Please check the appropriate box below and provide the requested information

Land uses to be served by the proposed water use(s), including proposed construction, are allowed outright or are not regulated by your comprehensive plan. Cite applicable ordinance section(s): 19.61.020L (permitted use)

Land uses to be served by the proposed water use(s), including proposed construction, involve discretionary land-use approvals as listed in the table below. (Please attach documentation of applicable land-use approvals which have already been obtained. Record of Action/land-use decision and accompanying findings are sufficient.) **If approvals have been obtained but all appeal periods have not ended, check "Being Pursued."**

Type of Land-Use Approval Needed (e.g., plan amendments, rezones, conditional-use permits, etc.)	Cite Most Significant, Applicable Plan Policies & Ordinance Section References	Land-Use Approval:	
		<input type="checkbox"/> Obtained <input type="checkbox"/> Denied	<input type="checkbox"/> Being Pursued <input type="checkbox"/> Not Being Pursued
		<input type="checkbox"/> Obtained <input type="checkbox"/> Denied	<input type="checkbox"/> Being Pursued <input type="checkbox"/> Not Being Pursued
		<input type="checkbox"/> Obtained <input type="checkbox"/> Denied	<input type="checkbox"/> Being Pursued <input type="checkbox"/> Not Being Pursued
		<input type="checkbox"/> Obtained <input type="checkbox"/> Denied	<input type="checkbox"/> Being Pursued <input type="checkbox"/> Not Being Pursued

Local governments are invited to express special land use concerns or make recommendations to the Oregon Water Resources Department regarding this proposed use of water in the box below or on a separate sheet.

Name: Katie Brown Title: Department Specialist
 Signature: Katie Brown Date: 1/3/25
 Governmental Entity: Josephine County Phone: 541-474-5420

Receipt Acknowledging Request for Land Use Information

Note to Local Government Representative:
 Please complete this form and return it to the applicant. For new water right applications only, if you are unable to complete this form while the applicant waits, you may complete this receipt and return it to the applicant. If you sign the receipt, you will have 30 days from the date of OWRD's Public Notice of the application to submit the completed Land Use Information Form to Oregon Water Resources Department. Please note while OWRD can accept a signed receipt as part of intake for an application for a new permit to use or store water, a completed Land Use Information Form is required for all other applications.

Applicant Name: _____

Staff Name: _____ Title: _____

Staff Signature: _____ Date: _____

Governmental Entity: _____ Phone: _____

RECEIVED
 CITY PLANNING
 Received by OWRD
 FEB 27 2025
 Salem, OR

2

APN: R325801

Statutory Warranty Deed
- continued

File No.: 7151-4145973 (wf)

BEFORE SIGNING OR ACCEPTING THIS INSTRUMENT, THE PERSON TRANSFERRING FEE TITLE SHOULD INQUIRE ABOUT THE PERSON'S RIGHTS, IF ANY, UNDER ORS 195.300, 195.301 AND 195.305 TO 195.336 AND SECTIONS 5 TO 11, CHAPTER 424, OREGON LAWS 2007, SECTIONS 2 TO 9 AND 17, CHAPTER 855, OREGON LAWS 2009, AND SECTIONS 2 TO 7, CHAPTER 8, OREGON LAWS 2010. THIS INSTRUMENT DOES NOT ALLOW USE OF THE PROPERTY DESCRIBED IN THIS INSTRUMENT IN VIOLATION OF APPLICABLE LAND USE LAWS AND REGULATIONS. BEFORE SIGNING OR ACCEPTING THIS INSTRUMENT, THE PERSON ACQUIRING FEE TITLE TO THE PROPERTY SHOULD CHECK WITH THE APPROPRIATE CITY OR COUNTY PLANNING DEPARTMENT TO VERIFY THAT THE UNIT OF LAND BEING TRANSFERRED IS A LAWFULLY ESTABLISHED LOT OR PARCEL, AS DEFINED IN ORS 92.010 OR 215.010, TO VERIFY THE APPROVED USES OF THE LOT OR PARCEL, TO DETERMINE ANY LIMITS ON LAWSUITS AGAINST FARMING OR FOREST PRACTICES, AS DEFINED IN ORS 30.930, AND TO INQUIRE ABOUT THE RIGHTS OF NEIGHBORING PROPERTY OWNERS, IF ANY, UNDER ORS 195.300, 195.301 AND 195.305 TO 195.336 AND SECTIONS 5 TO 11, CHAPTER 424, OREGON LAWS 2007, SECTIONS 2 TO 9 AND 17, CHAPTER 855, OREGON LAWS 2009, AND SECTIONS 2 TO 7, CHAPTER 8, OREGON LAWS 2010.

Dated this 20 day of March, 2024.

David S. Wurch
David S. Wurch

Luci Wurch
Luci Wurch

UNOFFICIAL COPY

STATE OF Oregon)
County of Josephine) ss.

This instrument was acknowledged before me on this 20th day of March, 2024
by **David S. Wurch and Luci Wurch.**

Wendy S. Forney

Notary Public for Oregon
My commission expires: 4/25/25

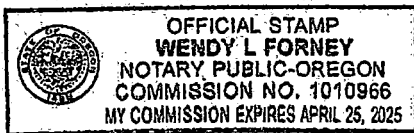

Received by OWRD

FEB 27 2025

Salem, OR



After recording return to:
John Kabot
1267 Fish Hatchery Rd
Grants Pass, OR 97527

Until a change is requested all tax
statements shall be sent to the
following address:
John Kabot
1267 Fish Hatchery Rd
Grants Pass, OR 97527

File No.: 7151-4145973 (wf)
Date: March 12, 2024

THIS SPACE RESERVED FOR RECORDER'S USE

JOSEPHINE COUNTY OFFICIAL RECORDS
RHIANNON HENKELS, COUNTY CLERK **2024-002847**

DED-WRD
Cnt=1 Pgs=3 Str=39 RHENKELS 03/20/2024 02:45 PM
\$15.00 \$11.00 \$10.00 \$60.00 \$5.00 \$101.00

I, Rhiannon Henkels, County Clerk, certify that the within
document was received and duly recorded in the official
records of Josephine County.

101

STATUTORY WARRANTY DEED

David S. Wurch and Luci Wurch, Grantor, conveys and warrants to **John Kabot**, Grantee,
the following described real property free of liens and encumbrances, except as specifically set
forth herein:

See Legal Description attached hereto as Exhibit A and by this reference incorporated herein.

Subject to:

1. Covenants, conditions, restrictions and/or easements, if any, affecting title, which may
appear in the public record, including those shown on any recorded plat or survey.

The true consideration for this conveyance is **\$65,000.00**. (Here comply with requirements of
ORS 93.030)

(B)

APN: R325801

Statutory Warranty Deed
- continued

File No.: 7151-4145973 (wf)

EXHIBIT A

LEGAL DESCRIPTION: Real property in the County of Josephine, State of Oregon, described as follows:

PARCEL 1:

Beginning at a point of intersection of Southerly right of way line of Redwood Highway with West line of Southeast Quarter of Southwest Quarter of Section 10, Township 37 South, Range 7 West of the Willamette Meridian, Josephine County, Oregon, said point being 23 feet Southerly (measured at right angles) to existing center line of said highway and approximately 470 feet South of Northwest corner of above said Southeast Quarter of Southwest Quarter of Section 10; thence on a 3° curve along said right of way line 631 feet, the long chord of said curve bearing North 76°30' East to true point of beginning of this description; thence along said right of way line North 66°50' East 326 feet; thence South 230 feet; thence South 66°50' West 326 feet to a point due South of Point of Beginning; thence North 230 feet to the Point of Beginning. EXCEPTING THEREFROM tract of land conveyed to State of Oregon, by and through its State Highway Commission, by deed recorded in Volume 192, Page 415, Josephine County Deed Records.

PARCEL 2:

Beginning at a point of intersection of Southerly right of way line of Redwood Highway with West line of Southeast Quarter of Southwest Quarter of Section 10, Township 37 South, Range 7 West of the Willamette Meridian, Josephine County, Oregon, said point being 23 feet Southerly (measured at right angles) to existing center line of said highway and approximately 470 feet South of the Northwest corner of above said Southeast Quarter of the Southwest Quarter of Section 10; thence on a 3° curve along said right of way line 631 feet, the long chord of said curve bearing North 76°30' East; thence continuing along said right of way line North 66°50' East 326 feet to the true point of beginning; thence North 66°50' East 23.2 feet; thence South 230 feet; thence South 66°50' West 23.2 feet; thence North 230 feet to true Point of Beginning. EXCEPTING THEREFROM tract of land conveyed to State of Oregon, by and through its State Highway Commission by deed recorded in Volume 192, Page 415, Josephine County Deed Records.

NOTE: This legal description was created prior to January 1, 2008.

Received by OWRD

FEB 27 2025

Salem, OR

North



10787 Redwood Hwy.
Wilderville, Or. 97543

37-07-10-CO Tax Lot# 800

Septic system

High tension power lines Abandoned wells



RECEIVED

JO CO - PLANNING

Received by OWRD

FEB 27 2025

Salem, OR

Water Availability Analysis

SLATE CR > APPLGATE R - AT MOUTH
ROGUE BASIN

Water Availability as of 2/3/2025

Watershed ID #: 71004 ([Map](#))
Date: 2/3/2025

Exceedance Level: 80%
Time: 9:55 AM

Water Availability

Limiting Watersheds

Complete Water Availability Analysis

Water Availability

Select any Watershed for Details

Resting Order	Watershed ID #	Stream Name	Jan	Feb	Mar	Apr	May	Jun	Jul	Aug	Sep	Oct	Nov	Dec	Str
Select	1	266 ROGUE R> PACIFIC OCEAN- AT MOUTH	Yes	Yes	Yes	Yes	Yes	Yes	No	No	No	Yes	No	Yes	Yes
Select	2	31531008 ROGUE R> PACIFIC OCEAN- AB SHASTA COSTA CR	No	No	No	No	Yes	No	No	No	No	No	No	No	Yes
Select	3	31531001 ROGUE R> PACIFIC OCEAN- AB MEADOW CR	No	No	No	No	Yes	No	No	No	No	No	No	No	Yes
Select	4	31531002 ROGUE R> PACIFIC OCEAN- AB GRAVE CR	No	No	No	No	No	No	No	No	No	No	No	No	Yes
Select	5	249 APPLGATE R> ROGUE R- AT MOUTH	No	No	No	No	No	No	No	No	No	No	No	No	Yes
Select	6	71004 SLATE CR> APPLGATE R- AT MOUTH	No	No	No	No	No	No	No	No	No	No	No	No	Yes

Download Data ([Text - Formatted](#), [Text - Tab Delimited](#), [Excel](#))

Mike's Water Truck Service

5452 Jerome Prairie Road
Grants Pass, OR 97527

toprilent@hotmail.com

Estimate

Date	Estimate #
2/13/2025	2022316

Name / Address
Loraditch Ranch & Home R/E Dan Loraditch

Project

Description	Qty	Rate
Water delivery to 10787 Redwood Hwy. - 3000 gal	1	650.00
Total		\$650.00

Received by OWRD

FEB 27 2025

Salem, OR

Elevations are based on an arbitrary datum. TBM, top of well casing elevation = 98.96'. Base flood elevation at proposed site of mobile home is 100.8' as determined by flood modelling using US Army Corps of Engineers HEC-RAS software. Flow of 6672 cfs determined using the USGS formula per the Flood Insurance Study for Josephine County published by FEMA.

There is no evidence of recent flooding of the site. Based on the modelling of the site, the proposed location of the mobile home is safe if the unit is raised to an elevation of not less than 101.8' based on the site datum, or 2.8 feet above the top of the well casing shown hereon.

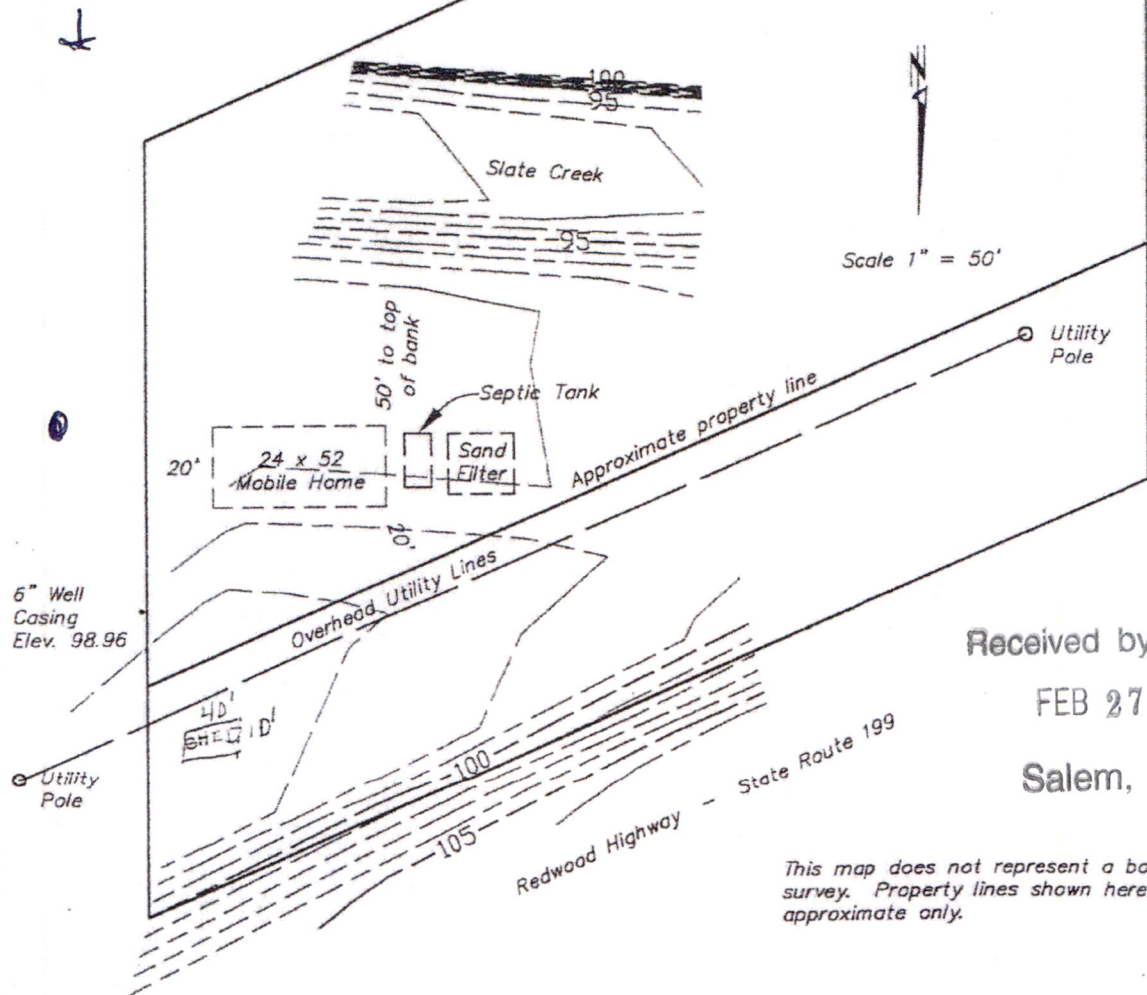

Received by OWRD
 FEB 27 2025
 Salem, OR

This map does not represent a boundary survey. Property lines shown hereon are approximate only.

E:\0-WORK\Hibbard\Hibbard.DWG, Layout1, 10/25/2000 12:51:29 PM, HP DeskJet 1120C Printer, 1:1

	Josephine County, Oregon	
	Burle Hibbard Property 10787 Redwood Highway, Grants Pass T. 37 S., R. 7 W., Sec. 10, TL 800	
	C. A. Johnson Planning & Engineering, Inc. 4810 Sardine Creek Road, Gold Hill, Oregon 97525 (541) 855-7269	
	DATE DATE DATE	PROJECT NO. DRAWING NO. 1 OF 1

STATE OF OREGON
WATER WELL REPORT
 (as required by ORS 537.765) WATER RESOURCES DEPT.
 SALEM, OREGON

OCT 06 1993

JOSE
 1669M

375/7w/10cd

(START CARD) # 55103

(1) OWNER: Well Number 1
 Name Dan Barklind
 Address 1704 Rounds Avenue
 City Grants Pass State OR Zip 97527

(2) TYPE OF WORK:
 New Well Deepen Recondition Abandon

(3) DRILL METHOD:
 Rotary Air Rotary Mud Cable
 Other

(4) PROPOSED USE:
 Domestic Community Industrial Irrigation
 Thermal Injection Other

(5) BORE HOLE CONSTRUCTION:
 Special Construction approval Yes No Depth of Completed Well 225 ft.
 Explosives used Yes No Type _____ Amount _____

HOLE			SEAL			Amount sacks or pounds
Diameter	From	To	Material	From	To	
10	0	18	Bentonite	0	18	9 sacks
6	18	225				

How was seal placed: Method A B C D E
 Other Poured

Backfill placed from _____ ft. to _____ ft. Material _____
 Gravel placed from _____ ft. to _____ ft. Size of gravel _____

(6) CASING/LINER:

Diameter	From	To	Gauge	Steel	Plastic	Welded	Threaded
Casing: 6	+2	18	250	<input checked="" type="checkbox"/>	<input type="checkbox"/>	<input checked="" type="checkbox"/>	<input type="checkbox"/>
Liner:				<input type="checkbox"/>	<input type="checkbox"/>	<input type="checkbox"/>	<input type="checkbox"/>

Final location of shoe(s) 18'

(7) PERFORATIONS/SCREENS:
 Perforations Method _____
 Screens Type _____ Material _____

From	To	Slot size	Number	Diameter	Tele/pipe size	Casing	Liner
						<input type="checkbox"/>	<input type="checkbox"/>
						<input type="checkbox"/>	<input type="checkbox"/>
						<input type="checkbox"/>	<input type="checkbox"/>

(8) WELL TESTS: Minimum testing time is 1 hour

Pump Bailor Air Flowing Artesian

Yield gal/min	Drawdown	Drill stem at	Time
.75		225	1 hr.

Temperature of Water 51 Depth Artesian Flow Found _____
 Was a water analysis done? Yes By whom _____
 Did any strata contain water not suitable for intended use? Too little
 Salty Muddy Odor Colored Other _____
 Depth of strata: _____

(9) LOCATION OF WELL by legal description:
 County Joseph Latitude _____ Longitude _____
 Township 37 N or S. Range 7 E or W. WM.
 Section 10 SE 1/4 SW 1/4
 Tax Lot 1000 Lot _____ Block _____ Subdivision _____
 Street Address of Well (or nearest address) _____
10761 Redwood Hwy

(10) STATIC WATER LEVEL:
6 ft. below land surface. Date 9/21/93
 Artesian pressure _____ lb. per square inch. Date _____

(11) WATER BEARING ZONES:
 Depth at which water was first found 30

From	To	Estimated Flow Rate	SWL
30	50	.25	6
158	170	.50	6

(12) WELL LOG: Ground elevation _____

Material	From	To	SWL
Brown clay, small-medium gravel	0	6	
Shale	6	225	

Received by OWRD

FEB 27 2025

Salem, OR

RECEIVED

SEP 27 1993

WELL DIST. #
 BARNES-PAGE, INC.

Date started 9-20-93 Completed 9-21-93

(unbonded) Water Well Constructor Certification:
 I certify that the work I performed on the construction, alteration, or abandonment of this well is in compliance with Oregon well construction standards. Materials used and information reported above are true to my best knowledge and belief.

Signed William K Shryver WWC Number 1590
 Date 9/21/93

(bonded) Water Well Constructor Certification:
 I accept responsibility for the construction, alteration, or abandonment work performed on this well during the construction dates reported above. All work performed during this time is in compliance with Oregon well construction standards. This report is true to the best of my knowledge and belief.

Signed Bob Spurr WWC Number 675
 Date 9/21/93

