

**CLAIM OF
BENEFICIAL USE
for Groundwater Permits
claiming more than 0.1 cfs**



Oregon Water Resources Department
725 Summer Street NE, Suite A
Salem, Oregon 97301-1266
(503) 986-0900
www.oregon.gov/OWRD

MADRONA ELEMENTARY SCHOOL

A fee of \$230 must accompany this form for permits
with priority dates of July 9, 1987, or later.

A separate form shall be completed for each permit.

In cases where a permit has been amended through the permit amendment process, a separate claim for the permit amendment is not required. Incorporate the permit amendment into the claim for the permit.

This form is subject to revision. **Begin each new claim** by checking for a new version of this form at:
<https://www.oregon.gov/OWRD/Forms/Pages/default.aspx>

The completion of this form is required by OAR 690-014-0100(1) and 690-014-0110(4).

Please type or print in dark ink. If this form is found to contain errors or omissions, it may be returned to you. **Every item must have a response.** If any requested information does not apply to the claim, insert "NA." **Do not delete or alter any section of this form unless directed by the form.** The Department may require the submittal of additional information from any water user or authorized agent.

"Section 8" of this form is intended to aid in the completion of this form and should not be submitted.

A claim of beneficial use includes both this report and a map. If the map is being mailed separately from this form, please include a note with this form indicating such.

If you have questions regarding the completion of this form, please call 503-979-9103.

The Department has a program that allows it to enter into a voluntary agreement with an applicant for expedited services. Under such an agreement, the applicant pays the cost to hire additional staff that would not otherwise be available. This program means a certificate may be issued in about a month. For more information on this program see
<https://www.oregon.gov/OWRD/programs/WaterRights/RA/Pages/default.aspx>

RECEIVED
MAR 14 2025
OWRD

**SECTION 1
GENERAL INFORMATION**

1. File Information:

APPLICATION # G-15335	PERMIT # (IF APPLICABLE) G-15164	PERMIT AMENDMENT # (IF APPLICABLE) NA
---------------------------------	--	---

2. Property Owner (current owner information):

APPLICANT/BUSINESS NAME THREE RIVERS SCHOOL DISTRICT		PHONE NO. 541-476-6304	ADDITIONAL CONTACT NO.	
ADDRESS 126 Ringuette Street				
CITY Grants Pass	STATE Oregon	ZIP 97527	E-MAIL keoni.gallegos@threerivers.k12.or.us	

If the current property owner is not the permit holder of record, it is recommended that an assignment be filed with the Department. ***Each permit holder of record must sign this form.***

3. Permit holder of record (this may, or may not, be the current property owner):

PERMIT HOLDER OF RECORD THREE RIVERS SCHOOL DISTRICT				
ADDRESS 126 Ringuette Street				
CITY Grants Pass	STATE Oregon	ZIP 97527		

ADDITIONAL PERMIT HOLDER OF RECORD NA				
ADDRESS				
CITY	STATE	ZIP		

4. Date of Site Inspection:

March 8, 2007

5. Person(s) interviewed and description of their association with the project:

NAME	DATE	ASSOCIATION WITH THE PROJECT
Rick Ross	March 8, 2007	Environmental Coordinator
Keoni Gallegos	February 20, 2024	Compliance Coordinator

6. County:

JOSEPHINE

7. If any property described in the place of use of the permit is excluded from this report, identify the owner of record for that property (ORS 537.230(5)):

OWNER OF RECORD NA				
ADDRESS				
CITY	STATE	ZIP		

Add additional tables for owners of record as needed

RECEIVED

MAR 14 2025

OWRD

**SECTION 2
SIGNATURES**

CWRE Statement, Seal and Signature

The facts contained in this Claim of Beneficial Use are true and correct to the best of my knowledge.

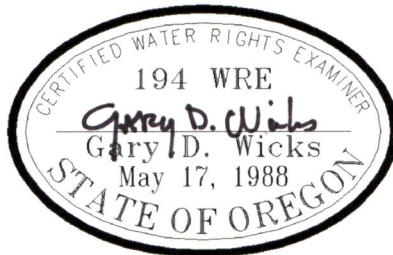

Renewal Date: June 30, 2024

CWRE NAME Gary D. Wicks		PHONE NO. Office: 541-479-3436	ADDITIONAL CONTACT NO. Cell: 541-660-9912
ADDRESS 311 NE "D" Street			
CITY Grants Pass	STATE Oregon	ZIP 97526	E-MAIL gdwicks@gmail.com

Permit Holder of Record Signature or Acknowledgement

***Each** permit holder of record must sign this form in the space provided below.*

The facts contained in this Claim of Beneficial Use are true and correct to the best of my knowledge. I request that the Department issue a water right certificate.

SIGNATURE	PRINT OR TYPE NAME	TITLE	DATE
	Dave Valenzuela	District Superintendent	3-10-2025

**RECEIVED
MAR 14 2025
OWRD**

SECTION 3

CLAIM DESCRIPTION

1. Point of appropriation name or number:

POINT OF APPROPRIATION POA NAME (CORRESPOND TO MAP)	WELL LOG ID # FOR ALL WORK PERFORMED ON THE WELL (IF APPLICABLE)	WELL TAG # (IF APPLICABLE)
POA	JOSE 6230 and JOSE 50603	L-8256

Attach each well log available for the well (include the log for the original well and any subsequent alterations, reconstructions, or deepenings)

2. Point of appropriation source, if indicated on permit:

POA NAME	SOURCE BASIN LOCATED WITHIN	TRIBUTARY TO:
POA	Applegate River	Rogue River

3. Developed use(s), period of use, and rate for each use:

POA NAME	USES	IF IRRIGATION, LIST CROP TYPE	SEASON OR MONTHS WHEN WATER WAS USED	ACTUAL RATE OR VOLUME USED (CFS, GPM, OR AF)
POA	Commercial	NA	Year Round	0.041 cfs (18.4 gpm)
POA	Irrigation	Lawn, Landscaping and Soccer Field	March 1 thru October 31	0.072 cfs (32.4 gpm)
Total Quantity of Water Used				0.113 cfs (50.8 gpm)

4. Provide a general narrative description of the distribution works. This description must trace the water system from **each** point of appropriation to the place of use:

Water is pumped from the ground using a 7.5 hp submersible pump in OWRD Well No. L-8256. Water is conveyed via a 2" PVC pipe through a 2" Cycle Stop valve and a 2" Badger Flow Meter before the system splits into separate irrigation and commercial use lines. A 2" GI pipe conveys water to the school building where it is used for the kitchen, rest rooms and drinking fountains. A 1-1/4" GI pipe conveys water to the irrigation system via a pressure tank, through a gate valve and backflow device. The irrigation system then splits into pipes that provide water to various sprinklers located around the buildings and to the soccer field.

The sprinklers around the buildings are Rainbird Mini Paw LG3 and Orbit Watermaster Model 54207 sprinklers that operate at a pressure of 50 psi. The sprinklers located in the soccer field are Hunter PGP with No. 6 nozzles. The maximum set is six heads. Other areas located west of the classrooms and soccer field are watered infrequently using hose lines with various sprinklers.

Reminder: The map associated with this claim must identify the location of the point of appropriation, Donation Land Claims (DLC), Government Lots (GLot), and Quarter-Quarters (QQ).

RECEIVED

MAR 14 2025

OWRD

5. Variations:

Was the use developed differently from what was authorized by the permit, permit amendment final order, or extension final order? If yes, describe below.

YES

(e.g. "The permit allowed three points of appropriation. The water user only developed one of the points." or "The permit allowed 40.0 acres of irrigation. The water user only developed 10.0 acres.")

The permit allowed for the irrigation of 6.0 acres. Only 2.2 acres of irrigation were surveyed.

6. Claim Summary:

POA NAME	MAXIMUM RATE AUTHORIZED	CALCULATED THEORETICAL RATE BASED ON SYSTEM	AMOUNT OF WATER MEASURED	USE	NO. OF ACRES ALLOWED	NO. OF ACRES DEVELOPED
POA	0.041 cfs (18.4 gpm)	0.244 cfs (109.5 gpm)	Not Measured	Commercial	NA	NA
	0.075 cfs (33.7 gpm)			Irrigation	6.0	2.2

SECTION 4

SYSTEM DESCRIPTION

Are there multiple POAs?

NO

If "YES" you will need to copy and complete a separate Section 4 for each POA.

POA Name or Number this section describes (only needed if there is more than one):

POA

A. Place of Use

1. Is the right for municipal use?

NO

If "YES" the table below may be deleted.

TWP	RNG	MER	SEC	QQ	GLOT	DLC	USE	IF IRRIGATION NO. PRIMARY ACRES	IF IRRIGATION NO. SUPPLEMENTAL ACRES
T. 37 S.	R. 6 W.	WM	12	SWSW	NA	NA	Irrigation	2.2	NA
Total Acres Irrigated								2.2	NA

Reminder: The map associated with this claim must identify Donation Land Claims (DLC), Government Lots (GLot), Quarter Quarters (QQ), and if for irrigation, the number of acres irrigated within each projected DLC, GLot, and QQ.

B. Groundwater Source Information (Well)

1. Is the appropriation from a well?

YES

If "NO", items 2 through 4 relating to this section may be deleted.

2. Describe the access port (type and location) or other means to measure the water level in the well:

1/2" diameter air vent pipe in sanitary seal.

RECEIVED

MAR 14 2025

OWRD

3. If well logs are not available, provide as much of the following information as possible:

CASING DIAMETER	CASING DEPTH	TOTAL DEPTH	COMPLETION DATE OF ORIGINAL WELL	COMPLETION DATES OF ALTERATIONS	WHO THE WELL WAS DRILLED FOR	WELL DRILLED BY
SEE	ATTACHED	WELL	LOGS			

4. In addition to the information requested in item "3" above, provide any other information which may help the Department locate any well logs associated with this appropriation.

Water Well Reports No. JOSE 6230 and JOSE 50603

C. Groundwater Source Information (Sump)

1. Is the appropriation from a dug well (sump)?

NO

If "NO", items 2 through 4 relating to this section may be deleted.

D. Diversion and Delivery System Information

Provide the following information concerning the diversion and delivery system. Information provided must describe the equipment used to transport and apply the water from the point of appropriation to the place of use.

1. Is a pump used?

YES

If "NO" items 2 through item 6 may be deleted.

2. Pump Information:

MANUFACTURER	MODEL	SERIAL NUMBER	TYPE (CENTRIFUGAL, TURBINE OR SUBMERSIBLE)	INTAKE SIZE	DISCHARGE SIZE
Berkeley	60575-15	unknown	Submersible		2"

3. Motor Information:

MANUFACTURER	HORSEPOWER
Berkeley	7.5

4. Theoretical Pump Capacity:

HORSEPOWER	OPERATING PSI	LIFT FROM SOURCE TO PUMP *If a well, the water level during pumping	LIFT FROM PUMP TO PLACE OF USE	TOTAL PUMP OUTPUT (IN CFS)
7.5	50 psi	85 feet	4 feet	0.244 cfs (109.5 gpm)

5. Provide pump calculations:

$$\begin{aligned}
 P &= \text{pump hp} = 7.5 & E_f &= \text{efficiency factor} = 7.04 \text{ (submersible pump)} \\
 H_1 &= \text{lift head} = \text{suction head (swl)} + \text{discharge lift (elev. dif.)} = 85' + 4' = 89' \\
 H_p &= \text{pressure head} = 127.0' \text{ at } 50 \text{ psi} \\
 Q &= \frac{PE_f}{H_1 + H_p} = \frac{7.5(7.04)}{89 + 127} = 0.244 \text{ cfs} = 109.5 \text{ gpm}
 \end{aligned}$$

RECEIVED

MAR 14 2025

OWRD

6. Measured Pump Capacity (using meter if meter was present and system was operating):

INITIAL METER READING	ENDING METER READING	DURATION OF TIME OBSERVED	TOTAL PUMP OUTPUT (IN CFS)
Not Measured			

Reminder: For pump calculations use the reference information at the end of this document.

7. Is the distribution system piped?

YES

If "NO" items 8 through item 13 may be deleted.

8. Mainline Information:

MAINLINE SIZE	LENGTH	TYPE OF PIPE	BURIED OR ABOVE GROUND
2"	185'	GI	Buried
1½"	320'	PVC	Buried
1¼"	105'	PVC	Buried

9. Lateral or Handline Information:

LATERAL OR HANDLINE SIZE	LENGTH	TYPE OF PIPE	BURIED OR ABOVE GROUND
1"	2100'	PVC	Buried

10. Sprinkler Information:

SIZE	OPERATING PSI	SPRINKLER OUTPUT (GPM)	TOTAL NUMBER OF SPRINKLERS	MAXIMUM NUMBER USED	TOTAL SPRINKLER OUTPUT (CFS)
No. 6	50	5.4/head	115	6	0.072 cfs (32.4 gpm)

Reminder: For sprinkler output determination use the reference information at the end of this document.

11. Drip Emitter Information:

SIZE	OPERATING PSI	EMITTER OUTPUT (GPM)	TOTAL NUMBER OF EMITTERS	MAXIMUM NUMBER USED	TOTAL EMITTER OUTPUT (CFS)
NA					

12. Drip Tape Information:

DRIPPER SPACING IN INCHES	GPM PER 100 FEET	TOTAL LENGTH OF TAPE	MAXIMUM LENGTH OF TAPE USED	TOTAL TAPE OUTPUT (CFS)	ADDITIONAL INFORMATION
NA					

13. Pivot Information:

MANUFACTURER	MAXIMUM WETTED RADIUS	OPERATING PSI	TOTAL PIVOT OUTPUT (GPM)	TOTAL PIVOT OUTPUT (CFS)
NA				

RECEIVED

MAR 14 2025

OWRD

E. Storage

1. Does the distribution system include in-system storage (e.g. storage tank, bulge in system / reservoir)?

NO

If "NO", item 2 and 3 relating to this section may be deleted.

F. Gravity Flow Pipe

1. Does the system involve a gravity flow pipe?

NO

If "NO", items 2 through 4 relating to this section may be deleted.

G. Gravity Flow Canal or Ditch

1. Is a gravity flow canal or ditch used to convey the water as part of the distribution system?

NO

If "NO", items 2 through 4 relating to this section may be deleted.

H. Additional notes or comments related to the system:

RECEIVED

MAR 14 2025

OWRD

**SECTION 5
CONDITIONS**

All conditions contained in the permit, permit amendment, or any extension final order shall be addressed. Reports that do not address all performance related conditions will be returned.

1. Time Limits:

Permits and extension final orders contain any or all of the following dates: the date when the actual construction work was to begin, the date when the construction was to be completed, and the date when the complete application of water to the proposed use was to be completed. These dates may be referred to as ABC dates. Describe how the water user has complied with each of the development timelines established in the permit or permit extension order:

	DATE FROM PERMIT	DATE ACCOMPLISHED*	DESCRIPTION OF ACTIONS TAKEN BY WATER USER TO COMPLY WITH THE TIME LIMITS
ISSUANCE DATE	Aug. 22, 2002		
BEGIN CONSTRUCTION (A)	Unspecified	Sept. 23, 1966	Drilled Well
COMPLETE CONSTRUCTION (B)	Unspecified		
COMPLETE APPLICATION OF WATER (C)	Oct. 1, 2006	1966	

* MUST BE WITHIN PERIOD BETWEEN PERMIT, OR ANY EXTENSION FINAL ORDER ISSUANCE AND THE DATE TO COMPLETELY APPLY WATER

2. Is there an extension final order(s)? **NO**

If "NO", items a and b relating to this section may be deleted.

3. Initial Water Level Measurements:

a. Was the water user required to submit an initial static water level measurement? **YES**

If "NO", items b through d relating to this section may be deleted.

b. What month was the initial measurement to be taken in?

March

c. Was the measurement submitted to the Department? **YES**

d. If the initial measurement was not submitted, provide that measurement now, if available:

DATE OF MEASUREMENT	MEASUREMENT MADE BY	METHOD	MEASUREMENT
March 1, 2003	Pacific Pump Co.	etape	19.24'

4. Annual Static Water Level Measurements:

a. Was the water user required to submit annual static water level measurements? **YES**

If "NO", items b through e relating to this section may be deleted.

b. Provide the month, or months, the static water level measurement(s) were to be made:

March

c. Were the static water level measurements taken in the month required? **MOST: Two more needed**

d. If "YES", were those measurements submitted to the Department? **YES**

e. If the annual measurements were not submitted, provide the measurements now:

DATE OF MEASUREMENT	MEASUREMENT MADE BY	METHOD	MEASUREMENT
SEE ATTACHED	MEASURED WATER	LEVEL TABLE	FROM WRIS

5. Pump Test:

a. Did the permit require the submittal of a pump test? **YES**

Ground water permits with priority dates on or after **December 20, 1988**, require the submittal of a pump test prior to issuance of a certificate. In some cases, the permit holder may qualify for a multiple well exemption or an unreasonable burden exemption.

For additional information regarding pump tests see:

<https://www.oregon.gov/OWRD/programs/GWWL/GW/Pages/PumpTestProgram.aspx>

If "NO", items b through e relating to this section may be deleted.

b. Has the pump test been previously submitted to the Department? **NO**

c. Is the pump test attached to this claim? **NO**

d. Has the pump test been approved by the Department? **NO**

e. Has a pump test exemption been approved by the Department? **NO**

**** Claims will not be reviewed until a pump test or exemption has been approved by the Department**

6. Measurement Conditions:

a. Does the permit, permit amendment, or any extension final order require the installation of a meter or approved measuring device? **YES**

If "NO", items b through f relating to this section may be deleted.

Reminder: If a meter or approved measuring device was required, the COBU map must indicate the location of the device in relation to the point of diversion or appropriation.

b. Has a meter been installed? **YES**

c. Meter Information

POA NAME	MANUFACTURER	SERIAL No.	CONDITION (WORKING OR NOT)	CURRENT METER READING	DATE INSTALLED
POA	Badger	18475741	working	520,146	July, 2002

If a meter has been installed, items d through f relating to this section may be deleted.

7. Recording and reporting conditions:

a. Is the water user required to report the water use to the Department? **NO**

If "NO", item b relating to this section may be deleted.

8. Other conditions required by permit, permit amendment final order, or extension final order:

a. Were there special well construction standards? **NO**

b. Was submittal of a ground water monitoring plan required? **NO**

c. Was submittal of a water management and conservation plan required? **NO**

d. Was a Well Identification Number (Well ID tag) assigned and attached **YES**

RECEIVED
MAR 14 2025
OWRD

to the well?

WELL ID #	DATE ATTACHED TO WELL
L-8256	Oct. 25, 1996

e. Other conditions?

NO

If "YES" to any of the above, identify the condition and describe the water user's actions to comply with the condition(s):

Re: Item 4.c – See the attached measured water level table (screenshot from WRIS). The permit requires seven consecutive annual static water level measurements. According to OWRD nine have been submitted, but not annually consecutive. Only five were made in the required month of March (although two were very close, at the end of February) The tests span eleven years which is longer than the seven years that are required.

SECTION 6 ATTACHMENTS

Provide a list of any additional documents you are attaching to this report:

ATTACHMENT NAME	DESCRIPTION
COBU Plat	Sheet One (1" = 400')
COBU Plat	Detail Sheet Two (1" = 200')
Well Reports	Water Well Reports No. JOSE 6230 and Jose 50603
Water Level Table	Screenshot of Measured Water Level Table from WRIS

SECTION 7 CLAIM OF BENEFICIAL USE MAP

The Claim of Beneficial Use Map must be submitted with this claim. Claims submitted without the Claim of Beneficial Use map will be returned. The map shall be submitted on poly film at a scale of 1" = 1320 feet, 1" = 400 feet, or the original full-size scale of the county assessor map for the location.

Provide a general description of the survey method used to prepare the map. Examples of possible methods include, but are not limited to, a traverse survey, GPS, or the use of aerial photos. If the basis of the survey is an aerial photo, provide the source, date, series and the aerial photo identification number.

The final proof survey for this claim of beneficial use was completed on March 8, 2007. A topographic survey of the property was used to establish the horizontal and vertical locations of the place of use, buildings, well location and the amount of lift. The property corners set per Survey No. 112-66 were used as control for this survey. The survey field work was conducted using a Wild T-1600 Theomat and a Distomat DI-1600 EDM with a combined accuracy of 1 second and 3 mm ± 2 ppm.

NOTE:
An aerial photo dated April 28, 2023 from Google Earth was used to update the current place of use on the Claim of Beneficial Use Map.

RECEIVED
MAR 14 2025

Map Checklist

Please be sure that the map you submit includes ALL the items listed below.

(Reminder: Incomplete maps and/or claims may be returned.)

- Map on polyester film
- Appropriate scale (1" = 400 feet, 1" = 1320 feet, or the original full-size scale of the county assessor map)
- Township, Range, Section, Donation Land Claims, and Government Lots
- If irrigation, number of acres irrigated within each projected Donation Land Claims, Government Lots, Quarter-Quarters
- Locations of fish screens and/or fish by-pass devices in relationship to point of diversion
- Locations of meters and/or measuring devices in relationship to point of diversion or appropriation
- Conveyance structures illustrated (pumps, reservoirs, pipelines, ditches, etc.)
- Point(s) of diversion or appropriation (illustrated and coordinates)
- Tax lot boundaries and numbers
- Source illustrated if surface water
- Disclaimer ("This map is not intended to provide legal dimensions or locations of property ownership lines")
- Application and permit number or transfer number
- North arrow
- Legend
- CWRE stamp and signature

RECEIVED
MAR 14 2025
OWRD

SW1/4SW1/4 of Section 12, T.37S., R.6W., W.M.

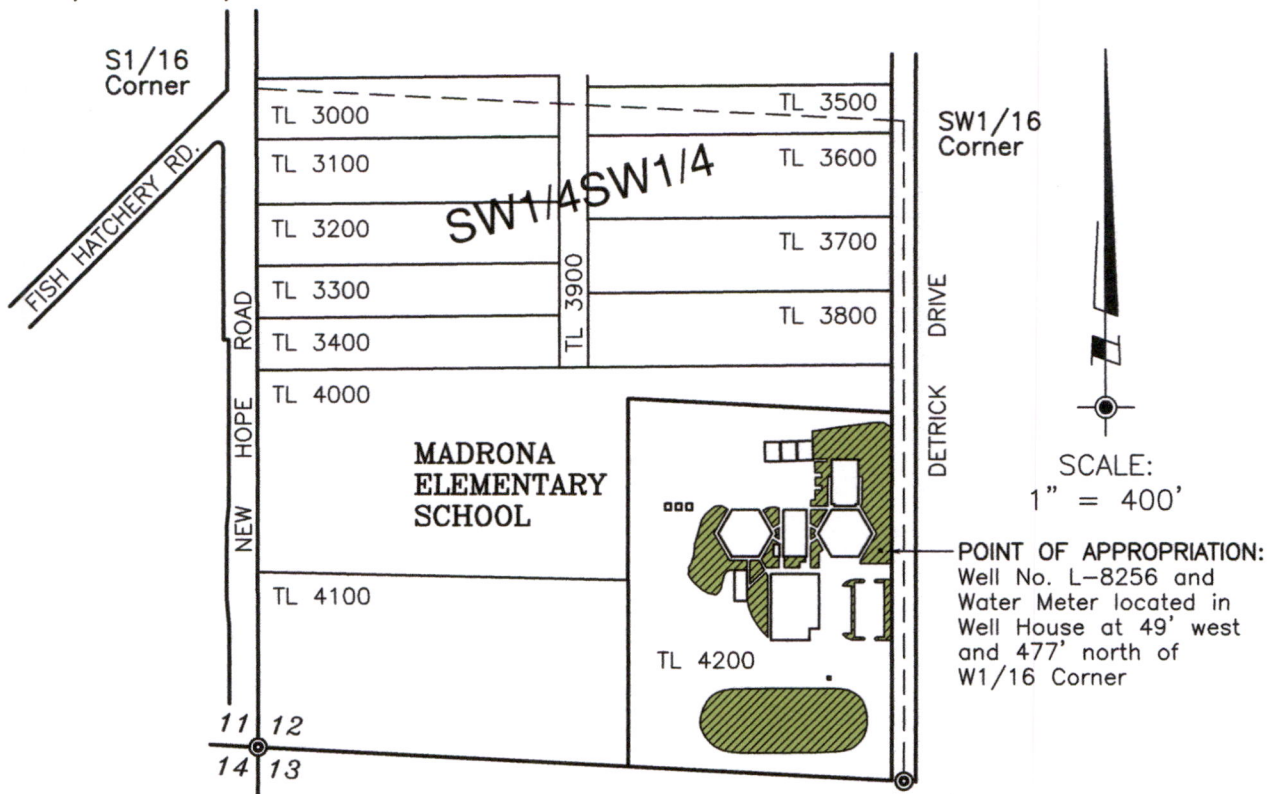

Section Corner
Fd. Brass Cap
per C.S. Bk. 7, Pg. 136

SEE DETAIL
ON SHEET 2

W1/16 Corner
Fd. 5/8" Iron Rod
per Survey No. 31-66

This plat was prepared for the purpose of identifying the location of the water right only. There is no intent to provide dimensions or locations of property ownership lines.

This survey was made using a Wild T-1600 Theomat and a Distomat DI-1600 E.D.M.I. with a combined accuracy of 1 second and 3 mm ± 2 ppm.

A twelve page site report accompanies this plat.

Supporting Documents:
Application No. G-15335
Permit No. G-15164

Priority Date: March 5, 2001

Usage: Commercial and Irrigation

LEGEND:



Place of Use: 2.2 acres

POINT OF APPROPRIATION:
Existing Well 49'W and 477'N of
the W 1/16 Corner of Section 12

RECEIVED

MAR 14 2025

OWRD

madrona (2024).dwg

PROJECT NO.
1015-06-304

DRAWING NO.
207-8.5.11

DATE:
Feb. 29, 2024

SCALE:
1" = 400'

SHEET NO.
1 of 2

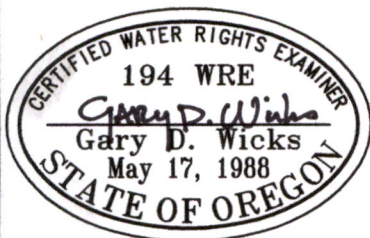

RENEWAL DATE: 6-30-24

**PLAT FOR
CLAIM OF BENEFICIAL USE**

LOCATED IN:
SW1/4SW1/4 of Section 12
Township 37 South, Range 6 West, W.M.
Josephine County, Oregon

PREPARED FOR:
THREE RIVERS SCHOOL DISTRICT
126 Ringuette Street
Grants Pass, Oregon 97527

Tel: 541-476-6304

PREPARED BY:
WICKS ENGINEERING & SURVEYING
311 N.E. "D" Street
Grants Pass, OR 97526

Tel: 541-479-3436

DETAIL SHEET MADRONA ELEMENTARY SCHOOL

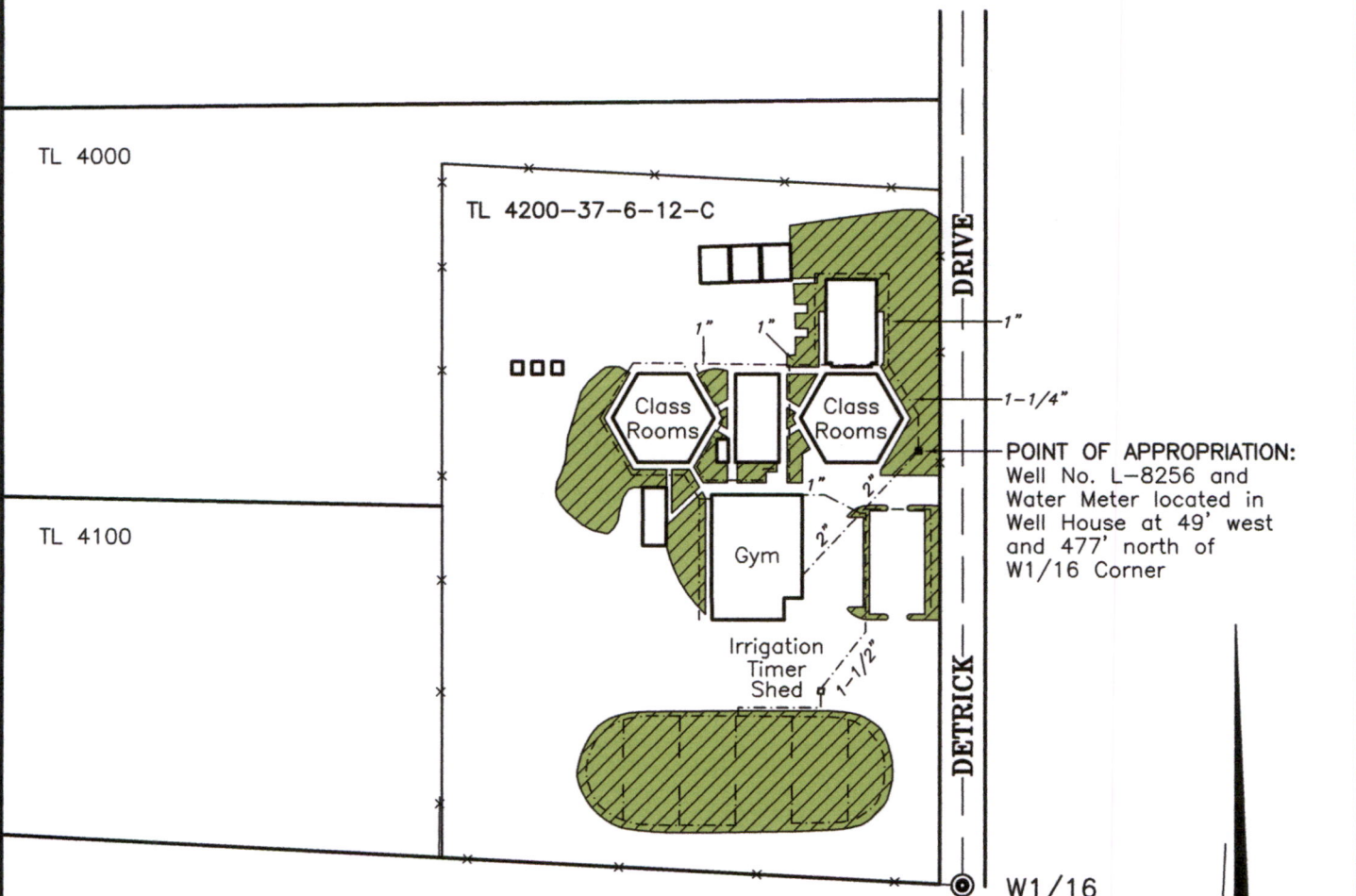

LEGEND:



Place of Use:

SW1/4SW1/4 Sec 12: 2.2 Acres



Approximate location of underground
water line (size as shown)

RECEIVED

MAR 14 2025

OWRD



SCALE:
1" = 200'

madrona (2024).dwg

PROJECT NO.
1015-06-304

DRAWING NO.
208-8.5.11

DATE:
Feb. 29, 2024

SCALE:
1" = 200'

SHEET NO.
2 of 2

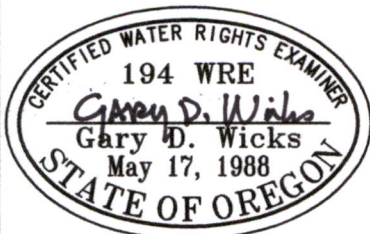

RENEWAL DATE: 6-30-24

PLAT FOR CLAIM OF BENEFICIAL USE

LOCATED IN:
SW1/4SW1/4 of Section 12
Township 37 South, Range 6 West, W.M.
Josephine County, Oregon

PREPARED FOR:
THREE RIVERS SCHOOL DISTRICT
126 Ringuette Street
Grants Pass, OR 97527

Tel: 541-476-6304

PREPARED BY:
WICKS ENGINEERING & SURVEYING
311 N.E. "D" Street
Grants Pass, OR 97526

Tel: 541-479-3436

School

JOSE
6230
SWS
T.L. 3301

NOTICE TO WATER WELL CONTRACTOR
The original and first copy
of this report are to be
filed with the
STATE ENGINEER, SALEM, OREGON, 97310
within 30 days from the date
of well completion.

RECEIVED
NOV 16 1966
STATE ENGINEER OF OREGON
SALEM, OREGON

State Well No. 37/6W-12cc
State Permit No.

(1) OWNER:

Name Josephine County School
Address Court House Annex Grants Pass Oregon
Ore. 97530

(2) LOCATION OF WELL:

County Josephine Driller's well number
1/4 1/4 Section 12 T. 37S R. 6W W.M.
Bearing and distance from section or subdivision corner

(3) TYPE OF WORK (check):

Well Deepening Reconditioning Abandon
1. If abandonment, describe material and procedure in Item 12.

(4) PROPOSED USE (check):

Domestic Industrial Municipal Rotary Driven
Irrigation Test Well Other Cable Jetted
Dug Bored

(5) TYPE OF WELL:

(6) CASING INSTALLED: Threaded Welded
6" Diam. from 0 ft. to 80 ft. Gage 250
" Diam. from ft. to ft. Gage
" Diam. from ft. to ft. Gage

(7) PERFORATIONS:

Perforated? Yes No
Type of perforator used
Size of perforations in. by in.
perforations from ft. to ft.
perforations from ft. to ft.
perforations from ft. to ft.
perforations from ft. to ft.

(8) SCREENS:

Well screen installed? Yes No
Manufacturer's Name
Model No.
Slot size Set from ft. to ft.
Diam. Slot size Set from ft. to ft.

(9) CONSTRUCTION:

Well seal—Material used in seal Cement Grout
Depth of seal 80' ft. Was a packer used? No
Diameter of well bore to bottom of seal 9 5/8 in.
Were any loose strata cemented off? Yes No Depth
Was a drive shoe used? Yes No
Was well gravel packed? Yes No Size of gravel:
Gravel placed from ft. to ft.
Did any strata contain unusable water? Yes No
Type of water? depth of strata
Method of sealing strata off

(10) WATER LEVELS:

Static level 4' ft. below land surface Date Sept 23 1966
Artesian pressure lbs. per square inch Date

(11) WELL TESTS:

Drawdown is amount water level is lowered below static level
Was a pump test made? Yes No If yes, by whom?
Yield: 50 gal./min. with 85 ft. drawdown after 4 hrs.
" " " " "
" " " " "
Bailer test gal./min. with ft. drawdown after hrs.
Artesian flow g.p.m. Date
Temperature of water 49 Was a chemical analysis made? Yes No

(12) WELL LOG:

Diameter of well below casing 6"
Depth drilled 190 ft. Depth of completed well 190 ft.
Formation: Describe by color, character, size of material and structure, and show thickness of aquifers and the kind and nature of the material in each stratum penetrated, with at least one entry for each change of formation.

MATERIAL	FROM	TO
Decomposed Granite & Clay	0	12
Soft decomposed granite	12	38
Decomposed Granite & Clay	38	76
Tombletite Granite with fractures	76	190

RECEIVED

MAR 14 2025

OWAD

Work started Sept 22 1966 Completed Sept 23 1966
Date well drilling machine moved off of well Sept 23 1966

(13) PUMP:

Manufacturer's Name
Type: H.P.

Water Well Contractor's Certification:

This well was drilled under my jurisdiction and this report is true to the best of my knowledge and belief.

NAME R.F. PAQUIN Drilling Co
(Person, firm or corporation) (Type or print)

Address 2820 So. RIVER Rd Grants Pass Ore

Drilling Machine Operator's License No. 422

[Signed] R.F. Paquin
(Water Well Contractor)

Contractor's License No. 275 Date 11-15, 1966

THREE RIVERS SCHOOL DISTRICT

MADRONA ELEMENTARY SCHOOL

Application No. G-15335 Permit No. G-15164

Well Test

Well Log	Test Type	Yield(gpm)	Drawdown	Duration (hr)	Calculated Specific Capacity (gpm/ft)
JOSE 6230	Pump	50.0	85.0	4.0	0.59

Measured Water Level

(Click to Collapse...)

Records/Page:

Measured Water Level

Date	Time	Water Level (BLSD)	WL Elev (ft AMSL)	Organization	OWRD	Method	Status	MP Height
3/5/2014		25.80	1054.20	PUMP INSTALLER	PERMIT CONDITION PROGRAM	ETAPE	STATIC	0.80
2/29/2012		26.58	1053.42	PUMP INSTALLER	PERMIT CONDITION PROGRAM	ETAPE	STATIC	0.80
2/24/2011		26.70	1053.30	PUMP INSTALLER	PERMIT CONDITION PROGRAM	ETAPE	STATIC	0.84
3/2/2010		26.75	1053.25	PUMP INSTALLER	PERMIT CONDITION PROGRAM	ETAPE	STATIC	0.80
3/11/2007		32.11	1047.89	PUMP INSTALLER	PERMIT CONDITION PROGRAM	ETAPE	STATIC	0.83
9/28/2005	14:58:00	29.90	1050.10	OWRD	GRANTS PASS	ETAPE	RISING	0.85
3/17/2005		33.16	1046.84	PUMP INSTALLER	PERMIT CONDITION PROGRAM	TAPE	PUMPING	0.85
2/20/2004		20.69	1059.31	PUMP INSTALLER	PERMIT CONDITION PROGRAM	ETAPE	STATIC	0.85
3/1/2003		19.24	1060.76	PUMP INSTALLER	PERMIT CONDITION PROGRAM	ETAPE	STATIC	
9/23/1966		4.00	1076.00	DRILLER	WELL LOG	REPORTED	UNKNOWN	

RECEIVED

MAR 14 2025

OWRD