

# U-380

Name Rogers Canning Company  
 By \_\_\_\_\_  
 Address Milton, Oregon

Date filed August 11, 1950  
 Priority August 11, 1950  
 Action suspended until \_\_\_\_\_  
 Returned to applicant \_\_\_\_\_  
 Date of approval January 31, 1951

### CONSTRUCTION

Date for beginning January 31, 1952  
 Date for completion October 1, 1952  
 Extended to \_\_\_\_\_  
 Date for application of water October 1, 1952  
 Extended to \_\_\_\_\_

### PROSECUTION OF WORK

Form "A" filed March 26, 1951  
 Form "B" filed June 20, 1951  
 Form "C" filed June 29, 1951

### FINAL PROOF

Blank mailed ~~July 19, 1951~~  
 Proof received JUL 28 1955  
 Date certificate issued \_\_\_\_\_

Application No. U-380  
 Permit No. U-355  
 Certificate No. 20805

Stream Index, Page No. 7-24B

*Final proof Map filed in*  
U-403

*5N/35-12 G1 WHAT 3964*

### ASSIGNMENTS

Date	To Whom	Address	Volume	Page

### REMARKS

*2.0 cfs from a well (Walla Walla R.) (Columbia R.) for canning.*

### FEES PAID

Date	Amount	Receipt No.
<u>8-13-50</u>	<u>10.00</u>	<u>10226</u>
<u>9-19-50</u>	<u>14.00</u>	<u>10455</u>
<u>5-20-55</u>	\$1 Cert. Fee	<u>3853</u>

### FEES REFUNDED

Date	Amount	Check No.

Form A

Application No. U-380

NOTICE OF BEGINNING OF CONSTRUCTION

I, Rogers Canning Company, the holder of Permit No. U-355 to appropriate the public waters of the state of Oregon, began the actual construction of the works described therein on the 8th day of January, 1951.

Remarks: Drilling commenced with the employment of three men

The appropriator should state the manner of beginning construction work, number of men employed, the amount of work completed up to the date of this statement, and any additional information which may tend to show the beginning of work in good faith.

IN WITNESS WHEREOF, I have hereunto set my hand this 23rd day of March, 1951.

ROGERS CANNING COMPANY

Milton, Oregon

Signature of Applicant: [Signature]

(Address)

Fill out, detach, and mail to the State Engineer, Salem, Oregon, when construction work is begun.

State Printing Dept. 41547

JAN 19 1955 FORM 125 WELL

FEB 8 1956 FORM 125 WELL

Form B

Application No. U-380

NOTICE OF COMPLETION OF CONSTRUCTION

I, Rogers Canning Company, the holder of Permit No. U-355 to appropriate the public waters of the state of Oregon, completed the construction of the works described therein on the 14th day of June, 1951.

Remarks: Drilling commenced with the employment of three men

If the works have less capacity than described in the permit, or you have definitely abandoned part of the proposed development, you should so state in order that our records may not be unnecessarily encumbered.

IN WITNESS WHEREOF, I have hereunto set my hand this 17th day of June, 1951.

ROGERS CANNING COMPANY

Milton, Oregon

Signature of Applicant: [Signature]

(Address)

Form C

IMPORTANT—This form is a notice to the State Engineer that permittee is ready to make final proof to the extent to which the water has actually been applied to the intended use under the terms of the permit.

NOTE: In the case of an irrigation permit, this Form C should not be mailed to the State Engineer until all of the land described in the permit, which it is intended to irrigate under this permit at any time, has actually been irrigated.

Application No. U-380

NOTICE OF COMPLETE APPLICATION OF WATER TO A BENEFICIAL USE

I, Rogers Canning Company, the holder of Permit No. U-355 to appropriate the public waters of the state of Oregon, completely applied the waters to a beneficial use in accordance with the terms of said permit, on the 14th day of June, 1951.

Remarks: Drilling commenced with the employment of three men

IN WITNESS WHEREOF, I have hereunto set my hand this 17th day of June, 1951.

ROGERS CANNING COMPANY

Milton, Oregon

Signature of Applicant: [Signature]

(Address)

RECEIVED JUN 20 1951 STATE ENGINEER SALEM, OREGON

T.5N.35E.W.M.

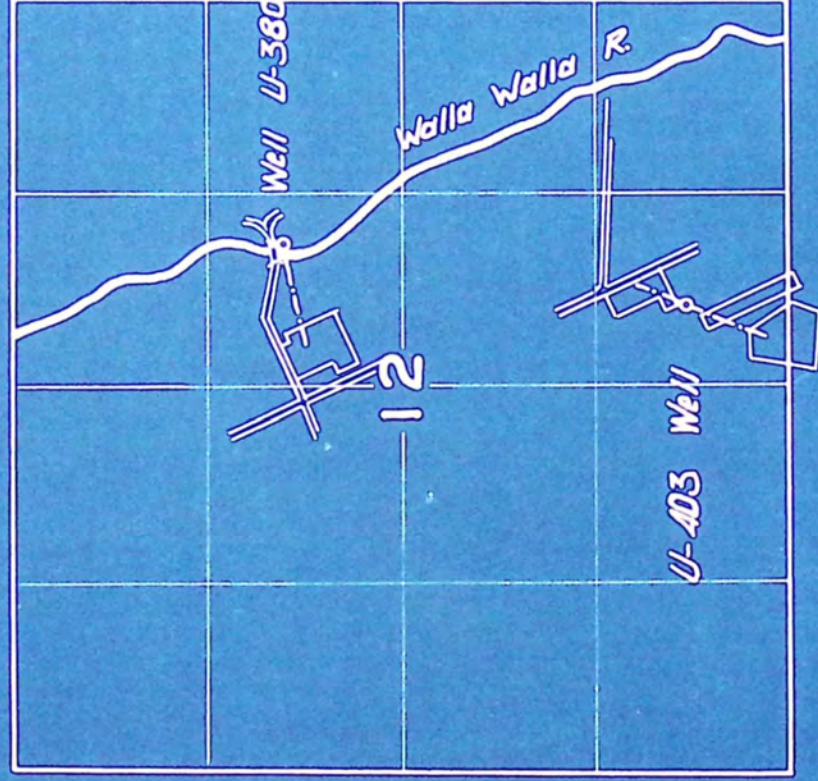

FINAL PROOF SURVEY

UNDER

U-380

U-355

Application No. U-203 Permit No. U-173

IN NAME OF

Rogers Canning Company

Umatilla Canning Company

Surveyed May 18, 1951, by H. J. Coffman

1/4 COR.

6 N.E. COR. SEC. 12.  
7

12'

NW 4 NE 4

NE 4 NE 4

SW 4 NE 4

SE 4 NE 4

RIVER

Proposed Location Of Well.

S. 41° 26' W. 2406.6'

Box Flume.

FAIR ST.  
PARK ST.  
THIRD ST.  
MILL ST.  
FIRST ST.

WALLA WALLA

Application No. U-380

Permit No. U-355

MAP  
SHOWING THE LOCATION OF PROPOSED WELL  
FOR

ROGERS CANNING CO.

MILTON, OREGON.

Scale 1"= 450'

September 15 1950.

T.5 N.R.35 E.W.M.

RECEIVED

SEP 19 1950

STATE ENGINEER  
SALEM, OREGON

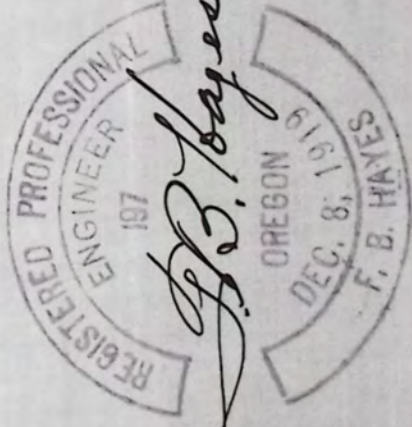

*F. B. Hayes*

Permit No. U-355

20805

Application No. U-380

County

Umatilla

RECEIVED  
MAY 20 1955

## Proof of Appropriation of Water

STATE ENGINEER  
SALEM, OREGON1. Name Rogers Canning Company 2. Address Milton, Oregon3. Source of supply a wellTributary of Walla Walla River4. Amount of water 2.68 c.f.s. 5. Priority date August 11, 19506. Use Canning

The well shall be so cased as to prevent the loss of underground water.

7. Location of point of diversion SW $\frac{1}{4}$  NE $\frac{1}{4}$  Sec. 12 Tp. 5 N. Rg. 35 E., W. M.   
(Legal Subdivision)

8. The description of land given below corresponds to that shown in the permit covering land to be irrigated, or, if for other purposes, the place of use.

Township	Range	Section	Legal Subdivision	No. Acres Actually Irrigated
5 N	35 E	12	SW $\frac{1}{4}$ NE $\frac{1}{4}$	

Land on which water is to be used is part of the property described as follows:

Reg. at a point on the E. line of Mill St., 23' northerly from the NW corner of Lot 3 of Bl. 2 of Miller's addition to the City of Milton in Umatilla Co., Oregon, and running thence Northeasterly parallel to and 8' Southerly from the center line of the Walla Wall Valley Railway Company's spur track 98.3' to a point 98' Easterly from and at right angles to the E. line of Mill St. and 32' Northerly from and at right angles to the N. line of Lot 3 of said Bl. 2 of Miller's addition: thence N. 65° E. 388.5 ft. to a point 20' Westerly from and at right angles to the center line of the Miller Mill flume; thence S. 20° 13' E. on a line parallel to and 20' from the center line of said Miller mill flume, extended to and beyond the end of said flume for a total distance of 331.6' more or less to a point on the N. line of William or Third St. now called "Williams St.", said N. line being and is the extended S. line of said Bl. 2 of Miller's addition; thence W. along said extended line 172.7' more or less to a point which is 2' Easterly from and at right angles to the Easterly line of Miller Avenue extended; thence W. along said extended S. line of said Bl. 2 and along the S. line of said Bl. 2 a distance of 289' to a point on the Easterly line of Mill St. which point is the SW corner of Lot 4 of said Bl. 2; thence Northwesterly along the Easterly line of Mill St., a distance of 67' to the SW corner of Lot 3 of said Bl. 2; thence Northwesterly along the Easterly line of Mill St. 74.93' to the place of beg.

### DESCRIPTION OF WORKS

9. (a) If a dam has been constructed, give description: Height, ..... ft.; length on top, ..... ft.; length on bottom, ..... ft.; material used and character of construction, .....
- (b) Give description of headgate: Width, ..... ft.; depth, ..... ft.; material used and character of construction, .....
- (c) Size of canal: Width on top (at waterline), ..... ft.; width on bottom, ..... ft.; depth of water, ..... ft.; grade, ..... ft. fall per 1,000 ft. Actual capacity, ..... sec.-ft. Give general description: .....
- (d) Pipe line: Description of intake, .....
- Length of pipe, ..... ft.; size at intake, ..... in.; size at ..... ft. from intake, ..... in.; size at place of use, ..... in. Difference in elevation between intake and place of use, ..... ft. Is grade uniform? ..... Actual capacity of pipe line, ..... sec.-ft. Give general description: .....  
(Material: Steel, wrought, cast iron, wood stave, etc.)
- (e) Pumping plant: Give size and type of pump, Pomona Turbine Deep Well pump.  
12 Stages, 8 inch column, 1 13/16 inch shaft, 10 inch bowls, Electric  
Suction lift, 125 ft. discharge lift, 10 ft. Type of motor used Electric  
Horsepower rating, 125 H. P. Actual capacity of pump, 1200 gallons per minute.  
June & July of each year
10. During what months is water beneficially used? .....
11. State character of soil .....
- Kind of crops raised .....
12. Does the accompanying map, filed with your application, show correctly the point of diversion, area of land irrigated, or place of use? .....
13. If not, wherein is such map in error? .....
14. Domestic use: Give number of families actually using water at this time .....
15. If for power, mining, municipal, manufacturing, storage or any other purpose than irrigation, give extent and method of such use Milton,regon plant, for all purposes necessary in its canning operations: Such as making brine, cooling cooked product, Washing raw product, drinking, and any and all other sanitary



# REPORT OF PERSON MAKING INSPECTION

(For use by Representative of State Engineer)

I, ..... **H. L. Coffman** ....., do hereby certify that I have made an inspection of the works described herein and in Permit No. **U-355** ....., on the **18th** ..... day of ..... **May** ....., 19.. **54**., and found the foregoing statements and descriptions of works to be accurate. In my opinion the appropriation has been completed to the extent of **2.68** (Quantity of water in second-foot or acre-feet) .....

and I recommend the issuance of water right certificate for this amount.

## NOTICE TO INSPECTORS

If conditions do not justify the above report by you, please return the proof without your signature, with a full report by letter.

..... **H. L. Coffman** .....

(Name)

..... **Field Engineer** .....

(Title)



T.5N.35E.W.M.

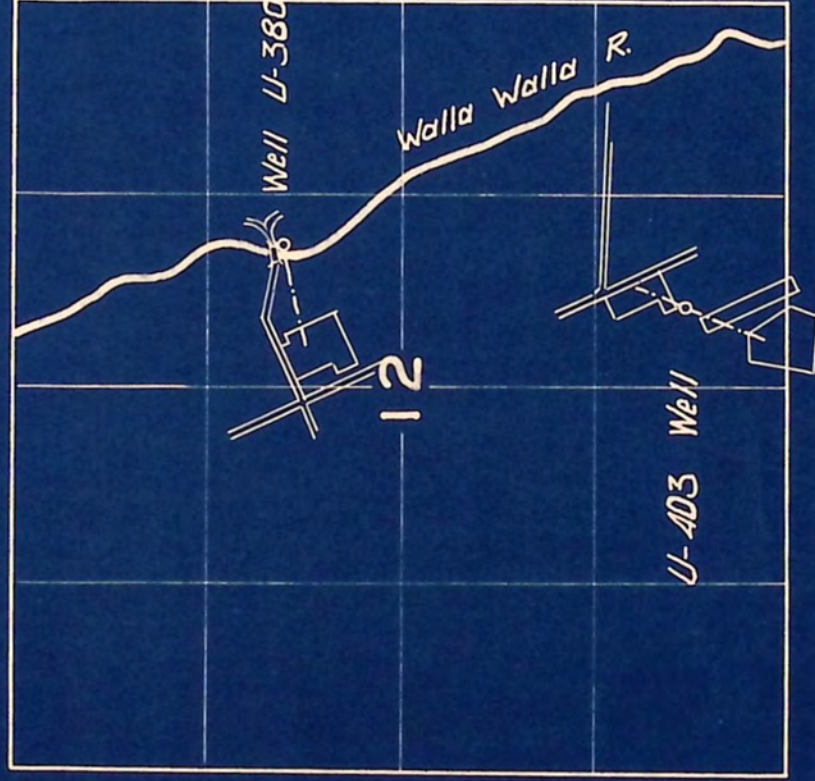

FINAL PROOF SURVEY

UNDER

Application No. 4-355-373 Permit No. 4-373

IN NAME OF

Rogers Lumber Company  
Walla Walla Lumber Company

Surveyed April 19 1904, by H. J. Coffman.

**Rogers**

**CANNING COMPANY**



PACKERS OF HIGHEST QUALITY PEAS,  
GROWN IN THE DEW-KIST MEADOWS OF  
THE BLUE MOUNTAINS OF EASTERN  
OREGON AND NOTED FOR THEIR EXCEP-  
TIONAL FLAVOR AND TENDERNES.

PLANTS AT MILTON-FREEWATER AND ATHENA, OREGON

*Milton-Freewater, Oregon*

May 19th, 1955

Mr. Lewis A. Stanley  
State Engineer  
Salem, Oregon

Re: U-380

Gentlemen:

Complying with your form letter of 12th, we are  
herein enclosing Proof of Appropriation of water under our Permit  
No. U-355, duly executed by ourselves. Also our check for \$1.00  
covering recording fee of Certificate of Water Right.

Yours very truly,

ROGERS CANNING COMPANY

By:

Carl J. Pelo  
Treasurer

CJP:gh  
Enc.

**RECEIVED**  
MAY 20 1955  
STATE ENGINEER  
SALEM, OREGON

NZ-4F-184

Permit No. U-355

Application No. U-380

County UMATILLA

## Proof of Appropriation of Water

1. Name ..... Rogers Canning Company 2. Address ..... Milton, Oregon
3. Source of supply ..... a well situated near Walla Walla River  
Tributary of ..... Columbia River
4. Amount of water ..... 3.0 c.f.s. 2.00 ..... 5. Priority date ..... August 11, 1950
6. Use ..... (canning)

Dunsmuir May 1954

7. Location of point of diversion,  $SW\frac{1}{2}NE\frac{1}{4}$  Sec. 12, Twp. 5 N., Range 35 E., W. M. (Legal Subdivision)

8. The description of land given below corresponds to that found in your permit covering land to be irrigated, or, if for other purposes, the place of use.

Township	Range	Section	Forty-acre Tract	No. Acres Described in Permit	No. Acres Actually Irrigated
5 N.	35 E.W.M.	12	SW $\frac{1}{2}$ NE $\frac{1}{4}$		
Place of use, description of land:					
<p>Beginning at a point on the East line of Mill Street, 23 feet northerly from the North-west corner of Lot 3 of Block 2 of Miller's addition to the City of Milton in Umatilla County, Oregon, and running thence Northeasterly parallel to and 8 feet Southerly from the center line of the Walla Walla Valley Railway Company's spur track 98.3 feet to a point 98 feet Easterly from and at right angles to the East line of Mill Street and 32 feet Northerly from and at right angles to the North line of Lot 3 of said Block 2 of Miller's addition: thence North 65° East 388.5 feet to a point 20 feet Westerly from and at right angles to the center line of the Miller Mill flume; thence South 20° 13 minutes East on a line parallel to and 20 feet from the center line of said Miller mill flume, extended to and beyond the end of said flume for a total distance of 331.6 feet more or less to a point on the North line of William or Third Street now called Williams Street", said North line being and is the extended South line of said Block 2 of Miller's addition; thence West along said extended line 172.7 feet more or less to a point which is 2 feet Easterly from and at right angles to the Easterly line of Miller Avenue extended; thence West along said extended South line of said Block 2 and along the South line of said Block 2 a distance of 29 feet to a point on the Easterly line of Mill Street which point is the Southwest corner of Lot 4 of said Block 2; thence Northwesterly along the Easterly line of Mill Street, a distance of 67 feet to the Southwest corner of Lot 3 of said Block 2; thence Northwesterly along the Easterly line of Mill Street 74.98 feet to the place of beginning.</p>					
The well shall be so cased as to prevent the loss of underground water.					

## DESCRIPTION OF WORKS

9. (a) If a dam has been constructed, give description: Height, ..... ft.; length on top, ..... ft.; length on bottom, ..... ft.; material used and character of construction, .....
- (b) Give description of headgate: Width, ..... ft.; depth, ..... ft.; material used and character of construction, .....
- (c) Size of canal: Width on top (at waterline), ..... ft.; width on bottom, ..... ft.; depth of water, ..... ft.; grade, ..... ft. fall per 1,000 ft. Actual capacity, ..... sec.-ft. Give general description: .....
- (d) Pipe line: Description of intake, .....
- Length of pipe, ..... ft.; size at intake, ..... in.; size at ..... ft. from intake, ..... in.; size at place of use, ..... in. Difference in elevation between intake and place of use, ..... ft. Is grade uniform? ..... Actual capacity of pipe line, ..... sec.-ft. Give general description: .....  
(Material: Steel, wrought, cast iron, wood stave, etc.)
- (e) Pumping plant: Give size and type of pump, .....
- Suction lift, ..... ft.; discharge lift, ..... ft. Type of motor used .....
- Horsepower rating, ..... H. P. Actual capacity of pump, ..... sec.-ft.
10. During what months is water beneficially used? .....
11. State character of soil .....
- Kind of crops raised .....
12. Does the accompanying map, filed with your application, show correctly the point of diversion, area of land irrigated, or place of use? .....
13. If not, wherein is such map in error? .....
14. Domestic use: Give number of families actually using water at this itme .....
15. If for power, mining, municipal, manufacturing, storage or any other purpose than irrigation, give extent and method of such use .....

**AFFIDAVIT OF APPROPRIATOR**

STATE OF OREGON,

County of ..... } ss.

I, ....., being first duly sworn, depose and say that I have read the above and foregoing proof of appropriation of water; that I know the contents thereof, and that the facts therein stated are true.

IN WITNESS WHEREOF, I have hereunto set my hand this ..... day of ....., 19.....

Subscribed and sworn to before me this ..... day of ....., 19.....

.....  
Notary Public for Oregon

[Notarial Seal]

My commission expires .....

**AFFIDAVIT OF WITNESSES**

STATE OF OREGON,

County of ..... } ss.

We, ....., and .....

of ....., being first duly sworn, depose and say that we are well acquainted with the facts and conditions set forth in the foregoing statement relative to proof of appropriation of water under Permit No. ....; that we and each of us have been over and upon each tract described in said proof, and from such personal inspection have knowledge that all necessary ditches, dams and other diversion and distributing works have been constructed, and water used as stated therein; that we have carefully read such proof of appropriation, and that each and every statement contained therein is true to the best of our knowledge and belief.

.....  
.....

Subscribed and sworn to before me this ..... day of ....., 19.....

.....  
Notary Public for Oregon

[Notarial Seal]

My commission expires .....

**REPORT OF PERSON MAKING INSPECTION**

(For use by Representative of State Engineer)

I, W. S. Coffman, do hereby certify that I have made an inspection of the works described herein and in Permit No. U-355, on the 18 day of May, 1954, and found the foregoing statements and descriptions of works to be accurate. In my opinion the appropriation has been completed to the extent of 2.68 (Quantity of water in second-feet or acre-feet) and I recommend the issuance of water right certificate for this amount.

**NOTICE TO INSPECTORS**

If conditions do not justify the above report by you, please return the proof without your signature, with a full report by letter.

W. S. Coffman  
(Name)

.....  
(Title)

Div Pt. - well no info.

Pump - Ramona Deepwell turbine 8 stage 8" column  
12" bowl, Capacity 1200 gpm - 10" discharge to  
unknown length 10" steel main to convey  
75% (said) waste to river.

Use - General Mfg' purposes, also uses waste to irrigate 120 acres

Fi. 6420 [ 1133 Gross up  
12" Fi. 6420 part of RDH  
of 356 RDH  
125

1/4 COR.

6  
7  
SECTION. SEC. 12



NW 1/4 NE 4

NE 1/4 NE 4

SW 1/4 NE 4

Proposed Location Of Well.  
SE 1/4 NE 4

RIVER

S. ALBERT W. 2408 6

Box Flume

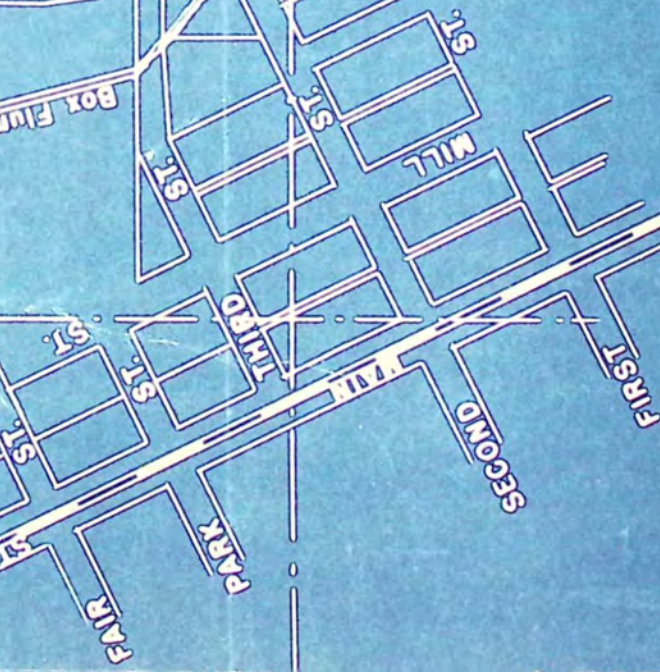

WALLA

Application No. O-380  
Permit No. O-355

MAP  
SHOWING THE LOCATION OF PROPOSED WELL  
FOR

ROGERS GANNING CO.

MILTON, OREGON.

Scale 1"= 450'

September 15 1950.

T.5 N.R.35 E.W.M.



*D.B. Payne*



U-380

January 31, 1951

Rogers Canning Company  
Milton  
Oregon

Gentlemen:

Herewith you will find Application No. U-380, Permit  
No. U-355, together with blueprint.

waters of the State of Oregon #U-380, on which we have completed item number four showing the location of the well. We are also enclosing herein two copies of the map showing the location of the proposed well. We trust this will complete the information needed by your office. We are also enclosing herein our check for \$14.00 payable to your order covering the recording fee on this application.

Yours very truly,

ROGERS CANNING COMPANY

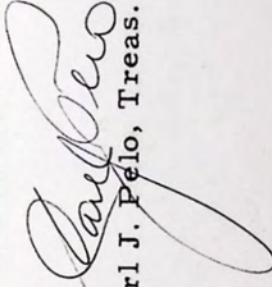
By   
Carl J. Pelo, Treas.

CJP/db  
Encs.

**Rogers**

**CANNING COMPANY**



PLANTS AT MILTON AND ATHENA, OREGON

PACKERS OF HIGHEST QUALITY PEAS,  
GROWN IN THE DEW-KIST MEADOWS OF  
THE BLUE MOUNTAINS OF EASTERN  
OREGON AND NOTED FOR THEIR EXCEP-  
TIONAL FLAVOR AND TENDERNESS.

Milton, Oregon

18 September 1950

Mr. Charles E. Stricklin  
State Engineer  
Salem, Oregon

Attention: Mr. Edward K. Humphrey, Ass't State Engineer

Gentlemen:

Re: File U-380

Complying with your letter of 24 August we are herein enclosing application for permit to appropriate the underground waters of the State of Oregon #U-380, on which we have completed item number four showing the location of the well. We are also enclosing herein two copies of the map showing the location of the proposed well. We trust this will complete the information needed by your office. We are also enclosing herein our check for \$14.00 payable to your order covering the recording fee on this application.

Yours very truly,

ROGERS CANNING COMPANY

CJP/db  
Encs.

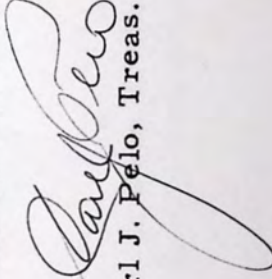
By   
Carl J. Péló, Treas.

RECEIVED  
SEP 19 1950  
STATE ENGINEER  
SALEM, OREGON

August 24, 1950

Rogers Canning Company  
Hilton, Oregon

Attention: Mr. Carl J. Pelo, Treasurer

Gentlemen:

This will acknowledge receipt of your letter of August 10 transmitting your application for a permit to appropriate 3.0 cubic feet of water per second from a well for use in canning, together with the statutory examination fee of \$10.00 for which our Receipt No. 10226 is enclosed.

The application has been filed and given No. U-380. It has been checked over and appears to be complete except that the location of the well should be described under Item 4 by giving its north or south and east or west distances from a recognized identified government survey corner or by a distance and bearing tie to such corner, and for your convenience in having it completed by showing such location, I am enclosing it herewith endorsed so that to retain its priority, it must be returned to this office on or before September 25, 1950. When the map is returned it should be accompanied by the tracing or a xerox made from such tracing, from which the map prints submitted were made and the balance due in recording fees in the amount of \$14.00.

Very truly yours,

CHAS. E. STRICKLIN  
State Engineer

By Ed K. Humphrey, Assistant

EKH:dh  
Enc.

# WESTERN UNION

1206

INTERNATIONAL SERVICE		
Check the class of service desired; otherwise this message will be sent at the full rate		
FULL RATE	DEFERRED	
CODE		NIGHT LETTER

JOSEPH L. EGAN, PRESIDENT

CASH NO.

CHARGE TO THE ACCOUNT OF

TIME FILED

Send the following message, subject to the terms on back hereof, which are hereby agreed to

COLLECT

ROGERS CANNING COMPANY  
MILTON, OREGON

APPLICATION FILED. LETTER FOLLOWS.

CHAS. E. STRICKLIN  
STATE ENGINEER

(Humphrey:mrh-4:00 P.M.)

**A NEW  
CURTIS  
SERVICE**

Telegraph your order for America's favorite magazines—HOLIDAY, 1 yr., \$5 • the Post, 1 yr., \$6 • LADIES' HOME JOURNAL, 1 yr., \$3. All prices U. S. only. No charge for wire. Pay Western Union clerk for subscription or when billed by publisher.

Publisher will, on subscriber's request, refund full amount paid for copies not previously mailed. Prices subject to change without notice.

You will note that we have enclosed two copies of the Map showing the proposed well site and the cannery site where the water will be used.

Yours very truly,

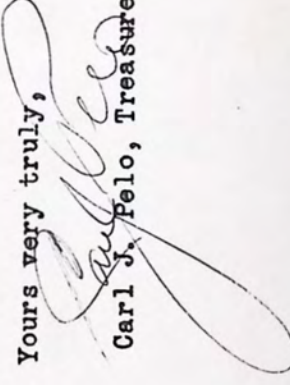
  
Carl J. Pelo, Treasurer.

# WESTERN UNION

1201

### SYMBOLS

DL = Day Letter
NL = Night Letter
LC = Deferred Cable
NLT = Cable Night Letter
Ship Radiogram

W. P. MARSHALL, PRESIDENT

Time shown in the date line on telegrams and day letters is STANDARD TIME at point of origin. Time of receipt is STANDARD TIME at point of destination

OA 122 SSN310

O WWA059 PD=WUX MILTON ORG 23 1115A

F CHAS E STRICKLIN

F STATE ENGINEER SALEM ORG

1950 AUG 23 AM 11 57

ADVISE ACTION TAKEN OUR APPLICATION APPROPRIATE UNDERGROUND  
WATER WIRE COLLECT  
ROGERS CANNING CO

RECEIVED

AUG 23 1950  
STATE ENGINEER  
SALEM, OREGON

SENDER IS AWAITING A SPEEDY

*answer*

PLEASE GIVE IT TO THE MESSENGER OR TELEPHONE

WESTERN UNION

APPRECIATE SUGGESTIONS FROM ITS PATRONS CONCERNING ITS SERVICE

upon favorable action on our application by your office.

You will note that we have enclosed two copies of the Map showing the proposed well site and the cannery site where the water will be used.

Yours very truly,

*Carl J. Pelo*  
Carl J. Pelo, Treasurer.

PACKERS OF HIGHEST QUALITY PEAS,  
GROWN IN THE DEW-KIST MEADOWS OF  
THE BLUE MOUNTAINS OF EASTERN  
OREGON AND NOTED FOR THEIR EXCEP-  
TIONAL FLAVOR AND TENDERNESS.

*Royers*

CANNING COMPANY



PLANTS AT MILTON AND ATHENA, OREGON

*Milton, Oregon*



EVER SAER MAIL

August 19th 1950  
**RECEIVED**

Mr. Chas. E. Stricklin, State Engineer 1950  
Salem, Oregon.

STATE ENGINEER  
SALEM. OREGON

Gentlemen:

We enclose herein application for a permit to appropriate the underground waters of the State of Oregon. Together with our check for \$10.00 to cover your fee.

We trust you will give this application your immediate attention with an early advise to us as we want to commence drilling promptly upon favorable action on our application by your office.

You will note that we have enclosed two copies of the Map showing the proposed well site and the cannery site where the water will be used.

Yours very truly,

*Carl J. Pelo*  
Carl J. Pelo, Treasurer.