

Name L. Rotherford
By _____
Address Route 1- Canby, Oregon
Date filed October 1, 1940
Priority October 1, 1940
Action suspended until _____

Returned to applicant _____
Date of approval January 10, 1941

CONSTRUCTION

Date for beginning January 10, 1942
Date for completion October 1, 1943
Extended to 10-1-47
Date for application of water October 1, 1944
Extended to 10-1-47

PROSECUTION OF WORK

Form "A" filed Begin
Form "B" filed September 29, 1947
Form "C" filed September 29, 1947
October 21, 1949

FINAL PROOF

(As is)

Blank mailed 4-18-48 9-30-47 JB

Proof received _____

Date certificate issued APR 30 1954

STATE PRINTING DEPT.

Application No. 19026
Permit No. 14633
Certificate No. 20372

Stream Index, Page No. 2-32 C

FEES PAID

Date	Amount	Receipt No.
<u>10/1/40</u>	<u>12.50</u>	<u>26725</u>
Total		
<u>3/26/54</u>	<u>\$1 Cert. Fee</u>	<u>1264</u>
<u>10/1/40</u>	<u>104 B. P.</u>	<u>26725</u>

FEES REFUNDED

Date	Amount	Check No.

ASSIGNMENTS

Date	To Whom	Address	Volume	Page

REMARKS

0.63 s. 7. from Milk Creek and Unnamed Spring Creek -
(Molalla River) for Irrigation of 50 acres,
being 0.13 s. 7. from Spring Creek and 0.50 from
Milk Creek.

10-4-43 Card for B

10-10-44 Card for C

2-10-45 Farm 100 Registered

OK
Form B
NOTICE OF COMPLETION OF CONSTRUCTION

Application No. 19026

I, L. Rutherford, the holder of Permit No. 14633
to appropriate the public waters of the state of Oregon, completed the construction of the works described
therein on the 27 day of September, 1947

Remarks:

If the works have less capacity than described in the permit, or you have definitely abandoned part of the proposed development, you
should so state in order that our records may not be unnecessarily encumbered.

IN WITNESS WHEREOF, I have hereunto set my hand this _____ day of _____, 19____.

(Signature of Witness)

L. Rutherford

(Signature of Applicant)

(Address)

(Address)

Fill out, detach, and mail to the State Engineer, Salem, Oregon, when construction work is completed.

2M-3-48

Form C

IMPORTANT—This form is a notice to the State Engineer that permittee is ready to make final proof to the extent to which the water has actually been applied to the intended use under the terms of the permit. Permittee is cautioned that Certificate of Water Right will be issued based on the extent of the quantity and use as determined by the final proof inspection and survey which will be made in response to the filing of this Form C.

NOTE: In the case of an irrigation permit, this Form C should not be mailed to the State Engineer until all of the land described in the permit, which it is intended to irrigate under this permit at any time, has actually been irrigated.

Fill out, detach, and mail to the State Engineer, Salem, Oregon, when all of the water has been applied.

Application No. 19026

NOTICE OF COMPLETE APPLICATION OF WATER TO A BENEFICIAL USE

I, L. Rutherford, the holder of Permit No. 14633
to appropriate the public waters of the state of Oregon, completely applied the waters to a beneficial use in
accordance with the terms of said permit, on the _____ day of Summer, 1948.

Remarks:

All the 50 acres has been irrigated.

IN WITNESS WHEREOF, I have hereunto set my hand this 2/5 day of October, 1949

(Signature of Applicant)

L. Rutherford

(Address)

T.4S.R.IE.W.M.

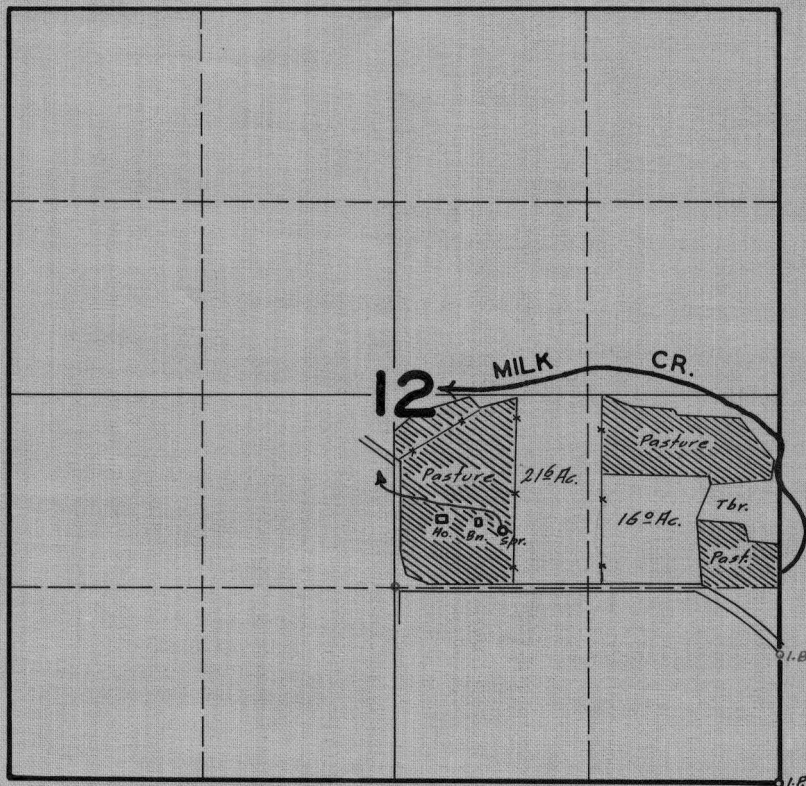

FINAL PROOF SURVEY

UNDER

Application No. 19026 Permit No. 14633

IN NAME OF

L. RUTHERFORD

Survived OCT. 6 1947, by JAS. E. BUNNELL

19026

T. 4 S., R. 1 E., W.M.

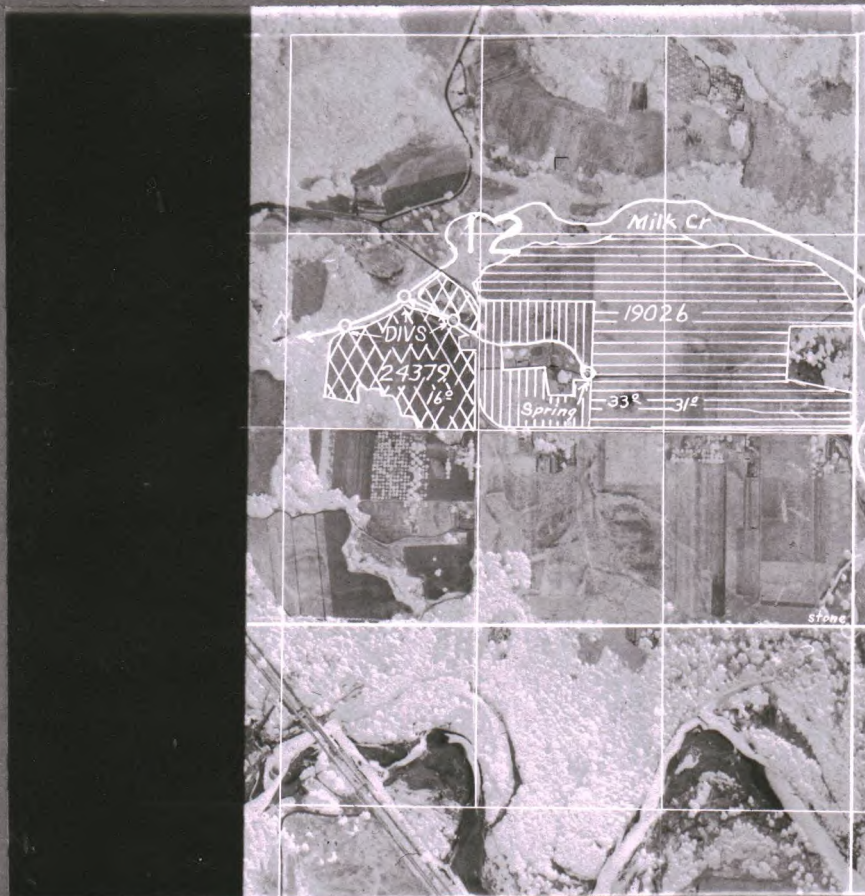

FINAL PROOF SURVEY

UNDER

Application No. 19026 Permit No. 11633
24379 19145

IN NAME OF
L. RUTHERFORD
FRANK SPERB

Surveyed May 26 1953, by H. L. Coffman

DFK-3D-121

Permit No. 14633

Application No. 19026

County CLACKAMAS

PROOF OF APPROPRIATION OF WATER

1. Name L. Rutherford
2. Address Route 1, Canby, Oregon
3. Source of supply Milk Creek and Unnamed Spring Creek, being 0.135 c.f.s. from spring creek and 0.50 c.f.s. from Milk Creek
Tributary of Molalla River

4. Amount of water 0.62 c.f.s.
5. Priority date October 1, 1940

6. Use Irrigation

7. Location of point of diversion, Any point on my property where streams designated in item 1 touch NE 1/4 SE 1/4 & NW 1/4 SE 1/4 Sec. 12, Twp. 4 S., Range 1 E., W. M.
(Legal Subdivision)

8. The description of land given below corresponds to that found in your permit covering land to be irrigated, or, if for other purposes, the place of use. In the blank column on the right, headed "No. acres actually irrigated", fill in the number of acres you have irrigated in each of the tracts described:

Township	Range	Section	Forty-acre Tract	No. Acres Described in Permit	No. Acres Actually Irrigated
4 S.	1 E.	12	From Milk Cr NE 1/4 SE 1/4	25	31.9
			NW 1/4 SE 1/4	25	16.9
			From Spring Cr NW 1/4 SE 1/4	50	21.6
					38.8
					11.2
If for irrigation, this appropriation shall be limited to 1/80th of one cubic foot per second or its equivalent for each acre irrigated and shall be further limited to a diversion of not to exceed 2 1/2 acre feet per acre for each acre irrigated during the irrigation season of each year, and shall be subject to such reasonable rotation system as may be ordered by the proper state officer.					This column must be filled in if water is used in irrigation
			PROOF AS IS		

(Attach separate sheet if necessary)

Surveyed May 28 1941
DFK 30-121 HC
J.E.B.
10-6-41

50.0

DESCRIPTION OF WORKS

9. (a) If a dam has been constructed, give description: Height, ft.; length on top, ft.; length on bottom, ft.; material used and character of construction,
- (b) Give description of headgate: Width, ft.; depth, ft.; material used and character of construction,
- (c) Size of canal: Width on top (at waterline), ft.; width on bottom, ft.; depth of water, ft.; grade, ft. fall per 1,000 ft. Actual capacity, sec.-ft.
Give general description: *500 ft. of 4" Main Line Pipe*
..... *300 ft. of 3" Lateral Pipe*
..... *200 ft. of 2" " "*
- (d) Pipe line: Description of intake,
8- Inche's Pal 1/2" Cap. Sprinklers
Length of pipe, ft.; size at intake, in.; size at ft. from intake, in.; size at place of use, in. Difference in elevation between intake and place of use, ft.
Is grade uniform? Actual capacity of pipe line, sec.-ft.
Give general description:
(Material: Steel, wrought, cast iron, wood stave, etc.)
..... *Pacific, 2"x2" Cent Direct connected*
..... *to a Wisconsin, size 2 7/8 x 2 3/4*
- (e) Pumping plant: Give size and type of pump, *gasoline engine*
Suction lift, *10'* ft.; discharge lift, *Level* ft. Type of motor used
Horsepower rating, H. P. Actual capacity of pump, sec.-ft.
10. During what months is water beneficially used? *Irrigation Season*
11. State character of soil *Loam*
Kind of crops raised *Pasture*
12. Does the accompanying map, filed with your application, show correctly the point of diversion, area of land irrigated, or place of use? *See data below*
13. If not, wherein is such map in error?
14. Domestic use: Give number of families actually using water at this time
15. If for power, mining, municipal, manufacturing, storage or any other purpose than irrigation, give extent and method of such use

AFFIDAVIT OF APPROPRIATOR

STATE OF OREGON,

County of } ss.

I,, being first duly sworn, depose and say that I have read the above and foregoing proof of appropriation of water; that I know the contents thereof, and that the facts therein stated are true.

IN WITNESS WHEREOF, I have hereunto set my hand this day of, 194.....

Subscribed and sworn to before me this day of, 194.....

Notary Public for Oregon

[Notarial Seal]

My commission expires

AFFIDAVIT OF WITNESSES

STATE OF OREGON,

County of } ss.

We,, and of, being first duly sworn, depose and say that we are well acquainted with the facts and conditions set forth in the foregoing statement relative to proof of appropriation of water under Permit No.; that we and each of us have been over and upon each tract described in said proof, and from such personal inspection have knowledge that all necessary ditches, dams and other diversion and distributing works have been constructed, and water used as stated therein; that we have carefully read such proof of appropriation, and that each and every statement contained therein is true to the best of our knowledge and belief.

Subscribed and sworn to before me this day of, 194.....

Notary Public for Oregon

[Notarial Seal]

My commission expires

REPORT OF PERSON MAKING INSPECTION

(For use by representative of State Engineer)

I, James E. Bunnell, do hereby certify that I have made an inspection of the works described herein and in Permit No. 14633, on the 6th day of Oct., 1947, and found the foregoing statements and descriptions of works to be accurate. In my opinion the appropriation has been completed to the extent of _____ and I recommend the issuance of water right certificate for this amount. _____
(Quantity of water in second-feet or acre-feet)

NOTICE TO INSPECTORS

If conditions do not justify the above report by you, please return the proof without your signature, with a full report by letter.

James E. Bunnell
(Name)
Field Engineer
(Title)
H. L. C.
26 May

PROOF OF APPROPRIATION

Permit No. _____

Recording fee paid

Receipt No. _____

SUCCESS BOND

Pump - 2 1/2" x 2" Byron Jackson cent belt dr 23 hp 4 cyl gas
2" x 2" cent dr 2 7/8" x 2 3/4" 1 cyl gas about 3 hp Wise
Pipe 600[±] 4", 600[±] 3" 400[±] 2" plus pipe borrowed from
neighbor.
heals 16 1/2" Jups pal type 5 4 Fc 35 x 90 (1/2" per hr)
lift suc 10[±] disch level portable
crop pasture - hay

Data from re-inspection
5-26-53

19026

SECTION

TOWNSHIP 4 S, RANGE 1 E, W. M.

North

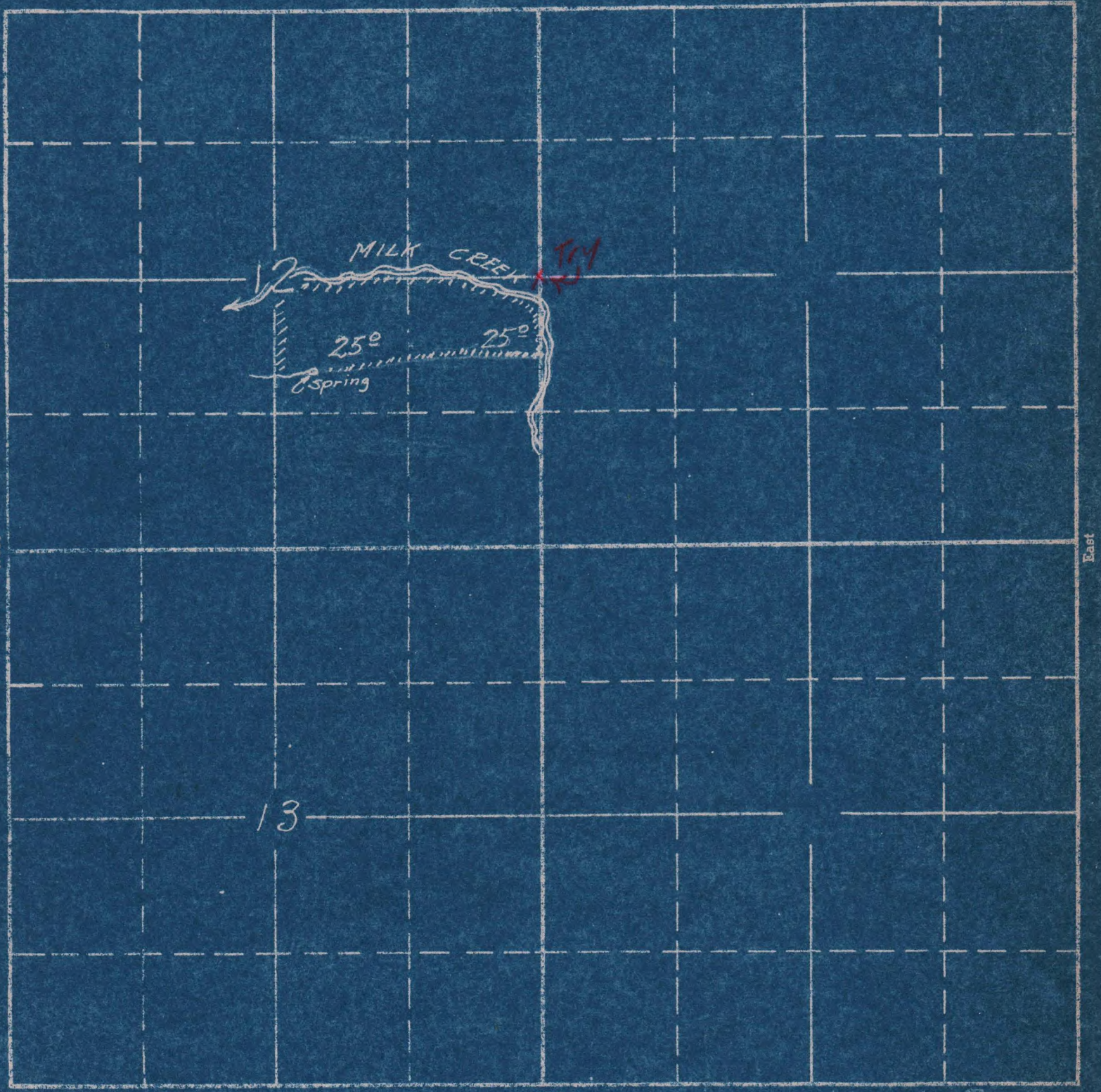

West

East

South

Sketched in office
of State Eng. from
data by applicant
10-1-'40.

19026 OK
2-32C
APPLICATION No. 19026
PERMIT No. 14633

19026

March 22, 1954

Mr. L. Rutherford
Route 1
Canby, Oregon.

Dear Mr. Rutherford:

We are enclosing herewith for completion, final proof in connection with the incomplete water right represented by your Permit No. 14633 granting a right to the use of 0.62 cfs of the waters of Milk Creek and an unnamed spring, being 0.135 cfs from Spring and 0.485 cfs from Milk Creek, for the irrigation of 50.0 acres of land.

The data contained in the proof, which is based on an inspection and survey of your project made by a representative of this department, defines the extent to which your water right has been completed within the terms of your Permit. The proof should be dated and signed by you on the second sheet under the Affidavit of Appropriator and returned to this office.

Upon receipt of the proof, properly executed and accompanied by the statutory fee of \$1.00, a Certificate of Water Right will be issued confirming the rights thereunder and, after being recorded in the records of Clackamas County, will be forwarded to you.

In the interest of economy and due to the fact that your completed project was examined by a representative of this department, it is not necessary that your signature be made before a Notary Public, nor that the signatures of witnesses be affixed to the proof.

You may keep the photo-map if you desire.

Yours very truly,

Chas. E. Stricklin

CHAS. E. STRICKLIN
State Engineer

Enclosure
Form 117

19026

Ed:

Permittee says that he has irrigated about 20 acres all told and this area is from the unnamed spring creek. Claims that he has tried to purchase additional pipe and larger size pump and motor in order to irrigate from the other stream (Milk Creek). He says that it is positive that he will enlarge the outlay as soon as the material is available. I believe that an extension would be in order at this time, with idea in mind to make final proof survey on the next trip. Say in 1947.

Application No. 19026
October 21, 1949

MEMORANDUM

Mr. Rutherford called at the office this date and states that he has irrigated more land than that shown by the last survey and that he desires another survey to be made.

vc

Application No. 19026Permit No. 14633**Application for Extension of Time**

To the State Engineer of Oregon:

I, L. Rutherford, of RT. 1, Box 347, Canby,
 state of Oregon, am the owner and holder of Permit No. 14633, to
 appropriate the public waters of the state of Oregon.

Under the terms and conditions of said permit, construction work is required to be completed on or
 before 10-1-, 1947, and complete application of water is required to be
 made on or before 10-1-, 1947.

I have heretofore done the following work described under said permit: _____

Construction is all
Completed

costing \$_____, and I estimate the cost of completion to be \$_____.

I have heretofore used water under said permit to the following extent: _____

I have increased the acreage since
the field engineer's inspection was made
but have now irrigated all the
land.

I am unable to { complete construction work
 make complete application of water } within the required time, for the following
 (Strike out phrase not applicable)

reasons, to wit: _____

Part of the ground wasn't in a
crop that needed to be irrigated
at the time

(If additional space is required, attach separate sheet)

(The fee provided by law in the amount of \$2.00 for filing an application for an extension of time should accom-
 pany the application for extension.)

(OVER)

Ext to 10/1/48 / Cons. & app.

WHEREFORE, I ask that the State Engineer extend the time for the

{ completion of construction work } under said permit to October 1, 1948
{ complete application of water }
(Strike out phrase not applicable)

AFFIDAVIT OF APPLICANT

STATE OF Oregon }
County of Marion } ss.

Russell J. Rutherford I, R. Rutherford, being first duly sworn, depose and say that I have read the above and foregoing application for extension of time; that I know the contents thereof, and the facts stated therein are true.

IN WITNESS WHEREOF, I have hereunto set my hand this 21st day of October, 1949

Subscribed and sworn to before me this 21 day of October, 1949

[Notarial Seal]

Max J. Rogers
Notary Public for Oregon

My commission expires Aug. 25, 1952

September 30, 1947

Mr. L. Rutherford
Route 1
Canby, Oregon

Dear Mr. Rutherford:

This will acknowledge receipt of Forms B and C, being notices of the completion of construction and complete application of water under your Permit No. 14633.

Pursuant to your reports and in line with the general practice of this office, a survey will be made at a later date for the purpose of checking the acreage actually irrigated. After this survey, proof may be made by you and certificate issued covering the lands which the survey shows to have been irrigated, and any lands described in your permit that have not been irrigated will be automatically eliminated from your water right.

In the meantime, the permit which you hold will be valid evidence of your water right.

Very truly yours,

CHAS. E. STRICKLIN
State Engineer

By
Ed K. Humphrey, Assistant

EKH:mjo

19026

June 25, 1945

Mr. L. Rutherford
Route 1
Canby, Oregon

Dear Mr. Rutherford:

Pursuant to the field engineer's recommendation, the time for completion of construction and complete application of water under your Permit No. 19026 is being extended until October 1, 1947.

Very truly yours,

CHAS. E. STRICKLIN
State Engineer

by

Ed K. Humphrey, Assistant

EKH:mjo

19026

February 10, 1945

Mr. L. Rutherford
Route 1
Canby, Oregon

According to the terms of your Application No. 19026, Permit No. 14633, which is for the appropriation of 0.63 second-feet of water from Milk Creek and unnamed spring creek, complete application of water was to have been made on or before October 1, 1944. It appears from our records that you have failed to submit the notice of complete application, although a post-card, calling this matter to your attention, was mailed to you on October 10, 1944.

Section 116-435, O. C. L. A., provides: "whenever the time within which any appropriation under a permit should have been perfected shall have expired and the owner of such permit shall fail or refuse within the period of three months thereafter to submit to the State Engineer proof of the completion of such appropriation as required by Section 116-426, O. C. L. A., the State Engineer may, after 60 days' notice by registered mail, order the cancellation of such permit, ***."

If you have complied with the terms of this permit, you should promptly submit the notice of complete application of water, after which we will take up with you the matter of final proof. If, however, you have abandoned your plan of development, we would appreciate your authority to cancel the permit, so that the permit may be cancelled without the necessity for following the legal procedure. In case you have not completed your appropriation, although you still wish to do so, you may submit an application for an extension of time. Such an extension may be granted if it appears that proper diligence has been shown.

Complete application of water under an irrigation permit means the irrigation of ALL of the land described in the permit, which it is intended to irrigate.

Form 3811
Rev. 1-4-40

RETURN RECEIPT

Received from the Postmaster the Registered or Insured Article, the original number of which appears on the face of this Card.

1 L. Rutherford
(Signature or name of addressee)

2 Marie Rutherford
(Signature of addressee's agent—Agent should enter addressee's name on line ONE above)

Date of delivery 2-12, 1945

is of Section 116-435,
which is quoted above, you
you within 60 days from
cancelled without further

y yours,

E. Stricklin

STRICKLIN
ineer

19226

Post Office Department

OFFICIAL BUSINESS

PENALTY FOR PRIVATE USE TO AVOID PAYMENT OF POSTAGE, \$300

POSTMARK OF DELIVERING

OFFICE

GANBY

FEB 12

3 PM

1915

OREG.

Return to **State Engineer**

(NAME OF SENDER)

Street and Number,
or Post Office Box,

REGISTERED ARTICLE

1899

SALEM,

INSURED PARCEL

OREGON.

No. _____

February 10, 1945

Mr. L. Rutherford
Route 1
Canby, Oregon

According to the terms of your Application No. 19026, Permit No. 14633, which is for the appropriation of 0.63 second-feet of water from Milk Creek and unnamed spring creek, complete application of water was to have been made on or before October 1, 1944. It appears from our records that you have failed to submit the notice of complete application, although a post-card, calling this matter to your attention, was mailed to you on October 10, 1944.

Section 116-435, O. C. L. A., provides: "whenever the time within which any appropriation under a permit should have been perfected shall have expired and the owner of such permit shall fail or refuse within the period of three months thereafter to submit to the State Engineer proof of the completion of such appropriation as required by Section 116-426, O. C. L. A., the State Engineer may, after 60 days' notice by registered mail, order the cancellation of such permit, ***."

If you have complied with the terms of this permit, you should promptly submit the notice of complete application of water, after which we will take up with you the matter of final proof. If, however, you have abandoned your plan of development, we would appreciate your authority to cancel the permit, so that the permit may be cancelled without the necessity for following the legal procedure. In case you have not completed your appropriation, although you still wish to do so, you may submit an application for an extension of time. Such an extension may be granted if it appears that proper diligence has been shown.

Complete application of water under an irrigation permit means the irrigation of ALL of the land described in the permit, which it is intended to irrigate.

In accordance with the provisions of Section 116-435, Oregon Compiled Laws Annotated, a part of which is quoted above, you are hereby notified that unless we hear from you within 60 days from the date of this letter, your permit will be cancelled without further notice.

Very truly yours,

Chas E. Stricklin

CHAS. E. STRICKLIN
State Engineer

Form #100
REGISTERED

19026

January 13, 1941

Mr. L. Rutherford
Route 1
Canby, Oregon

Dear Sir:

Herewith you will find Application No. 19026, Permit No. 14633, together with blue print.

The application has been approved and recorded in this office.

T.4S.R.1E.W.M.



FINAL PROOF SURVEY
UNDER

Application No. 19026 Permit No. 14633

IN NAME OF

L. RUTHERFORD

Surveyed OCT. 6, 1947, by JAS. E. BUNNELL

TOWNSHIP 4 S, RANGE 1 E, W. M.

North

West

East

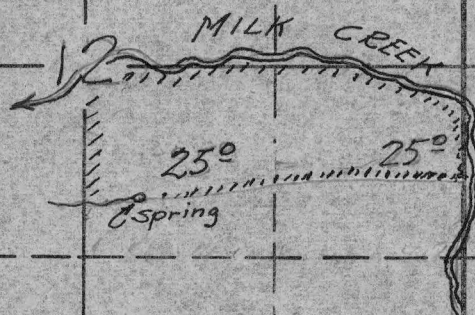

13

South

Sketched in office
of State Eng. from
data by applicant
10-1-'40.

19026 OK
2-32 C
APPLICATION No. 19026
PERMIT No. 14633

20372

Permit No. 14633

Application No. 19026

County CLACKAMAS

RECEIVED
 MAR 26 1954
 STATE ENGINEER
 SALEM, OREGON

Proof of Appropriation of Water

1. Name L. Rutherford 2. Address Route 1, Canby, Oregon
3. Source of supply Milk Creek and Unnamed Spring Creek
4. Tributary of Molalla River
5. Amount of water 0.62 cfs, being 0.135 cfs from Spring Creek & 0.485 cfs from Milk Creek
6. Priority date October 1, 1940
7. Use Irrigation - this appropriation shall be limited to 1/80th of one cubic foot per second for each acre irrigated and shall be further limited to a diversion of not to exceed 2 1/2 acre feet per acre for each acre irrigated during the irrigation season of each year, and shall be subject to such reasonable rotation system as may be ordered by the proper state officer.
8. Location of point of diversion NE 1/4 SE 1/4 & NW 1/4 SE 1/4 Sec. 12 Tp. 4 S. Rg. 1 E., W. M.
 (Legal Subdivision)
9. The description of land given below corresponds to that shown in the permit covering land to be irrigated, or, if for other purposes, the place of use.

Township	Range	Section	Legal Subdivision	No. Acres Actually Irrigated
4 S	1 E	12	From Milk Creek NE 1/4 SE 1/4	25.0
			NW 1/4 SE 1/4	13.8
			From Spring Creek NW 1/4 SE 1/4	11.2
				50.0

Land on which water is to be used is part of the property described by appropriator as follows:

(c) Size of canal: Width on top (at waterline) _____ ft; width on bottom _____ ft; depth of _____ ft; material used and character of construction _____

(d) Give description of headgate: Width _____ ft; depth _____ ft; material used and character of construction _____

(e) If a dam has been constructed, give description: Height _____ ft; length on top _____ ft; length on bottom _____ ft; material used and character of construction _____

DESCRIPTION OF WORKS
 (Attach separate sheet if necessary)

DESCRIPTION OF WORKS

9. (a) If a dam has been constructed, give description: Height, ft.; length on top, ft.; length on bottom, ft.; material used and character of construction,
- (b) Give description of headgate: Width, ft.; depth, ft.; material used and character of construction,
- (c) Size of canal: Width on top (at waterline), ft.; width on bottom, ft.; depth of water, ft.; grade, ft. fall per 1,000 ft. Actual capacity, sec.-ft.
Give general description:
- (d) Pipe line: Description of intake,
Length of pipe, ft.; size at intake, in.; size at ft. from intake, in.; size at place of use, in. Difference in elevation between intake and place of use, ft.
Is grade uniform? Actual capacity of pipe line, sec.-ft.
Give general description:
(Material: Steel, wrought, cast iron, wood stave, etc.)
8. (e) Pumping plant: Give size and type of pump,
Suction lift, 3" ft.; discharge lift, 2 1/2 inch ft. Type of motor used Gas
Horsepower rating, 24 h.p. H. P. Actual capacity of pump, 250 cu. ft. sec.-ft.
10. During what months is water beneficially used? July, Aug, Sept
11. State character of soil Sandy loam
Kind of crops raised Wheat & cultivated crops
12. Does the accompanying map, filed with your application, show correctly the point of diversion, area of land irrigated, or place of use? yes
13. If not, wherein is such map in error?
14. Domestic use: Give number of families actually using water at this time
15. If for power, mining, municipal, manufacturing, storage or any other purpose than irrigation, give extent and method of such use

AFFIDAVIT OF APPROPRIATOR

STATE OF OREGON,

County of Clatsop } ss.

I, L. Rutherford, being first duly sworn, depose and say that I have read the above and foregoing proof of appropriation of water; that I know the contents thereof, and that the facts therein stated are true.

IN WITNESS WHEREOF, I have hereunto set my hand this _____ day of _____, 19_____.

Subscribed and sworn to before me this _____ day of _____, 19_____.

Notary Public for Oregon

[Notarial Seal]

My commission expires _____

AFFIDAVIT OF WITNESSES

STATE OF OREGON,

County of _____ } ss.

We, _____, and _____ of _____, being first duly sworn, depose and say that

we are well acquainted with the facts and conditions set forth in the foregoing statement relative to proof of appropriation of water under Permit No. _____, that we and each of us have been over and upon each tract described in said proof, and from such personal inspection have knowledge that all necessary ditches, dams and other diversion and distributing works have been constructed, and water used as stated therein; that we have carefully read such proof of appropriation, and that each and every statement contained therein is true to the best of our knowledge and belief.

and I recommend the issuance of water right certificate for this amount _____
 as to which in my opinion the appropriation has been completed to the extent of _____
 of _____ and found the foregoing statements and descriptions of works to be correct.

Subscribed and sworn to before me this _____ day of _____, 19_____.

Notary Public for Oregon

[Notarial Seal]

My commission expires _____

REPORT OF PERSON MAKING INSPECTION

(For use by Representative of State Engineer)

I, James E. Bunnell, do hereby certify that I have made an inspection of the works described herein and in Permit No. 14633, on the 6th day of October, 1947, and found the foregoing statements and descriptions of works to be accurate. In my opinion the appropriation has been completed to the extent of _____ (Quantity of water in second-feet or acre-feet) and I recommend the issuance of water right certificate for this amount.

NOTICE TO INSPECTORS

If conditions do not justify the above report by you, please return the proof without your signature, with a full report by letter.

(sgd) James E. Bunnell

(Name) Field Engr.

(sgd) H. L. Coffman

(Title) Field Engr.

(May 26, 1953)

Mo' _____ and _____

County of _____

STATE OF OREGON

VERIDVAIL OF WITNESSES

(Notary Seal)

My commission expires _____

Subscribed and sworn to before me this _____ day of _____

of _____

IN WITNESS WHEREOF, I have hereunto set my hand and seal _____

the contents thereof and that the facts therein stated are true and correct and that I have read the above and foregoing report of appropriation of water and that I know the contents thereof and that the facts therein stated are true and correct.

I, James E. Bunnell

County of _____

STATE OF OREGON

VERIDVAIL OF VERIFICATION