

SURFACE WATER REGISTRATION CHECKLIST

(received after July 18, 1990)

CHECK BASIN MAP OK NAME LOWRZ # 20 UNADJUDICATED AREA ? YES
RECEIPT # 95442 WATERMASTER S W R NUMBER 217
CHECK ENCLOSURES yes PRELIMINARY DATA BASE ENTRY dup
ACKNOWLEDGEMENT LETTER Wek ENTER ON STREAM INDEX _____
CHECK QUADRANGLE MAP _____ CHECK GLO PLATS _____
WATERMASTER CHECKLIST _____ PUBLIC NOTICE PUBLICATION LCW

FORM REVIEW

_____ blanks filled in
_____ signed
_____ date received stamped

MAP REVIEW

_____ ✓ source and trib
_____ ✓ diversion point location
_____ conveyances (pipes, ditch, etc.)
_____ ✓ place of use
_____ ✓ scale
_____ ✓ township, range, section
_____ ✓ north arrow
_____ ✓ CWRE stamp
_____ ✓ disclaimer
_____ ✓ date survey was performed
_____ ✓ P.O.B. of survey
_____ ✓ dimensions and capacity of diversion system
_____ ✓ "beneficial use" type title
_____ "permanent-quality" paper

WATER RIGHT RECORD CHECK _____ FIELD INSPECTION _____
FINAL FILE REVIEW _____ FINAL DATA BASE ENTRY _____
ENTER ON PLAT CARDS _____

IS THE MATERIAL YOU REQUESTED ---

12-20-92

KELLY SOMERS
Public Works DEPT
CITY OF MILWAUKIE
6101 SE JOHNSON CREEK BLVD.
PORTLAND OR 97206

Oregon

WATER RESOURCES
DEPARTMENT

Water Rights/Adjudications
158 12th St. NE
Salem, Oregon 97310
(503) 378-8455 Ext. 255
FAX (503) 378-8130
1-800-624-3199

Donald E. Knauer
Adjudication Specialist
Adjudication Section



DEC 24 1992

SALEM, OREGON

STATE OF OREGON
WATER RESOURCES DEPARTMENT

SURFACE WATER REGISTRATION STATEMENT
PRE-1909 VESTED WATER RIGHT CLAIM

1. Name of Registrant: CITY OF MILWAUKIE
Mailing Address: Johnson Creek Facility, 6101 SE Johnson Creek Blvd,
Portland, Oregon 97206 Telephone No: (503) 652-4410
2. Source of water: SPRING CREEK
Tributary to: JOHNSON CREEK AND WILLAMETTE RIVER
3. Purpose(s) for which water is used: DUCK PONDS - WILDLIFE HABITAT
(Irrigation, Stockwater, Domestic, Hydroelectric power, Industrial, Etc.)
~~If irrigation, total number of acres irrigated:~~

	Upper Pond		Lower Pond	
Areas	0.5 Acre	0.2 Acre		
Volumes	0.75 Acre-Ft	0.30 Acre-Ft.		
4. Priority Date
 - a) Date of first use: 1883
 - b) Date water use development first initiated: 1883
 - c) Name of party who initiated development: Tyford or Adams

February 3, 1993

CITY OF MILWAUKIE
JOHNSON CREEK FACILITY
6101 SE JOHNSON CR BLVD
PORTLAND OR 97206

Dear MR BARTLETT,

This will acknowledge that your Surface Water Registration Statement in the name of CITY OF MILWAUKIE has been received by our office. The fees in the amount of \$400.00 have been received and our receipt #95442 is enclosed. Your registration statement has been numbered SWR-217.

Our office will review your form and map in the near future. If necessary we will schedule a meeting with you that will include a site inspection. If there are problems with your form we are usually able to take care of them during our visit. We will be able to answer any questions you might have about the adjudication process at that time.

Please feel free to contact this office if you have any questions.

Sincerely,

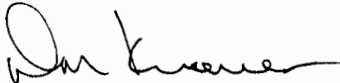

Don Knauer
Adjudication Specialist

Enclosure

C:\WP51\SWR\CLAIMANT\SWR-0217.001



3850 Portland Rd NE
Salem, OR 97310
(503) 378-3739
FAX (503) 378-8130

STATE OF OREGON
WATER RESOURCES DEPARTMENT
 3850 PORTLAND ROAD NE
 SALEM, OR 97310
 378-8455/378-8130 (FAX)

RECEIPT # **95442**

RECEIVED FROM: <u>City of Milwaukie</u>	APPLICATION
BY: _____	PERMIT
	TRANSFER

CASH: <input type="checkbox"/>	CHECK: # <input checked="" type="checkbox"/> <u>211-761</u>	OTHER: (IDENTIFY) <input type="checkbox"/>	TOTAL REC'D \$ <u>1100.00</u>
--------------------------------	---	--	-------------------------------

01-00-0 WRD MISC CASH ACCT		
842.010	ADJUDICATIONS	\$ <u>1100.00</u>
831.087	PUBLICATIONS/MAPS	\$
830.650	PARKING FEES Name/month	\$
	OTHER: (IDENTIFY)	\$

REDUCTION OF EXPENSE	
CASH ACCT.	\$
COST CENTER AND OBJECT CLASS	VOUCHER #

03-00-0 WRD OPERATING ACCT		
MISCELLANEOUS:		
840.001	COPY FEES	\$
850.200	RESEARCH FEES	\$
880.109	MISC REVENUE: (IDENTIFY)	\$
520.000	OTHER (P-6): (IDENTIFY)	\$
WATER RIGHTS:		
842.001	SURFACE WATER	\$
842.003	GROUND WATER	\$
842.005	TRANSFER	\$
WELL CONSTRUCTION:		
842.022	WELL DRILL CONSTRUCTOR	\$
842.016	WELL DRILL OPERATOR	\$
	LANDOWNER'S PERMIT	\$

06-00-0 WELL CONST START FEE		
842.013	WELL CONST START FEE	\$
	MONITORING WELLS	\$

45-00-0 LOTTERY PROCEEDS		
864.000	LOTTERY PROCEEDS	\$

07-00-0 HYDRO ACTIVITY		LIC NUMBER	
842.011	POWER LICENSE FEE(FW/WRD)		\$
842.115	HYDRO LICENSE FEE(FW/WRD)		\$
	HYDRO APPLICATION		\$

RECEIPT # **95442** DATED: 12/21/98 BY: [Signature]
 Distribution—White Copy-Customer, Yellow Copy-Fiscal, Blue Copy-File, Buff Copy-Fiscal

SITE REPORT FOR
SURFACE WATER REGISTRATION STATEMENT
PRE-1909 VESTED WATER RIGHT CLAIM
FOR KELLOGG LAKE

Registrant Name: City of Milwaukie
Registrant Address: 6101 SE Johnson Creek Blvd.
Portland, Oregon 97206
Contact: Tim Corbett, Public Works Director
Phone: (503) 652-4410
Survey Date: December 8, 1992

Survey Findings: Kellogg Lake water level is established by a 25.5 foot long concrete weir located within a 25.5 foot wide by 17 foot high box culvert under McLoughlin Blvd. (Highway 99E). The weir is approximately 1.7 feet high and 1.7 feet thick. The entrance channel is 7.7 feet deep and the spillway within the box culvert is 1.7 feet deep. A fish ladder, approximately 4 feet wide, is located along the north wall of the box culvert. It extends from the concrete weir to a point beyond the end of the box culvert beneath the low water level of the Willamette River.

Calculations: The surface area and volume of Kellogg Lake were taken from the Water Resources Dept. report titled "Lakes of Oregon: Vol. 4, Clackamas County", 1976, based on a survey performed on September 15, 1975. The amount of water claimed is based on 1/100 CFS per acre-foot for maintenance of wildlife and 1/10 inch per day average evaporation loss.

Maintenance = $(1/100)(45 \text{ Ac-Ft})$ = 0.45 CFS
Evaporation = $(1/10)(1/12)(15 \text{ Ac})(43560)(1/24)(1/60)^2$ = 0.06 CFS

TOTAL = 0.51 CFS

Survey Tie/Method: The government survey corner used to locate the water right is the EAST 1/4 Corner of Section 35, T1S R1E, WM. The method of survey was by inspection, supplemented by aerial photograph (1"=400'), aerial topography maps (1"=100'), assessors maps (1"=100') and construction drawings of Kellogg Lake Outlet.

Certification: The registration survey and inspection of the claimed use was performed by me on December 8, 1992, and the facts contained in this report and the accompanying registration map are correct to the best of my knowledge.

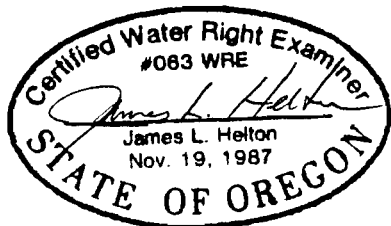

Expires 12-31-93

CUNNINGHAM ASSOCIATES, INC.
9401 SE McLoughlin Blvd.
Milwaukie, Oregon 97222
(503) 653-0753

LOCATION: Secs. 35 and 36, T.1 N., R.1 E., in Milwaukie about 6 mi (10 km) south of Portland city center. Surface-water outlet at Lat 45°28'30", Long 122°38'26". Lake Oswego 7 1/2-minute quadrangle map, photorevised 1970.

DRAINAGE BASIN: Willamette River.

DRAINAGE AREA: 14.8 mi² (38.3 km²).

SURFACE ELEVATION: 8 ft (2 m) above mean sea level, from topographic map. The mean tide change in the Willamette River at Kellogg Lake outlet is 2 ft (0.6 m).

SURFACE AREA: 15 acres (61,000 m²).

VOLUME: 45 acre-ft (55,000 m³).

INFLOW: No measurable flow in Kellogg Creek on southeast side of lake. The Willamette River could flood the lake during periods of extreme high water.

OUTFLOW: Some flow through spillway to the Willamette River on northwest end of lake.

USE: No specific recreational use; some fishing.

REMARKS: No evidence of either floating or submerged aquatic growth. Algal mats, high dissolved oxygen, and pH values indicated recent bloom. Bottom material is mostly soft mud.

Water-rights certificates issued for diversion of 0.031 ft³/s (<0.01 m³/s) for irrigation.

Photograph taken September 12, 1975.



WATER-QUALITY DATA

SAMPLING TIME: 1300 hours
CLOUD COVER: None

	pH (units)	CONDUCTIVITY (microhm/cm at 25°C)
SURFACE	8.7	215
BOTTOM	---	200

ALKALINITY (mg/l as CaCO₃) 87

TOTAL HARDNESS (mg/l as CaCO₃) 89

DISSOLVED SOLIDS (mg/l) 181

TRANSPARENCY (nephelometric turbidity units) 8

COLOR (Pt-Co units) 23

FECAL COLIFORM (colonies/100 ml) 67

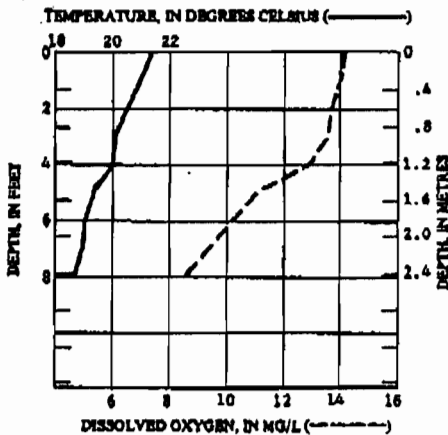

BATHYMETRIC MAP

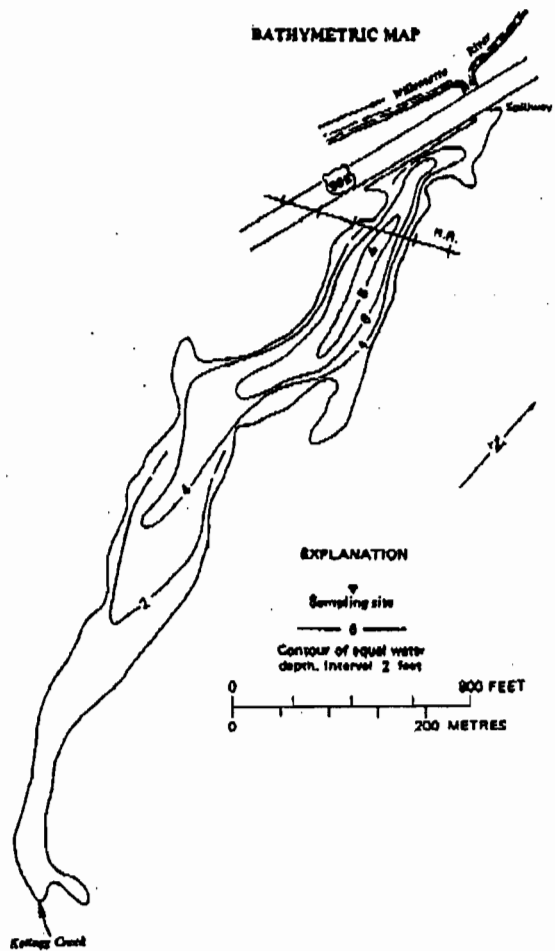

Nov 17^e

DEC 14

WATER RESOURCES DIVISION
SALEM, OREGON

Field Notes of the Roseman & Milwacker Head

By order of the County Court of Clatsop County, State of Oregon, to me called, I surveyed as follows to wit:

Beginning at W point in the center of the Head or Point 30 ft west of Jacob Miller Hotel in the Town of Milwacker where deposited on iron bolt, part of an Old grind stone about 10 inches long and drove W Stake No 1 Red C.R. from which W measure 12 inches in Diameter beam 35 1/4 & 74 links the north west part of the Hotel fence bears

S 43 1/2 E 58 Links Thence

S 4 3/4 E Magnetic variation 21 E

2.50 ch Bridge cross an old race

6.50 " edge of Mill-dam

8.00 " Mill Race

14.39 " intersect W fir 10 inch in diameter

157.56 " Set Post marked R A 1

From which an oak 4 inches in Diameter bears S 44 1/2 E 50 Links, Thence

S 33 E 3.92 ch to W fir tree 12 in in Diameter marked R A 2 Thence

S 15 E 3.50 " Edge of water water passage or dam 175 ch wide

6.65 " Set Post-marked R A 3, Thence

S 30 1/2 E 3.50 " " " " R A 4 Opposite Henry farm Oak set, Thence

S 46 1/2 E 4.14 " Set post marked R A 5, Thence

S 8.02 " W fir tree 14 in in Diameter

10.37 " Set a post set 6 Henry farm fence on the West, W rocky point, Thence

S 17 W 11.50 ch @ Hollow fir 15 ch R A 7, Thence

S 34 1/2 W 22.00 " Set Stake R A 8, Thence

S 21 1/2 W 2.50 " Set 14 mile post

23.25 " Set post marked R A 9 Thence

S 1 W 8.00 " @ Slough 150 ch wide

54.25 " Set 2nd mile post

65.58 " intersect W post for 36 inches in Diameter

J & R which is supposed to be across South line, as on definite information as to where the line was, Marking 2 miles, 6 chains and 25 Links

Finished this survey May 17 1880

Filed and recorded

May 17 1880

C. P. Williams

clerk

A. R. Short

Surveyor

Ante

Sec 30
15 1E



Millworks



Diagram on a scale of
90.00 chains to the inch

15 2E

9
96m

old road
ditch

Appended to be previous line

CITY OF MILWAUKIE
10722 S.E. MAIN STREET
MILWAUKIE, OREGON 97222

CHECK NO. 40824

INVOICE NUMBER	INVOICE DATE	P.O. NUMBER	COMMENT	AMOUNT
MEMO 12/17/92			Surface Water Registration Statement Pre-1099 Vested Water Right Claim as per attached notorized registration statements.	\$400.00

DEC 24 1992

REG. DEPT.
MILWAUKIE, OREGON

Here Is How Milwaukie Looked 80 Years Ago; Chart to Be Included in History Book

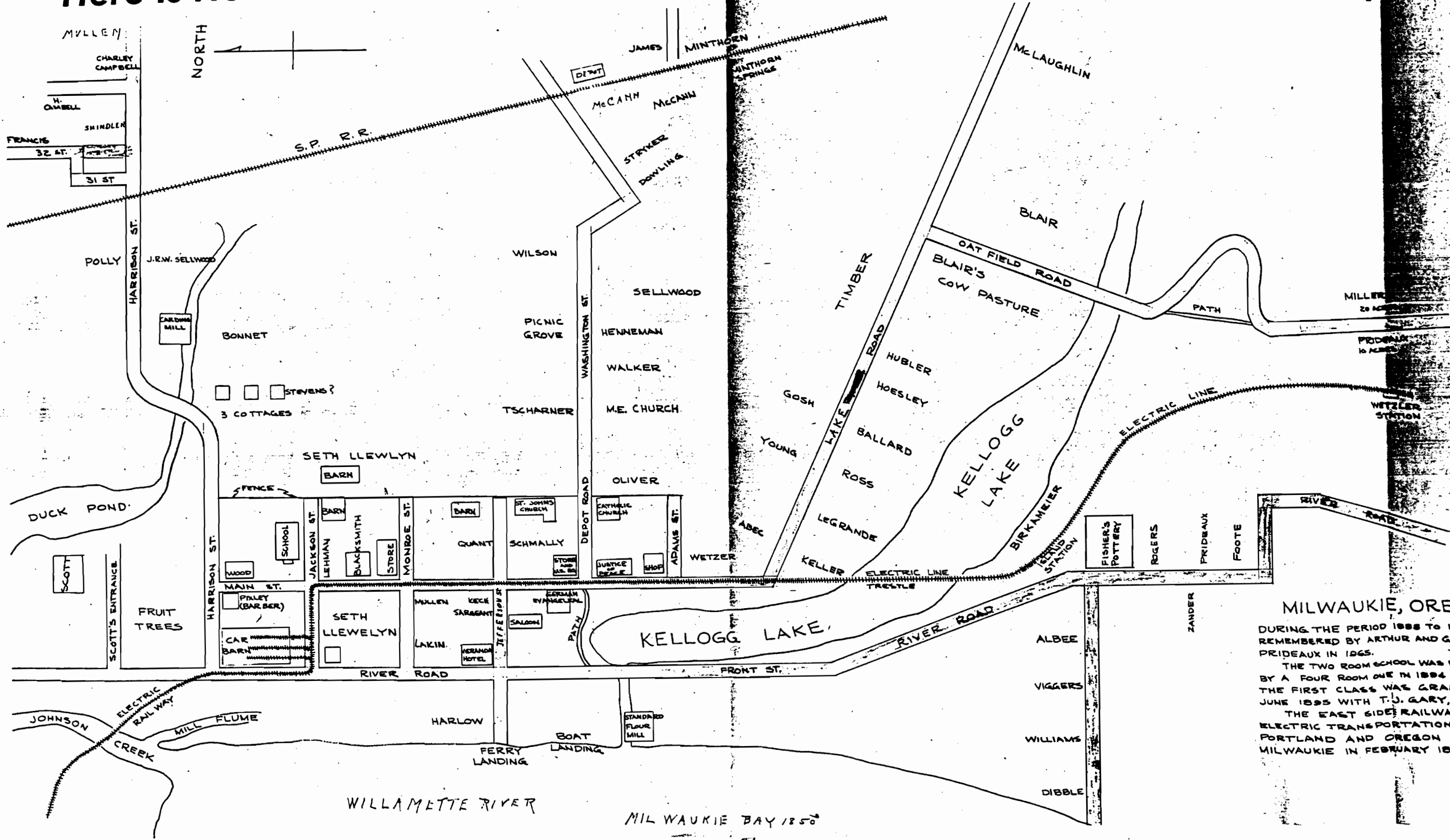

MILWAUKIE, OREGON
 DURING THE PERIOD 1888 TO 1893 AS REMEMBERED BY ARTHUR AND GEORGE PRIDEAUX IN 1965.
 THE TWO ROOM SCHOOL WAS REPLACED BY A FOUR ROOM ONE IN 1884 FROM WHICH THE FIRST CLASS WAS GRADUATED IN JUNE 1893 WITH T.J. GARY, PRINCIPAL.
 THE EAST SIDE RAILWAY CO. BEGAN ELECTRIC TRANSPORTATION BETWEEN PORTLAND AND OREGON CITY THROUGH MILWAUKIE IN FEBRUARY 1893.

SWR 217

Township No 1 South Range No 1 East of the Willamette Meridian, Oregon.

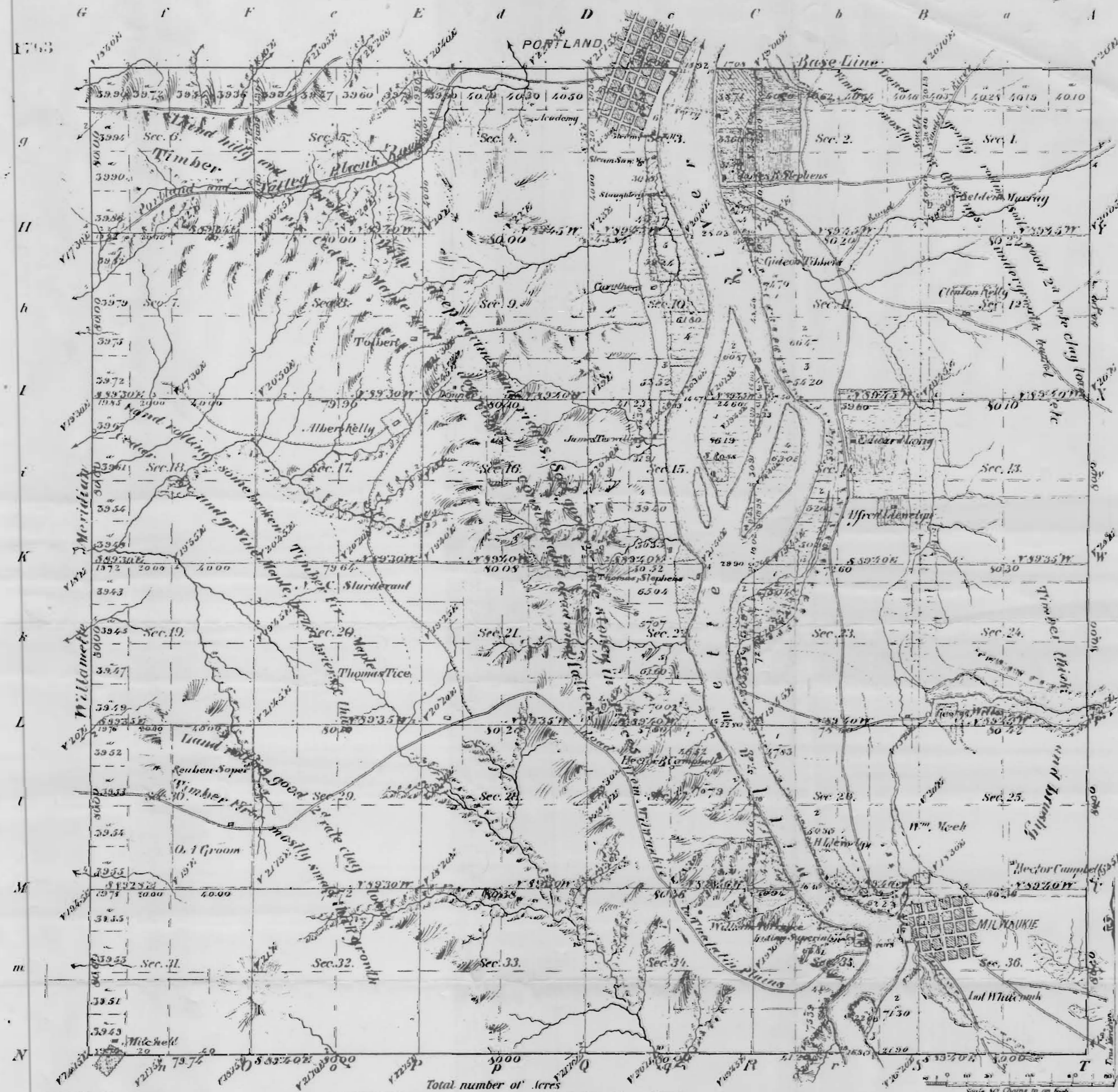

MEASURES OF
 Posts Courses CHAINS Posts Courses CHAINS Posts Courses CHAINS

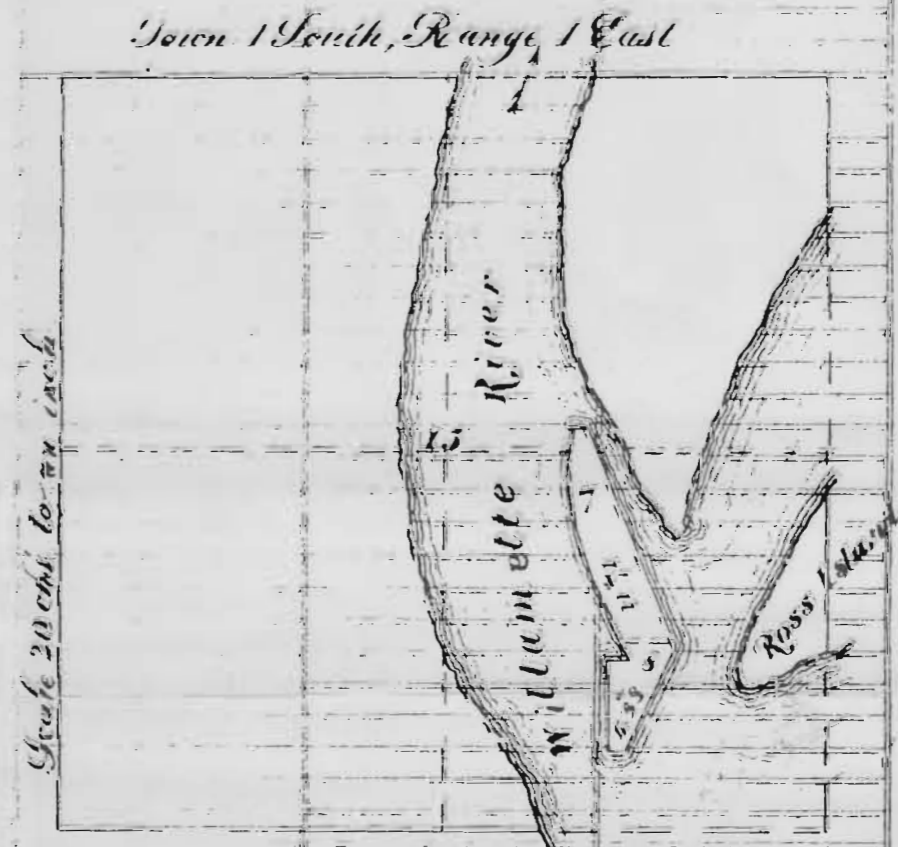

The above Special plat of the Survey of Joe Adams in Sec. 15: T. 1 S., R. 1 E., Will. Mer. is strictly conformable to the original field notes of the survey thereof on file in this office, which have been examined and approved.
 Surveyor General's Office, Eugene City, June 23, 1869. E. L. Appleton, Sur. Gen. for Ore.

The above Map of Township No 1 South, Range No 1 East, Will. Mer. Oregon, is a true and correct copy of the original Map on file in this office.
 Surveyor General's Office, Portland, Oregon, June 30, 1858. Robert H. McArthur, Sur. Gen. for Ore.

Surveys Designated	By Whom Surveyed	Date of Contract	Amount of Survey			When Surveyed	When changed by Sur. Gen's Office
			M.	Ch.	Ac.		
Township lines	Butler Bros	3 rd August 15, 1851	11	79	74	October 20, 1851	1 st Quarter 1852
Subdivisions	Butler Bros	3 rd October 25, 1851	74	69	45	May 20, 1852	2 nd Quarter 1852
			3	40	64		3 rd Quarter 1852

The above Map of Township No 1 South, Range No 1 East of the Willamette Meridian, Territory of Oregon, is strictly conformable to the field notes of the survey thereof on file in this office, which have been examined and approved.
 Surveyor General's Office, Oregon City, May 20th 1852. J. B. Preston, Sur. Gen. for Ore.

RECEIVED
 DEC 24 1992
 WATER RESOURCES DEPT.
 SALEM, OREGON

MICROBOX