

T 3N R 29E WM

16

15

21

22

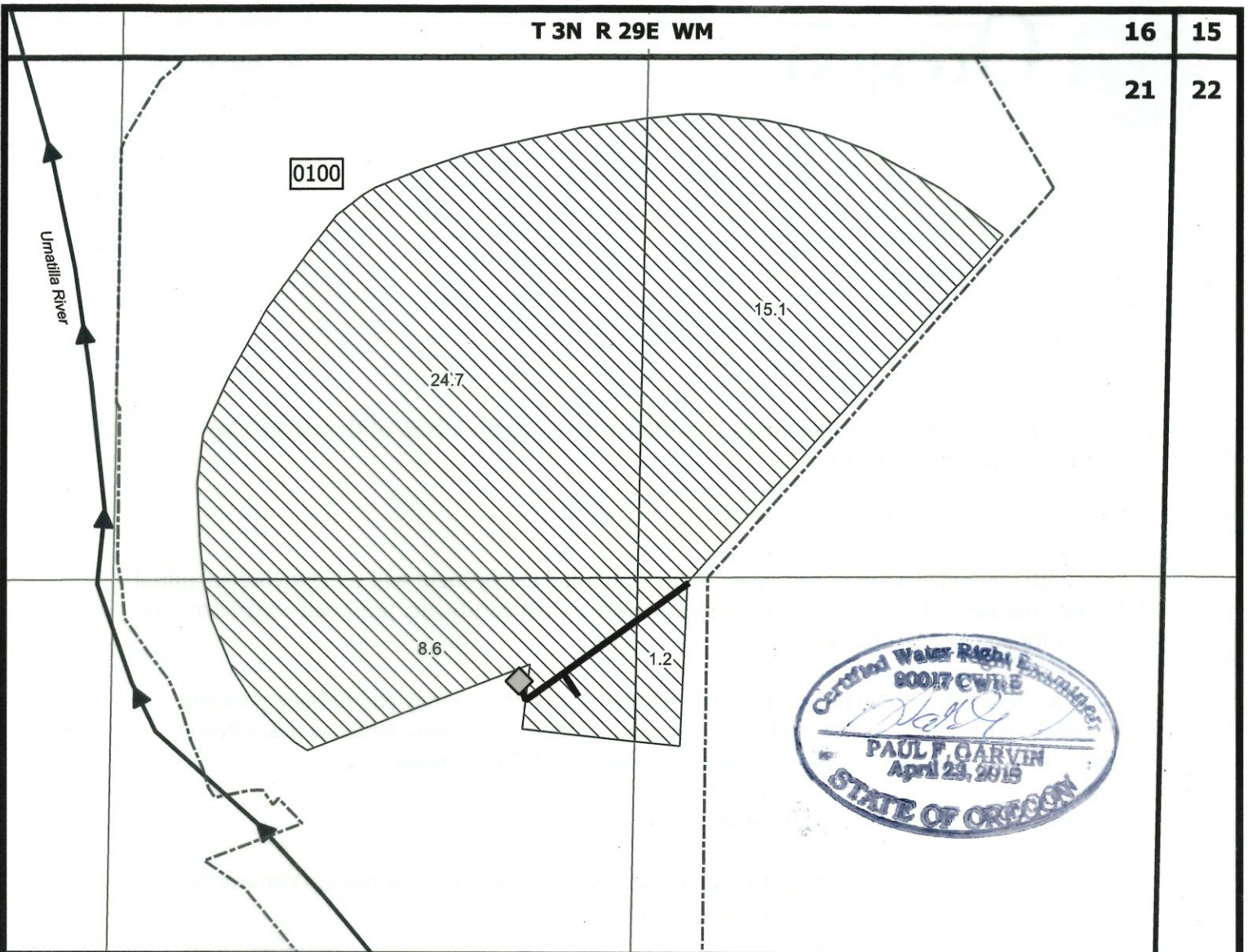

LEGEND

Umatilla County Taxlot Boundary

0100



Point of Diversion



Place of Use



8" mainline

Received
APR 23 2025
OWRD

Received
MAY 08 2025
OWRD

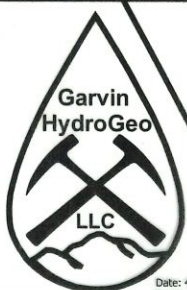

Claim of Beneficial Use Map Transfer T-7919 Umatilla County, OR

Prepared on Behalf of John and Debbie McBee

1 inch = 400 feet



Notes:

Shallow Well: 1,367' S and 1,390' W from the NE Corner, Section 21

The flowmeter is located approximately 12' southeast of the POD

This map is not intended to provide legal dimensions or locations of property ownership lines.