

SURFACE WATER REGISTRATION CHECKLIST

(received after July 18, 1990)

CHECK BASIN MAP DEX NAME Unipqua # 16 UNADJUDICATED AREA ? yes
 RECEIPT # 95477 S W R NUMBER 245
 CHECK ENCLOSURES DEX PRELIMINARY DATA BASE ENTRY DEX
 ACKNOWLEDGEMENT LETTER DEX ENTER ON STREAM INDEX _____
 CHECK QUADRANGLE MAP _____ CHECK GLO PLATS _____
 WATERMASTER CHECKLIST _____ PUBLIC NOTICE PUBLICATION SCB

FORM REVIEW

_____ blanks filled in
 _____ signed
 _____ date received stamped

MAP REVIEW

source and trib
 diversion point location
 conveyances (pipes, ditch, etc.)
 place of use _____
 scale
 township, range, section
 north arrow
 CWRE stamp
 disclaimer
 date survey was performed
 P.O.B. of survey
 dimensions and capacity of diversion system
 "beneficial use" type title
 "permanent-quality" paper

USED 1/16th LINES ON GOV LOTS.
ACTUAL LOCATION OF HOUSE

WATER RIGHT RECORD CHECK _____ FIELD INSPECTION _____
 FINAL FILE REVIEW _____ FINAL DATA BASE ENTRY _____
 ENTER ON PLAT CARDS _____

October 5, 1993

HARVEY WILCOX
% STUNTZNER ENGINEERING
PO BOX 118
COOS BAY OR 97420

re: SWR-245

Dear Mr Wilcox,

This will acknowledge the receipt of the map you prepared in support of the claim to a pre-1909 vested water right in the name of GENE C & MABEL ABBOTT. The map has been added to the file. If you have any questions, please give me a call.

Sincerely,



Don Knauer
Adjudication Specialist

J:\WP51\SWR\CLAIMANT\2\SWR-0245.002



3850 Portland Rd NE
Salem, OR 97310
(503) 378-3739
FAX (503) 378-8130

September 14, 1993

HARVEY WILCOX
3190 N LAKE ROAD
LAKESIDE OR 97449

RE: File# SWR-245

DEAR HARVEY WILCOX,

The Water Resources Department (WRD) received a little over 500 surface water registration statements in December, 1992. All of the files have been set up and receipts for the fees have been sent. The next step is to insure the maps received in support of the claims are acceptable based on Oregon Revised Statutes (ORS) and Oregon Administrative Rules (OAR).

I am returning the map you prepared for Gene C. and Mabel Abbott. You will find the item which requires completion or correction shown below. I have the description followed by the ORS or OAR site and paraphrased statute or rule.

✓ place of use (1/4 1/4)

ORS 539.240 (2) (d) (B) "The location of place of use by quarter-quarter section..." You must show the 1/16th lines or Government Lot lines for the place of use. You must also show the location of the house where the domestic use occurs.

✓ 1/10 acre

OAR 690-28-025-(4)-(d) "The number of acres irrigated in each quarter quarter shall be shown to the nearest tenth of an acre." The area you have shown cross-hatched scales about 0.2 acres. You must certify to the actual amount of beneficial use and show that acreage on the map.



3850 Portland Rd NE
Salem, OR 97310
(503) 378-3739
FAX (503) 378-8130

You must return the map before the claim can be processed. If you cannot have the map to the WRD within 60 days, please inform me as to when it can be expected. Please mark all correspondence with the file number.

As always, if you have any questions, please give me a call.

Sincerely,

A handwritten signature in black ink, appearing to read "Don Knauer", with a long horizontal flourish extending to the right.

Don Knauer
Adjudication Specialist

Enclosures

February 17, 1993

GENE C & MABEL ABBOTT
7046 LOWER SMITH RIVER RD
REEDSPORT OR 97467

Dear MR & MRS ABBOTT,

This will acknowledge that your Surface Water Registration Statement in the name of GENE C & MABEL ABBOTT has been received by our office. The fees in the amount of \$200.00 have been received and our receipt #95477 is enclosed. Your registration statement has been numbered SWR-245.

Our office will review your form and map in the near future. If necessary we will schedule a meeting with you that will include a site inspection. If there are problems with your form we are usually able to take care of them during our visit. We will be able to answer any questions you might have about the adjudication process at that time.

Please feel free to contact this office if you have any questions.

Sincerely,



Don Knauer
Adjudication Specialist

Enclosure

C:\WP51\SWR\CLAIMANT\SWR-0245.001



3850 Portland Rd NE
Salem, OR 97310
(503) 378-3739
FAX (503) 378-8130

STATE OF OREGON
WATER RESOURCES DEPARTMENT

RECEIPT # **95477**

3850 PORTLAND ROAD NE
 SALEM, OR 97310
 378-8455/378-8130 (FAX)

RECEIVED FROM: Gene C. or Mabel Abbott
 BY: _____

APPLICATION	
PERMIT	
TRANSFER	

CASH: CHECK: # 96104 OTHER: (IDENTIFY)

TOTAL REC'D \$ 700.00

01-00-0 WRD MISC CASH ACCT

842.010	ADJUDICATIONS	\$ <u>700.00</u>
831.087	PUBLICATIONS/MAPS	\$
830.650	PARKING FEES Name/month	\$
	OTHER: (IDENTIFY)	\$

REDUCTION OF EXPENSE

CASH ACCT.	\$
COST CENTER AND OBJECT CLASS	VOUCHER #

03-00-0 WRD OPERATING ACCT

MISCELLANEOUS:

840.001	COPY FEES	\$
850.200	RESEARCH FEES	\$
880.109	MISC REVENUE: (IDENTIFY)	\$
520.000	OTHER (P-6): (IDENTIFY)	\$

WATER RIGHTS:

842.001	SURFACE WATER	\$	842.002	\$
842.003	GROUND WATER	\$	842.004	\$
842.005	TRANSFER	\$	842.006	\$

WELL CONSTRUCTION

842.022	WELL DRILL CONSTRUCTOR	\$	842.023	\$
842.016	WELL DRILL OPERATOR	\$	842.019	\$
	LANDOWNER'S PERMIT	\$	842.024	\$

06-00-0 WELL CONST START FEE:

842.013	WELL CONST START FEE	\$	CARD #	
	MONITORING WELLS	\$	CARD #	

45-00-0 LOTTERY PROCEEDS

864.000	LOTTERY PROCEEDS	\$
---------	------------------	----

07-00-0 HYDRO ACTIVITY

842.011	POWER LICENSE FEE(FW/WRD)	LIC NUMBER	\$
842.115	HYDRO LICENSE FEE(FW/WRD)		\$
	HYDRO APPLICATION		\$

RECEIPT # **95477** DATED: 12/28/92 BY: C. Engel

Distribution—White Copy-Customer, Yellow Copy-Fiscal, Blue Copy-File, Buff Copy-Fiscal

#8. We know from our own knowledge that water has been used here since about 1935 as we both lived in the area and have owned it since 1960.

We have also been told by Clarence and Everett Abbott, sons of Joshua Abbott, of water use since about 1905, that they can remember.

RECEIVED

DEC 28 1992

WATER RESOURCES DEPT.
SALEM, OREGON



TELEPHONE (503) 267-2872
FAX (503) 267-0588

705 SO. 4TH, P.O. BOX 118
COOS BAY, OREGON 97420

RECEIVED

OCT 05 1993

WATER RESOURCES DEPT.
SALEM, OREGON

MEMORANDUM

TO: Don Knauer

DATE: 9/29/93

FROM: Harvey Wilcox

RE: Gene Abbott Water Rights
File # SWR-245

I have indicate the 40 acres that the use takes place on and have shown the home. I have also indicated the irrigation of lawn and garden to scale and labeled the area as 0.5 acres. All as per your letter of Sept 14.

Sincerely

Harvey Wilcox

Section 9 Township 21S Range 11W W.M.
Douglas County

N1/4

S4 S3
S9 S10



100' x 100' = 0.2² ac
N1/16 WAAS IS
ACTUALLY GOING
ON

N1/16

N1/.16

Legend

- P.O.D.
- Property Line
- Creek
- ▧ Home including 1/2 acre irrigation
- Waterline

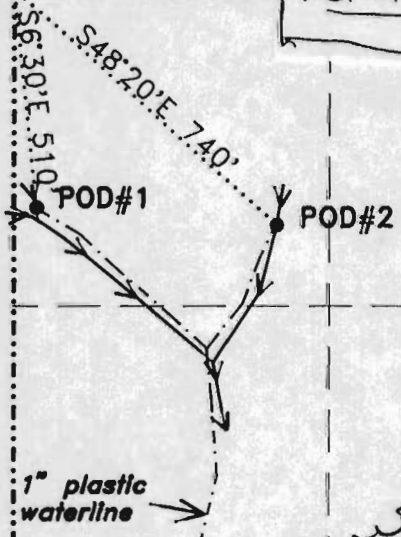

SALES 0.2 (100x100) ac
WHERE IS HOME? ?
LINES? GOT LOT?

SMITH RIVER

C1/4 CE1/16 E1/4

EXAMINERS DISCLAIMER STATEMENT

NOTE:

The P.O.D. and Waterline is entirely located on property owned by the applicant.

The preparation of this map was for the purpose of identifying the location of the Water Right only and has no intent to provide dimensions or location of property ownership lines.

PRE 1909 VEST WATER RIGHTS

IN THE NAME OF

Gene Abbott

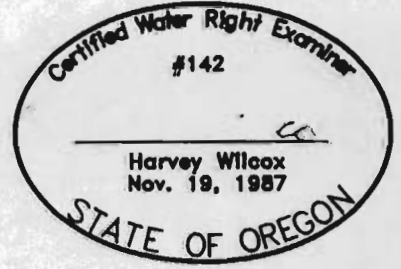

Surveyed on DECEMBER, 1992 by H.A. Wilcox

LAND SURVEYING

ENGINEERING

FORESTRY

RECEIVED

DEC 28 1992

WATER RESOURCES DEPT
SALEM, OREGON

STUNTZNER ENGINEERING & FORESTRY

CLAIM OF BENEFICIAL USE AND SITE REPORT
FOR PRE 1909 VESTED WATER RIGHTS

INFORMATION

THE PERMITTEE IS: GENE ABBOTT
HCL 7046
LOWER SMITH RIVER ROAD
REEDSPORT, OREGON 97467

I TALKED WITH GENE ABBOTT AT THE SITE ON NOVEMBER 30, 1992. THE SYSTEM WAS EXISTING AND IN USE AT THAT DATE. GENE HAS STATED THAT WATER HAS BEEN USED PRIOR TO 1909.

SOURCES

THE SOURCES OF WATER ARE TWO UNNAMED STREAMS THAT CONVERGE AND FLOW INTO SMITH RIVER.

DIVERSION POINTS

POD #1 IS A 2' HIGH ROCK AND DIRT DAM THAT IMPOUNDS 4'X3'X1' DEEP OF WATER.

POD #2 IS A 2' HIGH WOOD DAM THAT IMPOUNDS 6'X4'X1' DEEP OF WATER.

MOTOR/PUMP

THIS IS A GRAVITY SYSTEM.

PIPE

THE WATER IS TRANSFERRED FROM POD #1 THROUGH 25' OF 1 1/2" WHITE PLASTIC PIPE TO A 200 GALLON SETTLEMENT TANK. IT THEN FLOWS THROUGH 130' OF 1 1/4" WHITE PLASTIC PIPE TO A REDUCER. IT THEN FLOWS THROUGH 340' OF 1" WHITE PLASTIC PIPE TO A JUNCTION WITH THE WATER FROM POD #2. IT THEN FLOWS THROUGH 560' OF 1" WHITE PLASTIC PIPE TO THE HOUSE AND GARDEN.

THE WATER IS TRANSFERRED FROM POD #2 THROUGH 70' OF 1 1/4" WHITE PLASTIC PIPE TO A 100 GALLON SETTLEMENT TANK. IT THEN FLOWS THROUGH 100' OF 1 1/4" WHITE PLASTIC PIPE TO A REDUCER. IT THEN FLOWS THROUGH 180' OF 1" WHITE PLASTIC PIPE TO A JUNCTION WITH THE WATER FROM POD #1.

RECEIVED

DEC 28 1992

WATER RESOURCES DEPT.
SALEM, OREGON

HEADS

THERE IS 22' OF HEAD BETWEEN THE OPEN SETTLEMENT TANK BELOW POD #1 AND THE REDUCER. THERE IS 32' OF HEAD BETWEEN THE REDUCER AND THE JUNCTION WITH THE WATER FROM POD #2. THERE IS 20' OF HEAD BETWEEN THE JUNCTION AND THE PLACE OF USE AT THE HOUSE. THIS GIVES A TOTAL HEAD OF 74.

THERE IS 22' OF HEAD BETWEEN THE OPEN SETTLEMENT TANK BELOW POD #2 AND THE REDUCER. THERE IS 19' OF HEAD BETWEEN THE REDUCER AND THE JUNCTION WITH THE WATER FROM POD #1. THIS GIVES A TOTAL HEAD OF 61'. ELEVATIONS WERE MEASURED BY THEODOLITE.

USES

THE WATER IS BEING USED FOR DOMESTIC USE OF ONE HOUSEHOLD INCLUDING IRRIGATION OF LESS THAN 1/2 ACRE LAWN AND GARDEN

LIFT

SURVEY TIE

THE SURVEY CORNER USED TO LOCATE THE WATER RIGHTS WAS A 3 1/4" ALUM. CAP SET IN A SURVEY FOR INTERNATIONAL PAPER AND RECORDED WITH DOUGLAS COUNTY. MY TIE WAS TO AN ALUM. POST SET ON LINE AND 480' SOUTHERLY OF THE CN1/16 DESCRIBED ABOVE. MY BASIS OF BEARINGS WAS COMPASS WITH A DECLINATION OF 18 DEGREES EAST. MY TIES WERE MADE USING A THEODOLITE AND EDM.

REMARKS

RECEIVED

DEC 28 1992

**WATER RESOURCES DEPT.
SALEM, OREGON**

THE PRE 1909 VESTED WATER RIGHTS SURVEY AND INSPECTION OF THE USE WAS COMPLETED BY ME ON 11/30/92 AND THE FACTS CONTAINED ON THIS REPORT AND ACCOMPANYING MAP ARE CORRECT TO THE BEST OF MY KNOWLEDGE.

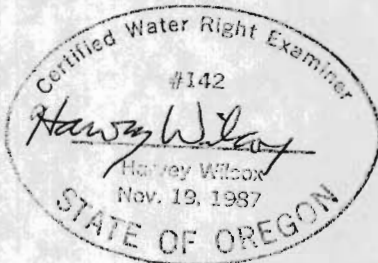

HARVEY WILCOX CWRE #142

I, _____ AGREE TO THE FINDINGS OF THE CWRE
AND DO SUBMIT THIS SITE REPORT AND MAP AS MY CLAIM OF
BENEFICIAL USE OF THE WATER AS PROVIDED UNDER PRE 1909 VESTED
WATER RIGHTS

(SIGNATURE)

RECEIVED

DEC 28 1992

WATER RESOURCES DEPT.
SALEM, OREGON

System Capacity Calc

The water from either POD can be turned off but both were on when I measured the PSI so I used POD #2 for my calc because IT is lower than POD #1. I also used a line size of 1" for the whole route.

line length = 840'
measured PSI at house = 22psi

PSI per 100' of pipe = $\frac{22}{8.4} = 2.6$
this gives a capacity of 0.19 cfs

FLOW OF WATER IN
COPPER & BRASS PIPES

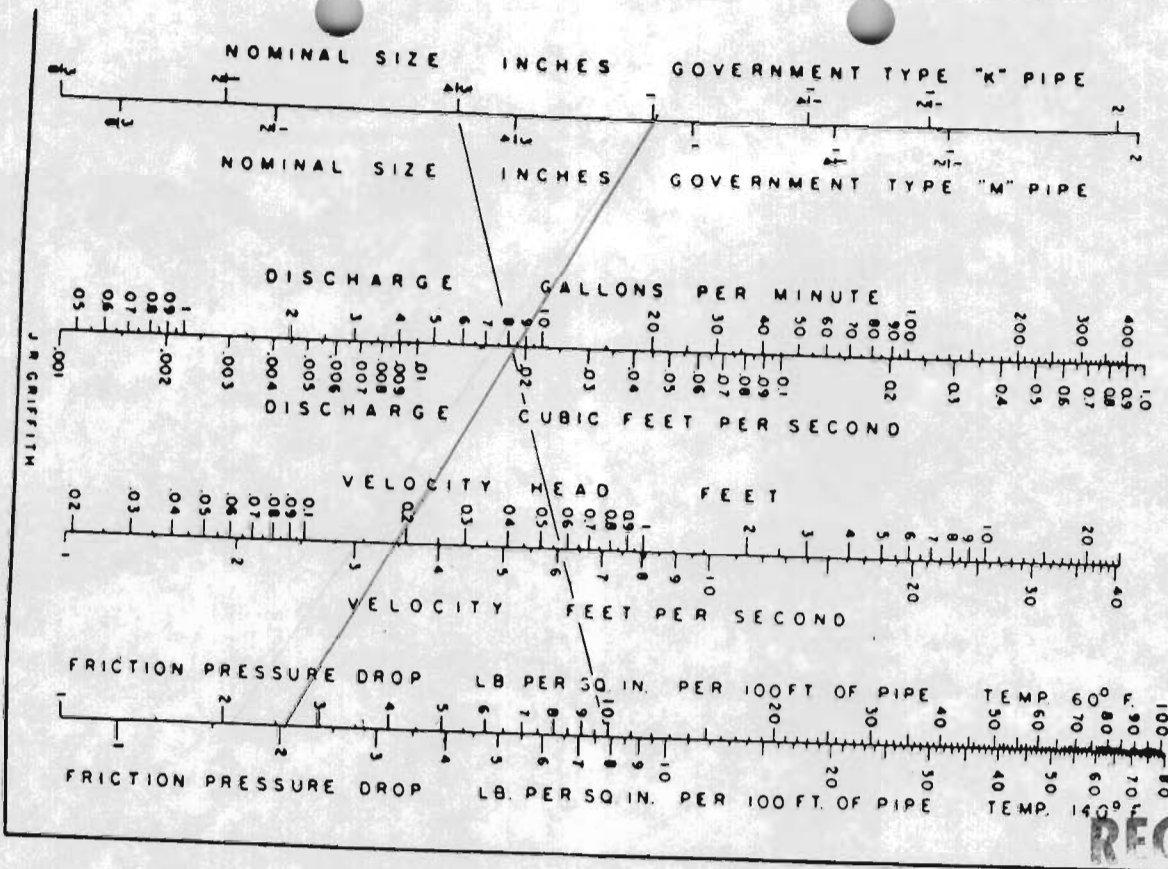

RECEIVED

DEC 28 1992

WATER RESOURCES DEPT.
SALE OREGON

Flow of Water in Small Pipes

3/8 to 2-in. diam.

THERE have been numerous nomographic charts published for the flow of water in pipes, including four of my own. However, I have not previously seen one applicable to pipes in the smaller size ranges.

The accompanying chart is based on tabular data published by the Bridgeport Brass Co.* Being applicable to the flow of water at temperatures both 60 deg. F. and 140 deg. F., it should be convenient in the design of building and boiler installations. It would be applicable to pipes of other material of corresponding smoothness with care being taken for corrosive waters.

Government types "K" and "M" have been included, the difference being in the wall thickness and internal diameter. The following table indicates the difference for the included sizes:

Nominal Size	Outside Dia., in.	Wall Thickness, in.	Type "K"	Type "M"
1/4	.500	.049	.025	
1/2	.625	.049	.028	
3/4	.875	.065	.032	
1	1.125	.065	.035	
1 1/4	1.375	.065	.042	
1 1/2	1.625	.072	.049	
2	2.125	.083	.058	

A single straight line intersecting all scales is necessary for a solution of this chart. Any two known, or assumed, values will determine the direction of the solution line. A solution line has been drawn for the following problem:

Required to determine the discharge of water at 60 deg. F. in 3/8-in. Government type "K" copper tube for a total pressure

drop of 20 lb. per sq. in. for a 200-ft. run of pipe.

$$\text{Pressure drop} = \frac{20}{2} = 10 \text{ lb. per sq. in. per 100 ft.}$$

A line has been drawn between the pipe size and this pressure drop. The following information is then obtained from the other scales:

- Discharge = 8.2 gal. per min.
- Discharge = 0.018 cu. ft. per sec.
- Velocity = 6.1 ft. per sec.
- Velocity head = 0.57 ft.
- Pressure loss for same pipe but water at 140 deg. F. would be 7.9 lb. per sq. in. per 100 ft. of pipe.

From the tables, * Discharge = 8.2 gal. per min.

$$\text{Discharge} = \frac{8.2}{448.83} = 0.0183 \text{ cu. ft. per sec.}$$

Area of 3/8-in. type "K" pipe

$$A = \frac{3.1416[(0.875 - 2(0.065))^2]}{4} = 0.436 \text{ sq. in.}$$

$$\text{Area} = \frac{0.436}{144} = 0.00303 \text{ sq. ft.}$$

$$\text{Vel.} = \frac{\text{Discharge}}{\text{Area}} = \frac{0.0183}{0.00303} = 6.04 \text{ sec. ft.}$$

$$\text{Velocity head} = \frac{V^2}{2g} = \frac{6.04^2}{64.4} = 0.567$$

* Water Pipe Sizes, by Walter S. Timmils, Bridgeport Brass Co., Bridgeport, Conn.

NOTES FOR 1967 EDITION

Not many references pertaining to small diameter tubing or pipe are available at present, particularly as regards head loss in fittings or bends. Manufac-

turers data must be consulted for these situations. It should be noted that this chart presents flow data only for straight sections of the described pipe. T/JM

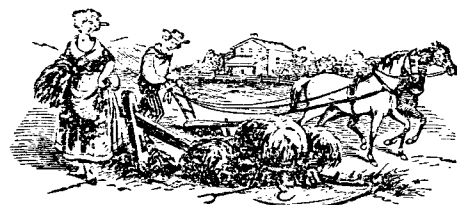

THE UNITED STATES OF AMERICA,

To all to whom these presents shall come, Greeting:

Homestead Certificate No. 1837
APPLICATION 3928

Whereas There has been deposited in the GENERAL LAND OFFICE of the United States a CERTIFICATE OF THE REGISTER

of the LAND OFFICE at Roseburg Oregon, whereby it appears that, pursuant to the Act of Congress approved 20th May, 1862, "To secure Homesteads to Actual Settlers on the Public Domain," and the acts supplemental thereto, the claim

of Joshua Abbott has been established and duly consummated, in conformity to law, for the

North east quarter of the north east quarter and the south west quarter of the north east quarter and the lots numbered seven, eight and nine of section nine in Township Twenty one South of range eleven West of Willamette Meridian in Oregon containing one hundred and sixty acres.

according to the OFFICIAL PLAT of the Survey of the said Land, returned to the GENERAL LAND OFFICE by the SURVEYOR GENERAL:

Now know ye, That there is, therefore, granted by the United States unto the said Joshua Abbott

the tract of Land above described: To have and to hold the said tract of Land, with the appurtenances thereof, unto the said Joshua Abbott and to his

heirs and assigns forever; subject to any vested and accrued water rights for mining, agricultural, manufacturing, or other purposes, and rights to ditches and reservoirs used in connection with such water rights, as may be recognized and acknowledged by the local customs, laws, and decisions of courts, and also subject to the right of the proprietor of a vein or lode to extract and remove his ore therefrom, should the same be found to penetrate or intersect the premises hereby granted, as provided by law.

In testimony whereof I, Grover Cleveland, President of the United States of America,

have caused these letters to be made Patent, and the seal of the GENERAL LAND OFFICE to be hereunto affixed.

Given under my hand, at the CITY OF WASHINGTON, the twentieth day of April, in the year of our Lord one thousand eight hundred and eighty five, and of the Independence of the United States the one hundred and ninth

By the President Grover Cleveland

By M. M. Moran, Secretary.
J. W. McCurt, Recorder of the General Land Office.

RECORDED, Vol. 5, Page 81

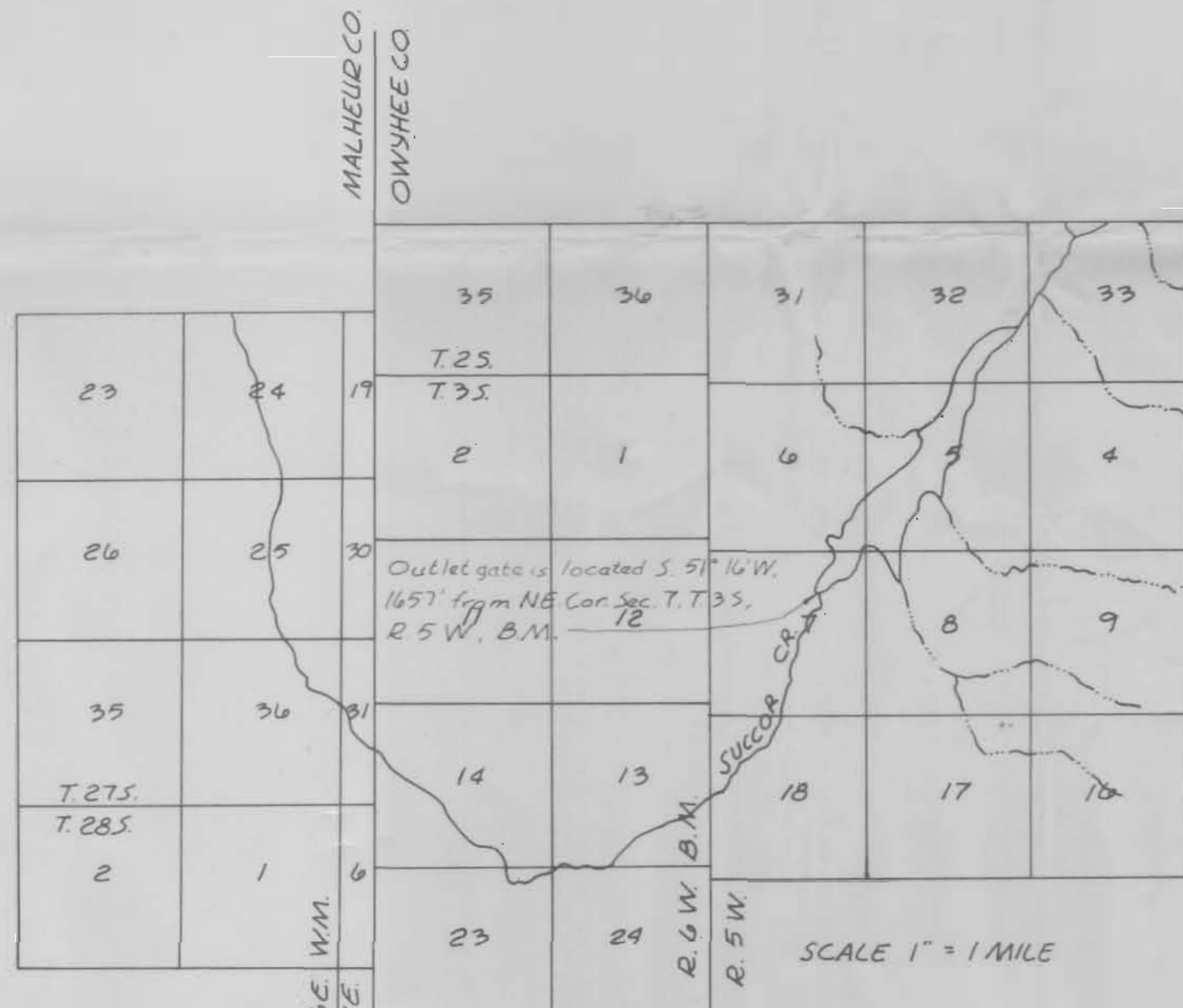
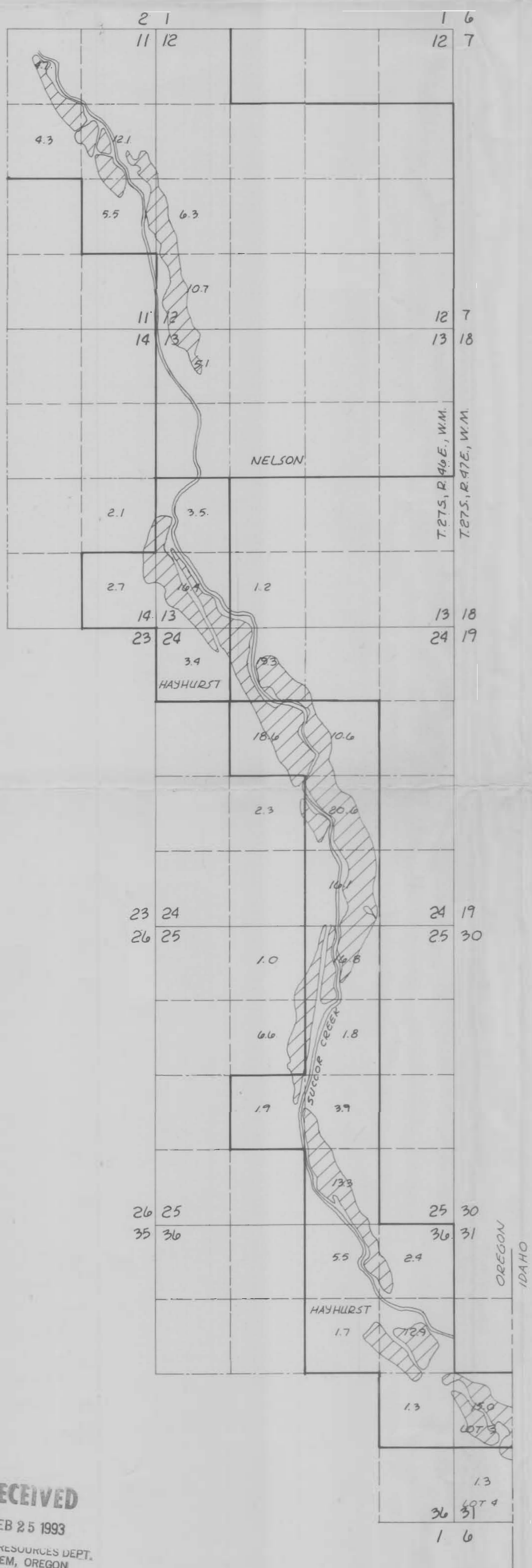
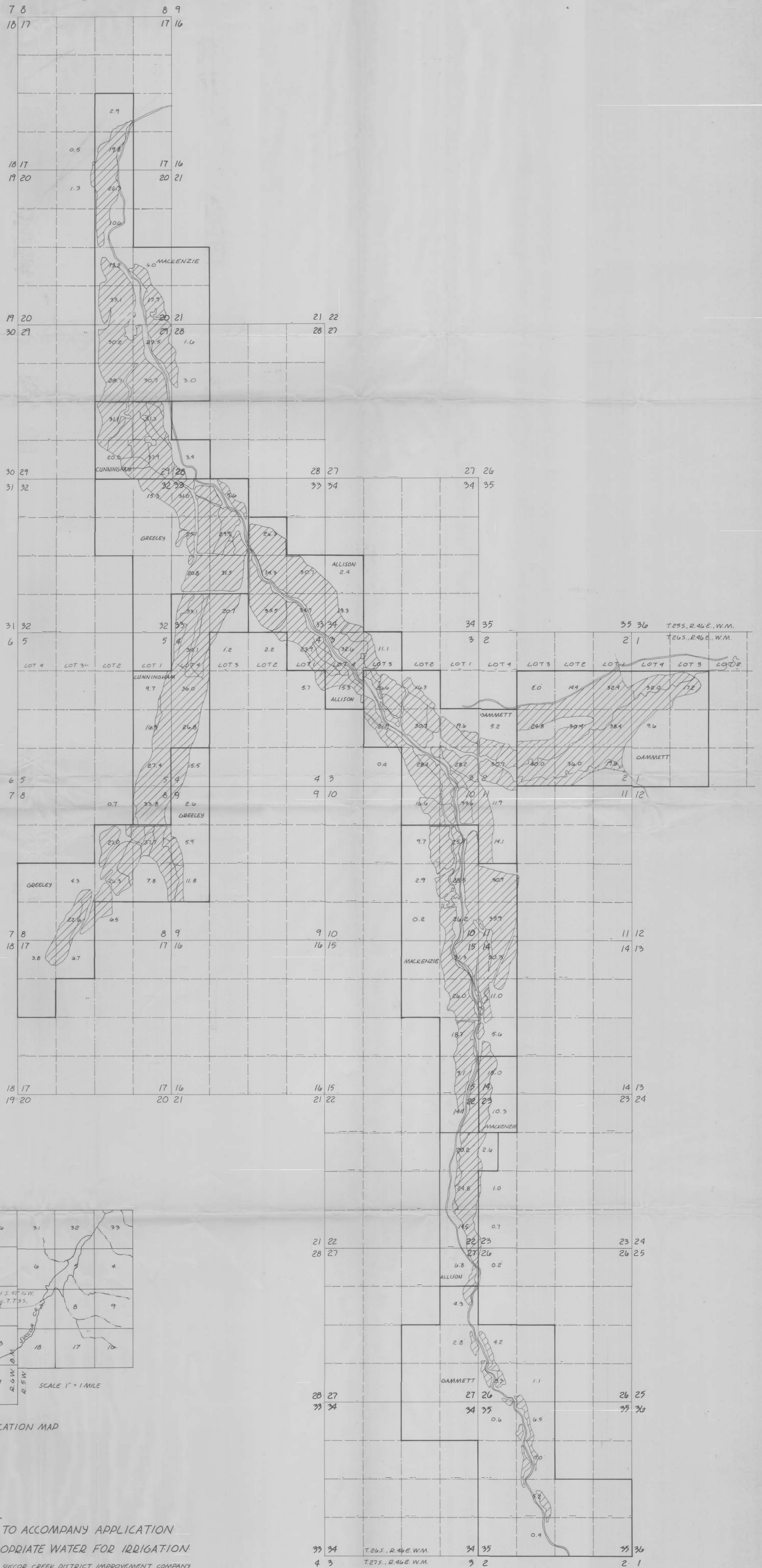
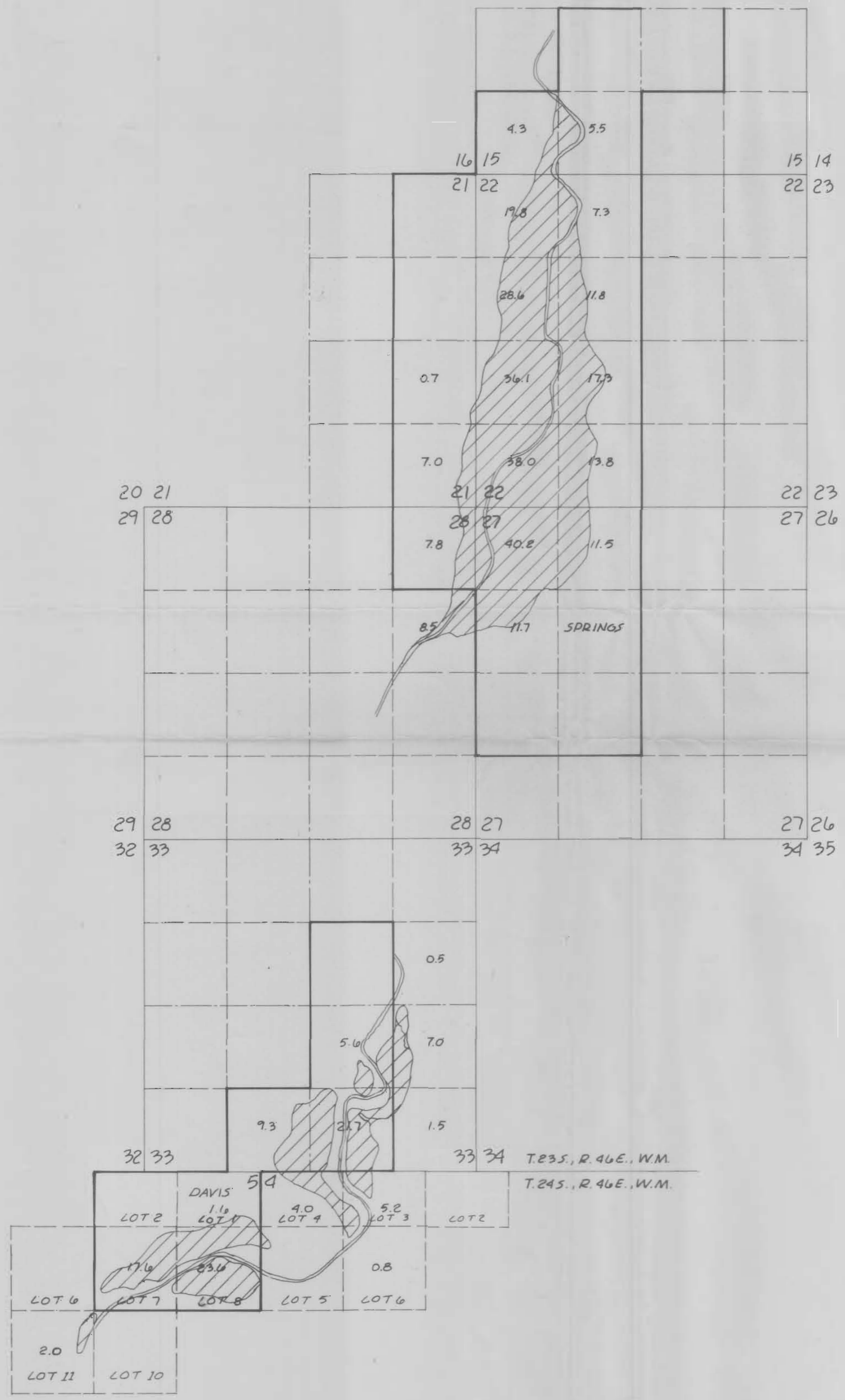

MAP TO ACCOMPANY APPLICATION
TO APPROPRIATE WATER FOR IRRIGATION

APPLICANT: SUCCOR CREEK DISTRICT IMPROVEMENT COMPANY
DRAWN AUGUST, 1975
REVISED MARCH 31, 1976
REVISED SEPTEMBER, 1987
REVISED SEPTEMBER, 1988

RECEIVED
FEB 25 1993
WATER RESOURCES DEPT.
SALEM, OREGON