

SURFACE WATER REGISTRATION CHECKLIST

(received after July 18, 1990)

CHECK BASIN MAP See NAME S. Coast # 17 UNADJUDICATED AREA ? YES
RECEIPT # 95459 S W R NUMBER 249
CHECK ENCLOSURES See PRELIMINARY DATA BASE ENTRY DWP
ACKNOWLEDGEMENT LETTER See ENTER ON STREAM INDEX _____
CHECK QUADRANGLE MAP _____ CHECK GLO PLATS _____
WATERMASTER CHECKLIST _____ PUBLIC NOTICE PUBLICATION See

FORM REVIEW

_____ blanks filled in
_____ signed
_____ date received stamped

MAP REVIEW

#23 ✓ source and trib
✓ diversion point location
_____ conveyances (pipes, ditch, etc.)
✓ place of use
✓ scale
✓ township, range, section
_____ north arrow
✓ CWRE stamp
✓ disclaimer
_____ date survey was performed
#12 ✓ P.O.B. of survey
_____ dimensions and capacity of diversion system
✓ "beneficial use" type title
✓ "permanent-quality" paper
✓ Violations

WATER RIGHT RECORD CHECK _____ FIELD INSPECTION _____
FINAL FILE REVIEW _____ FINAL DATA BASE ENTRY _____
ENTER ON PLAT CARDS _____

December 9, 1993

JAMES F GOSSON
580 S STATE ST
SUTHERLIN OR 97479

RE: SWR-249

Dear Jim,

This will acknowledge the receipt of map to support the pre-1909 vested water right claim in the name of LOWELL OR MARY MEYER you returned with corrections and completions. I have added the map to the file. Thank you for your attention to this matter. If you have any questions, please give me a call.

Sincerely,



Don Knauer
Adjudication Specialist

J:\WAS\C\2\SWR-0249.002



3850 Portland Rd NE
Salem, OR 97310
(503) 378-3739
FAX (503) 378-8130

September 14, 1993

JAMES F. GOSSON
580 S STATE STREET
SUTHERLIN OR 97479-9536

RE: File# SWR-249

DEAR JAMES F. GOSSON,

The Water Resources Department (WRD) received a little over 500 surface water registration statements in December, 1992. All of the files have been set up and receipts for the fees have been sent. The next step is to insure the maps received in support of the claims are acceptable based on Oregon Revised Statutes (ORS) and Oregon Administrative Rules (OAR).

I am returning the map you prepared for Lowell or Mary Meyer. You will find the item which requires completion or correction shown below. I have the description followed by the ORS or OAR site and paraphrased statute or rule.

conveyance ORS 539.120 "...the location of and each ditch, canal, pipeline or other means of conveying the water..." You must show the location, size and type of pipe or other conveyance.

diversion point size OAR 690-28-025-(4)-(c) "The dimensions and capacity of any existing diversion systems."

You must return the map before the claim can be processed. If you cannot have the map to the WRD within 60 days, please inform me as to when it can be expected. Please mark all correspondence with the file number.

As always, if you have any questions, please give me a call.

Sincerely,



Don Knauer
Adjudication Specialist

Enclosures
E:\WP51\SWR\CLAIMANT\2\SWR-0249.00M



3850 Portland Rd NE
Salem, OR 97310
(503) 378-3739
FAX (503) 378-8130

February 18, 1993

LOWELL & MARY MEYER
PO BOX 582
BANDON OR 97411

Dear MR & MRS MEYER,

This will acknowledge that your Surface Water Registration Statement in the name of LOWELL & MARY MEYER has been received by our office. The fees in the amount of \$30.00 have been received and our receipt #95459 is enclosed. Your registration statement has been numbered SWR-249.

Our office will review your form and map in the near future. If necessary we will schedule a meeting with you that will include a site inspection. If there are problems with your form we are usually able to take care of them during our visit. We will be able to answer any questions you might have about the adjudication process at that time.

Please feel free to contact this office if you have any questions.

Sincerely,

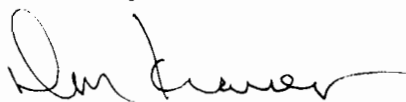

Don Knauer
Adjudication Specialist

Enclosure

C:\WP51\SWR\CLAIMANT\SWR-0249.001



3850 Portland Rd NE
Salem, OR 97310
(503) 378-3739
FAX (503) 378-8130

STATE OF OREGON
WATER RESOURCES DEPARTMENT

RECEIPT # **95459**

3850 PORTLAND ROAD NE
 SALEM, OR 97310
 378-8455/378-8130 (FAX)

RECEIVED FROM: <u>Lowell E. Meyer</u>	APPLICATION
BY: _____	PERMIT
	TRANSFER

CASH: CHECK: # 96455 OTHER: (IDENTIFY) _____

TOTAL REC'D \$ 30.00

01-00-0 WRD MISC CASH ACCT

842.010	ADJUDICATIONS	\$ <u>30.00</u>
831.087	PUBLICATIONS/MAPS	\$
830.650	PARKING FEES Name/month	\$
_____	OTHER: (IDENTIFY)	\$

REDUCTION OF EXPENSE

CASH ACCT.	\$
COST CENTER AND OBJECT CLASS	VOUCHER #

03-00-0 WRD OPERATING ACCT

MISCELLANEOUS:

840.001	COPY FEES	\$
850.200	RESEARCH FEES	\$
880.109	MISC REVENUE: (IDENTIFY)	\$
520.000	OTHER (P-6): (IDENTIFY)	\$

WATER RIGHTS:		EXAM FEE	RECORD FEE
842.001	SURFACE WATER	\$	842.002 \$
842.003	GROUND WATER	\$	842.004 \$
842.005	TRANSFER	\$	842.006 \$
WELL CONSTRUCTION		EXAM FEE	LICENSE FEE
842.022	WELL DRILL CONSTRUCTOR	\$	842.023 \$
842.016	WELL DRILL OPERATOR	\$	842.019 \$
	LANDOWNER'S PERMIT		842.024 \$

06-00-0 WELL CONST START FEE

842.013	WELL CONST START FEE	\$	CARD #
	MONITORING WELLS	\$	CARD #

45-00-0 LOTTERY PROCEEDS

864.000	LOTTERY PROCEEDS	\$
---------	------------------	----

07-00-0 HYDRO ACTIVITY

HYDRO ACTIVITY		LIC NUMBER	
842.011	POWER LICENSE FEE(FWWRD)		\$
842.115	HYDRO LICENSE FEE(FWWRD)		\$
	HYDRO APPLICATION		\$

RECEIPT # **95459** DATED: 12/25/12 BY: C. Engel

Distribution—White Copy-Customer, Yellow Copy-Fiscal, Blue Copy-File, Buff Copy-Fiscal

LOWEL MEYERS PUMP DATA:

1. Pump at pond:

Berkley Pump Model: 1316195
pump: 4" x 3" (6" x 6" plastic pipe)

Baldor Motor 230V/3 phase Catalog No.: JM21??
20 Hp

4 foot lift Basically level to pond

Water pumped to ditch then drains to pond - 6" plastic pipe
under road to pond. Water then pumped from pond to field.

2. Pump at upper pond:

Berkley Pump Model: illegible (same as lower pump)
4" x 3" (6" x 6" plastic pipe)

US Electric Motor 230V/3 phase Id: C528A/T07T151R079F
25 Hp

10 - 12 foot lift. Estimated 40 psi at field.

SURFACE WATER REGISTRATION #249 - MEYER

RECEIVED

DEC - 8, 1961

CAPACITY OF THE DELIVERY SYSTEM

WATER RESOURCES DEPT
SALEM, OREGON

DELIVERY SYSTEM
POINT OF DIVERSION TO SUMP

$H_{ELEVATION} = 4 \text{ FEET}$

$H_{PRESSURE} = 2 \text{ PSI (ESTIMATED)} = 5 \text{ FEET}$

$H_{FRICTION} = 2 \text{ FT./100 FT. (ESTIMATED)} = (2)(9) = 18 \text{ FEET}$

$HP = 20$

$$Q_{PUMP} = \frac{(6.61)(20)}{4+5+18} = \frac{132.2}{27} = 4.9 \text{ cfs}$$

$Q_{PUMP} > Q_{CLAIM} \text{ O.K.}$

DELIVERY SYSTEM
SUMP TO PLACE OF USE

$H_{ELEVATION} = 12 \text{ FEET}$

$H_{PRESSURE} = 40 \text{ PSI} = 92 \text{ FEET}$

$H_{FRICTION} = 4 \text{ FT./100 FT.} = 4 \times 5 = 20 \text{ FEET}$

$$Q_{PUMP} = \frac{(6.61)(25)}{12+92+20} = \frac{165.25}{124} = 1.33 \text{ cfs}$$

$Q_{PUMP} > Q_{CLAIM} \text{ O.K.}$

JAMES F. GOSSON Consulting Engineer

CIVIL ENGINEER
LAND SURVEYOR
WATER RIGHTS EXAMINER

DEC - 2 1993

WATER RESOURCES DEPT.
SALEM, OREGON

580 South State Street
Sutherlin, Oregon 97479

(503) 459-2243

Oregon Water Resources Department
3850 Portland Road, N.E.
Salem, Oregon 97310

Attention: Don Knauer

Re: SWR-249-Meyer

Dear Mr. Knauer,

In response to your letter of September 14, 1993, enclosed is a corrected map showing the locations of the delivery system and calculations identifying the capacity of the delivery system.

Please contact me if you need additional information.

Very truly yours,

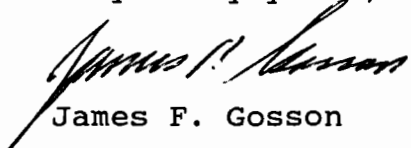
James F. Gosson

Enclosures

JFG/p

REGISTRATION STATEMENT MAP
PRE-1909 VESTED WATER RIGHT CLAIM
IN THE NAME OF LOWELL OR MARY MEYER
SECTION 12, T 29 S, R 15 W, W.M.

RECEIVED

DEC 28 1992
 WATER RESOURCES DEPT.
 SALEM, OREGON

1908 - 1992

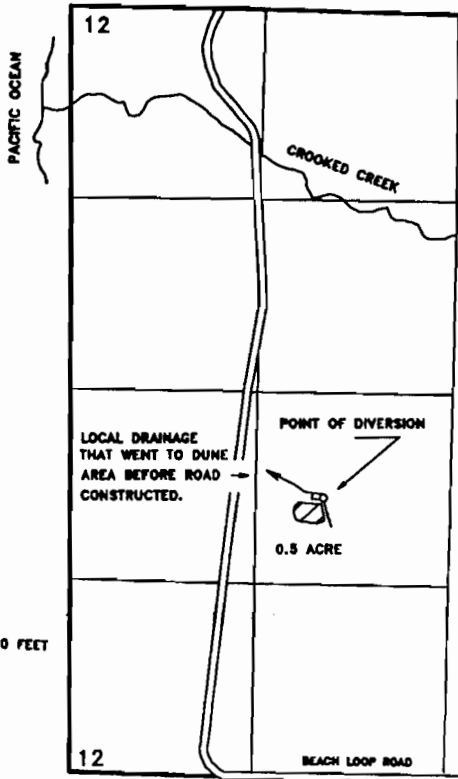

1992 - FUTURE

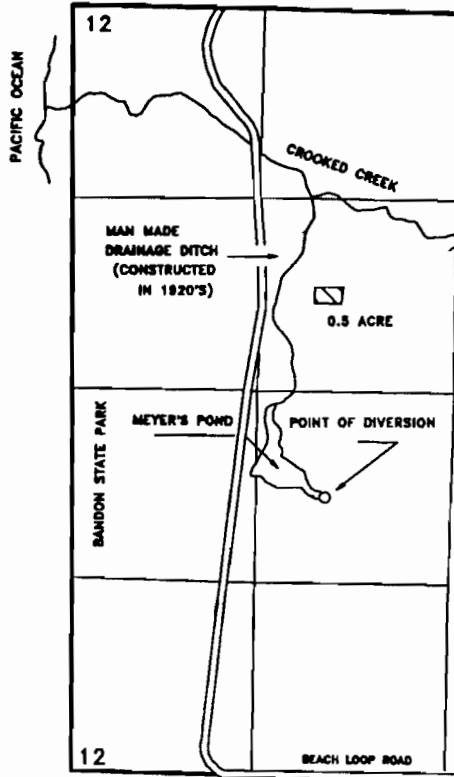

PIPE - DIRT?
SIZES
? AW PT?

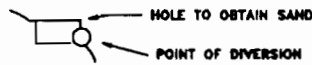

THE POINT OF DIVERSION IN 1908 AND CURRENTLY IS LOCATED 1900 FEET NORTH AND 1710 FEET EAST FROM THE SOUTHWEST CORNER OF SECTION 12, BEING WITHIN THE NE¼SW¼ OF SECTION 12, TOWNSHIP 29 SOUTH, RANGE 15 WEST, W.M., IN COOS COUNTY.

NOTE: THE ORIGINAL BOG WAS FARMED UNTIL 1992 WHEN IT BECAME NECESSARY TO MOVE THE BOG AS SHOWN ON THE MAP.

THE PURPOSE OF THIS MAP IS TO IDENTIFY THE LOCATION OF THE WATER RIGHT. IT IS NOT INTENDED TO PROVIDE INFORMATION RELATIVE TO THE LOCATION OF PROPERTY OWNERSHIP BOUNDARY LINES.

Certified Water Right Examiner
 #054 WRE
James F. Gosson
 James F. Gosson
 Nov. 19 1987
 STATE OF OREGON

CIVIL ENGINEER
LAND SURVEYOR
WATER RIGHTS EXAMINER

(503) 459-2243

December 22, 1992

RECEIVED

DEC 28 1992

Lowell Meyer
P. O. Box 582
Bandon, Oregon 97411

WATER RIGHTS DEPT.
SALEM, OREGON

Dear Lowell:

Please find enclosed the PRE-1909 VESTED WATER RIGHT CLAIM form, and mylar map. Before submitting the material to the Oregon Water Resources Department you will need to complete the following:

1. Obtain a copy of the legal description of the property upon which the irrigation occurred.
2. Sign the form before a notary public
3. Add any supportive material you might have to accompany the claim.

I understand you will deliver the material to the Department in Salem next week. As John discussed on the phone with you, please send over the pump and delivery system material to us so we can compute the capacity of your existing system. When you deliver the material to Don Knauer, you can tell him the capacity calculations will follow.

Please contact either John or me if you have any questions.

Yours truly,

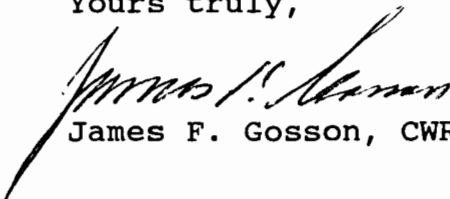
James F. Gosson, CWRE

Township	Range	Section	town Lot	Area Nu.
29 S	15 W	12 C	100 -	12366.06
29 S	15 W	12	204 -	12366.90
29 S	15 W	12	200	12346.00
29 S	15 W	12	200	

C-1
File in 29-14

MAP

MAP-C

Twp. 29 S. E. 15 W. W.M.
COOS COUNTY, OREGON.

Twp. 29 S. R. 14 W. W.M.
COOS COUNTY, OREGON.

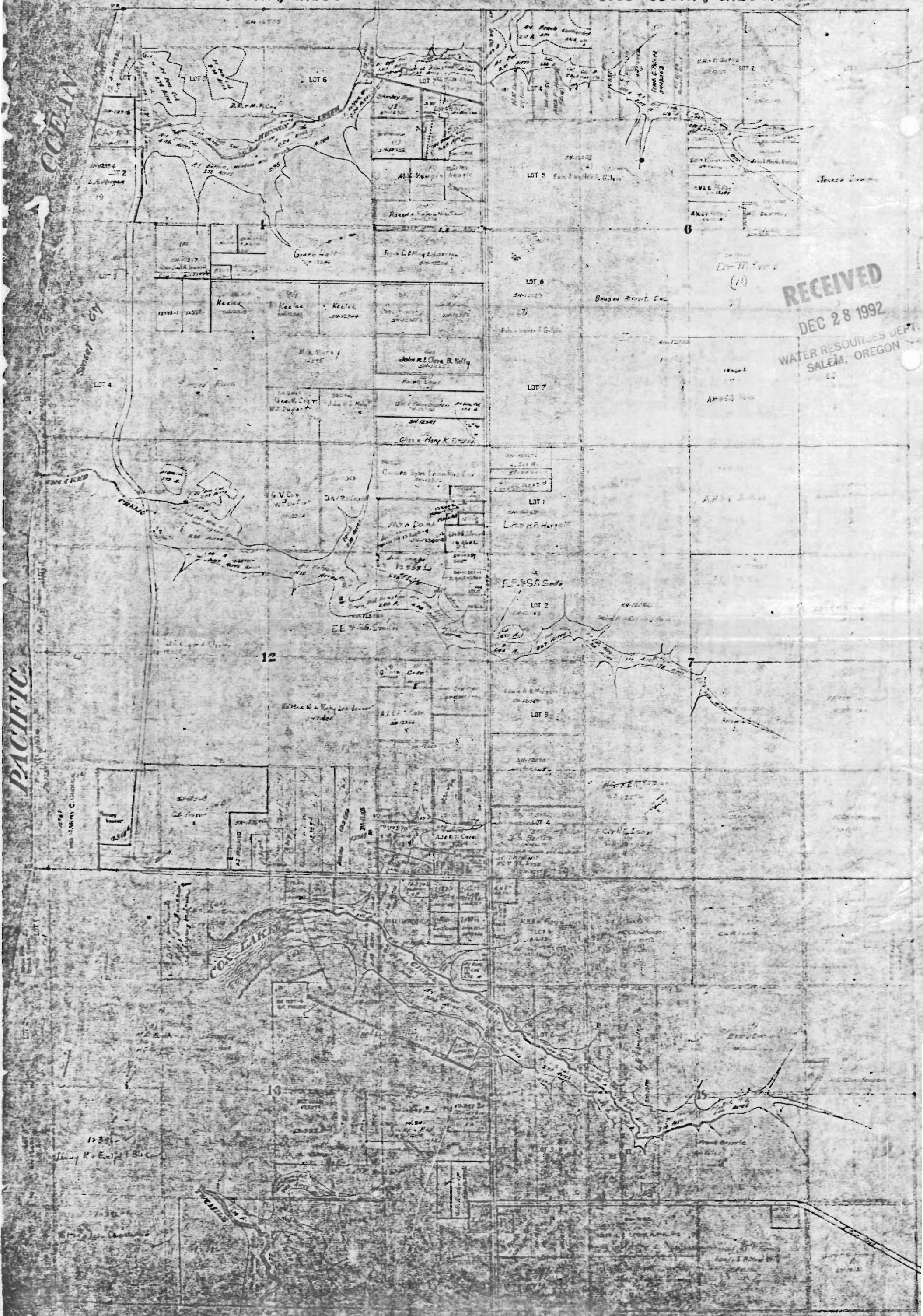

RECEIVED
 DEC 28 1992
 WATER RESOURCES DEPT.
 SALEM, OREGON

PACIFIC

R-72118
S-72119

SELANDER MAP K.E.S