

APR - 6 1995

WATER RESOURCES DEPT.
SALEM, OREGON

R. IMRIE CONN
885 FLOURNOY VALLEY ROAD
ROSEBURG, OREGON 97470

MARCH 30, 1995

OREGON WATER RESOURCES DEPT.
ADJUDICATION SECTION
3850 PORTLAND RD. N.E.
SALEM, OREGON 97310

ATT: DON KNAUER RE: CONTINUED USE OF PRE-1909 VESTED
WATER RIGHT CLAIM - SWR# 253,254&255.

THANK YOU VERY MUCH FOR OUR TELEPHONE CONVERSATION WHEN YOU RETURNED MY CALL A FEW DAYS PAST, AND YOUR EXPLANATION FOR THE CONTINUED USE OF WATER PRE-1909 VESTED WATER RIGHT CLAIM WITHOUT ANY OTHER ACTION PER SURFACE WATER REGISTRATION STATEMENTS VERIFIED AS COMPLETE IN YOUR OFFICE FOR SWR# 253, #254 & #255.

IT IS MY FURTHER UNDERSTANDING FROM YOU THAT THE FINAL STAGE FOR ALL SUCH WATER PRE-1909 VESTED WATER RIGHT CLAIMS AS VERIFIED AND COMPLETE IN YOUR OFFICE WILL BE THROUGH COURT ACTION. IN THE MEANTIME PROPERTIES MAY CONTINUE USE OF WATER WITHOUT ANY FURTHER ACTION.

TO AVOID ANY POSSIBLE CONFUSION, WOULD YOU PLEASE IDENTIFY AND ACKNOWLEDGE THE TWO ATTACHED LOCATIONS WITH SWR# 253 AND MAIL BACK ONE COPY TO ME AT 885 FLOURNOY VALLEY ROAD, ROSEBURG, OREGON 97470 AND RETAIN THE OTHER FOR THE FILE. SHOULD YOU FIND ANY DISCREPANCY FROM THE FILE SWR# 253 ON THE ATTACHED LOCATION, PLEASE MAIL A COPY OF THE LOCATION SURVEY FROM THE FILE SWR# 253 WITH SOME TYPE OF ACKNOWLEDGMENT FROM YOUR OFFICE. THANK YOU VERY MUCH FOR YOUR TIME AND EFFORT.

SINCERELY,

R. IMRIE CONN

ENC: TWO LOCATIONS SWR# 253.

P.S. ALSO, IT WOULD BE GREATLY APPRECIATED FOR COPIES OF LOCATION SURVEYS FOR SWR# 254 & 255 WITH SOME TYPE OF ACKNOWLEDGMENT FROM YOUR OFFICE. THANKS.

T.27 S., R.6 W., W.M.

APR - 4 1995
 WATER RESOURCE DEPT.
 SALEM, OREGON

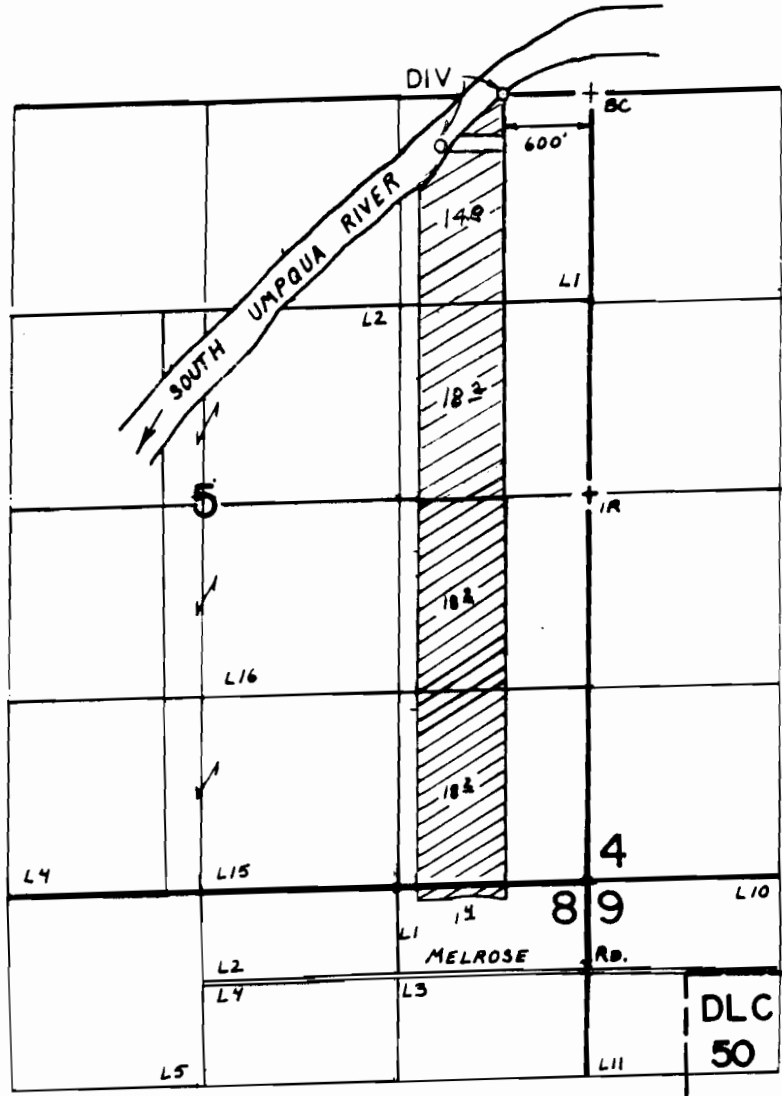

Hash marked location of
 STATE OF OREGON SWR# 253,
 Adjudication Section,
 Oregon Water Resource Dept.
 3850 Portland Road N.E.,
 SALEM, OREGON 97310 for
 70 acres not to exceed
 2.5 acre feet per yearly
 growing season from the
 SOUTH UMPQUA RIVER.

(M & B), Sec. 5 & 8,
 T.27 S., R.6 W., W.M.

2153 Melrose Road,
 Roseburg, Or. 97470,
 DOUGLAS COUNTY

SCALE: 4" = 1 mile

SWR#253

DOUGLAS COUNTY, OREGON

T.27 S., R.6 W., W.M.

APP - 1995

WATER RESOURCES DEPT.
SALEM, OREGON

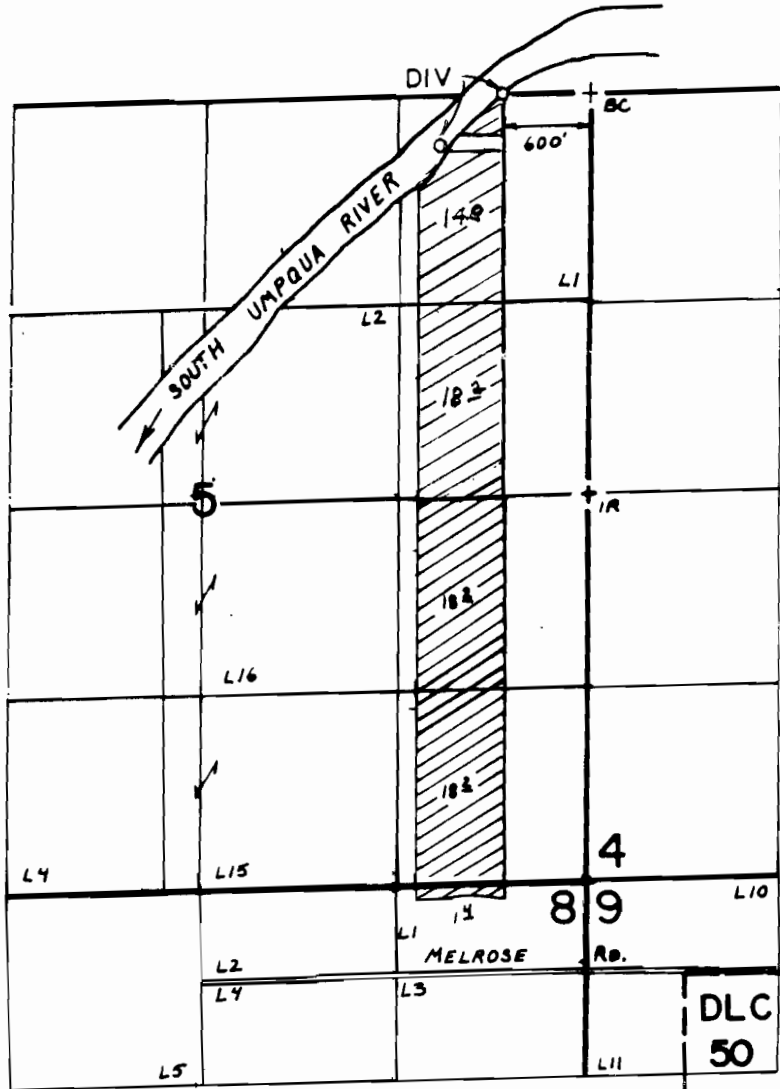

Hash marked location of
STATE OF OREGON SWR# 253,
Adjudication Section,
Oregon Water Resource Dept.
3850 Portland Road N.E.,
SALEM, OREGON 97310 for
70 acres not to exceed
2.5 acre feet per yearly
growing season from the
SOUTH UMPQUA RIVER.

(M & B), Sec. 5 & 8,
T.27 S., R.6 W., W.M.

2153 Melrose Road,
Roseburg, Or. 97470,
DOUGLAS COUNTY

SCALE: 4" = 1 mile

SWR#253

DOUGLAS COUNTY, OREGON

September 16, 1993

WATER
RESOURCES
DEPARTMENT

DUANE W. KIRBY
8087 LOOKINGGLASS ROAD
ROSEBURG OR 97470

RECEIVED

NOV - 2 1993

WATER RESOURCES DEPT.
SALEM, OREGON

RE: File# **SWR-253**

DEAR DUANE W. KIRBY,

The Water Resources Department (WRD) received a little over 500 surface water registration statements in December, 1992. All of the files have been set up and receipts for the fees have been sent. The next step is to insure the maps received in support of the claims are acceptable based on Oregon Revised Statutes (ORS) and Oregon Administrative Rules (OAR).

I am returning the map you prepared for R. Imrie Conn. You will find the item which requires completion or correction shown below. I have the description followed by the ORS or OAR site and paraphrased statute or rule.

conveyance ORS 539.120 "...the location of and each ditch, canal, pipeline
or other means of conveying the water..."

You must return the map before the claim can be processed. If you cannot have the map to the WRD within 60 days, please inform me as to when it can be expected. Please mark all correspondence with the file number.

As always, if you have any questions, please give me a call.

10-31-93

Sincerely,



Don Knauer
Adjudication Specialist

Don Knauer
Here is the corrected
map per your request
D.W. Kirby

Enclosures

J:\WP51\SWR\CLAIMANT\2\SWR-0253.00M



3850 Portland Rd NE
Salem, OR 97310
(503) 378-3739
FAX (503) 378-8130

RECEIVED

OCT - 6 1993

**WATER RESOURCES DEPT.
SALEM, OREGON**

R. IMRIE CONN
885 FLOURNOY VALLEY ROAD
ROSEBURG, OREGON 97470

SEPTEMBER 27, 1993

DON KNAUER
ADJUDICATION SPECIALIST
STATE OF OREGON
WATER RESOURCES DEPARTMENT
3850 PORTLAND RD. NE
SALEM, OREGON 97310

DEAR MR. KNAUER: RE: SWR-253, YOUR LETTERS SEPT. 15 & 16, '93.

THANK YOU FOR YOUR LETTER OF SEPT. 16, 1993 WITH ATTACHMENT OF A COPY OF DEED FOR WILLIAM A. IMRIE WHICH IS ALMOST NON LEGIBLE. WE APOLOGIZE FOR THIS DOCUMENT. IT REALLY IS DIFFICULT TO OBTAIN A GOOD COPY OF SOME OF THE OLDER DOCUMENTS.

HOWEVER IN THE INTEREST OF TIME WE ARE ATTACHING ANOTHER COPY FROM THE DOUGLAS COUNTY DOCUMENTS. IT IS NOT OF THE BEST, BUT IT IS BETTER THAN THE ONE ATTACHED TO YOUR LETTER OF SEPT. 16, 1993. SHOULD YOU NEED A CLEARER COPY PLEASE LET US KNOW AND WE WILL ENDEAVOR TO OBTAIN A WRITTEN CERTIFIED COPY OF THIS DOCUMENT. THANK YOU FOR YOUR ASSISTANCE IN THIS MATTER.

SINCERELY YOURS,

R. IMRIE CONN

ATT: DEED 15 FEB., 1909
WILLIAM A. IMRIE

This Indenture Witnesseth, That James W Hamilton

and Ollie I Hamilton, his wife

XXXXXX consideration of the sum of

Seven Thousand two hundred and fifty

DOLLARS

to them paid, have bargained and sold and by these presents do bargain, sell and convey unto

William A Imrie

the following described premises, to-wit:

Commencing at the NW corner of the East half of the D L C of A B Colver, in Section 11 Tp 27 S R 7 West in Douglas County, Oregon, thence running south one hundred and eighty six (186) rods to the North boundary of the D L C of F White, thence East one hundred and three and one third rods (103 1/3) thence north one hundred and eighty six rods (186) and thence west one hundred and three and one third rods to the place of beginning, and containing one hundred and twenty acres (120) more or less; Also the E 1/2 of the SW 1/4 and the NW 1/4 of the NE 1/4 of Section 14 Tp 27 S R 7 West and containing one hundred and twenty (120) acres; Also the SE 1/4 of the SW 1/4 and the SW 1/4 of the SE 1/4 of Section 11 Tp 27 S R 7 West of Willamette Meridian, containing eighty (80) acres more or less, there being in the aggregate 320 acres all lying and being situate in Douglas County, Oregon, save and excepting from the above described land that certain roadway conveyed to Douglas County, Oregon, and found of record in volume 61 page 95 of the Deed Records of Douglas County, Oregon.

RECEIVED

OCT - 6 1993

WATER RESOURCES DEPT SALEM, OREGON

TO HAVE AND TO HOLD the said premises with their appurtenances unto the said

William A Imrie, his heirs and assigns forever.

And the said James W Hamilton and Ollie I Hamilton

do hereby covenant to and with the said William A Imrie

his heirs and assigns, that they are the owner in fee simple of said premises, that they are free from all incumbrances,

and that they will warrant and defend the same from all lawful claims whatsoever.

IN WITNESS WHEREOF, we have hereunto set our hand and seals this 15th day of February A. D. 1909

Done in the Presence of

Elbert B Hermann

Andrew R Marker,

James W Hamilton

Ollie I Hamilton

(INITIAL)

(INITIAL)

(INITIAL)

CLAIM OF BENEFICIAL USE AND SITE REPORT

INFORMATION:

R. Imrie Conn
885 Flournoy Valley Rd.
Roseburg, Oregon 97470
(503) 673-6999

SOURCE(S):

South Umpqua River

DIVERSION
POINTS:

one

MOTOR:

Brand, unknown

type, Electric

HP, 40

Max. RPM's

PUMP:

Brand, unknown

type, centrifugal

intake/discharge dia | 6"/6"

size of pulleys.

PIPE: 6" Aluminum
3' dia. wheel,

HEADS: Rain Bird ^{30H.} 5/32 with 3/32
Nelson F33 9/64 with 3/32

USE(S): Irrigation

LIFT: From River to pump 12'
From pump to Ground 0'

SURVEY TIE: Field tie to property line
Assessor map T27S R6W section 5 & 8

SPECIAL
CONDITIONS: This system is a 3' dia wheel
REMARKS: with 6" main line.

The final proof survey and inspection of the use as found to be completed under the terms and conditions of Registration statement was completed by me on 1-18-93, and the facts contained in this report and accompanying final proof map are correct to the best of my knowledge.



I, R. Imrie Conn agree to the findings of the CWRE and do submit this site report and map as my Claim of Beneficial Use of the water as provided under the terms and conditions of my Registration statement

Imrie Conn

FINAL PROOF CALCULATIONS

Given Data: Duty of water = $\frac{1}{80}$ th cfs per acre
 Acres allowed as irrigated = 66.6
 operating pressure = ?

Pump 40 HP
 suction lift 12'
 discharge lift 0'
 heads Rainbird 30H 5/32 with 3/32 61
 Nelson F33 9/64 with 3/32 61

Assume 40 PSI

$$Q_{\text{pump}} = \frac{6.61 \times 40}{12 + 101.6} = 2.3275 \text{ cfs}$$

$$Q_{\text{heads}} = \frac{(61)(6.1) + (61)(5.2)}{449} = 1.5352 \text{ cfs}$$

the duty of water is $\frac{1}{80}$ th of one cfs per acre
 since 66.6 acres were found to have been
 beneficially irrigated, the maximum Q is $\frac{66.6}{80} = 0.8325 \text{ cfs}$.

since the system is delivering more than the full
 duty amount, the Q allowed on the final water
 right certificate will be limited by 0.8325 cfs.

Dunew. Kuly

T. 27S., R. 6 W., W.M.

SCALE: 1" = 1320'

REGISTRATION STATEMENT MAP

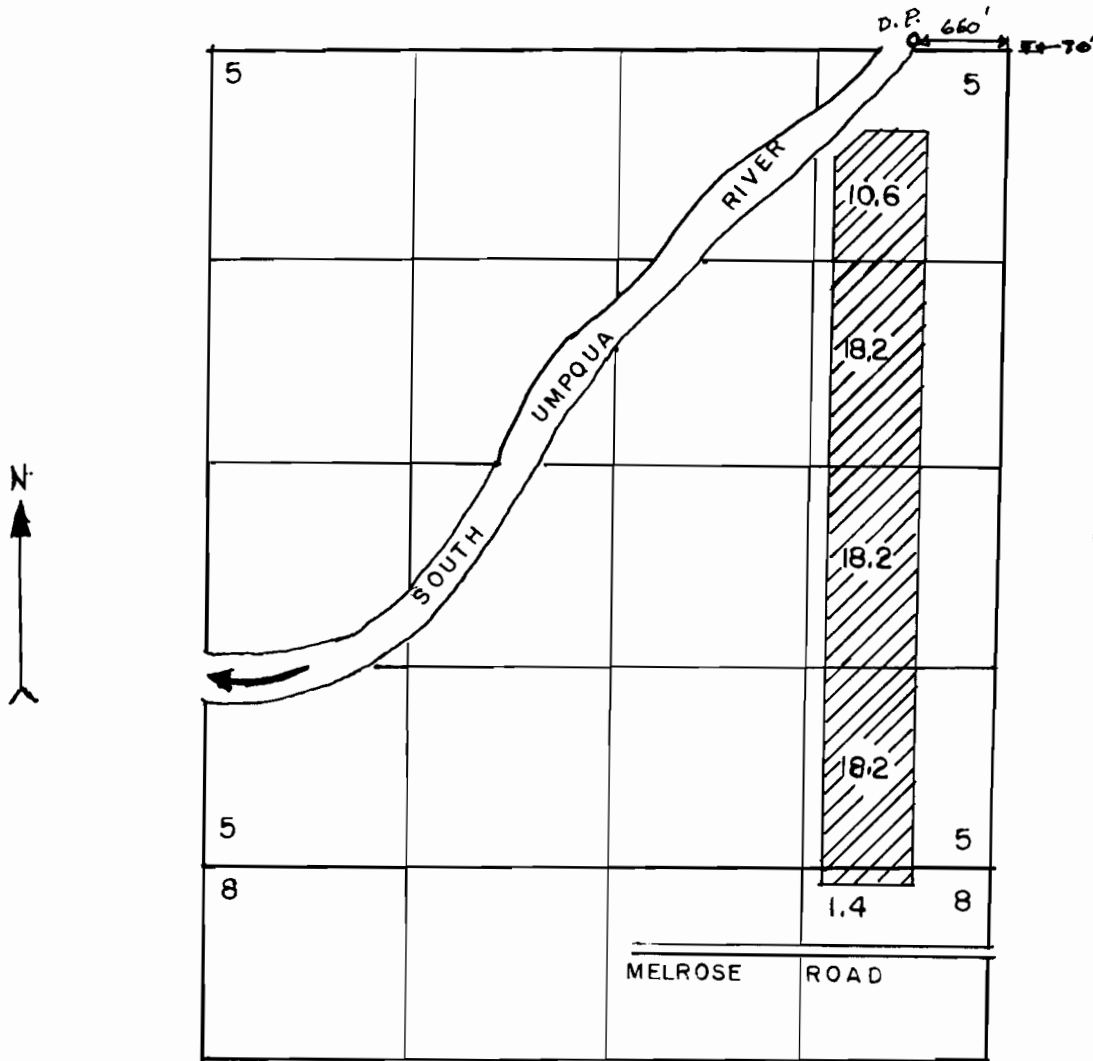

6" MAIN LINE
3" WHEEL LINE

THE PURPOSE OF THIS MAP IS TO IDENTIFY THE LOCATION OF THE WATER RIGHT. IT IS NOT INTENDED TO PROVIDE INFORMATION RELATIVE TO THE LOCATION OF PROPERTY OWNERSHIP BOUNDARY LINES.

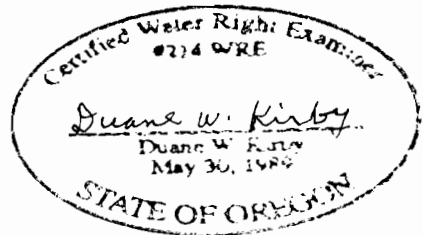

UNDER

IN NAME OF
R. IMRIE CONN

Surveyed JAN. 18 1993, by DUANE KIRBY

SWR-255

R. IMRIE CONN
885 FLOURNOY VALLEY RD.
ROSEBURG, OR. 97470

6887

JAN 26 1993

DECEMBER 30, 1992

STATE OF OREGON
WATER RESOURCE DEPT.
3850 PORTLAND RD. N.E.
SALEM, OR. 97310

WATER RESOURCE DEPT.
SALEM, OREGON

GENTLEMEN: RE: PRE-1909 VESTED WATER RIGHT, T.27 S., R. 6 W.,
W.M., SECTIONS 5 & 8.

AS REGARDS TO THE SAID REGISTRATION STATEMENT FOR THE ABOVE,
FROM MY OWN PERSONAL KNOWLEDGE I CAN MAKE THE FOLLOWING
REFLECTIONS:

PRIOR TO MY 8TH BIRTHDAY, AUG. 11, 1924, I ASSISTED MY
FATHER, HENRY ROSCOE CONN, TO HAUL WATER FOR IRRIGATION FROM
THE SOUTH UMPQUA RIVER, TRIBUTARY TO UMPQUA RIVER WHICH
DISCHARGES INTO THE PACIFIC OCEAN. A WAGON WITH GRAVEL BED
CONTAINED 55 GAL. DRUMS WITH THE TOPS REMOVED. THE TWO HORSE
TEAM AND WAGON WERE DRIVEN INTO A SPOT IN THE RIVER WHERE THE
WATER JUST CAME UP TO THE FLOOR OF THE BED OF THE GRAVEL
WAGON, AND BUCKETS OF WATER FROM THE SOUTH UMPQUA RIVER WERE
USED TO FILL THE BARRELS. AFTER FILLING THE BARRELS WITH
WATER, BURLAP SACKS WERE STRETCHED OVER THE TOP OF THE
BARRELS AND AN IRON BARREL MIDDLE HOOP WAS SECURED OVER THE
TOP OF THE BURLAP SACKS. THIS TOP OF BARRELS COVER REDUCED
SPILLAGE OF WATER FROM THE BARRELS UPON PULLING THE WAGON TO
SHORE FROM THE RIVER AND HAULING TO A 40 ACRE PLANTING OF
CAULIFLOWER NEAR THE SOUTHERN PORTION OF THE PROPERTY IN THIS
APPLICATION AS REFERENCED ABOVE.

TWO ITEMS OF INTEREST AND AS INFORMATION, ONLY: 1. ON MY
FIRST HAULING OF WATER BY MYSELF, I DROVE THE HORSE TEAM AND
GRAVEL BED WAGON INTO A DEEPER HOLE IN THE SOUTH UMPQUA RIVER.
MY PURPOSE WAS TO MAKE SHORTER LIFTS OF BUCKETS OF WATER TO
FILL THE BARRELS. TO MY SURPRISE, ALL EMPTY BARRELS STARTED
TO FLOAT AND TURN OVER. I HAD TO WRESTLE THE BARRELS SO THEY
WOULD NOT FLOAT OUT OF THE GRAVEL WAGON BED OF APPROXIMATELY
12 INCH HEIGHT AND GO DOWN STREAM IN THE RIVER. FINALLY
HOLDING BARRELS TOGETHER, I PLACED ONE BARREL UPRIGHT AND
FILLED IT WITH ENOUGH WATER TO STAND AND SO ON UNTIL ALL
BARRELS WERE BACK IN ORDER. ON MY NEXT TRIP, I DROVE THE
HORSE TEAM AND WAGON TO THE SPOT MY FATHER HAD INDICATED.

2. THE CAULIFLOWER CROP WAS CONSIDERED THE MOST BOUNTIFUL AS
EVER GROWN IN THE UMPQUA VALLEY. MID DECEMBER, AN INSPECTION
OF THE WHOLE CAULIFLOWER FIELD WAS MADE AND A DECISION THAT
HARVESTING COULD START WITHIN ABOUT 10 DAYS. THAT NIGHT
REGISTERED THE COLDEST NIGHT KNOWN TO THIS AREA. BY MID DAY
THERE WASN'T A SINGLE HEAD OF CAULIFLOWER WITH LEAVES AS THEY
WERE ALL FROZEN AND DROOPED TO THE GROUND. NOT A SINGLE HEAD

OF CAULIFLOWER WAS EVER HARVESTED FROM THIS PLANTING. PRIOR TO THE SEVERE FREEZE, THE PLANTS WERE MORE THAN 4 1/2 FEET HIGH WITH BEAUTIFUL AND PERFECT HEADS OF CAULIFLOWER FORMING.

FOR A FEW YEARS, IRRIGATION CONTINUED AS DESCRIBED HEREIN UNTIL A TRACTOR WITH A PULLEY WAS USED TO RUN A PUMP FROM THE SOUTH UMPQUA RIVER TO AN IRRIGATION SYSTEM THAT COULD BE MOVED FROM FIELD TO FIELD. VARIOUS METHODS WERE ADOPTED UNTIL THE PRESENT ELABORATE SYSTEM OF OVERHEAD SPRINKLERS TO COVER THE WHOLE AREA IN THIS APPLICATION, AS REFERENCED HEREIN UNDER PERMIT #45253 AND WITH SUPPLEMENTAL AGREEMENT (COLLINS) DATED 7/89.

MY FATHER, HENRY ROSCOE CONN, WHO WAS BORN IN OREGON DECEMBER 31, 1888, INFORMED ME THAT THE CONN FAMILY IMMIGRATED TO OREGON IN 1853-1854. HE EXPLAINED TO ME THAT HIS UNCLE, NORCISSA CONN, WHO WAS BORN IN OREGON IN 1864 DID IRRIGATION AS DESCRIBED HEREIN, PLUS SOME DITCH DIVERSION AND OTHER USES, BACK TO AND BEFORE THE BEGINNING OF THE CENTURY. HE ALSO TOLD ME THAT HENRY CONN, MY GRANDFATHER, WHO WAS BORN IN 1842 IN INDIANA AND WAS THE SON OF HENRY CONN (SR.), MY GTREAT-GRANDFATHER, WHO DIED IN 1896 IN OREGON HAD ACQUIRED THE WM.MCKINNEY DONATION LAND CLAIM #50 ON 21 NOVEMBER, 1864.

THE SOUTHERLY SIDE OF THE SOUTH UMPQUA RIVER FROM NEAR "ROCKY POINT" TO THE SCOTT PROPERTY WHERE THE MELROSE SCHOOL IS LOCATED, EXCEPTING THE BUSENBARK RANCH, WAS OWNED BY THE CONN FAMILY DATING BACK TO THE EIGHTEEN HUNDREDS AND INCLUDED THE WM. MCKINNEY D.L.C.#50, PURCHASED BY HENRY CONN (SR). 21 NOVEMBER, 1864. ALL OF THIS PROPERTY WAS USED FOR CROPS WITH IRRIGATION, LIVESTOCK OF HORSES, CATTLE, SHEEP, HOGS AND TURKEYS. GENERALLY, WELLS WERE DUG FOR DOMESTIC USE. ANY PROPERTY WITHIN THE ABOVE AREA IS ENTITLED TO PRE 1909 WATER RIGHTS. THE FIRST BREAK-UP OF THIS TOTAL PROPERTY OF HENRY CONN (SR.) WENT TO SONS: HENRY CONN, MY GRANDFATHER; VIRGIL CONN; HARMON CONN; AND NORCISSA CONN. VARIOUS OTHER DIVISIONS HAVE SINCE BEEN MADE WITH MANY IN THE CONN FAMILY.

TO THE BEST OF MY KNOWLEDGE AND BELIEF THE FOREGOING IS A TRUE AND ACCURATE RESUME AND CERTIFIED HERETO, AND USES HAVE CONTINUED SINCE THE DATES LISTED IN THIS APPLICATION.



R. IMRIE CONN
(ROSCOE I. CONN)
OFFICER - 0-378086

STATE OF OREGON
COUNTY OF DOUGLAS

CERTIFICATE OF WATER RIGHT

RECEIVED

DEC 28 1992

WATER RESOURCES DEPT.
SALEM, OREGON

THIS CERTIFICATE ISSUED TO

LAURANCES'S GARDENS
HC 1, BOX 45
CANTONVILLE, OREGON 97417

Right to use the waters of SOUTH UMPQUA RIVER, a
tributary of UMPQUA RIVER for the purpose of IRRIGATING 37.8 ACRES.

The right has been granted under Permit 45253. The date of
priority is JULY 11, 1989. The right is limited to not more than 0.47
CUBIC FOOT PER SECOND, or its equivalent in case of rotation, measured
at the point of diversion from the source.

The point of diversion is located as follows:

LOT 1 (NE 1/4 NE 1/4), SECTION 5, T 27 S, R 6 W, W.M.; 600
FEET WEST FROM NE CORNER SECTION 5

The amount of water used for irrigation together with the amount
used under any other right existing for the same lands, shall be
limited to ONE-EIGHTIETH of one cubic foot per second per acre, or its
equivalent for each acre irrigated and shall be further limited to a
rotation of not to exceed 2.5 acre-feet per acre for each acre
irrigated during the irrigation season of each year.

The right shall conform to the reasonable rotation system as may be
ordered by the proper state authority.

Description of the place of use under the right, and to which such
right is appurtenant, is as follows:

NE 1/4 SE 1/4 18.2 ACRES
SE 1/4 SW 1/4 18.2 ACRES
SECTION 5

NE 1/4 NE 1/4 1.4 ACRES
SECTION 8
TOWNSHIP 27 SOUTH, RANGE 6 WEST, W.M.

The right to the use of the water for the above purpose is restricted
to beneficial use on the lands or place of use described. The right
is subject to minimum flows established by the Water Resources
Commission with an effective date prior to this right.

WITNESS the signature of the Water Resources Director,
dated this date JULY 21, 1989.

/s/ WILLIAM H. YOUNG
Water Resources Director

CONTEMPO REALTY

Richard

11-18-92

① Note of ownership of
NARCISSSE COWN as
recorded? 189? This
date on H.C.

② H2O use May 5, two years
on H.C.



SUSAN FAGIN
Realtor

3. CWRE Map is attached
and may just be summarized
and signed by CWRE or redone?
A list of Roseburg CWRE included.

4. Your notarized signature
required and mail to Salem
per instructions. Father

212 SW = ... LAND, OREGON
111 SO. TENTH ST., TACOMA, WASHINGTON

TOWNSHIP 27 S., RANGE 6 W. W.M.

DOUGLAS COUNTY, OREGON

SCALE 2 IN. = 1 MILE

OCT. 1954



INFORMATION ONLY

RECEIVED
STATE 1999
RESOURCES DEPT.
OREGON
W. MARKS

88

65

32

MELROSE

Champagne
EDGAR RAINVILLE

6

8

18

17

16

19

9

10

16

17

20

3

2

10

10

10

10

10

2

2

2

2

2

2

2

3

3

3

3

12

12

12

Winchester

Winchester

Winchester

Winchester

Winchester

Winchester

Winchester

Winchester

Winchester

Winchester

Winchester

Winchester

Winchester

Winchester

Winchester

Winchester

Winchester

Winchester

Winchester

Winchester

Winchester

Winchester

Winchester

Winchester

Winchester

Winchester

Winchester

Winchester

Winchester

Winchester

Winchester

Winchester

Winchester

Winchester

Winchester

Winchester

Winchester

Winchester

Winchester

Winchester

Winchester

Winchester

Winchester

Winchester

Winchester

Winchester

Winchester

Winchester

Winchester

Winchester

Winchester

Winchester

Winchester

Winchester

Winchester

Winchester

Winchester

Winchester

Winchester

Winchester

Winchester

Winchester

Winchester

Winchester

Winchester

Winchester

Winchester

Winchester

Winchester

Winchester

Winchester

Winchester

Winchester

Winchester

Winchester

Winchester

Winchester

Winchester

Winchester

Winchester

Winchester

Winchester

Winchester

Winchester

Winchester

Winchester

Winchester

Winchester

Winchester

Winchester

Winchester

Winchester

Winchester

Winchester

Winchester

Winchester

Winchester

Winchester

Winchester

Winchester

Winchester

Winchester

Winchester

Winchester

Winchester

Winchester

Winchester

Winchester

Winchester

Winchester

Winchester

Winchester

Winchester

Winchester

Winchester

Winchester

Winchester

Winchester

Winchester

Winchester

Winchester

Winchester

Winchester

Winchester

Winchester

Winchester

Winchester

Winchester

Winchester

Winchester

Winchester

Winchester

Winchester

Winchester

Winchester

Winchester

Winchester

Winchester

Winchester

Winchester

Winchester

Winchester

Winchester

Winchester

Winchester

Winchester

Winchester

Winchester

Winchester

Winchester

Winchester

Winchester

Winchester

Winchester

Winchester

Winchester

Winchester

Winchester

Winchester

Winchester

Winchester

Winchester

Winchester

Winchester

Winchester

This is a location map for a water right application by Chuck Collins. This map is for the purpose of identifying the location of the water right only and is not intended to provide legal dimensions or locations of property ownership lines.

Diversion point should be

T 27 S, R 6 W

RECEIVED

DEC 28 1992

WATER RESOURCES DEPT.
SALEM OREGON

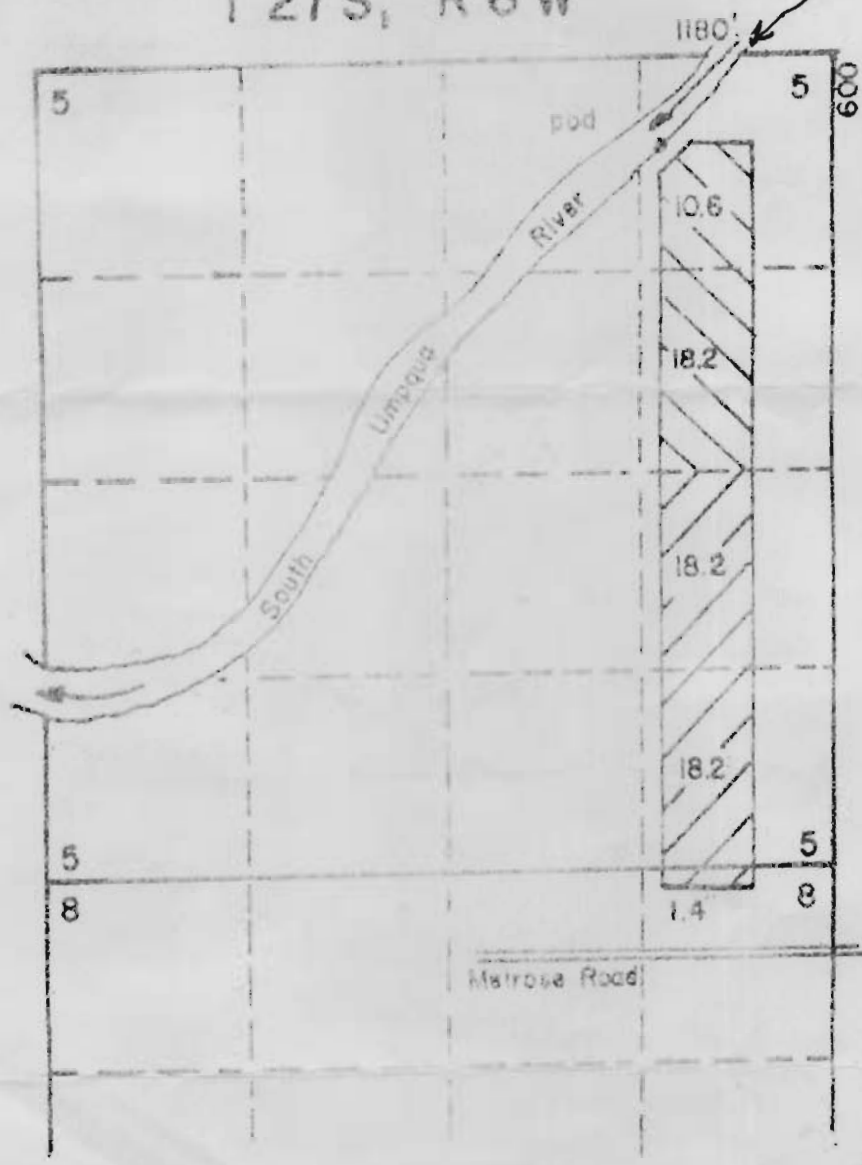

1" = 1320'



New Application - Primary Water Right - South Umpqua River
- Supplemental Water Right - Galesville Reservoir

Existing Application 60441, Permit No. 45253
Application for Supplemental Water Right - Galesville Reservoir



7-89

T 31 S, R 4 W

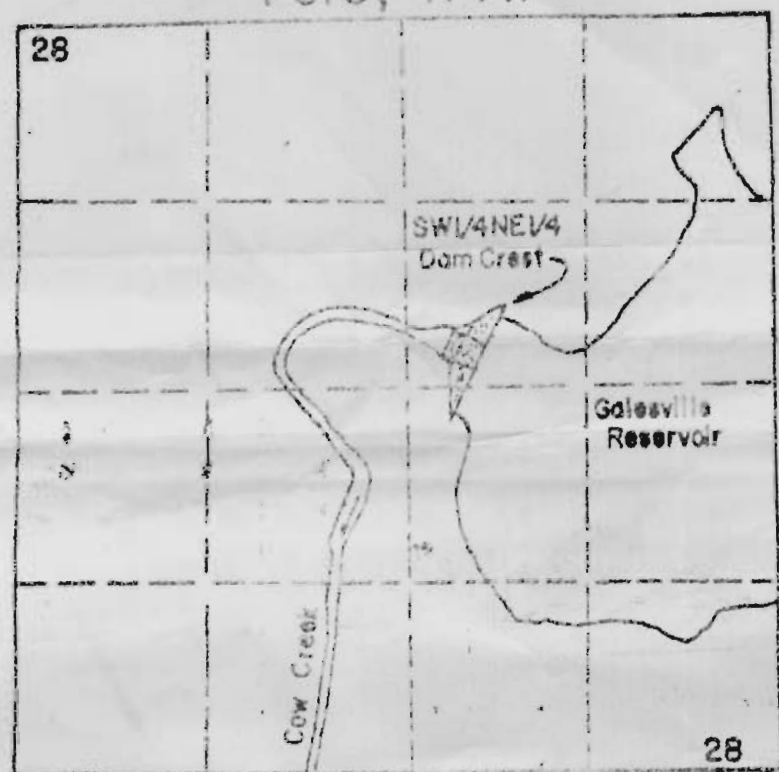

7/31/80

Dam (POD) = 2920' N, 2050' W From SE Cor Sec 28

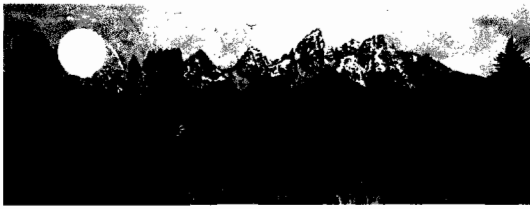

Duane W. Kirby, C.W.R.E.

To: Water Resources Department

I am preparing map for
R. Imrie loan for

T 27 S R 6 W S 05

T 27 S R 6 W S 08

I will have it and the site

Report to you by February 1, 1993

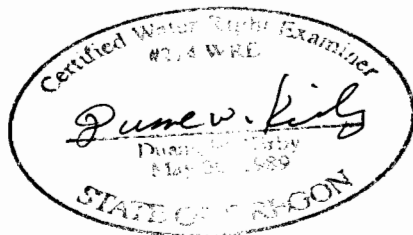

RECEIVED

DEC 20 1992

8087 Lookingglass Rd.
Roseburg, Oregon 97470

WATER RESOURCES DEPT
SALMON PROGRAM



R. Conn
14795 La Rinconada Dr
Los Gatos, CA
95030-1723

Richard - see 1904 H2C

Home ranch, please change
the River section on my
Engr. diagram from 14 A to
10.6 A, making a total of
66.6 A. Please correct
application from 70 A to
66.6 A. A new check is
attached for \$134 = @ 2⁰⁰
per A. or fraction thereof.

The attached diversion
point is wrong. Mine is correct
and where Capeo electric pole
is located. (over)

P.S. Do not forget 4 a and B and C and before 1909!
on each of 3 applications -

Should my diagram
be redrawn, a larger
area could be left
blank for gulch area
near river.

The division point on
the attached is on flaked
rock that is only a few
inches deep during summers.

Please obtain CWR E
maps (diagrams) and get in
before 12-26-92. Let me
know CWR E charges. Thanks
Father.

W. Henry (Three Indians namely by and between William
Henry, Wm. Henry, and Am. Wm. Henry his wife
Washington County and State of Oregon
and Henry Conn Douglas County and
State of Oregon the 21st day of November 1851 by
virtue of that for and in consideration of the sum
of three thousand dollars, lawful money of the
United States to us in hand paid, the receipt whereof
is hereby acknowledged, we have bargained
sold and conveyed and by these presents do bargain
and convey unto Henry Conn the following
described premises to wit, all that certain piece
parcel of land, situate and being in Douglas County
Oregon, commencing at a point five chains and thirty
links west and nine chains and ninety links east
from quarter post on line between sections four (4)
and nine (9) in Township 27 south R. 6 west three
North (64.37.40) fifty four chains and thirty seven links
thence East (120) four chains to Truckee River
thence meandering said River up stream as follows
viz South twenty six degrees (26.00 E) fifteen minutes East
twenty two chains and twenty eight links (22.28) thence
South ten degrees (10.30 E) thirty minutes East, thirty
chains eight links (38.08) thence South (13.30 E) thirteen
degrees and thirty minutes East, ten chains nine links
(10.19) thence South seven degrees East, twenty one chains and
twenty six links, thence South (26.30 E) twenty six degrees
and thirty minutes East, twenty two chains, and thirty
links (22.36) thence South 11.00 eleven degrees west (11.00)
twenty nine chains and fifty five links, thence South (10.00)
thirty one degrees and forty five minutes west, nineteen
chains and sixty four links (19.24) thence South
west eleven chains degrees west, twenty chains and
links (20.06) thence west forty one chains and nine links
thence North (0.23) twenty nine minutes East, one chain
and four chains, and fifty six links (56.04) thence east
thirty one chains and thirty seven links to the

running & said River up stream as follows
viz South twenty six degrees (26.00' E) fifteen minutes East
twenty two chains and twenty eight links (22.28), then
South ten degrees (10.30' E) thirty minutes East, thirty five
chains eight links (35.08) then South (13.30' E) thirteen
(10.19) then South seven degrees East, twenty one chains and
twenty six links, then South (26.30' E) twenty six degrees
and thirty minutes East, twenty two chains, and thirty six
links (22.36) then South 11.00: eleven degrees west (29.02)
twenty nine chains and fifty five links, then South (20.00)
thirty one degrees and forty five minutes west, nineteen
chains and thirty four links (19.24) then South 11
west eleven chains degree west, twenty chains and
links (20.06), then west forty one chains, and nine links
then North (0.23) twenty three minutes East, one chain
and four links and fifty six links (10.56) then
twenty four chains and seventy four links to the
of beginning and containing six hundred and thirty
thirteen acres (633.70) more or less, said claim with
Derivation claim of the said William McKinney and
Ann McKinney No 50: as described on the plat of
Survey in the Office of the Register & Receiver for the
Oregon, together with all and singular the heredit-
aments and appurtenances thereto belonging
To have and to hold the above granted
and bargained premises with the appurtenances to
unto the said Henry Combs his heirs and assigns to
his and their own proper use and behoof forever
And we the said do for ourselves and our

debtors and administrators connected with the
 said Henry Combs his heirs and assigns that
 at and until the executing of these presents we
 are well seized of the premises as of a good and
 indefeasible title estate in fee simple and that
 the same are free from all encumbrances
 whatsoever, and further we do by these presents bind
 ourselves, and our heirs to warrant and forever
 defend the above granted and bargained premises
 unto the said Henry Combs his heirs and assigns
 against all claims and demands whatsoever

In witness whereof we have hereunto set
 our hands and seals this day and year first above
 written

Witness
 Roger Jackson
 Thomas Humphrey

Wm McHenry
 Ann McHenry
 made

seal
 seal

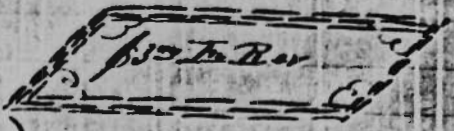

State of Oregon }
 County of Washington } 22

On this 21st day of November
 A.D. 1864 before me personally appeared William
 McHenry and Ann his wife to me known
 to be the individuals described in and who
 executed the foregoing conveyance and acknowl-
 edged that they executed the same and the
 said Ann wife of William McHenry aforesaid
 acknowledged in a private examination by me
 made apart from her husband that she
 executed the said conveyance fully and without
 fear or compulsion of anyone

In witness whereof I have hereunto
 set my hand and affixed the seal of a Justice
 Court at Wellsburg this 21st day of November
 A.D. 1864

Thomas Humphrey
 County Clerk

Recorded February 4th 1865
 J. B. Williams
 Recorder

Washington, the twentieth day of April in the year of our Lord one thousand Eight hundred and Eighty two, and of the Independence of the United States the one hundred and sixth.



By the President, Chester A. Arthur
By N.H. Cook, Secretary

S.W. Cook, Recorder of the General Land Office

1882 Apr 20

RECEIVED

Recorded Jan'y 26th 1881

S.W. Kimball Collector

S.C. Hunt Deputy

Susan Smith et al

To } This Indenture Witnesseth, that Susan Jane A. Chadwick, Henry A. Smith and Florence E. Smith his wife and William R. Smith and Amelia his wife for the consideration of the sum of one dollar to them paid, the receipt thereof is acknowledged have bargained and sold and by these presents do bargain sell and convey to Mrs. Jane A. Chadwick the following described premises to wit: Beginning at the centre of Deer creek on the west line of the land claim of said William J. Perry {division} from thence running South {13} thirteen chains and {6} links to a post marked No 2 from thence East fifteen {15} chains on South boundary of Wm J. Perry's land claim to a post marked B. thence North {11} Eleven chains, and {90} ninety links to the centre of said Deer creek thence Westwardly along the centre of said creek to the place of beginning, the same containing Nineteen and fifty nine one hundredths acres. Also beginning at the SE corner of old tract of S. J. Chadwick's land thence East two chains and fifty links to a post marked No 1 from thence North to a post marked No 20 West

Vertical text on the left margin, possibly a date or reference number.

Vertical text on the right margin, possibly a date or reference number.

United States }
 Do it }
 Henry Conn }
 Certificate }
 No 845 }
 Oregon, has deposited in the General Land Office of the United States a Certificate of the Register of the Land Office at Roseburg, Oregon. Whereby it appears that full payment has been made by the said Henry Conn, according to the provisions of the act of Congress of the 27th of April 1820 entitled an act making further provision for the sale of the Public Lands, and the acts supplemental thereto for the Lot numbered seven of section four in township twenty seven south of range six West of the Cascade Meridian in Oregon containing one acre and ninety seven hundredths of an acre. According to the official plat of the survey of said lands, returned to the General Land Office by the Surveyor General, which said tract has been purchased by the said Henry Conn. Now know ye that the United States of America, in consideration of the premises, and in conformity with the several acts of Congress in such case made and provided, have given and granted, and by these presents do give and grant, unto the said Henry Conn, and to his heirs, the said tract above described, to have and to hold the same, together with all the rights, privileges, immunities, appurtenances of whatsoever nature therunto belonging, unto the said Henry Conn, and to his heirs, and assigns forever, subject to any vested and accrued water rights for running, agricultural, manufacturing, or other purposes, and rights to ditches and reservoirs used in connection with such water rights, as may be recognized and acknowledged by the local customs, laws and decisions of courts, and also subject to the right of the proprietor of a vein or lode, to extract and remove his ore therefrom, should the same be found to penetrate or intersect the premises hereby granted, as provided by law. In testimony Whereof I Chester A. Arthur, President of the United States of America, have caused these letters to be made public, and the seal of the General Land Office to be hereunto affixed, Given under my hand at the City of

Ed Bonn - Tom Henry Bonn

This Indenture witnesseth that Ed Bonn for and in consideration of the sum of one dollar to him in hand paid, the receipt whereof is hereby acknowledged, has bargained, sold and by these presents does bargain sell and convey unto Henry Bonn (the father of the said Ed Bonn) the following described premises, to-wit: The East half of the South East Quarter the South East Quarter of the North East Quarter and Lots one, two, fifteen and sixteen of Section five and Lot two of Section Eight in Township Twenty seven South of Range six west, and Lot Eleven of Section Thirty-two of Township Twenty-six South of Range six west, containing three hundred fifteen and 3/400 acres; Also the South East Quarter the South half of the North East Quarter and Lots three and four of Section Eight and Lots twelve and thirteen of Section nine in Township Twenty seven South of Range six west, containing three hundred nineteen and 7/100 acres more or less. The Donation claim number fifty of William M. Kinney and Ann M. Kinney, his wife, the said claim being part of Section Four, nine and sixteen in Township Twenty seven South of Range six west and containing Six hundred thirty three and 5/100 acres. Also the following described premises to-wit: Beginning at the South West corner of the Donation claim of Henry Bonn and wife, thence north nine 7/100 chains; thence west eleven 5/100 chains; thence South forty chains; thence East fifteen 5/100 chains; thence north thirty 2/100 chains; thence west three 9/100 chains to the place of beginning, containing fifty nine and 10/100 ⁶⁰⁰⁰ acres; Also the Lot number twelve of Section sixteen in Township Twenty seven South of Range six west, containing sixteen and 1/100 acres; Also Lots numbered three and four in Section Five in Township Twenty seven South of Range six west, containing thirty one and 7/100 acres. Also the following described premises to-wit: Beginning twenty chains South of the section corner to Sections Eight, nine, six and Donation and running thence East to the West boundary of Wm Kinney's Donation claim N 00. thence

South Swanton and 5700 chains; these next to the section
 line between sections sixteen and seventeen. These north
 Swanton and 5700 chains to the place of beginning,
 being part of Lot twelve of Section sixteen in Township
 Twenty seven south of Range six west containing four teen
 and 5000 acres. Also the East half of the south west quarter of
 Section Eight and the East half of the north west quarter
 of Section seventeen in Township Twenty seven south
 of Range six west, containing one hundred and sixty
 acres. Also the north East quarter of Section sixteen
 in Township Twenty seven south of Range six west
 containing One hundred and sixty acres;
 Also the Lot numbered seven of Section four in Township
 Twenty seven south of Range six west, containing one
 and 9000 acres. Also Lot Eleven of Section nine in
 Township Twenty seven south of Range six west con-
 taining ten and 6000 acres. Also Lot one of Section
 Eighteen in Township Twenty seven south of Range six
 west containing nineteen and 700 acres. Also Lot
 fourteen of Section nine in Township Twenty seven
 south of Range six west containing seven and 2000
 acres. Also Lot Five of Section five in Township
 Twenty seven south of Range six west containing
 sixteen and 8000 acres. Also the south half of the
 claim numbered forty seven (47) in Township Twenty seven
 south of Range six west, the same being part of the
 Donation claim of Josiah Alletbury Farmer in Sections
 Twenty seven. Township Eight, thirty three and thirty four
 containing One hundred and sixty acres; Also
 the Donation claim of Hugh D. Dryden and wife, being
 claim No. 49 in Sections thirty five and thirty four
 in Township Twenty seven south of Range seven
 west claim No 39 in Sections two and three, Township
 Twenty seven south of Range seven west containing
 three hundred and nineteen and 1300 acres. Also the
 north half of the south west quarter and the south East
 quarter of the north west quarter and the north west
 quarter of the south east quarter and the west half
 of the north east quarter of Section four in Township
 Twenty seven south of Range seven west, containing
 two hundred and forty two and 900 acres. Also
 the south half of the south west quarter, the south east

quarter of the south east quarter and Lots five, six, seven, eight and nine of Section thirty four and Lots two and three of Section thirty three in Township Twenty six South of Range seven west containing two thousand and ninety six and 2/100 acres. Also Lot one of Section two in Township Twenty seven South of Range seven west and Lot one, two, three, four and five of Section thirty five in Township Twenty six South of Range seven west, containing three hundred and one and 65/100 acres; Also the north half of the south west quarter, the north west quarter of the south east quarter and Lots three, four and five of Section three and the north east quarter of the south east quarter and the east half of the north east quarter of Section four in Township Twenty seven South of Range seven west containing three hundred and twenty nine and 47/100 acres. Also the south west quarter of the south east quarter of Section thirty three in Township Twenty six South of Range seven west containing forty acres. Also the south west quarter of the north east quarter and the south east quarter of the south east quarter of Section thirty three in Township Twenty six South of Range seven west containing eighty acres. Also the north west quarter of the south east quarter of Section thirty three in Township Twenty six South of Range seven west containing forty acres. Also the Lots numbered twelve in Township Twenty seven South of Range six west containing Twenty two and 97/100 acres, all in Douglas County, State of Oregon and containing in the aggregate Three thousand four hundred Eighty one and 22/100 acres more or less. It is given with the tenements, hereditaments and appurtenances thereto belonging or in anywise appertaining to have and to hold the said premises with their appurtenances unto the said Henry Conn, his heirs and assigns forever. And the said L^d Conn hereby covenants to and with the said Henry Conn his heirs and assigns that he is the owner of the said premises or fee simple; that they are free from all incumbrances (save and except a judgment and decree of foreclosure for the sum of two thousand six hundred eighty five and 2/100 Dollars and the

costs and disbursements therefor taxed at twenty
 eight and 8/100 dollars, with interest on said
 judgment and costs and disbursements at
 the rate of six per cent per annum from November
 12th 1889. which said judgment and debts with costs
 and disbursements and interest is a lien on the Smith
 half of the Donation land claim of Harry Conn
 and Mary J Conn, his wife, situated in Township
 Twenty and Range Ten South of Range Six
 West of the Nicomac Meridian and that he
 will warrant and defend the same from all
 lawful claims whatsoever save and except the
 aforesaid judgment and costs and disbursements
 together with accumulated interest thereon.
 In witness whereof I have hereunto set my
 hand and seal this 22 day of February A.D. 1890
 Given in presence of } L. J. Conn
 Geo A Burnett }
 J B Crandall }

State of Oregon
 County of Marion }
 On this 22 day of February
 1890 before the undersigned, a Notary Public
 and for the County of Marion and State of Oregon
 personally came L. J. Conn, known to me to
 be the identical person who executed the foregoing
 conveyance and acknowledged to me that he
 executed the same for the uses and purposes therein
 made, freely and without fear or compulsion
 from any one.
 Witness my hand and Notarial seal this 22
 day of February A.D. 1890
 Geo A Burnett
 Notary Public

Filed & Recorded Feb 26 1890
 J. A. Taylor
 County Clerk

SURFACE WATER REGISTRATION CHECKLIST

(received after July 18, 1990)

CHECK BASIN MAP See NAME Unyquis # 16 UNADJUDICATED AREA ? yes
RECEIPT # 95572 S W R NUMBER 253
CHECK ENCLOSURES see PRELIMINARY DATA BASE ENTRY DWP
ACKNOWLEDGEMENT LETTER see ENTER ON STREAM INDEX _____
CHECK QUADRANGLE MAP _____ CHECK GLO PLATS _____
WATERMASTER CHECKLIST _____ PUBLIC NOTICE PUBLICATION see

FORM REVIEW

_____ blanks filled in
_____ signed
_____ date received stamped

MAP REVIEW

#3 ✓
_____ ✓ source and trib
_____ ✓ diversion point location
_____ ✓ conveyances (pipes, ditch, etc.)
_____ ✓ place of use
_____ ✓ scale
_____ ✓ township, range, section
_____ ✓ north arrow
_____ ✓ CWRE stamp
_____ ✓ disclaimer
_____ ✓ date survey was performed
_____ ✓ P.O.B. of survey
_____ ✓ dimensions and capacity of diversion system
_____ ✓ "beneficial use" type title
_____ ✓ "permanent-quality" paper

WATER RIGHT RECORD CHECK 1/10 th acct FIELD INSPECTION _____
FINAL FILE REVIEW _____ FINAL DATA BASE ENTRY _____
ENTER ON PLAT CARDS _____

April 10, 1995

R IMRIE CONN
885 FLOURNOY VALLEY RD
ROSEBURG OR 97470

re: SWR-253

Dear Mr Conn,

Thank you for your letter of March 30, 1995 in regards to the map supporting your pre-1909 vested water right claim. I am sending a copy of the map prepared and certified by Duane W. Kirby, WRE. If you have any further questions on this matter, please contact me.

Sincerely,

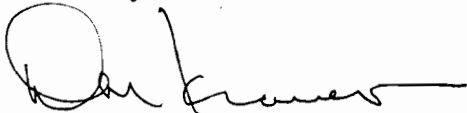

Don Knauer
Adjudication Specialist

m:\w\slc\2\swr-0253.006



Commerce Building
158 12th Street NE
Salem, OR 97310-0210
(503) 378-3739
FAX (503) 378-8130

SWE-253, 254, 255

3/23/95

Mr. Imrie Lunn asked
about the status of the
claims. I told he they
have met the requirements.
They have the legal right
to use the water. He
asked if there was more
he must do. I said no.

DEK

November 2, 1993

WATER
RESOURCES
DEPARTMENT

DUANE W KIRBY
8087 LOOKINGGLASS RD
ROSEBURG OR 97470

RE: SWR-253

Dear Mr Kirby,

This will acknowledge the receipt of map to support the pre-1909 vested water right claim in the name of R IMRIE CONN you returned with corrections and completions. I have added the map to the file. Thank you for your attention to this matter. If you have any questions, please give me a call.

Sincerely,

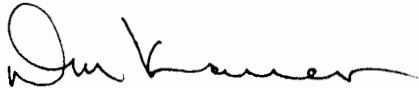

Don Knauer
Adjudication Specialist

J:\W\1\C\2\SWR-0253.005



3850 Portland Rd NE
Salem, OR 97310
(503) 378-3739
FAX (503) 378-8130

September 16, 1993

DUANE W. KIRBY
8087 LOOKINGGLASS ROAD
ROSEBURG OR 97470

RE: File# SWR-253

DEAR DUANE W. KIRBY,

The Water Resources Department (WRD) received a little over 500 surface water registration statements in December, 1992. All of the files have been set up and receipts for the fees have been sent. The next step is to insure the maps received in support of the claims are acceptable based on Oregon Revised Statutes (ORS) and Oregon Administrative Rules (OAR).

I am returning the map you prepared for R. Imrie Conn. You will find the item which requires completion or correction shown below. I have the description followed by the ORS or OAR site and paraphrased statute or rule.

conveyance

ORS 539.120 "...the location of and each ditch, canal, pipeline or other means of conveying the water..."

You must return the map before the claim can be processed. If you cannot have the map to the WRD within 60 days, please inform me as to when it can be expected. Please mark all correspondence with the file number.

As always, if you have any questions, please give me a call.

Sincerely,



Don Knauer
Adjudication Specialist

Enclosures

J:\WP51\SWR\CLAIMANT\2\SWR-0253.00M



October 6, 1993

R IMRIE CONN
885 FLOURNOY VALLEY ROAD
ROSEBURG OR 97470

RE: SWR-253

Dear Mr Conn,

This will acknowledge the receipt of the copy of the property description you sent to replace the illegible copy in your file. Thank you for your prompt attention to this matter.

If you have any questions, please give me a call.

Sincerely,



Don Knauer
Adjudication Specialist

J:\W\1\C\12\SWR-0253.004



September 16, 1993

R IMRIE CONN
885 FLOURNOY VALLEY ROAD
ROSEBURG OR 97470

RE: SWR-253

Dear Mr Conn,

In regards to my letter of September 15, 1993, please disregard the last two paragraphs. You have three files and I find the maps and statements were interchanged. At this time, all I need from you is a copy of the property description.

If you have any questions, please give me a call.

Sincerely,



Don Knauer
Adjudication Specialist

J:\W\1\C\2\SWR-0253.003



September 15, 1993

Oregon

WATER
RESOURCES
DEPARTMENT

R IMRIE CONN
885 FLOURNOY VALLEY ROAD
ROSEBURG OR 97470

re: **SWR-253**

Dear Mr Conn,

I am sending a copy of a statement and property description the Water Resources Department received in support of a claim to a pre-1909 vested water right. As you can see, the copy of the property description is not legible. I am requesting a legible copy.

You write in your statement about stockwater. You did not include stockwater in your claim to a pre-1909 vested water right. You did not pay fees for claiming stockwater. Would you explain your including the description of stockwater?

Your claim form lists sections 5 & 8 T27S R6W as the place of use. The map prepared by your CWRE shows the place of use within section 11 T27S R7W. Would you explain the discrepancy?

If you have any questions, please give me a call.

Sincerely,



Don Knauer
Adjudication Specialist

J:\W\S\C\2\SWR-0253.002



3850 Portland Rd NE
Salem, OR 97310
(503) 378-3739
FAX (503) 378-8130

February 18, 1993

R IMRIE CONN
885 FLOURNOT VALLEY ROAD
ROSEBURG OR 97470

Dear MR CONN,

This will acknowledge that your Surface Water Registration Statement in the name of R IMRIE CONN has been received by our office. The fees in the amount of \$134.00 have been received and our receipt #95572 is enclosed. Your registration statement has been numbered SWR-253.

Our office will review your form and map in the near future. If necessary we will schedule a meeting with you that will include a site inspection. If there are problems with your form we are usually able to take care of them during our visit. We will be able to answer any questions you might have about the adjudication process at that time.

Please feel free to contact this office if you have any questions.

Sincerely,



Don Knauer
Adjudication Specialist

Enclosure

C:\WP51\SWR\CLAIMANT\SWR-0253.001



3850 Portland Rd NE
Salem, OR 97310
(503) 378-3739
FAX (503) 378-8130

WATER RESOURCES DEPARTMENT

RECEIPT # **95572**

3850 PORTLAND ROAD NE

SALEM, OR 97310

378-8455/378-8130 (FAX)

RECEIVED FROM:

R. Imine Corp, Trustee

BY:

APPLICATION

PERMIT

TRANSFER

CASH:

CHECK: #

OTHER: (IDENTIFY)

24-12

TOTAL REC'D

\$ *134.00***01-00-0 WRD MISC CASH ACCT**

842.010 ADJUDICATIONS
 831.087 PUBLICATIONS/MAPS
 830.650 PARKING FEES Name/month
 OTHER: (IDENTIFY)

\$ *134.00*
 \$
 \$
 \$

REDUCTION OF EXPENSE

CASH ACCT.

COST CENTER AND OBJECT CLASS

VOUCHER #

\$

03-00-0 WRD OPERATING ACCT**MISCELLANEOUS:**

840.001 COPY FEES
 850.200 RESEARCH FEES
 880.109 MISC REVENUE: (IDENTIFY)
 520.000 OTHER (P-6): (IDENTIFY)

\$
 \$
 \$
 \$

WATER RIGHTS:

842.001 SURFACE WATER
 842.003 GROUND WATER
 842.005 TRANSFER

EXAM FEE

\$

\$

\$

EXAM FEE

\$

\$

842.002

842.004

842.006

842.023

842.019

842.024

RECORD FEE

\$

\$

\$

LICENSE FEE

\$

\$

\$

06-00-0 WELL CONST START FEE

842.013 WELL CONST START FEE
 MONITORING WELLS

\$

\$

CARD #

CARD #

45-00-0 LOTTERY PROCEEDS

864.000 LOTTERY PROCEEDS

\$

07-00-0 HYDRO ACTIVITY

LIC NUMBER

842.011 POWER LICENSE FEE(FW/WRD)
 842.115 HYDRO LICENSE FEE(FW/WRD)

\$
 \$

HYDRO APPLICATION

\$

RECEIPT #

95572

DATED:

12-29-92

BY:

R. B. Buehler