

RECEIVED

NOV - 5 1993

WATER RESOURCES DEPT.
SALEM, OREGON

WATER
RESOURCES
DEPARTMENT

September 16, 1993

DUANE W. KIRBY
8087 LOOKINGGLASS ROAD
ROSEBURG OR 97470

RE: File# **SWR-255**

DEAR DUANE W. KIRBY,

The Water Resources Department (WRD) received a little over 500 surface water registration statements in December, 1992. All of the files have been set up and receipts for the fees have been sent. The next step is to insure the maps received in support of the claims are acceptable based on Oregon Revised Statutes (ORS) and Oregon Administrative Rules (OAR).

I am returning the map you prepared for R. Imrie Conn. You will find the item which requires completion or correction shown below. I have the description followed by the ORS or OAR site and paraphrased statute or rule.

conveyance

ORS 539.120 "...the location of and each ditch, canal, pipeline or other means of conveying the water..." You must show the pipelines and areas that are irrigated by means of the pump. You must also show how the areas are irrigated. You must also show how the stockwater is diverted, conveyed and used.

place of use (1/4 1/4)

ORS 539.240 (2) (d) (B) "The location of place of use by quarter-quarter section..." You have shown stockwater use in the SW 1/4 NE 1/4 and the NE 1/4 SW 1/4 only. If there is other stockwater use, you must show the place of use and manner by which it is used.

Don Knauer

Here is the corrected map you requested.
The one pump is moved to the
5 different diversion points
D. Kirby



3850 Portland Rd NE
Salem, OR 97310
(503) 378-3739
FAX (503) 378-8130

diversion point size

OAR 690-28-025-(4)-(c) "The dimensions and capacity of any existing diversion systems." You have shown five diversion points but supply information for only one pump. You must supply the information for the other four diversion points. You must identify which diversion point is used for which use and where that use is.

You must return the map before the claim can be processed. If you cannot have the map to the WRD within 60 days, please inform me as to when it can be expected. Please mark all correspondence with the file number.

As always, if you have any questions, please give me a call.

Sincerely,

A handwritten signature in black ink, appearing to read "Don Knauer", written in a cursive style.

Don Knauer
Adjudication Specialist

Enclosures

T. 27S., R. 7 W., W.M.

SCALE: 1" = 1320'

REGISTRATION STATEMENT MAP

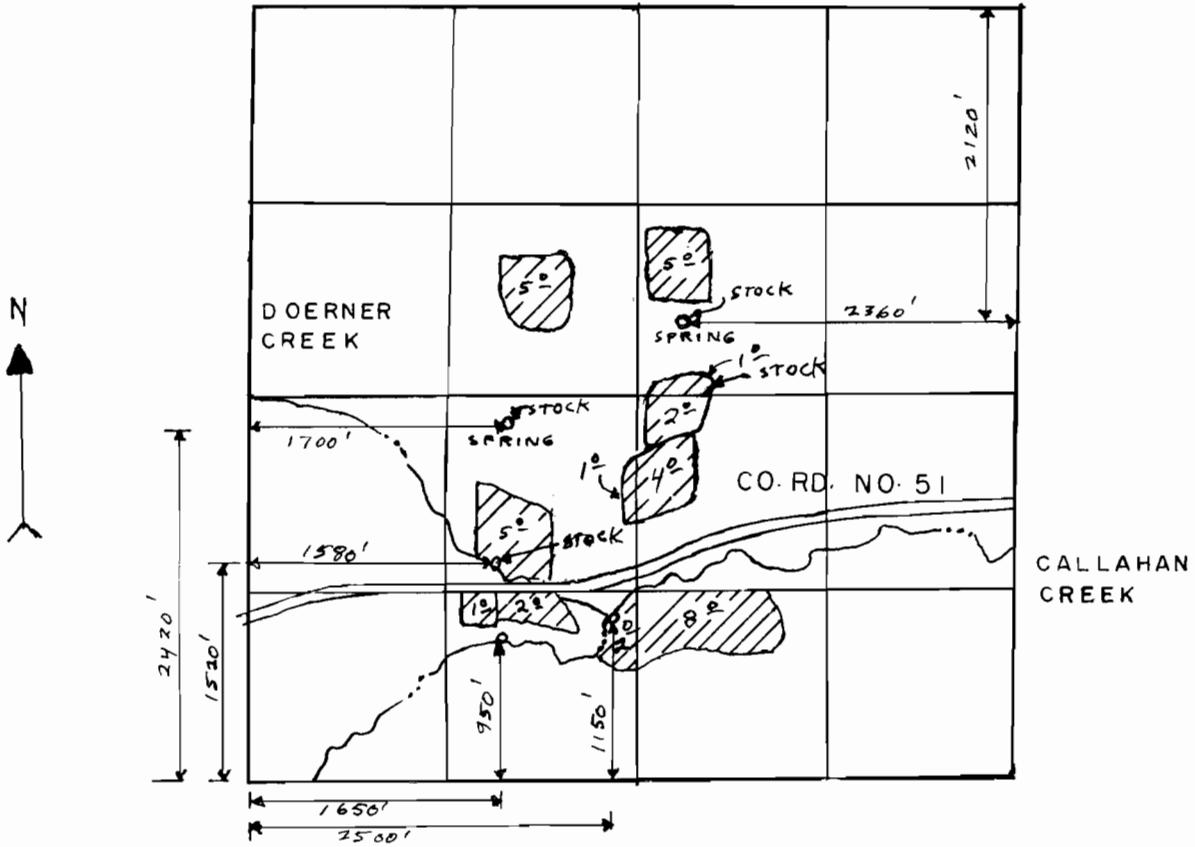

SECTION 11

UNDER

THE PURPOSE OF THIS MAP IS TO IDENTIFY THE LOCATION OF THE WATER RIGHT. IT IS NOT INTENDED TO PROVIDE INFORMATION RELATIVE TO THE LOCATION OF PROPERTY OWNERSHIP BOUNDARY LINES.

IN NAME OF

R. IMRIE CONN

Surveyed JAN. 20, 1993, by DUANE KIRBY

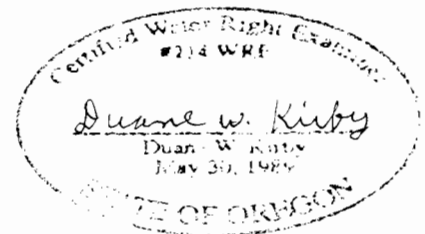

SWR-255

INFORMATION:

R. Emrie Conn
 885 Flournoy valley Rd.
 Roseburg, Oregon 97470

JAN 27 1993

ALL INFORMATION
 SUBJECT TO

SOURCE(S):

spring, pond, unnamed creek to Doerner creek
 Callahan creek to Doerner Cr. to south
 Umpqua River

DIVERSION
POINTS:

5

MOTOR:

Brand, wards

type, Electric

HP, 3

Max. RPM's

PUMP:

Brand, wards

type, centrifugal

intake/discharge dia 1" / 1"

size of pulleys. 3"

PIPE: Plastic 1"

HEADS: rainbird

JUN 2 1988

SALES

USE(S): Irrigation and
stock water

LIFT: 12'

SURVEY TIE: Field tie to property line
Assessor map T27S R7W section 11

SPECIAL
CONDITIONS:

REMARKS:

JAN 2 1989

The final proof survey and inspection of the use, as found to be completed under the terms and conditions of Registration Statement was completed by me on 1-20-93, and the facts contained in this report and accompanying final proof map are correct to the best of my knowledge.



I, R. Imrie Conn agree to the findings of the CWRE and do submit this site report and map as my Claim of Beneficial Use of the water as provided under the terms and conditions of my Registration Statement

R. Imrie Conn

FINAL PROOF CALCULATIONS

Given Data

Duty of water = $\frac{1}{80}$ th cfs per Acre.
 Acres allowed as irrigated = 36.0
 operating pressure = 7
 Pump 3 HP centrifugal
 suction lift = 2
 Discharge lift = 10
 sprinkler heads rainbird No 30 $\frac{5}{32}$ $\frac{3}{32}$

Assume 40 PSI

$$Q_{\text{pump}} = \frac{6.61 \times 3}{12 + 101.6} = 0.01746 \text{ cfs}$$

$$Q_{\text{heads}} = \frac{6.1 \times 13}{449} = 0.1766 \text{ cfs}$$

thus the system's theoretical capacity is 0.1746 cfs
 the duty of water for the permit is $\frac{1}{80}$ th of one cfs
 per Acre. since 36.0 Acres were found to have been
 Beneficially Irrigated, the Maximum Q is $\frac{36.0}{80.0} = 0.45 \text{ cfs}$

only some of the area is watered with a pump.
 the other Acres are watered without using a pump.

since the system and areas that don't need a pump
 are capable of delivering the full duty
 amount. the Q . allowed on the Final water
 Right certificate will be limited in this case 0.45 cfs
 for Irrigation.

stock watering is for up to 200 sheep and
 60 head of cows.

Based on this and Acres, the stock watering
 should be 0.015 cfs.

Dune Kirby

R. IMRIE CONN
885 FLOURNOY VALLEY RD.
ROSEBURG, OREGON 97470

DECEMBER 30, 1992

JAN 28 1993

STATE OF OREGON
WATER RESOURCE DEPT.
3850 PORTLAND RD. N.E.
SALEM, OREGON 97310

WATER RESOURCES DEPT.
SALEM, OREGON

GENTLEMEN: RE: PRE FEBRUARY 24, 1909 VESTED WATER RIGHT,
T 27 S., R 7 W., W.M., SECTIONS 11 & 14.

I AM THE FATHER OF RICHARD I. CONN, AND WILLIAM A. IMRIE IS MY GRANDFATHER ON MY MOTHER'S SIDE. WILLIAM A. IMRIE PURCHASED THE ABOVE DESIGNATED PROPERTY FEBRUARY 15, 1909.

FROM VARIOUS CONVERSATIONS WITH MY GRANDFATHER, WILLIAM A. IMRIE, AND SOME OF THE MEMBERS OF HIS FAMILY I CAN ASCERTAIN TO THE FOLLOWING AND LATER TO THE ABOVE DATES FROM MY OWN PERSONAL KNOWLEDGE AS SET OUT HEREIN.

DURING THE FIRST 5 DAYS AFTER PURCHASE OF THIS PROPERTY ON FEB. 15, 1909, WILLIAM A. IMRIE, MY GRANDFATHER, LOCATED A STOCK WATERING AREA ON THE DOERNER CREEK JUST NORTH OF THE COUNTY ROAD. HE, ALSO, DID THE SAME FOR TWO STOCK WATERING SPOTS ON THE CALLAHAN CREEK ON THE SOUTH SIDE OF THE COUNTY ROAD, AS WELL AS ONE WATERING HOLE FROM THE UNNAMED CREEK TOWARDS THE NORTH SIDE OF THIS PROPERTY. THE DOERNER STREAM AND THE UNNAMED STREAM FLOW INTO THE CALLAHAN CREEK WHICH FLOWS INTO THE CHAMPAGNE CREEK WHICH EMPTIES INTO THE SOUTH UMPQUA RIVER, A TRIBUTARY TO THE UMPQUA RIVER WHICH DISCHARGES INTO THE PACIFIC OCEAN.

AT OR NEAR THESE STOCK WATERING SPOTS IRRIGATION WATER WAS REMOVED, AT FIRST, BY SLED BY FILLING CONTAINERS ON TOP OF SLED AND PULLING SLED TO IRRIGATION AREAS WITH ONE HORSE. DURING THE INITIAL FIRST 5 DAYS CONCENTRATION WAS FOR PLANTING AND IRRIGATING AND ESTABLISHING APPROX. 2 ACRES OF ORCHARD. PART OF THIS ORCHARD IS STILL PRODUCING. ALSO, APPROX. 4 ACRES NORTH OF BARN WHICH IS STILL ON THE PROPERTY WAS PLANTED TO AN EARLY GARDEN AND IRRIGATED AS NECESSARY FROM PLANTING UNTIL HARVESTING BETWEEN NATURAL RAIN PERIODS.

IRRIGATION WAS IMPROVED BY VARIOUS METHODS FROM TIME TO TIME, INCLUDING DIVERSION FROM ANOTHER UNNAMED STREAM TOWARDS THE MORE SOUTHERLY PART OF THIS PROPERTY AND WHICH STREAM FLOWS INTO THE CALLAHAN CREEK.

TWO OTHER STOCK WATERING HOLES WERE ESTABLISHED, ONE IN THE NORTHERLY UNNAMED CREEK WITH THE CONSTRUCTION OF A SMALL DAM, AND THE OTHER IN THE SOUTHERLY UNNAMED CREEK. HOWEVER, THE

ORIGINAL STOCK WATERING LOCATIONS WERE THE PROMINENT ONES,
EXCEPT FOR THE SMALL DAM AS MENTIONED ABOVE.

BOTH STOCK RAISING AND IRRIGATION HAVE CONTINUED FROM
PURCHASE DATE BY WILLIAM A. IMRIE, FEBRUARY 15, 1909, UNTIL
THE PRESENT TIME. STOCK HAS INCLUDED HORSES, MULES, CATTLE
AND SHEEP. TODAY, THERE ARE BEEF CATTLE AND HORSES ON THIS
PROPERTY. THERE IS A MODERN HORSE BARN AND ARENA FOR THE
HORSE OPERATION.

THE FOREGOING IS CERTIFIED AND BELIEVED TO BE AN ACCURATE
ACCOUNTING FOR THE PROPERTY IN THIS APPLICATION.

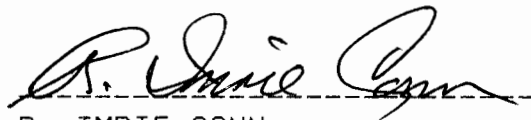
A handwritten signature in cursive script, appearing to read "R. Imrie Conn", written over a horizontal dashed line.

R. IMRIE CONN
(ROSCOE I. CONN)
OFFICER - 0-378086

CC: COPY OF RECORDED
PURCHASE 15 FEB., 1909
WILLIAM A. IMRIE

RECEIVED

APR - 6 1995

WATER RESOURCES DEPT.
SALEM, OREGON

R. IMRIE CONN
885 FLOURNOY VALLEY ROAD
ROSEBURG, OREGON 97470

MARCH 30, 1995

OREGON WATER RESOURCES DEPT.
ADJUDICATION SECTION
3850 PORTLAND RD. N.E.
SALEM, OREGON 97310

ATT: DON KNAUER RE: CONTINUED USE OF PRE-1909 VESTED
WATER RIGHT CLAIM - SWR# 253, 254 & 255.

THANK YOU VERY MUCH FOR OUR TELEPHONE CONVERSATION WHEN YOU RETURNED MY CALL A FEW DAYS PAST, AND YOUR EXPLANATION FOR THE CONTINUED USE OF WATER PRE-1909 VESTED WATER RIGHT CLAIM WITHOUT ANY OTHER ACTION PER SURFACE WATER REGISTRATION STATEMENTS VERIFIED AS COMPLETE IN YOUR OFFICE FOR SWR# 253, #254 & #255.

IT IS MY FURTHER UNDERSTANDING FROM YOU THAT THE FINAL STAGE FOR ALL SUCH WATER PRE-1909 VESTED WATER RIGHT CLAIMS AS VERIFIED AND COMPLETE IN YOUR OFFICE WILL BE THROUGH COURT ACTION. IN THE MEANTIME PROPERTIES MAY CONTINUE USE OF WATER WITHOUT ANY FURTHER ACTION.

TO AVOID ANY POSSIBLE CONFUSION, WOULD YOU PLEASE IDENTIFY AND ACKNOWLEDGE THE TWO ATTACHED LOCATIONS WITH SWR# 253 AND MAIL BACK ONE COPY TO ME AT 885 FLOURNOY VALLEY ROAD, ROSEBURG, OREGON 97470 AND RETAIN THE OTHER FOR THE FILE. SHOULD YOU FIND ANY DISCREPANCY FROM THE FILE SWR# 253 ON THE ATTACHED LOCATION, PLEASE MAIL A COPY OF THE LOCATION SURVEY FROM THE FILE SWR# 253 WITH SOME TYPE OF ACKNOWLEDGMENT FROM YOUR OFFICE. THANK YOU VERY MUCH FOR YOUR TIME AND EFFORT.

SINCERELY,

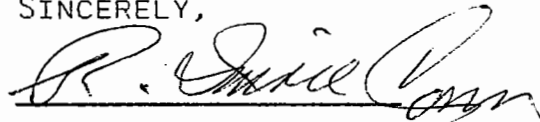

R. IMRIE CONN

ENC: TWO LOCATIONS SWR# 253.

P.S. ALSO, IT WOULD BE GREATLY APPRECIATED FOR COPIES OF LOCATION SURVEYS FOR SWR# 254 & 255 WITH SOME TYPE OF ACKNOWLEDGMENT FROM YOUR OFFICE. THANKS.



Duane W. Kirby, C.W.R.E.

TO : water Resources Department

I am preparing map for
R. Imrie Comm
for

T 27 R 7 W S 11

T 27 R 7 W S 14

I will have it and the site
Report TO you by February 1, 1993



Handwritten text, possibly a signature or date, below the stamp.

Handwritten text, possibly a date or initials, below the signature.

8087 Lookingglass Rd.
Roseburg, Oregon 97470

C 14

206

C 511

C 596

C 95

C 688

C 344

S. 11. T. 27. S. R. 14. W. 11. M.

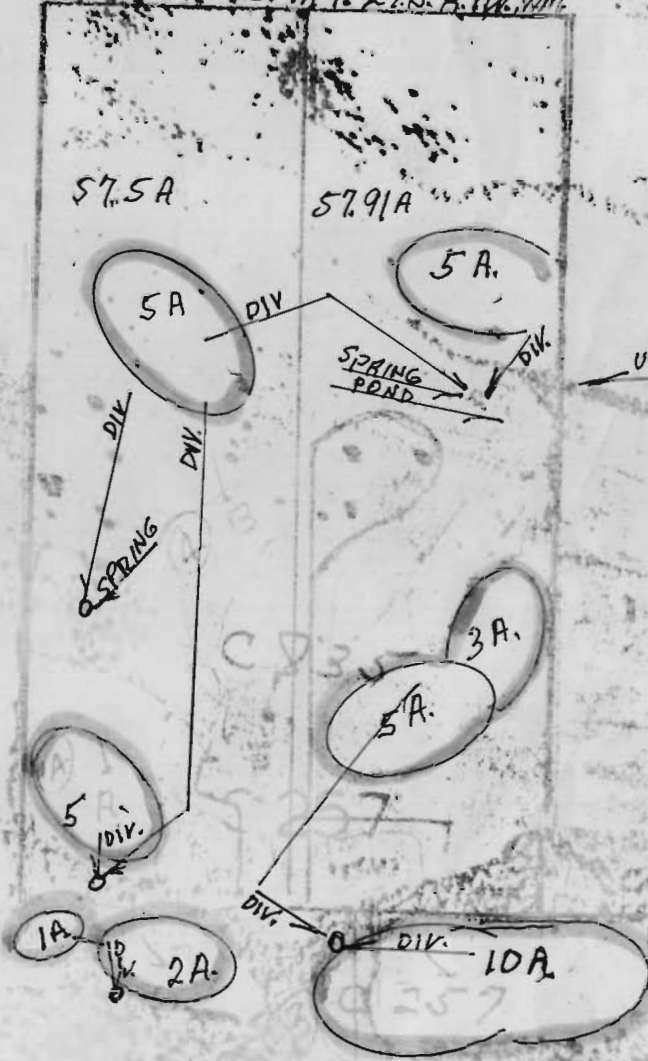

UNAMED CR. TO DOERNER CR.

RECEIVED

DEC 28 1992

WATER RESOURCES DEPT.
SALEM, OREGON

RECEIVED

DEC 28 1992

WATER RESOURCES DEPT.
SALEM, OREGON

This Indenture Witnesseth, That James W Hamilton

and Ollie I Hamilton, his wife
Seven Thousand two hundred and fifty
in then said, he do bargain and sell and by these presents do bargain, sell and convey unto
DOLLARS.

William A Imrie
the following described premises, to-wit:

Commencing at the NW corner of the East half of the D L C of A B Collier, in Section 11 Tp 27 S R 7 West in Douglas County, Oregon, thence running south one hundred and eighty six (186) rods to the North boundary of the D L C of P White, thence East one hundred and three and one third rods (103 1/3) thence north one hundred and eighty six rods (186) and thence west one hundred and three and one third rods to the place of beginning, and containing one hundred and twenty acres (120) more or less; Also the E 1/2 of the NW 1/4 and the NW 1/4 of the NE 1/4 of Section 14 Tp 27 S R 7 West and containing one hundred and twenty (120) acres; Also the SE 1/4 of the SW 1/4 and the SW 1/4 of the SE 1/4 of Section 11 Tp 27 S R 7 West of Willamette Meridian, containing eighty (80) acres more or less, there being in the aggregate 320 acres all lying and being situate in Douglas County, Oregon, save and excepting from the above described land that certain roadway conveyed to Douglas County, Oregon, and found of record in volume 61 page 95 of the Deed Records of Douglas County, Oregon.

RECEIVED

DEC 28 1992

WATER RESOURCES DEPT
SALEM, OREGON

TO HAVE AND TO HOLD the said premises with their appurtenances unto the said

William A Imrie, his heirs and assigns forever.

And the said James W Hamilton and Ollie I Hamilton

do hereby covenant to and with the said William A Imrie

he is heirs and assigns, that he they are the owner in fee simple of said premises, that they are free from all incumbrances,

and that they will warrant and defend the same from all lawful claims whatsoever.

IN WITNESS WHEREOF, we have hereunto set our hand and seals this 15th day of February A. D. 1909

Done in the Presence of

Elbert B Hornum } James W Hamilton (seal)
Andrew R Marker, } Ollie I Hamilton (seal)

STATE OF OREGON,
County of Douglas, } ss. On this, the 15th day of February A. D. 1909, personally came before me a Notary Public in and for said County, the within named James W Hamilton and Ollie I Hamilton his wife, to me personally known to be the identical persons described in and who executed the within instrument, and acknowledged to me that they executed the same freely and voluntarily, for the uses and purposes therein named.

Witness my hand and seal this 15th day of February 1909

(Seal) Elbert B. Hornum
Notary Public for Oregon

Filed the record at _____ o'clock _____ M., March 25 1909. A. D. 1909

E. H. Leman, County Clerk.

By _____ Deputy.

The Indenture Witnesseth, That James W Hamilton

and Ollie I Hamilton, his wife

Seven Thousand two hundred and fifty

is then paid, in full bargained and sold and by their presents do bargain, sell and convey unto

William A Irris

the following described premises, to-wit:

Commencing at the NW corner of the East half of the D L C of A B Collier, in Section 11 Tp 27 S R 7 West in Douglas County, Oregon, thence running south one hundred and eighty six (186) rods to the North boundary of the D L C of F White, thence East one hundred and eighty six rods (186) and thence west one hundred and three and one third rods to the place of beginning, and containing one hundred and twenty acres (120) more or less; Also the E 1/2 of the NW 1/4 and the NW 1/4 of the NE 1/4 of Section 14 Tp 27 S R 7 West and containing one hundred and twenty (120) acres; Also the SE 1/4 of the SW 1/4 and the SW 1/4 of the SE 1/4 of Section 11 Tp 27 S R 7 West of Willamette Meridian, containing eighty (80) acres more or less, there being in the aggregate 320 acres all lying and being situate in Douglas County, Oregon, save and excepting from the above described land that certain roadway conveyed to Douglas County, Oregon, and found of record in volume 61 page 93 of the Deed Records of Douglas County, Oregon.

WATER RESOURCES DEPT SALEM OREGON DEC 28 1992 RECEIVED

TO HAVE AND TO HOLD the said premises with their appurtenances unto the said

William A Irris, his heirs and assigns forever.

And the said James W Hamilton and Ollie I Hamilton

do hereby covenant to and with the said William A Irris

that they are the owner in fee simple of said premises, that they are free from all incumbrances, and that they will warrant and defend the same from all lawful claims whatsoever.

IN WITNESS WHEREOF, we have hereunto set our hands and seals this 15th day of February A. D. 1909

Done in the Presence of

Elbert B Hermann, Andrew R Barker, James W Hamilton, Ollie I Hamilton

STATE OF OREGON,

County of Douglas, On this, the 15th day of February A. D. 1909, personally came before me a Notary Public

James W Hamilton and Ollie I Hamilton his wife, to me personally

known to be the identical persons so described in and who executed the within instrument, and acknowledged to me that they executed the same freely and voluntarily, for the uses and purposes therein named.

Witness my hand and seal this 15th day of February 1909

(Seal)

Elbert B. Hermann Notary Public for Oregon

Filed for record at 11 o'clock M., March 25th 1909 A. D. 1909

E. H. Loner, County Clerk

By Deputy

No.

Million Dollar Club

HOMEQUITY™
RELOCATION CENTER

CONTEMPO REALTY

11-17-92

Richard -

① Need date of W.A. IMRIE
recorded ownership for H.E.

② H.E. April 5,
year following above.

③ CWRE MAP

155 N. Santa Cruz Ave.

Los Gatos, CA 95030

Bus 354-2295

Res 395-0370

your sig. note job
♥ your referrals!



SUSAN FAGIN

Realtor

SWE-253, 254, 255

3/23/95

MR. IMRIE LUNN CALLED
ABOUT THE STATUS OF THE
CLAIMS. I TOLD HE THEY
HAVE NOT MET THE REQUIREMENTS.
THEY HAVE THE LEGAL RIGHT
TO USE THE WATER. HE
ASKED IF THERE WAS MORE
HE MUST DO. I SAID NO.

DET

SURFACE WATER REGISTRATION CHECKLIST

(received after July 18, 1990)

CHECK BASIN MAP OK NAME Whisper # 16 UNADJUDICATED AREA ? Yes

RECEIPT # 95574 S W R NUMBER 255

CHECK ENCLOSURES OK PRELIMINARY DATA BASE ENTRY OK

ACKNOWLEDGEMENT LETTER OK ENTER ON STREAM INDEX _____

CHECK QUADRANGLE MAP _____ CHECK GLO PLATS _____

WATERMASTER CHECKLIST _____ PUBLIC NOTICE PUBLICATION 10/80

FORM REVIEW

- _____ blanks filled in
- _____ signed
- _____ date received stamped

MAP REVIEW

- ✓ source and trib
- ✓ diversion point location
- ✓ conveyances (pipes, ditch, etc.)
- ✓ place of use STOCK? SWNS? MSW OTHERS?
- ✓ scale
- ✓ township, range, section
- ✓ north arrow
- ✓ CWRE stamp
- ✓ disclaimer
- ✓ date survey was performed
- ✓ P.O.B. of survey
- ✓ dimensions and capacity of diversion system
- ✓ "beneficial use" type title
- ✓ "permanent-quality" paper
- ✓ 10th AC

TOTAL = 5 WHAT ABOUT OTHER 4?
 INFO = 1 (IDENTIFY)
 AREAS WHICH PUMP # HOW? WHICH OTHERS?

WATER RIGHT RECORD CHECK _____ FIELD INSPECTION _____

FINAL FILE REVIEW _____ FINAL DATA BASE ENTRY _____

ENTER ON PLAT CARDS _____

November 8, 1993

WATER
RESOURCES
DEPARTMENT

DUANE W KIRBY
8087 LOOKINGGLASS RD
ROSEBURG OR 97470

RE: SWR-255

Dear MR KIRBY,

This will acknowledge the receipt of map to support the pre-1909 vested water right claim in the name of R IMRIE CONN you returned with corrections and completions. I have added the map to the file. Thank you for your attention to this matter. If you have any questions, please give me a call.

Sincerely,

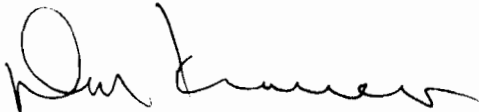

Don Knauer
Adjudication Specialist

J:\W\SIC\2\SWR-0255.002



3850 Portland Rd NE
Salem, OR 97310
(503) 378-3739
FAX (503) 378-8130

September 16, 1993

DUANE W. KIRBY
8087 LOOKINGGLASS ROAD
ROSEBURG OR 97470

RE: File# **SWR-255**

DEAR DUANE W. KIRBY,

The Water Resources Department (WRD) received a little over 500 surface water registration statements in December, 1992. All of the files have been set up and receipts for the fees have been sent. The next step is to insure the maps received in support of the claims are acceptable based on Oregon Revised Statutes (ORS) and Oregon Administrative Rules (OAR).

I am returning the map you prepared for R. Imrie Conn. You will find the item which requires completion or correction shown below. I have the description followed by the ORS or OAR site and paraphrased statute or rule.

✓ conveyance

ORS 539.120 "...the location of and each ditch, canal, pipeline or other means of conveying the water..." You must show the pipelines and areas that are irrigated by means of the pump. You must also show how the areas are irrigated. You must also show how the stockwater is diverted, conveyed and used.

✓ place of use (¼ ¼)

ORS 539.240 (2) (d) (B) "The location of place of use by quarter-quarter section..." You have shown stockwater use in the SW ¼ NE ¼ and the NE ¼ SW ¼ only. If there is other stockwater use, you must show the place of use and manner by which it is used.



diversion point size

OAR 690-28-025-(4)-(c) "The dimensions and capacity of any existing diversion systems." You have shown five diversion points but supply information for only one pump. You must supply the information for the other four diversion points. You must identify which diversion point is used for which use and where that use is.

You must return the map before the claim can be processed. If you cannot have the map to the WRD within 60 days, please inform me as to when it can be expected. Please mark all correspondence with the file number.

As always, if you have any questions, please give me a call.

Sincerely,

A handwritten signature in black ink, appearing to read "Don Knauer", with a long horizontal flourish extending to the right.

Don Knauer
Adjudication Specialist

Enclosures

February 18, 1993

R IMRIE CONN
885 FLOURNOY VALLEY ROAD
ROSEBURG OR 97470

Dear MR CONN,

This will acknowledge that your Surface Water Registration Statement in the name of R IMRIE CONN has been received by our office. The fees in the amount of \$272.00 have been received and our receipt #95574 is enclosed. Your registration statement has been numbered SWR-255.

Our office will review your form and map in the near future. If necessary we will schedule a meeting with you that will include a site inspection. If there are problems with your form we are usually able to take care of them during our visit. We will be able to answer any questions you might have about the adjudication process at that time.

Please feel free to contact this office if you have any questions.

Sincerely,

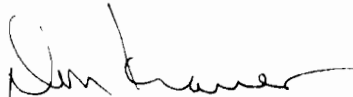

Don Knauer
Adjudication Specialist

Enclosure

C:\WP51\SWR\CLAIMANT\SWR-0255.001



STATE OF OREGON
WATER RESOURCES DEPARTMENT

RECEIPT # **95574**

3850 PORTLAND ROAD NE
 SALEM, OR 97310
 378-8455/378-8130 (FAX)

RECEIVED FROM: R. Imrie Conn, Trustee
 BY: _____

APPLICATION	
PERMIT	
TRANSFER	

CASH: CHECK: # 29412 OTHER: (IDENTIFY)

TOTAL REC'D \$ 572.00

01-00-0 WRD MISC CASH ACCT

842.010	ADJUDICATIONS	\$ <u>272.00</u>
831.087	PUBLICATIONS/MAPS	\$
830.650	PARKING FEES Name/month	\$
_____	OTHER: (IDENTIFY)	\$

REDUCTION OF EXPENSE

CASH ACCT.	\$
COST CENTER AND OBJECT CLASS	VOUCHER #

03-00-0 WRD OPERATING ACCT

MISCELLANEOUS:

840.001	COPY FEES	\$
850.200	RESEARCH FEES	\$
880.109	MISC REVENUE: (IDENTIFY)	\$
520.000	OTHER (P-6): (IDENTIFY)	\$

WATER RIGHTS:

842.001	SURFACE WATER	EXAM FEE	842.002	RECORD FEE
842.003	GROUND WATER	\$	842.004	\$
842.005	TRANSFER	\$	842.006	\$

WELL CONSTRUCTION

842.022	WELL DRILL CONSTRUCTOR	EXAM FEE	842.023	LICENSE FEE
842.016	WELL DRILL OPERATOR	\$	842.019	\$
_____	LANDOWNER'S PERMIT	\$	842.024	\$

06-00-0 WELL CONST START FEE

842.013	WELL CONST START FEE	\$	CARD #	
_____	MONITORING WELLS	\$	CARD #	

45-00-0 LOTTERY PROCEEDS

864.000	LOTTERY PROCEEDS	\$
---------	------------------	----

07-00-0 HYDRO ACTIVITY

842.011	POWER LICENSE FEE(FW/WRD)	LIC NUMBER	\$
842.115	HYDRO LICENSE FEE(FW/WRD)		\$
_____	HYDRO APPLICATION		\$

RECEIPT # **95574**

DATED: 12-29-92 BY: D. Bushnell

RECEIVED

DEC 28 1992

WATER RESOURCES DEPT.
SALEM, OREGON

M 22 75

NW COR
1/2 A B
CULLVER DEC
LOT 2

LOT 1

LOT 3

85-100

79-5301

INFORMATION ONLY

4-02

SEC. 11, T. 27 S., R. 7 W., W.M.

MELROSE

FLOURNEY

1700 2

1600

CALLAHAN

SEC. 11, T. 27 S., R. 7 W., W.M.

APPROX
1/4 COR

APPROX
1/4 COR

200
2000 M

SEC. 14, T. 27 S., R. 7 W., W.M.

4-00