

RECEIVED

REGISTRATION STATEMENT CLAIM OF BENEFICIAL USE ¹⁵ 1994

WATER RESOURCES DEPT.
SALEM, OREGON

File# SWR-310

INFORMATION: James L. or Karen Hazlett
PO Box 165
Glide, OR 97443

Located SE1/4NE1/4, 0.5 Ac, Section 12, T27S, R2W, WM.

On December 19, 1992, I made a survey of the above listed property and viewed the water system installed and in use. I used an assessor map and an aerial photo during the course of preparing this final proof survey and site map.

SOURCE: Water is taken from Little River, tributary to the North Umpqua River, the Umpqua River.

DIVERSION POINT: The diversion point is a natural depression in the south side of the river.

PUMP: Meyers 100 MM 1/3 hp pump, 1 1/4" suction, 1" discharge, 10 GPM.

PIPE: The water distribution main line is 1" PVC from the point of diversion to the lawn or garden area. The lawn or garden is irrigated with hoses attached to standpipes and feeding garden sprinklers.

USE(S): Water is used for lawn or non-commercial garden.

HEAD: Elevation difference between the point of diversion and the highest point on the lawn or non-commercial garden was estimated to be twenty feet.

CALCULATIONS:	Lawn or non-commercial garden		
	0.5 ac @ 1/80 cfs/ac	0.006 cfs	2.4 GPM
	pump capacity	0.022 cfs	10.0 GPM

POINT OF BEGINNING: Assessor's maps and aerial photos were used to draw the accompanying map.

RECEIVED

Sheet 2 of 2
JUL 15 1994

WATER RESOURCES DEPT.
SALEM, OREGON

REMARKS: None.

The final proof survey and inspection of the use as found to be completed under terms and conditions of File# SWR-310 was completed by me on December 19, 1992, and the facts contained in this report and accompanying vested water right map are correct to the best of my knowledge.



I, James L. Hazlett, agree to the findings of the CWRE and do submit this site report and map as my Registration Statement Claim of Beneficial Use of the water provided under the terms and conditions of my File# SWR-310.

James L. Hazlett
James L. Hazlett

T27S. R2W.WM

SCALE 1" = 1320'
COUNTY OF DOUGLAS

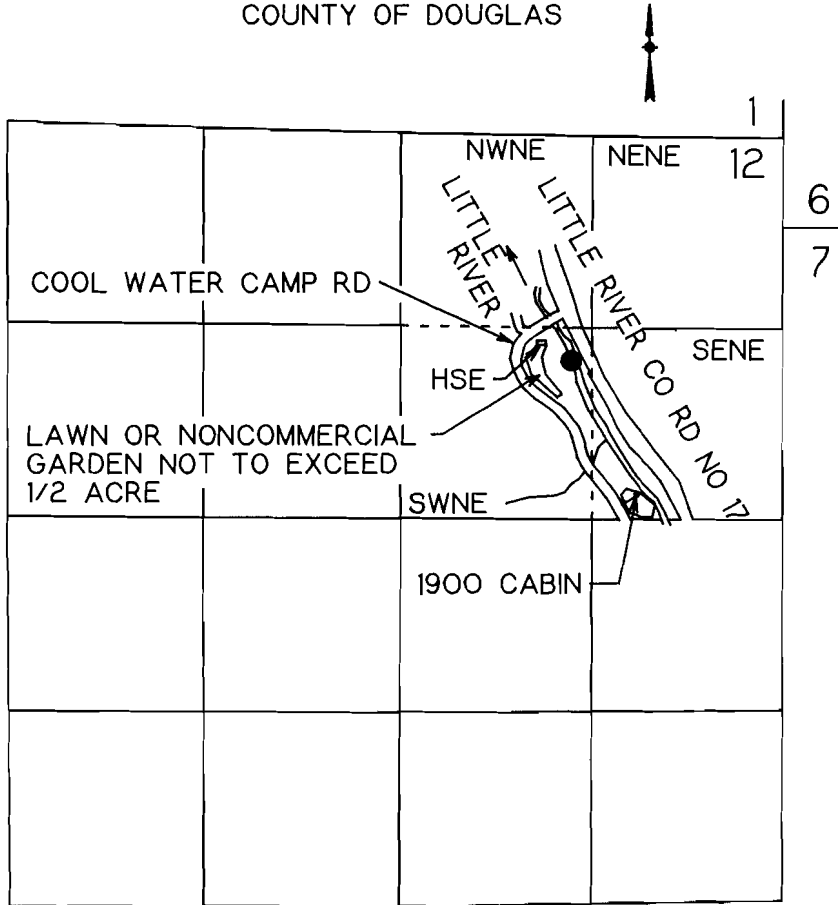

POD IS 1090 FT N AND 1460 FT W FROM E 1/4 COR SEC 12

VESTED WATER RIGHT MAP

PRE-1909 CLAIM OF BENEFICIAL USE

THIS IS A LOCATION MAP FOR A VESTED WATER RIGHT BY JAMES OR KAREN HAZELETT. THIS MAP IS FOR THE PURPOSE OF IDENTIFYING THE LOCATION OF THE VESTED WATER RIGHT ONLY AND IS NOT INTENDED TO PROVIDE LEGAL DIMENSIONS OR LOCATIONS OF PROPERTY OWNERSHIP LINES.

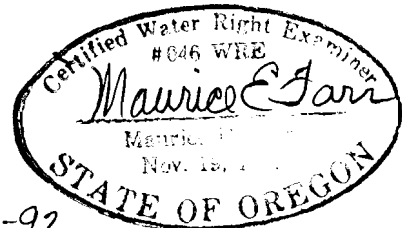

12-92

PRE-1909 VESTED WATER RIGHT CLAIM
T 27 R 2W S 12, Willamette Meridian

Chronological facts

1/8/1902 Nels Nelson settled T27 R2 S12 NE Quarter
6/15/1908 Nelson filed Notice for Publication and Final Proof of Settlement
12/14/1908 Nelson's homestead was evaluated by the Deputy Forest Supervisor.
1/14/1908 Forest Officer for Umpqua National Forest recommends granting the patent to Nelson.
1/16/1908 Acting District Forester recommends granting the patent.
9/2/1909 Nelson patent was issued.
10/9/1909 Deed issued to Nelson was recorded in Douglas County.
Property held from 1902 until 1934 by Nels Neslon.
10/2/1934 Property was sold to Hilda Poore
4/23/1936 Mortgage agreement was issued by Howard and Hilda Poore to sell the property to Iaasac and Anna Heitman. This agreement was extended in December of 1938 and paid in full on 4/9/1942 (recorded on 4/20/1942).
6/14/43 I. Heitman (widower of Anna Heitman) and Inga Bee Heitman sold the property to A. J. Young
1958 A. J. Young passed away and the property passed to his heirs.
3/25/1963 A. J. Young heirs sold the westerly portion (containing 60 acres) of Nelson forest homestead to Calvin D. and Lillie S. Willis
4/15/74 Calvin and Ramona Willis subdivided the properties for development to homesites
Richard and Billie Toleno purchased Lot 1 Block 3 of the Forest Haven First Addition Subdivision. This lot already had subsurface septic approval.
1990 Norman and Kimberly Combs assumed the property in a transfer between related parties. Intent is to develop the parcel for residential living.
1991 James and Karen Hazlett began residing on lot 2 of block 3.

In 1908 the examining forester noted 3 houses on the property. One house was owner occupied. By studying the field notes of the forester, it was concluded that one of the other 2 houses was rented.

In a conversation with 84 year old Lova Young, one of the remaining A. J. Young heirs, additional information was gathered on A. J. Young and his life and use of properties owned by him.

A. J. Young was on a number of banking boards in Wisconsin before coming to Roseburg. When he relocated to Douglas County, he made his living through investment property management.

Mrs. Young confirmed that A. J. Young invested in many rental properties. Included in the rental properties were cabins in Tiller, residences and commercial properties in Roseburg and this subject property on Little River. Mrs Young further stated she doubted the present existance of proof that the Little River property was used for rental income but since the timber on the property was immature and there were cabins on the property, her father-in-law (A. J. Young) would have used it to generate rental income. In speculation, he probably would have purchased the property for that primary purpose especially if it was being used for rental income prior to his purchase.

Timber revenue would be a longer range goal. The property was logged minimally in 1947 and 1948. Rental of cabins on the property was probable and would have continued until the sale of the property in 1963.

In addition to Mrs. Young's information, Calvin Willis indicated that one of the A. J. Young heirs, "Brig" Young mentioned a farmer pasturing goats in the meadow at the location of lots 1 and 2, Block three. This is also where cabins, barns, gardens and water systems existed.

It is concluded that from the time Nels Nelson sold this property until the time Calvin Willis purchased 60 acres of the property, it was used as rental income property with continued water use. At one point, a right-of-way was granted on a portion of the property to the then named "Roseburg Lumber Company" specifically for the purpose of obtaining water. These events would not have occurred if any indication existed showing water rights to Little River were not part of the ownership of this land.

In performing research on the use of this land, we spoke with a number of government agencies including the U. S. National Forest Service, the Douglas County Assessor's Office, the Douglas County Clerk's Office and their Archives Division as well as the Timber Tax Department of the State of Oregon and the Douglas County Surveyor's Department. The one common statement from each of these departments related to the lack of complete or orderly records from the past. We also learned that aerial photos and physical assessments for that area were either not done at all or sporadic due to a lesser degree of population..

We are of the opinion that the use of the property between the ownership of Nels Nelson and Calvin Willis was for investment income including rents. We further believe that no 5 year break occurred on this property for the use of water from either Little River or any unnamed creek or springs.

Additional information on this property is still being sought. This includes but is not limited to aerial photos, assessments, tax information and other information.

Forest Homestead Entry
Historical Records Inventory
for the
Umpqua National Forest*

DEC 20 1982

Compiled by

Gerald W. Williams, Ph.D.
Sociologist and Social Historian

November 2, 1981

*Note: The following historical records inventory, for forest homesteads, was compiled from recently discovered Umpqua National Forest documents. The forest homestead claims, which date between 1906 and 1937, comprise the majority of the documents. These historical records are stored at the Umpqua National Forest in Roseburg, Oregon. The inventoried record files consist of official correspondence and internal reports between the U.S. Forest Service, Department of Interior (General Land Office), and the homestead claimants. Many of these homestead claims were patented and presently are inclusions within the Umpqua National Forest boundary. Others are now outside the Forest boundary, with many homesteads adjacent to the Roseburg District of the Bureau of Land Management.

Forest Homestead Entry Records

The following inventory of 218 forest homestead entry records is listed alphabetically by last name. Some of the records consist of one or two pages of material, while others are several inches thick. The majority of these claims were filed under various homestead acts, including the June 11, 1906 Act (34 Stat. 233). As the records indicate, many homestead claims had been established by "squatters" after 1900. Approximately one-half the claims were allowed to be patented. The remainder of the homestead claims were either denied patent, relinquished to the Government by the claimant, or the information was not available in these records. In addition, a number of homestead entry applications were appealed by the USFS on the grounds that the claimant did not fulfill the homestead requirements and in a few cases, the Forest Officers believed timber fraud was intended. A more comprehensive inventory of each record folder is planned.

A brief explanation of the codes used in the following inventory, is in order:

- Claim = Lists which of the various homestead acts the claim was filed under, if known.
- Location = The legal township, range, and section location of the homestead entry claim. The exact location within each section is omitted. The legal locations are the same as listed in the records, with several exceptions in the unsurveyed areas. The homestead claim locations in unsurveyed townships have been adjusted to reflect current land surveys and are noted in the inventory.
- HE = Homestead Entry identification number assigned by the Department of Interior, General Land Office.
- HA = Homestead Application identification number assigned by the Umpqua National Forest, prior to HE listing by the General Land Office.
- Ser. = Serial identification number of the homestead entry assigned by the General Land Office. Often, the serial number is the same as the HE number.
- HES = Homestead Entry Survey identification number. The HES was a comprehensive ground survey and report conducted by a licensed Forest Service land surveyor.
- Patent = Refers to the status of the homestead entry claim, especially if the claim was allowed by the U.S. Government to be patented (owned) by the claimant and the date of that status.
- Photographs = Dates of original photographs of the homestead.
- File dates = The earliest and latest dates of the correspondence in the file folder.

Mulvihill, Cornelius
Claim - June 11th Act?
Location - T. 30S., R. 1W., 32
Identification - HE 10591
Ser.
HES
Patent recommended 1/6/09
File dates - 1908-09

Neal, Lydia
Claim - June 11th Act
Location - T. 26S., R. 1W., 8
Identification - HE 09846
Ser.
HES
Patent 736009 (2/21/20)
Photographs - 9/13/19
File dates - 1919-20

Nelson, Nels
Claim - Homestead Laws
Location - T. 27S., R. 2W., 12
Identification - HE 13700
Ser.
HES
Patent 77328 (9/2/09)
File dates - 1908-09

Norman, Walter A
Claim - June 11th Act
Location - T. 31S., R. 1W., 32
Identification - HE 08801
Ser. 08801
HES
Patent recommended 8/26/16
File dates - 1916

Norman, William S.
Claim - June 11th Act
Location - T. 31S., R. 1W., 34
Identification - HE 08505
Ser. 08505
HES
Patent 677866 (5/15/19)
File dates - 1917-19

Olinghouse, Charles W.
Claim - Homestead Laws
Location - T. 31S. R. 3W., 22
Identification - HE 12325
Ser.
HES
Patent certificate issued 10/2/08
File dates - 1908

Kimberly A. Combs
1537 SE Jackson St.
Roseburg, OR 97470

United States Dept of the Interior
Bureau of Land Management
National Archives
Washington, DC 20409

December, 15, 1992

I am seeking information on a section of land near Little River in Douglas County, Oregon. The exact area I am interested in is Township 27 South, Range 2 West, Section 12, the Northeast Quarter, Willamette Meridian.

Information of primary interest regards a Forest Homestead application bearing the entry number 13700 by one Nels Nelson as claimant. Patent number 77328 was issued on this land on September 2, 1909 with reference to the Roseburg, Oregon office #0250.

I would like to know what information is contained within this file and what the cost would be to secure legible copies for my files.

I may be reached 8 am to 1 pm and 2 pm to 5 pm Pacific Coast time at (503) 440-4222 or at (503) 672-7216 at other times.

Your assistance is greatly appreciated.

Sincerely,

Kimberly A. Combs

Kim Combs & myself K. Hazlett worked together to gather information, our property is adjoining and was one before subdivision in 1974

United States
Department of
Agriculture

Forest
Service

Umpqua National Forest
P.O. Box 1008
Roseburg, OR 97470
(503) 672-6601

REPLY TO: 1680 History
DATE: November 13, 1992

To Whom It May Concern:

The following Forest Homestead Act of 1906 records were copied from originals in the archives of the Umpqua National Forest, Roseburg, Oregon. These records were copied at the request of Kim Combs.

The file concerns the homestead application of Nels Nelson in Township 27 South, Range 2 West, NE 1/4 Section 12, Willamette Meridian. The land was, during 1909 until Patent, was within the external boundaries of the Umpqua National Forest. The short file begins with a U.S. Department of the Interior (USDI) "notice for publication" dated July 20, 1908 and ends with a one sheet patent #77328 dated September 25, 1909.

The file, which is copied, contains:

USDA Report of Agricultural Settlement	Dec 23, 1908
Field notes for the Report	n.d.
Site map to accompany the Report?	n.d.
USDA Form 308 recommending Patent	Jan 16, 1909
USDI notification of Patent	Sept 25, 1909

Sincerely,

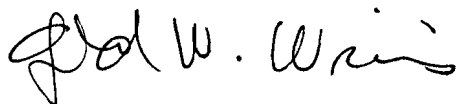

GERALD W. WILLIAMS
Sociologist and Social Historian
Umpqua National Forest

United States
Department of
Agriculture

Forest
Service

Umpqua National Forest
P.O. Box 1008
Roseburg, OR 97470
(503) 672-6601

REPLY TO: 1680 History
DATE: November 13, 1992

To Whom It May Concern:

The following Forest Homestead Act of 1906 records were copied from originals in the archives of the Umpqua National Forest, Roseburg, Oregon. These records were copied at the request of Kim Combs.

The file concerns the homestead application of Nels Nelson in Township 27 South, Range 2 West, NE 1/4 Section 12, Willamette Meridian. The land was, during 1909 until Patent, was within the external boundaries of the Umpqua National Forest. The short file begins with a U.S. Department of the Interior (USDI) "notice for publication" dated July 20, 1908 and ends with a one sheet patent #77328 dated September 25, 1909.

The file, which is copied, contains:

USDA Report of Agricultural Settlement	Dec 23, 1908
Field notes for the Report	n.d.
Site map to accompany the Report?	n.d.
USDA Form 308 recommending Patent	Jan 16, 1909
USDI notification of Patent	Sept 25, 1909

Sincerely,

GERALD W. WILLIAMS
Sociologist and Social Historian
Umpqua National Forest

State of Oregon
County of Douglas ss.

Suscribed and sworn before me on this 16th day of DECEMBER, 1993.

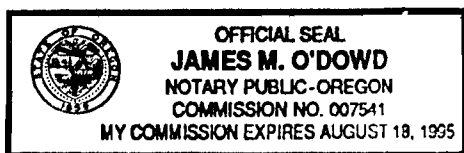

DEPARTMENT OF THE INTERIOR,
UNITED STATES LAND OFFICE,

UFO 23 032

0250

Roseburg, Oregon,

July 20, 1908

Mr H. M. Hale,
Roseburg, Oregon,

Dear Sir:

Enclosed herewith is copy of notice for publication in connection with the final proof on H. E. No. 13700, S. E. No. 0200 of *Milo Nelson*, for the $5^2 N 2^4 E$, $N 2^4 N 2^4 E$ Sec. 12, T²⁷ South, Range 2 W. Will. Mer., filed June 10, 1903 on which date for final proof has been set.

Yours very truly,

Bey Ledy
Register.

1 enclosure

Reg mail.

UNITED STATES DEPARTMENT OF AGRICULTURE
FOREST SERVICE

REPORT ON AGRICULTURAL SETTLEMENT.

Umpqua National Forest,

Roseburg, Land District.

1. Location of settlement or farm: S 1/2 NE 1/4, N 1/2 NE 1/4 Sec. 12
(If land is surveyed, describe it by subdivisions; if unsurveyed, describe by streams or other natural

T 27 S R 2 W WM.

landmarks, distances, and directions. Add a sketch map, if necessary.)

2. Name of present claimant or owner: Nels Nelson

Address of present claimant or owner: Peel, Ore.

3. If claimant has a family, of what members does it consist? Single, no family

(Is their only home on this claim?)

4. Is the land patented or held as a homestead or other entry, mining claim, or simply as a squatter location? Give number of entry: H. E. 13700

5. Description of house, giving size, materials of which built, and number of rooms: 3 houses

Present residence hewed log house with fireplace, 4 windows, 2 doors 22ft, x 12ft, x 10ft post- 2 rooms. & woodshed. A very good house and well constructed value \$300. House No. 2 14' x 16' one room, log \$100. House #3 10' x 12' one room, split boards value \$50.

6. Description of barn and other outbuildings by size and materials:

Barn, Split boards. 24' x 25' x 8' post value \$75.

(What is their probable value?)

7. How much of the land is suited to tilling? 60 to 75 Acres

Acres of land under plow: between 3 and 4 Acres of land under fence: approx 4

Acres of land under ditch: all the cleared land ditched on one side
for drainage purposes

8. What does claimant raise on the land? ^{for own use} hay, potatoea, carrots and garden vegetables

How much was raised the past season? ~~carrots 1 ton; Potatoes 20 bu.; Hay 1 1/2~~
~~garden truck enough for own use during the year.~~

3 AM; 1905 cleared 1 1/2 A. 1906 1 1/2 A. 1907 took out stumps on cleared
9. Number of acres of timberland on the claim: 130 A. 1908 no clearing. land

Estimated number of feet of timber in board measure: approximately three million fir.

How much, if any, timber has been cut? not more than 25 thousand ft.

For what purpose cut? clearing

By whom cut? claimant Date of cutting: since settlement

If cut for cultivation, has the ground where the timber stood been cultivated, and how cultivated? well cultivated. roots grubbed out and plowed.

If cut for improvements, was the whole amount of timber cut put into improvements on the claim?
yes

Has claimant sold or negotiated for the sale of any timber?

no

10. Live stock owned by claimant:

Number of cattle: none Number of horses: rents two

Number of sheep: none Number of goats: none

Where are they grazed?

Has permit been obtained for them to graze on public land?

11. Date claimant settled on this land: Jan. 8, 1902

Date claimant filed on this land: June 15, 1903

Date claimant established actual residence on this land: Jan 8, 1902

State whether claimant has lived continuously on land, or only at certain times:

practically continuous - has worked out for a few days for
near farmers in addition to absences noted below.

Give dates and duration of and reasons for absences, and report if family remained on land

during such absences. Give source of information: 1902 Absent Sept - Oct. Coos Bay
1903 Absent Sept - Oct. Worked Coos Bay, Saw Mill
1904 " " " " in Albany, Ore.
1905 " about 3 months in the Fall, Worked Roseburg Brick Yard.
1906 " " 1 " " " Worked prune drying
1907 " " 1 " " " Worked on Forest Service Trail.
1908 " " 2 1/2 " " Jy. Aug. & Sept. " " "
Actual residence averages 9 mos. or more including all absences.

Plow, drag, double harness, 2 saddles, hoes, grub hoes, axes, hew, saws, and various other impliments

What evidences of residence, such as cultivation or presence of farming implements or household

furniture, were found by Forest officers? 1 #7 stove; dishes for about 4 people

3 chairs, w tables, bed and blankets, gun, small set carpenter tools

grub stake for about 6 months

12. Is the claim used in any way for trade or business? no.

13. Ascertain, if possible, whether this claimant has ever made a homestead entry elsewhere; if so, state where, and whether it has been perfected or abandoned: no

14. Has claim been sold or mortgaged? no

15. If this claim or entry is believed to have been made at the instance or in the interest of any others, or believed to be in any way fraudulent, give name, residence, and post-office address of reliable witnesses and abstract of their testimony:

16. For what purpose is the land most valuable? timber at present tho its timber value is small and the agricultural value is still smaller but its location on the river makes it a fairly desirable place of its kind.

17. Date Forest officer examined this claim: Dec 14, 1908

18. Remarks:

19. Recommendation as to action that should be taken, and reasons for the recommendation:

Claimant has complied with the H.L. Law and patent should therefore issue.

Dated at Roseburg, Ore., 190 8

Dec. 25. 1908

A. M. Hale
Deputy Forest Supervisor Forest Ranger.

Approved Jane 14, 190

S. C. B.

Forest Supervisor.

Respectfully forwarded to Forester.

1/17/08

REPORT OF

.....
Forest Supervisor,

.....
(P. O. address.)

....., 190

REPORT ON

AGRICULTURAL SETTLEMENT

OF

.....
(Name of settler.)

IN

.....
NATIONAL FOREST.

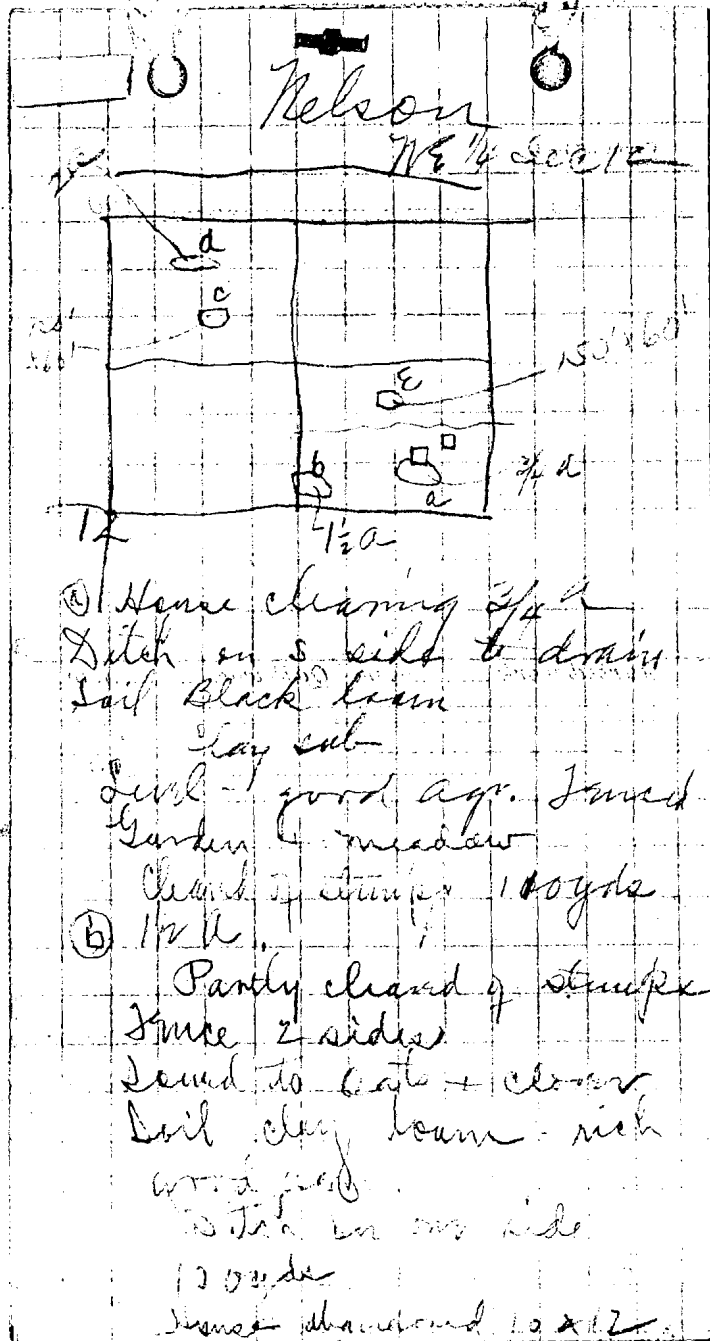

- (a) Home clearing 3/4 a
Ditch on s side to drain
Soil Black loam
Hay cut
Level - good agr. Fenced
Garden meadow
Clear of stumps 100 yds
- (b) 1/2 a
Partly cleared of stumps
Fence 2 sides
Level to gate + clear
Soil clay loam - rich
wood shed
Ditch on one side
100 yds
House abandoned 10 x 12

8

8

Mison

Similar to - small

young growth
2 1/2
2 8"
2 7"
1 6"
1 8"
1 7"
1 7"
1 6"
1 2"
1

big pine
2 1/2

Cranny C 100' x 60'
Clear & hard oak
Slopes 15-20% S.
Soil - brackly loam rich
good as the slope
Timber on NW 40 very
poor perhaps 100 ft. or
plenty uprod.

1902

190

Form 874-2



N. W. 40

About 2/3 possible of
cultivation. 1/3 would
make pasture.
Think little value

Wild meadow.
soil very shallow rock
out crops in one place.
soil gravelly clay loam
connd. w. small boulders
Grows some hay.

Clearing N side 7000
15' x 60' - cleared of stumps
& trees
Clay loam w. clay sub.
rich good agr
Sand level. Rich good
spuds
Fenced w. barbed wire
good fence
75 ft ditch

Started work _____ a. m. Quit work _____ p. m.

190

Form 874-2

Shrubbery

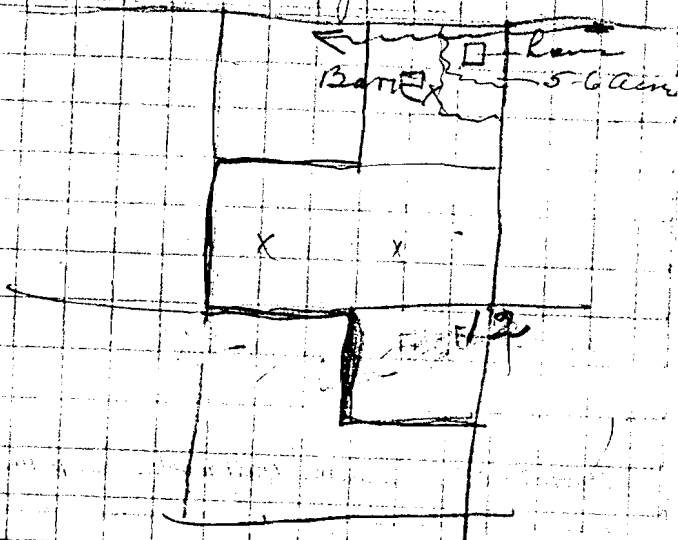

Cleaning - Mr. W
Clear 5-6 acres free of
stumps + plowd.

4-5 acres staked, burned
+ sowed but not cleared
of stumps or logs

Soil - clay loam

Started work _____ a.m. Quit work _____ p.m.

190

Form 874-2

Barn 28 x 28 w/ post
includes closed shed
Chicken house 10 x 10
\$1100.00

House 16 x 22 x 11 ft
2 Run up & down stairs
\$175.00

Rust house 16 x 14 - \$50

Farm tools

Plow & harrow, 3 gal. cans
6 axes - wedges etc
Garden tools

2 beds bedding

1 stove

5 chairs

Cooking out fit & dishes
for 2 or 3 persons
clothing

Not sold or recorded

ST. 110 110 110

Started work a. m. Quit work p. m.

190

Form 874-2

Juice Approx 800
pocket lunch \$80

50 rods rail fence \$75

Hay 1 1/2 ton
Spuds 50 bu
Corn 10 bu
Onions 1 bu

Garden truck
3 bu melons

Christmas 17

Garden 100 x 75 ft

Nels Nelson

Form 974.

T 27

P. 2 W

Mer.

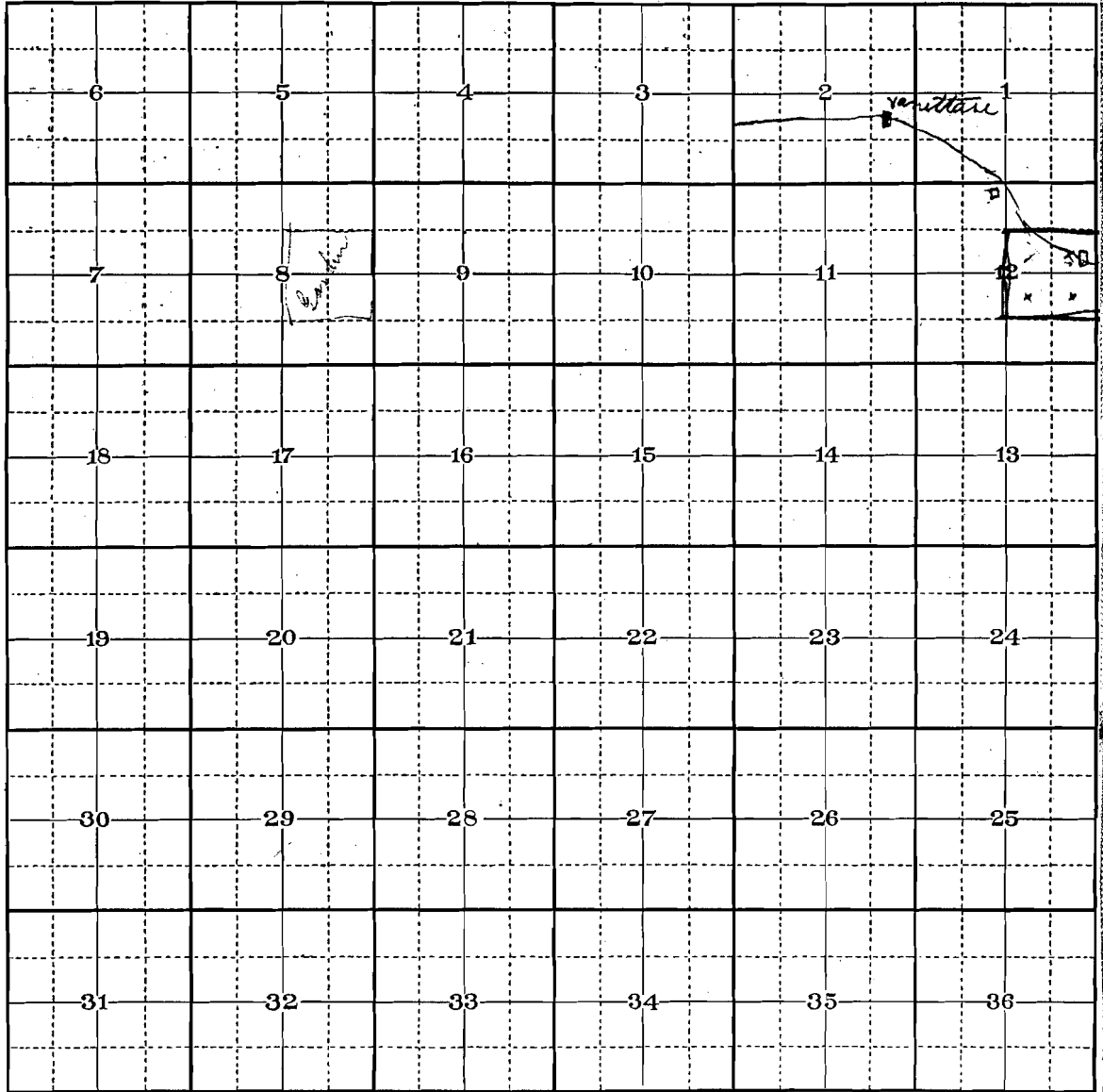

8-257

SCALE.—One inch = 1 mile.

DEC 20

1911

Form 308

FOREST SERVICE
National Forest
Umpqua
ROSEBURG, OREGON
JAN 19 1909
RECEIVED
Answered.....

UNITED STATES DEPARTMENT OF AGRICULTURE
FOREST SERVICE
DISTRICT NO. 6

OL
Umpqua, Claims,
Nelson, Hals,
H.E. 13700,
Roseburg.

BECK BUILDING
PORTLAND, OREGON

January 16, 1909.

The COMMISSIONER

of the General Land Office.

Sir:

A report has been received from the Forest officer
in charge of the Umpqua National Forest,
dated January 14, 1909, on H. E. No. 13700, Hals Nelson,
claimant, Roseburg, Oregon, Land District,
for the S/2 NE/4, N/2 NE/4 Sec. 12, T. 27 S., R. 2 W., W.M.

I recommend that patent issue.

The Forester will be glad to be informed of any ac-
tion taken on the entry.

Very respectfully,

Geo. H. Seall,

Acting District Forester.

For information of Supervisor.

DEC 23 1908

WILLIAM S. BROWN
DISTRICT FORESTER

DEPARTMENT OF THE INTERIOR,

UNITED STATES LAND OFFICE,

Roseburg, Oregon.

(Place.)

September 25, 1909.

(Date.)

0250

FOREST SERVICE

National Forest,

(Umpqua

ROSEBURG, OREGON

SEP 28 1909

RECEIVED

Answered.....

MR. S. C. Bartrum, Forest Supervisor,

Roseburg,

Oregon.

Dear Sir:

Notice is hereby given that under date of September 2, 1909, patent No. 77328 issued to Nels Nelson, for the NE $\frac{1}{4}$, Sec. 12, in Tp. 27 S., of R. 2 W., Will. Mer., within the confines of the Umpqua National Forest.

Very respectfully,

J. Benj. L. Eddy
Register.

E.R.F.

The United States of America,

Roseburg 0250.

Be all to whom these presents shall come, Greeting:

Homestead Certificate No.

Application

WHEREAS There has been deposited in the GENERAL LAND OFFICE of the United States a Certificate of the Register of the Land Office at Roseburg, Oregon, whereby it appears that, pursuant to the Act of Congress approved 20th May, 1862, "To secure Homesteads to Actual Settlers on the Public Domain," and the acts supplemental thereto, the claim of

WELLS WELSON

has been established and duly consummated, in conformity to law, for the northeast quarter of Section twelve in Township twenty-seven south of Range two west of the Willamette Meridian, Oregon, containing one hundred sixty acres,

according to the Official Plat of the Survey of the said Land, returned to the GENERAL LAND OFFICE by the Surveyor General;

NOW KNOW YE, That there is, therefore, granted by the UNITED STATES unto the said Wells Welson

the tract of Land above described; TO HAVE AND TO HOLD the said tract of Land, with the appurtenances thereof, unto the said Wells Welson

and to his heirs and assigns forever; subject to any vested and accrued water rights for mining, agricultural, manufacturing, or other purposes, and rights to ditches and reservoirs used in connection with such water rights, as may be recognized and acknowledged by the local customs, laws, and decisions of courts; and also subject to the right of the proprietor of a vein or lode to extract and remove his ore therefrom, should the same be found to penetrate or intersect the premises hereby granted, as provided by law. And there is reserved from the lands hereby granted, a right of way thereon for ditches or canals constructed by the authority of the United States.

IN TESTIMONY WHEREOF, I, William N. Taft, President of the

United States of America, have caused these letters to be made Patent, and the seal of the General Land Office to be hereunto affixed.

(SEAL)

GIVEN under my hand, at the City of Washington, the SECOND day of SEPTEMBER, in the year of our Lord one thousand nine hundred and NINE, and of the Independence of the United States the one hundred and THIRTY-FOURTH.

By the President:

By

Wm. N. Taft

W. J. ...

Secretary.

Recorder of the General Land Office.

THE UNITED STATES OF AMERICA.

Homestead Certificate No. Washington, 0250
Application

To all to Whom these Presents shall Come—GREETING:

WHEREAS, There has been deposited in the General Land Office of the United States a Certificate of the Register of the Land Office at Besburg, Oregon whereby it appears that, pursuant to the Act of Congress approved 30th May, 1862, "To Secure Homesteads to Actual Settlers on the Public Domain," and the acts supplemental thereto, the claim of Mela Nelson has been established and duly consummated, in conformity to law, for the northeast quarter of Section twelve in Township twenty seven, South of Range two west of the Willamette Meridian, Oregon, containing one hundred sixty acres.

according to the Official Plat of the Survey of the said Land, returned to the General Land Office by the Surveyor General.

NOW, KNOW YE, That there is, therefore, granted by the United States unto the said

Mela Nelson

the tract of land above described:

TO HAVE AND TO HOLD THE SAID TRACT OF LAND, with the appurtenances thereof, unto the said

Mela Nelson

and to her heirs

and assigns forever, subject to any vested and accrued water rights for mining, agricultural, manufacturing or other purposes, and rights to ditches and reservoirs used in connection with such water rights, as may be recognized and acknowledged by the local customs, laws and decisions of Courts, and also subject to the right of the proprietor of a vein or lode, to extract and remove his ore therefrom, should the same be found to penetrate or intersect the premises hereby granted, as provided by law, and there is reserved from the lands hereby granted a right of way thereon for ditches or canals constructed by the authority of the United States.

IN TESTIMONY WHEREOF, I, William H. Taft

President of the United

States of America, have caused these letters to be made Patent, and the Seal of the General Land Office to be hereunto affixed.



Given under my hand, at the City of Washington, the second day of September, in the year of our Lord one thousand nine hundred and nine, and of the Independence of the United States the one hundred and thirty fourth

BY THE PRESIDENT: Wm H Taft

Patent Number By M. H. Young Secretary.

Recorded by H. J. Sanford Recorder of the General Land Office.

Filed for Record at Besburg, Oregon on November 9 A. D. 1909, and recorded at the request of

By Peter H. Smith Deputy.

Esthera
County Clerk

File No.	TIME OF RECEPTION		GRANTOR	GRANTEE	INSTRUMENT	TO WHOM DELIVERED
	Year	Month Day a.m. p.m.				
5375	Nov	5 10	Ada Harding et al	E. A. Urney	Deed	Douglas Nat. Bank
5376	"	"	W. Prior	C. M. Hunkley et al	Release	" " "
5377	"	"	J. W. Young	C. E. & Russell	Release	1st Nat. Bank
5378	"	"	Southern Bk. Co.	C. E. & Russell	Mtg.	" " "
5379	"	"	C. E. & Russell	Southern Bk. Co.	Deed	" " "
5380	"	"	Ella Hall	Phoebe McCoy	Mtg.	Phoebe McCoy
5381	"	"	Sallie A. Moore et al	Wm M. Moore	Deed	Wm M. Moore
5382	"	"	E. Lee et al	Martha C. Lee	Deed	Mrs. M. E. Lee
5383	"	"	John Applegate		affidavit	
5384	"	"	R. J. McLaughlin	R. W. Bumgarner	Deed	R. W. Bumgarner
5385	"	"	Lucia A. Smith	Rockwell Nat. Bk.	Asson.	Rockwell Nat. Bank
5386	"	"	Har. K. Brown	M. W. French	Release	" " "
5387	"	"	3rd Chas. Bernard et al	H. L. Browning	Mining Deed	H. L. Browning
5388	"	"	Marvin Hervey	H. L. Browning	Deed	"
5389	"	"	J. W. Booth et al	W. C. Hardison et al	Deed	See file
5390	"	"	H. Dyer	Notarial Commission		H. Dyer
5391	"	"	Glendale State Bk.	Walter George Eatis		Glendale News
5392	"	"	Blair K. Gilbertson	Katrina Edin	Datis	Katrina Edin
5393	"	"	M. A. Wagner	Glendale State Bank	Mtg.	Glendale State Bank
5394	"	"	C. E. Fields et al	R. J. Fausch et al	Mtg.	R. J. Fausch et al
5395	"	"	E. Chace	W. W. Quinn	Datis	U. S. Dist. Ct. & Archery Co.
5396	"	"	P. L. Sanders	State Land Board	Mtg.	C. O. Watson
5397	"	"	N. N. Crutman	L. M. Carroll	Deed	L. M. Carroll
5398	"	"	J. H. Carroll	L. M. Carroll	"	" " "
5399	"	"	A. D. Sain	L. M. Carroll	"	" " "
5400	"	"	2. W. Pickett et al	Ed. Smith	Chat Mts	Ed. Smith
5401	"	"	E. L. Brown et al	Ernest L. Piddle	Agreement	Ernest L. Piddle
5402	"	"	A. Creason	Robt. Hathaway	Deed	Robt. Hathaway
5403	"	"	1 Edward Smith	Douglas County	Deed	See file
5404	"	"	U. S.	Frank Hill	Pat.	Glendale State Bank
5405	"	"	Cor. A. Noble	Geo. H. Kesterson	Deed	1st Nat. Bank
5406	"	"	Geo. H. Kesterson	Chas. A. Betcher	Deed	" " "
5407	"	"	Geo. E. Manning et al	Har. L. Mabie	Deed	E. J. Young et al
5408	"	"	Page Dimmick	E. J. Fritta et al	Deed	Page & Dimmick
5409	"	"	W. J. Cody	R. W. Hayward	Mtg.	W. J. Cody
5410	"	"	U. S.	E. L. Fritta	Pat.	Douglas, Abs. Co.
5411	"	"	Be. Gilbert et al	John Enger	Mtg.	John Enger
5412	"	"	U. S.	Olus. F. Gattoche	Pat.	Olus. F. Gattoche
5413	"	"	Ox. C. RR Co.	" " "	Deed	" " "
5414	"	"	5. Balph Spiker	Geo. H. Smith	Bill of Sale	A. M. Orcutt
5415	"	"	U. S.	Neil Nelson	Pat.	Neil Nelson
5416	"	"	Corey, James	J. M. Lewis	Mtg.	J. M. Lewis
5417	"	"	W. J. Eger	W. J. Eger	Release	C. M. Noy
5418	"	"	J. J. Eger	W. J. Eger	Deed	" " "

When Received			Where Forwarded		FEES	TOTALS	RECEIVED BY COUNTY TREASURER			REMARKS
Month	Day	Year	Vol	Page			Month	Day	Year	
Nov	11	07	63	322	1.00					City
"	13	"	26	277	.60					"
"	"	"	26	277	.60					City
"	"	"	26	278	2.00					"
Nov	11	09	63	322	.80					"
"	13	"	26	279	1.00					City - Call
"	"	"	63	323	3.00					Drain, St.
"	11	"	63	325	1.00					Yoncalla, Or.
"	"	"	63	325	.70					"
"	13	"	26	280	.60				743 Mar. 75 St	Seattle Wash
"	"	"	26	280	.40					City
"	"	"	26	281	.60					"
"	19	"	3	493	.60					Buckles, Or.
"	"	"	3	478	.40					"
Nov	11	03	63	326	.60					Office
"	"	"	1	10	.50					W. Supt's Cook Or.
"	13	"	26	281	.40					Glendale, Or.
"	"	"	26	282	.40					Glendale, Or.
"	"	"	26	282	1.00					Glendale, Or.
"	20	"	26	283	1.00					City
"	13	"	26	283	.40				131 Third St. B. 12	Portland, Ore.
"	17	"	26	284	1.20					City
Nov	11	09	63	326	1.20					"
"	"	"	63	327	1.00					"
"	"	"	63	328	1.00					"
Dec	1	"	3	478	1.00					Call
Nov	11	"	63	329	.60					Piddle, Ore.
"	17	"	62	561	.60					Echebrow, Ore.
"	11	"	63	329					No fee. County business in office	
"	17	"	40	443	.80					Glendale Or.
"	13	"	63	330	.60					Grants Pass Or.
"	"	"	63	331	.60					" " "
"	"	"	63	331	.60					Oakland Or.
"	20	"	26	285	.40					"
"	"	"	26	285	1.00					Yoncalla Or
Nov	13	09	65	114	.80					City
"	20	"	26	286	1.00					City
"	11	"	40	441	.80					Dillard Or
"	13	"	63	332	1.60					"
Nov	15	19	5	119	.60					City
* Nov	20	"	26	287	.80					Call
"	20	"	26	287	1.00					Glendale, Or.

Returned Jackson Co. Bond

X

Thelma Alley Perry)
State of Oregon)
County of Douglas) ss. this the 26th day of September 1934, before me the undersigned, a Notary Public in and for said County and State, appeared J E McClintock and A J Geddes, both to me personally known, who being duly sworn did say that he, the said J E McClintock is the Mayor, and the said A J Geddes is the City Recorder of the City of Roseburg, Oregon, the above named municipal corporation, and that the seal affixed to said instrument is the corporate seal of said City, and that said instrument was signed and sealed in behalf of said City by authority of its Common Council, and said J E McClintock and A J Geddes acknowledged said instrument to be the free act and deed of said City.

IN WITNESS WHEREOF I have hereunto set my hand and affixed my Notarial seal this the day and year first above in this my certificate written.

(Seal)

Paul E Geddes Notary Public for Oregon
My Commission Expires April 12, 1935.

Filed for record Oct 2, 1934 at 11:25 A M
Roy Agee, County Clerk

By *Edith R Jones* Deputy

NELS NELSON

TO

HILDA POORE

#95251

KNOW ALL MEN BY THESE PRESENTS, That NELS NELSON, unmarried in consideration of Ten (\$10.00) Dollars to be paid by HILDA POORE do hereby remise, release and forever QUITCLAIM unto the said Hilda Poore and unto her heirs and assigns all his right, title and interest in and to the following described parcel of real estate, situated in County of Douglas State of Oregon, to-wit:

The Northeast quarter of Section twelve (12) in Township twenty-seven (27) South of Range two (2) West of the Willamette Meridian, Oregon, containing one hundred sixty (160) acres.

TO HAVE AND TO HOLD, the same, together with all and singular the hereditaments and appurtenances thereunto belonging or in anywise appertaining to the said Hilda Poore and to her heirs and assigns forever.

108

D-96

IN WITNESS WHEREOF, I have hereunto set my hand and seal this 2nd day of October A D 1934.

EXECUTED IN THE PRESENCE OF

Nels Nelson

(Seal)

Olive Diller

W F Harris

STATE OF OREGON)

County of Douglas) ss

BE IT REMEMBERED, That on this 2nd day of October A D 1934 before me, the undersigned, a notary public in and for said County and State, personally appeared the within named Nels Nelson who is known to me to be the identical person described in and who executed the within instrument, and acknowledged to me that he executed the same freely and voluntarily.

IN TESTIMONY WHEREOF, I have hereunto set my hand and notarial seal the day and year last above written.

(Seal)

W F Harris Notary Public for the State of Oregon

My Commission Expires Jan 3, 1937.

Filed for record Oct 2, 1934 at 2:10 P M

Roy Agee, County Clerk

By *Hena C Green* Deputy

C A PUCKETT

TO

EMMA HARRIETT PUCKETT

#95252

THIS INDENTURE WITNESSETH, That C A PUCKETT, for and in consideration of One Dollar and love and affection has bargained, sold and forever quit-claimed, and by these presents do bargain, sell and forever quit-claim unto EMMA HARRIETT PUCKETT, my wife, an undivided one-half interest in and to the following described premises, to-wit:

Beginning at a point 20 and 55/100 chains North and 3 and 28/100 chains West from the Southeast corner of the J G Clark Donation Land Claim Number 51, in Township 30 South, Range 5 West; thence West 18 and 52/100 chains to a point in County Road; thence North 2 and 45/100 chains to a black oak tree 30 inches in diameter; thence North 11 and 50 M East 3 and 38/100 chains along the east line of A P Gillette land; thence East 15 and 8/100 chains to land of W Cornutt; thence South 7 and 45 M East 5 and 72/100 chains along land of W Cornutt to place of beginning containing 9 and 2/100 acres, more or less. Subject to all legal highways. This contains interest in the Elliott and Shaw Water Right; all lying and being in Douglas County,

The afforementioned easement and right-of-way is for the following purposes, namely: the perpetual right to enter and to erect, maintain, repair, rebuild, operate, and patrol one single pole structure (or multiple structure) electric power transmission and distribution line, and the necessary appurtenances thereto, including structural lines; the right to clear a right-of-way and keep the same clear of brush, timber, inflammable structures and fire hazards; and the right to remove danger trees, if any, located beyond the limits of said right-of-way.

It is understood and agreed that the United States of America or its assigns may grant any person, cooperative, corporation or agency, public or private, the right to place electric distribution line systems on the poles erected on the right-of-way hereby granted, to place on the right-of-way such additional poles and anchors as will be necessary to support the line, and thereafter to operate, repair, and maintain such additional systems and facilities.

TO HAVE AND TO HOLD the said easement and right-of-way unto the UNITED STATES OF AMERICA and its assigns forever. It is further understood and agreed by the undersigned that the payment of such purchase price is accepted as full compensation for all damages incidental to the exercise of any of the rights above described.

Douglas County, Oregon, covenants with the UNITED STATES OF AMERICA that it is lawfully seized and possessed of the lands aforesaid; has a good and lawful right and power to sell and convey the same; that the same are free and clear of all encumbrances, except as above noted.

IN WITNESS WHEREOF Douglas County, Oregon, a municipal corporation, pursuant to an order of the County Court, duly and legally entered, has caused these presents to be executed in its behalf by its Board of County Commissioners, and its corporate seal to be hereunto affixed this 8th day of April, 1942.

(county court seal)

MICHAEL B. BOULDER, Chairman of Municipal Corporation
By J. J. Eusemberg County Judge
By James Hutchinson Commissioner
By H. J. Houston Commissioner
Board of County Commissioners

STATE OF OREGON)
County of Douglas (ss

On this 9th day of April, 1942, before me appeared J. J. Eusemberg, County Judge of Douglas County, Oregon; and J. J. Eusemberg, County Commissioner; and H. J. Houston, County Commissioner; to me personally known, who being duly sworn, I say that they are the County Judge and County Commissioners; respectively, of Douglas County, Oregon, a municipal corporation and that the seal affixed to said instrument is the corporate seal of said corporation, and that said instrument was signed and sealed in behalf of said corporation by authority of its Board of County Commissioners, and said County Judge and Commissioners acknowledged said instrument to be the free act and deed of said corporation. In WITNESS WHEREOF, I have hereunto set my hand and affixed my official seal the day and year first above written.

(notarial seal)

Filed for record Apr. 20, 1942 at 2:43 PM
Mortgage County Clerk
By *Edith H. Jones* Deputy

Lyle Neys Bruex, Notary Public in and for the State of Oregon residing at Portland, Oregon.
My commission expires February 20, 1943

HOWARD D POORE et ux TO MICHAEL B BOULDER et ux 274757
County Clerk

The undersigned HOWARD D POORE and HILDA E POORE, husband and wife, of Los Angeles, California for and in consideration of the sum set forth below the receipt whereof is hereby acknowledged, do hereby grant to I LEITMAN and INGA BEE LEITMAN, husband and wife, residing in Los Angeles, California, all that real property situated in

The Northeast quarter (NE_{1/4}) of Section Twelve (12) in Township Twenty-seven (27) South, Range Two (2) West of the Willamette Meridian in the State of Oregon, containing 1.0 acres, county of Douglas, State of Oregon, bounded and described as above:

On this 9th day of April 1942, the undersigned issues this Grant DEED as payment in full and in full satisfaction of a MORTGAGE for the sum of One Thousand Three Hundred Fifty-One (1351.00) dollars, issued April 23rd, 1936, to I LEITMAN and ANNA LEITMAN, husband and wife, residing in Los Angeles, California, (Anna Leitman now deceased) the above described property.

The MORTGAGE above referred to was Recorded May 11th 1936, in Mortgage Records of Douglas County, Oregon, in Volume 50, page 513.

The MORTGAGE AGREEMENT was recorded December 3rd 1938, in Volume 52, page 411 of Mortgage Records of Douglas County, Oregon.

WITNESS their hands this 9th day of April 1942.

Howard D Poore
Hilda E Poore

STATE OF CALIFORNIA)
County of Los Angeles (ss

On this 9th day of April A D 1942, before me Thomas A Watt a Notary Public in and for said county and state, personally appeared Howard D Poore and his wife, Hilda E Poore, known to me (or proved to me on the oath of) to be the persons whose names are subscribed to the within instrument and acknowledged to me that they execute the same. In WITNESS WHEREOF, I have hereunto set my hand and affixed my official seal the day and year in this certificate first above written.

(notarial seal)

Filed for record Apr. 20, 1942 at 5:00 PM
Mortgage County Clerk
By *Edith H. Jones* Deputy

Thomas A Watt, Notary Public in and for the County of Los Angeles, State of California.
My commission expires January 21, 1943

ROBERT MILLER TO CHARLES F MILLER et ux 274760
County Clerk

THIS INSTRUMENT WITNESSETH That ROBERT MILLER, widower, grantor of lawful age, for and in consideration of the sum of Ten Dollars, and other valuable considerations to him well does hereby bargain, sell and convey unto CHARLES F MILLER, GRACE M. M., husband and wife, and or to the survivor, grantees, the following described

166738

E A S E M E N T

KNOW ALL MEN BY THESE PRESENTS, That the undersigned, A. J. YOUNG and CORA YOUNG, husband and wife, as Grantors, for and in consideration of the sum of One Dollar to them paid, by ROSEBURG LUMBER CO., a corporation, as Grantee, do hereby give and grant unto the said Grantee, an easement for one right-of-way for water pipe line over and across the following described real property, to wit:

All that part of the northeast quarter of Section 12, Township 27 South, Range 2 West, W. M., in Douglas County, Oregon, which lies West of the Umpqua National Forest road right-of-way extending northerly and southerly through said lands.

Said right-of-way is to be not more than ten feet in width, and extends from Little River easterly to the nearest convenient point on the east boundary of the above described lands of Grantors, and a. now in place.

To Have and to Hold the above right-of-way unto the said Grantors, its successors and assigns forever.

WITNESS OUR HANDS AND SEALS this 18th day of ~~July~~ ^{Aug.}, 1953.

A. J. Young (SEAL)
Cora Young (SEAL)

STATE OF OREGON)
County of Douglas) ss. Aug. 18 A. D. 1953.

Personally appeared the above named A. J. YOUNG and CORA YOUNG, husband and wife, and acknowledged the foregoing instrument to be their voluntary act and deed. Before me:

Saronalee Strait Notary Public for Oregon.

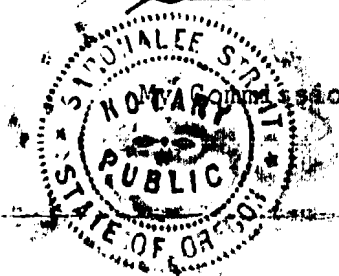

Commission expires August 4, 1957.

26. If disease/injury related to occupation, specify.
27. Signature L. C. Davison M. D. 616 W. 4th St. Santa Ana, Calif.
28. When required by law _____ coroner.
County of _____

STATE OF CALIFORNIA)
County of Orange (ss

I hereby certify the foregoing to be a full, true and correct copy of the Death Certificate of Anna Elizabeth Heitman as the same appears of record in my office.

Witness my hand and official seal this 3rd day of January, 1940.

(official seal)

Edw. Lee Russell, M. L.
Health Officer, Orange County.
By Leila Ritner Deputy Registrar.

Filed for record Aug. 2, 1943 at 11:01 AM
Roy Agee County Clerk

By *Edith R. Jones* Deputy

ISAAC HEITMAN et ux to A. J. YOUNG #30470
KNOW ALL MEN BY THESE PRESENTS, That ISAAC HEITMAN and INGA BEE HEITMAN, his wife, in consideration of Ten and no/100 (10.00) Dollars, and other valuable consideration to them paid by A. J. YOUNG do hereby grant, bargain, sell and convey unto said A. J. Young his heirs and assigns, all the following real property, with the tenements, hereditaments and appurtenances situated in the County of Douglas and State of Oregon, bounded and described as follows, to wit:

North East Quarter of Section 12, in Township 27 South Range 2 West, Willamette Meridian, containing 160 acres, more or less, in Douglas County, Oregon.

TO HAVE AND TO HOLD the above described and granted premises unto the said A. J. Young and his heirs and assigns forever. the grantors.

and Isaac Heitman and Inga Bee Heitman, his wife, above named do covenant to and with the above named grantees his heirs and assigns that they are lawfully seized in fee simple of the above granted premises, that the above granted premises are free from all incumbrances, and that they will and their heirs, executors and administrators, shall warrant and forever defend the above granted premises, and every part and parcel thereof, against the lawful claims and demands of all persons whomsoever.

Witness our hands and seals this 14th day of June, 1943.

Executed in the presence of _____

Isaac Heitman (seal)
Inga B. Heitman (seal)

STATE OF CALIFORNIA)
County of Los Angeles (ss

BE IT REMEMBERED, that on this 14th day of June, A D 1943, before me the undersigned, a Notary Public in and for said County and State, personally appeared the within named Isaac Heitman and Inga B. Heitman, who are known to me to be the identical individuals described in and who executed the within instrument and acknowledged to me that they executed the same freely and voluntarily.

IN TESTIMONY WHEREOF, I have hereunto set my hand and official seal the day and year last above written.

(notarial seal)

L W Klinker Notary Public for
My commission expires Oct. 11, 1943

STATE OF CALIFORNIA)
County of Los Angeles (ss

I, J. F. Koroney, County Clerk and Clerk of the Superior Court of the State of California, in and for said County, the same being a court of record of the aforesaid County, having by law a seal, do hereby certify that L W Klinker, whose name is subscribed to the attached certificate of acknowledgment, proof or affidavit, was at the time of taking said acknowledgment, proof or affidavit, a Notary Public in and for Los Angeles County, duly commissioned and sworn and residing in said County, and was, as such, an officer of said State, duly authorized by the laws thereof to take and certify the same, as well as to take and certify the proof and acknowledgment of deeds and other instruments in writing to be recorded in said State, and that full faith and credit are and ought to be given to his official acts; that the impression of his official seal is not required by law to be filed in the office of the County Clerk; I further certify that I am well acquainted with his handwriting and verily believe that the signature to the attached certificate is his genuine signature, and further that the annexed instrument is executed and acknowledged according to the laws of the State of California.

IN WITNESS WHEREOF, I have hereunto set my hand and affixed the seal of said Superior Court this 14th day of June, 1943.

(official seal)

J F Koroney
County Clerk and Clerk of the Superior Court of the State of California in and for the County of Los Angeles.

Filed for record Aug. 2, 1943 at 11:02 AM
Roy Agee County Clerk

By *Edith R. Jones* Deputy

By E T Neary Deputy \$1.65 L.F. stamps affixed and cancelled

WAYNE CHAPMAN et ux to T W THOMASON et ux #30471
THIS INSTRUMENT WITNESSETH, That WAYNE CHAPMAN and MARY CHAPMAN, husband and wife, in consideration of the sum of Ten Dollars and other good and valuable considerations, to them paid, have bargained and sold and by these presents do bargain, sell and convey unto T W THOMASON and EMMA C THOMASON, husband and wife, the following described premises, to-wit:

The East half of Lot No. Ten (10) and Lot No. Eleven (11), in Block No. Four (4) in Waite's Addition to the City of Roseburg.

together with all and singular the tenements, hereditaments and appurtenances therunto belonging or in anywise appertaining, and all estate, right, title and interest in and to the same, including dower and claim of dower.

TO HAVE AND TO HOLD said premises, with their appurtenances, unto the said T W Thomason and Emma C Thomason their heirs and assigns forever.

WAYNE CHAPMAN
MAY 2 1943
SALSA

A KRUSE TO LOUIS L EHR et ux #30462
 KNOW ALL MEN BY THESE PRESENTS, That E A KRUSE, unmarried, of Yoncalla, State of Oregon, in consideration of Ten & 00/100 Dollars, to me paid by LOUIS L EHR and CURNEY V EHR, of Yoncalla, State of Oregon, has bargained and sold and by these presents do grant, bargain, sell and convey unto said LOUIS L EHR and CURNEY V EHR, husband and wife, their heirs and assigns, all the following bounded and described real property, situated in the County of Douglas and State of Oregon:
 The Southeast quarter of the Southeast quarter of Section Six (6) and the Northeast quarter of the Northeast quarter of Section Seven (17), and the Southwest quarter of the Southwest quarter of Section five (5), all in Township 23 South of Range 5 West of the Willamette Meridian.
 First party to furnish abstract of title brought up to this date showing merchantable title.
 together with all and singular the tenements, hereditaments and appurtenances thereunto belonging or in anywise appertaining, and also all my estate, right, title and interest in and to the same, including dower and claim of dower.
 TO HAVE AND TO HOLD the above described and granted premises unto the said Louis L Ehrlich and Curney V Ehrlich, husband and wife, their heirs and assigns forever. and E A Kruse, grantor above named does covenant to and with Louis L Ehrlich and Curney V Ehrlich, husband and wife, the above named grantees, their heirs and assigns that he is lawfully seized in fee simple of the above granted premises, that the above granted premises are free from all incumbrances, and that he will and his heirs, executors and administrators, shall warrant and forever defend the above granted premises, and every part and parcel thereof, against the lawful claims and demands of all persons whatsoever.
 IN WITNESS WHEREOF, the grantor above named, has hereunto set his hand and seal this 29th day of July 1943.

Executed in the presence of _____ E A Kruse (2041)

STATE OF OREGON)
COUNTY OF DOUGLAS)

BE IT REMEMBERED, that on this 29th day of July, A D 1943, before me the undersigned, a Notary Public in and for said County and State, personally appeared the within named E A Kruse, unmarried, who is known to me to be the identical person described in and who executed the within instrument and acknowledged to me that he executed the same freely and voluntarily.

IN TESTIMONY WHEREOF, I have hereunto set my hand and notarial seal the day and year last above written.
A L Lasswell Notary Public for Oregon.
My commission expires March 17, 1945

Filed for record Aug . 2, 1943 at 9:28 AM
Roy Ages County Clerk

By *Edith R Jones* Deputy \$6.60 I R Stamps affixed and cancelled.

DEATH CERTIFICATE OF ANNA ELIZABETH HEITMAN #30469
State of California Department of Public Health Vital Statistics
STANDARD CERTIFICATE OF DEATH Local Registered No. 216

- 1. Place of death: Dist. No. 3001. County of Orange. City, town or rural district of Santa Ana Street and No. 602 South Main.
- 2. Full name: Heitman, Anna Elizabeth. Residence: 602 So. Main. If non-resident, give city or town and state: formerly of Sierra Madre, Calif.
- 3. Sex: Female
- 4. Color or race: Cauc.
- 5. Single, Married, Widowed or Divorced: Married.
- 5a If married, Widowed or divorced: Name of husband or wife: Isaac Heitman.
- 6. Date of Birth: May 21, 1863.
- 7. age: 76 years 3 mos. 13 days.

OCCUPATION

- 8. Trade, profession or kind of work done: Housewife.
- 9. Industry or business in which work was done:
- 10. Date deceased last worked at this occupation: 1936.
- 11. Total years spent in this occupation: 27

12. Birthplace, city or town: Port William. State or Country: Nova Scotia.

FATHER

13. Name: Thomas H Borden

14. Birthplace, city or town: Port William. State or country: Nova Scotia.

MOTHER

15. Maiden Name: Mary Ann Best

16. Birthplace, city or town: Horton State or country: Nova Scotia.

LENGTH OF RESIDENCE

17. A. City town or rural district of death: 21 days

B. In California: 21 years

C. In U. S., if of foreign birth: 50 years.

18. Informant: Isaac Heitman Address: 502 So. Birch St.

19. Burial, Cremation or removal: Burial Place Forest Lawn Glendale Date: 9/5/39

20. Embalmer- License No. 1995 Signature: Claude K Read Funeral Director: Winbigler Mortuary

Address: Santa Ana, California.

21. Filed Sep. 5, 1939. K H Sutherland M D Registrar.

22. Date of death: September 3, 1939.

23. MEDICAL CERTIFICATE OF DEATH:

I hereby certify that I attended deceased from Aug. 20, 1939 to Sep. 2, 1939. That I last saw her alive on Sep. 2, 1939, and that death occurred on the above stated date at the hour of 4:50 AM. The principal cause of death and related causes of importance in order of onset, were as follows:

Cerebral hemorrhage. Date of onset: 3 months ago. Other contributory causes of importance: If operation, date of _____ Was there an autopsy _____ Condition for which performed _____ Were laboratory test confirming diagnosis _____

24. Coroners Certificate of death: I hereby certify that I took charge of the remains described above, held an _____ thereon, and from such action find that said deceased came to h_ d-ath on the date stated above.

25. If death was due to external causes (violence) fill in the following: Accident, Suicide or Homicide Date of injury _____ Injured at _____ Did injury occur in home, industry or public place _____ Manner of injury Nature of injury _____

- 26. If disease/injury related to occupation, specify.
- 27. Signature L. C. Davison M. D. 616 W. 4th St. Santa Ana, Calif.
- 28. When required by law _____ coroner.
County of _____.

STATE OF CALIFORNIA)
County of Orange (ss

I hereby certify the foregoing to be a full, true and correct copy of the Death Certificate of Anna Elizabeth Heitman as the same appears of record in my office.

Witness my hand and official seal this 3rd day of January, 1940.

(official seal)

Edw. Lee Russell, M. D.
Health Officer, Orange County.
By Leila Ritner Deputy Registrar.

Filed for record Aug. 2, 1943 at 11:01 AM

Roy Noyse County Clerk

By *Edith H. Jones* Deputy

ISAAC HEITMAN et ux to A J YOUNG 430470
KNOW ALL MEN BY THESE PRESENTS, That ISAAC HEITMAN and INGA BEE HEITMAN, his wife, in consideration of Ten and no/100 (\$10.00) Dollars, and other valuable consideration to them paid by A J YOUNG do hereby grant, bargain, sell and convey unto said A J Young his heirs and assigns, all the following real property, with the tenements, hereditaments and appurtenances situated in the county of Douglas and State of Oregon, bounded and described as follows, to wit:

North east quarter of Section 12, in Township 27 South Range 2 West, Willamette Meridian, containing 160 acres, more or less, in Douglas County, Oregon.

TO HAVE AND TO HOLD the above described and granted premises unto the said A J Young and his heirs and assigns forever.

And Isaac Heitman and Inga Bee Heitman, his wife, above named do covenant to and with the above named grantee his heirs and assigns that they are lawfully seized in fee simple of the above granted premises, that the above granted premises are free from all incumbrances, and that they will and their heirs, executors and administrators, shall warrant and forever defend the above granted premises, and every part and parcel thereof, against the lawful claims and demands of all persons whomsoever.

Witness our hands and seals this 14th day of June, 1943.

Executed in the presence of _____ Isaac Heitman (seal)
Inga B. Heitman (seal)

STATE OF CALIFORNIA)
County of Los Angeles (ss

BE IT REMEMBERED, that on this 14th day of June, A D 1943, before me the undersigned, a Notary Public in and for said County and State, personally appeared the within named Isaac Heitman and Inga B. Heitman, who are known to me to be the identical individuals described in and who executed the within instrument and acknowledged to me that they executed the same freely and voluntarily.

IN TESTIMONY WHEREOF, I have hereunto set my hand and official seal the day and year last above written.
(notarial seal) L W Klinker Notary Public for
My commission expires Oct. 11, 1943

STATE OF CALIFORNIA)
County of Los Angeles (ss

I, J F Koroney, County Clerk and Clerk of the Superior Court of the State of California, in and for said County, the same being a court of record of the aforesaid County, having by law a seal, do hereby certify that L W Klinker, whose name is subscribed to the attached certificate of acknowledgment, proof or affidavit, was at the time of taking said acknowledgment, proof or affidavit, a Notary Public in and for Los Angeles County, duly commissioned and sworn and residing in said County, and was, as such, an officer of said State, duly authorized by the laws thereof to take and certify the same, as well as to take and certify the proof and acknowledgment of deeds and other instruments in writing to be recorded in said State, and that full faith and credit are and ought to be given to his official acts; that the impression of his official seal is not required by law to be filed in the office of the County Clerk; I further certify that I am well acquainted with his handwriting and verily believe that the signature to the attached certificate is his genuine signature, and further that the annexed instrument is executed and acknowledged according to the laws of the State of California.

IN WITNESS WHEREOF, I have hereunto set my hand and affixed the seal of said Superior Court this 14th day of June, 1943.

(official seal)

J F Koroney
County Clerk and Clerk of the Superior Court of the State of California in and for the County of Los Angeles.

By E T Nedry Deputy

Filed for record Aug. 2, 1943 at 11:02 AM

Roy Noyse County Clerk

By *Edith H. Jones* Deputy

31.65 L.H. State Seal affixed and cancelled

KNOW ALL MEN BY THESE PRESENTS, That **Bernard A Young and Lova B Young, husband and wife and Adelbert A. Young and Mary G. Young, husband and wife**, grantor **B**
 in consideration of **Ten and no/100- - - - -** Dollars,
 and other good and valuable consideration
 to them paid by **Calvin D. Willis and Lillie S. Willis**
 , husband and wife, grantees,
 do hereby grant, bargain, sell and convey unto the said grantees, as tenants by the entirety, their heirs and assigns, all the following real property, with the tenements, hereditaments and appurtenances, situated in the County of **Douglas** and State of Oregon, bounded and described as follows, to-wit:

That part of the NE¹/₄ of Section 12, Township 27 South, Range 2 West, W.M. Douglas County, Oregon, which lies West of the Umpqua National Forest road right of way extending northerly and southerly through said lands



To Have and to Hold the above described and granted premises unto the said grantees as tenants by the entirety, their heirs and assigns forever.

And we, the grantors, covenant that we are lawfully seized in fee simple of the above granted premises free from all incumbrances,

and that we will and our heirs, executors and administrators, shall warrant and forever defend the above granted premises, and every part and parcel thereof, against the lawful claims and demands of all persons whomsoever.

Witness our hand and seal this 25th day of MARCH, 1963

Bernard A. Young (SEAL)
Lova B. Young (SEAL)
Adelbert A. Young (SEAL)
Mary G. Young (SEAL)

STATE OF OREGON,

County of Douglas } ss. On this 25th day of MARCH, 1963, before me, the undersigned, a Notary Public in and for said County and State, personally appeared the within named Bernard A. Young and Lova B. Young, husband and wife

known to me to be the identical individual^s described in and who executed the within instrument, and acknowledged to me that they executed the same freely and voluntarily.

IN TESTIMONY WHEREOF, I have hereunto set my hand and affixed my official seal the day and year last above written.

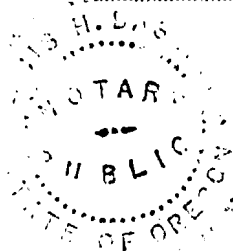

James H. Young
 Notary Public for Oregon.
 My Commission expires March 1, 1963

WARRANTY DEED

TO _____

AFTER RECORDING RETURN TO _____

200 4

(DON'T USE THIS SPACE; RESERVED FOR RECORDING LABEL IN COUNTIES WHERE USED.)

STATE OF OREGON,

County of Douglas } ss.

I certify that the within instrument was received for record on the 3rd day of April, 1963, at 3¹⁵ o'clock P.M., and recorded in book 322 on page 447
 Record of Deeds of said County.

Witness my hand and seal of

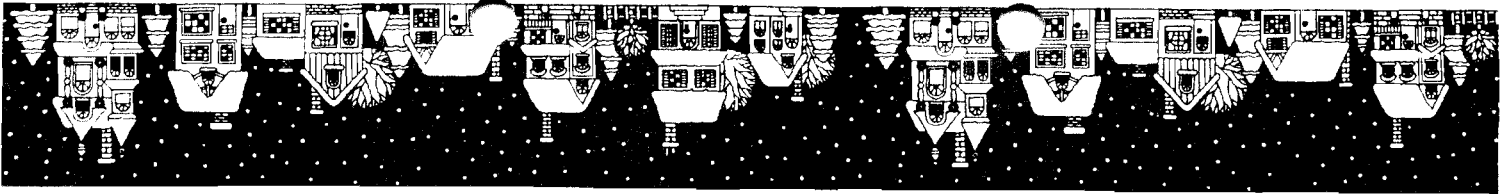

December 7, 1982

It is the purpose of this letter to state facts as I know them concerning surface water usage in the N E ¼ Sec 12, Township 27 S Range 2 W.W.M.

I purchased the westerly portion of that land containing 60 acres more or less from Brig Young and others in March 1963 and have used surface water continuously since that time. Such water was used for household purposes, gardening, fire protection, etc. I also filed water rights and was granted same on the unnamed (Willis Creek) creek joining Little River on its westerly side about 300 yards north of the Forest Service (U. S.) boundary, which water was used as a community system.

I recall Brig Young saying at the time of my purchase of the land from him that his father A. J. Young had allowed a farmer who raised goats to pasture them in that meadow located on the westerly side of Little River which borders U.S. Forest Service on the south.

At the time of my purchase there was considerable evidence of a structure (fallen down) but with much broken glass, pieces of an iron kitchen stove and lumber strewn about as well as a flume, boards of which (in various stages of rot) ran from the unnamed creek toward the building site.

It is my opinion that there has never been a lapse even approaching 5 years that surface water has not been used on the aforementioned ¼ section of land.....since Nels Nelson homesteaded it.

*12-8-92 - Notarized by
Leslie Neff
My Commission Exp. 2/24/96
Leslie Neff*

Sincerely & Respectfully,
Calvin D. Willis, present owner
Calvin D. Willis

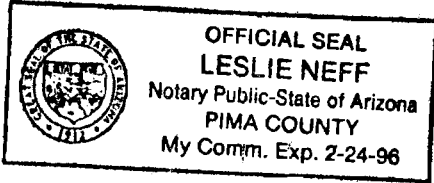

RECORDED
DEC 29 1982
WATER RIGHTS DIVISION
SALEM, OREGON

YEAR	ACRES	ASSESSED VALUE LAND	ASSESSED VALUE IMPROVEMENTS	TOTAL ASSESSED VALUES	DATE POSTED
<i>86</i>		<i>31066</i>	<i>0</i>	<i>31066</i>	047 FEB 21 1986
86	45072.00	DPR LN 12.00 110 OTH LN	31,066	OPR BL OTH BL	TOTAL VALUE 31,066
88	T27 R02 12.00	S12A LAND	TL02900 22,146	ACCOUNT 45072.00 BLDG TOTAL	CLASS 110 22,146
90	T27 R02 12.00	S12A LAND	TL02900 SP 23,880	ACCOUNT 45072.00 BLDG TOTAL	CLASS 110 23,880
<i>90</i>		<i>23,690</i>	<i>0</i>	<i>23,690</i>	<i>Divided by 1-90</i>
91	T27 R02 12.00	S12A LAND	TL02900 SP 24,950	ACCOUNT 45072.00 BLDG TOTAL	CLASS 110 24,950
92	T27 R02 12.00	S12A LAND	TL02900 SP 27,632	ACCOUNT 45072.00 BLDG TOTAL	CLASS 110 27,632

CLASS OF PROPERTY

110

MAP
T27 R02 S12A TL 2900
VALUATION SUMMARY OF REAL PROPERTY

22-2-1986-2700

CODE
12.00
ACCT
45072.00

ACCOUNT NUMBER
45072

T27 R02 S12A TL 2900
FOREST HAVEN 1ST ADD
PT L 2 B 3

DOUGLAS COUNTY
LAND
APPRAISAL

ACCT 45072.00
CODE 12.00
CLASS 110

WILLIS, CALVIN D

PLAN ZONE OVLY

PLAN ZONE OVLY

2812 W SANDERS
ROSEBURG, OR 97470

COMMENT: B= LOC R 2500+

ELECTRIC
SANITATION
IMPROVEMENTS
LANDSCAPING
FRONTAGE
NEIGHBORHOOD
MISC2
MISC4

WATER
STREET
ACCESS
TOPOGRAPHY
LOCATION
MISC1
MISC3
MISC5

SEQ	CODE	CLASS	M	%	ADJUST	ACRES/FT	CD	BASIC	VC	VALUE	A	YR
01	12.00	HKAUR	B	0	2,500	1.00	E	8,200.00	L	10,700		91
02	12.00	SK2	S	92	1,218-	6.48	E	2,350.00		14,010		90
03	12.00	OLR		0	0	2.00	E	120.00		240		91
MRKT	24,950	ASSD			24,950	0.00		TOTAL		24,950		

YEAR 1991

REVISED: 03/07/88 PLAT 15/2 APPRAISER A20

400 1-1-0
CLASS OF PROPERTY

DOUGLAS COUNTY OREGON
VALUATION SUMMARY OF REAL PROPERTY

45072
ACCOUNT NUMBER

YEAR	LAND				TIMBER			IMPROVEMENTS			TOTALS	
	ACRES	APPRAISED VALUE	%	ASSESSED VALUE	APPRAISED VALUE	%	ASSESSED VALUE	APPRAISED VALUE	%	ASSESSED VALUE	APPRAISED VALUE	ASSESSED VALUE
74	9.53	210									210	JUN 7
YEAR 1975	ACCT 45072.00	CODE 12.00	CLS 400	LAND 30.0+% TBR. 270			% BLDG	15.0+% MDB.			TOTAL 270	
75		5300							R.M.		5300	APR 7
75		2860							UF		2860	APR 2
1976		5300							H		5300	
76		3090							HD		3090	FEB
76		7100							TZ		7100	FEB
YR 78	ACCT 45072.00	CODE 12.00	CLS 410	63.0 LAND 11,570			24.0 BLDG			OT-VAL 11,570		
79		11510							GC		11510	JAN 7
YR 79	ACCT 45072.00	CODE 12.00	CLS 410	41.0 LAND 16,230			12.0 BLDG			TOT-VAL 16,230		
80	45072.00	12.00	410	OOPR LAND 15,900			OOPR BLDG			TOTAL VALUE 15,900		
				OTHER LAND			OTHER BLDG					
81	45072.00	12.00	410	OPR LN 17,200			OPR BL			TOTAL VALUE 17,200		
				OTH LN +8			OTH BL					
82		31100							CD		31100	JA
83	45072.00	12.00	110	OPR LN 27,100			OPR BL			TOTAL VALUE 27,100		
				OTH LN -13			OTH BL					
84	45072.00	12.00	110	OPR LN 27,100			OPR BL			TOTAL VALUE 27,100		
				OTH LN			OTH BL					

SER SUPERSEDED

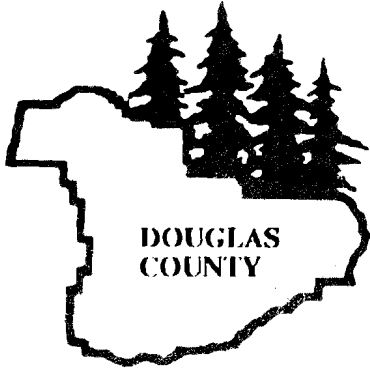

OFFICE OF THE TAX COLLECTOR

Douglas County Courthouse - Roseburg, Oregon 97470
Telephone (503) 440-4253

Anne E. Schroeder
Tax Collector

December 16, 1992

Karen H. Hazlett
P. O. Box 165
Glide, OR 97443

Dear Ms. Hazlett,

We do have available hand written records that were kept in ledger books as far back as the early 1900's thru 1949. These records are available to you for your research.

Tax records from 1950-1963 have been sent on microfilm to the State Archives in Salem. I am not certain as to the availability of these records.

If you need assistance in any way, please call.

Sincerely,

Anne E. Schroeder
Tax Collector.

*Info compiled from records at the
Douglas County Court House.*

1943-1944 tax roll for fiscal year end vol

June 30, 1944 acreage Vol II

1936 Vol ii Micro 389-390 Line 33 pg 226

1937-36 Vol II pg 227 Line 26 Micro #388 6-10-77

1938 Vol II Micro #387 pg177 line 25

1939 6-2-77 Micro #386

1940 5-26-77 Micro #385

1941 Micro #384 (address)

1942 Micro #382

1943 To Isaac Heitman (address) Micro #381 5-1-77

1943-44 To Heitmans (Isaac and Inga Bee)(address) Micro
#380

page 184 line 33 #380

1944 Young Vol II pg 190 line 23 Micro 379

1945 Young Vol II pg 162 Line 9 Micro 377

1946 AJ Young pg 208 line 23 #376

1947 AJ Young(logged) pg 179 line 22 Micro 375

1948 AJ Young (logged) pg 213 line 40 Micro 373

1949 AJ Young pg 180 line 37 Micro 372

8161

CONTINUING ASSESSMENT ROLL OF TAXABLE REAL PROPERTIES OF DOUGLAS COUNTY, OREGON

12 00

12

DESCRIPTION OF PROPERTY

SPECIAL ASSESSMENTS

SERIAL NUMBER	DESCRIPTION	TAX LOT NO	SEC	TAX	RAISE	DATE	AMT	NUMBER	ACRES	FAR. PATROL ACRES	RECREAT ACRES
	West National Forest Road										

YEAR OF ASSESSMENT	DATA RECORD	NAME OF OWNER	ACREAGE AND VALUE								TAXING DISTRICTS								CODE NO	
			FARM LAND		TIMBER		TOTAL		AGRI. MACH. & EQUIP.		TOTAL		EXEMPT		S. U. N. M.		S. M. P. S.			
			ACRES	VALUE	ACRES	VALUE	ACRES	VALUE	ACRES	VALUE	ACRES	VALUE	ACRES	VALUE	ACRES	VALUE	ACRES	VALUE	ACRES	VALUE
1952	32	Young, A J 616 S E Flint Roseburg, Oregon	8	20				80	200			12			1					12
1953	32	do	80	140	90	420	80	560				12			1					12
1954	32	do	60	110	1370	710	60	850				12			1					12
1956	57	do	60	110	1370	1500	60	1610				12			1					12
1958		do	60	110	1370	2250	60	2360												
1958		do	60	110	1370	1500	60	1610												
1959	30	do	60	110	347	510	60	650												
1960	35	Young, Albert A & Bernard A Chatham Roseburg, Oregon 1117 S E Kane St	60	110	347	510	60	650												
1960	35	do	60	120	347	660	60	780												
1961		do	60	140	347	880	60	1020												
1961	1961	do	60	140			60	140												

OVER

OVER

CONTINUING ASSESSMENT ROLL OF TAXABLE REAL PROPERTIES OF DOUGLAS COUNTY, OREGON 12 00

8161

6-0-1

DESCRIPTION OF PROPERTY

SPECIAL ASSESSMENTS

SERIAL NUMBER

SECTION

TAX MAP

CD

TA

BLK

A

THE PARTIAL RANGE A 21

~~FOREST LAND~~

NE 1/4 West National Forest Road

1 12 27 2 I

7 3 7

less pt platted

YEAR OF ASSESSMENT

RECORD

NAME OF OWNER

ACREAGE AND VALUE

TAXING DISTRICTS

FARM LAND

IMPROVEMENTS

TOTAL VALUE

ACRES

VALUE

ACRES

VALUE

TOTAL VALUE

TOTAL VALUE

SP. ASSESS.

AD. VAL.

TOTAL VALUE

EXEMPT

EXEMPT

EXEMPT

EXEMPT

EXEMPT

EXEMPT

EXEMPT

EXEMPT

YEAR OF ASSESSMENT	RECORD	NAME OF OWNER	FARM LAND ACRES	FARM LAND VALUE	IMPROVEMENTS ACRES	IMPROVEMENTS VALUE	TOTAL VALUE	TOTAL VALUE	SP. ASSESS.	AD. VAL.	TOTAL VALUE	EXEMPT	EXEMPT	EXEMPT	EXEMPT	EXEMPT	EXEMPT	EXEMPT	
1963	321175	Willis, Calvin D & Lillie S	60	110	--	--	60	110			110								12-00
1963	ASSMT	PO-Box-305 Room 309 Pacific Bldg Roseburg, Oregon	Same as Above				Same as Above												
1964	337307	do	51.42	110			51.42	110			110								
1966	1966	do	51.42	110			51.42	110	420		530								
1967	457	do	51.42	110			51.42	110	00		110								
			51.42	440							440								
1968	1968	Same as Above	51.42	510							510								
												440							
												510	12						12-00
1969	69-1400	Willis, Calvin D Pacific Bldg Room 109 Roseburg, Oregon	51.42	510							510								
		4507 NE Graham	51.42	670							670								
1970			51.42	930							930								
												670							
												930							

SURFACE WATER REGISTRATION CHECKLIST

(received after July 18, 1990)

CHECK BASIN MAP dek NAME Umpqua # 16 UNADJUDICATED AREA ? yes
RECEIPT # 95680 S W R NUMBER 310
CHECK ENCLOSURES dek PRELIMINARY DATA BASE ENTRY dek
ACKNOWLEDGEMENT LETTER dek ENTER ON STREAM INDEX _____
CHECK QUADRANGLE MAP _____ CHECK GLO PLATS _____
WATERMASTER CHECKLIST _____ PUBLIC NOTICE PUBLICATION SCW

FORM REVIEW

_____ blanks filled in
_____ signed
_____ date received stamped

MAP REVIEW

123 → _____ ✓ source and trib
_____ ✓ diversion point location
_____ ✓ conveyances (pipes, ditch, etc.)
_____ ✓ place of use
_____ ✓ scale
_____ ✓ township, range, section
_____ ✓ north arrow
_____ ✓ CWRE stamp
_____ ✓ disclaimer
_____ date survey was performed
12 → _____ ✓ P.O.B. of survey
_____ dimensions and capacity of diversion system
_____ ✓ "beneficial use" type title
_____ ✓ "permanent-quality" paper

151 → _____ 1/10 to none WATER RIGHT RECORD CHECK _____ FIELD INSPECTION _____

FINAL FILE REVIEW _____ FINAL DATA BASE ENTRY _____

ENTER ON PLAT CARDS _____

July 15, 1994

MAURICE E FARR
1960 SW BURDETTE DR
ROSEBURG OR 97470

RE: SWR-310

Dear Mr Farr,

This will acknowledge the receipt of map to support the pre-1909 vested water right claim in the name of JAMES OR KAREN HAZLETT you returned with corrections and completions. I have added the map to the file. Thank you for your attention to this matter. If you have any questions, please give me a call.

Sincerely,



Don Knauer
Adjudication Specialist

cc: James or Karen Hazlett

J:\WAS\C\3\SWR-0310.002



Commerce Building
158 12th Street NE
Salem, OR 97310-0210
(503) 378-3739
FAX (503) 378-8130

FAPD - 46

STATE OF OREGON
WATER RESOURCES DEPARTMENT
INTEROFFICE MEMO

May 11, 1994

TO: WATER RIGHT EXAMINERS

FROM: DON KNAUER

SUBJECT: PRE-1909 VESTED WATER RIGHT CLAIM MAPS

Alright you guys, this is a test, DO YOU KNOW WHAT TIME IT IS? The answer is, it's time to get the maps, reports, answers, mylars and all that kind of stuff back to the Water Resources Department. There's talk around the office of putting together a "map-patrol" with a tough leader to travel around and retrieve the required documents.

You may remember, I reviewed maps for compliance with Oregon Revised Statutes and Oregon Administrative Rules submitted to support pre-1909 vested water right claims. For the past few months and up to a year ago I have returned maps, requested mylars, asked for clarification, and asked for reports. Some of these files are getting stale.

It is very important that you give me something, preferably the map, mylar, report, etc. but at minimum you must give me a submittal date. The review of the files cannot be completed without the map, report, etc. It is a deterrent to the claimant, your client, for this issue to go unresolved.

If you need copies of anything in the files, just let me know. I have hand written below the file numbers of those I returned to you. The toll free number is 1-800-624-3199.

j:\wp51\swr\claimant\cwrememo.94

SWR-71	SWR-310
- 109	- 366
- 132	- 378
- 133	- 451
- 136	- 492
- 177	- 559
- 236	< 1 -

October 7, 1993

MAURICE E. FARR
1960 SW BURDETTE DRIVE
ROSEBURG OR 97470

RE: File# SWR-310

DEAR MAURICE E. FARR,

The Water Resources Department (WRD) received a little over 500 surface water registration statements in December, 1992. All of the files have been set up and receipts for the fees have been sent. The next step is to insure the maps received in support of the claims are acceptable based on Oregon Revised Statutes (ORS) and Oregon Administrative Rules (OAR).

I am returning the map you prepared for **James I. or Karen Hazlett**. You will find the item which requires completion or correction shown below. I have the description followed by the ORS or OAR site and paraphrased statute or rule.

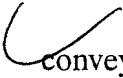
 conveyance

ORS 539.120 "...the location of and each ditch, canal, pipeline or other means of conveying the water..."

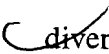
 diversion point size

OAR 690-28-025-(4)-(c) "The dimensions and capacity of any existing diversion systems."

 acre

OAR 690-28-025-(4)-(d) "The number of acres irrigated in each quarter quarter shall be shown to the nearest tenth of an acre."



You must return the map before the claim can be processed. If you cannot have the map to the WRD within 60 days, please inform me as to when it can be expected. Please mark all correspondence with the file number.

As always, if you have any questions, please give me a call.

Sincerely,

A handwritten signature in black ink, appearing to read "Don Knauer", with a long horizontal flourish extending to the right.

Don Knauer
Adjudication Specialist

Enclosures

March 2, 1993

JAMES L OR KAREN HAZLETT
PO BOX 165
GLIDE OR 97443

Dear MR OR MRS HAZLETT,

This will acknowledge that your Surface Water Registration Statement in the name of JAMES L OR KAREN HAZLETT has been received by our office. The fees in the amount of \$200.00 have been received and our receipt #95680 is enclosed. Your registration statement has been numbered SWR-310.

Our office will review your form and map in the near future. If necessary we will schedule a meeting with you that will include a site inspection. If there are problems with your form we are usually able to take care of them during our visit. We will be able to answer any questions you might have about the adjudication process at that time.

Please feel free to contact this office if you have any questions.

Sincerely,



Don Knauer
Adjudication Specialist

Enclosure

C:\WP51\SWR\CLAIMANT\SWR-0310.001



STATE OF OREGON
WATER RESOURCES DEPARTMENT
 3850 PORTLAND ROAD NE
 SALEM, OR 97310
 378-8455/378-8130 (FAX)

RECEIPT # **95680**

RECEIVED FROM: <u>James Hazlett</u>	APPLICATION
BY: _____	PERMIT
	TRANSFER

CASH: <input type="checkbox"/>	CHECK: # <u>X 24 708</u>	OTHER: (IDENTIFY) <input type="checkbox"/>	TOTAL REC'D \$ <u>200.00</u>
--------------------------------	--------------------------	--	------------------------------

01-00-0 WRD MISC CASH ACCT

842.010	ADJUDICATIONS	\$ <u>200.00</u>
831.087	PUBLICATIONS/MAPS	\$
830.650	PARKING FEES Name/month	\$
_____	OTHER: (IDENTIFY)	\$

REDUCTION OF EXPENSE

CASH ACCT.	\$
COST CENTER AND OBJECT CLASS	VOUCHER #

03-00-0 WRD OPERATING ACCT

MISCELLANEOUS:			
840.001	COPY FEES		\$
850.200	RESEARCH FEES		\$
880.109	MISC REVENUE: (IDENTIFY)		\$
520.000	OTHER (P-6): (IDENTIFY)		\$
WATER RIGHTS:			
842.001	SURFACE WATER	EXAM FEE	
842.003	GROUND WATER	\$	842.002
842.005	TRANSFER	\$	842.004
		\$	842.006
WELL CONSTRUCTION			
842.022	WELL DRILL CONSTRUCTOR	EXAM FEE	
842.016	WELL DRILL OPERATOR	\$	842.023
	LANDOWNER'S PERMIT	\$	842.019
			842.024

06-00-0 WELL CONST START FEE

842.013	WELL CONST START FEE	\$	CARD #
	MONITORING WELLS	\$	CARD #

45-00-0 LOTTERY PROCEEDS

864.000	LOTTERY PROCEEDS	\$
---------	------------------	----

07-00-0 HYDRO ACTIVITY

		LIC NUMBER	
842.011	POWER LICENSE FEE(FW/WRD)		\$
842.115	HYDRO LICENSE FEE(FW/WRD)		\$
_____	HYDRO APPLICATION		\$

RECEIPT # **95680** DATED: 12-30-92 BY: R. B. ...

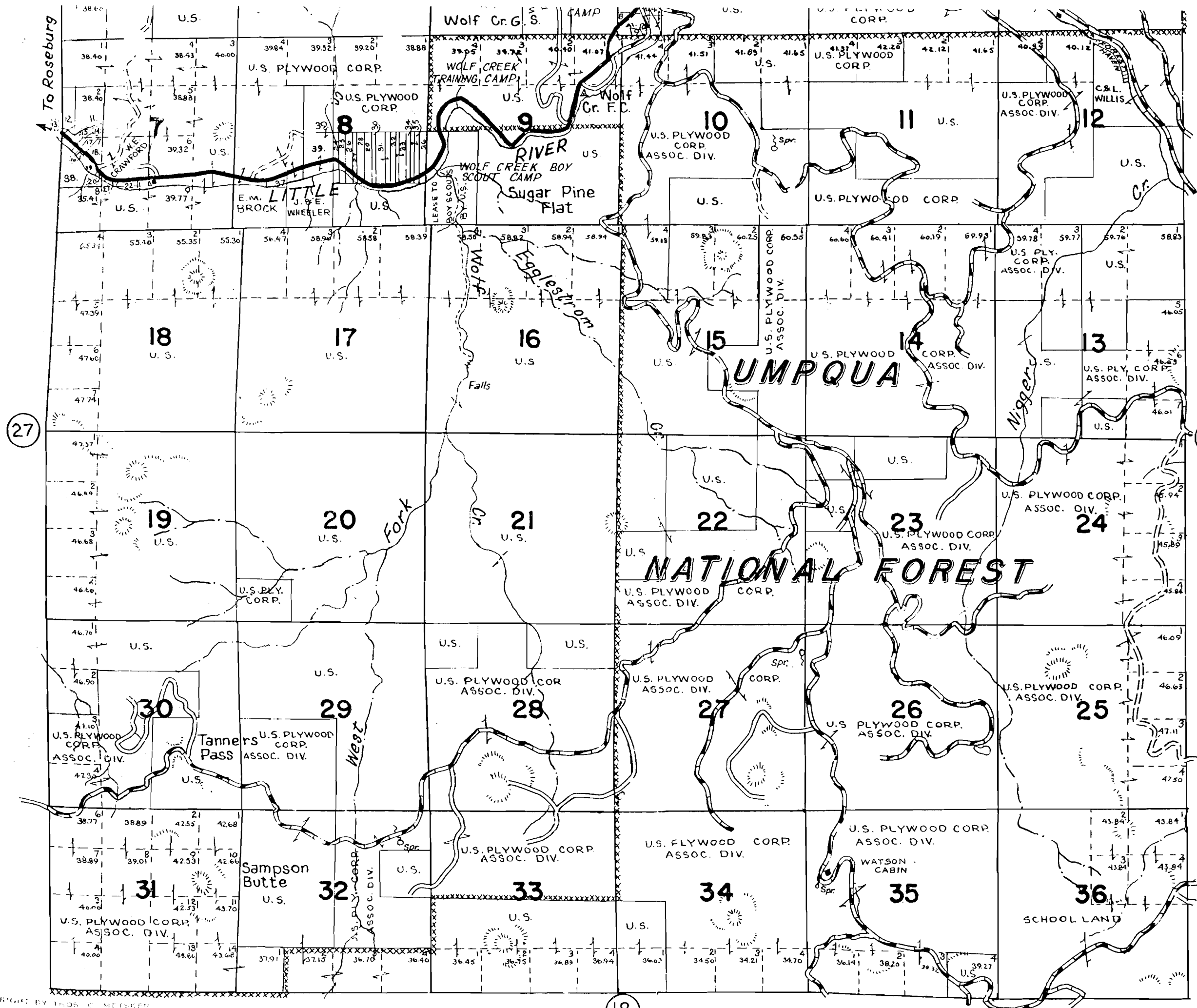

- 18 W.E. CRAWFORD
- 19 C.V. & M. ERICKSON
- 20 J. BERGMAN
- 21 R.E. & E. PFEIFFER
- 22 F. CORDER
- 23 A.A. & E.R. WILSON
- 24 J.M. & O.M. IVEY
- 25 E. DEVENY
- 26 F. PRINCE
- % B. POWERS
- 27 J.V. & V. ROMINE
- 28 C. MARSHMAN
- 29 F. & E. PRINCE
- 30 H.M. & H.K. BAILEY
- 31 A. & L.W. MARTINEZ
- 32 A. & A. MULKER
- 33 C. & J. GUNDERSON
- % O. & E. BERGER
- 34 C. & J. GUNDERSON
- 35 G. & M. KUYKENDALL
- 36 L. & E. COOPER
- 37 M.L. D. HATCH
- 38 J.I. & O.M. LYNCH
- 39 J.P. & B.J. SUMMERS
- 40 D.L. TURNBULL
- 41 SO. ORE. ASSOC. OF CHRISTIAN CHURCHES

- LEGEND--
- STATE HWY. (27) U.S. HWY. (7)
 - PAVED HIGHWAYS
 - IMPROVED DIRT ROADS
 - DIRT ROADS
 - INFERIOR ROADS
 - RAILROADS
 - TRAILS
 - INTERMITTENT CREEKS
 - SCHOOLS
 - ELEC. P.W.L. TRANS. LINES
 - IRRIGATION CANALS
 - NAT'L. FOREST BDRS. XXXXX

- N. Umpqua Timber Co.

UMPQUA NATIONAL FOREST

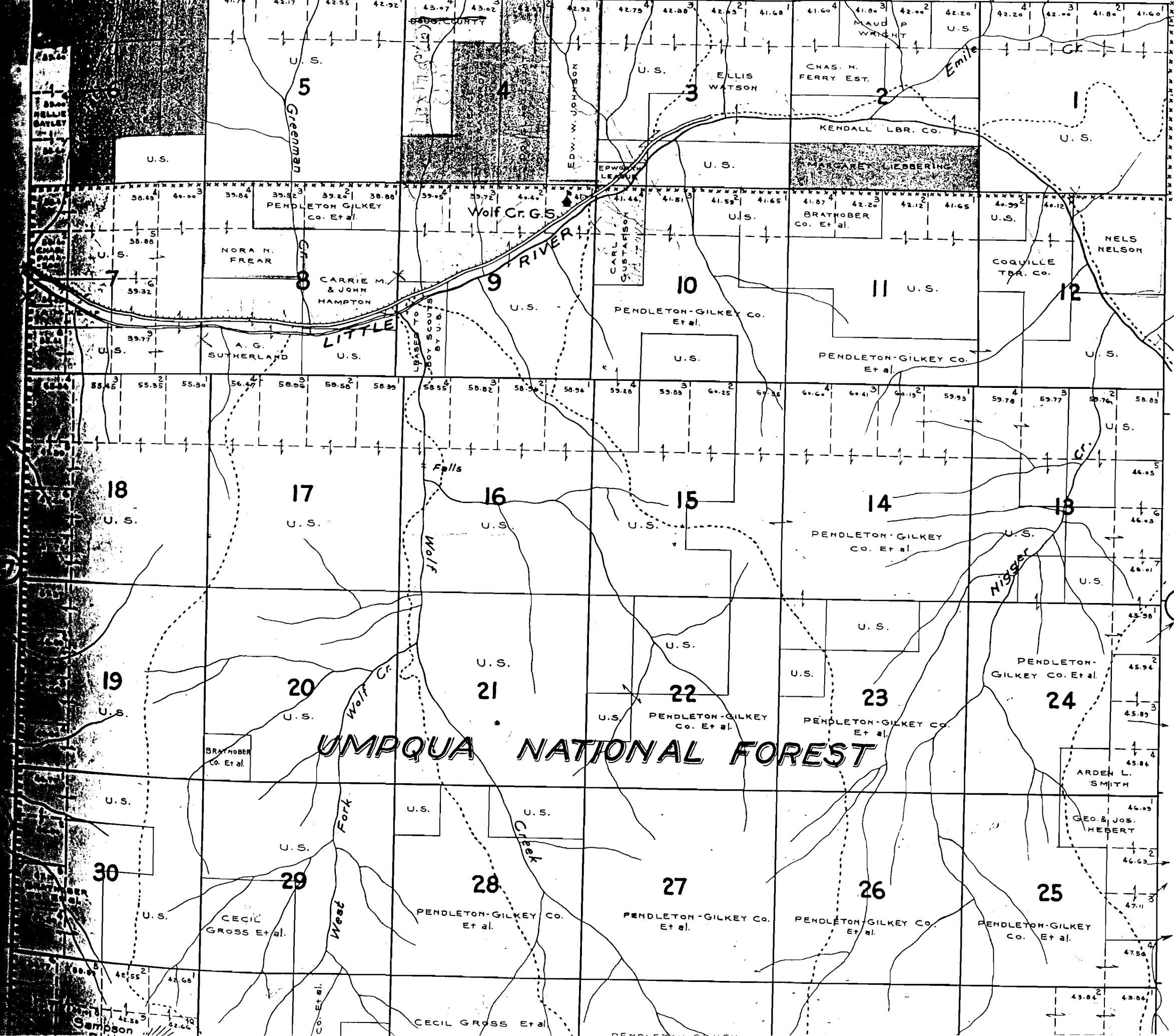

7

1941
Aug

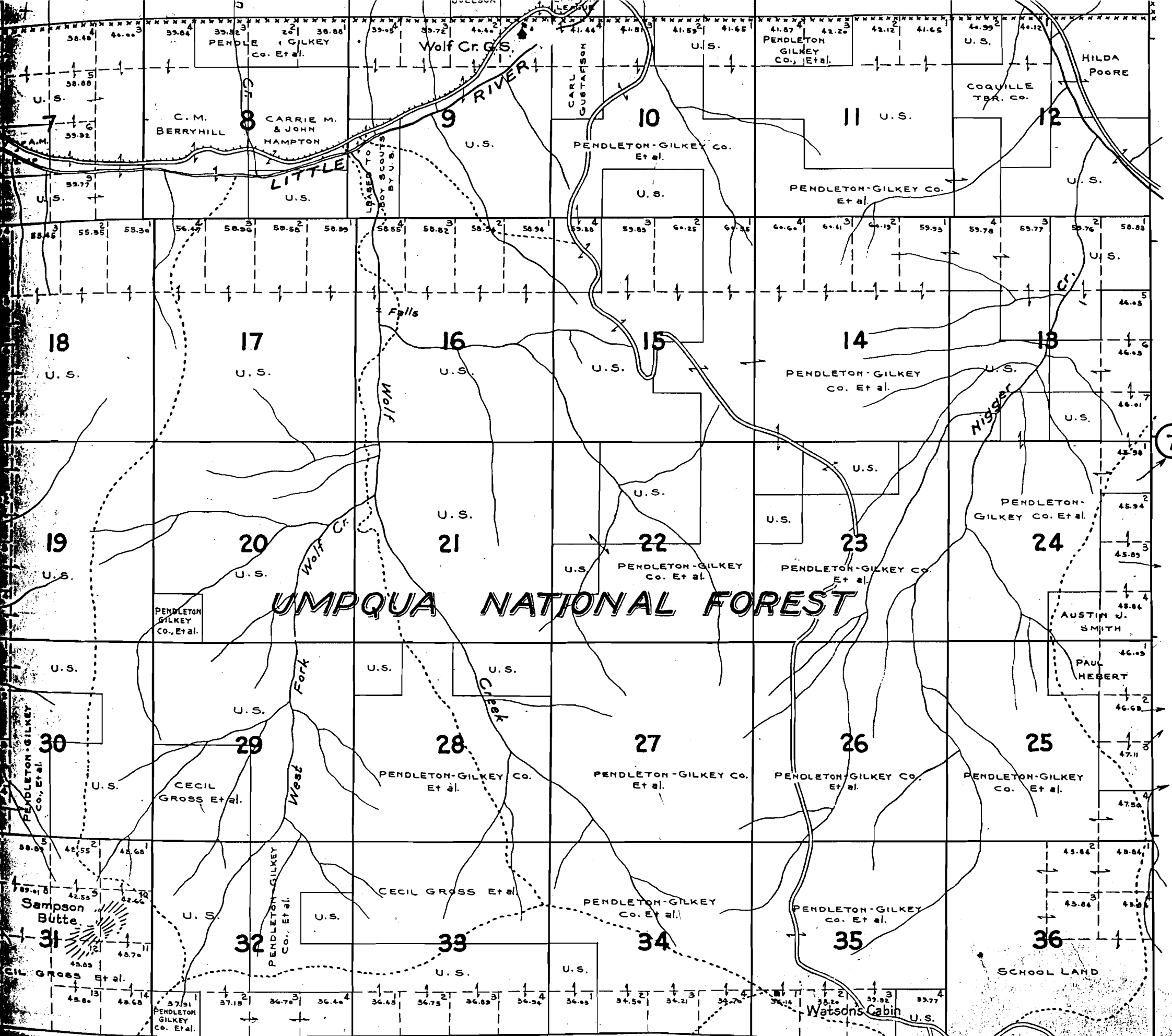

UMPQUA NATIONAL FOREST

-LEGEND-

- PAVED ROADS
- STATE HIGHWAYS
- GRAVELED ROADS
- DIRT ROADS
- INFERIOR ROADS
- RAILROADS
- TRAILS
- INTERMITTENT CREEKS
- SCHOOLS

James & KAREN HAZLET
Block 3 Lot 2

FOREST HAVEN 1ST ADDITION SECTION 12, T.27S., R.2W., W.M.

APRIL 1974

SCALE: 1"=100'

DEDICATION

KNOW ALL MEN BY THESE PRESENTS that Calvin D. Willis and Ramona D. Willis are owners of the land shown and described on the annexed plat, and that we have caused the same to be surveyed and to be platted by the name of "Forest Haven, First Addition" and that we hereby dedicate to use of the public forever the streets shown hereon.

Calvin D. Willis Ramona D. Willis

ACKNOWLEDGMENT

STATE OF OREGON)
COUNTY OF DOUGLAS)

On the 15th day of May 1974 before me appeared Calvin D. Willis and Ramona D. Willis to me known to be the persons described in and who executed the foregoing dedication, who being duly sworn, did say that they executed the same for the purpose set forth therein.

Notary Public, State of Oregon
My commission expires , 197 .

FILED

MAY 22

G. D. Myltenbeck
County Clerk

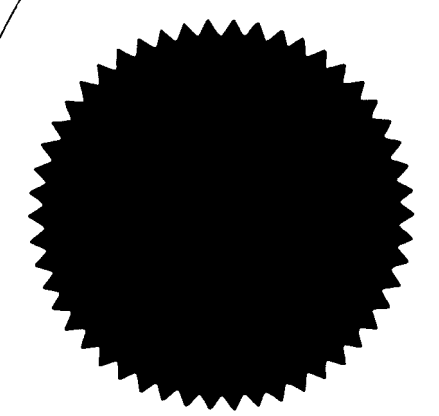
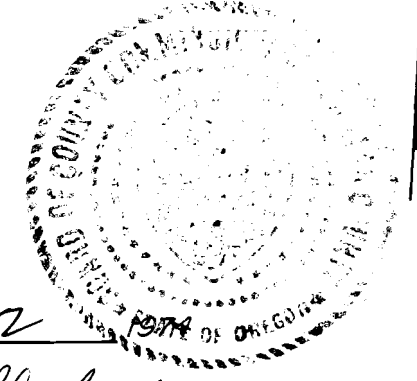

LEGEND

- — Set 2" iron pipe
- — Set 5/8" iron rod
- — Set 1/2" iron rod
- — not set

APPROVALS

BY ORDER OF COUNTY BOARD OF COMMISSIONERS

Approved 21 MAY 1974
Ray E. Warner
Chairman

Approved 21 MAY 1974
G. D. Myltenbeck
Commissioner

Approved 197

Commissioner

Approved 16 May 1974
Francis L. Ingram
County Surveyor

Approved May 21, 1974
Spauld W. Starnes Jr.
County Assessor

Approved Jamark Gray 1974
13 May 1974
County Health Officer

BY ORDER OF COUNTY PLANNING COMMISSION

Approved 9 May 1974
Dudley Owsen
President

Approved May 9 1974
Sara L. House
Secretary



BLOCK 4
(40.14 CC.)

STATE OF OREGON)
COUNTY OF DOUGLAS)

I, G. D. Myltenbeck, County Clerk of Douglas County, Oregon, do hereby certify that the within copy of plat has been compared by me with the original thereof and that it is an exact copy of the whole thereof as the same appears on file in my office and custody.

Witness my hand and official seal this day of , 197 .

County Clerk

NOTE:
Lot 2 Block 1, Lot 2 Block 3 & Block 4, have not been approved as to suitability for the placement of sub surface sewer systems.

U.S. FLYWOOD

VOL. 15 PAGE 2 A

VOL. 15 PAGE 2 A

Based on plat "FOREST HAVEN"

C 1/4 Section 12

N89°45'35"W 1918.02'

UMPQUA NATIONAL FOREST