

SURFACE WATER REGISTRATION CHECKLIST

(received after July 18, 1990)

CHECK BASIN MAP yes NAME Wuyqian # 16 UNADJUDICATED AREA ? yes
RECEIPT # 95072 S W R NUMBER 328
CHECK ENCLOSURES yes PRELIMINARY DATA BASE ENTRY Def
ACKNOWLEDGEMENT LETTER yes ENTER ON STREAM INDEX _____
CHECK QUADRANGLE MAP _____ CHECK GLO PLATS _____
WATERMASTER CHECKLIST _____ PUBLIC NOTICE PUBLICATION SCA

FORM REVIEW

_____ blanks filled in
_____ signed
_____ date received stamped

MAP REVIEW

source and trib
 diversion point location
 conveyances (pipes, ditch, etc.)
 place of use
 scale
 township, range, section
 north arrow
 CWRE stamp
 disclaimer
_____ date survey was performed
 P.O.B. of survey
 dimensions and capacity of diversion system
 "beneficial use" type title
 "permanent-quality" paper

WATER RIGHT RECORD CHECK _____ FIELD INSPECTION _____
FINAL FILE REVIEW _____ FINAL DATA BASE ENTRY _____
ENTER ON PLAT CARDS _____

April 6, 1993

HIRAM B GERMOND
8694 HUBBARD CREEK ROAD
UMPQUA OR 97486

RE: SWR-328

Dear Mr Germond,

This will acknowledge the receipt of the CWRE map and data sheet to be added to your file. A review of all information in the file will be completed in the future.

If you have any questions, please give me a call.

Sincerely,

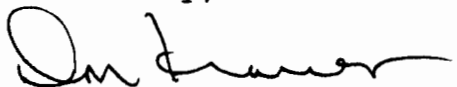

Don Knauer
Adjudication Specialist

J:\WIS\C\3\SWR-0328.004



March 30, 1993

HIRAM B GERMOND
8694 HUBBARK CREEK ROAD
UMPQUA OR 97486

RE:SWR-328

Dear Mr Germond,

I contacted Jim Gosson in regards to the required map to support the claim you have made to a pre-1909 water right. He told me he had sent the mylar map and description of the delivery system to you around March 4, 1993. That information is required to be submitted to the Water Resources Department before we can complete processing you claim. Please send it as soon as possible.

If you have any questions, please give me a call.

Sincerely,

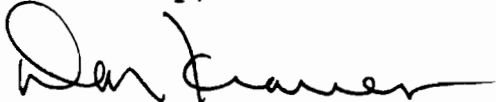
Don Knauer
Adjudication Specialist

m:\w\s\c\swr-0328.003



March 4, 1993

JAMES GOSSON
580 SOUTH STATE ST
SOUTHERLIN OR 97479

RE: Surface Water Registration Map

Dear JIM,

HIRAM B GERMOND has indicated to the Oregon Water Resources Department (WRD) that you have been hired to prepare the claim of beneficial use map for their Surface Water Registration Statement. Would you please inform me of your anticipated schedule of map preparation and submission to the WRD.

Please mark all correspondence related to this claim with the file number SWR-328.

Sincerely,

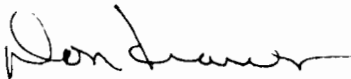

Don Knauer
Adjudication Specialist

C:\WP51\SWR\CLAIMANT\SWR-0328.002



March 4, 1993

HIRAM B GERMOND
8694 HUBBARD CREEK ROAD
UMPQUA OR 97486

Dear MR GERMOND,

This will acknowledge that your Surface Water Registration Statement in the name of HIRAM B GERMOND has been received by our office. The fees in the amount of \$200.00 have been received and our receipt #95672 is enclosed. Your registration statement has been numbered SWR-328.

Our office will review your form and map in the near future. If necessary we will schedule a meeting with you that will include a site inspection. If there are problems with your form we are usually able to take care of them during our visit. We will be able to answer any questions you might have about the adjudication process at that time.

Please feel free to contact this office if you have any questions.

Sincerely,

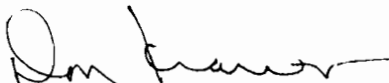

Don Knauer
Adjudication Specialist

Enclosure

C:\WP51\SWR\CLAIMANT\SWR-0328.001



**STATE OF OREGON
WATER RESOURCES DEPARTMENT**

RECEIPT # **95672**

3850 PORTLAND ROAD NE
SALEM, OR 97310
378-8455/378-8130 (FAX)

RECEIVED FROM: Georgetown Living Trust
BY: _____

APPLICATION	
PERMIT	
TRANSFER	

CASH: CHECK: # X 96-505 OTHER: (IDENTIFY)

TOTAL REC'D \$ 200.00

01-00-0 WRD MISC CASH ACCT

842.010	ADJUDICATIONS	\$ <u>200.00</u>
831.087	PUBLICATIONS/MAPS	\$
830.650	PARKING FEES Name/month	\$
_____	OTHER: (IDENTIFY)	\$

REDUCTION OF EXPENSE

CASH ACCT.	\$
COST CENTER AND OBJECT CLASS	VOUCHER #

03-00-0 WRD OPERATING ACCT

MISCELLANEOUS:

840.001	COPY FEES	\$
850.200	RESEARCH FEES	\$
880.109	MISC REVENUE: (IDENTIFY)	\$
520.000	OTHER (P-6): (IDENTIFY)	\$

WATER RIGHTS:		EXAM FEE		RECORD FEE
842.001	SURFACE WATER	\$	842.002	\$
842.003	GROUND WATER	\$	842.004	\$
842.005	TRANSFER	\$	842.006	\$
WELL CONSTRUCTION		EXAM FEE		LICENSE FEE
842.022	WELL DRILL CONSTRUCTOR	\$	842.023	\$
842.016	WELL DRILL OPERATOR	\$	842.019	\$
	LANDOWNER'S PERMIT		842.024	\$

06-00-0 WELL CONST START FEE

842.013	WELL CONST START FEE	\$	CARD #	
	MONITORING WELLS	\$	CARD #	

45-00-0 LOTTERY PROCEEDS

864.000	LOTTERY PROCEEDS	\$
---------	------------------	----

07-00-0 HYDRO ACTIVITY

		LIC NUMBER	
842.011	POWER LICENSE FEE(FW/WRD)		\$
842.115	HYDRO LICENSE FEE(FW/WRD)		\$
_____	HYDRO APPLICATION		\$

RECEIPT # **95672**

DATED: 12-30-92

BY: [Signature]

**SURFACE WATER REGISTRATION STATEMENT
PRE-1909 VESTED WATER RIGHT CLAIM
IN THE NAME OF HIRAM B. GERMOND**

DESCRIPTION OF THE PRESENT DELIVERY SYSTEM

Water is diverted from the un-named stream by gravity via a 3/4" x 75' poly pipeline to a metal tank of approximately 160 gallons, thence via a 3/4" x 400' gravity pipeline to a pumphouse containing a 3/4 horsepower electric motor, centrifugal pump, and pressure tank. The water is delivered under pump pressure via a 3/4" x 600' poly pipeline to the place of use.

A well also delivers water through a portion of the delivery system to the place of use when the quantity of water available from the un-named stream is not sufficient to meet the demand.

Diversions to Holding Tank

3/4" x 75' poly

Holding Tank to Pumphouse

3/4" x 400' poly
H_{ELEVATION}: 40'

Pumphouse to Place of Use

3/4" x 600' poly
H_{ELEVATION}: 25'

Motor
Serial #: 7K83
Model #: C48K2D811A7
Brand: A.O. Smith, Inc.
HP: 3/4
RPM: 3450

Pump
Brand: Aermotor Corp.
Type: Centrifugal
Intake: 1 1/2"
Discharge: 1 1/4"
Serial #: Unknown

CAPACITY OF PRESENT DELIVERY SYSTEM

$$USING Q = \frac{CxHP}{H}$$

WHEN

C = 6.61

HP = 3/4

H = H_{ELEVATION} + H_{PRESSURE} + H_{FRICTION} = 25 ft. + 30 LBS/INCH² + 20'/100' (est)

H = 25 + (2.31)(30) + (20)(6)

H = 214

THEN Q = $\frac{(6.61)(0.75)}{214} = 0.0231 \text{ cfs}, > 0.01 \text{ cfs}, \text{ O.K.}$

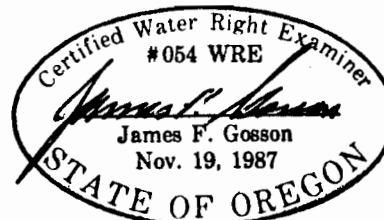

JAMES F. GOSSON Consulting Engineer

580 South State Street
Sutherlin, Oregon 97479

CIVIL ENGINEER
LAND SURVEYOR
WATER RIGHTS EXAMINER

RECEIVED (503) 459-2243

MAR 29 1993

WATER RESOURCES DEPT.
SALEM, OREGON

March 25, 1993

Oregon Water Resources Department
3850 Portland Road, N.E.
Salem, Oregon 97310

Attention: Don Knauer

Re: SWR - 328 (Germond)

Dear Don,

In response to your letter of March 4, 1993, I sent a mylar map and description of the delivery system to Mr. Germond on about February 10, 1993.

I am enclosing a paper copy of the map and a copy of the description of the delivery system for your information.

Very truly yours,

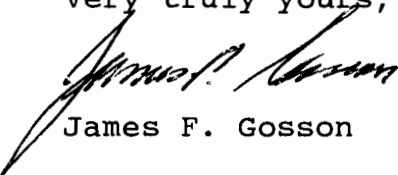
James F. Gosson

Enclosures

JFG/p

**REGISTRATION STATEMENT MAP
PRE-1909 SURFACE WATER RIGHT CLAIM
IN THE NAME OF HIRAM B. GERMOND**

MAR 29 1993
WATER RESOURCES DEPT.
SALEM, OREGON

SECTION 29, TOWNSHIP 25 SOUTH, RANGE 7 WEST, W.M.

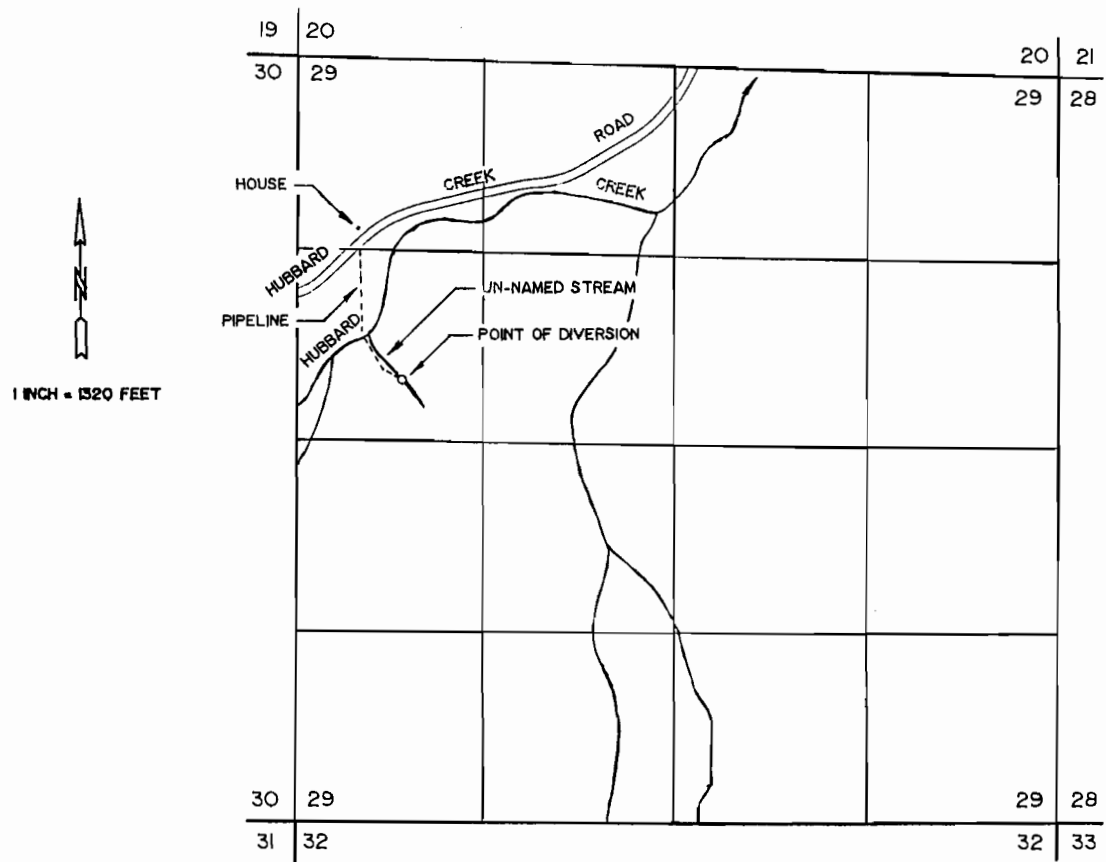

THE POINT OF DIVERSION IS LOCATED 420 FEET NORTH AND 720 FEET EAST FROM THE WEST 1/4 CORNER OF SECTION 29, BEING WITHIN THE SW 1/4 OF THE NW 1/4 OF SECTION 29, TOWNSHIP 25 SOUTH, RANGE 7 WEST, W.M., DOUGLAS COUNTY.

THE PURPOSE OF THIS MAP IS TO IDENTIFY THE LOCATION OF THE WATER RIGHT. IT IS NOT INTENDED TO PROVIDE INFORMATION RELATIVE TO THE LOCATION OF PROPERTY OWNERSHIP BOUNDARY LINES.

Certified Water Right Examiner
 #054 WRE
 James F. Gosson
 Nov. 19, 1987
 STATE OF OREGON

SURFACE WATER REGISTRATION STATEMENT
PRE-1909 VESTED WATER RIGHT CLAIM
IN THE NAME OF HIRAM B. GERMOND

MAR 29 1993
WATER RESOURCES DEPT.
SALEM, OREGON

DESCRIPTION OF THE PRESENT DELIVERY SYSTEM

Water is diverted from the un-named stream by gravity via a 3/4" x 75' poly pipeline to a metal tank of approximately 160 gallons, thence via a 3/4" x 400' gravity pipeline to a pumphouse containing a 3/4 horsepower electric motor, centrifugal pump, and pressure tank. The water is delivered under pump pressure via a 3/4" x 600' poly pipeline to the place of use.

A well also delivers water through a portion of the delivery system to the place of use when the quantity of water available from the un-named stream is not sufficient to meet the demand.

Diversion to Holding Tank

3/4" x 75' poly

Holding Tank to Pumphouse

3/4" x 400' poly

H_{ELEVATION}: 40'

Pumphouse to Place of Use

3/4" x 600' poly

H_{ELEVATION}: 25'

Motor
Serial #: 7K83
Model #: C48K2D811A7
Brand: A.O. Smith, Inc.
HP: 3/4
RPM: 3450

Pump
Brand: Aermotor Corp.
Type: Centrifugal
Intake: 1 1/2"
Discharge: 1 1/4"
Serial #: Unknown

CAPACITY OF PRESENT DELIVERY SYSTEM

$$USING Q = \frac{CxHP}{H}$$

WHEN

C = 6.61

HP = 3/4

H = H_{ELEVATION} + H_{PRESSURE} + H_{FRICITION} = 25 ft. + 30 LBS/INCH² + 20'/100' (est)

H = 25 + (2.31)(30) + (20)(6)

H = 214

THEN Q = $\frac{(6.61)(0.75)}{214} = 0.0231 \text{ cfs}, > 0.01 \text{ cfs}, \text{ O.K.}$

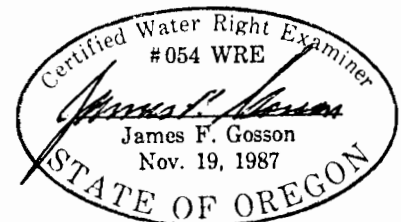

RECEIVED

DEC 30 1992

WATER RESOURCES DEPT.
SALEM, OREGON

#22227

Book 73 pg. 308

J C Fullerton et ux

To

W C Gaddis

THIS INDENTURE WITNESSETH, That we, J C Fullerton, and Clara Fullerton, his wife, in consideration of the sum of Three thousand Dollars, topaid, ha.. bargained and sold and by these presents do bargain sell and convey unto W C Gaddis the following described premises, to-wit:

The Lots numbered nine (9) and ten (10) in Block numbered fifty six (56) in the Railroad Addition of the City of Roseburg, Douglas County, Oregon, as the same appears of record in the office of the County Clerk of Douglas County, Oregon, together with the tenements and appurtenances thereunto belonging or in anywise appertaining,

This conveyance is made subject to the lien of the City of Roseburg, against the premises hereinbefore described on account of street improvements as shown by the record of said City of Roseburg.

TO HAVE AND TO HOLD said premises, with their appurtenances unto the said W C Gaddis his heirs and assigns forever, And the said J C Fullerton does hereby covenant to and with the said W C Gaddis his heirs and assigns that he is the owner in fee simple of said premises; that they are free from all incumbrances except as above stated and that he will warrant and defend the same from all lawful claims whatsoever.

IN WITNESS WHEREOF we have hereunto set our hands and seals this seventh (7) day of February A D 1914.

Done in presence of

W W Cardwell

J O Watson,

STATE OF OREGON,

County of Douglas,) SS.

J C Fullerton (Seal)

Clara Fullerton, (Seal)

On this the seventh day of February 1914 personally came before me a Notary Public in and for said County the within named J C Fullerton and Clara Fullerton his wife, to me personally known to be the identical persons described in and who executed the within instrument and acknowledged to me that they executed the same freely and voluntarily for the uses and purposes therein named.

Witness my hand & seal this 7th day of February 1914.

J O Watson,

Notary Public for Oregon.

Filed for record February 9th 1914, At 11 a. m., E H Lenox, County Clerk,

By: *[Signature]* Deputy,

L T Thompson, et ux

To

Jacob S Germond et al

#22228

KNOW ALL MEN BY THESE PRESENTS, That we, L T Thompson and Ann Thompson, husband and wife, of Douglas County, State of Oregon, in consideration of ten (\$10.00) Dollars to them paid by Jacob S Germond and C L Germond, of Douglas County, State of Oregon, have bargained and sold and by these presents do grant bargain sell and convey unto said Jacob S Germond and C L Germond their heirs and assigns all the following bounded and described real property, situated in the County of Douglas and State of Oregon,

South half of Northwest quarter (S $\frac{1}{2}$ of NW $\frac{1}{4}$) of Section twenty nine (29) and the Northwest quarter (NW $\frac{1}{4}$) of Section thirty one (31) Township twenty five (25) South Range seven (7) West of the Willamette Meridian, Douglas County, State of Oregon, containing two hundred forty (240) acres more or less, together with all and singular the tenements, hereditaments and appurtenances thereto belonging or in anywise appertaining, and also all our estate, right title and interest in and to the same including dower and claim of dower.

TO HAVE AND TO HOLD the above described and granted premises unto the said Jacob S Germond and C L Germond, their heirs and assigns forever. And we L T Thompson and Ann Thompson, grantors above named do covenant to and with Jacob S Germond and C L Germond the above named grantees their heirs and assigns that we are lawfully seized in fee simple of the above granted premises, that the above granted premises are free from all incumbrances, and that we will and our heirs, executors and administrators shall warrant and forever defend the above granted premises and every part and parcel thereof against the lawful claims and demands of all persons whomsoever.

IN WITNESS WHEREOF we the grantors above named have hereunto set our hands and seals this first day of May 1913.

Signed sealed and delivered in the presence of us as witnesses.

E D Briggs,

B L Eddy,

STATE OF OREGON,

County of Douglas,) SS.

L T Thompson, (Seal)

Ann Thompson, (Seal)

BE IT REMEMBERED That on this first day of May A D 1913 before me the undersigned a Notary Public in and for said County and State, personally appeared the within named L T Thompson and Ann Thompson who are known to me to be the identical persons described in and who executed the within instrument and acknowledged to me that they executed the same freely and voluntarily.

IN TESTIMONY WHEREOF I have hereunto set my hand and Notarial seal the day and year last above written.

B L Eddy,

Notary Public for Oregon.

Filed for record February 9th 1914, E H Lenox, County Clerk,

By: *[Signature]* Deputy,

Frank T Storrs,

To

Sampson S Start,

#22230

KNOW ALL MEN BY THESE PRESENTS, That Frank T Storrs and Emma K Storrs, of Baker, County of Baker, State of Oregon, in consideration of Twenty five dollars Dollars to be paid by Sampson S Start, of Baker County of Baker, State of Oregon, have bargained and sold and by these presents do grant bargain sell and convey unto said Sampson S Start his heirs and assigns one half interest in all the following bounded and described real property situate in the County of Douglas, and State of Oregon,

The Lot number one (1) of Section 15, the lot number 7 and the northeast quarter of the Southeast quarter of Section 16, the lots numbered one, two and three and the northwest quarter of the southwest quarter of section 21, also that part of the

496 57

RECEIVED

DEC 30 1902

WATER RESOURCES DEPT. SALEM, OREGON

496

Sheriff

To

L T Thompson

This Indenture, made this 28th day of January A D 1903 between E L Parrott Sheriff of the County of Douglas, State of Oregon of the first part and L T Thompson of the second part, Witnesseth that Whereas, by virtue of a tax warrant issued out of the Clerk's office of the County Court of the State of Oregon for the County of Douglas on the 30th day of July 1900 under the seal of said Court, and to the said Sheriff directed and delivered commanding him to levy upon the goods and chattels of the delinquent Taxpayers named in the Delinquent Tax Roll for the year 1899 thereunto attached and if none be found then upon the real property as set forth and described in said Tax Roll so charged thereon, together with costs and expenses.

And Whereas, Because sufficient personal property of G B Davidson Est Delinquent Tax payer could not be found whereof the said Sheriff could cause to be made the amount of taxes due from the said Delinquent Tax payer specified in said Tax Roll; the said Sheriff did in obedience to said command levy upon and seize all the right title and interest which the said Delinquent Tax payer had to the hereinafter described premises and did on the 26th day of January A D 1907 sell all the right title and interest of the said G B Davidson Est Delinquent Tax payer had in and to the said premises at Public Auction at the Court House door in said County of Douglas between the hours of nine in the morning and four in the afternoon of that day to wit at one o'clock P M having first given due notice of the time and place of such sale according to law at which sale said premises were struck off and sold to the said party of the second part for the sum of Three & 55/100 Dollars Gold Coin of the United States of America he being the highest bidder and that being the highest sum bidden for the same whereupon the said Sheriff gave to the said party of the second part such certificate of said sale as is by law directed to be given; and Whereas, Two years have elapsed since the sale of said real property by the said Sheriff and no redemption having been made of the premises so sold as by law provided; Now This Indenture Further Witnesseth, That the said party of the first part by virtue of said Tax Warrant and in pursuance of the Statute in such cases made and provided and in consideration of the sum of money so bid as aforesaid to him in hand paid has sold and by these presents does sell grant and convey unto the said party of the second part all the right, title and interest which the said G B Davidson Est Delinquent Tax Payer had in and to the following described premises to; wit:

1/2 of NW 1/4 Sec 29 Tp 25 S R 7 W, 80 acres together with all and singular tenements, hereditaments and appurtenances thereunto belonging or in any wise appertaining To have and to hold the same unto the said L T Thompson heirs and assigns forever, as fully and absolutely as the said Sheriff of said Douglas County can or ought to by virtue of said Tax Warrant and the proceedings thereunder and the law relating thereto, sell grant and convey said premises.

In Witness Whereof I have hereunto set my hand and seal this 28th day of January 1903
Signed sealed and delivered in the presence of
E L Parrott (seal)
Sheriff and Tax Collector of Douglas County

H T McClallen
D R Shambrook

State of Oregon)
County of Douglas) ss. On this 28th day of January A D 1903 personally appeared before me a County Clerk in and for said County the above named E L Parrott Sheriff of Douglas County, to me well known to be the identical person described in and who executed the foregoing conveyance and acknowledged to me that he, in his official capacity as such sheriff executed the same for the uses and purposes therein set forth.

Witness my hand and seal of the County Court of Douglas County State of Oregon this 28th day of January 28 A D 1903

(seal) D R Shambrook
County Clerk

Filed and recorded October 25th, 1907

C O White et ux To M H Foreman
Know all men by these presents, That C O White and Clara E White his wife of Douglas County, State of Oregon, in consideration of One Thousand and Fifty and no/100 Dollars to them paid by J H Foreman of Douglas County State of Oregon have bargained and sold and by these presents do grant, bargain, sell and convey unto said J H Foreman his heirs and assigns all the following bounded and described real property situated in the County of Douglas and State of Oregon: Commencing at a point which forms a corner to sections 21, 22 27 and 28, in Township 29 South of Range 1 West of Willamette Meridian, and running thence East along the section line between said sections 22 and 27 for a distance of 19.62 chains to a rock in the County Road, 1 foot square (said rock also being the North east corner of Johnson's Addition to Myrtle Creek) thence running North 20 degrees and 40 minutes East for a distance of 16.42 chains to the South west corner of the tract of land herein conveyed (which is tied with Bearing Tree) as follows: Black Oak 8 inches in Diameter bears South 3 degrees West at a distance of 14 links and White Oak 12 inches in Diameter bears North 12 degrees West at a distance of 46 links) thence running North for a distance of 16.78 chains to the North west corner of said tract (which corner is marked by an iron rod in the ground and is tied by two bearing trees as follows: White Oak tree 7 inches in Diameter bears South 15 degrees West at a distance of 88 links and a Laurel tree 10 inches in Diameter bears South 55 Degrees East at a distance of 63 links) thence East 34.20 chains to the North East corner of said tract (which corner is marked by a post in the County road and which corner is also tied by two bearing trees as follows: Laurel Tree 10 inches in Diameter bears North 40 Degrees East at a distance of 63 links and a white oak tree 12 inches in Diameter bears South 15 degrees West at a distance of 88 links)

Book 73 pg 521

RECEIVED

DEC 30 1932

WATER RESOURCES DEPT.
SALEM, OREGON

STATE OF OREGON,
County of Multnomah,) SS.

Be it Remembered That on this 3rd day of March A D 1914, before me, the undersigned a Notary Public in and for said County and State, personally appeared the within named Adeline M Tarr and W B Tarr, husband & wife, who are known to me to be the identical persons described in and who executed the within instrument and acknowledged to me that they executed the same freely and voluntarily.

IN TESTIMONY WHEREOF I have hereunto set my hand and notarial seal the day and year last above written.

(Seal) John A McKee,
Notary Public in and for State of Oregon.
Filed for record April 29th 1914 at 8 a m., E H Lenox, County Clerk,
By: *Pete K. Cook* Deputy,

Jacob S Germond, -----
To C L Germond et ux #23371

DEED OF PARTITION.

THIS INDENTURE made the 7th day of February, 1894, between Jacob S Germond (a single man) of the County of Douglas, State of Oregon, party of the first part, and C L Germond and Lovie A Germond his wife of the County of Douglas, State of Oregon, parties of the second part, Witnesseth:

WHEREAS the said Jacob S Germond and C L Germond do now hold as tenants in common in equal parts, certain tracts, pieces or parcels of land situated in Douglas County, Oregon, being the same premises conveyed to them by L T Thompson and Ann Thompson, his wife, by deed bearing date May 1, 1913, and whereas, the parties hereto have mutually agreed to make partition of said lands and hold their respective shares in severalty.

NOW THIS INDENTURE WITNESSETH: First, the said Jacob S Germond party of the first part, shall from henceforth have, hold, possess and enjoy in severalty by himself, and to him, and his heirs and assigns, as his share and proportion of the said lands and premises all of the South half of the Northwest quarter (S $\frac{1}{2}$ NW $\frac{1}{4}$) of Section twenty nine (29) and all of lot numbered two (2) or the Southwest quarter of the Northwest quarter (SW $\frac{1}{4}$ NW $\frac{1}{4}$) of Section thirty one (31) in Township twenty five (25) South of Range seven (7) West of Willamette Meridian in said Douglas County, Oregon; and the said parties of the second part in consideration of the premises and of one (\$1.00) Dollar to them in hand paid, the receipt whereof is hereby acknowledged, do hereby give, grant, bargain, sell, set over, convey, release and confirm unto the said Jacob S Germond, the party of the first part, his heirs and assigns forever the last above described premises. Together with all and singular the tenements, hereditaments and appurtenances thereunto belonging or in any wise appertaining, and also all the estate, right, title and interest including dower and claim of dower of said parties of the second part, both at law and in equity in or to the above granted premises.

TO HAVE AND TO HOLD the above granted premises, together with the appurtenances unto the said Jacob S Germond his heirs and assigns forever.

Second, the said C L Germond, party of the second part, shall from henceforth have, hold, possess and enjoy in severalty by himself and to him and his heirs and assigns, for his share and proportion of the said lands and premises all of lot numbered one (1) or the North west quarter of the North west quarter (NW $\frac{1}{4}$ NW $\frac{1}{4}$) and all of the East half of the North west quarter (E $\frac{1}{2}$ NW $\frac{1}{4}$) of Section thirty one (31) in Township twenty five (25) South of Range seven (7) West of Willamette Meridian, in said county and State; and the said party of the first part in consideration of the premises and one (\$1.00) dollars to him in hand paid, does hereby give, grant, bargain, sell, set over, convey, release and confirm unto the said C L Germond, the party of the second part, his heirs and assigns forever, the last above described premises. Together with all and singular the tenements, hereditaments and appurtenances thereto belonging or in anywise appertaining, and also all the estate, right, title and interest of the party of the first part, both at law and in equity in and to the above granted premises.

TO HAVE AND TO HOLD all and singular the above granted premises, together with the appurtenances unto the said C L Germond his heirs and assigns forever.

IN WITNESS WHEREOF the parties to this indenture have hereunto set their hands and seals in duplicate the day and year first above written.

Signed sealed and delivered in the presence of us as witnesses.
Olive L Walker,
B L Eddy,

Jacob S Germond, (Seal)
C L Germond, (Seal)
Lovie A Germond. (Seal)

STATE OF OREGON,
County of Douglas,) SS.

BE IT REMEMBERED That on this 7th day of February A D 1914, before me the undersigned a Notary Public in and for said County and State, personally appeared the within named Jacob S Germond and C L Germond, and Lovie A Germond who are known to me to be the identical individuals described in and who executed the foregoing instrument and acknowledged to me that they executed the same freely and voluntarily.

IN TESTIMONY WHEREOF I have hereunto set my hand and notarial seal the day and year last above written.

(Seal) B L Eddy,
Notary Public for Oregon.
Filed for record April 29th 1914, E H Lenox, County Clerk,
By: *Pete K. Cook* Deputy,

H A Kaeppler et ux -----
To J J Meredith et al #23372

WARRANTY DEED.

KNOW ALL MEN BY THESE PRESENTS, That H A Kaeppler and Etta M Kaeppler, his wife, of Portland in the County of Multnomah, and State of Oregon in consideration of the sum of Fifteen thousand four hundred dollars (\$15,400.00) to them paid by J J Meredith and S C Meredith of New Salem, in the County of Morton and State of North Dakota, have bargained and sold and by these presents do grant, bargain, sell and convey unto said J J Meredith, his heirs and assigns an undivided share of the following described premises:

KNOW ALL MEN BY THESE PRESENTS, That JACOB S. GERMOND, a single man, Umpqua, Oregon

in consideration of TEN DOLLARS AND OTHER VALUABLE CONSIDERATIONS Grantor Dollars,

to him paid by HIRAM B. GERMOND and MELBA L. GERMOND, husband and wife, of UMPQUA, OREGON grantee

do hereby grant, bargain, sell and convey unto the said grantee heirs and assigns, all the following real property, with the tenements, hereditaments and appurtenances, situated in the County of Douglas and State of Oregon, bounded and described as follows, to-wit

South half of the North West quarter (S 1/2 of NW 1/4), and the North West quarter of the South West quarter (NW 1/4 of SW 1/4) of Section Twenty-Nine (29),

and the South thirty-five (35) acres of the North East quarter of the South East quarter (NE 1/4 of SE 1/4) of Section Thirty (30); in Township Twenty-five (25) South of Range Seven (7), west of the Willamette Meridian, in Oregon.



To Have and to Hold the above described and granted premises unto the said grantee heirs and assigns forever.

And the grantor do hereby covenant that he lawfully seized in fee simple of the above granted premises free from all incumbrances.

No exceptions and that he will and his heirs, executors and administrators, shall warrant and forever defend the above granted premises, and every part and parcel thereof, against the lawful claims and demands of all persons whomsoever.

Witness my hand and seal this 6th day of May 19 49

Handwritten signature of Jacob S. Germond with a circular seal to the right.

STATE OF OREGON (SEAL)

County of Douglas on this 6th day of May 19 49

before me, the undersigned, a Notary Public in and for said County and State, personally appeared the within named

Jacob S. Germond

who is known to me to be the identical individual described in and who executed the within instrument, and acknowledged to me that he executed the same freely and voluntarily.

IN TESTIMONY WHEREOF, I have hereunto set my hand and affixed my official seal the day and year last above written.

Handwritten signature of the Notary Public.

Notary Public for Oregon

My Commission expires Jan 17, 1958

WARRANTY DEED

FORM No. 411

JACOB S. GERMOND

TO

HIRAM B. GERMOND

MELBA L. GERMOND

STATE OF OREGON

County of Douglas

I certify that the within instrument was received for record on the 4th day of May 1949 at 10 o'clock P.M. and recorded in book 107 on page 111 of said County Record of Deeds.

Witness my hand and seal of County affixed

ROY AGEE

County Clerk-Recorder

Handwritten signature of Roy Agee.

Handwritten signature of the County Clerk-Recorder.

RECEIVED DEC 30 1952