

E-RECEIVED
JUL 02 2025
OWRD

Attachment A

Application Map

Groundwater Permit Application – Oregon Parks and Recreation Department

Vokhidjon Kakhramonov

From: RATCLIFFE Katie S * WRD <katie.s.ratcliffe@water.oregon.gov>
Sent: Tuesday, August 27, 2024 9:07 AM
To: Vokhidjon Kakhramonov
Subject: RE: Map scale waiver for Oregon Parks and Recreation Department (OPRD)

Good morning Vokhidjon.

I approve use of this map scale for this application for the purposes of application intake. Please include a copy of this email with application submittal so that our Customer Service Group has it in hand. If we end up needing a closer level of detail of any area of the map when the caseworker does their review, we will let you know. Please note that I have not checked the map against the other requirements of OAR 690-310-0050.

Katie

[Katie Ratcliffe](#)
Water Rights Section Manager
Oregon Water Resources Department
Phone: 971-338-8105 (work cell)
katie.s.ratcliffe@water.oregon.gov

E-RECEIVED
JUL 02 2025
OWRD

From: Vokhidjon Kakhramonov <vkakhramonov@gsiws.com>
Sent: Monday, August 26, 2024 12:55 PM
To: RATCLIFFE Katie S * WRD <katie.s.ratcliffe@water.oregon.gov>
Subject: RE: Map scale waiver for Oregon Parks and Recreation Department (OPRD)

You don't often get email from vkakhramonov@gsiws.com. [Learn why this is important](#)

Dear Katie

I attached draft maps for your review.
Please let me know if you need any additional information.

Regards,
Vokhidjon

Vokhidjon Kakhramonov
Water Resources Analyst
mobile: 541.272.5717
1600 SW Western Boulevard, Suite 240, Corvallis, OR 97333
GSI Water Solutions, Inc. | www.gsiws.com

From: Vokhidjon Kakhramonov
Sent: Monday, August 26, 2024 11:37 AM
To: Katie.S.RATCLIFFE@water.oregon.gov
Subject: Map scale waiver for Oregon Parks and Recreation Department (OPRD)

Dear Katie

Good morning

I'm writing to request a map scale waiver (per 310-0050 (2)(c)) for two groundwater permit applications to be submitted on behalf of OPRD at Silver Falls State Park. The maps use a scale of 1 inch = 4,400 ft in order to fit the entire service area. Let me know if there is anything else I can provide.

Thank you
Regards,
Vokhidjon

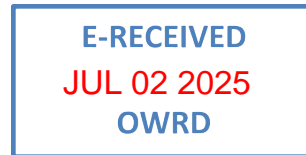

Vokhidjon Kakhramonov

Water Resources Analyst

mobile: 541.272.5717

1600 SW Western Boulevard, Suite 240, Corvallis, OR 97333

GSI Water Solutions, Inc. | www.gsiws.com

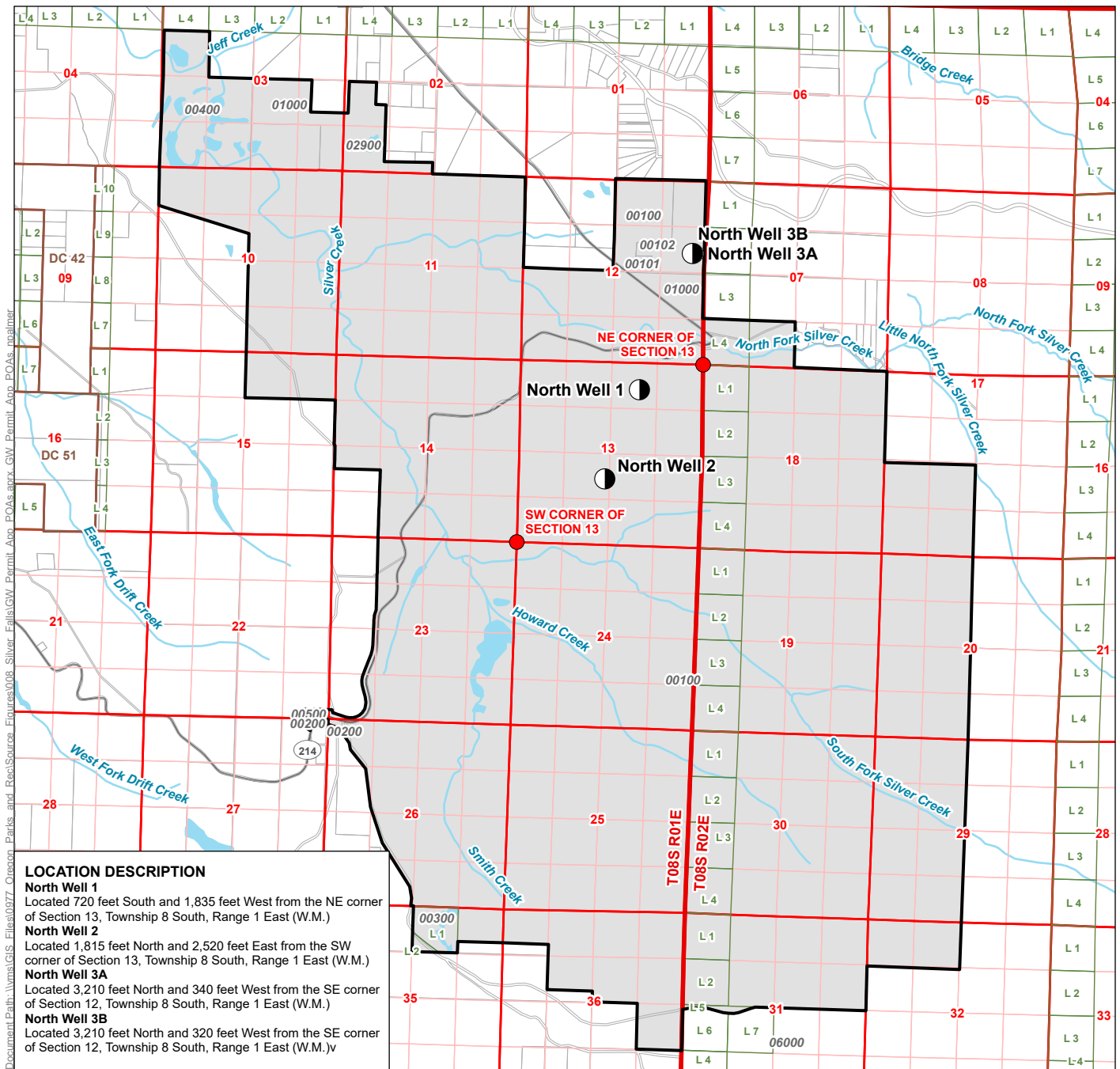

LEGEND

● Point of Appropriation

■ Place of Use (POU)

All Other Features

□ Tax Lot

■ Donation Land Survey (DLC)

■ Government Lot (GL)

— Major Road

— Watercourse

— Waterbody

Groundwater Permit Application in the Name of OPRD Proposed Place of Use/Points of Appropriation

Township 8 South, Range 1 and 2 East (W.M.)
Marion County

E-RECEIVED
JUL 02 2025
OWRD

DISCLAIMER

This map was prepared for the purpose of identifying the location of a water right only and it is not intended to provide legal dimensions or location of property ownership lines.

Date: June 27, 2025
Data Sources: BLM, ESRI, OWRD, USGS

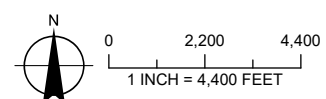

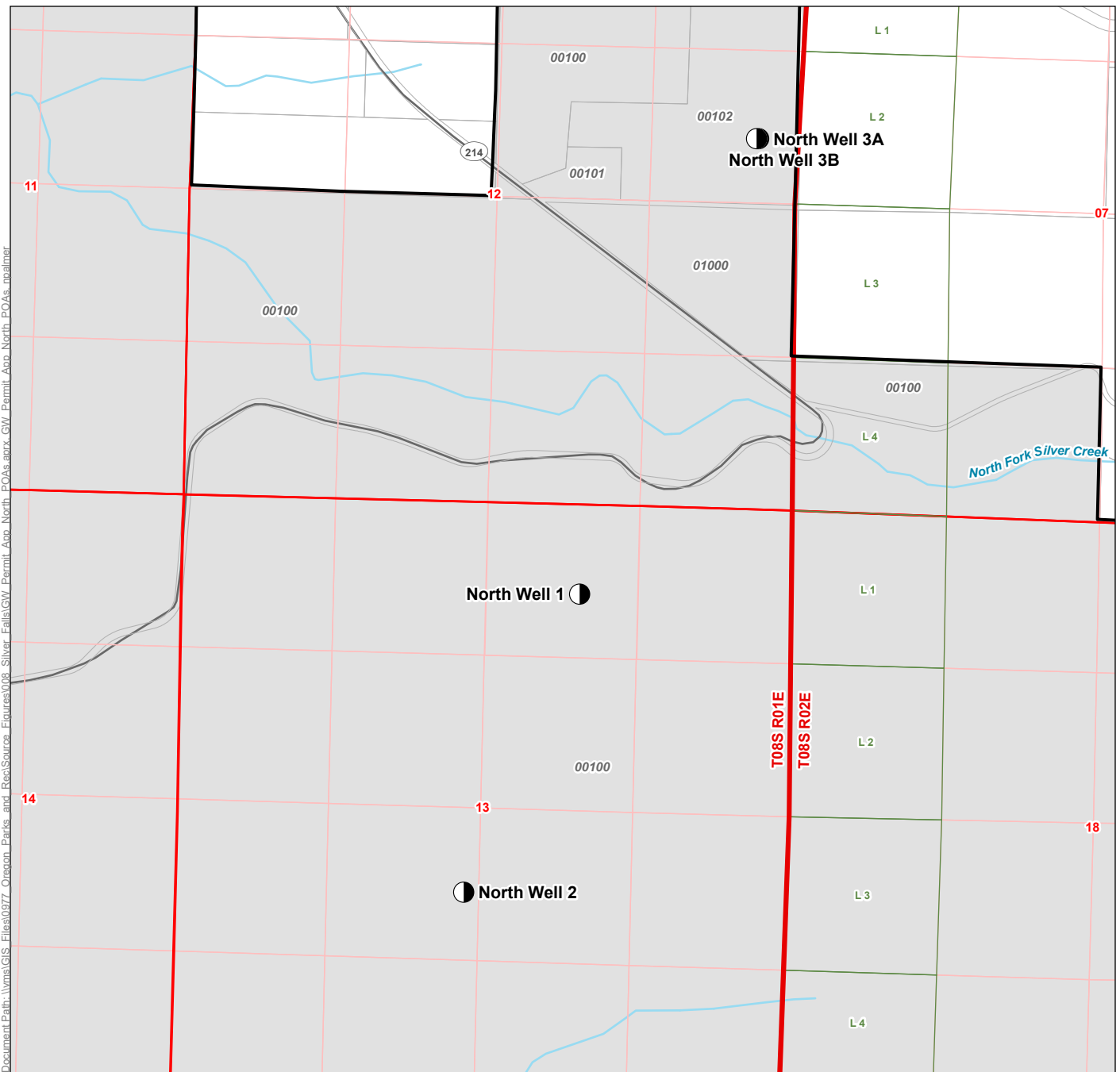

LEGEND

● Point of Appropriation

▭ Place of Use (POU)

All Other Features

▭ Tax Lot

▭ Government Lot (GL)

— Major Road

~ Watercourse

LOCATION DESCRIPTION

North Well 1

Located 720 feet South and 1,835 feet West from the NE corner of Section 13, Township 8 South, Range 1 East (W.M.)

North Well 2

Located 1,815 feet North and 2,520 feet East from the SW corner of Section 13, Township 8 South, Range 1 East (W.M.)

North Well 3A

Located 3,210 feet North and 340 feet West from the SE corner of Section 12, Township 8 South, Range 1 East (W.M.)

North Well 3B

Located 3,210 feet North and 320 feet West from the SE corner of Section 12, Township 8 South, Range 1 East (W.M.)

Groundwater Permit Application in the Name of OPRD

Proposed Place of Use/Points of Appropriation

Township 8 South, Range 1 and 2 East (W.M.)
Marion County

E-RECEIVED
JUL 02 2025
OWRD

DISCLAIMER

This map was prepared for the purpose of identifying the location of a water right only and it is not intended to provide legal dimensions or location of property ownership lines.

Date: June 27, 2025
Data Sources: BLM, ESRI, OWRD, USGS

