

CLAIM OF BENEFICIAL USE MAP
 APPLICATION S-89305, PERMIT S-55464
 SECTION 26, TOWNSHIP 33 SOUTH, RANGE 1 EAST, W.M.
 JACKSON COUNTY, OREGON

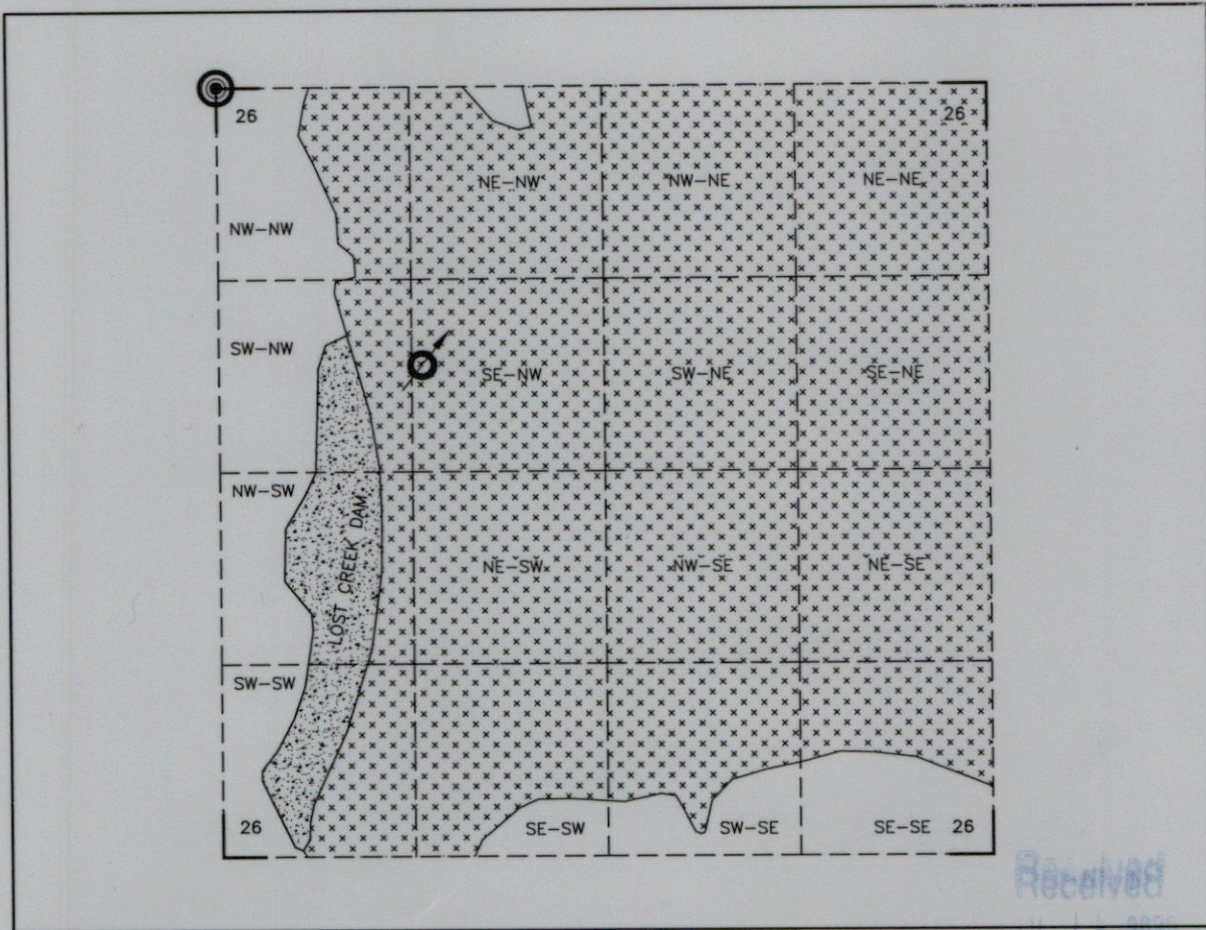

LEGEND



REFERENCE CORNER (RC):
 -RC#1 NW COR. SEC. 26, T.33S., R.1E., W.M.



POINT OF DIVERSION(POD):
 -POD#1: 1993' S. & 1237' E. FROM RC#2

--- 1/16TH SECTION LINES (AS PROJECTED)

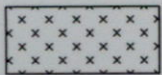

LOST CREEK RESERVOIR

Note: This map shows the location of Lost Creek Reservoir, dam, and outlet structure (POD#1). Water is stored under Permit R-8142 and released into the Rogue River per BOR contact. Downstream, POD#2 rediverts water for irrigation use.

DISCLAIMER: THIS MAP WAS PREPARED FOR THE PURPOSE OF IDENTIFYING THE LOCATION OF WATER RIGHT ONLY AND IS NOT INTENDED TO PROVIDE LEGAL DESCRIPTIONS OR LOCATIONS OF PROPERTY LINES.

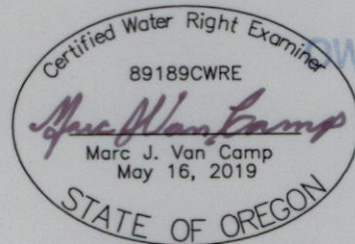

EXPIRES 06/30/2026

Received
 JUL 14 2025
 Received
 JUL 14 2025



NORTH

1"=1320'

VCC

VAN CAMP CONSULTING

P.O. Box 995
 Coos Bay, OR 97420
 (541) 297-1880
 vancampconsulting@gmail.com

Prepared For:
 Scott Fenters
 9049 Buesing Rd.
 Klamath Falls, OR
 97603





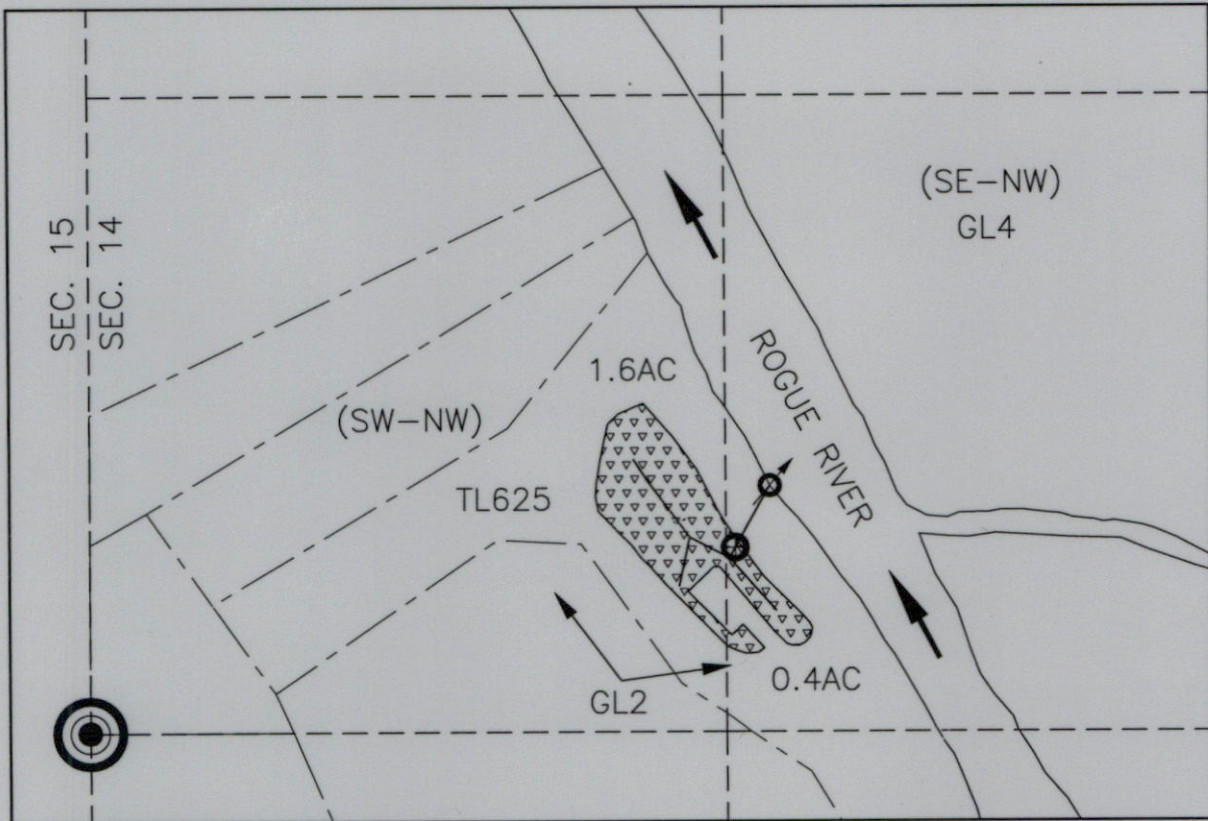

Project:
 Permit S-55464 Claim
 of Beneficial Use

April 1, 2025 Pg: 2 of 2

CLAIM OF BENEFICIAL USE MAP
 APPLICATION S-89305, PERMIT S-55464
 SECTION 14, TOWNSHIP 35 SOUTH, RANGE 7 WEST, W.M.
 JOSEPHINE COUNTY, OREGON

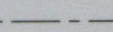

LEGEND

-  **REFERENCE CORNER (RC):**
 -RC#2 W. 1/4 COR. SEC. 14, T.35S., R.7W., W.M.
-  **POINT OF DIVERSION (POD):**
 -POD#2 & FISH SCREEN: 510' N. & 1412' E. FROM RC#2
-  **TOTALIZING FLOW METER**
-  **MAINLINE**
-  **TAXLOTS**
-  **1/16TH SECTION LINES (AS PROJECTED)**

 PLACE OF USE: IRRIGATION 2.0 ACRES
 IN GL 2 SEC. 14, T.35S., R.7W., W.M.

Received
 JUL 14 2025
 OWRB

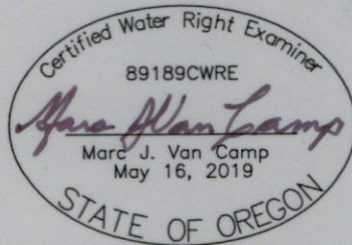

EXPIRES 06/30/2026

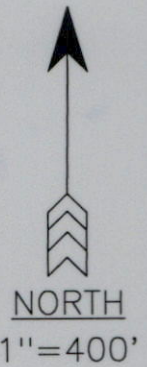

DISCLAIMER: THIS MAP WAS PREPARED FOR THE PURPOSE OF IDENTIFYING THE LOCATION OF WATER RIGHT ONLY AND IS NOT INTENDED TO PROVIDE LEGAL DESCRIPTIONS OR LOCATIONS OF PROPERTY LINES.

VCC

VAN CAMP CONSULTING

P.O. Box 995
 Coos Bay, OR 97420
 (541) 297-1880
 vancampconsulting@gmail.com

Prepared For:
 Scott Fenters
 9049 Buesing Rd.
 Klamath Falls, OR
 97603

Project:
 Permit S-55464 Claim
 of Beneficial Use

April 1, 2025 Pg: 1 of 2