

T.2S. R.3E. Section 12, W.M.

POD (center of the dam) is located 805 feet north and 1,900 feet west from the SE corner, Section 12.
 POD (water from trench) is located 1,060 feet north and 1,960 feet west from the SE corner, Section 12

 Snowberry Reservoir Area (2.5 acres inundated) 9.48 AF are covered under Application R-88698, Permit R-15391. This application is applying for the additional 1.52 AF.

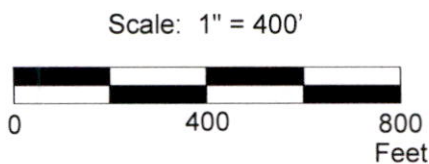
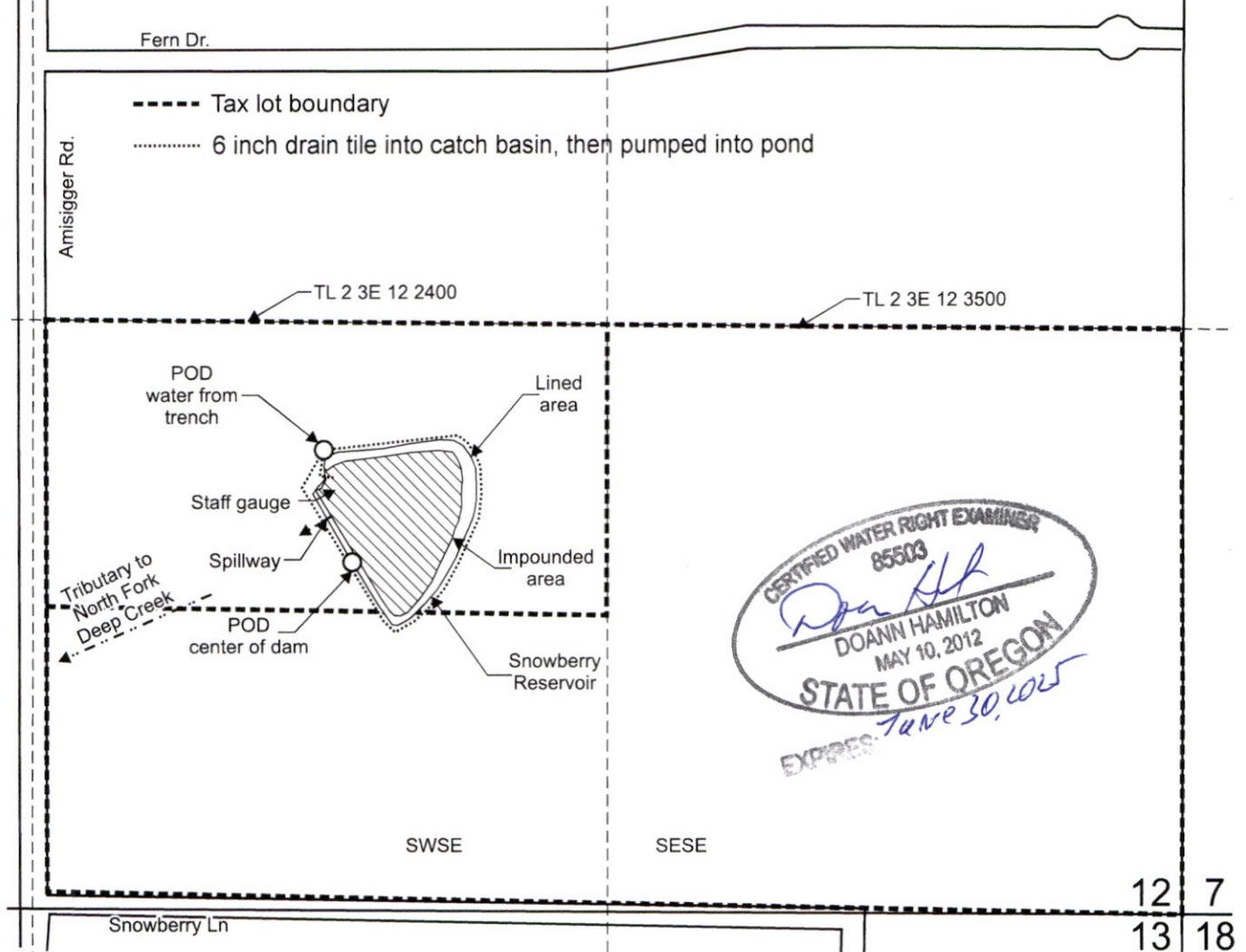

This map was prepared for the purpose of identifying the location of a water right only and is not intended to provide legal dimensions or location of property ownership lines.

Reservoir Application Map

Pacific Hydro-Geology Inc.

04/2025

Michael Townsend
 T.2S. R.3E. Section 12, W.M.

Received
 JUL 23 2025
 OWRD

12 7
 13 18

