

89330

Name Ryan Beyerlein  
 By 3434 Quartz Creek Rd.  
 Address PO Box 1052  
Merlin, OR 97532

C28

Priority 1-30-2023County Josephine WM# 14

## RELATED FILES

## DEVELOPMENT

Date

Completion 8-11-2028

Extended to \_\_\_\_\_

Final Proof received \_\_\_\_\_

Proposed Cert. Mailed \_\_\_\_\_

Application No. R-89330Permit No. R-15594

Certificate No. \_\_\_\_\_

Date

DENIED \_\_\_\_\_

MISFILED \_\_\_\_\_

WITHDRAWN \_\_\_\_\_

CANCELLED \_\_\_\_\_

Volume Page

## FEES PAID

| Date             | Amount          | Receipt No.   |
|------------------|-----------------|---------------|
| <u>1-30-2023</u> | <u>\$521.00</u> | <u>140043</u> |
| <u>4-28-2023</u> | <u>\$610.00</u> | <u>140599</u> |
|                  |                 |               |
|                  |                 |               |
|                  |                 |               |

Cert. Fee

## FEES REFUNDED

| Date | Amount | Receipt No. |
|------|--------|-------------|
|      |        |             |
|      |        |             |
|      |        |             |

## ASSIGNMENTS

Date

To Whom

Address

## REMARKS

## MAP LOCATION

# Mailing List for FO Copies

Application: R-89330

Permit: R-15594

Original mailed to Applicant:

RYAN R. BEYERLEIN  
3434 QUARTZ CREEK RD  
MERLIN OR 97532

Sent via auto email:

1. Applicant – rougefarmer6@gmail.com
2. Agent – Samantha Walgamot, rougefarmer6@gmail.com
3. WRD – Watermaster District 14, Scott C. Ceciliani
4. WRD – Justin Dillon, SWR
5. WRD – SW Section

Copies sent to:

1. File – R-89330

Application Specialist: Dianna Brainard

|               |                    |
|---------------|--------------------|
| Copies Mailed |                    |
| By:           | <u>KMWF</u>        |
|               | (STAFF)            |
| On:           | <u>AUG 11 2023</u> |
|               | (DATE)             |



BEFORE THE WATER RESOURCES DEPARTMENT  
OF THE STATE OF OREGON

Water Right Application R-89330 in the     )  
name of RYAN R. BEYERLEIN                     )  
   )

FINAL ORDER  
APPROVING THE STORAGE OF  
SURFACE WATER

**Authority**

The application is being processed in accordance with Oregon Revised Statute (ORS) 537.409, which establishes the process by which an application to store waters of the public may be submitted. This statute can be accessed here:

<https://www.oregon.gov/OWRD/programs/policylawandrules/Pages/default.aspx>

The Water Resources Department's website can be accessed here:

<https://www.oregon.gov/OWRD>

In accordance with ORS 537.409, the Department shall conduct a public interest review of an application submitted to store water in a reservoir that has a storage capacity of less than 9.2 acre-feet or a dam or impoundment structure less than 10 feet in height.

The review shall be limited to issues pertaining to:

- (a) Water availability;
- (b) Potential detrimental impact to existing fishery resources; and
- (c) Potential injury to existing water rights.

In addition, the Department will review ORS Chapter 538 to determine if the source of water has been withdrawn from further appropriation and will conduct a review consistent with ORS Chapter 390.835 – Oregon's Scenic Waterway laws – to determine whether the use is prohibited.

Following this review, the Department shall issue a final order granting or denying the permit or granting the permit with conditions.

**NOTICE OF RIGHT TO PETITION FOR RECONSIDERATION OR JUDICIAL REVIEW**

This is a final order in other than contested case. This final order is subject to judicial review under ORS 536.075 and ORS 183.484. Any petition for judicial review of the final order must be filed within the 60-day time period specified by ORS 183.484(2). Pursuant to ORS 536.075, ORS 183.484, and OAR 137-004-0080, you may petition for judicial review or petition the Director for reconsideration of this order. A petition for reconsideration may be granted or denied by the Director, and if no action is taken within 60 days following the date the petition was filed, the petition shall be deemed denied.

ORS 537.409 does not provide an opportunity to request a contested-case hearing. Appeal rights on this final order approving the application are limited to the above procedures.



### FINDINGS OF FACT

1. On January 30, 2023, Ryan R. Beyerlein submitted an application for a permit to store water pursuant to ORS 537.409.

Storage Volume: 0.918 ACRE-FOOT

Dam Height: 9.0 FEET

Source: QUARTZ CREEK, TRIBUTARY TO JUMP OFF JOE CREEK

County: JOSEPHINE COUNTY

Reservoir Location: SECTION 5, TOWNSHIP 35 SOUTH, RANGE 6 WEST, W.M.

2. The required examination fees were paid, and the minimum application requirements were met.
3. On February 7, 2023, the Department provided public notice of the application in the Department's weekly public notice. A 60-day comment period followed.
4. The Department did not receive public comment related to the possible issuance of the attached permit.
5. An assessment of water availability at 50% exceedance for the proposed use was completed using the Department's Water Availability Reporting System. A copy of this assessment is in the application file. This review is done consistent with OAR 690-410-0070(2)(a). The assessment established that water is available December 1 through March 31 of each year for the proposed use.
6. The Department relies on the Oregon Department of Fish and Wildlife's review and recommendations in determining whether a proposed use would pose a significant detrimental impact to existing fishery resources. The Department has determined that, if limited to February 1 through March 31, and as conditioned, the proposed use will not pose a significant detrimental impact to existing fishery resources.
7. The Department has determined that the proposed use, as conditioned, will not injure other water rights.
8. The Department has determined that the proposed source has not been withdrawn from further appropriation under ORS Chapter 538.
9. The proposed reservoir is not prohibited under ORS 390.835.

### CONCLUSIONS OF LAW

1. Application R-89330 contains the information required by ORS 537.409(1)-(3).
2. The proposed use would not impair or be detrimental to the public interest as described in ORS 537.409.



ORDER

Application R-89330 is approved and Permit R-15594 is issued as limited by the conditions contained therein.

Dated at Salem, Oregon on AUG 11 2023

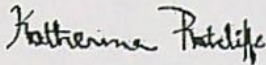

Katherine Ratcliffe  
Water Rights Section Manager, for  
Douglas E. Woodcock, Acting Director  
Oregon Water Resources Department

If you have questions about statements contained in this document, please contact Dianna Brainard at [dianna.j.brainard@water.oregon.gov](mailto:dianna.j.brainard@water.oregon.gov) or 971-375-1602.

If you have other questions about the Department or any of its programs, please contact our Water Resources Customer Service Group at 503-986-0900.



STATE OF OREGON  
COUNTY OF JOSEPHINE  
PERMIT TO STORE PUBLIC WATERS

THIS PERMIT IS HEREBY ISSUED TO

RYAN R. BEYERLEIN  
3434 QUARTZ CREEK RD  
MERLIN OR 97532

The specific limits and conditions of the use are listed below.

APPLICATION FILE NUMBER: R-89330

SOURCE OF WATER: QUARTZ CREEK, TRIBUTARY TO JUMP OFF JOE CREEK

STORAGE FACILITY: UNNAMED RESERVOIR

MAXIMUM DAM HEIGHT: 9.0 FEET

MAXIMUM VOLUME: 0.918 ACRE-FOOT

PURPOSE OR USE OF THE STORED WATER: MULTIPURPOSE USE

WATER MAY BE APPROPRIATED FOR STORAGE DURING THE PERIOD: FEBRUARY 1 THROUGH MARCH 31

DATE OF PRIORITY: JANUARY 30, 2023

DAM/RESERVOIR LOCATION:

| Twp  | Rng | Mer | Sec | Q-Q   | Measured Distances   |
|------|-----|-----|-----|-------|--|
| 35 S | 6 W | WM  | 5   | SW SW | 266.4 FEET NORTH AND 108.4 FEET EAST FROM SW CORNER, SECTION 5 |

POINT OF DIVERSION:

| Twp  | Rng | Mer | Sec | Q-Q   | Measured Distances   |
|------|-----|-----|-----|-------|--|
| 35 S | 6 W | WM  | 5   | SW SW | 490 FEET NORTH AND 568 FEET EAST FROM SW CORNER, SECTION 5 |

THE AREA TO BE SUBMERGED BY THE RESERVOIR:

| Twp  | Rng | Mer | Sec | Q-Q   |
|------|-----|-----|-----|-------|
| 35 S | 6 W | WM  | 5   | SW SW |



## PERMIT SPECIFIC CONDITIONS

1. Failure to comply with any of the provisions of this permit may result in action including, but not limited to, restrictions on the use, civil penalties, or cancellation of the permit.
2. **Water Use Measurement, Recording, and Reporting:**
  - A. Before water use may begin under this permit, the permittee shall install a totalizing flow meter, or other suitable measuring device as determined by the watermaster, at each point of diversion. The permittee shall maintain the device in good working order.
  - B. The permittee shall allow the watermaster access to the device; provided however, where any device is located within a private structure, the watermaster shall request access upon reasonable notice.
  - C. The Director may require the permittee to keep and maintain a record of the volume of water diverted, and may require the permittee to report water-use on a periodic schedule as established by the Director. In addition, the Director may require the permittee to report general water-use information, the periods of water use and the place and nature of use of water under the permit.
  - D. The Director may provide an opportunity for the permittee to submit alternative measuring and reporting procedures for review and approval.

3. **Agricultural Water Quality Management Area Rules:**

The permittee shall comply with basin-specific Agricultural Water Quality Management Area Rules described in Oregon Administrative Rule Chapter 603-095. The permittee shall protect riparian areas, allowing site capable vegetation to establish and grow along streams, while providing the following functions: shade (on perennial and some intermittent streams), bank stability, and infiltration or filtration of overland runoff.

4. **Fish Stocking:**

Per ORS 498.222 and OAR 635-007-0600, all persons transporting fish in Oregon shall have a fish transport permit issued by the Oregon Department of Fish and Wildlife (ODFW). The permittee shall not stock fish in the reservoir without a fish transport permit issued by ODFW. As part of the permitting process, the permittee shall also screen the inlet and outlet of their pond to ensure that fish cannot escape into public waters and/or to keep wild fish from entering the pond.

5. **In-Water Work:**

Any in-water work related to construction, development, or maintenance of the proposed use shall be conducted during the preferred work period of June 15 through September 15, unless an alternate time period is approved by Oregon Department of Fish and Wildlife.



**6. Off-Channel Stored Water Releases:**

The permittee shall not release polluted water from this off-channel reservoir into waters of the state except when the release is directed by the State Engineer to prevent dam failure.

**7. Water Quality:**

- a. The use may be restricted if the quality of the source stream or downstream waters decrease to the point that those waters no longer meet existing state or federal water quality standards due to reduced flows.
- b. All water use under this permit shall comply with state and federal water quality laws. The permittee shall not violate any state and federal water quality standards, shall not cause pollution of any waters of the state, and shall not place or cause to be placed any wastes in a location where such wastes are likely to escape or be carried into the waters of the state by any means. The use may be restricted if the quality of source stream or downstream waters decrease to the point that those waters no longer meet existing state or federal water quality standards. Permittee is responsible for obtaining any necessary state and federal permits.

**8. Riparian Area Restoration:**

If the riparian area is disturbed in the process of developing a point of diversion, the permittee shall be responsible for restoration and enhancement of such riparian area in accordance with ODFW's Fish and Wildlife Habitat Mitigation Policy OAR 635-415. For purposes of mitigation, the ODFW Fish and Wildlife Habitat Mitigation Goals and Standards, OAR 635-415, shall be followed.

**9. Fish Screen and By-Pass Device:**

The permittee shall install, maintain, and operate fish screening and by-pass devices consistent with current Oregon Department of Fish and Wildlife (ODFW) standards. Fish screening is to prevent fish from entering the proposed diversion while by-pass devices provide adequate upstream and downstream passage for fish. The required screen and by-pass devices are to be in place and functional, and approved in writing by ODFW prior to diversion of any water. The permittee may submit evidence in writing that ODFW has determined screens and/or by-pass devices are not necessary.

**10. Live Flow:**

Once the allocated volume has been stored, permittee shall pass all live flow downstream at a rate equal to inflow, using methods that protect instream water quality.

**11. Scenic Waterway Flows:**

Diversion of water under this permit is contingent on designated scenic waterway flows being met downstream. The user is required to monitor streamflow at Rogue River near Agness, OR gage 14372300, and discontinue diversion when the flows specified below are unmet at the gage. At the



discretion of the Director, the location and nature of streamflow monitoring required to protect scenic waterway flows is subject to change. In addition, the watermaster may regulate diversion under this right if it is determined by the Department that the flows listed below are unmet at the gage.

| Rogue Scenic Waterway |                    |
|-----------------------|--------------------|
| Month                 | Minimum Flow (CFS) |
| February              | 3500               |
| March                 | 3500               |

12. The storage of water allowed herein is subject to the installation and maintenance of an outlet pipe (with a minimum diameter of 8" for any in-channel reservoir). This requirement may be waived if the Department determines other means have been provided to evacuate water when necessary.
13. The permittee shall pass all live flow outside the storage season described above.
14. The permittee shall not construct, operate or maintain any dam or artificial obstruction to fish passage in the channel of the subject stream without providing a fishway to ensure adequate upstream and downstream passage for fish, unless the permittee has requested and been granted a fish passage waiver by the Oregon Fish and Wildlife Commission. The permittee is hereby directed to contact an Oregon Department of Fish and Wildlife Fish Passage Coordinator, before beginning construction of any in-channel obstruction.
15. This permit allows an annual appropriation (not to exceed the specified volume). This permit does not provide for the appropriation of water for out-of-reservoir uses, the maintenance of the water level or maintaining a suitable freshwater condition. If any water is to be used for out-of-reservoir purposes, a secondary water right is required. If any additional live flow is to be appropriated to maintain either the water level or a suitable freshwater condition, an additional water right is required.

#### STANDARD CONDITIONS

1. This permit is for the beneficial use of water without waste. The water user is advised that new regulations may require the use of best practical technologies or conservation practices to achieve this end.
2. By law, the land use associated with this water use must be in compliance with statewide land-use goals and any local acknowledged land-use plan.
3. The use of water allowed herein may be made only at times when sufficient water is available to satisfy all prior rights, including prior rights for maintaining instream flows.



## DEVELOPMENT AND COMPLETION TIMELINE REQUIREMENTS

1. Construction of the water system shall begin within five years of the date of permit issuance. The deadline to begin construction may not be extended. This permit is subject to cancellation proceedings if the begin construction deadline is missed.
2. The permitted volume of water shall be stored within five years of the date of permit issuance. If additional time is needed, the permittee may submit an application for extension of time, which may be approved based upon the merit of the application.
3. Within one year after storage of water, the permittee shall submit a claim of beneficial use to the Oregon Water Resources Department.
4. The claim of beneficial use shall be prepared by a Certified Water Right Examiner in conformance with the requirements of OAR 690-014 if an associated secondary permit exists for the use of stored water under this permit, or if the reservoir capacity is equal to or greater than 9.2 acre-feet.
5. If no secondary permit exists and the reservoir capacity is less than 9.2 acre-feet of water, the claim of beneficial use need not be prepared by a Certified Water Right Examiner. The information submitted to the Oregon Water Resources Department shall include:
  - a. the dimensions of the reservoir;
  - b. the maximum capacity of the reservoir in acre-feet; and
  - c. a map identifying the location of the reservoir prepared in compliance with Water Resources Department standards.

Issued AUG 11 2023

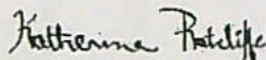

Katherine Ratcliffe  
Water Rights Section Manager, for  
Douglas E. Woodcock, Acting Director  
Oregon Water Resources Department



QT/QT = SW SW

MAP TAX LOT: 35S, 06W, 05-00-001300-00

POND LAT/LONG: 42.550349, -123.445026

3434 QUARTZ CREEK RD. MERLIN OR 97532

266.4 FEET NORTH AND 108.4 FEET EAST FROM THE  
SW CORNER OF SECTION 5

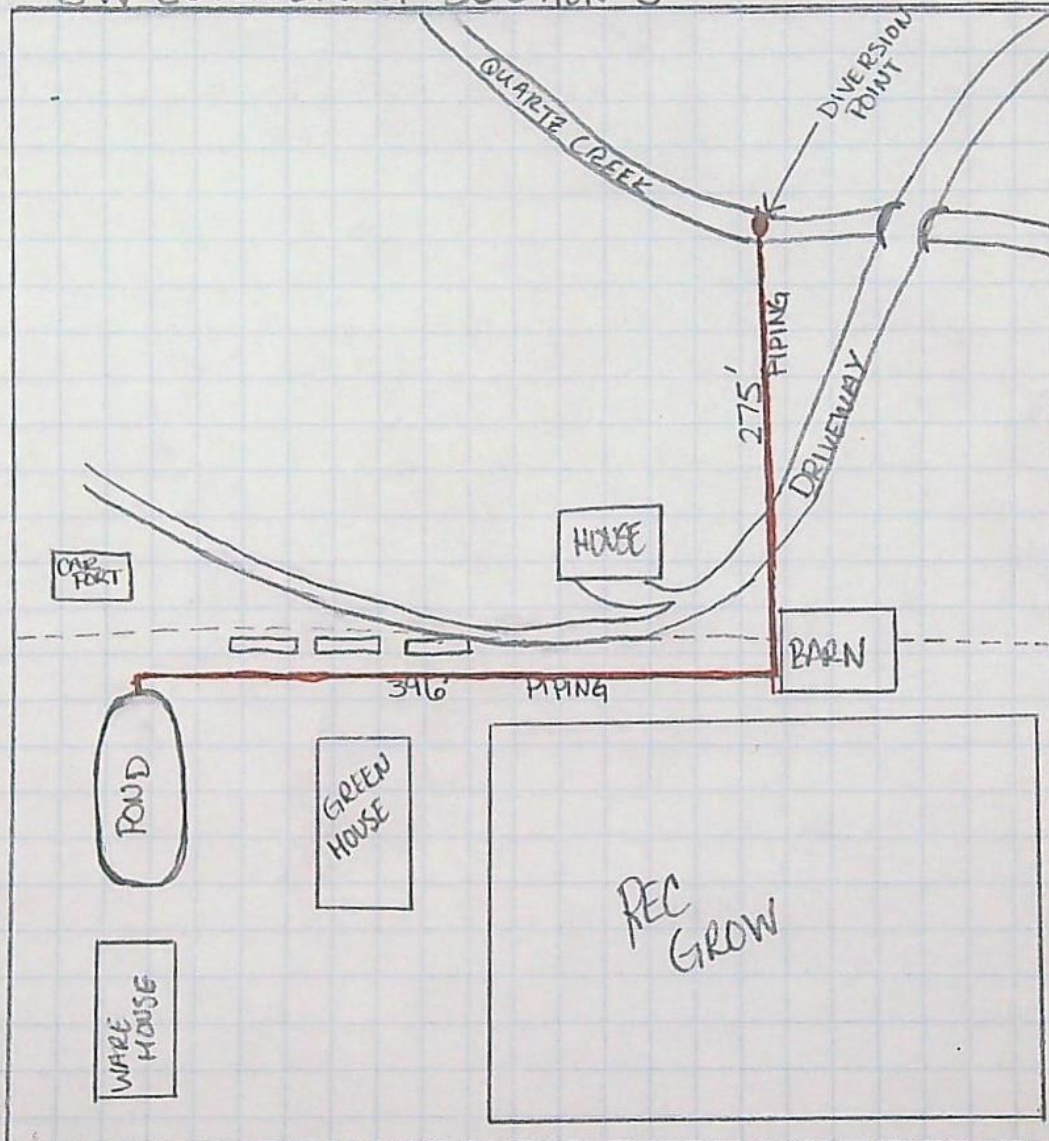

DIVERSION LAT/LONG:  
42.551086, -123.4435

POND  
CAPACITY:  
.918 AF

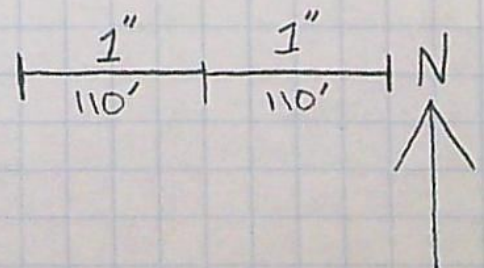

RECEIVED

MAY 04 2023

OWRD



**DIVERSION LOCATION FROM LAND SURVEY CORNER**

119 FEET NORTH AND 523 FEET EAST FROM THE SW CORNER OF THE  
SOUTHWEST QUARTER OF THE SOUTHWEST QUARTER OF SECTION 5, TOWNSHIP  
35 SOUTH, RANGE 6 WEST OF THE WILLAMETTE MERIDIAN, JOSEPHINE COUNTY,  
OREGON.

LATITUDE AND LONGITUDE:

42.551086, -123.4435

**RECEIVED**

**MAY 04 2023**

**OWRD**



QT/QT=SWSW

MAP TAX LOT: 35S, 06W, 05-00-001300-00

LAT/LONG: 42.550349, -123.445026

3434 QUARTZ CREEK RD. MERLIN OR 97532

216.4 FEET NORTH AND 108.4 FEET EAST FROM THE  
SW CORNER OF SECTION 5

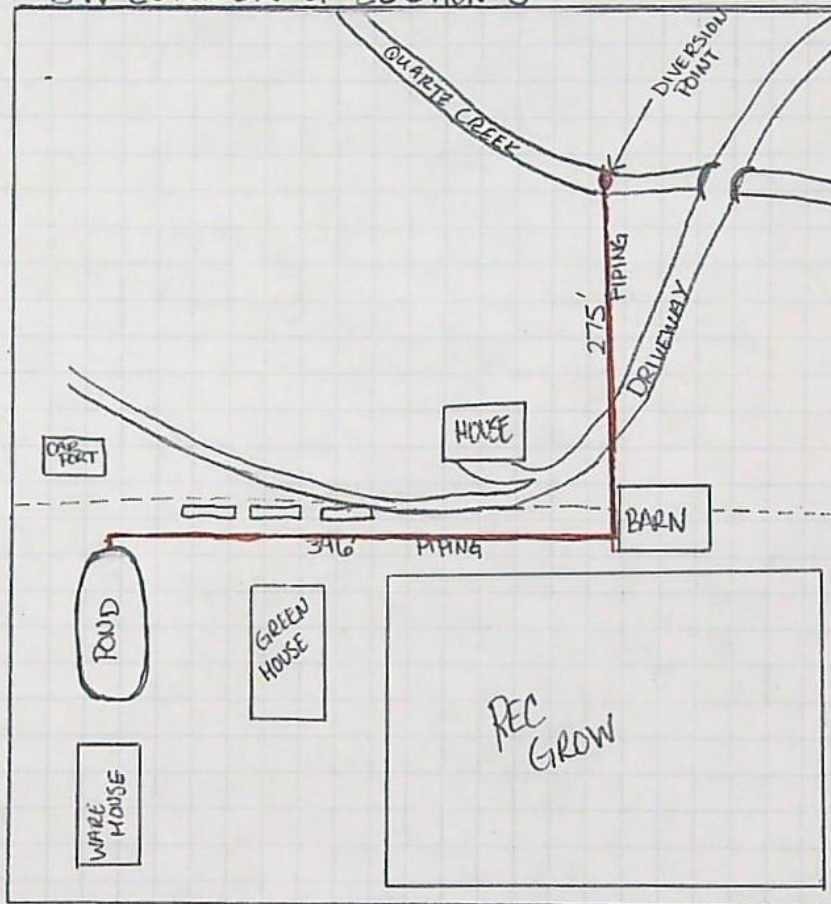

RECEIVED

APR 06 2023

OWRD

POND  
CAPACITY:  
.918 AF

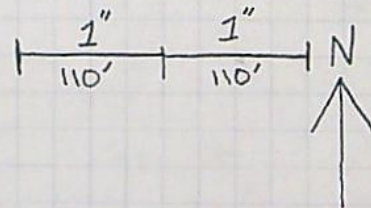



POND LOCATION FROM LAND SURVEY CORNER

266.4 FEET NORTH AND 108.4 FEET EAST FROM THE SW CORNER OF THE  
SOUTHWEST QUARTER OF THE SOUTHWEST QUARTER OF SECTION 5, TOWNSHIP  
35 SOUTH, RANGE 6 WEST OF THE WILLAMETTE MERIDIAN, JOSEPHINE COUNTY,  
OREGON.

LATITUDE AND LONGITUDE TO CENTER OF POND:

42.550349, -123.445026

RECEIVED

APR 06 2023

OWRD



QT/QT = SW/SW

MAP TAX LOT: 35-06-05-00-001300-00

S W Section Q/Q Taxlot

LAT/LONG: 42.55099, -123.44365

RECEIVED

JAN 03 2023

OWRD

3434 QUARTZ CREEK RD, MERLIN OR 97532

RC  
MN

(82.5 Feet East, 467.5 Feet South from the NW corner)

POND  
CAPACITY:

.918 AF

RECEIVED

JAN 30 2023

OWRD  
SALEM, OREGON

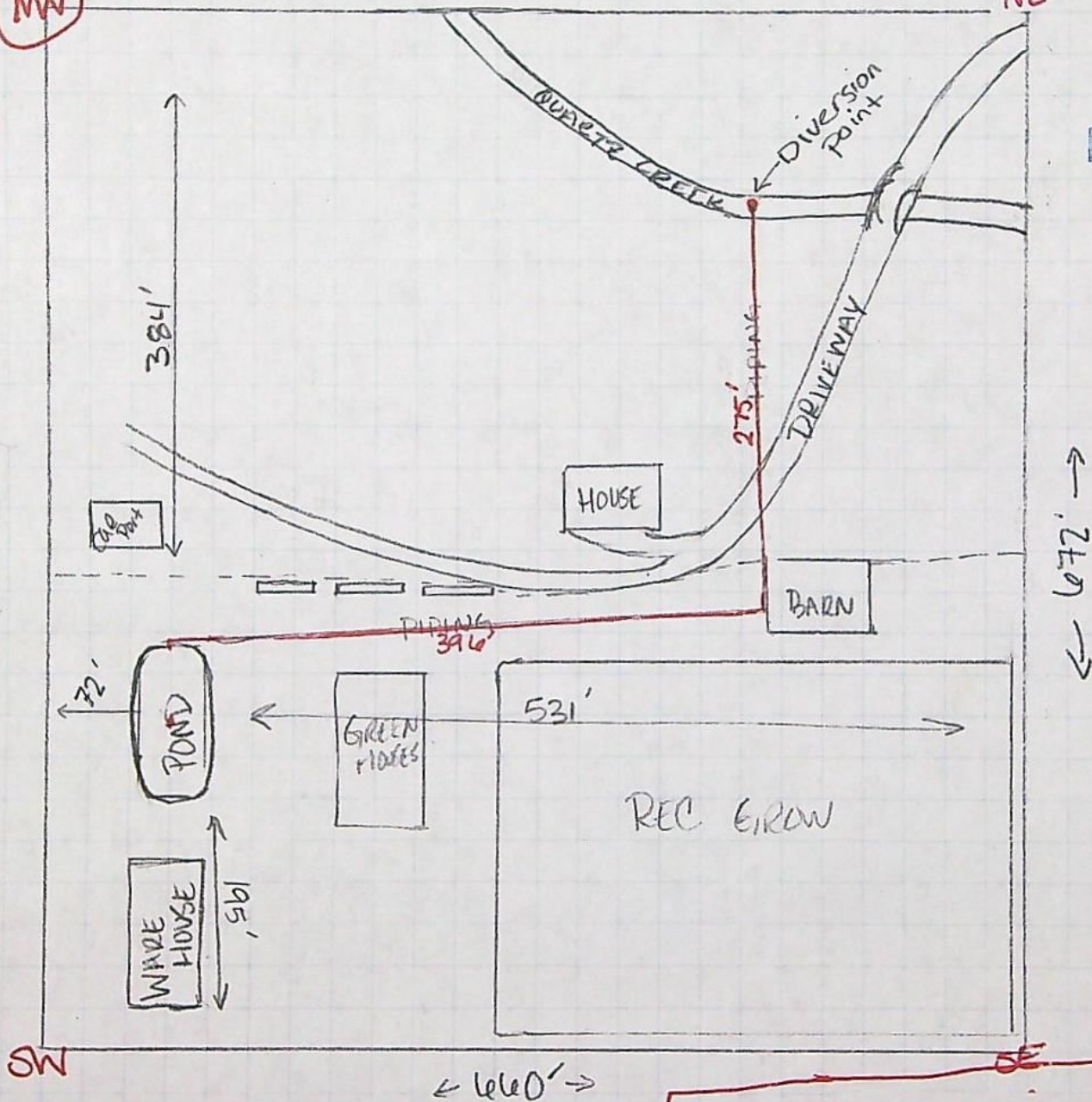

KEY:

----- FENCE



## BRAINARD Dianna J \* WRD

---

**From:** BUCHHOLZ Sheila L \* WRD  
**Sent:** Thursday, February 2, 2023 11:59 AM  
**To:** BRAINARD Dianna J \* WRD  
**Subject:** Application R-89330 (snap 222166), and R-89331 (snap 222163)

Good Afternoon Dianna,

You have been assigned as caseworker on these related applications. I wanted to let you know that the applicant on both of them gave us measured distances from their own tax lots. This isn't an acceptable area to measure from. The applicant needs to provide legal measurements from a quarter quarter, or possibly from a DLC, but not a tax lot.

I just wanted you to have this information for while you are working the cases.

Thanks so much!

*Sheila Buchholz*

Data Technician 1

725 Summer St. NE, Suite A | Salem, Oregon 97301

Email: [Sheila.L.Buchholz@water.oregon.gov](mailto:Sheila.L.Buchholz@water.oregon.gov)



OREGON  
WATER  
RESOURCES  
DEPARTMENT

Integrity | Service | Technical Excellence | Teamwork | Forward-Looking





# Oregon

Tina Kotek, Governor

Water Resources Department  
725 Summer St NE, Suite A  
Salem, OR 97301  
(503)-986-0900  
Fax: (503)-986-0904

January 31, 2023

Ryan Beyerlein  
3434 Quartz Creek Rd.  
PO Box 1052  
Merlin, OR 97532

Dear Applicant:

The Oregon Water Resources Department has received your applications to store water in a reservoir under the Alternate Review process. Your applications have been assigned file numbers **R-89330** and **R-89331**. Please refer to these numbers when contacting the Department. Should you have any questions about your applications, please contact the following Water Rights Specialist assigned to your application:

|                 |   |
|-----------------|---|
| Dianna Brainard | Phone: 971-375-1602   |
|                 | Email: <a href="mailto:dianna.j.brainard@water.oregon.gov">dianna.j.brainard@water.oregon.gov</a> |

A description of the steps that are used for processing an application to stored water in a reservoir are shown on the reverse side of this letter.

Included with this letter is a Wetland Determination Request form provided by the Department of State Lands (DSL) Wetland Program to determine if wetlands or other regulated water bodies (such as creeks) are in the project area. Please complete and return the form to DSL.

Please note that your application is subject to review and comment from other state agencies and interested parties.

Sincerely,

Dante Luongo  
Customer Service Representative  
Oregon Water Resources Department

cc: File R-

Encl. - DSL Wetland Offsite Form



## Water-Use Permit Application Processing Steps

### Oregon Water Resources Department

#### Alternate Review Process for a Reservoir Applications:

After a completed application has been received by the Department, the Department must make public notice of the application within 60 days. Applications are noticed to the public every Tuesday and can be accessed from the Department's website: <https://www.oregon.gov/owrd>.

The Department does not notify individual, neighboring landowners of an application, unless they are identified in the application as affected landowners. The public notice is to ensure that any person may submit detailed information requesting the Department deny an application based upon whether the proposed use causes injury to existing water rights or poses a significant detrimental impact to an existing fishery resource. All comments must be submitted within 60 days of the public notice.

Following the 60-day public comment period, the Department can issue a Final Order. Alternate Reservoir applications typically take between 3-5 months to process, depending upon the number of pending applications in the queue.

The Department recommends applicants not schedule excavation work or otherwise expend financial resources until an ODFW fish passage plan and the alternate reservoir application have been approved. Also note that other permits may be required for any construction activities in waterways, wetlands, or riparian areas.



## Alternate Reservoir Application Completeness Checklist

Minimum Requirements (ORS 537.409)

For use by WRD staff only

|                 |                |                   |   |
|-----------------|----------------|-------------------|---|
| Application #:  | R-89330        | Receipt #:        | 140043  |
| Applicant Name: | Ryan Beyerlein | Amount Requested: | .918  |
| Priority Date:  | 1-30-2023      | Proposed Use:     | Multipurpose  |
| County:         | Josephine      | POD TRS & TL:     | 35S 6W 5  |
| WM #:           | 14             | Caseworker:       | <input type="checkbox"/> KF Dianna <input type="checkbox"/> LG Brainard |
| Reviewed by:    | Dante Luongo   | Reviewed Date:    | 1-31-2023   |

- ☒ **ORS 538.** Is the source withdrawn by ORS 538? ☐ YES ☐ NO [if yes, return application and fees]
- ☒ Landowner name, mailing address and telephone number provided.
- ☒ Source and tributary listed. Notes: NO WELLS-MUST HAVE GW APP TO USE A WELL AS A SOURCE. Cannot accept an E2 application and a storage application at the same time.
- ☒ Reservoir Location. TRSQQ and tax lot provided. Note: only 1 reservoir/pond per application
- ☒ Dam height, if applicable: 9 Ft
- ☒ Property ownership indicated?
- ☒ If applicant does not own all the land is the affected landowner's name and mailing address listed?  
☐ YES ☐ NO (Note: this includes lands not owned by applicant, upon which the source is located OR that are crossed by the diversion works, and any roads or rights-of-way.)
- ☒ Application signed by the landowner(s)? All parties noted as applicants must sign the application.
- ☒ **Completed Watermaster review sheet**, signed and dated. Note: Must be completed within last 6 months.
  - Will the reservoir injure an existing water right? ☐ YES ☐ NO
  - If YES, can conditions be applied to mitigate injury? ☐ YES ☐ NO
- ☒ **Completed ODFW review sheet**, signed and dated. Note: Must be completed within last 6 months.
  - Will reservoir pose a significant detrimental impact to an existing fishery resource? ☐ YES ☐ NO
  - If YES, can conditions be applied to mitigate the impact? ☐ YES ☐ NO ☐ N/A
- ☒ **Completed Land-Use Form** or receipt signed by the appropriate planning department official enclosed?  
 Note: Does the use on land-use form match the proposed use on the application? Must be signed within the last 12 months.
- ☒ **Provide a Legal Description** of all the property involved with this application. A copy of a deed, land sales contract, or title insurance meets this requirement.



☒ **Acceptable Map.** Note: Requirements set forth by the Commission; causes fatal flaw if not provided by the applicant.

- ☒ Reservoir Location - noting Township, Range, Section, 1/4 1/4 and Tax Lot number(s)
- ☒ Scale of the Map, even scale such as 1" = 400', 1" = 1000', or 1" = 1320'
- ☒ Reference corner on map
- ☒ North directional symbol
- ☒ 1/4's clearly identified
- ☒ Reservoir clearly identified
- ☒ Dam, or POD (if off-channel), coordinates referenced to a government land survey corner  
Note: If no dam, use coordinates to the center of reservoir.

☒ **Fees:** Amount of Water Requested: .918 Name on Check: \_\_\_\_\_

|                     |  |
|---------------------|--|
| Exam Fee Due:       | \$521  |
| Exam Fee Submitted: | \$521  |
| Difference:         | \$0  |
| Recording Fee Paid? | <input type="checkbox"/> Yes <input checked="" type="checkbox"/> No \$ |
| Total:              | \$1131   |



Application for a Permit to  
**Store Water in a Reservoir**  
Alternate Review (ORS 537.409)



Oregon Water Resources Department  
725 Summer Street NE, Suite A  
Salem, Oregon 97301-1266  
(503) 986-0900  
www.oregon.gov/OWRD

RECEIVED

JAN 30 2023

OWRD  
SALEM, OREGON

You may use this form for any reservoir storing less than 9.2 acre-feet or with a dam less than 10 feet high.

Use a separate form for each reservoir

**SECTION 1: APPLICANT INFORMATION AND SIGNATURE**

RECEIVED

**Applicant**

JAN 03 2023

|   |                 |                                |  |
|---|-----------------|--------------------------------|--|
| NAME <b>RYAN BEYERLEIN</b>                        |                 | PHONE (HM) <b>541-479-2605</b> |  |
| PHONE (WK)  | CELL            | FAX                            |  |
| ADDRESS <b>3434 QUARTZ CREEK RD P.O. BOX 1052</b> |                 |                                |  |
| CITY <b>MERLIN</b>                                | STATE <b>OR</b> | ZIP <b>97532</b>               | E-MAIL * <b>ROGUEFARMER6@GMAIL.COM</b> |

**Organization**

|         |       |       |          |
|---------|-------|-------|----------|
| NAME    |       | PHONE | FAX      |
| ADDRESS |       | CELL  |          |
| CITY    | STATE | ZIP   | E-MAIL * |

**Agent** – The agent is authorized to represent the applicant in all matters relating to this application.

|  |                 |                           |  |
|--|-----------------|---------------------------|--|
| AGENT / BUSINESS NAME <b>SAMANTHA WALGAMOT</b> |                 | PHONE <b>541-479-2605</b> | FAX                                    |
| ADDRESS <b>932 SW BRIDGE ST APTA</b>           |                 | CELL                      |  |
| CITY <b>GRANTS PASS</b>                        | STATE <b>OR</b> | ZIP <b>97526</b>          | E-MAIL * <b>ROGUEFARMER6@GMAIL.COM</b> |

Note: Attach multiple copies as needed

\* By providing an e-mail address, consent is given to receive all correspondence from the department electronically. (paper copies of the final order documents will also be mailed.)

By my signature below I confirm that I understand:

- I am asking to use water specifically as described in this application.
- Evaluation of this application will be based on information provided in the application.
- I cannot legally store water until the Water Resources Department issues a permit.
- Oregon law requires that a permit be issued before beginning construction. Acceptance of this application does not guarantee a permit will be issued.
- If I get a permit, I must not waste water.
- If development of the water use is not according to the terms of the permit, the permit can be cancelled.
- The water use must be compatible with local comprehensive land use plans.
- Even if the Department issues a permit, I may have to stop using water to allow senior water right holders to get water to which they are entitled.



I (we) affirm that the information contained in this application is true and accurate.

Applicant Signature

Print Name and Title if applicable

Date

Applicant Signature

Print Name and Title if applicable

Date



JAN 30 2023

JAN 03 2023

SECTION 2: SOURCE OF WATER AND LOCATION OF RESERVOIR

OWRD  
SALEM, OREGON

OWRD

|                        |   |                |         |                 |           |
|------------------------|---|----------------|---------|-----------------|-----------|
| Reservoir name:        | N/A   |                |         |                 |           |
| Source*:               | QUARTZ CREEK Tributary: JUMP OFF JOE CREEK                |                |         |                 |           |
| County:                | JOSEPHINE   |                |         |                 |           |
| Quantity:              | Acre-Feet [length x width x depth / 43,560] .918 acre ft. |                |         |                 |           |
| Reservoir Location:    | Township (N or S)   | Range (E or W) | Section | Quarter-Quarter | Tax Lot # |
|                        | 35 S  | 6 W            | 5       | SW/SW           | 1300      |
| Maximum Height of Dam: | 9 feet. If excavated write "zero feet."                   |                |         |                 |           |

\* Provide the name of the water body or other source from which water will be diverted, and the name of the stream or lake it flows into. Indicate if source is run-off, seepage, an unnamed stream, or spring.

SECTION 3: WATER USE

Indicate the proposed use(s) of the stored water: MULTIPURPOSE USE

NOTE: You may wish to consider filing for "Multipurpose use" for your reservoir. Multipurpose use does not limit the types of future uses for the stored water. Multipurpose covers all uses including: stock water, fish and wildlife, aesthetics, domestic, irrigation, agriculture, fire protection and pollution abatement.

SECTION 4: PROPERTY OWNERSHIP

Do you own all the land where you propose to divert, transport, and use water?

☒ Yes (please check appropriate box below then skip to section 5)

☒ There are no encumbrances

☐ This land is encumbered by easements, right of way, roads of way, roads or other encumbrances

☐ No (Please check the appropriate box below)

☐ I have a recorded easement or written authorization permitting access.

☐ I do not currently have written authorization or easement permitting access.

☐ Written authorization or an easement is not necessary, because the only affected lands I do not own are state-owned submersible lands, and this application is for irrigated and/or domestic use only (ORS 274.040). (Do not check this box if you described your use as "Multipurpose" in #3 above.)

List the names and mailing addresses of all affected landowners:



RECEIVED

JAN 30 2023

RECEIVED

JAN 03 2023

## SECTION 5: ENVIRONMENTAL IMPACT

OWRD  
SALEM, OREGON

OWRD

Channel: Is the Reservoir: ☐ in-stream or ☒ off channel?Wetland: Is the project in a wetland? ☐ YES ☒ NO ☐ unknownExisting: Is this an existing reservoir? ☐ YES ☒ NO

If YES, how long has it been in place? \_\_\_\_\_ years.

Fish Habitat: Is there a fish habitat upstream of the proposed structure? ☐ YES ☐ NO ☒ unknown

If YES, how much? \_\_\_\_\_ miles.

Existing: Have you been working with other agencies? ☐ YES ☒ NO

Indicate agency, staff and phone numbers of those involved. Also indicate any agencies that are cost sharing in this project.

## SECTION 6: WITHIN A DISTRICT

☐ Check here if the point of diversion or place of use are located within or served by an irrigation or other water district.

|                           |        |          |  |
|---------------------------|--------|----------|--|
| Irrigation District Name: |        | Address: |  |
| City:                     | State: | Zip:     |  |

## SECTION 7: DESCRIPTION

Provide a short description of the design and operation of the proposed diversion, including a description of how live flow will be passed outside the authorized storage season. Use this space for narrative. You may also provide narrative and sketches on separate pages.

WATER WILL BE CONTINUOUSLY PUMPED THROUGH UNTIL SEASON IS OVER. AT THAT TIME THE STORED WATER WILL BE USED IN PLACE OF PRIMARY WATER RIGHT, WHEN NEEDED.

If the diversion involves a dam, use this space below for sketches of the diversion (e.g. cross-section of the dam with its dimensions, dimension and placement of outlet pipe, means of passing live flow outside of the authorized storage season, and means for providing fish passage).

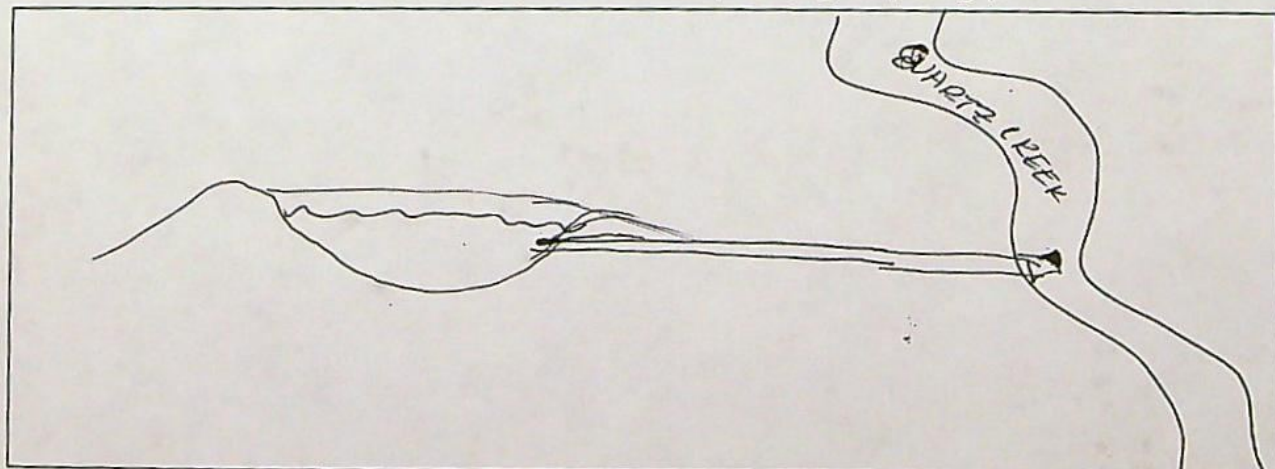



JAN 30 2023

OWRD  
SALEM, OREGON**Watermaster Alternate Reservoir Application Review Sheet**

In lieu of the water right application process set forth in ORS 537.140 to 537.211, an owner of a reservoir may submit an alternate reservoir application for a reservoir that has a storage capacity less than 9.2 acre-feet or a dam or impoundment structure less than 10 feet in height. ORS 537.409 describes the criteria used to evaluate alternate reservoir applications.

The review shall be limited to issues pertaining to: a) water availability, b) potential detrimental impact to existing fishery resources; and c) potential injury to existing water rights. (ORS 537.409 (6))

Within 60 days after the Water Resources Department provides public notice, any person may submit detailed, legally obtained information in writing, requesting the Department to deny the application for a permit on the basis that the reservoir: (a) Would result in injury to an existing water right; or (b) Would pose a significant detrimental impact to existing fishery resources. (ORS 537.409 (5))

|   |  |  |                                 |  |  |   |  |  |
|---|--|--|---------------------------------|--|--|---|--|--|
| <b>Applicant's Name</b> Ryan R. Beyerlein   |  |  | <b>Agent:</b> Samantha Walgamot |  |  | <b>Address:</b> 3434 Quartz Creek Rd., Merlin |  |  |
| 1. Does the proposed reservoir have the potential to injure existing water rights? <input checked="" type="checkbox"/> YES <input type="checkbox"/> NO  |  |  |                                 |  |  |   |  |  |
| Explain: Instream water rights C-59772 and C-73026 are not always met.  |  |  |                                 |  |  |   |  |  |
| 2. Can conditions be applied to mitigate the potential injury to existing water rights? <input checked="" type="checkbox"/> YES <input type="checkbox"/> NO   |  |  |                                 |  |  |   |  |  |
| Explain: Use may be made at times when sufficient water is available to satisfy all prior rights, including prior right for maintaining instream flows. Installation of measuring device. Rogue Scenic Waterway condition.  |  |  |                                 |  |  |   |  |  |
| 3. Is water available for the proposed reservoir? <input checked="" type="checkbox"/> YES <input type="checkbox"/> NO   |  |  |                                 |  |  |   |  |  |
| 4. If yes, during what period? Beginning: December End: March   |  |  |                                 |  |  |   |  |  |
| Attach a WARS printout at 50% exceedance. If WARS does not cover the proposed location, make a recommendation for a storage season based upon regulation history and your knowledge of the location. (Water Availability for Reservoir Policy found under OAR 690-410-0070(2)(c)) |  |  |                                 |  |  |   |  |  |
| 5. Did you meet with staff from another agency to discuss this application? <input type="checkbox"/> YES <input checked="" type="checkbox"/> NO   |  |  |                                 |  |  |   |  |  |
| Who:  |  |  | Agency:                         |  |  | Date:   |  |  |
| Who:  |  |  | Agency:                         |  |  | Date:   |  |  |

Watermaster Name: Scott Ceciliani

Watermaster Signature: 

Date: 1-17-2023

**NOTE: This completed form must be returned to the applicant**



## Water Availability Analysis

JUMPOFF JOE CR > ROGUE R - AT MOUTH  
ROGUE BASIN

Water Availability as of 1/17/2023

Watershed ID #: 70984 ([Map](#))

Date: 1/17/2023

Exceedance Level: 50% v

Time: 8:42 AM

### Water Availability

### Limiting Watersheds

### Complete Water Availability Analysis

## Water Availability

Select any Watershed for Details

[illegible]

Download Data ( [Text - Formatted](#), [Text - Tab Delimited](#), [Excel](#) )



**Oregon Water Resources Department  
Alternate Reservoir Application**

[Main](#)
[Help](#)

For impoundments less than 10 feet in height or storing less than 9.2 acre feet of water

Today's Date Tuesday, January 17, 2023

|   |             |            |
|---|-------------|------------|
| Base Application Fee  |             | \$480.00   |
| Proposed Dam Height in feet   | 9           |            |
| Proposed Reservoir volume in Acre Feet  | 918         | \$41.00    |
|   | Subtotal    | \$521.00   |
| Permit Recording Fee ***  |             | \$610.00   |
| *** the Permit Recording Fee is not required when the application is submitted but, must be paid before a permit will be issued. It is fully refundable if a permit is not issued. If the recording fee is not paid prior to issuance of the Final Order, permit issuance will be delayed | Recalculate |            |
| Estimated cost of Permit Application  |             | \$1,131.00 |

RECEIVED

JAN 30 2023

OWRD  
SALEM, OREGON



## ODFW Alternate Reservoir Application Review Sheet

RECEIVED

JAN 30 2023

OWRD  
SALEM, OREGON

This portion to be completed by the applicant.

Applicant Name: Ryan BeyerleinAddress: 3434 Quartz Creek Rd, Merlin, OR 97532Phone/Email: 541-479-2605/roguefarmer6@gmail.comReservoir Name: Beyerlein Reservoir 2Volume (AF): 0.918 AFSource: Quartz CreekBasin Name: Quartz Creek < Jumpoff Joe Creek < Rogue River☐ in-channelTwp Rng Sec QQ: 35S 6W 5 SWSW☒ off-channel

Note: It is unlikely that ODFW will be able to complete this form while you wait, nevertheless we recommend making an appointment to submit the form so as to provide any necessary clarifications. See pg. 6 of Instructions for contact information.

This portion to be completed by Oregon Department of Fish and Wildlife (ODFW) staff.

- 1) Is the proposed project and AO<sup>1</sup> off channel?..... ☒ YES\* ☐ NO  
(if yes then proceed to #4; if no then proceed to #2)

*\*Based on available information, the proposed use does not appear to involve instream structures that would create or maintain an artificial obstruction. However, if the applicant creates or maintains an artificial obstruction to fish passage for the proposed use, the applicant will need to address Oregon's fish passage laws.*

- 2) Is the proposed project or AO located where NMF<sup>2</sup> are or were historically present?..... ☐ YES ☐ NO  
(if yes then proceed to #3; if no then proceed to #4)

- 3) If NMF are or were historically present:

- a. Is there an ODFW-approved fish-passage plan?..... ☐ YES ☐ NO  
b. Is there an ODFW-approved fish-passage waiver or exemption?..... ☐ YES ☐ NO

If fish passage is required under ORS 509.580 through .910, then either 3(a) or 3(b) must be "Yes" to move forward with the application. If responses to 3(a) and 3(b) are "No", then the proposed reservoir does not meet the requirements of Oregon Fish Passage Law and shall not be constructed as proposed.

- 4) Would the proposed project pose any other significant detrimental impact to an existing fishery resource locally or downstream?..... ☒ YES ☐ NO

*Explain below (for example, list STE species or other existing fishery resources that would be impacted negatively.)*

- ☒ Any diversion or appropriation of water for storage during the period April 1-January 31 poses a significant detrimental impact to existing fishery resources. (For example, if diversion of water for storage during a certain time period would cause a significant detrimental impact to an existing fishery resource, then ODFW should recommend conditions or limitations.)

<sup>1</sup> AO = Artificial Obstruction means any dam, diversion, culvert or other human-made device placed in waters of this state that precludes or prevents the migration of native migratory fish. ORS 509.580 (1)

<sup>2</sup> NMF = Native Migratory Fish Species in Oregon as defined by OAR 635 - 012 - 0005 (32)



If NMF fish are present at the project site or point of water diversion then the applicant should be advised that a fish screen consistent with screening criteria will be required.

- ☐ This proposed pond or reservoir contemplates impounding water in the Columbia Basin above Bonneville Dam. ODFW has determined that additional diversions of water in this area pose a significant detrimental impact to existing fishery resources during the period April 15 through September 30.

ESA-listed fish (Coho Salmon), sensitive species (spring Chinook Salmon, summer steelhead, and Pacific Lamprey), and other game fish (fall Chinook Salmon, winter steelhead, and Coastal Cutthroat Trout) may be present in Quartz Creek, Jumpoff Joe Creek, and/or the Rogue River during the period of impact. ODFW has identified biologically necessary flows not captured in an instream water right (e.g., flows in a Basin Investigation Report, Persistence Flow Determination, Seasonally Varying Flow prescription, or other flow analysis) that would benefit fishery resources at the Point of Diversion or downstream.

In addition to existing instream water rights and pending instream water right applications, ODFW recommends the following biologically necessary flows be available in Jumpoff Joe Creek at the mouth to protect public uses:

|     |               |     |               |     |               |     |               |
|-----|---------------|-----|---------------|-----|---------------|-----|---------------|
| JAN | type here cfs | APR | type here cfs | JUL | 24.7 cfs      | OCT | type here cfs |
| FEB | type here cfs | MAY | 100 cfs       | AUG | 9.6 cfs       | NOV | 71.4 cfs      |
| MAR | type here cfs | JUN | 52.3 cfs      | SEP | type here cfs | DEC | type here cfs |

RECEIVED

JAN 30 2023

OWRD  
SALEM, OREGON

Based on parameters assessed by ODFW, instream flows are currently below those essential to support the biological needs of an existing fishery resource during April 1-January 31. In addition, ODFW reviewed available information (Rogue River Basin Temperature TMDL; DEQ 2008) regarding water quality impairment and determined that the proposed use would impair water quality that supports existing fishery resources (e.g., habitat) at or downstream of the Point of Diversion. The proposed pond is in the Rogue River basin and subject to the Rogue River Basin Temperature TMDL (DEQ, 2008), which identifies the critical period for temperature as April 1-October 31. Diminished flows from the proposed withdrawal could impact temperature impairments in the Rogue River during this period.

Because of these reasons, the proposed use will diminish water quality, physical habitat, and/or alter the flow regime to which fish are naturally adapted. These changes will negatively affect their distribution, productivity, and abundance. Therefore, a further reduction in flow or alteration of habitat from the proposed use would result in a significant detrimental impact to an existing fishery resource without appropriate conditions and/or mitigation.

| Impairment to Fishery Resource | Jan | Feb | Mar | Apr | May | Jun | Jul | Aug | Sep | Oct | Nov | Dec |
|--------------------------------|-----|-----|-----|-----|-----|-----|-----|-----|-----|-----|-----|-----|
| Water Quantity                 |     |     |     |     |     |     |     |     |     |     |     |     |
| Water Quality                  |     |     |     |     |     |     |     |     |     |     |     |     |

If YES, can conditions be applied to mitigate the significant detrimental impact to an existing fishery resource?

☐ NO (explain) ☒ YES

☒ See applicable conditions selected from "Menu of Conditions" on next page

Water is only available to support the quality and quantity of biologically necessary flows at the POD and/or downstream during February 1-March 31. ODFW recommends the storage season be restricted to coincide with this period or the proposed use be mitigated prior to issuance of a Final Order for any storage outside of this period. Without appropriate conditions (see below) and/or mitigation, a further reduction in flow or alteration of habitat from the proposed water use outside of this period will result in a significant detrimental impact to an existing fishery resource.

Mitigation is often complicated, time consuming, and expensive, and may include, but is not limited to, actions such as replacing the proposed amount of water through purchasing or transferring an existing water right. If the applicant chooses to pursue mitigation after application submittal to WRD, ODFW will provide a Mitigation Obligation



Applicant Name: Ryan Beyerlein

ODFW Review

consistent with the goals and standards of OAR 635-415-0025 (ODFW Habitat Mitigation Recommendations) to compensate for any potential impact from the proposed use. Upon request, the WRD caseworker can schedule a consultation with ODFW for more information. Any pump or other diversion in Quartz Creek associated with the fill of this proposed reservoir must be equipped with an ODFW approved fish screen. Please contact Rich Kilbane (541-826-8774) in the Central Point ODFW Screen Shop for additional information. No obstruction to fish passage shall be built/placed in Quartz Creek as part of this project without ODFW approvals per ORS 509.585.

ODFW Signature: \_\_\_\_\_

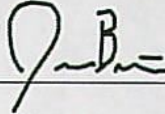

Print Name: Jason Brandt

ODFW Title: SW Hydro Coordinator

Date: 1/24/23

RECEIVED

JAN 30 2023

OWRD  
SALEM, OREGON



## MENU OF CONDITIONS FOR WRD, ODFW, DEQ AND ODA

Revised May 12, 2020, March 25, 2021

RECEIVED

JAN 30 2023

OWRD  
SALEM, OREGON

Use this menu to identify appropriate conditions to be included in the permit:

- ☒ **Agricultural Water Quality Management Area Rules:** The permittee shall comply with basin-specific Agricultural Water Quality Management Area Rules described in Oregon Administrative Rule Chapter 603-095. The permittee shall protect riparian areas, including through irrigation practices and the management of any livestock, allowing site capable vegetation to establish and grow along streams, while providing the following functions: shade (on perennial and some intermittent streams), bank stability, and infiltration or filtration of overland runoff.
- ☐ **b52** Water may be diverted only when Department of Environmental Quality sediment standards are being met.
- ☐ **b5** The water user shall install and maintain adequate treatment facilities meeting current DEQ requirements to remove sediment before returning the water to the stream.
- ☒ **b51a** The period of use has been limited to February 1-March 31.
- ☐ **b57** Before water use may begin under this permit, a totalizing flow meter must be installed at each diversion point.
- ☐ **b58** Before water use may begin under this permit, a staff gage that measures the entire range and stage between full reservoir level and dead-pool storage must be installed in the reservoir. The staff gage shall be United States Geological Survey style porcelain enamel iron staff gage style A, C, E or I.
- ☐ **blv:** Water must be diverted to a trough or tank through an enclosed water delivery system. The delivery system must be equipped with an automatic shutoff or limiting flow control mechanism or include a means for returning water to the stream source through an enclosed delivery system. The use of water shall not exceed 0.10 cubic feet per second per 1000 head of livestock.
- ☐ **Bypass Flows:** Per 690-410-0070 (2)(c), the following flows shall be bypassed or passed through the reservoir during the filling season:
- 1) When the biologically necessary flows identified below are not available immediately upstream of the impacted area, the permittee shall pass all live flow downstream at a rate equal to the inflow, minus the amount of mitigation water provided upstream, if applicable, and
  - 2) When the biologically necessary flows identified below are available immediately upstream of the impacted area, the permittee shall pass flow downstream at a rate equal to or greater than the biologically necessary flows.
- Once the reservoir has reached the permitted volume, all live flow shall be passed downstream at a rate equal to the inflow.
- The permittee shall quantify and document inflow and outflow and maintain the bypass flows for the life of the permit and subsequent certificate per the approved Bypass Plan. The bypass flow data shall be available upon request by the Oregon Water Resources Department, Oregon Department of Fish and Wildlife, Oregon Department of Environmental Quality, or Oregon Department of Agriculture.
- ☒ **Construction Activities:** For construction activities (clearing, grading, excavation, staging, and stockpiling) that will disturb one or more acres and may discharge to state waters, the permittee is required to obtain from DEQ a 1200-C NPDES Stormwater Construction Permit prior to project construction.
- ☐ **fence:** The stream and its adjacent riparian area shall be fenced to exclude livestock.
- ☐ **fishapprove:** The permittee shall install, maintain, and operate fish screening and by-pass devices consistent with current Oregon Department of Fish and Wildlife (ODFW) standards. Fish screening is to prevent fish from entering the proposed diversion while by-pass devices provide adequate upstream and downstream passage for fish. The required screen and by-pass devices are to be in place and functional, and approved in writing by ODFW prior to diversion of any water. The permittee may submit evidence in writing that ODFW has determined screens and/or by-pass devices are not necessary.
- ☒ **fishdiv33:** If the riparian area is disturbed in the process of developing a point of diversion, the permittee shall be responsible for restoration and enhancement of such riparian area in accordance with ODFW's Fish and Wildlife Habitat Mitigation Policy OAR 635-415. For purposes of mitigation, the ODFW Fish and Wildlife Habitat Mitigation Goals and Standards, OAR 635-415, shall be followed.

The use may be restricted if the quality of the source stream or downstream waters decrease to the point that those waters no longer meet existing state or federal water quality standards due to reduced flows.

The permittee shall install, maintain, and operate fish screening and by-pass devices consistent with current Oregon Department of Fish and Wildlife (ODFW) standards. Fish screening is to prevent fish from entering the proposed diversion while by-pass devices provide adequate upstream and downstream passage for fish. The required screen and by-pass devices are to be in place and functional, and approved in writing by ODFW prior to diversion of any water. The permittee may submit evidence in writing that ODFW has determined screens and/or by-pass devices are not necessary.

- ☐ **fishmay:** Notwithstanding that ODFW has made a determination that fish screens and/or by-pass devices are not necessary at the time of permit issuance, the permittee may be required in the future to install, maintain, and operate fish screening and by-pass devices to prevent fish from entering the proposed diversion and to provide adequate upstream and downstream passage for fish.



- ☐ **fishpass:** As required by ORS 509.585, a person owning or operating an artificial obstruction (AO) may not construct or maintain any AO across any waters of this state that are inhabited, or historically inhabited, by native migratory fish (NMF) without providing passage for NMF. A person owning or operating an AO shall, prior to construction, fundamental change in permit status or abandonment of the AO in any waters of this state, obtain a determination from ODFW as to whether NMF are or historically have been present in the waters. If ODFW determines that NMF are or historically have been present in the waters, the person owning or operating the AO shall either submit a proposal for fish passage to ODFW or apply for a waiver or exemption. Approval of the proposed fish-passage facility, waiver, or exemption must be obtained from the department prior to construction, permit modification or abandonment of the AO. Approved fish-passage plans, waivers, and exemptions shall maintain adequate passage of NMF at all times (ORS 509.601) as per the approved plan, waiver or exemption.
- ☐ **fishself:** The permittee shall install, maintain, and operate fish screening and by-pass devices consistent with current Oregon Department of Fish and Wildlife (ODFW) standards. Fish screening is to prevent fish from entering the proposed diversion while by-pass devices provide adequate upstream and downstream passage for fish. The required screen and by-pass devices are to be in place and functional prior to diversion of any water. Permittee shall obtain written approval from ODFW that the installation of the required screen and by-pass devices meets the state's criteria or the permittee shall submit documentation that ODFW has determined screens and/or by-pass devices are not necessary.
- ☒ **Fish Stocking:** Per ORS 498.222 and OAR 635-007-0600, all persons transporting fish in Oregon need to have a fish transport permit issued by the Oregon Department of Fish and Wildlife (ODFW). The permittee shall not stock fish in the reservoir without a fish transport permit approved by ODFW. As part of the permitting process, the permittee must also screen the inlet and outlet of their pond to insure that fish cannot escape into public waters and/or to keep wild fish from entering the pond.
- ☐ **futile call:** The use of water allowed herein may be made only at times when waters from the (NAME OF SURFACE WATER) would not otherwise flow into a tributary of the type here River or sufficient water is available to satisfy all prior rights, including rights for maintaining instream flows.
- ☐ **In-Water or Riparian Construction:** For in-water or riparian construction, permittee may be required to obtain additional permits from the Oregon Department of State Lands, the U.S. Army Corps of Engineers, and the DEQ Section 401 certification program prior to construction. The applicant must contact these agencies to confirm requirements.
- ☒ **In-Water Work:** Any in-water work related to construction, development, or maintenance of the proposed use shall be conducted during the preferred work period of June 15-September 15 unless an alternate time period is approved by the Oregon Department of Fish and Wildlife.
- ☒ **Live Flow:** Once the allocated volume has been stored, permittee shall pass all live flow downstream at a rate equal to inflow, using methods that protect instream water quality.
- ☒ **Off-Channel Stored Water Releases:** The permittee shall not release polluted water from this off-channel reservoir into waters of the state except when the release is directed by the State Engineer to prevent dam failure.
- ☐ **On-Channel Reservoir:** The permittee shall design and operate the water storage facility such that all waters within and below the reservoir meet water quality criteria. The permittee shall develop a reservoir operations plan that details how water quality criteria and standards will be met. A Certified Water Rights Examiner shall verify that the reservoir operations are consistent with the plan before a certificate is issued. The reservoir operator shall maintain a copy of the plan and make it available for review upon request.
- ☐ **riparian:** If the riparian area is disturbed in the process of developing a point of diversion, the permittee shall be responsible for restoration and enhancement of such riparian area in accordance with ODFW's Fish and Wildlife Habitat Mitigation Policy OAR 635-415. For purposes of mitigation, the ODFW Fish and Wildlife Habitat Mitigation Goals and Standards, OAR 635-415, shall be followed.
- ☒ **Water Quality:** All water use under this permit shall comply with state and federal water quality laws. The permittee shall not violate any state and federal water quality standards, shall not cause pollution of any waters of the state, and shall not place or cause to be placed any wastes in a location where such wastes are likely to escape or be carried into the waters of the state by any means. The use may be restricted if the quality of source stream or downstream waters decrease to the point that those waters no longer meet existing state or federal water quality standards.
- ☒ **wetland:** The permittee must submit an offsite determination request to the Oregon Department of State Lands (DSL) to determine the need for a wetland delineation prior to disturbance or development of the point of diversion and/or diversion of water.
- ☐ **wq:** The use may be restricted if the quality of the source stream or downstream waters decrease to the point that those waters no longer meet existing state or federal water quality standards due to reduced flows.

RECEIVED

JAN 30 2023

OWRD  
SALEM, OREGON



RECEIVED

RECEIVED

JAN 03 2023

JAN 30 2023

RECEIVED

FEB 09 2022

# Land Use Information Form

OWRD

OWRD  
SALEM, OREGONOregon Water Resources Department  
725 Summer Street NE, Suite A  
Salem, Oregon 97301-1266503-986-0900  
www.oregon.gov/OWRD

|   |                 |                                |  |
|---|-----------------|--------------------------------|--|
| NAME <u>RYAN BEYERLEIN</u>                      |                 | PHONE (HM) <u>541-479-2605</u> |  |
| PHONE (WK)                                      | CELL            | FAX                            |  |
| ADDRESS <u>3434 QUARTZ CREEK RD PO BOX 1052</u> |                 |                                |  |
| CITY <u>MERLIN</u>                              | STATE <u>OR</u> | ZIP <u>97532</u>               | E-MAIL* <u>ROGUEFARMER66@GMAIL.COM</u> |

## A. Land and Location

Please include the following information for all tax lots where water will be diverted (taken from its source), conveyed (transported), and/or used or developed. Applicants for municipal use, or irrigation uses within irrigation districts may substitute existing and proposed service-area boundaries for the tax-lot information requested below.

| Township   | Range     | Section  | ¼ ¼       | Tax Lot #   | Plan Designation<br>(e.g., Rural Residential/RR-5) | Water to be:                                 |                                   |                               | Proposed Land Use: |
|------------|-----------|----------|-----------|-------------|--|--|-----------------------------------|-------------------------------|--------------------|
| <u>35S</u> | <u>6W</u> | <u>5</u> | <u>00</u> | <u>1300</u> | <u>WR</u>  | <input checked="" type="checkbox"/> Diverted | <input type="checkbox"/> Conveyed | <input type="checkbox"/> Used | _____              |
| _____      | _____     | _____    | _____     | _____       | _____  | <input type="checkbox"/> Diverted            | <input type="checkbox"/> Conveyed | <input type="checkbox"/> Used | _____              |
| _____      | _____     | _____    | _____     | _____       | _____  | <input type="checkbox"/> Diverted            | <input type="checkbox"/> Conveyed | <input type="checkbox"/> Used | _____              |
| _____      | _____     | _____    | _____     | _____       | _____  | <input type="checkbox"/> Diverted            | <input type="checkbox"/> Conveyed | <input type="checkbox"/> Used | _____              |

List all counties and cities where water is proposed to be diverted, conveyed, and/or used or developed:

JOSEPHINE COUNTY, MERLIN

## B. Description of Proposed Use

Type of application to be filed with the Water Resources Department:

- ☒ Permit to Use or Store Water   
 ☐ Water Right Transfer   
 ☐ Permit Amendment or Ground Water Registration Modification  
☐ Limited Water Use License   
 ☐ Allocation of Conserved Water   
 ☐ Exchange of Water

Source of water: ☒ Reservoir/Pond   
☐ Ground Water   
☐ Surface Water (name) \_\_\_\_\_

Estimated quantity of water needed: 918   
☐ cubic feet per second   
☐ gallons per minute   
☒ acre-feet

Intended use of water: ☒ Irrigation   
☐ Commercial   
☐ Industrial   
☐ Domestic for \_\_\_\_\_ household(s)  
☐ Municipal   
☐ Quasi-Municipal   
☐ Instream   
☒ Other Multifuse

Briefly describe:

TO STORE WATER FOR IAG USE AFTER PRIMARY WATER RIGHT HAS BEEN DEPLETED.

**Note to applicant:** If the Land Use Information Form cannot be completed while you wait, please have a local government representative sign the receipt at the bottom of the next page and include it with the application filed with the Water Resources Department.



RECEIVED

RECEIVED

JAN 30 2023

09 2022

**For Local Government Use Only**

OWRD

SALEM, OREGON

JCC PLANNING

The following section must be completed by a planning official from each county and city listed unless the project will be located entirely within the city limits. In that case, only the city planning agency must complete this form. This deals only with the local land-use plan. Do not include approval for activities such as building or grading permits.

Please check the appropriate box below and provide the requested information

- ☐ Land uses to be served by the proposed water uses (including proposed construction) are allowed outright or are not regulated by your comprehensive plan. Cite applicable ordinance section(s): Section 19.65.020.6.5 (outright use)
- ☐ Land uses to be served by the proposed water uses (including proposed construction) involve discretionary land-use approvals as listed in the table below. (Please attach documentation of applicable land-use approvals which have already been obtained. Record of Action/land-use decision and accompanying findings are sufficient.) If approvals have been obtained but all appeal periods have not ended, check "Being pursued."

| Type of Land-Use Approval Needed<br>(e.g., plan amendments, rezones, conditional-use permits, etc.) | Cite Most Significant, Applicable Plan Policies & Ordinance Section References | Land-Use Approval:   |  |
|---|--|--|--|
|   |  | <input type="checkbox"/> Obtained<br><input type="checkbox"/> Denied | <input type="checkbox"/> Being Pursued<br><input type="checkbox"/> Not Being Pursued |
|   |  | <input type="checkbox"/> Obtained<br><input type="checkbox"/> Denied | <input type="checkbox"/> Being Pursued<br><input type="checkbox"/> Not Being Pursued |
|   |  | <input type="checkbox"/> Obtained<br><input type="checkbox"/> Denied | <input type="checkbox"/> Being Pursued<br><input type="checkbox"/> Not Being Pursued |
|   |  | <input type="checkbox"/> Obtained<br><input type="checkbox"/> Denied | <input type="checkbox"/> Being Pursued<br><input type="checkbox"/> Not Being Pursued |
|   |  | <input type="checkbox"/> Obtained<br><input type="checkbox"/> Denied | <input type="checkbox"/> Being Pursued<br><input type="checkbox"/> Not Being Pursued |
|   |  | <input type="checkbox"/> Obtained<br><input type="checkbox"/> Denied | <input type="checkbox"/> Being Pursued<br><input type="checkbox"/> Not Being Pursued |

Local governments are invited to express special land-use concerns or make recommendations to the Water Resources Department regarding this proposed use of water below, or on a separate sheet.

Josephine County Planning  
700 NW Dimmick Street  
Suite C  
Grants Pass, OR 97526

RECEIVED

JAN 03 2023

OWRD

Name: Tami Smith Title: Assistant Planner

Signature: Tami Smith Phone: 541-474-5424 Date: 2-16-2022

Government Entity: Josephine County

**Note to local government representative:** Please complete this form or sign the receipt below and return it to the applicant. If you sign the receipt, you will have 30 days from the Water Resources Department's notice date to return the completed Land Use Information Form or WRD may presume the land use associated with the proposed use of water is compatible with local comprehensive plans.

Receipt for Request for Land Use Information

Applicant name: \_\_\_\_\_

City or County: \_\_\_\_\_ Staff contact: \_\_\_\_\_

Signature: \_\_\_\_\_ Phone: \_\_\_\_\_ Date: \_\_\_\_\_



2022





RECEIVED

JAN 30 2023

OWRD  
SALEM, OREGON

RECEIVED

JAN 03 2023

OWRD



After recording return to:  
Roger F. Jones and Michael R. Jones  
1502 NW Highland  
Grants Pass, OR 97526

File No.: 7151-2565987 (RAC)  
Date: March 10, 2016

THIS SPACE RESERVED FOR RECORDER'S USE

Map/Tax Lot # 35-06-05 TL 1300  
Tax Account #R303023

**TRUST DEED***(Assignment Restricted)*

THIS DEED OF TRUST, made this Tenth day of March, 2016, between Ryan R. Beyerlein, as GRANTOR, and First American Title, as TRUSTEE, and Roger F. Jones and Michael R. Jones, or survivor, as BENEFICIARY.

**WITNESSETH:** Grantor irrevocably conveys to Trustee in trust, with power of sale, certain real property in Josephine County, Oregon, described as:

See Legal Description attached hereto as Exhibit A and by this reference incorporated herein.

Together with all tenements, hereditaments and appurtenances, including easements, and all other rights thereunto belonging or in any way now or hereafter appertaining, and the rents, issues, and profits thereof, together with all fixtures now or hereafter attached to or used in connection with said real estate.

FOR THE PURPOSE OF SECURING PERFORMANCE of each agreement of Grantor herein contained and payment of the sum of **Two Hundred Sixty Thousand dollars (\$260,000.00)**, with interest thereon according to the terms of a promissory note of even date herewith, payable to Beneficiary or order, and made by Grantor, the final payment of principal and interest hereof, if not sooner paid, to be due and payable March 17, 2026.

Note: The Trust Deed Act provides that the Trustee hereunder must be either an attorney who is an active member of the Oregon State Bar, a bank, trust company or savings and loan association authorized to do business under the laws of Oregon or the United States, a title insurance company authorized to insure title to real property of the state, its subsidiaries, affiliates, agents or branches, the United States or any agency thereof, or an escrow agent licensed under ORS 896.505 to 896.585.

\*WARNING: 12 USC 1701/-S regulates and may prohibit exercise of this option.



RECEIVED

JAN 30 2023

OWRD  
SALEM, OREGON  
File No.: 7151-2565987 (RAC)  
Date: 03/10/2016

RECEIVED

JAN 03 2023

OWRD

APN: R303023

Trust Deed - continued

In the event the within described property, or any part thereof, or any interest therein is sold, agreed to be sold, conveyed, assigned or alienated by the Grantor without first having obtained the written consent or approval of the Beneficiary, then, at the Beneficiary's option, all obligations secured by this instrument, irrespective of the maturity dates expressed therein, or herein, shall become immediately due and payable.

**Grantor agrees:**

1. To protect, preserve and maintain the property in good condition and repair; not to remove or demolish any building or improvement therein; not to commit or permit any waste of said property.

2. To complete or restore promptly and in good and workmanlike manner any building or improvement, which may be constructed, damaged or destroyed thereon, and pay when due all costs incurred therefore.

3. To provide and continuously maintain insurance on the buildings now or hereafter erected on the said property against loss or damage by fire and other hazards as the Beneficiary may require, in an amount not less than \$260,000.00, written by companies acceptable to the Beneficiary, with loss payable to Beneficiary; proof of insurance shall be delivered to the Beneficiary as soon as issued.

4. To comply with all laws, ordinances, regulations, covenants conditions and restrictions affecting said property.

5. To keep said premises free from construction liens and to pay all taxes, assessments and other charges that may be levied or assessed upon or against said property before any part of such taxes, assessments and other charges become past due or delinquent and promptly deliver receipt of payment to Beneficiary.

6. Should the Grantor fail to make payment of any taxes, assessments, insurance premiums, liens or other charges payable by Grantor, either by direct payment or by providing Beneficiary with funds with which to make such payment, Beneficiary may, at its option, make payment thereof, and the amount so paid, with interest at the rate set forth in the note secured hereby, together with the obligations of Grantor, described in paragraphs 7 and 8 of this Trust Deed section, shall be added to and become a part of the debt secured by this Trust Deed, without waiver of any right arising from breach of any of the covenants hereof and for such payments, with interest as aforesaid, the property herein before described, as well as the Grantor, shall be bound to the same extent that they are bound for the payment of the obligation herein described and all such payments shall be immediately due and payable without notice, and the nonpayment thereof shall, at the option of the Beneficiary, render all sums secured by this Trust Deed immediately due and payable and constitute a breach of this Trust Deed.

7. To pay all costs, fees and expenses of this trust including the cost of title search, as well as the other costs and expenses of the Trustee incurred in connection with or in enforcing this obligation together with trustees' and attorneys' fees actually incurred.

8. To appear in and defend any action or proceeding purporting to affect the security rights or powers of Beneficiary or Trustee; and in any suit, action or proceeding in which the Beneficiary or Trustee may appear, including evidence of title and the Beneficiary's or Trustee's attorneys' fees. The amount of attorneys' fees mentioned in this paragraph 7 above in all cases shall be fixed by the trial court and in the event of an appeal from any judgment or decree of the trial court, Grantor further agrees to pay such sum as the appellate court shall adjudge reasonable as the Beneficiary's or Trustee's attorneys' fees on such appeal.

**The parties mutually agree:**

1. In the event that any portion of the property is taken under the right of eminent domain or condemnation, Beneficiary shall have the right, if it so elects, to require that all or any portion of the monies payable as compensation for such taking, which are in excess of the amount required to pay all



RECEIVED

JAN 30 2023

OWRD  
SALEM, OREGONFile No.: 7151-2565987 (RAC)  
Date: 03/10/2016

RECEIVED

JAN 03 2023

OWRD

APN: R303023

Trust Deed - continued

reasonable costs, expenses and attorneys' fees, both in the trial and appellate courts, necessarily paid or incurred by Beneficiary in such proceedings, be applied upon the indebtedness secured hereby; and Grantor agrees, at its own expense, to take such actions and execute such instruments as shall be necessary in obtaining such compensation promptly upon Beneficiary's request.

2. Upon any default by Grantor hereunder, Beneficiary may at any time without notice, either in person, by agent, or by a receiver to be appointed by a court, and without regard to the adequacy of any security for the indebtedness hereby secured, enter upon and take possession of the property or any part thereof, in its own name, sue or otherwise collect the rents, issues and profits, including those past due and unpaid, and apply the same, less costs and expenses of operation and collection, including reasonable attorneys' fees upon any indebtedness secured hereby, in such order as Beneficiary may determine.

3. The entering upon and taking possession of the property, the collection of such rents, issues and profits, or the proceeds of fire and other insurance policies or compensation or awards for any taking or damage of the property, and the application or release thereof as aforesaid, shall not cure or waive any default or notice of default hereunder, or invalidate any act done pursuant to such notice.

4. Upon default by Grantor in payment of any indebtedness secured hereby or in Grantor's performance of any agreement contained hereunder, time being of the essence with respect to such payment and/or performance, the Beneficiary may declare all sums secured hereby immediately due and payable. In such event Beneficiary, at its election, may proceed to foreclose this trust deed by advertisement and sale, or may direct the Trustee to pursue any other right or remedy, either at law or in equity, which the Beneficiary may have. In the event the Beneficiary elects to foreclose by advertisement and sale, the Beneficiary or the Trustee shall execute and cause to be recorded a written notice of default and election to sell the said described real property to satisfy the obligation secured hereby whereupon the Trustee shall fix the time and place of sale, give notice thereof as then required by law and proceed to foreclose this trust deed in the manner provided in ORS 86.752 to 86.809.

5. The Grantor and those persons authorized by ORS 86.778 may cure any default(s) 5 days before the date the Trustee has designated for sale. Any cure of default(s) shall require payment of or tendering performance and the payment of all costs and expenses actually incurred in enforcing the obligations of this Trust Deed, including, but not limited to, trustee and attorneys' fees as authorized by law.

In the absence of any such cure, the Trustee will enforce the obligations of this Trust Deed in accordance with paragraph 4 herein and as authorized and required by applicable law.

6. When Trustee sells pursuant to the powers provided herein Trustee shall apply the proceeds of sale to payment of (1) the expenses of sale, including the compensation of the Trustee and a reasonable charge by Trustee's attorney, (2) the obligation secured by the trust deed, (3) to all persons having recorded liens subsequent to the interest of the Trustee in the trust deed as their interest may appear in the order of their priority and (4) the surplus, if any, to the Grantor or to his successor in interest entitled to such surplus.

7. Beneficiary may from time to time appoint a successor or successors to any Trustee named herein or to any successor trustee appointed hereunder. Upon such appointment, and without conveyance to the successor trustee, the latter shall be vested with all title, powers and duties conferred upon any Trustee herein named or appointed hereunder. Each such appointment and substitution shall be made by written instrument executed by Beneficiary, which, when recorded in the mortgage records of the county or counties in which the property is situated, shall be conclusive proof of proper appointment of the successor trustee.



RECEIVED

JAN 30 2023

OWRD  
SALEM, OREGON

APN: R303023

Trust Deed - continued

File No.: 7151-2565987 (RAC)  
Date: 03/10, 2016

The Grantor covenants to and agrees with the Beneficiary and the Beneficiary's successors in interest that the Grantor is lawfully seized in fee simple of the real property and has a valid, unencumbered title thereto, except as may be set forth in any addendum or exhibit attached hereto, and that the Grantor will warrant and forever defend the same against all persons whomsoever.

This deed applies to, inures to the benefit of, and binds all parties hereto, their heirs, legatees, devisees, administrators, executors, personal representatives, successors and assigns. The term Beneficiary shall mean the holder and owner, including pledgee, of the contract secured hereby, whether or not named as a Beneficiary herein. In construing this deed and whenever the context so requires the singular number includes the plural.

**Borrower is to pay for all closing and collection fees and services; there is no cost to the lender.**

IN WITNESS WHEREOF, the Grantor has hereunto set his hand this day and year first above written.

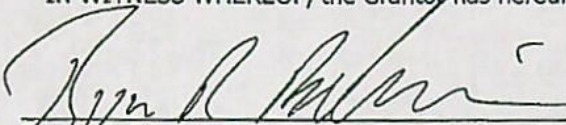
  
Ryan R. Beyerlein

RECEIVED

JAN 03 2023

OWRD

STATE OF Oregon )  
County of Josephine ) ss.

This instrument was acknowledged before me on this 17 day of March, 2016  
by **Ryan R. Beyerlein**.

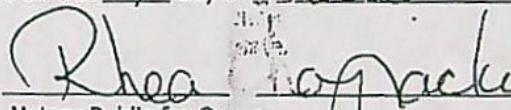
  
Notary Public for Oregon

My commission expires: 522200





RECEIVED

JAN 30 2023

OWRD  
SALEM, OREGON

APN: R303023

Trust Deed - continued

File No.: 7151-2565987 (AC)  
Date: 03/10/2016

**EXHIBIT A**

**LEGAL DESCRIPTION:** Real property in the County of Josephine, State of Oregon, described as follows:

**PARCEL 1:**

THE SOUTHWEST QUARTER OF THE SOUTHWEST QUARTER OF THE SOUTHWEST QUARTER OF SECTION 5, TOWNSHIP 35 SOUTH, RANGE 6 WEST OF THE WILLAMETTE MERIDIAN, JOSEPHINE COUNTY, OREGON.

**PARCEL 2:**

TOGETHER WITH AN EASEMENT FOR DRIVEWAY PURPOSES FOR INGRESS AND EGRESS OVER AN EXISTING ROAD, INCLUDING THE TERMS AND PROVISIONS THEREOF, RECORDED IN DOCUMENT NO. 91-07577, OFFICIAL RECORDS OF JOSEPHINE COUNTY, OREGON.

ALSO TOGETHER AN EASEMENT FOR ROAD PURPOSES, INCLUDING THE TERMS AND PROVISIONS THEREOF, RECORDED IN DOCUMENT NO. 94-1039, OFFICIAL RECORDS OF JOSEPHINE COUNTY, OREGON.

**NOTE:** This Legal Description was created prior to January 01, 2008.

RECEIVED

JAN 03 2023

OWRD



RECEIVED

JAN 30 2023

OWRD  
SALEM, OREGON

Alternate Reservoir Application Completeness Checklist | Summary of Needed Items:

Application:

- ✓ • Water Master Review (Dated in the last 6 months)
- ✓ • ODFW Review (Dated in the last 6 months)
- 1 ✓ ☒ An application map. The map must include following elements:
  - ✓ ☒ The approximate size and location of the reservoir, with the township, range, section, quarter-quarter, and tax lot number(s) clearly identified and labeled.
  - ✓ ☒ An acceptable map scale, clearly shown and labeled. The Department will accept an even scale, for example, 1" = 400 feet, 1" = 500 feet, 1" = 1000 feet, or 1" = 1320 feet.
  - ✓ ☒ Reference corner on map.
  - ✓ ☒ North directional symbol.
  - ✓ ☒ Quarter-quarters clearly identified.
  - ✓ ☒ Reservoir clearly identified.
  - ✓ ☒ The location of the dam, if one exists, by measured distance from a government land survey corner. If no dam exists, provide the measured distance to the center of reservoir. A measured distance includes how many feet north or south, and how many feet east or west, from a recognized survey corner (Example: 495 feet South and 200 feet West from the NW Corner, Section 16).
  - ✓ ☒ If the reservoir is located off-channel, and water is pumped from a creek or stream to the reservoir, include the measured distances of the point of diversion.

The checked items were included in the map provided. The unchecked/highlighted items are what is required.



**STATE OF OREGON  
WATER RESOURCES DEPARTMENT**

725 Summer St. N.E. Ste. A

SALEM, OR 97301-4172

(503) 986-0900 / (503) 986-0904 (fax)

RECEIPT # **140599**

INVOICE # \_\_\_\_\_

RECEIVED FROM: Ryan Boyerlein

BY: \_\_\_\_\_

APPLICATION R-89330

PERMIT

TRANSFER

CASH: ☐ CHECK: # \_\_\_\_\_ OTHER: (IDENTIFY) MO.

☐ ☐ ☒ 28533307364

TOTAL REC'D \$ 610.00

**1083 TREASURY 4170 WRD MISC CASH ACCT**

0407 COPIES

OTHER: (IDENTIFY) \_\_\_\_\_

0243 I/S Lease \_\_\_\_\_ 0244 Muni Water Mgmt. Plan \_\_\_\_\_ 0245 Cons. Water \_\_\_\_\_

**4270 WRD OPERATING ACCT**

MISCELLANEOUS

0407 COPY & TAPE FEES

0410 RESEARCH FEES

0408 MISC REVENUE: (IDENTIFY) \_\_\_\_\_

TC162 DEPOSIT LIAB. (IDENTIFY) \_\_\_\_\_

0240 EXTENSION OF TIME

WATER RIGHTS:

0201 SURFACE WATER

0203 GROUND WATER

0205 TRANSFER

WELL CONSTRUCTION

0218 WELL DRILL CONSTRUCTOR

LANDOWNER'S PERMIT

OTHER (IDENTIFY) \_\_\_\_\_

EXAM FEE

\$

\$

\$

EXAM FEE

\$

0202

0204

0219

0220

RECORD FEE

\$ 610.00

\$

LICENSE FEE

\$

\$

**0536 TREASURY 0437 WELL CONST. START FEE**

0211 WELL CONST START FEE

0210 MONITORING WELLS

OTHER (IDENTIFY) \_\_\_\_\_

\$

\$

CARD#

CARD#

**0607 TREASURY 0467 HYDRO ACTIVITY LIC NUMBER**

0233 POWER LICENSE FEE (FW/WRD)

0231 HYDRO LICENSE FEE (FW/WRD)

HYDRO APPLICATION

\$

\$

\$

**TREASURY OTHER / RDX**

FUND \_\_\_\_\_ TITLE \_\_\_\_\_

OBJ. CODE \_\_\_\_\_ VENDOR # \_\_\_\_\_

DESCRIPTION \_\_\_\_\_

\$

RECEIPT: **140599**

DATED: 4/28/23

BY: Cathy D. Miller



**STATE OF OREGON  
WATER RESOURCES DEPARTMENT**

725 Summer St. N.E. Ste. A

SALEM, OR 97301-4172

(503) 986-0900 / (503) 986-0904 (fax)

RECEIPT # **140599**

INVOICE # \_\_\_\_\_

RECEIVED FROM: Ryan Boyerleau

BY: \_\_\_\_\_

APPLICATION R-89330

PERMIT

TRANSFER

CASH: ☐ CHECK: # ☐ OTHER: (IDENTIFY) MO.

TOTAL REC'D \$ 610.00

**1083 TREASURY 4170 WRD MISC CASH ACCT**

0407 COPIES

\$

OTHER: (IDENTIFY) \_\_\_\_\_

\$

0243 I/S Lease \_\_\_\_\_ 0244 Muni Water Mgmt. Plan \_\_\_\_\_ 0245 Cons. Water \_\_\_\_\_

**4270 WRD OPERATING ACCT**

MISCELLANEOUS

0407 COPY & TAPE FEES

\$

0410 RESEARCH FEES

\$

0408 MISC REVENUE: (IDENTIFY) \_\_\_\_\_

\$

TC162 DEPOSIT LIAB. (IDENTIFY) \_\_\_\_\_

\$

0240 EXTENSION OF TIME

\$

WATER RIGHTS:

EXAM FEE

RECORD FEE

0201 SURFACE WATER

\$

0202

\$ 610.00

0203 GROUND WATER

\$

0204

\$

0205 TRANSFER

\$

WELL CONSTRUCTION

EXAM FEE

LICENSE FEE

0218 WELL DRILL CONSTRUCTOR

\$

0219

\$

LANDOWNER'S PERMIT

0220

\$

OTHER (IDENTIFY) \_\_\_\_\_

**0536 TREASURY 0437 WELL CONST. START FEE**

0211 WELL CONST START FEE

\$

CARD#

0210 MONITORING WELLS

\$

CARD#

OTHER (IDENTIFY) \_\_\_\_\_

**0607 TREASURY 0467 HYDRO ACTIVITY LIC NUMBER**

0233 POWER LICENSE FEE (FW/WRD)

\$

0231 HYDRO LICENSE FEE (FW/WRD)

\$

HYDRO APPLICATION

\$

**TREASURY OTHER / RDX**

FUND \_\_\_\_\_ TITLE \_\_\_\_\_

OBJ. CODE \_\_\_\_\_ VENDOR # \_\_\_\_\_

DESCRIPTION \_\_\_\_\_

\$

RECEIPT:

**140599**

DATED: 4/24/23

BY: Casey D. Miller

Distribution - White Copy - Customer, Yellow Copy - Fiscal, Blue Copy - File, Buff Copy - Fiscal



**STATE OF OREGON  
WATER RESOURCES DEPARTMENT**

725 Summer St. N.E. Ste. A  
SALEM, OR 97301-4172

(503) 986-0900 / (503) 986-0904 (fax)

RECEIPT # **140043**

INVOICE # \_\_\_\_\_

RECEIVED FROM: Ryan Beyerslein

BY: \_\_\_\_\_

|             |                |
|-------------|----------------|
| APPLICATION | <u>R 87330</u> |
| PERMIT      |                |
| TRANSFER    |                |

CASH: ☐ CHECK: # ☐ OTHER: (IDENTIFY) mo  
☒ 28533300030

TOTAL REC'D \$ 521.00

**1083 TREASURY 4170 WRD MISC CASH ACCT**

0407 COPIES \$ \_\_\_\_\_

OTHER: (IDENTIFY) \_\_\_\_\_ \$ \_\_\_\_\_

0243 I/S Lease \_\_\_\_\_ 0244 Muni Water Mgmt. Plan \_\_\_\_\_ 0245 Cons. Water \_\_\_\_\_

**4270 WRD OPERATING ACCT**

**MISCELLANEOUS**

0407 COPY & TAPE FEES \$ \_\_\_\_\_

0410 RESEARCH FEES \$ \_\_\_\_\_

0408 MISC REVENUE: (IDENTIFY) \_\_\_\_\_ \$ \_\_\_\_\_

TC162 DEPOSIT LIAB. (IDENTIFY) \_\_\_\_\_ \$ \_\_\_\_\_

0240 EXTENSION OF TIME \$ \_\_\_\_\_

**WATER RIGHTS:**

0201 SURFACE WATER \$ 521.00 0202 \$ \_\_\_\_\_

0203 GROUND WATER \$ \_\_\_\_\_ 0204 \$ \_\_\_\_\_

0205 TRANSFER \$ \_\_\_\_\_

**WELL CONSTRUCTION**

0218 WELL DRILL CONSTRUCTOR \$ \_\_\_\_\_ 0219 \$ \_\_\_\_\_

**LANDOWNER'S PERMIT**

0220 \$ \_\_\_\_\_

OTHER (IDENTIFY) \_\_\_\_\_

**0536 TREASURY 0437 WELL CONST. START FEE**

0211 WELL CONST START FEE \$ \_\_\_\_\_ CARD# \_\_\_\_\_

0210 MONITORING WELLS \$ \_\_\_\_\_ CARD# \_\_\_\_\_

OTHER (IDENTIFY) \_\_\_\_\_

**0607 TREASURY 0467 HYDRO ACTIVITY LIC NUMBER**

0233 POWER LICENSE FEE (FW/WRD) \$ \_\_\_\_\_

0231 HYDRO LICENSE FEE (FW/WRD) \$ \_\_\_\_\_

HYDRO APPLICATION \$ \_\_\_\_\_

**TREASURY OTHER / RDX**

FUND \_\_\_\_\_ TITLE \_\_\_\_\_

OBJ. CODE \_\_\_\_\_ VENDOR # \_\_\_\_\_

DESCRIPTION \_\_\_\_\_ \$ \_\_\_\_\_

RECEIPT: **140043**

DATED: 1-30-2003 BY: [Signature]