

**CLAIM OF  
BENEFICIAL USE  
for Reservoir Permits by  
CWRE's (not self-certified)**



**Oregon Water Resources Department**  
725 Summer Street NE, Suite A  
Salem, Oregon 97301-1266  
(503) 986-0900  
[www.oregon.gov/OWRD](http://www.oregon.gov/OWRD)

**A fee of \$345 must accompany this form for permits  
with priority dates of July 9, 1987, or later.**

Enter the date the priority date of the permit:

**July 23, 2016**

**A separate form shall be completed for each permit.**

*In cases where a permit has been amended through the permit amendment process, a separate claim for the permit amendment is not required. Incorporate the permit amendment into the claim for the permit.*

This form is subject to revision. **Begin each new claim** by checking for a new version of this form at:

<https://www.oregon.gov/OWRD/Forms/Pages/default.aspx>

The completion of this form is required by OAR 690-014-0100(1) and 690-014-0110(4).

Please type or print in dark ink. If this form is found to contain errors or omissions, it may be returned to you. **Every item must have a response.** If any requested information does not apply to the claim, insert "NA." **Do not delete or alter any section of this form unless directed by the form.** The Department may require the submittal of additional information from any water user or authorized agent.

"Section 8" of this form is intended to aid in the completion of this form and should not be submitted.

If you have questions regarding the completion of this form, please call 503-986-0900.

The Department has a program that allows it to enter into a voluntary agreement with an applicant for expedited services. Under such an agreement, the applicant pays the cost to hire additional staff that would not otherwise be available. This program means a certificate may be issued in about a month. For more information on this program see:

<https://www.oregon.gov/OWRD/programs/WaterRights/RA/Pages/default.aspx>

Received by OWRD

SEP 04 2025

Salem, OR

**SECTION 1**

**GENERAL INFORMATION**

**1. File Information**

APPLICATION #	PERMIT # (IF APPLICABLE)	PERMIT AMENDMENT # (IF APPLICABLE)
<b>R-87769</b>	<b>R-14956</b>	<b>NA</b>

**2. Property Owner (current owner information)**

Revised 7/1/2025

COBU Form Reservoir - Page 1 of 9

WR

APPLICANT/BUSINESS NAME <b>X NOVO, LLC</b>		PHONE NO. <b>707.479.1233</b>	ADDITIONAL CONTACT NO.
ADDRESS <b>2265 Boysen Lane</b>			
CITY <b>St. Helena</b>	STATE <b>California</b>	ZIP <b>94574</b>	EMAIL <b>craig@xnovo.com</b>

If the current property owner is not the permit holder of record, it is recommended that an assignment be filed with the Department. ***Each permit holder of record must sign this form.***

**3. Permit holder of record (this may, or may not, be the current property owner)**

PERMIT HOLDER OF RECORD <b>X NOVO, LLC</b>			
ADDRESS <b>2265 Boysen Lane</b>			
CITY <b>St. Helena</b>	STATE <b>California</b>	ZIP <b>94574</b>	

ADDITIONAL PERMIT HOLDER OF RECORD <b>NA</b>		
ADDRESS		
CITY	STATE	ZIP

**4. Date of Site Inspection:**

**December 21, 2023**

**5. Person(s) interviewed and description of their association with the project:**

NAME	DATE	ASSOCIATION WITH THE PROJECT
<b>Stirling Fox</b>	<b>12/21/2023</b>	<b>Vineyard Manager</b>

**6. County**

**Polk**

**7. If any property described in the place of use of the permit final order is excluded from this report, identify the owner of record for that property (ORS 537.230(5)):**

OWNER OF RECORD <b>NA</b>		
ADDRESS		
CITY	STATE	ZIP

Add additional tables for owners of record as needed



## SECTION 2 SIGNATURES

### CWRE Statement, Seal and Signature

The facts contained in this Claim of Beneficial Use are true and correct to the best of my knowledge.

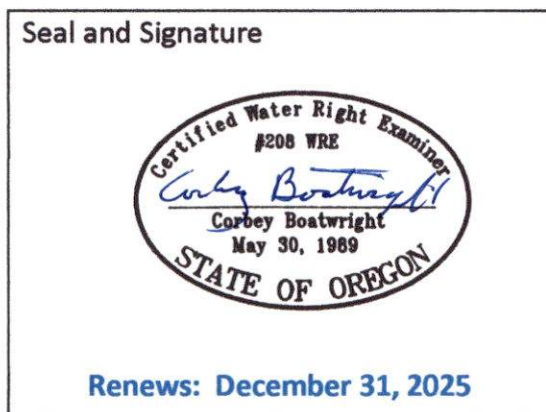

CWRE NAME <b>Corbey Boatwright</b>	PHONE NO. <b>503.363.9225</b>	ADDITIONAL CONTACT NO.	
ADDRESS <b>Boatwright Engineering, Inc. 2613 12<sup>th</sup> Street SE</b>			
CITY <b>Salem</b>	STATE <b>Oregon</b>	ZIP <b>97302</b>	EMAIL <b>corbey@boatwrightengr.com</b>

### Permit Holder(s) of Record Signature or Acknowledgement

**Each** permit or transfer holder of record must sign this form in the space provided below.

The facts contained in this Claim of Beneficial Use are true and correct to the best of my knowledge. I request that the Department issue a water right certificate.

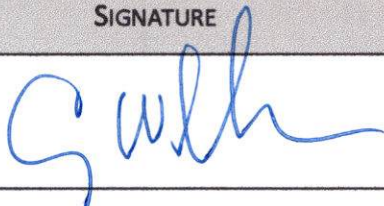
SIGNATURE	PRINT OR TYPE NAME	TITLE	DATE
	<b>Craig Williams</b>	<b>Trustee, Craig &amp; Robin Williams 1991 Revocable Trust, as Member of X NOVO, LLC</b>	<b>9/3/25</b>

Received by OWRD  
 SEP 04 2025  
 Salem, OR

### SECTION 3 CLAIM DESCRIPTION

**1. Reservoir source and, if from surface water, the tributary:**

RESERVOIR NAME OR NUMBER	SOURCE	TRIBUTARY
<b>X NOVO Reservoir</b>	<b>Runoff</b>	<b>Brush College Creek</b>

**2. Developed use(s), period of use, and acre foot (af) for each use:**

RESERVOIR NAME OR NUMBER	USES	SEASON OR MONTHS WHEN WATER WAS APPROPRIATED FOR STORAGE	VOLUME STORED (AF)
<b>X NOVO Reservoir</b>	<b>Multiple Purpose</b>	<b>Jan 1 – Dec 31</b>	<b>5.2</b>
<b>Total Quantity of Water Stored</b>			<b>5.2</b>

**3. Provide a general narrative description of the distribution works. This description must trace the water system from each point of diversion to the reservoir:**

**During storm events, surface runoff water sheet flows into the reservoir.**

**Reminder: The map associated with this claim must identify the location of the point(s) of diversion, Donation Land Claims (DLC), Government Lots (GLot), and Quarter-Quarters (QQ).**

**4. Variations:**

Was the use developed differently from what was authorized by the permit, **YES**  
permit amendment final order, or extension final order? If yes, describe below.

(e.g. "The permit allowed the development of three reservoirs. The permit holder only developed one of the reservoirs." or "The permit allowed for the storage of 9 acre feet of water. The reservoir was developed to hold 5.2 acre feet.")

**The permit authorized the storage of 9.0 acre-feet. The reservoir capacity is 5.2 acre-feet.**

**5. Claim Summary:**

RESERVOIR NAME OR #	MAXIMUM STORAGE AUTHORIZED BY PERMIT (AF)	MAXIMUM STORAGE DEVELOPED (AF)
<b>X NOVO Reservoir</b>	<b>9.0</b>	<b>5.2</b>

**Received by OWRD**  
**SEP 04 2025**  
**Salem, OR**



## SECTION 4

### SYSTEM DESCRIPTION

Are there multiple reservoirs? **NO**

If "YES" you will need to copy and complete Sections A through E for each reservoir.

Reservoir Name or Number this section describes (only needed if there is more than one):

**X NOVO Reservoir**

#### A. Reservoir Location

1. Is the reservoir on-channel? **NO**

2. Provide dam outlet location and/or point of diversion(s).

TWP	RNG	MER	SEC	QQ	GLot	DLC	MEASURED DISTANCES
<b>7S</b>	<b>3W</b>	<b>WM</b>	<b>7</b>	<b>NW-NE</b>	<b>----</b>	<b>----</b>	<b>815' SOUTH &amp; 235' EAST of N 1/4 COR, SEC 7</b>

Reminder: The map associated with this claim must identify Donation Land Claims (DLC), Government Lots (GLot), and Quarter-Quarters (QQ).

#### B. Diversion and Delivery System Information

Provide the following information concerning the diversion and delivery system. Information provided must describe the equipment used to transport the water from the point(s) of diversion to the reservoir.

1. Is a pump used? **NO**

6. Additional notes or comments related to the system:

**During storm events, surface run-off water sheet flows by gravity and enters the north side of the reservoir.**

#### C. Gravity Flow Pipe

(THE DEPARTMENT TYPICALLY USES THE HAZEN-WILLIAM'S FORMULA FOR A GRAVITY FLOW PIPE SYSTEM)

1. Does the system involve a gravity flow pipe? **NO**

#### D. Gravity Flow Canal or Ditch

(THE DEPARTMENT TYPICALLY USES MANNING'S FORMULA FOR CANALS AND DITCHES)

1. Is a gravity flow canal or ditch used to convey the water as part of the distribution system? **NO**

#### E. Reservoir

1. Does the reservoir require the submittal of as-built plans and specifications? **NO**

3. If the reservoir stores less than 9.2 acre-feet of water or if the dam is less than 10 feet in height, and as-built plans and specifications are not required, complete the table and items 4 through 8.

MAXIMUM DEPTH	AVERAGE DEPTH	SURFACE AREA (IN ACRES)	VOLUME (IN ACRE FEET)
15.1	Based on: Avg Area = 12.6' Avg Vol = 9.8' Max Depth = 7.55'	0.69	5.2

4. Provide reservoir volume calculations:

See attached area-capacity curve.

5. Provide the following information concerning the physical characteristics of the dam:

CREST WIDTH (W)	DAM HEIGHT AT CENTERLINE (H)	DISTANCE FROM DOWNSTREAM TOP OF DAM TO DOWNSTREAM TOE (L)	DISTANCE FROM UPSTREAM TOP OF DAM TO UPSTREAM TOE (U)	WATER LEVEL AT INSPECTION	DOWN-STREAM SLOPE	UP-STREAM SLOPE
12'	11.9'	59.5'	30'	468.1	3:1	3.5:1

6. Provide a drawing showing the cross section of the dam at the maximum section indicating details and dimensions. The drawing should be drawn at a standard even scale.

See attached DAM CROSS SECTION drawing

7. Describe the outlet works (size and type of the outlet conduit and location):

8-inch N-12 outlet pipe, 8-inch Waterman Canal Gate C-20f at east end of south face of dam.

8. Describe the emergency spillway (dimensions and location):

BOTTOM WIDTH (W)	TOP WIDTH (L)	SPILLWAY DEPTH (H)
A bar screened outlet structure consisting of an Advantage Precast, Inc., G-2 ditch inlet with a 12" diameter outlet pipe, located at the NW cor of the reservoir. Pipe outfalls to a dissipation pad at the southeast corner of the reservoir.		

Received by OWRD  
SEP 04 2025  
Salem, OR



## SECTION 5 CONDITIONS

All conditions contained in the permit, permit amendment, or any extension final order shall be addressed. Reports that do not address all performance related conditions will be returned.

### 1. Time Limits:

Permits and any extension final orders contain any or all of the following dates; the date when the actual construction work was to begin, the date when the construction was to be completed, and the date when the complete application of water to the proposed was to be completed. These dates may be referred to as ABC dates. Describe how the water user has complied with each of the development timelines established in the permit or extension final order:

	DATE FROM PERMIT	DATE ACCOMPLISHED*	DESCRIPTION OF ACTIONS TAKEN BY WATER USER TO COMPLY WITH THE TIME LIMITS
ISSUANCE DATE	May 31, 2012		
BEGIN CONSTRUCTION (A)	No Date	October 2, 2014	Excavation commenced for reservoir construction
COMPLETE CONSTRUCTION (B)	May 31, 2017	July 2, 2015	Reservoir finished, including: 8-inch outlet w/gate, spillway, and liner
COMPLETE APPLICATION OF WATER (C)	May 31, 2017	December 31, 2016	Reservoir filled to capacity with all conditions met

\* must be within period between permit or any extension final order issuance and the date to completely apply water

2. Is there an extension final order(s)? NO

### 3. Measurement Conditions:

a. Does the permit, permit amendment, or any extension final order require the installation of a meter or approved measuring device? NO

### 4. Recording and reporting conditions

a. Is the water user required to report the water use to the Department? NO

### 5. Outlet Pipe

a. Is the water user required to install a minimum 8" outlet pipe/conduit? YES

b. Has the outlet pipe been installed? YES

### 6. Fish Screening

a. Are any points of diversion required to be screened to prevent fish from entering the point of diversion? NO

### 7. By-pass Device

a. Are any points of diversion required to have a by-pass device to prevent fish from entering the point of diversion? NO

**8. Other conditions required by permit, permit amendment final order, or extension final order**

- a. Was the water user required to restore the riparian area if it was disturbed? **YES**
- b. Was a fishway required? **YES**
- c. Was submittal of a letter from an engineer required prior to storage of water? **NO**
- d. Was submittal of a water management and conservation plan required? **NO**
- e. Other conditions? **NO**

If "YES" to any of the above, identify the condition and describe the water user's actions to comply with the condition(s):

**8.a. Restoration of riparian area required – In Compliance. The location of the reservoir is a draw in a farmed field. There is no creek and no riparian area existed prior to construction, therefore, there is no area that needed to be restored**

**8.b. Fishway required to provide fish passage – In Compliance. There is no upgradient water body. See attached email from Alex Farrand, ODFW Fish Biologist, South Willamette District Office, in which he states: "... in this case ... and from ODFWA's point of view, screens and fish passage would not be required for this pond. It seems clear there never existed any historic channel or habitat for fish to use."**

**SECTION 6  
ATTACHMENTS**

Provide a list of any additional documents you are attaching to this report:

ATTACHMENT NAME	DESCRIPTION
<b>Claim of Beneficial Use</b>	<b>Map</b>
<b>Craig Williams Dam, Area Capacity Curve, Sheet 1 of 1, June 2015</b>	<b>Area Capacity Curve</b>
<b>Craig Williams Dam, Dam Cross Section, 8/26/2025</b>	<b>Dam Cross Section</b>
<b>Jeanne Boatwright</b>	<b>Email from Alex Farrand, ODFW, 9-20-2017</b>
<b>Boundary Survey for Craig Williams</b>	<b>Polk County CS 15467, by James S. Hepler, PLS, Dated October 7, 2010</b>

Received by OWRD  
SEP 04 2025  
Salem, OR



## SECTION 7

### CLAIM OF BENEFICIAL USE MAP

The Claim of Beneficial Use Map must be submitted with this claim. Claims submitted without the Claim of Beneficial Use map will be returned. The map shall be submitted on poly film at a scale of 1" = 1320 feet, 1" = 400 feet, or the original full-size scale of the county assessor map for the location.

Provide a general description of the survey method used to prepare the map. Examples of possible methods include, but are not limited to, a traverse survey, GPS, or the use of aerial photos. If the basis of the survey is an aerial photo, provide the source, date, series and the aerial photo identification number.

**The Point of Diversion for the reservoir, defined as the location of the centerline of the dam at the crossing of the centerline of the existing draw, was located by field measurements to a 5/8-inch iron rod at the interior angle corner in the south property line. The distance to the 2" aluminum disk at the north ¼ section corner of Section 7, was calculated using Polk County Survey Record CS 15467. Google Earth aerial photography confirms that pond construction was commenced prior to 7-23-2016 and completed by 7-3-2017. Pond on Claim map was located using Google Earth aerial photography dated 7-13-2022.**

#### Map Checklist

Please be sure that the map you submit includes ALL the items listed below.

**(Reminder: Incomplete maps and/or claims may be returned.)**

- ☒ Map on polyester film.
- ☒ Appropriate scale (1" = 400 feet, 1" = 1320 feet, or the original full-size scale of the county assessor map)
- ☒ Township, Range, Section, Donation Land Claims, and Government Lots
- ☐ If irrigation, number of acres irrigated within each projected Donation Land Claims, Government Lots, Quarter-Quarters
- ☐ Locations of fish screens and/or fish by-pass devices in relationship to point of diversion
- ☐ Locations of meters and/or measuring devices in relationship to point of diversion
- ☐ Conveyance structures illustrated (pumps, reservoirs, pipelines, ditches, etc.)
- ☒ Point(s) of diversion or appropriation (illustrated and coordinates)
- ☒ Tax lot boundaries and numbers
- ☒ Quarter-Quarters illustrated and named (NE NE, NW NE, etc.)
- ☐ Source illustrated if surface water
- ☒ Disclaimer ("This map is not intended to provide legal dimensions or locations of property ownership lines")
- ☒ Application and permit number or transfer number
- ☒ North arrow
- ☒ Legend
- ☒ CWRE stamp and signature

Received by OWRD  
SEP 04 2025  
Salem, OR

# ACRE—FEET

SCALE:  
HORIZ.: 1" = 1 ACFT  
VERT.: 1" = 5'

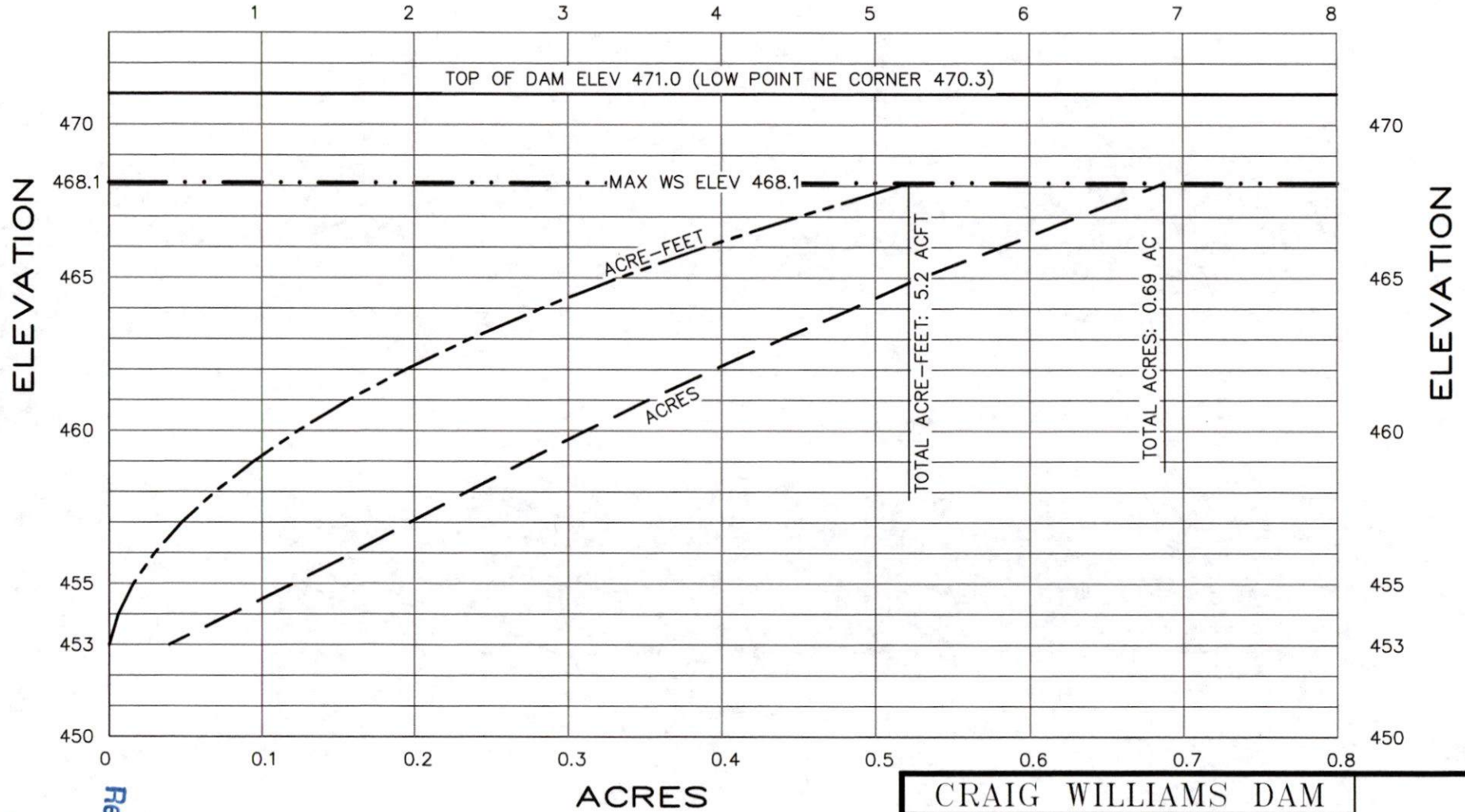

SCALE:  
HORIZ.: 1" = 0.1 AC  
VERT.: 1" = 5'

## CRAIG WILLIAMS DAM

### AREA CAPACITY CURVE

Sec. 7, T.7S., R.3W., W.M. POLK COUNTY, OREGON

Scale: AS NOTED Date: JUNE, 2015 Revised:

Design: CFB  
Drawn: PHD  
Chkd: CFB

Boatwright Engineering, Inc.  
2613 12th Street SE, SALEM, OREGON 97302  
TEL: (503) 363-9225  
FAX: (503) 363-1051

Job No.  
Sheet

1 of 1

Salem, OR

SEP 04 2025

Received by OWRC



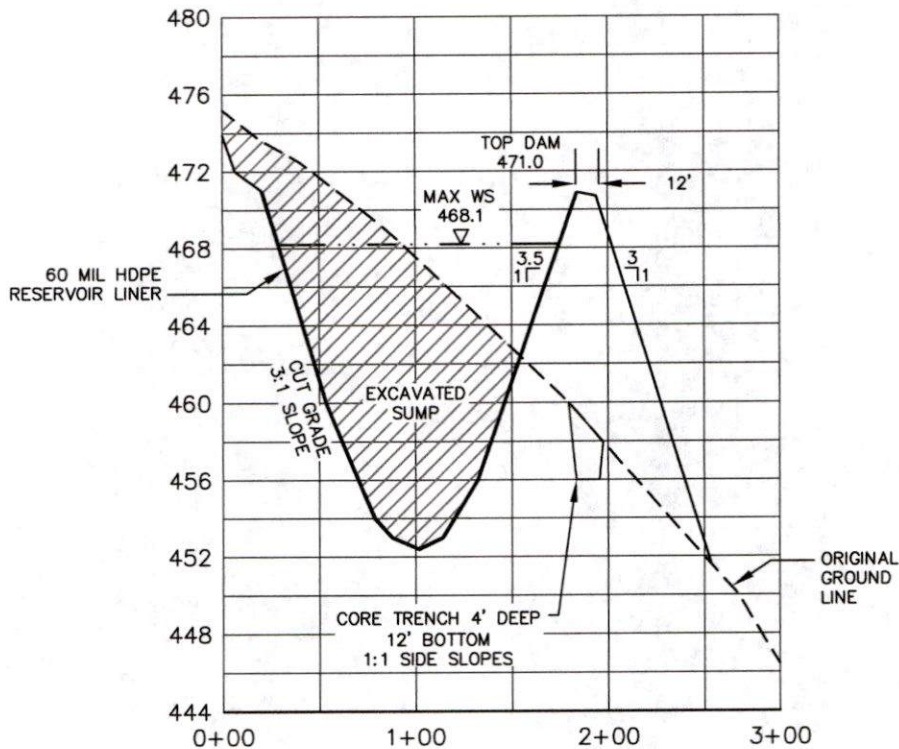

## DAM CROSS SECTION

HORIZONTAL SCALE 1" = 100'  
VERTICAL SCALE 1" = 10'

Received by OWRD  
SEP 04 2025  
Salem, OR

Sec. 7, T.7S., R.3W., W.M. POLK COUNTY

### DAM CROSS SECTION

**X NOVO, LLC, CRAIG WILLIAMS, manager**  
3285 Gibson Road - Salem, OR

DRAWN BY: STAFF

CHECKED BY: CFB

SCALE: AS NOTED

DATE: 8-26-2025

## Jeanne Boatwright

---

**From:** Alex Farrand <alex.farrand@state.or.us>  
**Sent:** Wednesday, September 20, 2017 1:59 PM  
**To:** Jeanne Boatwright  
**Subject:** RE: Water Right Permit S-55082

Hi Jeanne,

I reviewed the applications and permits you sent me and would agree that in this case (Permits R-14956 and S-55082) and from ODFW's point of view, screens and fish passage would not be required for this pond. It seems clear there never existed any historic channel or habitat for fish to use. Let me know if you need anything more from me besides this e-mailed response.

Cheers,

**Alex Farrand**  
Fish Biologist - ODFW  
South Willamette District Office  
7118 NE Vandenberg Ave.  
Corvallis, OR 97330  
Ph: 541-757-5239  
fax: 541-757-4252

**From:** Jeanne Boatwright [<mailto:jeanne@boatwrightengr.com>]  
**Sent:** Friday, September 15, 2017 3:14 PM  
**To:** Alex Farrand <alex.farrand@state.or.us>  
**Cc:** Craig Williams <[cwilliams@netwiz.net](mailto:cwilliams@netwiz.net)>  
**Subject:** Water Right Permit S-55082

Received by OWRD  
SEP 04 2015  
Salem, OR

Alex,

Our client has 2 water rights in Polk County on Gibson Road off of Brush College Road out of West Salem.

The first is for a small, Alternate Review Reservoir (Application R-87769, Permit R-14956). I have attached the Application and the Permit for this right, both of which have certain areas boxed in red for you to review. You will note that Steve Mamoyac signed off on the ODFW Alternate Reservoir Review Sheet and said there are no native migratory fish now, nor were there any historical instances in this location. Therefore no screens or passage were required for the off channel reservoir.

The second water right is the secondary to use the stored water to drip irrigate the surrounding vineyard (Application S-55082, Permit S-88309). Again, I have attached the Application and the Permit for this right, both of which have certain areas boxed in red for you to review. You will see that the permit, unlike the one for the reservoir, requires a sign off from ODFW regarding the need for fish screens and fish passage. I asked the case worker why this language appeared when the reservoir source had already been deemed to not need screens or passage. I was told that, because the source is a permitted reservoir, the secondary is expedited and they always get the fish language included.

While this seems like a no-brainer, I will need confirmation from you that the screens and passage are not required for the irrigation right from this reservoir, which I am hopeful that you can provide.



I have also included a Google Earth shot from this past July that shows the reservoir and the vineyard, relative to Gibson and Brush College Roads.

Jeanne Boatwright  
**Boatwright Engineering, Inc.**  
2613 12th Street SE  
Salem, Oregon 97302  
ph: 503-363-9225

Received by OWRD  
SEP 04 2025  
Salem, OR

BOUNDARY SURVEY

FOR

CRAIG WILLIAMS

IN THE NE 1/4 OF SECTION 7, T 7 S., R. 3 W., W.M.  
POLK COUNTY, OREGON  
OCTOBER 7, 2010



1/4 CORNER  
2" ALUMINUM DISK ON 2" O.D. I.P.  
UP 0.5' ON SOUTH SIDE OF STONE  
0.75' NORTH OF FENCE  
MARKED AS SHOWN  
[BLANCHARD, RE E-119]

1" I.P., DOWN 0.2'  
[HOWE, CS 1328]  
ANCHOR POST IS 0.9' SE

(N55°1'W 460.0', HOWE, CS 1328)  
(N06°16'01"W 463.18'  
(N06°16'01"W 4.20'

1/2" I.P., UP 0.6' [HOWE, CS 1328]  
0.7' NORTH OF ANCHOR POST  
N06°16'01"W 4.20'

617.85' (618.0', HOWE, CS 1328)

N89°38'18"W 1211.98'  
(S89°27'E 1270' - DOCUMENT 2008-004445)

1/2" I.P., UP 0.3'  
FENCE CORNER  
[SOLBERG, CS 3593]  
N03°09'16"W 1.18'

2.5' SOUTH OF FENCE CORNER  
N03°09'16"W 1.18'

S89°35'57"E 2639.22' OR 39.988 CHAINS  
(S89°35'57"E 2639.27', BLANCHARD, 5598)  
(39.77 CHAINS, BOOK 148 PAGE 160)

1427.17'

BRASS DISK IN CONCRETE, DOWN  
MARKED AS SHOWN  
CARSONITE POST 1.0' NORTH  
[RESTORATION BOOK E PAGE 121]



5/8" I.R., UP 0.4' [SHULL, 5489A]  
FENCE IS 4.8' EAST  
S86°42'19"W 0.13'

(890', DOCUMENT NO. 2008-004445)  
N00°03'20"E 905.63'

969.70' OR 14.692 CHAINS,  
(14.70 CHAINS, COLLINS, SURVEY BOOK 8, PAGE 179)  
(N01°15'E 1864.29' OR 28.25 CHAINS  
(SWART, 7360)

5/8" I.R. [STATE HIGHWAY]  
SMOOTH ROD UP 7" TOP 3" IS BENT,  
IN DECAYED MAPLE STUMP  
UNKNOWN RECORD OF SURVEY  
N80°10'15"W 7.88'

3/4" I.P. [BARNES, 1630]  
BENT NORTHERLY, UP 2" TOP 3" IS BENT,  
IN DECAYED MAPLE STUMP  
BEARS S25E 6.3' TO FACE  
(40' S25E 0.10 CHAINS, BARNES)  
8.7' TO CENTER OF TREE  
(9" MAPLE, S61E 16.5 LINKS, COLLINS, SURVEY BOOK 8 PAGE 179)

NARRATIVE

This survey was made to monument the corners of the tract of land described in Document No. 2008-004445 except the tract described in Document No. 2009-007188, and to mark the east line. Monuments were found for all of the corners of the tract. However, some of the monuments were not correctly placed to represent the corners of the tract. At the westerly southwest corner, State Highway set a monument in an unrecorded survey. It appears that a fence line was used in the State Highway survey instead of the center of section line as specified in prior deeds. Surveys by Collins, Blanchard, and Barnes agree on the location of the center of section line. Therefore, I have held monuments as in those surveys for the center of section line and intersected that line with the north line of the State Highway tract as monumented to correctly monument the westerly southwest corner.

At the northeast corner, a monument by Solberg was found north of the section line. Surveyors had only run parts of the line from various directions. Consequently, monuments along that line are off of the section line. I have remonumented the northeast corner at the correct location by intersecting Solberg's line with the section line. All other corners were correctly monumented in previous surveys. Those monuments were found and held. The east line was marked at various intervals with white fiberglass posts.

LEGEND

- = Found Monument as noted, flush with ground surface and in good condition unless otherwise noted
- = Set 5/8"x30" Iron Rod with Yellow Plastic Cap, Marked "AZIMUTH SURVEYING"
- ( ) = Data of Record
- [ ] = Surveyor, File Number for survey in which monument probably originated
- I.P. = Iron Pipe
- I.R. = Iron Rod

SCALE : 1" = 100'

1/2" I.P., UP 4" [SWART, 7360]  
CALLED FOR IN BOOK 148 PAGE 160  
HELD AS BEING 0.10' EASTERLY OF THE NORTH-SOUTH  
CENTERLINE OF SECTION 7 (BLANCHARD, 5598)

SE CORNER  
BOOK 162, PAGE 487

20.00' (20.00' - SHULL, 5489A)

S89°59'33"W 569.37' (N89°59'35"W 569.36' - SHULL, 5489A)

[SOLBERG, 3514]

20.03' (20.03' - SOLBERG, 3514)

5/8" I.R. [SOLBERG, 3514]

REGISTERED  
PROFESSIONAL  
LAND SURVEYOR  
*James S. Hepler*  
OREGON  
JULY 25, 1990  
2451  
JAMES S. HEPLER  
EXPIRATION DATE: 6-30-11  
AZIMUTH SURVEYING  
2015 Market Street, NE  
Salem, Oregon 97301  
Phone (503) 364-0026  
Project No. 10-063

BLANCHE D. MUSSMAN REVOCABLE TRUST  
DOCUMENT 2009-007188

5/8" I.R. [HEPLER, 15352]  
5/8" I.R. [STATE HIGHWAY]  
UNKNOWN RECORD OF SURVEY

(N00°48'14"E 838.11' - SHULL, 5489A)  
(N04°6'59"E 838.11' - SHULL, 5489A)

(N66°33'44"E 588.11' - HEPLER, 15352)  
(N66°33'44"E 588.11' - HEPLER, 15352)

5/8" I.R. [HEPLER, 15352]

(370.98' - HEPLER, 15352)

5/8" I.R. [STATE HIGHWAY]  
UNKNOWN RECORD OF SURVEY  
FOUND BY SHULL, 5489A

(N79°42'30"W 781.75' - DOCUMENT 2008-004445)  
(N80°10'15"W 774.14'  
(N79°42'30"W 781.75' - DOCUMENT 2008-004445)

S03°18'12"E 1429.30' - SHULL, 5489A)  
(N3°18'12"E 1429.30' - SHULL, 5489A)  
(S02°18'12"E 1871.53'  
(S02°18'12"E 1871.53'

(431.04' - GIERING, 3593)  
422.20'

5/8" I.R. WITH ALUMINUM CAP  
[GIERING, 3593]





Received by OWRD

SEP 04 2025

Salem, OR

Date Received (Date Stamp Here)

## OWRD Over-the-Counter Submission Receipt

Applicant Name(s) & Address: X NOVO LLC 2265 Boysen Lane  
St. Helena, CA 94574

Transaction Type: COBU-Res

Fees Received: \$ 345.00

☐ Cash

☒ Check:

Check No. 3608

Name(s) on Check: X NOVO LLC

Thank you for your submission. Oregon Water Resources Department (Department) staff will review your submittal as soon as possible.

If your submission is determined to be complete, you will receive a receipt for the fees paid and an acknowledgement letter stating your submittal is complete.

If determined to be incomplete, your submission and the accompanying fees will be returned with an explanation of deficiencies that must be addressed in order for the submittal to be accepted.

If you have any questions, please feel free to contact the Department's Customer Service staff at 503-986-0801 or 503-986-0810.

Sincerely,

OWRD Customer Service Staff

Submission received by: Sarah Benham  
(Name of OWRD staff)

### Instructions for OWRD staff:

- Complete this Submission Receipt and make two (2) copies. Place one copy with the check/cash; and place the other copy with the submission (i.e., the application or other document).
- Date-stamp all pages. (NOTE: Do not stamp check.)
- Give this original Submission Receipt to the applicant.
- Record Submission Receipt Information on the "RECEIVED OVER THE COUNTER" log sheet.
- Fold and put one copy of the Submission Receipt with check/cash into the Safe slot. Place the other copy of the Submission Receipt with submission (application/other document) in the top drawer of filing cabinet.