

**STATE OF OREGON  
WATER RESOURCES DEPARTMENT**

RECEIPT # **95821**

3850 PORTLAND ROAD NE  
SALEM, OR 97310  
378-8455/378-8130 (FAX)

RECEIVED FROM: 7L Cattle Company  
BY: \_\_\_\_\_

APPLICATION	
PERMIT	
TRANSFER	

CASH:  CHECK: #  24-12 OTHER: (IDENTIFY)

TOTAL REC'D \$ 1173.00

**01-00-0 WRD MISC CASH ACCT**

842.010	ADJUDICATIONS	\$ <u>1173.00</u>
831.087	PUBLICATIONS/MAPS	\$
830.650	PARKING FEES Name/month	\$
_____	OTHER: (IDENTIFY)	\$

**REDUCTION OF EXPENSE**

CASH ACCT.	\$
COST CENTER AND OBJECT CLASS	VOUCHER #

**03-00-0 WRD OPERATING ACCT**

**MISCELLANEOUS:**

840.001	COPY FEES	\$
850.200	RESEARCH FEES	\$
880.109	MISC REVENUE: (IDENTIFY)	\$
520.000	OTHER (P-6): (IDENTIFY)	\$

**WATER RIGHTS:**

842.001	SURFACE WATER	EXAM FEE	\$	842.002	RECORD FEE	\$
842.003	GROUND WATER	EXAM FEE	\$	842.004	RECORD FEE	\$
842.005	TRANSFER	EXAM FEE	\$	842.006	RECORD FEE	\$

**WELL CONSTRUCTION**

842.022	WELL DRILL CONSTRUCTOR	EXAM FEE	\$	842.023	LICENSE FEE	\$
842.016	WELL DRILL OPERATOR	EXAM FEE	\$	842.019	LICENSE FEE	\$
_____	LANDOWNER'S PERMIT	EXAM FEE	\$	842.024	LICENSE FEE	\$

**06-00-0 WELL CONST START FEE**

842.013	WELL CONST START FEE	\$	CARD #	
_____	MONITORING WELLS	\$	CARD #	

**45-00-0 LOTTERY PROCEEDS**

864.000	LOTTERY PROCEEDS	\$
---------	------------------	----

**07-00-0 HYDRO ACTIVITY**

842.011	POWER LICENSE FEE(FW/WRD)	LIC NUMBER	\$
842.115	HYDRO LICENSE FEE(FW/WRD)	LIC NUMBER	\$
_____	HYDRO APPLICATION	LIC NUMBER	\$

RECEIPT # **95821**

DATED: 12/31/92

BY: [Signature]

2-14-95

CARL SUNDET, CWRE

SUR- 94, 98, 235, 393, 429

---

ASKED HIM ABOUT MAPS &  
INFO HE SAID HE WOULD  
PUT IT TOGETHER AND SEND  
IT BY END OF THIS MONTH.

TOLD HIM I WOULD CALL &  
REMIND HIM IF I DON'T GET IT.

W. C. Cunniff

STATE OF OREGON  
WATER RESOURCES DEPARTMENT  
INTEROFFICE MEMO

May 11, 1994

TO: WATER RIGHT EXAMINERS

FROM: DON KNAUER

SUBJECT: PRE-1909 VESTED WATER RIGHT CLAIM MAPS

Alright you guys, this is a test, DO YOU KNOW WHAT TIME IT IS? The answer is, it's time to get the maps, reports, answers, mylars and all that kind of stuff back to the Water Resources Department. There's talk around the office of putting together a "map-patrol" with a tough leader to travel around and retrieve the required documents.

You may remember, I reviewed maps for compliance with Oregon Revised Statutes and Oregon Administrative Rules submitted to support pre-1909 vested water right claims. For the past few months and up to a year ago I have returned maps, requested mylars, asked for clarification, and asked for reports. Some of these files are getting stale.

It is very important that you give me something, preferably the map, mylar, report, etc. but at minimum you must give me a submittal date. The review of the files cannot be completed without the map, report, etc. It is a deterrent to the claimant, your client, for this issue to go unresolved.

If you need copies of anything in the files, just let me know. I have hand written below the file numbers of those I returned to you. The toll free number is 1-800-624-3199.

j:\wp51\swr\claimant\cwrememo.94

- SWR-94 : WHITTLES
- 98 : BRATTAIN
- 235 : OSU
- 393 : FLOAZ
- 429 : BRATTAIN

November 18, 1993

CARL E. SUNDET  
PO BOX 1228  
LAKEVIEW OR 97630

RE: File# SWR-429

DEAR CARL E. SUNDET,

The Water Resources Department (WRD) received a little over 500 surface water registration statements in December, 1992. All of the files have been set up and receipts for the fees have been sent. The next step is to insure the maps received in support of the claims are acceptable based on Oregon Revised Statutes (ORS) and Oregon Administrative Rules (OAR).

I am NOT returning the map you prepared for Thomas A. Brattain. The information can be submitted in a report or letter form. You will find the item which requires completion or correction shown below. I have the description followed by the ORS or OAR site and paraphrased statute or rule.

conveyance	ORS 539.120 "...the location of .... and each ditch, canal, pipeline or other means of conveying the water..." You must describe the systems for domestic and stockwater beneficial use.
place of use (¼ ¼)	ORS 539.240 (2) (d) (B) "The location of place of use by quarter-quarter section..." You must describe the place of use for domestic and stockwater beneficial use.
diversion point size	OAR 690-28-025-(4)-(c) "The dimensions and capacity of any existing diversion systems." You must describe the systems for domestic and stockwater beneficial use.



---

3850 Portland Rd NE  
Salem, OR 97310  
(503) 378-3739  
FAX (503) 378-8130

A reminder for future reference, the acceptable scales for maps for water rights does not include 1" = 1000' without prior approval.

You must return the map before the claim can be processed. If you cannot have the map to the WRD within 60 days, please inform me as to when it can be expected. Please mark all correspondence with the file number.

As always, if you have any questions, please give me a call.

Sincerely,

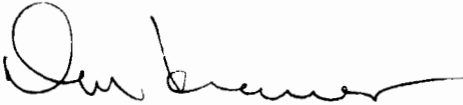
A handwritten signature in black ink, appearing to read "Don Knauer". The signature is fluid and cursive, with a long horizontal stroke at the end.

Don Knauer  
Adjudication Specialist

Enclosures

**SURFACE WATER REGISTRATION CHECKLIST**

(received after July 18, 1990)

CHECK BASIN MAP DWF NAME Goose & Summer Lakes # 13 UNADJUDICATED AREA ? OK DWF  
 RECEIPT # 95821 S W R NUMBER 429  
 CHECK ENCLOSURES DWF PRELIMINARY DATA BASE ENTRY DWF  
 ACKNOWLEDGEMENT LETTER DWF ENTER ON STREAM INDEX \_\_\_\_\_  
 CHECK QUADRANGLE MAP \_\_\_\_\_ CHECK GLO PLATS \_\_\_\_\_  
 WATERMASTER CHECKLIST \_\_\_\_\_ PUBLIC NOTICE PUBLICATION Done

**FORM REVIEW**

\_\_\_\_\_ blanks filled in  
 \_\_\_\_\_ signed  
 \_\_\_\_\_ date received stamped

**IRRI DOM STOLK  
 MAP REVIEW**

IRRI	DOM	STOLK	
✓	✓	✓	source and trib
✓	✓	✓	diversion point location
✓	#3	#3	conveyances (pipes, ditch, etc.)
✓	#4	#4	place of use
✓	✓	✓	scale _____ note: 1" = 1000'
✓	✓	✓	township, range, section
✓	✓	✓	north arrow
✓	✓	✓	CWRE stamp
✓	✓	✓	disclaimer
✓	✓	✓	date survey was performed
✓	✓	✓	P.O.B. of survey
✓	#12	#12	dimensions and capacity of diversion system
✓	✓	✓	"beneficial use" type title
✓	✓	✓	"permanent-quality" paper

WATER RIGHT RECORD CHECK \_\_\_\_\_ FIELD INSPECTION \_\_\_\_\_

FINAL FILE REVIEW \_\_\_\_\_ FINAL DATA BASE ENTRY \_\_\_\_\_

ENTER ON PLAT CARDS \_\_\_\_\_

April 2, 1993

THOMAS A BRATTAIN  
PO BOX 270  
PAISLEY OR 97636

Dear MR BRATTAIN,

This will acknowledge that your Surface Water Registration Statement in the name of THOMAS A BRATTAIN has been received by our office. The fees in the amount of \$1173.00 have been received and our receipt #95821 is enclosed. Your registration statement has been numbered SWR-429.

Our office will review your form and map in the near future. If necessary we will schedule a meeting with you that will include a site inspection. If there are problems with your form we are usually able to take care of them during our visit. We will be able to answer any questions you might have about the adjudication process at that time.

Please feel free to contact this office if you have any questions.

Sincerely,

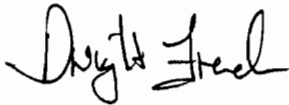

Dwight French  
Adjudication Section

Enclosure

J:\WP51\SWR\CLAIMANT\SWR-0429.001



---

3850 Portland Rd NE  
Salem, OR 97310  
(503) 378-3739  
FAX (503) 378-8130

Brattain Ranch ditches:  
SWR - 429

Using Manning's formula  $V = \frac{1.486}{N} R^{2/3} S^{1/2}$

All N = 0.024 Corrugated pipe headgates

RECEIVED  
FEB 14 1996  
WATER RESOURCES DEPT.  
SALEM, OREGON

XL Spring:  
IRRIGATION

#3 24" cmp

Area = 3.14 sq. ft.  
Wetted perimeter = 6.28 ft.  
S = 2 ft./1000 ft.  
N = 0.024  
V = 1.74 ft/sec  
Q = 5.48 CFS  
5.48 CFS x 449 = 2460 GPM

#4 24" cmp

Area = 3.14 sq. ft.  
Wetted perimeter = 6.28 ft.  
S = 2 ft./1000 ft.  
N = 0.024  
V = 1.74 ft/sec  
Q = 5.48 CFS  
5.48 CFS x 449 = 2460 GPM

#5 ditch

Area = 3.14 sq. ft.  
Wetted perimeter = 6.28 ft.  
S = 3 ft./1000 ft.  
N = 0.024  
V = 2.14 ft/sec  
Q = 6.71 CFS  
6.71 CFS x 449 = 3012 GPM

Total System Q = 7932 GPM  
Total claimed = 7535 GPM

DOMESTIC

#6 Spring House

6'x4'x4' Concrete Spring Box = 96 CF x 7.48 = 718 Gal.  
Delivery is by hand bailing.

Place of use is NW 1/4 NW 1/4 Section 26, T.32S. R.21E.

STOCKWATER

Pond

Area = 48044 sq ft  
Depth = 4'  
48044 x 4 x 0.4 = 76870 CF  
76870 x 7.48 = 574,988 Gal.

Place of use is the NW 1/4 NW 1/4 Section 26 and  
NE 1/4 NE 1/4 Section 27, T.32S. R.21E.



Brattain Ranch ditches:  
SWR - 98

$$\text{Using Manning's formula } V = \frac{1.486}{N} R^{2/3} S^{1/2}$$

All N = 0.030 Earth channels winding and sluggish

Spring #1:  
IRRIGATION 2.3 ACRES  
ditch

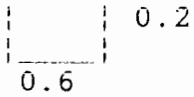

$$\begin{aligned} \text{Area} &= 0.12 \text{ sq. ft.} \\ \text{Wetted perimeter} &= 1.00 \text{ ft.} \\ S &= 1 \text{ ft./1000 ft.} \\ N &= 0.030 \\ V &= 0.38 \text{ ft/sec} \\ Q &= 0.046 \text{ CFS} \\ 0.046 \text{ CFS} \times 449 &= 20.5 \text{ GPM} \end{aligned}$$

STOCKWATER  
Pond

$$\begin{aligned} \text{Area} &= 25265 \text{ sq ft} \\ \text{Depth} &= 2.5' \\ 25265 \times 2.5 \times 0.4 &= 25264 \text{ CF} \\ 25264 \times 7.48 &= 188,980 \text{ Gal.} \end{aligned}$$

Spring #2:  
IRRIGATION 2.0 ACRES  
and  
STOCKWATER  
ditch

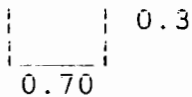

$$\begin{aligned} \text{Area} &= 0.21 \text{ sq. ft.} \\ \text{Wetted perimeter} &= 1.30 \text{ ft.} \\ S &= 1 \text{ ft./1000 ft.} \\ N &= 0.030 \\ V &= 0.46 \text{ ft/sec} \\ Q &= 0.098 \text{ CFS} \\ 0.098 \text{ CFS} \times 449 &= 43.8 \text{ GPM} \end{aligned}$$

Spring Area #3 (seep)  
STOCKWATER

$$\begin{aligned} \text{Total System } Q &= 64.3 \text{ GPM} \\ \text{Total claimed} &= 14.0 \text{ GPM} \end{aligned}$$

**REC**  
**FEB 14 1996**  
WATER RESOURCES DIVISION  
SALEM, OREGON

SUNDET AND ASSOCIATES

CARL SUNDET  
P.O. BOX 1228  
LAKEVIEW, OR 97630

(541) 947-3293

CWRE # 127

MANNING'S FORMULA

$$V = \frac{1.486}{N} R^{2/3} S^{1/2}$$

V = Velocity

N = Roughness coefficient

R = Wetted perimeter

S = Hydraulic gradient

Velocity (V) X End area of ditch = Q (CFS)

VOL 385

RECEIVED

PRELIMINARY OATHS OF ASSISTANTS.

DEC 31 1992

WATER RESOURCES DEPT. SALEM, OREGON

We, *Howard Sharp and Frank Howard*

do solemnly swear that we will faithfully execute the duties of Chain Carriers; that we will level the chain over even and uneven ground, and plumb the tally pins, either by sticking or dropping the same; that we will report the true distance to all notable objects, and the true length of all lines that we will assist in measuring, to the best of our skill and ability, and in accordance with the instructions given us in the survey of the

*Subdivisional* lines of *Township 82*  
*South Range 21 East* Willamette Meridian, Oregon.

*Howard Sharp*, Chainman.  
*Frank Howard*, Chainman.  
Chainman.  
Chainman.

Subscribed and sworn to before me this *16<sup>th</sup>*  
day of *May* *April* 1895

[SEAL.]

*John H. McCusick*  
*U.S. Deputy Surveyor*  
*and James Moore*

do solemnly swear that we will well and truly perform the duties of Axman in the establishment of corners and other duties, according to instructions given and to the best of our skill and ability, in the survey of the

*Subdivisional lines of T 32 S of*  
*Range 21 E* Willamette Meridian, Oregon.

*James Moore*, Axman.  
Axman.

Subscribed and sworn to before me this *16<sup>th</sup>*  
day of *May* 1895

[SEAL.]

*John H. McCusick*  
*U.S. Deputy Surveyor*

# INDEX

433

Referring the Lines to the Pages of the Field Notes.

T. 292 E R. 21 E Will. Mer.

6	59	3	44	1	39	3	24	2	12	1
68	57		43		38		23		11	
7	56	8	42	9	32	10	22	11	10	12
55	54		41		31		21		9	
18	53	17	40	16	30	15	20	14	8	13
62	51		39		29		19		7	
19	50	20	39	21	28	22	19	23	6	24
49	48		38		27		17		5	
20	47	20	37	20	26	21	15	20	4	25
47	46		36		25		15		3	
31	45	22	35	23	25	24	13	25	2	26

Meanders of \_\_\_\_\_ Pages \_\_\_\_\_ to \_\_\_\_\_

Meanders of \_\_\_\_\_ Pages \_\_\_\_\_ to \_\_\_\_\_

Subdivision 3<sup>rd</sup> S R 21 E continued

- chains low level marshy meadow
- 40.00 Set a basalt stone 14+8+6 ins.  
10 ins. in the ground for  $1/4$  S. E. cor.  
mkd  $1/4$  on W. face. Dig pits 18+18+12  
ins N. and S. of stone and raised  
mound of earth  $3\frac{1}{2}$  ft base  $1\frac{1}{2}$   
ft high W. of fl.
- 72.80 Barbed wire fence bears S  $27\frac{1}{2}$  E
- 73.30 Irrigating ditch bears N  $70$  E  
and S  $70$  W
- 76.10 Barbed wire fence bears N  $59$  W  
and S  $59$  E
- 80.00 In N. edge of marsh - Set a  
basalt stone 24+20+10 ins 18  
ins in the ground for cor of trees  
N 2 - 23 - N and N by mkd with 2  
notches on E. and W. edges and  
raised mound of stone 2 ft base  $1\frac{1}{2}$  ft  
high W. of fl. pits impracticable  
A pond 100 ft in diam bears N.  
1.50 chs dist  
The X.L. Co's. house bears S  $56$  E 5 chs dist  
Spring house bears S  $51\frac{1}{2}$  E about 4.50 chs dist  
Barn house bears S  $66$  E about 4.50 chs dist  
Land level  
Soil sand and clay loam 10 ft or to

10385

Subdivision Sp 3 & R 21 E Continued  
chain Stone 2 ft base 1 1/2 ft high  
W. of Cor. <sup>into irregular</sup> This cor is 50 ft from  
last section. Hence on nearly  
level land

7930 The Cor of Secs 5-6-7 and 8  
Land rolling and bench  
Soil sandy loam 3rd rate - stony  
Dense undergrowth of sage brush  
7930 chs.

APR 30 1895

General Description  
This Sp has three varieties of soil  
alkali along Albert Lake, and rich  
alluvial in the marsh and meadow  
which is enclosed in Secs 25-26  
27-28-33-34-35 and a part of <sup>36</sup> 36.  
The remaining portion is sandy  
desert and stony producing  
good grass in the early spring on  
account of the moisture from the  
snow and rains.

The marshy portion has been drained  
by the X L Cattle firm and is mostly  
good meadow producing from  
1 to 3 tons of hay per acre  
The desert portion would

produce good crops were it possible  
 to irrigate it. To irrigate from  
 Albert Lake would not be prac-  
 ticable on account of the large  
 amount of salt borax and  
 alkali contained in the water  
 and springs of clear water are  
 not in sufficient quantities  
 to irrigate but a small portion  
 of the land

There is no timber on this Sp.  
 and the settlers resort to sage  
 brush for fuel, the desert  
 portion being covered with a  
 dense growth of it and some  
 greasewood and grass

The Larkspur a plant deadly  
 to cattle in the early spring  
 grows abundantly in the sandy  
 soil on the desert.

John A. McQueen  
 U.S. Dept. Surveyor

ed  
 gh  
 abou  
 nearly  
 way  
 it  
 ick  
 mead  
 do  
 36  
 sandy  
 on  
 the  
 mind  
 mostly

Dependent Resurvey of the Subdivision of T. 32 S., R. 21 E.

Chains.

Set an iron post, 3 ft. long, 1 in. diam., 26 ins. in the ground, with the original stone deposited at the base, for 4 sec. cor., with brass cap nkd.



18x18x12 ins., E. and W. of post, 3 ft. dist. dig pits,

Thence

S. 89° 50' W., with new measurement.

35.00 Enter marshy meadow land, bears NE. and SW.

40.14 the cor. of secs. 26, 27, 34, and 35.

Land level.

Soil, sandy loam; 1st rate.

No timber; undergrowth, greasewood.

North, bet. secs. 26 and 27.

Over marshy meadow land.

18.20 An irrigation ditch, 4 lks. wide, bears NE. and SW.

40.07 Proportional measurement,

Set an iron post, 3 ft. long, 1 in. diam., 26 ins. in the ground, for 4 sec. cor., with brass cap nkd.

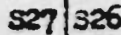

1941

18x18x12 ins., N. and S. of post, 3 ft. dist. dig pits,

73.95 An irrigation ditch, 30 lks. wide, bears E. and W.

74.60 An irrigation ditch, 25 lks. wide, bears E. and W.

80.14 Proportional measurement,

Set an iron post, 3 ft. long, 2 ins. diam., 26 ins. in the ground, for cor. of secs. 22, 23, 26, and 27, with brass cap nkd.

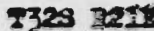

1941

from which

The SW. cor. of foundation of X L Ranch house, bears S. 58 1/2° E., 417 lks. dist.

Raise a mound of stone, 3 ft. base, 2 ft. high, W. of cor.

Land, level.

Soil, sandy loam; 1st rate.

No timber; no undergrowth.

Set a mound of stone to top, for 4 sec. cor., with brass cap nkd.



Ship No. 32 *Sault Range No 21 East of the Willamette Meridian Oregon*

S 89:50' N

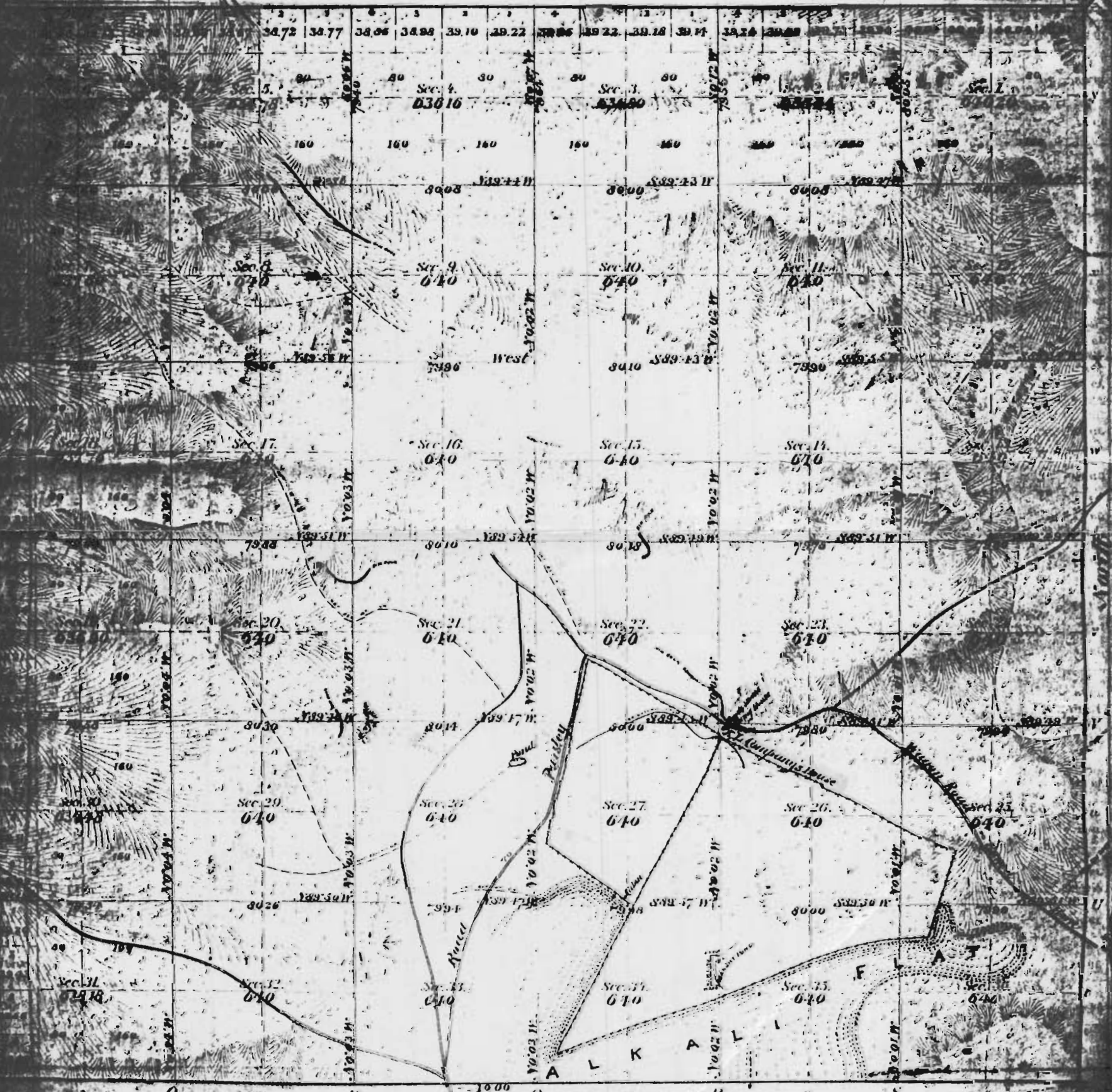

Total number of acres 23,009.18

Scale of Gunter  
 Date of Survey  
 March 1 1891

Amount of Survey		When Surveyed	Mean Declinations
M.	CK <sup>s</sup> LK <sup>s</sup>		

The above Map of Township No. 32  
 Oregon



Signed, sealed and delivered in presence of us as witnesses

Marybelle Stout  
J. L. Wells

M. A. Sutton, Seal

Olive L. Sutton, Seal

State of Oregon,  
County of Multnomah } ss.

RECEIVED

DEC 11 1897

WATER RESOURCES DEPT  
SALE & RENT

This certifies, that on this 24<sup>th</sup> day of August, A. D. 1897, before me, the undersigned, a Notary Public in and for said County and State, personally appeared the within named M. A. Sutton, and Olive L. Sutton, his wife, known to me to be the identical persons described in and who executed the within instrument, and acknowledged to me that they executed the same freely and voluntarily.

In testimony whereof, I have hereunto set my hand and seal the day and year last above written.

Filed Aug. 28, 1897, and recorded Sept. 15<sup>th</sup>  
1897, W. A. Massingill, Co. Clerk  
by J. M. Batchelder, cly

Seal  
Notary  
Public.

J. L. Wells  
Notary Public for Oregon.

The United States of America.

Desert Lands, }  
Certificate No. 139, }  
General Land Office of the }  
United States, a certificate of the Register of the Land Office at Astoria, }  
Oregon whereby it appears that full payment has been made by the said Thomas }  
P. Turner according to the provisions of the Act of Congress of the 24<sup>th</sup> of April, }  
1820, entitled an "Act making further provision for the sale of the Public }  
Lands" and the acts supplemental thereto, for the South West Quarter of the }  
North East Quarter, the South half of the North West Quarter, and the South }  
West quarter of Section Twenty seven, the East half of the South East Quarter }  
of Section Twenty eight, the North East Quarter of the North East Quarter of }  
Section Thirty three, and the North half of the North West Quarter of Section }  
Thirty four in Township Thirty two South, of Range Twenty One East }  
of Willamette Meridian in Oregon, containing Four hundred and }  
eighty acres, according to the official plat of the survey of the said }  
Lands, returned to the General Land Office by the Surveyor General, }  
which said tract has been purchased by the said Thomas P. Turner.

Now know ye, that the United States of America, in consideration of the }  
premises, and in conformity with the several acts of Congress in such }  
cases made and provided have given and granted, and by these presents do }  
give and grant unto the said Thomas P. Turner, and to his heirs, }  
the said tract above described, To have and to hold the same, together }  
with all the rights, privileges, immunities, and appurtenances of whatever }  
nature thereunto belonging, unto the said Thomas P. Turner and to his }  
heirs forever.

rights for mining, agricultural, manufacturing, or other purposes, and rights to ditches and reservoirs used in connection with such water rights as may be recognized and acknowledged by the local customs, laws and decisions of Courts, and also subject to the right of the proprietor of a vein or lode to extract and remove his ore therefrom should the same be found to penetrate or intersect the premises hereby granted, as provided by law.

In testimony whereof J. Grover Cleveland, President of the United States of America, has caused these letters to be made Patent, and the Seal of the General Land Office to be hereunto affixed.

Given under my hand at the City of Washington, the fifteenth day of January, in the year of our Lord one thousand eight hundred and ninety-seven, and of the Independence of the United States the one hundred and twenty-first.



L. G. C. Lamar,

By the President Grover Cleveland,

by M. M. Keane, Secretary,

Recorder of the General Land Office.

Recorded Vol. 3, page 209.

Filed for record in Lake County, Oregon, Sept 4, 1897, and  
 recorded Sept. 15, 1897, W. H. Massingill, Co. Clerk  
 by J. M. Batchelder, Deputy.

RECEIVED

DEC 8 1 1892

NATURAL RESOURCES DEPT.  
 SALEM, OREGON

State of Oregon

RECEIVED

DEC 8 1897

WATER RESOURCES DEPT  
SALEM, OREGON

In consideration of eight hundred Dollars paid to the Board of Commissioners for the sale of School, University, and other State Lands, the State of Oregon do hereby grant, bargain, sell and convey unto J. M. Riggs, his heirs and assigns, the following described School lands situate in Lake County, Oregon, to-wit: The South half of North East Quarter, North West Quarter of North East Quarter of Section thirty four, the South West Quarter of North West Quarter, South West Quarter of North East Quarter, East half of South West Quarter, South West Quarter of South West Quarter of Section Twenty six, Township Thirty two South, Range Twenty one East of Willamette Meridian, containing 320 acres.

To have and to hold the said premises, with their appurtenances, unto the said J. M. Riggs, his heirs and assigns forever.

Witness the seal of the State, affixed this 14<sup>th</sup> day of April, 1897.

Wm. P. Lord, Governor.

H. R. Kincaid, Secretary.

Phil Metschan, Treasurer.



State Record of Deeds, Book V, Page 372.

Filed for record April, 20<sup>th</sup> 1897.

and recorded April 21<sup>st</sup> 1897. W. A. Massingill, Clerk

by J. M. Battersby Deputy

This Indenture, made the fourth day of August, in the year of our Lord one thousand eight hundred and ninety seven, between J. M. Riggs, party of the first part, and C. W. Clark and Frederick Cox the parties of the second part, witnesseth that the said party of the first for and in the consideration of the sum of One hundred Dollars of the United States of America to him in hand paid by the said part of the second part, the receipt whereof is hereby acknowledged, do by these presents bargain, sell and convey unto the said parties of the second part all that certain lot, piece, or parcel of land situate in the County of Lake, State of Oregon, and bounded and particularly described as follows, to-wit: South half of North East Quarter, North West Quarter of North East Quarter, Sec. 34, South West Quarter of North West Quarter, South West Quarter of North East Quarter, East half of South West Quarter, South West Quarter of South West Quarter, Sec. 26, Township 32, S., Range 21 East and containing 320 acres.

Together with all the tenements, hereditaments and appurtenances therunto belonging or in any wise appertaining; and also all the estate, right, title and interest at law or equity therein or thereto, including dower and claim of dower.

To have and to hold the same to the said parties of the second part, their heirs and assigns forever. And the said party of the first part do covenant

WATER RESOURCES DEPT  
SALES DIVISION

that the said real estate is free from all incumbrance and that he will and his heirs, executors and administrators shall warrant and defend the same to the said parties of the second part, their heirs and assigns forever against the lawful claim and demands of all persons whomsoever claiming through, under or by me.

In witness whereof, the said party of the first part has hereunto set his hand and seal this seventh day of August A.D. 1895

Executed in the presence of

W. R. Steele  
J. M. Miller

J. M. Riggs (Seal)

State of Oregon }  
County of Lake } ss.

On the seventh day of August, A.D. 1895, personally came before me a Notary Public in and for said County, the within named J. M. Riggs to me personally known to be the identical person who executed the within instrument, and acknowledged to me that he executed the same freely for the uses and purposes therein named.

Witness my hand and seal this seventh day of August, A.D. 1895,

Filed for record April 20<sup>th</sup> 1897, and recorded April 21, 1897, W. A. Massingill  
by J. M. Butcher, Clerk  
Deputy



J. M. Miller  
Notary Public

State of Oregon

In consideration of Eight hundred Dollars, paid to the Board of Commissioners for the sale of School, University, and other State Lands, the State of Oregon does hereby grant, bargain, sell and convey unto W. Bowen, his heirs and assigns, the following described School lands, situate in Lake County, Oregon, to wit: The North West Quarter of North West Quarter, North East Quarter of North West Quarter of Section Twenty six, East half of North East Quarter, North West Quarter of North East Quarter, North half of North West Quarter, South West Quarter of North West Quarter of Section thirty five, Township thirty two, South, Range Twenty one East of Willamette Meridian containing 320 acres.

To have and to hold the said premises, with their appurtenances, unto the said W. Bowen, his heirs and assigns forever.

Witness the seal of the State affixed this 14<sup>th</sup> day of April, 1897.



Wm. P. Lord, Governor  
H. R. Kincaid, Secretary  
Phil. Mitschaw, Treasurer

State Record of Deeds, Book V, Page 370

Filed for record April 20, 1897, and recorded April 21, 1897, W. A. Massingill

10  
110

This Indenture made the 5<sup>th</sup> day of September, in the year of our Lord, ~~one thousand~~  
 eight hundred and ninety five, between W. Bowen of Lake County, Oregon, and  
 C. M. Clark and Fred, Cos of Sacramento, California, the parties of the second part  
 witnesseth that the said part of the first part for and in the consideration of the  
 sum of Six hundred Dollars, lawful money of the United States of America  
 him in hand paid by the said parties of the second part, the receipt whereof is  
 hereby acknowledged do by these presents bargain, sell and convey unto the said  
 parties of the second part and to their heirs and assigns, all those certain lots,  
 pieces or parcels of land situate in the County of Lake, State of Oregon, and bounded  
 and particularly described as follows, to wit:  $N 91^{\circ}$  of  $S 11^{\circ}$ ,  $N 8^{\circ}$  of  $S 11^{\circ}$ , Sec. 26  
 $E 2^{\circ}$   $N 8^{\circ}$ ,  $S 11^{\circ}$  of  $N 8^{\circ}$ ,  $N 7^{\circ}$   $S 11^{\circ}$ ,  $S 11^{\circ}$  of  $S 11^{\circ}$ , Sec. 35 T<sub>32</sub> S., Range, 21 East Will.  
 Mer, containing 320 acres;

Together with all the tenements, hereditaments, and appurtenances therunto belonging  
 or in anywise appertaining; and also all the estate, right, title and interest at  
 law or equity therein or thereto, including dower and claim of dower.

To him and to hold the same unto the said party of the second part, their heirs  
 and assigns forever. And the said party of the first part do covenant with the  
 said parties of the second part, and their legal representatives forever that the  
 said real estate is free from all incumbrances and that he will, and his heirs, exe-  
 cutors and administrators shall warrant and defend the same to the said  
 parties of the second part, their heirs and assigns forever against the  
 lawful claim and demands of all persons whomsoever

In witness whereof the said party of the first part has hereunto set his hand and  
 seal this 5<sup>th</sup> day of September, A. D. 1895.

Executed in the presence of  
 Chas. Umbach  
 Ida Umbach

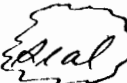
W. Bowen. 

State of Oregon  
 County of Lake.

On the 5<sup>th</sup> day of September, A. D. 1895, personally came before me, a Notary  
 Public in and for said County, the within named W. Bowen to personally know  
 to be the identical person described in, and who executed the within instrument,  
 and acknowledged to me that he executed the same freely for the uses and purposes  
 therein named.

Witness my hand and seal this 5<sup>th</sup> day of September, A. D. 1895.

Chas. Umbach  
 Notary Public

Filed for record April 20<sup>th</sup> 1897, at 2:30  
 o'clock P.M. and recorded April 21, 1897  
 N. A. Massingill, Clerk  
 S. J. Metchette, Deputy



4

111

# State of Oregon

RECEIVED  
DEC 11 1892  
WATER RESOURCES DEPT  
SALEM, OREGON

In consideration of eight hundred dollars paid to the Board of Commissioners for the sale of school, University, and other State lands, the State of Oregon does hereby grant, bargain, sell, and convey unto G. W. Duncan, his heirs and assigns, the following described school lands situate in Lake County, Oregon, to wit: The South East Quarter, the North half of North East Quarter of Section Twenty seven, the North East Quarter of North East Quarter of Section Thirty four, North West Quarter of North West Quarter of Section Twenty six, Township thirty two South, Range Twenty one East of Willamette Meridian, containing 320 acres.

To have and to hold the said premises, with their appurtenances, unto the said G. W. Duncan, his heirs and assigns forever.

Witness the Seal of the State, affixed this 14<sup>th</sup> day of April, 1897.

Wm P. Lord, Governor  
H. B. Kincaid, Secretary  
Phil. Mitschan, Treasurer



State Record of deeds, Book V, Page 373.

Filed for record April 20<sup>th</sup> 1897  
and Recorded April 21<sup>st</sup> 1897, W. A. Massingill  
Clerk  
by J. M. Batchelder, deputy.

This Indenture, made the 27<sup>th</sup> day of August, in the year of our Lord one thousand eight hundred and ninety five, between G. W. Duncan, party of the first part and C. W. Clarke and Frederick Cox, of Sacramento, Cal., parties of the second part witnesseth that the said party of the first part in the consideration of the sum of Five hundred dollars, lawful money of the United States of America, to him in hand paid by the said parties of the second part, the receipt whereof is hereby acknowledged, do by these presents bargain, sell and convey unto the said parties of the second part and to their heirs and assigns all that certain lot piece or parcel of land situate in the County of Lake, State of Oregon, and bounded and particularly described as follows, to wit:

East half of South East Quarter, West half of South East Quarter, Section 27, North East Quarter of North East Quarter Section 34, North half of North East Quarter, Section 27 and North West Quarter of North West Quarter Section 26 all in Township 32 South of Range 21 East

Together with all the tenements, hereditaments and appurtenances therunto belonging or in anywise appertaining; and also all the <sup>estate</sup> right, title, and interest at law and equity therein or thereto including dower and claim of dower.

To have and to hold the same to the said parties of the second part, their heirs and assigns forever, And the said party of the first part do

112

Warrant with the said parties of the second part and their legal representatives forever that the said real estate is free from all incumbrance, and that he will, and his heirs, executors and administrators shall warrant and defend the same to the said parties of the second part, their heirs and assigns forever against the lawful claim and demands of all person whomsoever, claiming under, through or by me.

In witness whereof the said party of the first part has hereunto set his hand and seal this 27<sup>th</sup> day of August, A.D. 1895

Executed in the presence of

J. M. Miller

Frank Lehugel

G. W. Duncan Seal

State of Oregon, }  
County of Lake. }  
Notary Public

On the 27<sup>th</sup> day of August, A.D. 1895, personally came before me a Notary Public in and for said County, the within named G. W. Duncan to me personally known to be the identical person described in and who executed the within instrument, and acknowledged to me that he executed the same freely for the uses and purposes therein named.

Witness my hand and seal this 27<sup>th</sup> day of August, A.D. 1895

Filed for record April 20<sup>th</sup> 1897 at 2:30

o'clock P.M. and recorded April 21, 1897

W. A. Massingill, Clerk

by J. M. Batcher, deputy



G. W. Duncan

Notary Public

State of Oregon

In consideration of Four hundred Dollars paid to the Commissioners for the sale of School, University and other State lands, the State of Oregon does hereby grant, bargain sell and convey unto J. A. Fitzpatrick, his heirs and assigns, the following described School lands situate in Lake County, Oregon, to wit: The North East Quarter of North East Quarter, West half of North East Quarter, South East Quarter of North West Quarter of Section Twenty-eight, Township Thirty-two South, Range Twenty-one East of Willamette Meridian, containing 160 acres.

To have and to hold the said premises, with their appurtenances, unto the said J. A. Fitzpatrick, his heirs and assigns forever.

Witness the Seal of the State, affixed this 14<sup>th</sup> day of April, 1897.

Wm. P. Lord, Governor

A. R. Mcneaid, Secretary

Phil. Metsehan, Treasurer



State Record of Deeds, Book I, Page 374.

Filed for record April 20, 1897 and recorded

April 22, 1897

W. A. Massingill, Clerk

by J. M. Batcher, deputy

RECEIVED

DEC 31 1992

WATER RESOURCES DEPT  
SALEM, OREGON



113 7

This Indenture made the eighth day of November in the year of our Lord, one thousand eight hundred and ninety five between J. A. Fitzpatrick, party of the first part and C. W. Clarke and Frederick Cox the parties of the second part, Witnesseth that the said party of the first part for and in the consideration of the sum of Two hundred Dollars, lawful money of the United States of America, to him in hand paid by the said parties of the second part, the receipt whereof is hereby acknowledged, do bargain, sell and convey unto the said parties of the second part, and to their heirs and assigns, all that certain lot, piece, or parcel of land situate in the County of Lake, State of Oregon, and bounded and particularly described as follows, to wit: North East Quarter of North East Quarter, West half of North East Quarter, and South East Quarter of North West Quarter, all in Section Twenty eight (28) Township 32 S. Range 21 East, containing 160 acres.

Together with all the tenements, hereditaments and appurtenances therunto belonging or in anywise appertaining; and also all the estate, right, title and interest, at law or in equity therein or thereto, including dower and claim of dower, To have and to hold the same to the said parties of the second part, their heirs and assigns forever. And the said party of the first part do covenant with the said parties of the second part and their legal representatives forever, that the said real estate is free from all incumbrance, and that he will and his heirs, executors and administrators shall warrant and defend the same to the said parties of the second part, their heirs and assigns forever against the lawful claim and demands of all persons whomsoever, against all persons claiming under, by, or through him.

In Witness whereof the said party of the first part has hereto set his hand and seal this eighth day of November, 1895.

Executed in the presence of  
J. M. Miller  
J. M. Green

J. A. Fitzpatrick 

State of Oregon, }  
County of Lake } ss.

On the eighth day of November, A.D. 1895 personally came before me, a Notary Public in and for said County, the within named J. A. Fitzpatrick, to me personally known to be the identical described in and who executed the within instrument, and acknowledged to me that he executed the same freely for the use and purposes therein named

Witness my hand and seal this eighth day of November, A.D. 1895,  
J. M. Miller

Notary Public



Filed for record April 20<sup>th</sup> 1897, at 2-30 o'clock P.M. and recorded April 22, 1897.

W. A. Massingill  
Clerk  
by J. M. Butchelder, Deputy

RECEIVED  
DEC 31 1892  
WATER RESOLVED  
SALEM, OREGON

State of Oregon,

114

In consideration of One hundred Dollars paid to the Board of Commissioners for the sale of School, University and other State lands, the State of Oregon does hereby bargain, sell, and convey unto Mattie Green, her heirs and assigns, the following described School lands situate in Lake County Oregon, to-wit: The South West Quarter of South East Quarter of Section thirty three Township thirty two South, Range Twenty one East of Willamette Meridian, containing 40 acres.

To have and to hold the said premises, with their appurtenances, unto the said Mattie Green her heirs and assigns forever.

Witness the seal of the State, affixed this 14<sup>th</sup> day of April, 1897.

Wm P. Lord, Governor  
H. H. Mearns, Secretary  
Phil. Metcalf, Treasurer



State Record of Deeds, Book V, Page 375.

Filed for Record April 21, 1897

and recorded April 22, 1897, W. A. Manningill, Clerk  
by J. M. Batchelder, Deputy.

This Indenture, made the fifteenth day of January in the year of our Lord One thousand eight hundred and ninety seven, between Mattie Green, the party of the first part, and Fred. Cox and C. W. Clarke, the parties of the second part, witnesseth that the said party of the first part for and in the consideration of the sum of One hundred (\$100.00) Dollars of the United States of America, to her in hand paid by the said parties of the second part, the receipt whereof is hereby acknowledged, do by these presents bargain, sell and convey unto the said parties of the second part, and to their heirs and assigns, all that certain lot, piece or parcel of land, situate in the County of Lake, State of Oregon, and bounded and particularly described as follows, to-wit: The South West Quarter (SW 1/4) of South East Quarter (SE 1/4) of Section number thirty three (33), in Township Thirty two (32) South, of Range Twenty one East of the Willamette Meridian.

Together with all the tenements hereditaments, and appurtenances thereunto belonging or in any wise appertaining; and also all the estate, right, title, and interest at Law and equity therein or thereto, including dower and claim of dower.

To have and to hold the same to the said parties of the second part, their heirs and assigns forever. And the said party of the first part does covenant with the said parties of the second part, their heirs, and their legal representatives forever that the said real estate is free from all incumbrance, and that she will and her heirs, executors and administrators shall warrant and defend the same to the said parties of the second part, their heirs and assigns forever against the lawful claim and demands of all persons whomsoever.

RECEIVED  
DEC 31 1892  
MAYOR RESOLUTIONS DE  
SALEM, OREGON

In Witness whereof the said party of the first part has hereunto set her hand and seal this fifteenth day of January, 1897.

Executed in the presence of  
J. M. Miller  
J. P. Light

Hattie Greene 

State of Oregon,  
County of Lake, } ss.

On the thirteenth day of February, A.D. 1897, personally came before me, a Notary Public in and for said County, the within named Hattie Greene, to me personally known to be the identical person described in and who executed the within instrument, and acknowledged to me that she executed the same for the purposes and uses therein named.

Witness my hand and seal this 13<sup>th</sup> day of February, A.D. 1897.

Filed for record April 21<sup>st</sup> at 9 o'clock  
A.M. and recorded April 22, 1897, W. A. Masingill  
Clerk



J. M. Miller  
Notary Public

by J. M. Batchelder, Deputy

State of Oregon

In consideration of Six hundred Dollars paid to the Board of Commissioners for the sale of School University and other State Lands, the State of Oregon does hereby grant, bargain, sell and convey unto Mrs. Cora Green, her heirs and assigns, the following described School lands situate in Lake County, Oregon, to wit: The South East Quarter, the South East Quarter of the North West Quarter of Section Twenty six, South East Quarter of North East Quarter of Section Twenty seven, Township thirty two South, Range Twenty one East of Willamette Meridian containing 240 acres

To have and to hold the said premises, with their appurtenances unto the said Mrs. Cora M. Green, her heirs and assigns forever

Witness the seal of the State, affixed this 14<sup>th</sup> day of April, 1897.

W. P. Lord, Governor  
A. R. Kucaid, Secretary  
Phil. Metschau, Treasurer



State Record of Deeds, Book V, Page 371.

Filed for record April 21, 1897 and  
recorded April 22<sup>nd</sup> 1897.

W. A. Masingill, Clerk  
by J. M. Batchelder, Deputy

RECEIVED  
MAY 1 1897  
NOTARY PUBLICS DEPT.  
SALEM, OREGON

This Indenture, made the 20<sup>th</sup> day of Apr, in the year of our Lord one thousand eight hundred and ninety seven between Cora Green and F. M. Green, her husband, the parties of the first part and, Frederick Cox and C. W. Clarke the parties of the second part, Witnesseth that the said parties of the first part for and in the consideration of the sum of six hundred Dollars of the United States of America, to them in hand paid by the said parties of the second part the receipt whereof is hereby acknowledged, do by these presents, bargain sell and convey unto the said parties of the second part, and to their heirs and assigns, all those certain lots, pieces or parcels of land, situate in the County of Lake, State of Oregon, and bounded and particularly described as follows, to-wit: The South East Quarter, the North East Quarter, of North West Quarter of Section No. Twenty six, South East Quarter of North East Quarter of Section Twenty seven, in Township thirty two, South of Range Twenty one East of Willamette Meridian.

Together with all the tenements, hereditaments and appurtenances therunto belonging or in anywise appertaining; and also all the estate, right, title and interest at law and equity therein or thereto, including dower and claim of dower.

To have and to hold the same to the said parties of the second part, their heirs and assigns forever. And the said parties of the first part do covenant with the said parties of the second part and their legal representatives forever that the said real estate is free from all incumbrance, and that they will and their heirs, executors and administrators shall warrant and defend the same to the said parties of the second part, their heirs and assigns forever, against the lawful claim and demands of all persons whomsoever claiming under through, or by us, or either of us.

In Witness whereof the said parties of the first part have hereunto set their hands and seals this 20<sup>th</sup> day of April, 1897.

Executed in the presence of  
F. M. Miller  
Robert McKee

F. M. Green *seal*  
Cora Green *seal*

State of Oregon }  
County of Lake } *ad.*

On the 20<sup>th</sup> day of April, A.D. 1897, personally came before me, a Notary Public in and for said County, the within named Cora Green and F. M. Green, her husband, to me known to be the identical persons described in and who executed the within instrument, and acknowledged to me that they executed the same freely for the uses and purposes therein named.

Filed for record Apr. 21<sup>st</sup> 1897, at 2 o'clock P.M.  
and recorded Apr. 22, 1897. N. A. Macneil  
Notary



F. M. Miller  
Notary Public