

**STATE OF OREGON  
WATER RESOURCES DEPARTMENT**

RECEIPT # **95783**

3850 PORTLAND ROAD NE  
SALEM, OR 97310  
378-8455/378-8130 (FAX)

RECEIVED FROM: Hollis and Dan Mad  
BY: \_\_\_\_\_

APPLICATION	
PERMIT	
TRANSFER	

CASH:  CHECK: #  96-292 OTHER: (IDENTIFY)

TOTAL REC'D \$ 200.00

**01-00-0 WRD MISC CASH ACCT**

842.010	ADJUDICATIONS	\$ <u>200.00</u>
831.087	PUBLICATIONS/MAPS	\$
830.650	PARKING FEES Name/month	\$
_____	OTHER: (IDENTIFY)	\$

**REDUCTION OF EXPENSE**

CASH ACCT. \$ \_\_\_\_\_

COST CENTER AND OBJECT CLASS

VOUCHER # \_\_\_\_\_

**03-00-0 WRD OPERATING ACCT**

**MISCELLANEOUS:**

840.001	COPY FEES	\$
850.200	RESEARCH FEES	\$
880.109	MISC REVENUE: (IDENTIFY)	\$
520.000	OTHER (P-6): (IDENTIFY)	\$

**WATER RIGHTS:**

842.001	SURFACE WATER	EXAM FEE	842.002	RECORD FEE
842.003	GROUND WATER	\$	842.004	\$
842.005	TRANSFER	\$	842.006	\$

**WELL CONSTRUCTION**

842.022	WELL DRILL CONSTRUCTOR	EXAM FEE	842.023	LICENSE FEE
842.016	WELL DRILL OPERATOR	\$	842.019	\$
_____	LANDOWNER'S PERMIT	\$	842.024	\$

**06-00-0 WELL CONST START FEE**

842.013	WELL CONST START FEE	\$	CARD #	
_____	MONITORING WELLS	\$	CARD #	

**45-00-0 LOTTERY PROCEEDS**

864.000	LOTTERY PROCEEDS	\$
---------	------------------	----

**07-00-0 HYDRO ACTIVITY**

LIC NUMBER

842.011	POWER LICENSE FEE(FW/WRD)		\$
842.115	HYDRO LICENSE FEE(FW/WRD)		\$
_____	HYDRO APPLICATION		\$

RECEIPT # **95783**

DATED: 12/31/92 BY: C. Engel

SURFACE WATER REGISTRATION CHECKLIST

(received after July 18, 1990)

CHECK BASIN MAP DNF NAME SOUTH COAST # 17 UNADJUDICATED AREA ? OK DWP  
RECEIPT # 95783 S W R NUMBER 432  
CHECK ENCLOSURES DWP PRELIMINARY DATA BASE ENTRY DWP  
ACKNOWLEDGEMENT LETTER DNF ENTER ON STREAM INDEX \_\_\_\_\_  
CHECK QUADRANGLE MAP \_\_\_\_\_ CHECK GLO PLATS \_\_\_\_\_  
WATERMASTER CHECKLIST \_\_\_\_\_ PUBLIC NOTICE PUBLICATION Jan

FORM REVIEW

blanks filled in  
 signed  
 date received stamped

MAP REVIEW

source and trib  
 diversion point location  
 conveyances (pipes, ditch, etc.)  
 place of use  
 scale  
 township, range, section  
 north arrow  
 CWRE stamp  
 disclaimer  
 date survey was performed  
 P.O.B. of survey  
 dimensions and capacity of diversion system  
 "beneficial use" type title  
 "permanent-quality" paper

WATER RIGHT RECORD CHECK \_\_\_\_\_ FIELD INSPECTION \_\_\_\_\_  
FINAL FILE REVIEW \_\_\_\_\_ FINAL DATA BASE ENTRY \_\_\_\_\_  
ENTER ON PLAT CARDS \_\_\_\_\_

January 12, 1995

EDWARD RILEY  
PO BOX 630  
NORTH BEND OR 97459

re: SWR-432

Dear Mr Riley,

I completed the review of the map and site report received from you on Sept. 30, 1994 in support of the pre-1909 vested water right claim in the name of HOLLIS AND ANNA MAST. The map and report meet the requirements for filing. I have added them to the file.

Thank you for your attention to this matter. If you have any questions, please give me a call.

Sincerely,



Don Knauer  
Adjudication Specialist

j:\wsl\cl4\swr-0432.005



Commerce Building  
158 12th Street NE  
Salem, OR 97310-0210  
(503) 378-3739  
FAX (503) 378-8130

October 10, 1994

WATER  
RESOURCES  
DEPARTMENT

EDWARD RILEY  
PO BOX 630  
NORTH BEND OR 97459

RE: swr-432

Dear Mr. Riley,

This will acknowledge the receipt of the map you submitted in support of the pre-1909 claim by the Masts. I will not be able to review the returned maps at this time. I have been assigned to do other work. In the future, the map and other data will be reviewed.

I do note that you have shown irrigation on the map and your report. The only use claimed on the SWR form is stockwater. The irrigation is not part of this claim.

If you have any questions, please give me a call.

Sincerely,

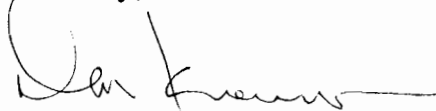

Don Knauer  
Adjudication Specialist

cc: Hollis Mast

j:\wp51\swr\claimant\4\swr-0432.004



Commerce Building  
158 12th Street NE  
Salem, OR 97310-0210  
(503) 378-3739  
FAX (503) 378-8130

November 18, 1993

HOLLIS & ANNA MAST  
HC 83 # 2470  
COQUILLE OR 97423

RE: SWR-432

Dear Mr & Mrs Mast,

I am sending a copy of the letter I sent to Edward Riley, CWRE on April 14, 1993. I have not heard anything from him or you in regards to the required map to support your pre-1909 vested water right claim. I am in the process of reviewing the maps and will pass your file by at this time. I cannot complete my review without the required map. You must send me a map submission date.

If you have any questions, please give me a call. In Oregon a toll free number is 1-800-624-3199.

Sincerely,

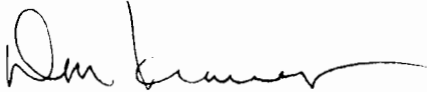

Don Knauer  
Adjudication Specialist

CC: EDWARD RILEY

M:\WP51\SWR\432.0031-

J: WP51\SLC\4\432.003



April 14, 1993

EDWARD W RILEY, CWRE  
PO BOX 630  
NORTH BEND OR 97459

RE: Surface Water Registration Map

Dear MR RILEY,

HOLLIS MAST has indicated to the Oregon Water Resources Department (WRD) that you have been hired to prepare the claim of beneficial use map for their Surface Water Registration Statement. Would you please inform me of your anticipated schedule of map preparation and submission to the WRD.

Please mark all correspondence related to this claim with the file number SWR-498.

Sincerely,

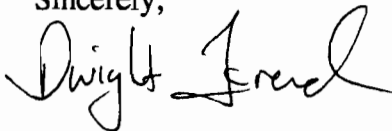

Don Knauer  
Adjudication Specialist

C:\WP51\SWR\CLAIMANT\SWR-0498.002



---

3850 Portland Rd NE  
Salem, OR 97310  
(503) 378-3739  
FAX (503) 378-8130

April 2, 1993

HOLLIS C AND ANNA A MAST  
HC 83 #2470  
COQUILLE OR 97423

Dear HOLLIS AND ANNA MAST,

This will acknowledge that your Surface Water Registration Statement in the name of HOLLIS C AND ANNA A MAST has been received by our office. The fees in the amount of \$200 have been received and our receipt #95783 is enclosed. Your registration statement has been numbered SWR-432.

The map you submitted with your claim is not acceptable. ORS 539.240 (2) (d) requires the map be prepared by a Certified Water Right Examiner (CWRE). Within 60 days of this letter you must send a letter to this address indicating you have contracted with a CWRE to prepare your map. You should send your letter to my attention. In your letter you must identify the name of the CWRE who will prepare your registration statement map. We will contact the CWRE to arrange a map submittal deadline.

We will not be able to process you claim until we have received your map. If you have any questions regarding this process, please do not hesitate to give me a call.

Please feel free to contact this office if you have any questions.

Sincerely,

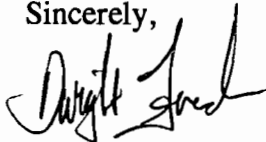

Dwight French  
Adjudication Section

Enclosure

J:\WP51\SWR\CLAIMANT\4\SWR-0432.001



3850 Portland Rd NE  
Salem, OR 97310  
(503) 378-3739  
FAX (503) 378-8130

CLAIM OF BENEFICIAL USE AND SITE REPORT - SWR-432

PERMITTEE: Mr. and Mrs. Hollis Mast  
HC 83 #2470  
Coquille, OR 97423

There are no deviations from the original applications Permit #22053 dated June 30, 1953, and application #39616, Permit #29476 which was filed after June 30, 1953.

SOURCES:

Diversion Point #1	227.78' North 824.39' East of West 1/4 Corner, Section 1, T28S, R12WWM
Diversion Point #2	2100.01' South 615.02' East of West 1/4 Corner, Section 1, T28S, R12WWM
Diversion Point #3	612.43 South 694.65' West of West 1/4 Corner, Section 1, T28S, R12WWM

Water usage from these three sources dates back to 1873 on the Coquille River and 1890 on the unnamed creek. Water was primarily for watering stock, field irrigation and domestic use.

EQUIPMENT:

Diversion Point #1 - Coquille River

240 GPM pump	Myers Model 20HM15
15 HP Electric Motor	7" Impeller Serial No. M1650
1000' 5" Pipe	

Diversion Point #2 - Coquille River

300 GPM Pump	Myers Model 25HM20
20 HP Electric Motor	7" Impeller M1602
1420'-6" Pipe	
1000'-5" Pipe	
1070'-3" Pipe	

Diversion Point #3 - Unnamed Creek

Gravity Feed 1" line to watering troughs 2,000 feet.

**RECEIVED**

SEP 30 1994

WATER RESOURCES DEPT.  
SALEM, OREGON



The final proof survey and inspection of the use as found to be completed under the terms and conditions of the permits #22053 and #29476 was completed by me on September 26, 1994 and the facts contained in this report and accompanying final proof map are correct to the best of my knowledge.



**Certified Water Rights Examiner**

We, Hollis C. and Anna A. Mast agree to the findings of the CWRE and do submit this site report and map as my Claim of Beneficial Use of the water as provided under the terms and conditions of my Permits #22053 and #29476.

*Hollis C. Mast*  
\_\_\_\_\_  
Hollis C. Mast

*Anna A. Mast*  
\_\_\_\_\_  
Anna A. Mast

Date 9-29-94

**RECEIVED**  
SEP 30 1994  
WATER RESOURCES DEPT.  
SALEM, OREGON

Mast#1.CBU(Claim of Beneficial Use)



**edward w. riley**

ARCHITECTS & ENGINEERS

planning  
building design  
municipal engineering

AIRPORT TERMINAL BUILDING  
Post Office Box 630  
North Bend, Oregon 97459  
Telephone 503 - 756-6606

September 29, 1994

State Water Resources Department  
3850 Portland Road NE  
Salem, OR 97310

Submitted herewith please find a Water Rights map and Beneficial Use Statement  
for the following:

Mr. and Mrs. Hollis Mast - SWR-178  
HC 83 #2470 [REDACTED]  
Coquille, OR 97423

Edward W. Riley - CWR #112

EWR/lb

**RECEIVED**

SEP 30 1994

WATER RESOURCES DEPT.  
SALEM, OREGON

RECEIVED

APR 14 1993

WATER RESOURCES DEPT.  
SALEM, OREGON

H.C. 83 #2470  
Coquille, OR 97423  
April 9, 1993

Oregon Water Resources Department  
3850 Portland Rd NE  
Salem, OR 97310

Att: Dwight French  
Re: Surface Water Registration # SWR-432

Edward Riley, North Bend Airport Terminal Building, North  
Bend, OR 97459 has been contracting for mapping this  
account.

Sincerely

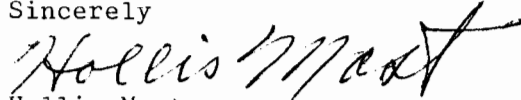

Hollis Mast

Hollis Mast

RECEIVED

LOCATION OF ~~ACR PRACTICES~~  
Program Year \_\_\_\_\_

Water Use and  
Diversion  
A-G-F Farm No \_\_\_\_\_

Operator Hollis Mast

County COOS

Section land 2 Township 28 S. Range 12 W. W.M. Aerial Photo No. COB-3A-9

RECEIVED

DEC 31 1992

WATER RESOURCES DEPT.  
SALEM, OREGON

Tracing  
Scale: 1 in. = 660 ft. 1/4 cor.

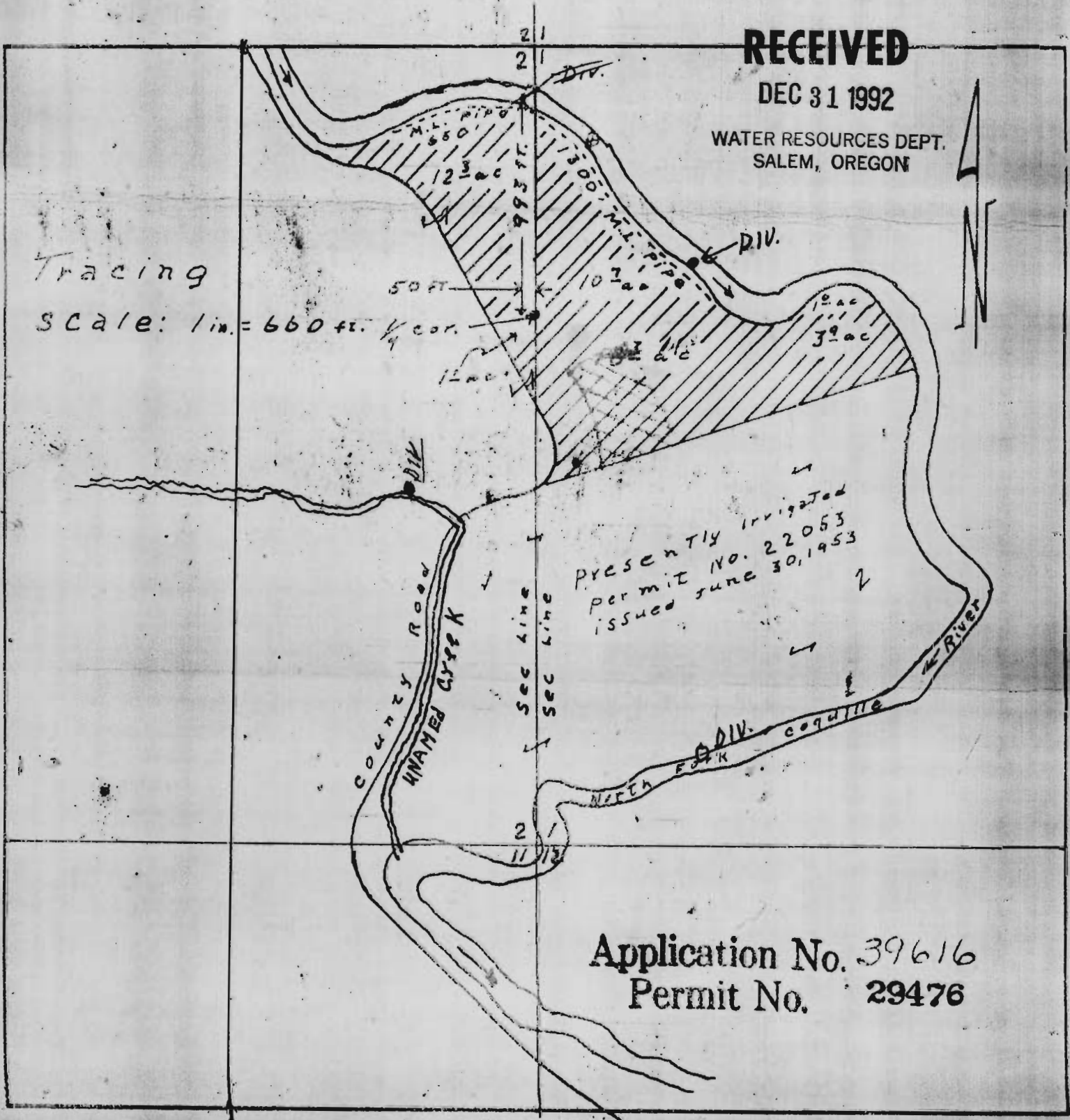

Application No. 39616  
Permit No. 29476