

# CLAIM OF BENEFICIAL USE MAP

TO ADD PLACE OF USE FOR STORAGE  
PER APPLICATION R-36326  
OREGON DEPARTMENT OF STATE LANDS

Rev. 10  
OCT 27 2025

NE 1/4 SECTION 27, TOWNSHIP 27 SOUTH, RANGE 24 EAST, W.M.  
TAX LOT: 100, HARNEY COUNTY, OREGON

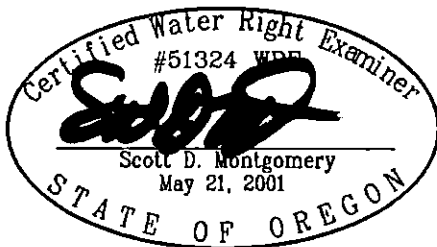
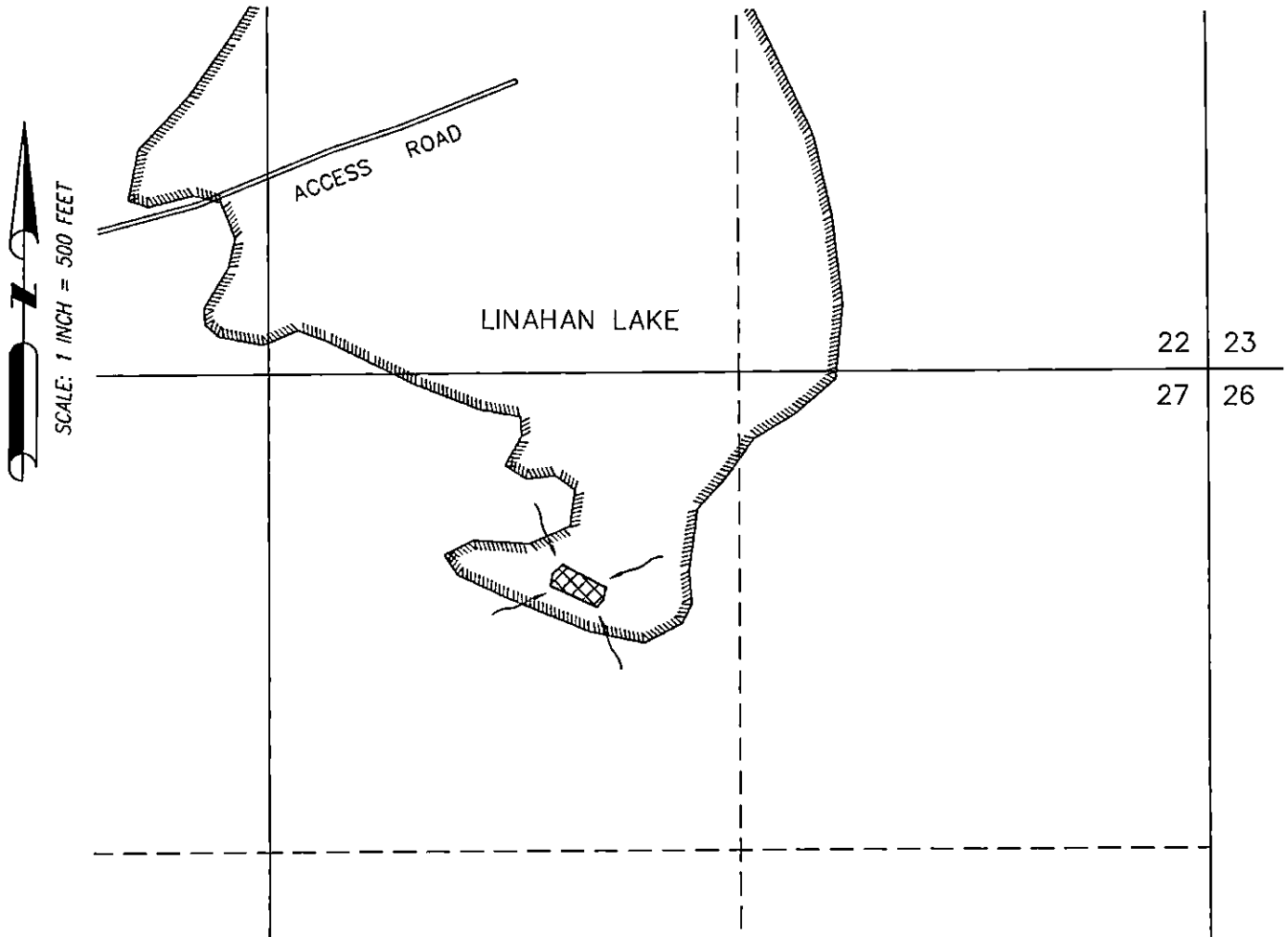

RENEWAL DATE: 12/31/2026

## SLOPPY

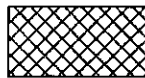

0.3 ACRE-FEET STO WITHIN NW  
1/4 NE 1/4 SECTION 27 FROM  
SEASONAL RUNOFF, AS SHOWN.

POD AT CENTER OF PIT IS LOCATED 600' S  
& 1760' W FROM NE CORNER OF SECTION 27.

THIS MAP IS FOR THE PURPOSE OF LOCATING A WATER RIGHT ONLY AND HAS NO  
INTENT TO PROVIDE LEGAL DIMENSIONS OR THE LOCATION OF PROPERTY LINES.

PREPARED FOR:

OREGON DEPARTMENT OF STATE LANDS  
775 SUMMER STREET NE #100  
SALEM, OR 97301

PREPARED BY:



ALL POINTS ENGINEERING AND SURVEYING, INC.  
P.O. BOX 767 TERREBONNE, OR 97760  
(541) 548-5833  
[www.APEandS.com](http://www.APEandS.com)