

CLAIM OF BENEFICIAL USE MAP

TO ADD PLACE OF USE FOR STORAGE
PER APPLICATION R-36304
OREGON DEPARTMENT OF STATE LANDS

NE 1/4 SECTION 4, TOWNSHIP 28 SOUTH, RANGE 24 EAST, W.M.
TAX LOT: 400, HARNEY COUNTY, OREGON

Recorded

OCT 27 2025

04475

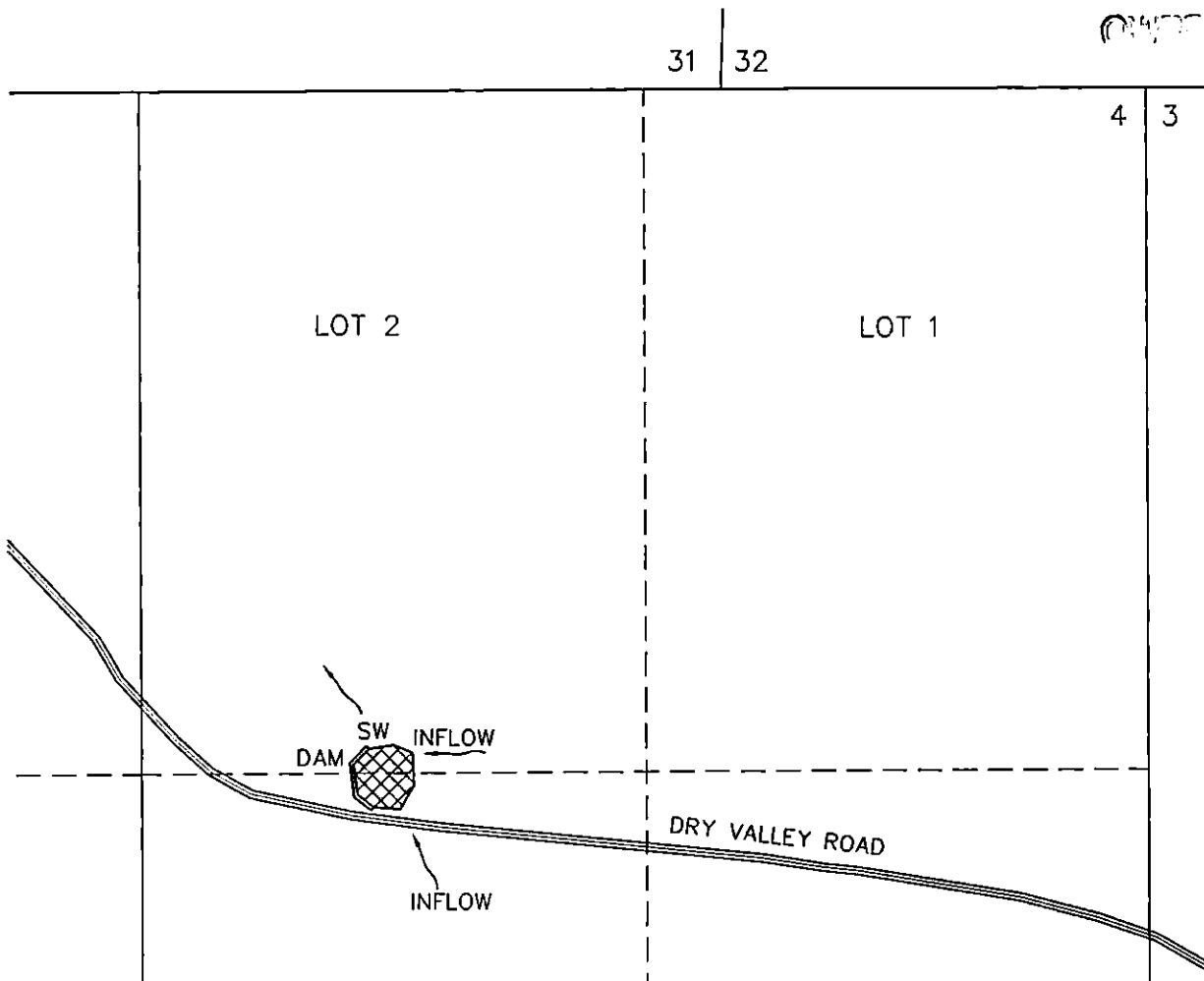

SCHRODER #2



2.0 ACRE-FEET STO WITHIN W
1/2 NE 1/4 SECTION 4 FROM
SEASONAL RUNOFF, AS SHOWN.

POD AT CENTER OF DAM IS LOCATED 1765' S
& 2115' W FROM NE CORNER OF SECTION 4.

THIS MAP IS FOR THE PURPOSE OF LOCATING A WATER RIGHT ONLY AND HAS NO
INTENT TO PROVIDE LEGAL DIMENSIONS OR THE LOCATION OF PROPERTY LINES.

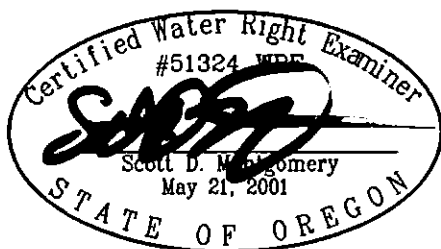

RENEWAL DATE: 12/31/2026

PREPARED FOR:

OREGON DEPARTMENT OF STATE LANDS
775 SUMMER STREET NE #100
SALEM, OR 97301

PREPARED BY:



ALL POINTS ENGINEERING AND SURVEYING, INC.
P.O. BOX 767 TERREBONNE, OR 97760
(541) 548-5833
www.APEandS.com