

**RECEIVED**

JAN 14 1994

WATER RESOURCES DEPT  
SALEM, OREGON

Don Knauer  
Adjudication Specialist  
Water Resources Dept.  
3850 Portland Rd NE  
Salem, Or 97310

Dear Don

Enclosed are the following corrected maps:

(1) Arita and Arlo Harwood SWR 542. I added the 1/16 lines and showed the location of the house.

(2) Jane Muffett SWR 540 and SWR 539. I added the 1/16 lines.

(3) Marcella Dailey SWR 452. I showed the location of the house.

(4) Robert and Fontella Hankins SWR 454. These questions all concern the claimed use of irrigation. Mr. Hankins claims that there was irrigation of 5 acres of potatoe fields prior to 1909 and showed me where he thought it had been. As I explained in my final proof report there is currently no irrigation at this time and no sign that there has been in the near past. There is currently no point of diversion, no conveyance system and only an estimate of the original place of use. I have changed the hatchuring on the map to a dashed line to indicate that the irrigation is not a current use. If you have any questions about this I can be reached at 759-4467 or 267-2872.

Sincerely

*Harvey Wilcox*  
Harvey Wilcox

PS: The Benson Creek Stock map is in their possession and I have asked them to send it to you. Also I am no longer an employee of Stuntzner Engineering. I have started my own business called Wilcox Land and Forestry Services, 759-4467, 3190 N. Lake Rd Lakeside, Or 97449. I can also be reached at Stuntzner Engineering as I finish up work that I have started for them.

THE UNITED STATES OF AMERICA.

Homestead Certificate No. 220 }  
Application 1118 }

To all to Whom these Presents shall Come—GREETING:

WHEREAS, There has been deposited in the General Land Office of the United States a Certificate of the Register of the Land Office at Roseburg, Oregon whereby it appears that, pursuant to the Act of Congress approved 20th May, 1862, "To Secure Homesteads to Actual Settlers on the Public Domain," and the acts supplemental thereto, the claim of Miriam Koepke, widow of Fritz Koepke has been established and duly consummated, in conformity to law, for the Northwest quarter of the northwest quarter, and the west half of the northwest quarter - section thirty four in Township Twenty, South of Range ten west of the Willamette Meridian Oregon, containing one hundred twenty acres.

RECEIVED  
DEC 31 1992  
WATER RESOURCES DEPT  
SALEM, OREGON

according to the Official Plat of the Survey of the said Land, returned to the General Land Office by the Surveyor General.

NOW, KNOW YE, That there is, therefore, granted by the United States unto the said

Miriam Koepke,

the tract of land above described:

TO HAVE AND TO HOLD THE SAID TRACT OF LAND, with the appurtenances thereof, unto the said

Miriam Koepke,

and to her heirs

and assigns forever, subject to any vested and accrued water rights for mining, agricultural, manufacturing or other purposes, and rights to ditches and reservoirs used in connection with such water rights, as may be recognized and acknowledged by the local customs, laws and decisions of Courts, and also subject to the right of the proprietor of a vein or lode, to extract and remove his ore therefrom, should the same be found to penetrate or intersect the premises hereby granted, as provided by law, and there is reserved from the lands hereby granted a right of way thereon for ditches or canals constructed by the authority of the United States.

IN TESTIMONY WHEREOF, I, Charles D. Rossell President of the United States of America, have caused these letters to be made Patent, and the Seal of the General Land Office to be hereunto affixed.



Given under my hand, at the City of Washington, the twenty-fifth day of May, in the year of our Lord one thousand one hundred and eighty, and of the Independence of the United States the one hundred and thirty-second.

BY THE PRESIDENT: Charles D. Rossell

By A. S. Stamp Secretary.

Recorded Vol. 778 Page 279 H. W. Sanford Recorder of the General Land Office.

Filed for Record at Portland N. August 10 A. D. 1908, and recorded at the request of

By R. C. Noel Deputy. E. N. Leno Co. Clerk

Recorded July 20 18  
J. W. Benson Co. Clerk  
J. S. Depuean Deputy

United States vs P. P. Simmons

33/118

Recorded

By

The United States of America.

To all to whom these presents shall come greeting.

Whereas there has been deposited in the General Land office of the United States a Certificate numbered one thousand one hundred and ninety eight of the Register and receiver at Roseburg Oregon whereby it appears that under the provisions of the act of Congress approved the 27th day of September 1850 entitled an act to create the office of surveyor general of the Public Lands in Oregon and to provide for the survey and to make donations to settlers of the said public lands and the legislation supplemental thereto the claim of P. P. Simmons of Umpqua County Oregon Application No. 1200. has been established to a donation of one quarter section or one hundred and sixty acres of land and that the same has been surveyed and designated according to the official plat of survey returned to the General Land Office by the Surveyor General, as Lot two of Section twenty eight, Lot two of section twenty seven Lots six seven and eight of section thirty three and Lots one, two, four, five and six of section thirty four all in township twenty south of Range ten west in the district of lands subject to sale at Roseburg Oregon containing one hundred and twenty nine acres and twenty hundredths of an acre.

Now know ye that the United States of America in consideration of the premises, and in conformity with the provisions of the act aforesaid have given and granted and by these presents do give and grant unto the said P. P. Simmons and to his heirs the tract of land above described to have and to hold the said tract with the appurtenances unto the said P. P. Simmons and to his heirs and assigns forever.

In testimony whereof I Myself President of the United States have caused these letters to be made patent, and the seal of the General Land Office to be hereunto affixed.

Given under my hand at the City of Washington this twenty third day of January in the year of our Lord one thousand eight hundred and seventy four

29.020

a  
C  
6  
one  
two  
three  
four  
five  
six  
seven  
eight  
nine  
ten  
eleven  
twelve  
thirteen  
fourteen  
fifteen  
sixteen  
seventeen  
eighteen  
nineteen  
twenty  
twenty one  
twenty two  
twenty three  
twenty four  
twenty five  
twenty six  
twenty seven  
twenty eight  
twenty nine  
thirty  
thirty one  
thirty two  
thirty three  
thirty four  
thirty five  
thirty six  
thirty seven  
thirty eight  
thirty nine  
forty  
forty one  
forty two  
forty three  
forty four  
forty five  
forty six  
forty seven  
forty eight  
forty nine  
fifty  
fifty one  
fifty two  
fifty three  
fifty four  
fifty five  
fifty six  
fifty seven  
fifty eight  
fifty nine  
sixty  
sixty one  
sixty two  
sixty three  
sixty four  
sixty five  
sixty six  
sixty seven  
sixty eight  
sixty nine  
seventy  
seventy one  
seventy two  
seventy three  
seventy four  
seventy five  
seventy six  
seventy seven  
seventy eight  
seventy nine  
eighty  
eighty one  
eighty two  
eighty three  
eighty four  
eighty five  
eighty six  
eighty seven  
eighty eight  
eighty nine  
ninety  
ninety one  
ninety two  
ninety three  
ninety four  
ninety five  
ninety six  
ninety seven  
ninety eight  
ninety nine  
one hundred

Christian Pyritz & wife } This Indenture Witnesseth, That we Christian  
 Pyritz and Christiane Pyritz his wife, for  
 the consideration of sixty- (60) Dollars to us  
 paid, have bargained and sold and by these presents do bargain and  
 sell unto Frederick Koepke the following described premises  
 to-wit: A portion of the N E 1/4 of the S W 1/4 of Section 34, T. 20. S. 35. R. 10 W. and more particularly described as follows. Commencing  
 on a gulch about 20 yds east of the line between the N E 1/4 and  
 N W 1/4 of the S W 1/4 of S. 35. T. 20. S. R. 10 W. running thence in an  
 Easting direction along Smiths River to the line between the N E 1/4 of the  
 S 1/4 and the N W 1/4 of the S E 1/4 of S. 35. T. 20. S. R. 10 W. thence North to the  
 1/2 sec line of S. 35. thence West along said 1/2 sec line to the gulch afore-  
 said, thence in a southerly direction down said gulch to the river and  
 to the place of beginning and containing near 8 acres of land being in  
 the N E 1/4 of the S W 1/4 of S. 35. T. 20. S. R. 10 W. and situated in Douglas  
 County - State of Oregon. To Have and to Hold. The said premises with  
 their appurtenances unto the said Frederick Koepke his heirs and  
 assigns forever. And the said Christiane Pyritz and Christiane  
 Pyritz do hereby covenant to and with the said Frederick Koepke  
 his heirs and assigns, that they are the owners in fee simple of said  
 premises that they are free from all incumbrances, and that they  
 will warrant and defend the same, from all lawful claims whatsoever.  
 In witness whereof we have set our hands and seal, this 14th day  
 of November A. D. 1879.

Given in Presence of  
 M. W. McLean  
 John E. McLean  
 Christiane Pyritz  
 Christiane Pyritz

State of Oregon } Acknowledgment  
 County of Douglas ss

On this 14th day of November A. D. 1879, person-  
 ally came before me one M. W. McLean Notary Public in and  
 for said County, the within named Christiane Pyritz and  
 Christiane Pyritz his wife, to me personally known to be the parties  
 herein described in and who executed the foregoing Conveyance  
 and acknowledged to me that they executed the same freely  
 of their own volition and without duress. And the said Christiane  
 Pyritz and Christiane Pyritz separately and apart from her said husband  
 acknowledged to me that she executed the same freely and

RECEIVED

DEC 31 1992

WATER RESOURCES DEPT.  
SALEM, OREGON

CLAIM OF BENEFICIAL USE AND SITE REPORT FOR PRE 1909 VESTED  
WATER RIGHTS.

INFORMATION:

THE PERMITEE IS MARCELLA DAILEY. I TALKED TO PAUL DAILEY ON  
THE SITE. PAUL IS MARCELLA'S SON. PAUL SHOWED ME THE WATER  
SYSTEM AND THE LOCATION OF THE STOCK WATERING AREAS.

MARCELLA DAILEY  
22101 LOWER SMITH RIVER RD  
REEDSPORT, OREGON 97467

SOURCE:

THE SOURCE FOR THE DOMESTIC USE IS AN UNNAMED STREAM WHICH IS  
A TRIBUTARY OF SMITH RIVER. THE INSTREAM STOCK WATERING  
OCCURS AT VARIOUS UNNAMED STREAMS AND IN SMITH RIVER ITSELF.

DIVERSION POINT:

THE DIVERSION POINT IS A 4" METAL PIPE SET IN A CRACK IN THE  
BEDROCK OF A SMALL UNNAMED STREAM. THIS DIVERTS THE WATER 30'  
TO A 50 GALLON SETTLEMENT TANK.

MOTOR/PUMP:

THIS IS A GRAVITY SYSTEM.

PIPE

THERE IS 30' OF 4" METAL PIPE FROM THE DIVERSION POINT TO A  
50 GALLON SETTLEMENT BARREL. THERE IS 200' OF 3/4" PLASTIC  
PIPE FROM THE SETTLEMENT TANK TO A 1500 GALLON STORAGE TANK.  
THERE IS AN ADDITIONAL 90' OF 3/4" PLASTIC PIPE TO A 1000  
GALLON STORAGE TANK. THERE IS 270' OF 1 1/4" PLASTIC PIPE  
FROM THE 1500 GALLON TANK TO THE RESIDENCE FOR INHOUSE USE.  
THERE IS 180' OF 1" PLASTIC PIPE FROM THE 1000 GALLON TANK TO  
THE RESIDENCE FOR IRRIGATION OF 1/2 ACRE LAWN AND GARDEN.

HEADS

IRRIGATION OF LAWN AND GARDEN IS ACCOMPLISHED WITH A STANDARD  
5/8" GARDEN HOSE AND WAVE SPINKLER.

USES

THE WATER IS BEING USED FOR DOMESTIC HOUSEHOLD USE INCLUDING  
IRRIGATION OF LESS THAN 1/2 ACRE OF LAWN AND GARDEN.

LIFT

THE RESIDENCE IS 74' LOWER THAN THE 1500 GALLON STORAGE TANK  
AS MEASURED BY THEODOLITE AND EDM. THE MEASURED PSI AT THE  
HOUSE IS 30PSI.

CALCULATIONS

SEE THE ATTACHED CALCULATION SHEET AND NOMOGRAPH. THE SYSTEM CAPABILITY IS 0.065 CFS FOR DOMESTIC USE. THE MAXIMUM STOCK USE IS 0.006 CFS.

SURVEY TIE

THE BRASS CAP AT THE SECTION CORNER COMMON TO SECTIONS 27,28,33 AND 34 AND THE MEANDER CORNER AT THE S1/16 WERE TIED TO THE POD WITH A THODOLITE AND EDM. THE BEARING BETWEEN THE TWO CORNERS WAS CALCULATED USING SURVEY M93-28 BY HINTZ AND SURVEY M115-64 BY ROBERTS. THE BEARING BETWEEN THE CORNERS IS N ODEG 14'34" W 4034.12'. THE BEARING FROM THE SECTION CORNER TO THE POD IS S 42DEG 15' E 3028'. THE LOCATION OF THE STOCK WATERING AREAS WERE PICKED FROM THE ASSESSORS MAP

THE PRE 1909 VESTED WATER RIGHTS SURVEY AND INSPECTION OF THE USE AS FOUND TO BE COMPLETED UNDER THE CONDITIONS AND TERMS OF PRE 1909 VESTED WATER RIGHTS WAS COMPLETED BY ME ON DEC 28, 1992. THE FACTS CONTAINED ON THIS REPORT ARE CORRECT TO THE BEST OF MY KNOWLEDGE.

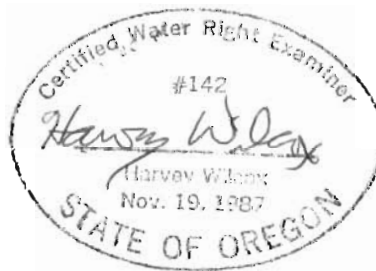

I, MARCELLA DAILEY, AGREE TO THE FINDINGS OF THE CWRE AND DO SUBMIT THIS SITE REPORT AND MAP AS MY CLAIM OF BENEFICIAL USE OF THE WATER AS PROVIDED UNDER THE TERMS AND CONDITIONS OF PRE 1909 VESTED WATER RIGHTS.

SIGNATURE Marcella Dailey



## Calculations

PSI measured at house = 30 psi  
470' of pipe from the storage tank to the house  
using the attached nomograph -

$30 \text{ psi} / 4.7 = 6.38 \text{ psi} / 100' \text{ of pipe}$   
Pipe size is  $1\frac{1}{4}"$  from the storage tank  
the nomograph gives 0.065 cfs

There are presently 36 head of cattle.  
Marcie informed me that the highest  
number of cattle is about 80

$(80 \text{ head}) (15 \text{ gal/day/head}) (1 \text{ day/hr}) (1 \text{ hr}^3 / 7.48 \text{ gal})$

$(1 \text{ hr} / 60 \text{ min}) (1 \text{ min} / 60 \text{ sec}) = \text{0.006 cfs}$

### FLOW OF WATER IN COPPER & BRASS PIPES

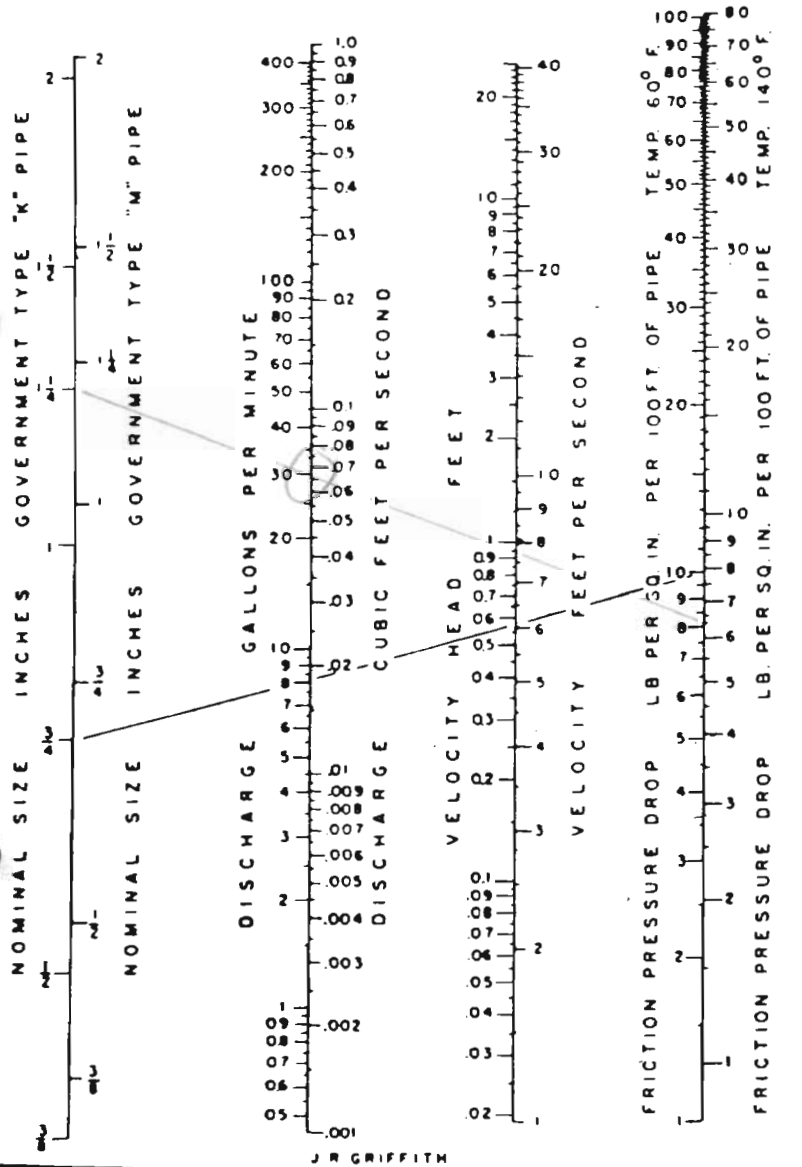

## Flow of Water in Small Pipes

3/8 to 2-in. diam.

**T**HERE have been numerous nomographic charts published for the flow of water in pipes, including four of my own. However, I have not previously seen one applicable to pipes in the smaller size ranges.

The accompanying chart is based on tabular data published by the Bridgeport Brass Co.\* Being applicable to the flow of water at temperatures both 60 deg. F. and 140 deg. F., it should be convenient in the design of building and boiler installations. It would be applicable to pipes of other material of corresponding smoothness with care being taken for corrosive waters.

Government types "K" and "M" have been included, the difference being in the wall thickness and internal diameter. The following table indicates the difference for the included sizes:

Nominal Size	Outside Dia., In.	Wall Thickness, In.	
		Type "K"	Type "M"
3/8	.500	.049	.025
1/2	.625	.049	.028
3/4	.875	.065	.032
1	1.125	.065	.035
1 1/4	1.375	.065	.042
1 1/2	1.625	.072	.049
2	2.125	.083	.058

A single straight line intersecting all scales is necessary for a solution of this chart. Any two known, or assumed, values will determine the direction of the solution line. A solution line has been drawn for the following problem:

Required to determine the discharge of water at 60 deg. F. in 3/4-in. Government type "K" copper tube for a total pressure

drop of 20 lb. per sq. in. for a 200-ft. run of pipe.

$$\text{Pressure drop} = \frac{20}{2} = 10 \text{ lb. per sq. in. per 100 ft.}$$

A line has been drawn between the pipe size and this pressure drop. The following information is then obtained from the other scales:

- Discharge = 8.2 gal. per min.
- Discharge = 0.018 cu. ft. per sec.
- Velocity = 6.1 ft. per sec.
- Velocity head = 0.57 ft.

Pressure loss for same pipe but water at 140 deg. F. would be 7.9 lb. per sq. in. per 100 ft. of pipe.

From the tables,\* Discharge = 8.2 gal. per min.

$$\text{Discharge} = \frac{8.2}{448.83} = 0.0183 \text{ cu. ft. per sec.}$$

$$\text{Area of } 3/4\text{-in. type "K" pipe} \\ A = \frac{3.1416[(0.875 - 2(0.065))^2]}{4} = 0.436 \text{ sq. in.}$$

$$\text{Area} = \frac{0.436}{144} = 0.00303 \text{ sq. ft.}$$

$$\text{Vel.} = \frac{\text{Discharge}}{\text{Area}} = \frac{0.0183}{0.00303} = 6.04 \text{ sec. ft.}$$

$$\text{Velocity head} = \frac{V^2}{2g} = \frac{6.04^2}{64.4} = 0.567$$

\* *Water Pipe Sizes*, by Walter S. Timmla, Bridgeport Brass Co., Bridgeport, Conn.

#### NOTES FOR 1967 EDITION

Not many references pertaining to small diameter tubing or pipe are available at present, particularly as regards head loss in fittings or bends. Manufac-

turers data must be consulted for these situations. It should be noted that this chart presents flow data only for straight sections of the described pipe. TJM



Section 34&35 Township 20S Range 10W W.M.

Douglas County

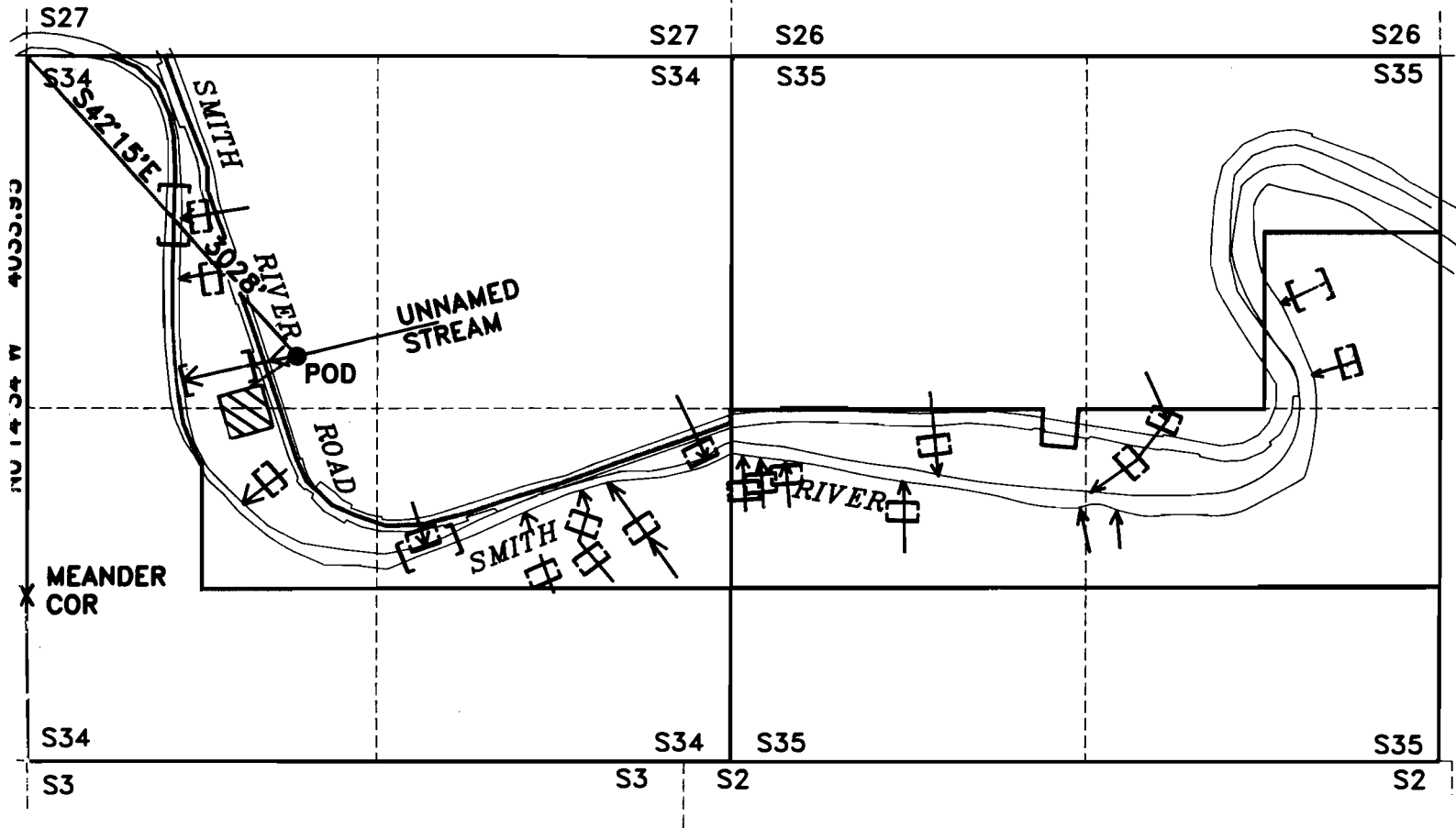

Legend

- P.O.D.
- Property Line
- Creek
- Waterline
- ▨ Home Including 1/2 acre irrigation lawn & garden
- [ ] Stock Watering



SCALE 4" = 1 MILE

EXAMINERS DISCLAIMER STATEMENT

The preparation of this map was for the purpose of identifying the location of the Water Right only and has no intent to provide dimensions or location of property ownership lines.

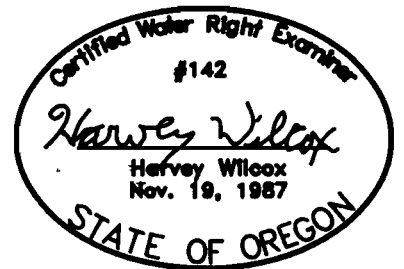

EXPIRES 12/31/94

**PRE 1909 VESTED WATER RIGHTS SURVEY**

IN THE NAME OF

Marcella Dailey

Surveyed on December 27, 1992 by H.A. Wilcox

SURFACE WATER REGISTRATION CHECKLIST

(received after July 18, 1990)

CHECK BASIN MAP Det NAME Chippewa # 16 UNADJUDICATED AREA ? yes  
 RECEIPT # 95801 S W R NUMBER 452  
 CHECK ENCLOSURES Det PRELIMINARY DATA BASE ENTRY Det  
 ACKNOWLEDGEMENT LETTER Det ENTER ON STREAM INDEX \_\_\_\_\_  
 CHECK QUADRANGLE MAP \_\_\_\_\_ CHECK GLO PLATS \_\_\_\_\_  
 WATERMASTER CHECKLIST \_\_\_\_\_ PUBLIC NOTICE PUBLICATION Det

**FORM REVIEW**

\_\_\_\_\_ blanks filled in  
 \_\_\_\_\_ signed  
 \_\_\_\_\_ date received stamped

**MAP REVIEW**

#4 ✓ source and trib  
 ✓ diversion point location  
 ✓ conveyances (pipes, ditch, etc.)  
 \_\_\_\_\_ place of use  
 ✓ scale  
 ✓ township, range, section  
 ✓ north arrow  
 ✓ CWRE stamp  
 ✓ disclaimer  
 ✓ date survey was performed  
 ✓ P.O.B. of survey  
 ✓ dimensions and capacity of diversion system  
 ✓ "beneficial use" type title  
 ✓ "permanent-quality" paper  
 ✓ 1/10th A.C.P.S.

WATER RIGHT RECORD CHECK \_\_\_\_\_ FIELD INSPECTION \_\_\_\_\_  
 FINAL FILE REVIEW \_\_\_\_\_ FINAL DATA BASE ENTRY \_\_\_\_\_  
 ENTER ON PLAT CARDS \_\_\_\_\_

January 19, 1994

HARVEY WILCOX  
3190 N LAKE ROAD  
LAKESIDE OR 97449

RE: SWR-452

Dear Mr Wilcox,

This will acknowledge the receipt of map to support the pre-1909 vested water right claim in the name of DAILEY FAMILY TRUST you returned with corrections and completions. I have added the map to the file. Thank you for your attention to this matter. If you have any questions, please give me a call.

Sincerely,



Don Knauer  
Adjudication Specialist

J:\W\S\C\4\SWR-0452.002



November 29, 1993

HARVEY WILCOX  
3190 N LAKE ROAD  
LAKESIDE OR 97449

RE: File# SWR-452

DEAR HARVEY WILCOX,

The Water Resources Department (WRD) received a little over 500 surface water registration statements in December, 1992. All of the files have been set up and receipts for the fees have been sent. The next step is to insure the maps received in support of the claims are acceptable based on Oregon Revised Statutes (ORS) and Oregon Administrative Rules (OAR).

I am returning the map you prepared for Martin and Marcella Dailey Family Trust. You will find the item which requires completion or correction shown below. I have the description followed by the ORS or OAR site and paraphrased statute or rule.

place of use (1/4 1/4)

ORS 539.240 (2) (d) (B) "The location of place of use by quarter-quarter section..." You must identify the actual location of the house with the domestic use.

You must return the map before the claim can be processed. If you cannot have the map to the WRD within 60 days, please inform me as to when it can be expected. Please mark all correspondence with the file number.

As always, if you have any questions, please give me a call.

Sincerely,

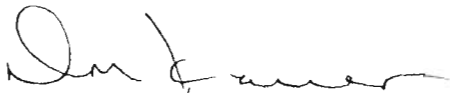

Don Knauer  
Adjudication Specialist

Enclosures

J:\WP51\SWR\CLAIMANT\4\SWR-0452.00M





T. 20S., R. 10W., W.M.

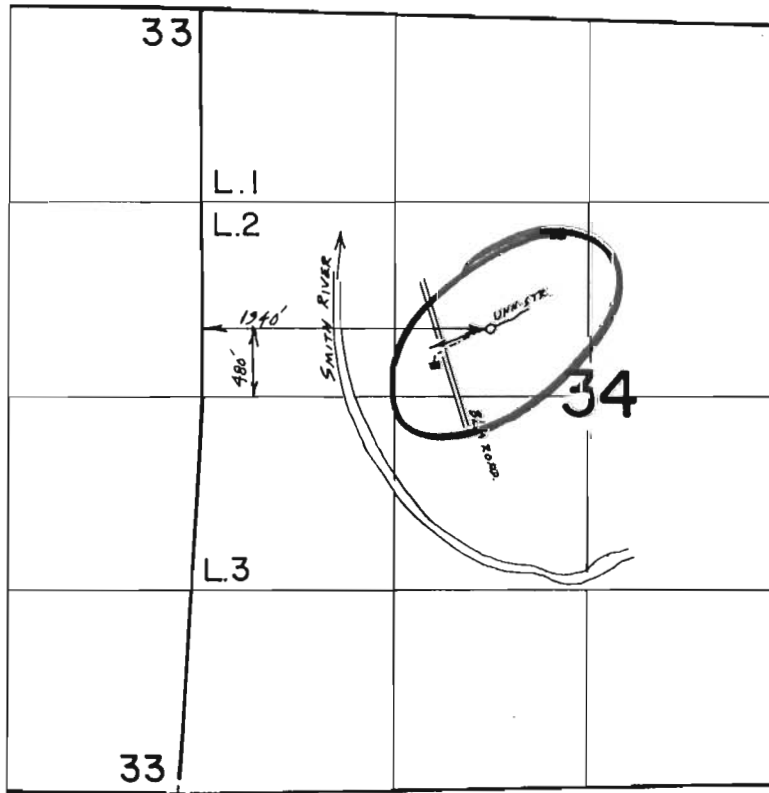

Scale 1" = 1320'

**FINAL PROOF SURVEY**  
UNDER

Application No. 65294 Permit No. 47917.....  
IN NAME OF

PAUL M. & MARCELLA DAILEY

Surveyed Sept. 3, 1992., by S. James.....



INFO.: MET W/ MARCECCA DAILEY, GRAVITY-FLOW FROM  
UNNAMED STREAM USED FOR DOMESTIC.  
DIV. PT.

SOURCE: UNNAMED STREAM ✓

DIV. PT.: GRAVITY-FLOW FROM A 2' LONG X 0<sup>25</sup> WIDE GROOVE  
CHISELED INTO BEDROCK AT A CASCADE IN STREAM  
CHANNEL BY A 30' LONG SECTION OF 2" GALVANIZED  
PIPE LEADING TO 55 GALLON DRUM USED AS A  
SETTLING TANK.

PIPE: 30 FT. OF 2" GALVANIZED  
200 FT. OF 1 1/2" B. POLY PIPE SETTLING TANK → STO. TANK  
1000 GALLON STORAGE TANK  
350 FT. OF 1 1/2" B. POLY PIPE FROM STORAGE TANK → HOUSE

USE: DOMESTIC FOR ONE FAMILY INCLUDING ...

LAKES GARDEN



Mike Stumack  
VI 7/26/89

NOTE: FOUND REMNANTS (OLD ~~STEEL~~ IRON PIPE AT DIV. PT.  
AND ALONG ROUTE TO STORAGE TANK-) MRS. DAILEY  
CLAIMS THAT SYSTEM USED SINCE 1870'S. I CONCUR.

UPDATE: 2/3/89 TOO MUCH WORK TO PLANE TABLE WITH  
ALIDADE THAT LACKS A COMPASS. WILL TRY  
TO ORDER AERIAL JMS

STATE OF OREGON  
COUNTY OF DOUGLAS  
CERTIFICATE OF WATER RIGHT

THIS CERTIFICATE ISSUED TO

PAUL M. AND MARCELLA DAILEY  
ROUTE 3, BOX 133  
REEDSPORT, OREGON 97467

confirms the right to use the waters of AN UNNAMED STREAM, a tributary of THE SMITH RIVER, for DOMESTIC USE FOR ONE FAMILY INCLUDING THE IRRIGATION OF LAWN AND NON-COMMERCIAL GARDEN NOT TO EXCEED ONE-HALF ACRE.

This right was perfected under Permit 47917. The date of priority is JULY 13, 1983. This right is limited to 0.01 CUBIC FOOT PER SECOND or its equivalent in case of rotation, measured at the point of diversion from the source.

The point of diversion is located as follows:

SE 1/4 NW 1/4, SECTION 34, T 20 S, R 10 W, W.M.; 480 FEET NORTH AND 1940 FEET EAST FROM THE WEST QUARTER CORNER OF SECTION 34.

The use shall conform to such reasonable rotation system as may be ordered by the proper state officer.

A description of the place of use to which this right is appurtenant is as follows:

SE 1/4 NW 1/4  
SECTION 34  
TOWNSHIP 20 SOUTH, RANGE 10 WEST, W.M.

The right to the use of the water for the above purpose is restricted to beneficial use on the lands or place of use described. The use confirmed herein may be made only at times when sufficient water is available to satisfy all prior rights, including rights for maintaining instream flows.

WITNESS the signature of the Water Resources Director, affixed  
APRIL 9, 1993.

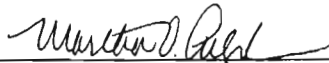
  
Martha O. Pagel

Recorded in State Record of Water Right Certificates numbered 68231.

65294.LMS

April 8, 1993

MARTIN & MARCELLA DAILEY FAMILY TRUST  
22101 LOWER SMITH RIVER ROAD  
REEDSPORT OR 97467

Dear MR & MRS DAILEY,

This will acknowledge that your Surface Water Registration Statement in the name of MARTIN & MARCELLA DAILEY FAMILY TRUST has been received by our office. The fees in the amount of \$340.00 have been received and our receipt #95801 is enclosed. Your registration statement has been numbered SWR-452.

Our office will review your form and map in the near future. If necessary we will schedule a meeting with you that will include a site inspection. If there are problems with your form we are usually able to take care of them during our visit. We will be able to answer any questions you might have about the adjudication process at that time.

Please feel free to contact this office if you have any questions.

Sincerely,



Don Knauer  
Adjudication Specialist

Enclosure

J:\WP51\SWR\CLAIMANT\4\SWR-0452.001



STATE OF OREGON

WATER RESOURCES DEPARTMENT

3850 PORTLAND ROAD NE

SALEM, OR 97310

378-8455/378-8130 (FAX)

RECEIPT # **95801**

RECEIVED FROM:

BY: *Martin + Marcella Daily Family Trust*

APPLICATION

PERMIT

TRANSFER

CASH:  CHECK: #  96-104 OTHER: (IDENTIFY)

TOTAL REC'D \$ **340**

**01-00-0 WRD MISC CASH ACCT**

842.010	ADJUDICATIONS	\$ <b>340</b>
831.087	PUBLICATIONS/MAPS	\$
830.650	PARKING FEES Name/month	\$
	OTHER: (IDENTIFY)	\$

**REDUCTION OF EXPENSE**

CASH ACCT.

COST CENTER AND OBJECT CLASS

VOUCHER #

\$

**03-00-0 WRD OPERATING ACCT**

**MISCELLANEOUS:**

840.001	COPY FEES	\$
850.200	RESEARCH FEES	\$
880.109	MISC REVENUE: (IDENTIFY)	\$
520.000	OTHER (P-6): (IDENTIFY)	\$

**WATER RIGHTS:**

842.001	SURFACE WATER	\$	842.002	\$
842.003	GROUND WATER	\$	842.004	\$
842.005	TRANSFER	\$	842.006	\$

**WELL CONSTRUCTION**

842.022	WELL DRILL CONSTRUCTOR	\$	842.023	\$
842.016	WELL DRILL OPERATOR	\$	842.019	\$
	LANDOWNER'S PERMIT	\$	842.024	\$

**EXAM FEE**

\$
\$
\$

**RECORD FEE**

**EXAM FEE**

\$
\$

**LICENSE FEE**

**06-00-0 WELL CONST START FEE**

842.013	WELL CONST START FEE	\$	CARD #	
	MONITORING WELLS	\$	CARD #	

**45-00-0 LOTTERY PROCEEDS**

864.000	LOTTERY PROCEEDS	\$
---------	------------------	----

**07-00-0 HYDRO ACTIVITY**

LIC NUMBER

842.011	POWER LICENSE FEE(FW/WRD)	\$
842.115	HYDRO LICENSE FEE(FW/WRD)	\$

HYDRO APPLICATION

\$

RECEIPT # **95801**

DATED: *12-31-92*

BY: *D. Bushnell*