

T. 29 S., R. 12 W., Sec. 30

Map for a pre-1909 Surface Water Registration.

Scale: 1" = 400 ft.

Survey date: May 29, 1993.

This map is not the result of a property Survey and is not to be used as such.

For: Danny and Victoria BAUCUM.

File: SWR 473.

Stock Watering shown: ()

Catching Creek is a Tributary of S. Fork Cog. River.

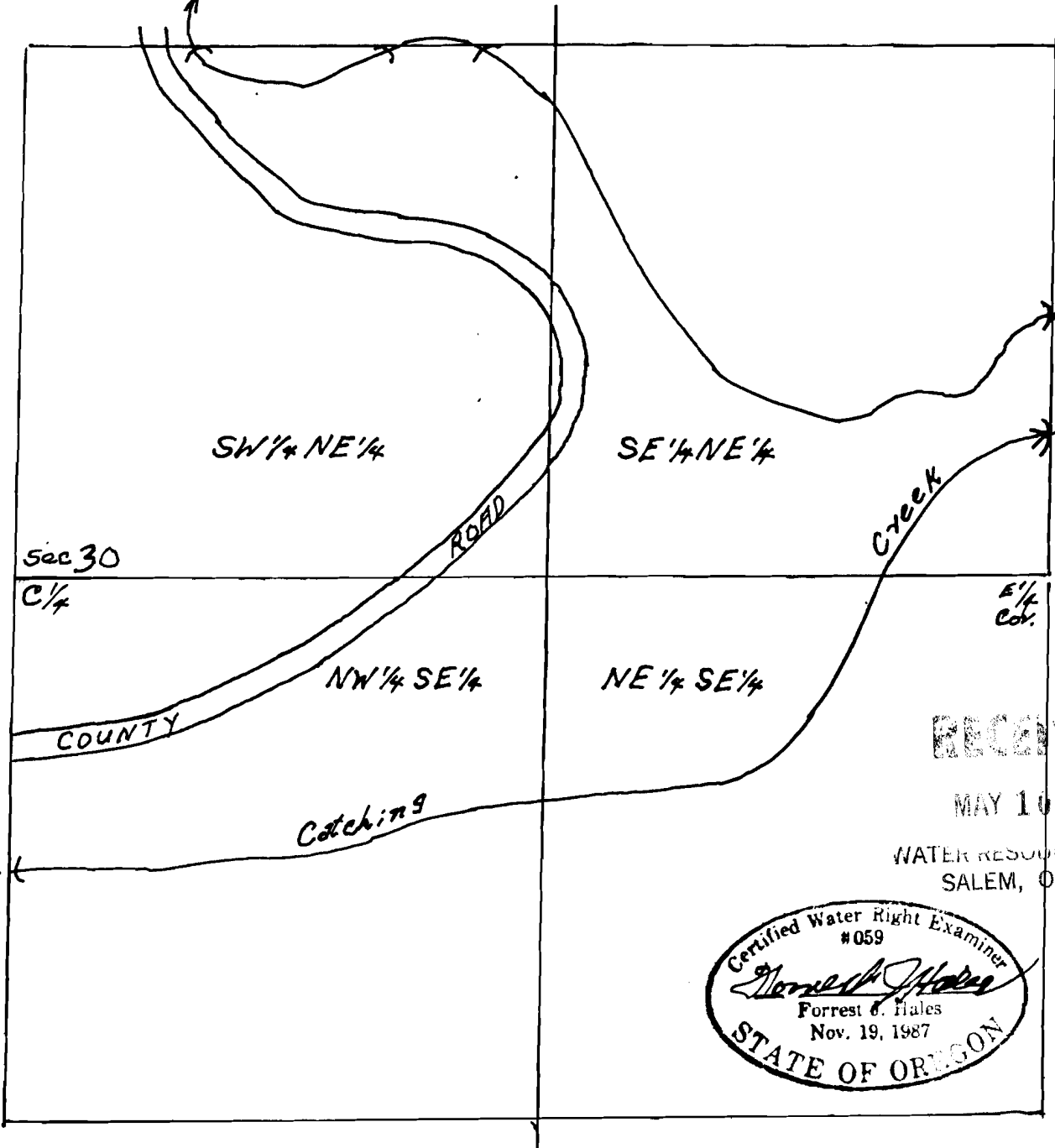

RECEIVED

MAY 10 1993

WATER RESOURCES DEPT.
SALEM, OREGON

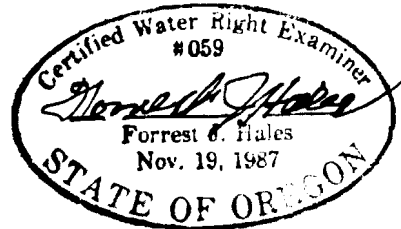

RECEIVED

Oregon

MAY 10 1993

WATER RESOURCES DEPT.
SALEM, OREGON

WATER
RESOURCES
DEPARTMENT

April 9, 1993

DANNY & VICTORIA BAUCUM
PO BOX 536
COQUILLE OR 97423

Per 1909 Cont. Watering

Dear DANNY & VICTORIA BAUCUM,

This will acknowledge that your Surface Water Registration Statement in the name of DANNY & VICTORIA BAUCUM has been received by our office. The fees in the amount of \$200.00 have been received and our receipt #95878 is enclosed. Your registration statement has been numbered SWR-473.

The map you submitted with your claim is not acceptable. ORS 539.240 (2) (d) requires the map be prepared by a Certified Water Right Examiner (CWRE). Within 60 days of this letter you must send a letter to this address indicating you have contracted with a CWRE to prepare your map. You should send your letter to my attention. In your letter you must identify the name of the CWRE who will prepare your registration statement map. We will contact the CWRE to arrange a map submittal deadline.

We will not be able to process you claim until we have received your map. If you have any questions regarding this process, please do not hesitate to give me a call.

Please feel free to contact this office if you have any questions.

Sincerely,

Dwight French

Dwight French
Adjudication Section

Enclosure



3850 Portland Rd NE
Salem, OR 97310
(503) 378-3739
FAX (503) 378-8130

Power of Attorney
(Special)

RECEIVED

JAN 04 1993

WATER RESOURCES DEPT.
SALEM, OREGON

Know All People By These Presents:

That DANNY A. BAUCUM, of _____
City of PENN VALLEY, County of NEVADA
State of California, hereby appoint(s) NATE TENNESON
of _____, City of COQUILLE
County of COOS, State of OREGON, as MY attorney in fact
to act in SIGNING MY name and to do any and all of the following.

SIGN DOCUMENTS IN MY NAME RELATED TO
SURFACE WATER REGISTRATION STATEMENT

T-29-R12-S30

TAX LOT 700 ONLY

Granting to NATE TENNESON attorney in fact full power and authority to do and perform all and every act and thing whatsoever requisite, necessary, and proper to be done in the exercise of any of the rights and powers herein granted, as fully to all intents and purposes as I might or could do if personally present, with full power of delegation substitution or revocation, hereby ratifying and confirming all that NATE TENNESON attorney in fact, or his substitute or substitutes, shall lawfully do or cause to be done by virtue of this power of attorney and the rights and powers herein granted.

By executing this document, I further intend to revoke all previous General Power of Attorney appointments executed by me or on my behalf to the extent that they authorize any of the same acts herein specified.

I have personally executed this document on December 31st, 1992,
at Winds Valley, California.

Danny A. Bausum
(Signature) **RECEIVED**

JAN 04 1993

WATER RESOURCES DEPT.
SALEM, OREGON

Statement of Witness:

I declare under the penalty of perjury under the laws of California that the person who signed or acknowledged this document is personally known to me (or provided to me on the basis of convincing evidence) to be the principal, that the principal signed or acknowledged this power of attorney in my presence, and that the principal appears to be of sound mind and under no duress, fraud, or undue influence.

1. Signature _____

Print Name _____

Date _____

Residential Address _____

2. Signature _____

Print name _____

Date _____

Residential Address _____

Notary Public:

STATE OF CALIFORNIA

COUNTY OF NEVADA

On this 31st day of December in the year of 1992,
before me, the undersigned, a Notary Public in and for said State, personally
appeared Danny A. Bausum, personally
known to me (or proved to me on the basis of satisfactory evidence) to be the
person(s) whose name(s) is/are subscribed to the within instrument and
acknowledged to me that he/she/they executed the same in his/her/their
authorized capacity(ies), and that by his/her/their signature(s) on the
instrument the person(s), or the entity upon behalf of which the person(s)
acted, executed the instrument.

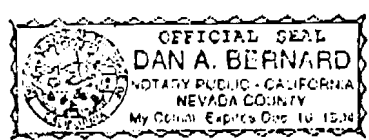

Witness my hand and official seal.

Dan A. Bernard
Notary Public

STATE OF OREGON

COUNTY OF COOS

RECEIVED

JAN 04 1993

CERTIFICATE OF WATER RIGHT

WATER RESOURCES DEPT. SALEM, OREGON

This is to certify, That VERAL E. TARNO

of Catching Creek Rt, Box 10, Myrtle Point, State of Oregon 97458, has made proof to the satisfaction of the Water Resources Director, of a right to the use of the waters of Catching Creek and an unnamed spring

a tributary of South Fork Coquille River for the purpose of irrigation of 46.4 acres and domestic use for one family

under Permit No. 37327 and that said right to the use of said waters has been perfected in accordance with the laws of Oregon; that the priority of the right hereby confirmed dates from September 18, 1973

that the amount of water to which such right is entitled and hereby confirmed, for the purposes aforesaid, is limited to an amount actually beneficially used for said purposes, and shall not exceed 0.435 cubic foot per second, being 0.43 cfs from Catching Creek for irrigation and 0.005 cfs from spring for domestic

or its equivalent in case of rotation, measured at the point of diversion from the stream. The point of diversion is located in the SE 1/4 NE 1/4, NW 1/4 SE 1/4, Section 30, T29S, R12W, WM; Creek- 360 feet North and 530 feet West; Spring- 1240 feet South and 2470 feet West, both from East 1/4 Corner, Section 30.

The amount of water used for irrigation, together with the amount secured under any other right existing for the same lands, shall be limited to one-eightieth of one cubic foot per second per acre, or its equivalent for each acre irrigated and shall be further limited to a diversion of not to exceed 2.5 acre-feet per acre for each acre irrigated during the irrigation season of each year,

and shall conform to such reasonable rotation system as may be ordered by the proper state officer.

A description of the place of use under the right hereby confirmed, and to which such right is appurtenant, is as follows:

- 4.8 acres SW 1/4 NE 1/4
- Domestic and 22.8 acres SE 1/4 NE 1/4
- 8.0 acres NE 1/4 SE 1/4
- 10.8 acres NW 1/4 SE 1/4
- Section 30
- Township 29 South, Range 12 West, WM

The right to the use of the water for the purposes aforesaid is restricted to the lands or place of use herein described and is subject to minimum flows established by the Water Resources Commission with an effective date prior to this right.

WITNESS the signature of the Water Resources Director, affixed

this date. June 6, 1986

William H. Young Water Resources Director

Basin "17" W. Co. RD. S.F. Coquille Riv. misc.

37327

RECEIVED

JAN 04 1983

WATER RESOURCES DEPT.
SALEM, OREGON

T. 29S., R. 12W., W.M.

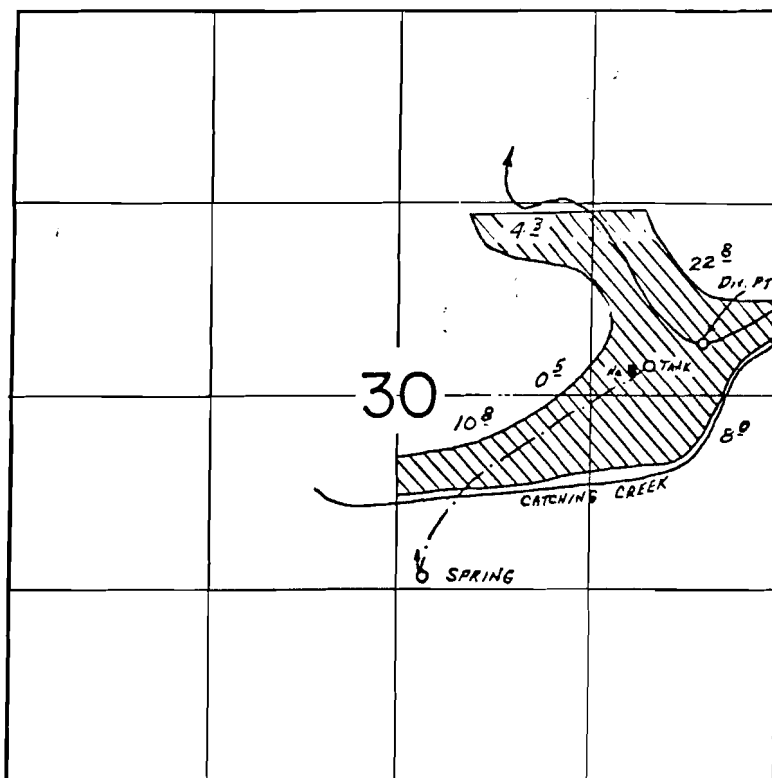

DIP. PTS. LOC.: CREEK- 360' N. & 530' W.; SPRING- 1240' S & 2470' W.,
BOTH FROM E 1/4 COR. SEC. 30.

FINAL PROOF SURVEY UNDER

Application No. 51242... Permit No. 37327.....
IN NAME OF

.....VERAL E. TARNO.....

Surveyed JULY 21... 1980., by J.S. DONALDSON



Y. TITLE COMPANY
 COPY OF ASSESSOR'S MAP IS
 VIDED SOLELY TO ASSIST IN LO-
 ING SUBJECT PROPERTY. NO
 ABILITY IS ASSUMED BY KEY FOR
 DISCREPANCIES IN THIS MAP AS OUT-
 LINED AND THE ACCOMPANYING
 LEGAL DESCRIPTION.

29-12-30

101
 5.05 AC.
 100
 14.40 AC.

30

RECEIVED

JAN 04 1933

WATER RESOURCES DEPT.
 SALEM, OREGON

SEE CO. 57A

701
 33.64 AC.

700
 121.95 AC.

41-01

CATCHING CREEK

CATCHING

CO.

CREEK

600

80.00 AC.

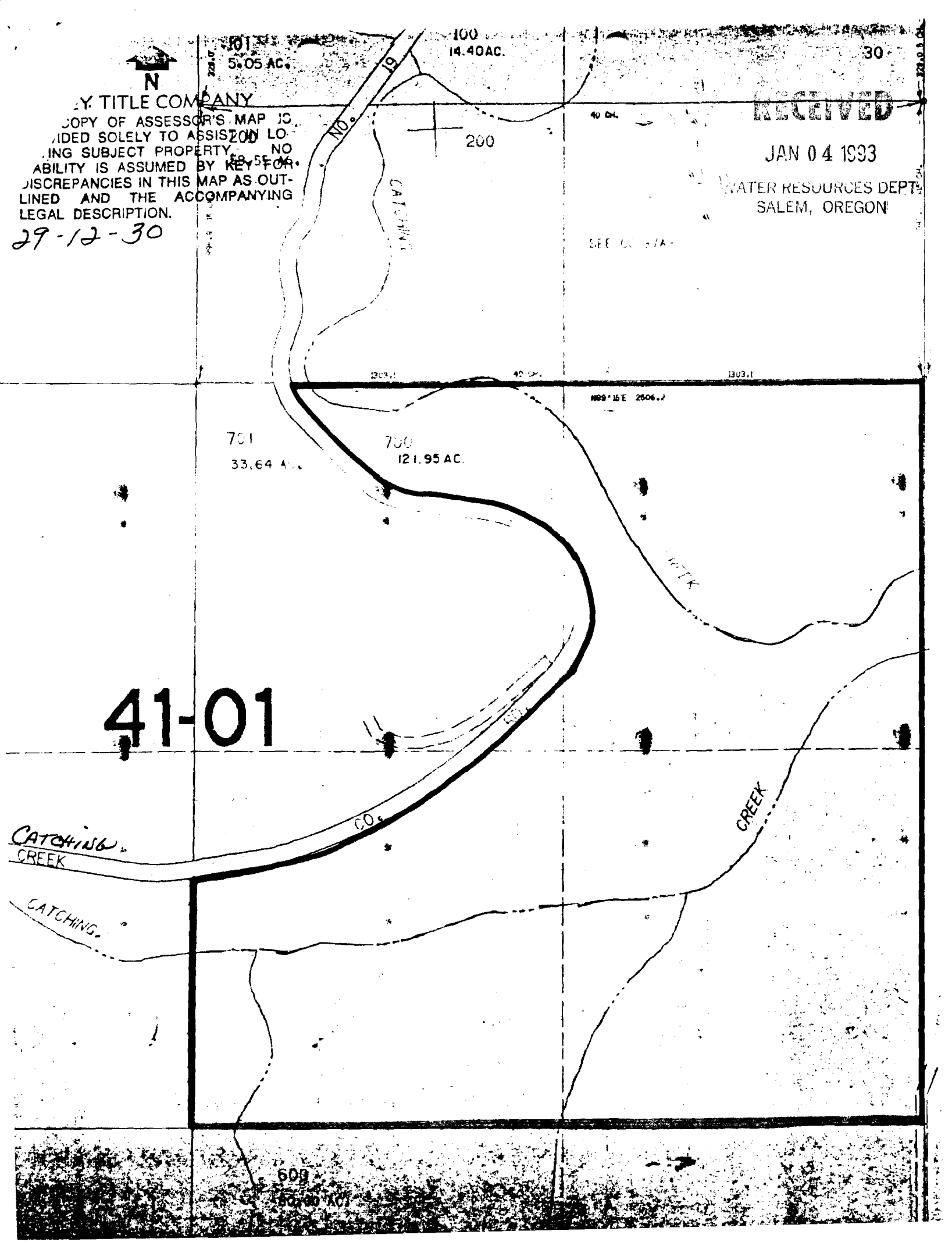

SALEM, OREGON
 CONTINUING ASSESSMENT ROLL OF TAXABLE REAL PROPERTIES OF CLATSOP COUNTY, OREGON

A SLASH IN THE SERIAL NUMBER INDICATES THE NUMBER HAS BEEN BROUGHT FORWARD FROM A PREVIOUS YEAR'S LISTING

SERIAL NUMBER	DESCRIPTION OF PROPERTY			
	NAME OF PLAT OR SUBDIVISION	TAX LOT NUMBER	SECTION	TOWNS OR LG
/11674	City, Wash	1	30	29
11674.00	Exc. 3.08 acres County Road			

YEAR OF ASSESSMENT	DEED RECORD MICRO REEL NO.	NAME OF OWNER	TOTAL ACRES	ASSESSED				V A
				LAND	TIMBER	STRUCTURAL IMPROVEMENTS	AFFIXED MACHINERY	
		Brought Forward From Old Card						
1974	73-9-90538 73-10-9162	Veral E. & Joyce M. Tarno	156.92	32,580	2,600	18,370		53
1974				32,580	4,060	18,370		55
1974				18,685	4,060	18,370		

JAN 04 1933

x' This Indenture Witnesseth, that Jesse G. Belieu and his wife, Margaret S. Belieu, for the consideration of the sum of ^{WATER RESOURCES DEPT. SALEM, OREGON} ~~one~~ ^{one} hundred and sixty Dollars, to them paid, have bargained and sold and by these presents do bargain, sell and convey unto Bickford Bartlett the following described premises, to-wit: The South half of the North East quarter and the North half of the South East quarter of section thirty, in Township twenty nine, South of Range twelve West of Ullamette Meridian, in Coos County, Oregon, containing one hundred and sixty acres To Have and To Hold the said premises, with their appurtenances, unto the said Bickford Bartlett his heirs and assigns forever. And the said Jesse G. Belieu and Margaret S. Belieu

do hereby covenant to and with the said Bickford Bartlett, his heirs and assigns that they are the owners in fee simple of said premises; that they are free from all incumbrances and that they will warrant and defend the same from all lawful claims whatsoever. In Witness Whereof, we have hereunto set our hands and seals this 5th day of March, 1900

Done in Presence of
 L. A. Roberts. }
 J. T. Dunlap }
 State of Oregon, }
 County of Coos. } ss.

#22 J.R. Kemp
 3-10-1900
 J.G.B.

Jesse G. Belieu (seal)
 Margaret S. Belieu (seal)

On the 10th day of March 1900, personally came before me, a Notary Public in and for said County and State, the within named Jesse G. Belieu and Margaret S. Belieu, his wife, to me personally known to be the identical persons described in and who executed the within instrument and who each personally acknowledged to me that they executed the same freely and voluntarily for the uses and purposes therein named, and without fear or compulsion from anyone.

Witness my hand and seal this 10th day of March, 1900.

(Seal)

L. A. Roberts.
 Notary Public for Oregon.

Recorded March 12-1900
 L. H. Hazard, Co. Clerk

SURFACE WATER REGISTRATION CHECKLIST

(received after July 18, 1990)

CHECK BASIN MAP DWF NAME SOUTH COAST # 17 UNADJUDICATED AREA ? OK DWF
RECEIPT # 95878 S W R NUMBER 473
CHECK ENCLOSURES DWF PRELIMINARY DATA BASE ENTRY DWF
ACKNOWLEDGEMENT LETTER _____ ENTER ON STREAM INDEX _____
CHECK QUADRANGLE MAP _____ CHECK GLO PLATS _____
WATERMASTER CHECKLIST _____ PUBLIC NOTICE PUBLICATION SCSN

FORM REVIEW

_____ blanks filled in
_____ signed
_____ date received stamped

MAP REVIEW

source and trib
_____ diversion point location
_____ conveyances (pipes, ditch, etc.)
 place of use
 scale
 township, range, section
 north arrow
 CWRE stamp
 disclaimer
 date survey was performed
_____ P.O.B. of survey
_____ dimensions and capacity of diversion system
 "beneficial use" type title
 "permanent-quality" paper

WATER RIGHT RECORD CHECK _____ FIELD INSPECTION _____
FINAL FILE REVIEW _____ FINAL DATA BASE ENTRY _____
ENTER ON PLAT CARDS _____

May 10, 1993

DANNY & VICTORIA BAUCUM
PO BOX 536
COQUILLE OR 97423

RE: SWR-473

Dear Mr & Mrs Baucum,

This will acknowledge the receipt of the map prepared by Forrest Hales, CWRE to support your claim to a pre-1909 vested water right. The map has been added to your file and will be reviewed in the future. If you have any questions, please give me a call.

Sincerely,



Don Knauer
Adjudication Specialist

J:\W\S\C\4\SWR-0473.002



3850 Portland Rd NE
Salem, OR 97310
(503) 378-3739
FAX (503) 378-8130

April 9, 1993

WATER
RESOURCES
DEPARTMENT

DANNY & VICTORIA BAUCUM
PO BOX 536
COQUILLE OR 97423

Dear DANNY & VICTORIA BAUCUM,

This will acknowledge that your Surface Water Registration Statement in the name of DANNY & VICTORIA BAUCUM has been received by our office. The fees in the amount of \$200.00 have been received and our receipt #95878 is enclosed. Your registration statement has been numbered SWR-473.

The map you submitted with your claim is not acceptable. ORS 539.240 (2) (d) requires the map be prepared by a Certified Water Right Examiner (CWRE). Within 60 days of this letter you must send a letter to this address indicating you have contracted with a CWRE to prepare your map. You should send your letter to my attention. In your letter you must identify the name of the CWRE who will prepare your registration statement map. We will contact the CWRE to arrange a map submittal deadline.

We will not be able to process you claim until we have received your map. If you have any questions regarding this process, please do not hesitate to give me a call.

Please feel free to contact this office if you have any questions.

Sincerely,

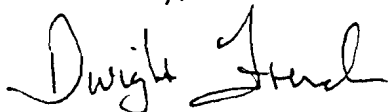

Dwight French
Adjudication Section

Enclosure



3850 Portland Rd NE
Salem, OR 97310
(503) 378-3739
FAX (503) 378-8130

WATER RESOURCES DEPARTMENT

RECEIPT # **95878**3850 PORTLAND ROAD NE
SALEM, OR 97310
378-8455/378-8130 (FAX)RECEIVED FROM: Harmon

BY: _____

APPLICATION

PERMIT

TRANSFER

CASH:

CHECK: #

OTHER: (IDENTIFY)

TOTAL REC'D

\$

01-00-0 WRD MISC CASH ACCT

842.010 ADJUDICATIONS

\$

831.087 PUBLICATIONS/MAPS

\$

830.650 PARKING FEES Name/month

\$

OTHER: (IDENTIFY)

\$

REDUCTION OF EXPENSE

CASH ACCT.

\$

COST CENTER AND OBJECT CLASS

VOUCHER #

03-00-0 WRD OPERATING ACCT**MISCELLANEOUS:**

840.001 COPY FEES

\$

850.200 RESEARCH FEES

\$

880.109 MISC REVENUE: (IDENTIFY)

\$

520.000 OTHER (P-6): (IDENTIFY)

\$

WATER RIGHTS:

842.001 SURFACE WATER

EXAM FEE

\$

842.002

RECORD FEE

\$

842.003 GROUND WATER

\$

842.004

\$

842.005 TRANSFER

\$

842.006

\$

WELL CONSTRUCTION**EXAM FEE**

\$

842.023

LICENSE FEE

\$

842.022 WELL DRILL CONSTRUCTOR

\$

842.019

\$

842.016 WELL DRILL OPERATOR

LANDOWNER'S PERMIT

842.024

\$

06-00-0 WELL CONST START FEE

842.013 WELL CONST START FEE

\$

CARD #

MONITORING WELLS

\$

CARD #

45-00-0 LOTTERY PROCEEDS

864.000 LOTTERY PROCEEDS

\$

07-00-0 HYDRO ACTIVITY

LIC NUMBER

842.011 POWER LICENSE FEE(FWWRD)

\$

842.115 HYDRO LICENSE FEE(FWWRD)

\$

HYDRO APPLICATION

\$

RECEIPT #

95878DATED: 1-4-93BY: [Signature]