

December 21, 1993

LLOYD C KREUTZER
PO BOX 62
LANGLOIS OR 97450

RE: SWR-508

Dear Mr Kreutzer,

I am in the process of reviewing the maps submitted in support of pre-1909 vested water right claims. There may have been some misunderstanding about the required map during the last few months before the December 31, 1992 deadline. As the deadline approached, it was apparent the Water Right Examiners (WRE) would not be able to survey and prepare the required map and site report. We allowed claimants to submit most any kind of map to meet the deadline. We tried to insure claimants understood that the survey, map and site report would be required as soon as the WRE had time to make the field survey and complete the map and report.

The reason I am writing today is about your map. The map submitted does not meet the statutory requirements. I need to know when I might receive the required map from you. I cannot complete my review of your claim without the required map.

If you have any questions, please give me a call. The toll free number is 1-800-624-3199.

Sincerely,



Don Knauer
Adjudication Specialist

J:\W\SIC\5\SWR-0508.004



3850 Portland Rd NE
Salem, OR 97310
(503) 378-3739
FAX (503) 378-8130

June 23, 1993

WATER
RESOURCES
DEPARTMENT

HOWARD J NEWHOUSE
PO BOX 360
WEDDERBURN OR 97491

RE: letter of May 25, 1993 to John Drolet

Dear Mr Newhouse,

You sent me a copy of your letter to John Drolet and a note saying you have no plans to prepare any maps for Lloyd C Kreutzer. It appears there is some misunderstanding and I may be able to help. There are two very different and distinct manners in which a water right is established in Oregon. There is the application for a permit process established by the 1909 legislature. There is the pre-1909 claim to a vested water right.

A person applying for a permit to use water for "stockwater direct from a surface water source" would have the application rejected by the Water Resources Department (WRD). If that person makes the claim that the use of water for "stockwater direct from a surface water source" started before 1909 and has continued through the years, the WRD is obligated to accept the claim, process it and eventually present the claim to Circuit Court for a determination. The claim says the use began before 1909 which means there is no more water being taken from the source. The claim is to put on record what has been going on for all these years. There are numerous decrees of court which have allowed the stockwater direct use of surface water under a pre-1909 vested water right.

Once the claim by Lloyd C Kreutzer is in an acceptable form, to include a map prepared by a water right examiner showing the extent of beneficial use, the WRD will review all data submitted. Sometime in the future the actual determination of all vested water rights in the area



3850 Portland Rd NE
Salem, OR 97310
(503) 378-3739
FAX (503) 378-8130

will be planned and the Kreutzer claim will be included.

I am sending a copy of this letter to Mr Kreutzer and must request again that a map prepared by a water right examiner be submitted to support his claim to a pre-1909 vested water right. The WRD cannot process his claim under the map is received.

If you have any questions, please give me a call.

Sincerely,

A handwritten signature in black ink, appearing to read "Don Knauer", with a long horizontal flourish extending to the right.

Don Knauer
Adjudication Specialist

June 14, 1993

HOWARD J NEWHOUSE
PO BOX 360
WEDDERBURN OR 97491

RE: Surface Water Registration Map

Dear MR NEWHOUSE,

LLOYD C KREUTZER has indicated to the Oregon Water Resources Department (WRD) that you have been hired to prepare the claim of beneficial use map for their Surface Water Registration Statement. Would you please inform me of your anticipated schedule of map preparation and submission to the WRD.

Please mark all correspondence related to this claim with the file number SWR-508.

Sincerely,



Don Knauer
Adjudication Specialist

J:\WP51\SWR\CLAIMANT\5\SWR-0508.002



3850 Portland Rd NE
Salem, OR 97310
(503) 378-3739
FAX 378-8130

SURFACE WATER REGISTRATION CHECKLIST

(received after July 18, 1990)

CHECK BASIN MAP DWF NAME South Coast # 17 UNADJUDICATED AREA ? OK DWF
RECEIPT # 95961 S W R NUMBER 508
CHECK ENCLOSURES DWF PRELIMINARY DATA BASE ENTRY DWF
ACKNOWLEDGEMENT LETTER DWF ENTER ON STREAM INDEX _____
CHECK QUADRANGLE MAP DWF CHECK GLO PLATS _____
~~FLORAS TX 88~~ LANGOLIS 136
WATERMASTER CHECKLIST _____ PUBLIC NOTICE PUBLICATION SCW

FORM REVIEW

_____ blanks filled in
_____ signed
_____ date received stamped

MAP REVIEW

_____ source and trib
_____ diversion point location
_____ conveyances (pipes, ditch, etc.)
_____ place of use
_____ scale
_____ township, range, section
_____ north arrow
_____ CWRE stamp
_____ disclaimer
_____ date survey was performed
_____ P.O.B. of survey
_____ dimensions and capacity of diversion system
_____ "beneficial use" type title
_____ "permanent-quality" paper

WATER RIGHT RECORD CHECK _____ FIELD INSPECTION _____

FINAL FILE REVIEW _____ FINAL DATA BASE ENTRY _____

ENTER ON PLAT CARDS _____

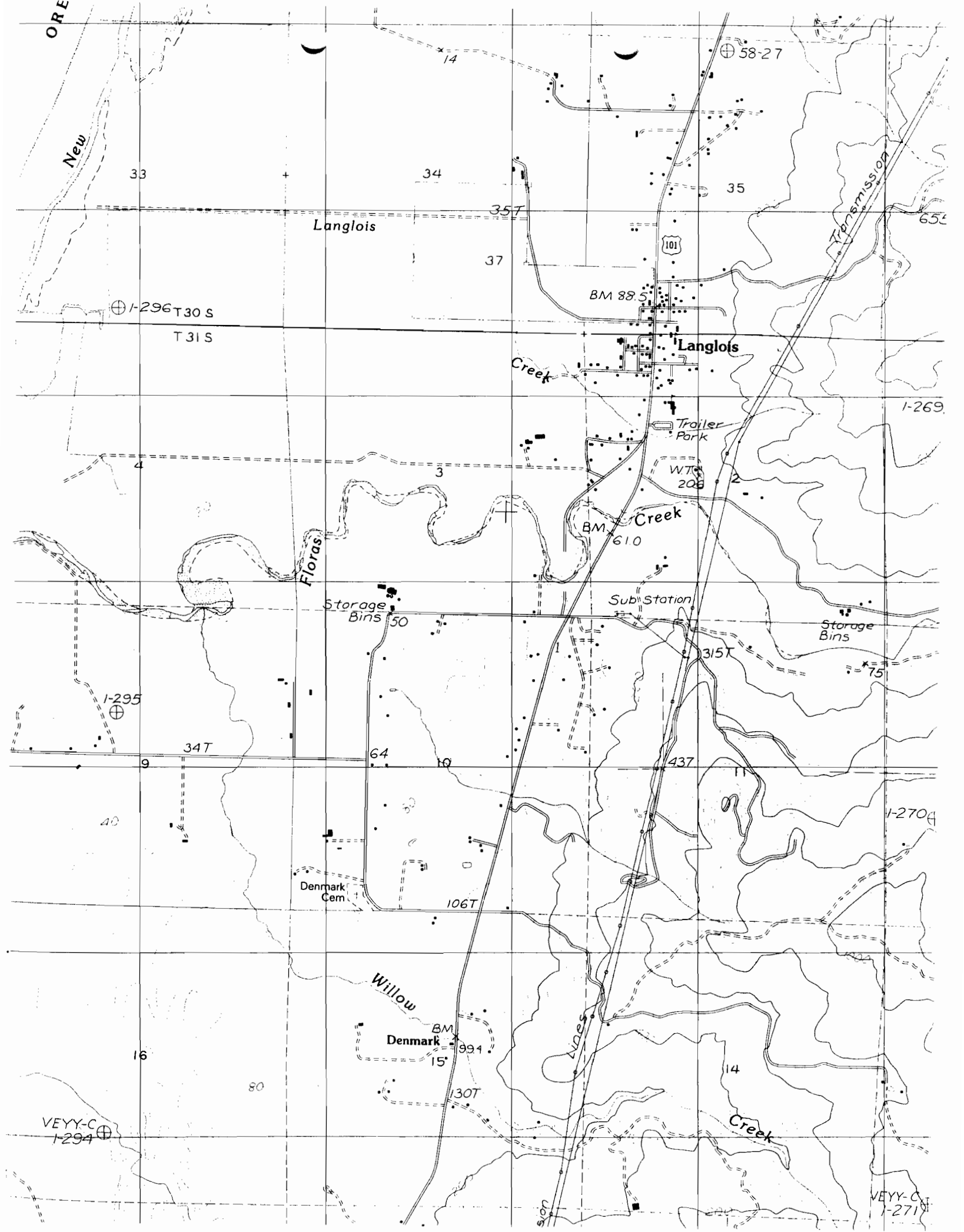

April 20, 1993

WATER
RESOURCES
DEPARTMENT

LLOYD C KREUTZER
PO BOX 62
LANGLOIS OR 97450

Dear LLOYD KREUTZER,

This will acknowledge that your Surface Water Registration Statement in the name of LLOYD C KREUTZER has been received by our office. The fees in the amount of \$200.00 have been received and our receipt #95961 is enclosed. Your registration statement has been numbered SWR-508.

The map you submitted with your claim is not acceptable. ORS 539.240 (2) (d) requires the map be prepared by a Certified Water Right Examiner (CWRE). Within 60 days of this letter you must send a letter to this address indicating you have contracted with a CWRE to prepare your map. You should send your letter to my attention. In your letter you must identify the name of the CWRE who will prepare your registration statement map. We will contact the CWRE to arrange a map submittal deadline.

We will not be able to process your claim until we have received your map. If you have any questions regarding this process, please do not hesitate to give me a call.

Please feel free to contact this office if you have any questions.

Sincerely,

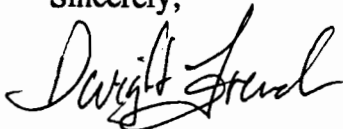

Dwight French
Adjudication Section

Enclosure

J:\WP51\SWR\CLAIMANT\5\SWR-0508.001



3850 Portland Rd NE
Salem, OR 97310
(503) 378-3739
FAX (503) 378-8130

RECEIPT # **95961**

STATE OF OREGON
WATER RESOURCES DEPARTMENT

3850 PORTLAND ROAD NE
SALEM, OR 97310
378-8455/378-8130 (FAX)

RECEIVED FROM: Lloyd Kreutzer
BY: _____

APPLICATION	
PERMIT	
TRANSFER	

CASH: CHECK: # 95-455 OTHER: (IDENTIFY)

TOTAL REC'D \$ 200.00

01-00-0 WRD MISC CASH ACCT

842.010	ADJUDICATIONS	\$ <u>200.00</u>
831.087	PUBLICATIONS/MAPS	\$
830.650	PARKING FEES Name/month	\$
_____	OTHER: (IDENTIFY)	\$

REDUCTION OF EXPENSE

CASH ACCT.	\$
VOUCHER #	

COST CENTER AND OBJECT CLASS

03-00-0 WRD OPERATING ACCT

MISCELLANEOUS:

840.001	COPY FEES	\$
850.200	RESEARCH FEES	\$
880.109	MISC REVENUE: (IDENTIFY)	\$
520.000	OTHER (P-6): (IDENTIFY)	\$

WATER RIGHTS:

842.001	SURFACE WATER	EXAM FEE	842.002	RECORD FEE
842.003	GROUND WATER	\$	842.004	\$
842.005	TRANSFER	\$	842.006	\$

WELL CONSTRUCTION

842.022	WELL DRILL CONSTRUCTOR	EXAM FEE	842.023	LICENSE FEE
842.016	WELL DRILL OPERATOR	\$	842.019	\$
	LANDOWNER'S PERMIT	\$	842.024	\$

06-00-0 WELL CONST START FEE

842.013	WELL CONST START FEE	\$	CARD #	
	MONITORING WELLS	\$	CARD #	

45-00-0 LOTTERY PROCEEDS

864.000	LOTTERY PROCEEDS	\$
---------	------------------	----

07-00-0 HYDRO ACTIVITY

842.011	POWER LICENSE FEE(FW/WRD)	LIC NUMBER	\$
842.115	HYDRO LICENSE FEE(FW/WRD)		\$
_____	HYDRO APPLICATION		\$

RECEIPT # **95961**

DATED: 1-6-93

BY: D. Bunknell

To	Gregg Rice	From	Jerra Woody
Co./Dept.		Co.	
Phone #		Phone #	396-3121 x354
Fax #	247-2368	Fax #	

RECEIVED

1901
JAN 05 1993

OCT 28 1996

WATER RESOURCES DEPT.
WATER RESOURCES DEPT. SALFM, OREGON

STATE OF OREGON
WATER RESOURCES DEPARTMENT

**SURFACE WATER REGISTRATION STATEMENT
PRE-1909 VESTED WATER RIGHT CLAIM**

1. Name of Registrant: LLOYD C. KREUTZER
Mailing Address: P.O. BOX 62 Langlois, Ore.
Telephone No: 348-2412

2. Source of water: FLORAS CREEK
Tributary to: PACIFIC OCEAN

3. Purpose(s) for which water is used: Stockwater
(Irrigation, Stockwater, Domestic, Hydroelectric power, Industrial, Etc.)
If irrigation, total number of acres irrigated: 0

4. Priority Date
a) Date of first use: 1901
b) Date water use development first initiated: 1901
c) Name of party who initiated development: Wm. Guerin

5. Amount of water claimed: .10 CFS, in CFS or GPM
(Water put to beneficial use)

6. Location of place of use:
Partial Sections 2, 3, 11, 12 Township 31 N/S, Range 15 E/W.
Sections, Township _____ N/S, Range _____ E/W.
(Attach additional pages if necessary)

7. Usual period of use: JAN 1 / 1 day to DEC 1 / 31 day
month day month day

Don
I filed a copy for each of the WR. Can

Floras Cr - 11/1/96

RECEIVED

24 October 1996

Oregon Water Resources Dept.
158 12th St NE
Salem, OR 97310
Attn: Data Center

OCT 28 1996
WATER RESOURCES DEPT.
SALEM, OREGON

Re: Water Right Permits #13708, #17228, #45551 and #49993 as well as Pre-1909 Vested Stock Water Right filed January 05, 1993

Property covered by the above referenced Water Rights has been purchased by Stonecypher Ranch, Inc. Specifically this property is described as follows:

1. Permit #13708 -- NW 1/4 SW 1/4 - 10.5 ACRES, SW 1/4 SW 1/4 - 7.5 ACRES and NE 1/4 SW 1/4 - 8.5 ACRES all in Section 2, T31S, R15W.
2. Permit #17228 --
 - a. NW 1/4 SE 1/4 - 7.6 ACRES, SW 1/4 SE 1/4 - 21.2 ACRES and SE 1/4 SE 1/4 - 5.7 ACRES -- and NE 1/4 SW 1/4 - 6.7 ACRES and SE 1/4 SW 1/4 - 0.2 ACRES all in Section 2, T31S, R15W.
 - b. NE 1/4 NE 1/4 - 10.5 ACRES and NW 1/4 NE 1/4 - 5.4 ACRES all in Section 11, T31S, R15W.
 - c. NW 1/4 NW 1/4 - 2.9 ACRES in Section 12, T31S, R15W.
3. Permit #45551 -- NW 1/4 SE 1/4 - 1.0 ACRES and Domestic Use all in Section 2, T31S, R15W.
4. Permit #49993 -- SW 1/4 SW 1/4 - 8.1 ACRES and SE 1/4 SW 1/4 - 17.0 ACRES all in Section 2, T31S, R15W.
5. All property covered by Pre-1909 Vested Stock Water Right Claim in Sections 2, 3, 11 and 12 of T31S, R15W filed January 05, 1993 by Lloyd C. Kreutzer a copy of which is attached.

In order that Stonecypher Ranch, Inc receives all correspondence and documentation relating to the above Water Rights please change the address of record concerning these Rights and properties to the following:

Stonecypher Ranch Inc
94141 Stonecypher Road
Sixes, OR 97476

Sincerely,

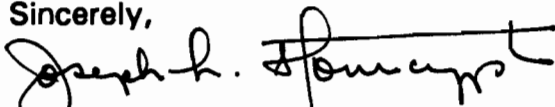
Joseph L. Stonecypher, President

Don:

7-5-99

Please send:

Please send form for →

SWK #13 ✓

Please send maps if any

#15

470

WAITING ON CURVE

297

585

583

432

WAITING ON CURVE

572

508

WAITING ON CURVE

397

WAITING ON CURVE

Jim Simpson

RECEIVED

JUL - 6 1993

Oregon

June 23, 1993

WATER RESOURCES DEPT.
SALEM, OREGON

WATER
RESOURCES
DEPARTMENT

HOWARD J NEWHOUSE
PO BOX 360
WEDDERBURN OR 97491

RE: letter of May 25, 1993 to John Drolet

Dear Mr Newhouse,

You sent me a copy of your letter to John Drolet and a note saying you have no plans to prepare any maps for Lloyd C Kreutzer. It appears there is some misunderstanding and I may be able to help. There are two very different and distinct manners in which a water right is established in Oregon. There is the application for a permit process established by the 1909 legislature. There is the pre-1909 claim to a vested water right.

A person applying for a permit to use water for "stockwater direct from a surface water source" would have the application rejected by the Water Resources Department (WRD). If that person makes the claim that the use of water for "stockwater direct from a surface water source" started before 1909 and has continued through the years, the WRD is obligated to accept the claim, process it and eventually present the claim to Circuit Court for a determination. The claim says the use began before 1909 which means there is no more water being taken from the source. The claim is to put on record what has been going on for all these years. There are numerous decrees of court which have allowed the stockwater direct use of surface water under a pre-1909 vested water right.

Once the claim by Lloyd C Kreutzer is in an acceptable form, to include a map prepared by a water right examiner showing the extent of beneficial use, the WRD will review all data submitted. Sometime in the future the actual determination of all vested water rights in the area

Don,

My conversation with LLOYD Kreutzer had nothing to do with Pre 1909. It was for additional water.

HJN



3850 Portland Rd NE
Salem, OR 97310
(503) 378-3739
FAX (503) 378-8130

RECEIVED

JUN 22 1993

WATER RESOURCES DEPT.
SALEM, OREGON

H.J. NEWHOUSE

LAND SURVEYOR • OR 402 • CA 3605

POST OFFICE BOX 360
WEDDERBURN, OREGON 97491
TELEPHONE (503) 247-6923

May 25, 1993

Mr. John Droplet
Watermaster Dist. 19
290 N. Central St.
Coos County Annex
Coquille, Ore. 97423

Lloyd Kreutzer brought in some water filings for me to look over as he wants to file additional ones for stock water. For the life of me I can't sort this mess out. Some are in the name of Lloyd Kreutzer, L.E. Kreutzer, and sons, and Olive Kreutzer. I think Lloyd has control of all of them. I have some data on Transfer 4544, Permit #45551 and 49993. Then we have Permit # 17228. And then Permit #37181 and a transfer #T3930. I don't know whether these are all or not. You would think with all that water filed on they would have enough for stock water, besides almost all the tracts border either Willow Creek or Floras Creek. How much more water can you take from these streams?

06-10-93

Howard,

You're right; the water right situation for the Kreutzers is complicated.

As for stockwater, is it possible that they are not aware that no permits are required if stock drink from the stream?

Regarding other permits, rights, & transfers, give me a call if we need to meet and I'll prepare for such a meeting.

Howard John



RECEIVED

JUN 22 1993

**WATER RESOURCES DEPT.
SALEM, OREGON**

Oregon

**WATER
RESOURCES
DEPARTMENT**

June 14, 1993

HOWARD J NEWHOUSE
PO BOX 360
WEDDERBURN OR 97491

RE: Surface Water Registration Map

Dear MR NEWHOUSE,

LLOYD C KREUTZER has indicated to the Oregon Water Resources Department (WRD) that you have been hired to prepare the claim of beneficial use map for their Surface Water Registration Statement. Would you please inform me of your anticipated schedule of map preparation and submission to the WRD.

Please mark all correspondence related to this claim with the file number SWR-508.

Sincerely,



Don Knauer
Adjudication Specialist

June 18, 1993

I have no plans to prepare any maps at this time.

H.J. Newhouse

J:\WP51\SWR\CLAIMANT\5\SWR-0508.002



3850 Portland Rd NE
Salem, OR 97310
(503) 378-3739
FAX 378-8130

June 8 1993

Dear Dwight French

We have contracted for maps
Howard J. Newhouse
P.O. Box 360
Wedenburn, Oregon
97491

PK 247-6923

my SWP-508

RECEIVED

JUN 14 1993

WATER RESOURCES DEPT.
SALEM, OREGON

Sincerely
Lloyd Kreutzer

LLOYD KREUTZ

Lloyd Kreutz
12/31/92

31-15

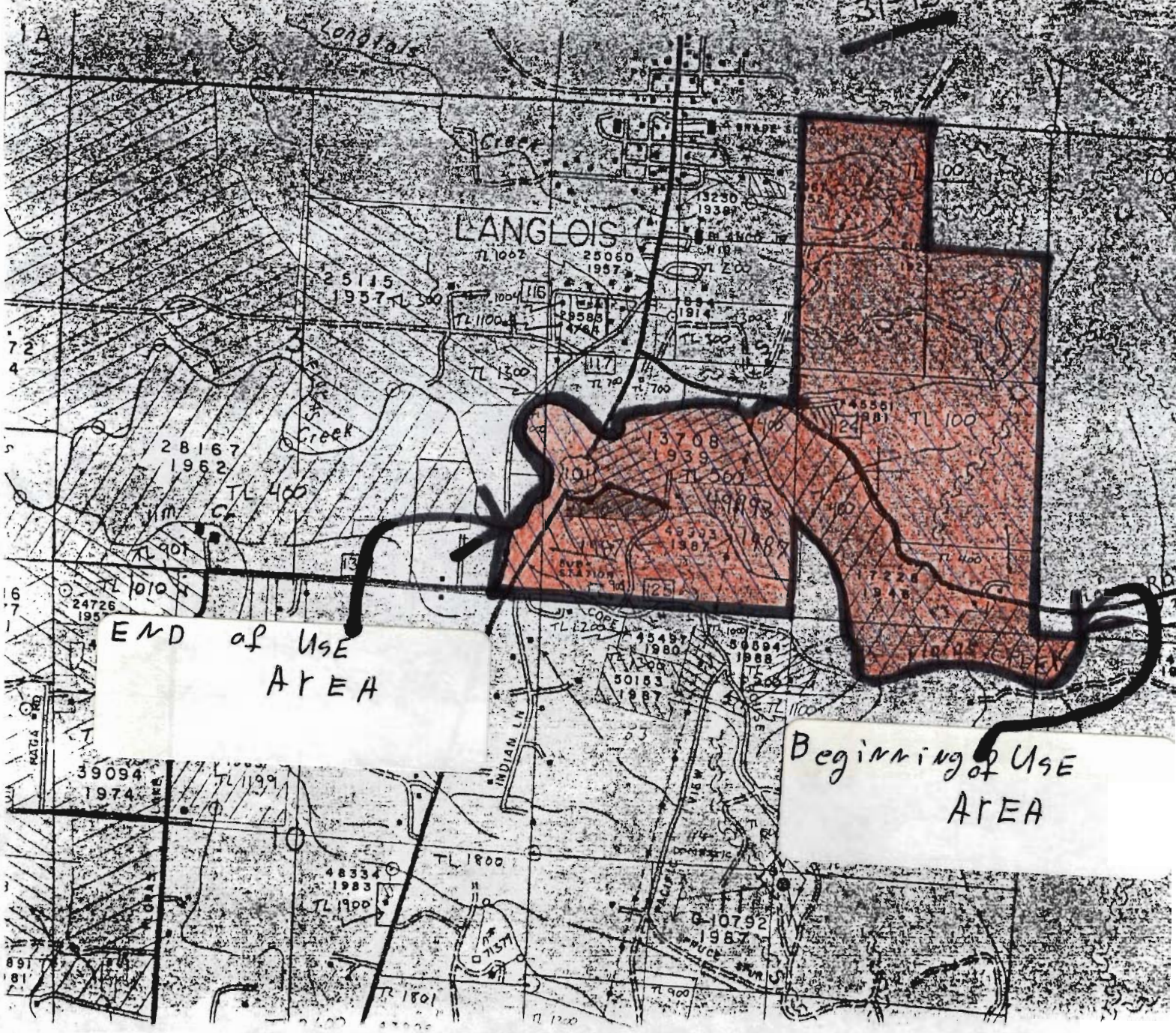

END of USE
AREA

Beginning of USE
AREA

RECEIVED

Watermaster's Office
District No. 19
Coos County Courthouse
Coquille, OR 97423

JAN 05 1993

WATER RESOURCES DEPT
SALEM, OREGON

Receipt Name: Lloyd Kreutzer

Date: December 31, 1992

Amount: \$ 200⁰⁰

Pre-1989 application form.

Received by: James Sims
Asst. Watermaster Dist. 19