

**CLAIM OF
BENEFICIAL USE
for Transfer New or Additional
POD Only**



Oregon Water Resources Department
725 Summer Street NE, Suite A
Salem, Oregon 97301-1266
(503) 986-0900
www.oregon.gov/OWRD

A fee of \$345 must accompany this form for transfers where the application was submitted on July 9, 1987, or later.

Enter the date the transfer application was submitted:

09/19/2022

A separate form shall be completed for each transfer.

This form is subject to revision. **Begin each new claim** by checking for a new version of this form at:
<https://www.oregon.gov/OWRD/Forms/Pages/default.aspx>

The completion of this form is required by OAR 690-014-0100(1) and 690-014-0110(4).

Please type or print in dark ink. If this form is found to contain errors or omissions, it may be returned to you. **Every item must have a response.** If any requested information does not apply to the claim, insert "NA." **Do not delete or alter any section of this form unless directed by the form.** The Department may require the submittal of additional information from any water user or authorized agent.

"Section 8" of this form is intended to aid in the completion of this form and should not be submitted.

A claim of beneficial use includes both this report and a map. If the map is being mailed separately from this form, please include a note with this form indicating such.

If you have questions regarding the completion of this form, please call 503-979-9103.

The Department has a program that allows it to enter into a voluntary agreement with an applicant for expedited services. Under such an agreement, the applicant pays the cost to hire additional staff that would not otherwise be available. This program means a certificate may be issued in about a month. For more information on this program see:

<https://www.oregon.gov/OWRD/programs/WaterRights/RA/Pages/default.aspx>

SECTION 1

GENERAL INFORMATION

Type of Authorized Change

This Claim is being submitted for a transfer where the only authorized change was a change in either point(s) of diversion or additional point(s) of diversion, or a combination of both. **YES**

If additional changes were authorized, you will need to select a different form.

1. File Information

APPLICATION #

T-14090

Received

FEB 06 2026

OWRD

2. Property Owner (current owner information)

APPLICANT/BUSINESS NAME Hubbard Family LLC Attn: Meredith Morgan, Manager		PHONE NO. 847-436-7099 847-436-7098	ADDITIONAL CONTACT NO.
ADDRESS 1145 Raleigh Road			
CITY Glenview	STATE IL	ZIP 60025-3041	E-MAIL meredith@chicagomorgans.com doug@chicagomorgans.com

If the current property owner is not the transfer holder of record, it is recommended that an assignment be filed with the Department. **Each** transfer holder of record must sign this form.

3. Transfer holder of record (this may, or may not, be the current property owner)

TRANSFER HOLDER OF RECORD Hubbard Family LLC; Attn: Meredith Morgan		
ADDRESS 1145 Raleigh Road		
CITY Glenview	STATE IL	ZIP 60025-3041

4. Date of Site Inspection:

07/02/2025

5. Person(s) interviewed and description of their association with the project:

NAME	DATE	ASSOCIATION WITH THE PROJECT
Russell Crowson	07/02/2025	Farm Manager
Anthony Knox	07/02/2025	Irrigation System Installer

6. County:

Benton and Lane

7. If any property described in the place of use of the transfer final order is excluded from this report, identify the owner of record for that property (ORS 537.230(5)):

OWNER OF RECORD		
ADDRESS		
CITY	STATE	ZIP

Add additional tables for owners of record as needed

Received

FEB 06 2026

OWRD

**SECTION 2
SIGNATURES**

CWRE Statement, Seal and Signature

The facts contained in this Claim of Beneficial Use are true and correct to the best of my knowledge.

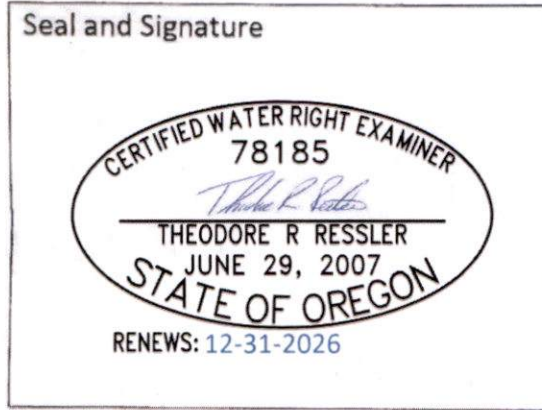

CWRE NAME Theodore R. Ressler		PHONE No. 503-967-7050 x204	ADDITIONAL CONTACT NO.	
ADDRESS Summit Water Resources LLC; 4784 SE 17th Avenue, Suite 111				
CITY Portland	STATE OR	ZIP 97202	E-MAIL tressler@summitwr.com	

Transfer Holder of Record Signature or Acknowledgement

Each transfer holder of record must sign this form in the space provided below.

The facts contained in this Claim of Beneficial Use are true and correct to the best of my knowledge. I request that the Department issue a water right certificate.

SIGNATURE	PRINT OR TYPE NAME	TITLE	DATE
	Meredith Morgan	Manager of Hubbard Family LLC	1/17/2026

**Received
FEB 06 2026
OWRD**

SECTION 3
CLAIM DESCRIPTION

Note: The Claim only needs to describe the new or additional point(s) of diversion. This Claim does not need to provide information for the original point(s) of diversion unless the original point of diversion is either a new or additional point of diversion on another right involved in this transfer.

1. New or additional point of diversion name or number:

POINT OF DIVERSION (POD) NAME OR NUMBER (CORRESPOND TO MAP)	SOURCE
North River POD	Willamette River > Columbia River

2. Variations:

Was the use developed differently from what was authorized by the transfer final order, **NO** or extension final? If yes, describe below.

(e.g. "The order allowed three new/additional points of diversion. The water user only developed one of the points.")

3. Claim Summary:

NEW OR ADDITIONAL POD NAME OR #	MAXIMUM RATE AUTHORIZED IN ORDER	CALCULATED THEORETICAL RATE BASED ON SYSTEM	AMOUNT OF WATER MEASURED
North River POD	0.58 cfs	0.60 cfs (269 gpm)	0.589 cfs (264 gpm)

DOWNSIDE
FEB 3 2026

Received
FEB 06 2026
OWRD

SECTION 4 SYSTEM DESCRIPTION

Are there multiple new or additional Points of Diversion (POD)s? NO

If "YES" you will need to copy and complete a separate Section 4 for each POD.

POD Name or Number this section describes (only needed if there is more than one):

North River POD

A. POD System Information

Provide the following information concerning the point of diversion. Information provided must describe the equipment used to appropriate water from the point of diversion.

1. Pump Information

MANUFACTURER	MODEL	SERIAL NUMBER	TYPE (CENTRIFUGAL, TURBINE OR SUBMERSIBLE)	INTAKE SIZE	DISCHARGE SIZE
Cornell	2.5WH	264470	Centrifugal	3-inch	2.5-inch

2. Motor Information

MANUFACTURER	HORSEPOWER
Baldor	20

3. Theoretical Pump Capacity

HORSEPOWER	OPERATING PSI	LIFT FROM SOURCE TO PUMP	LIFT FROM PUMP TO PLACE OF USE	TOTAL PUMP OUTPUT (IN CFS)
20	81 psi^A	15 ft^B	0 ft^C	0.60 cfs (269 gpm)

Notes

^A Operating pressure measured on discharge mainline just downstream of pump discharge.

^B Vertical lift from water surface to pump

^C Lift downstream of pump discharge is a component of the measured operational pressure

4. Provide pump calculations:

$$Q_{\text{pump}} = \frac{(\text{Hp})(\text{conversion factor})}{(\text{lift} + \text{pressure}) \text{ total head in feet}} = \text{cfs}$$

Conversion factor:

$$\text{Centrifugal Pumps, 75\% eff. } \frac{(550 \text{ ft lb/sec/Hp})(.75)}{(62.4 \text{ lb/cu ft})} = 6.61 \text{ ft}^4/\text{sec/Hp}$$

$$Q_{\text{pump}} = \frac{(20)(6.61)}{(15 + 81 * 2.54)} = \underline{0.60 \text{ cfs (269 gpm)}}$$

Received
FEB 06 2026
OWRD

Note: minor frictional losses upstream of the pressure gauge (pump column, etc.) accounted for by the 2.54 ft H₂O/psi conversion factor (versus 2.31 ft H₂O/psi).

5. Measured Pump Capacity (using meter if meter was present and system was operating)

INITIAL METER READING	ENDING METER READING	DURATION OF TIME OBSERVED	TOTAL PUMP OUTPUT (IN CFS)
58,777,790 gallons	58,778,300 gallons	1 minute, 56 seconds	0.589 cfs (264 gpm)

Reminder: For pump calculations use the reference information at the end of this document.

B. Gravity Flow Pipe

(THE DEPARTMENT TYPICALLY USES THE HAZEN-WILLIAM'S FORMULA FOR A GRAVITY FLOW PIPE SYSTEM)

1. Does the diversion involve a gravity flow pipe? NO

If "NO", items 2 through 4 relating to this section may be deleted.

C. Gravity Flow Canal or Ditch

(THE DEPARTMENT TYPICALLY USES MANNING'S FORMULA FOR CANALS AND DITCHES)

1. Does the diversion involve a gravity flow ditch or canal? NO

If "NO", items 2 through 4 relating to this section may be deleted.

D. Additional notes or comments related to the system:

Water is diverted using a bankside, skid-mounted centrifugal pump with a 4-inch aluminum suction line equipped with a Sure-Flo SCS4 self-cleaning fish screen. The diverted water passes through a filter system and is then conveyed by pipe to a drip irrigation system that applies water for irrigation of the hazelnut orchard.

Received
 FEB 06 2026
 OWRD

Received
 FEB 06 2026
 OWRD

SECTION 5 CONDITIONS

All conditions contained in the transfer final order, or any extension final order shall be addressed. Reports that do not address all performance related conditions will be returned.

1. Time Limits:

Describe how the water user has complied with each of the development timelines established in the transfer final order and any extensions of time issued for the transfer:

	DATE FROM TRANSFER	DATE THE NEW AND/OR ADDITIONAL POD(S) WERE READY FOR USE *THIS DATE MUST FALL BETWEEN THE "ISSUANCE DATE" AND THE "COMPLETENESS DATE"
ISSUANCE DATE	05/16/2025	
COMPLETENESS DATE FROM ORDER (C)	10/01/2025	07/02/2025

* MUST BE WITHIN PERIOD BETWEEN TRANSFER FINAL ORDER, OR ANY EXTENSION FINAL ORDER ISSUANCE AND THE DATE TO COMPLETE THE CHANGE

2. Is there an extension final order(s)?
If "NO", you may delete the following table.

NO

3. Measurement Conditions:

a. Does the transfer final order, or any extension final order require the installation of a meter or other approved measuring device?
YES

If "NO", items b through f relating to this section may be deleted.

Reminder: If a meter or approved measuring device was required, the COBU map must indicate the location of the device in relation to the point of diversion.

b. Has a meter been installed?

YES

c. Meter Information

POD NAME OR #	MANUFACTURER	SERIAL #	CONDITION (WORKING OR NOT)	CURRENT METER READING	DATE INSTALLED
North River POD	Netafim	21-100107932	Working	58,778,300 gallons	5/17/2023

If a meter has been installed, items d through f relating to this section may be deleted.

4. Recording and reporting conditions

a. Is the water user required to report the water use to the Department?

NO

If "NO", item b relating to this section may be deleted.

Received
FEB 06 2026
OWRD

5. Fish Screening

a. Are any points of diversion required to be screened to prevent fish from entering the point of diversion? **YES;**
required for the new point of diversion added by the transfer.

If "NO", items b through e relating to this section may be deleted.

Reminder: If fish screening devices were required, the COBU map must indicate their location in relation to the point of diversion.

b. Has the fish screening been installed? **YES**

c. When was the fish screening installed?

DATE	BY WHOM
2023	Knox Irrigation

Reminder: If the permit or transfer final order was issued on or after February 1, 2011, the fish screen is required to be approved by the Oregon Department of Fish and Wildlife regardless of the rate of diversion.

d. If the diversion **involves a pump and** the total diversion rate of all rights at the point of diversion is less than 225 gpm (0.5 cfs) and the permit was issued prior to February 1, 2011:

- Has the self-certification form previously been submitted to the Department? **N/A**

If not, go to <https://www.oregon.gov/OWRD/Forms/Pages/default.aspx>, complete and attach a copy of the 'ODFW Small Pump Screen Self Certification' form to this claim, and send a copy of it to the Oregon Department of Fish and Wildlife (ODFW).

Reminder: Failure to submit evidence of a timely installed fish screen may result in an unfavorable determination. The ODFW self certification form needs to have been previously submitted or be attached to this form.

e. If the diversion does **not involve a pump or** the total diversion rate of all rights at the point of diversion is 225 gpm (0.5 cfs) or greater:

- Has the ODFW approval been previously submitted? **YES;**
required only for the new point of diversion added by the transfer (Attachment 3).

If not, contact and work with ODFW to ensure compliance. To demonstrate compliance, provide signed documentation from ODFW. A form is available at:
<https://www.oregon.gov/OWRD/Forms/Pages/default.aspx>

Reminder: Failure to submit evidence of a timely installed fish screen may result in an unfavorable determination. In order to receive a favorable approval, the ODFW/WRD "Fish Screen Inspection" form needs to have been previously submitted or be attached to this form.

6. By-pass Devices

a. Are any points of diversion required to have a by-pass device to prevent fish from entering the point of diversion? **YES;**
however, ODFW determined that bypass was not required (Attachment 3).

If "NO", items b and c relating to this section may be deleted.

Reminder: If by-pass devices were required, the COBU map must indicate their location in relation to the point of diversion.

7. Other conditions required by the transfer final order or extension final order:

- a. Was the water user required to restore the riparian area if it was disturbed? NO
- b. Was a fishway required? NO
- c. Other conditions? NO

If "YES" to any of the above, identify the condition and describe the water user's actions to comply with the condition(s):

SECTION 6 ATTACHMENTS

Provide a list of any additional documents you are attaching to this report:

ATTACHMENT NAME	DESCRIPTION
Attachment 1	Claim of Beneficial Use Map
Attachment 2	Water Right Transfer Information
Attachment 3	ODFW Correspondence

Received
FEB 06 2026
OWRD

Received
FEB 06 2026
OWRD

SECTION 7

CLAIM OF BENEFICIAL USE MAP

The Claim of Beneficial Use Map must be submitted with this claim. Claims submitted without the Claim of Beneficial Use map will be returned. The map shall be submitted on polyester film at a scale of 1" = 1320 feet, 1" = 400 feet, or the original full-size scale of the county assessor map for the location.

For the purpose of this Claim, the map identifying the location of the place of use does not require a new survey. The location of the place of use identified on the Claim map should be based on the original right of record at the time the transfer final order was issued. In transfers approved for additional points of diversion, the original points must be identified the map based on the original right of record at the time the transfer final order was issued.

Provide a general description of the survey method used to prepare the map. Examples of possible methods include, but are not limited to, a traverse survey, GPS, or the use of aerial photos. If the basis of the survey is an aerial photo, provide the source, date, series and the aerial photo identification number.

The point of diversion, visible system components, and the place of use were visited during the site inspection. The location of the point of diversion and the extent of the place of use were obtained from a field survey completed during the site inspection and an aerial photo [7/01/2024, GoogleEarth]. The map was created using Geographic Information System (GIS) software and spatial datasets obtained from ESRI, United States Geological Survey (USGS), and Bureau of Land Management (BLM), Benton County, Lane County, Oregon Water Resources Department (OWRD). Additional data and information specific to the property appurtenant to the water right and the use water of under the water right described in this Claim of Beneficial Use report were obtained from the water user.

Received

FEB 06 2026

OWRD

Map Checklist

Please be sure that the map you submit includes ALL the items listed below.
(Reminder: Incomplete maps and/or claims may be returned.)

- Map on polyester film
- Appropriate scale (1" = 400 feet, 1" = 1320 feet, or the original full-size scale of the county assessor map)
- Township, Range, Section, Donation Land Claims, and Government Lots
- If irrigation, number of acres irrigated within each projected Donation Land Claims, Government Lots, Quarter-Quarters
- Locations of fish screens and/or fish by-pass devices in relationship to point of diversion
- Locations of meters and/or measuring devices in relationship to point of diversion or appropriation
- N/A** Conveyance structures illustrated (pumps, reservoirs, pipelines, ditches, etc.) ***Not required for this type of Claim of Beneficial Use**
- Point(s) of diversion or appropriation (illustrated and coordinates)
- Tax lot boundaries and numbers
- Source illustrated if surface water
- Disclaimer ("This map is not intended to provide legal dimensions or locations of property ownership lines")
- Application and permit number or transfer number
- North arrow
- Legend
- CWRE stamp and signature

Received
FEB 06 2026
OWRD

Received
FEB 06 2026
OWRD

Attachment 1
Claim of Beneficial Use Map

Claim of Beneficial Use

Transfer T-14090

A Water Right held by Hubbard Family LLC
Township 15 South, Range 4 West, Section 8 (W.M.)
Benton and Lane County

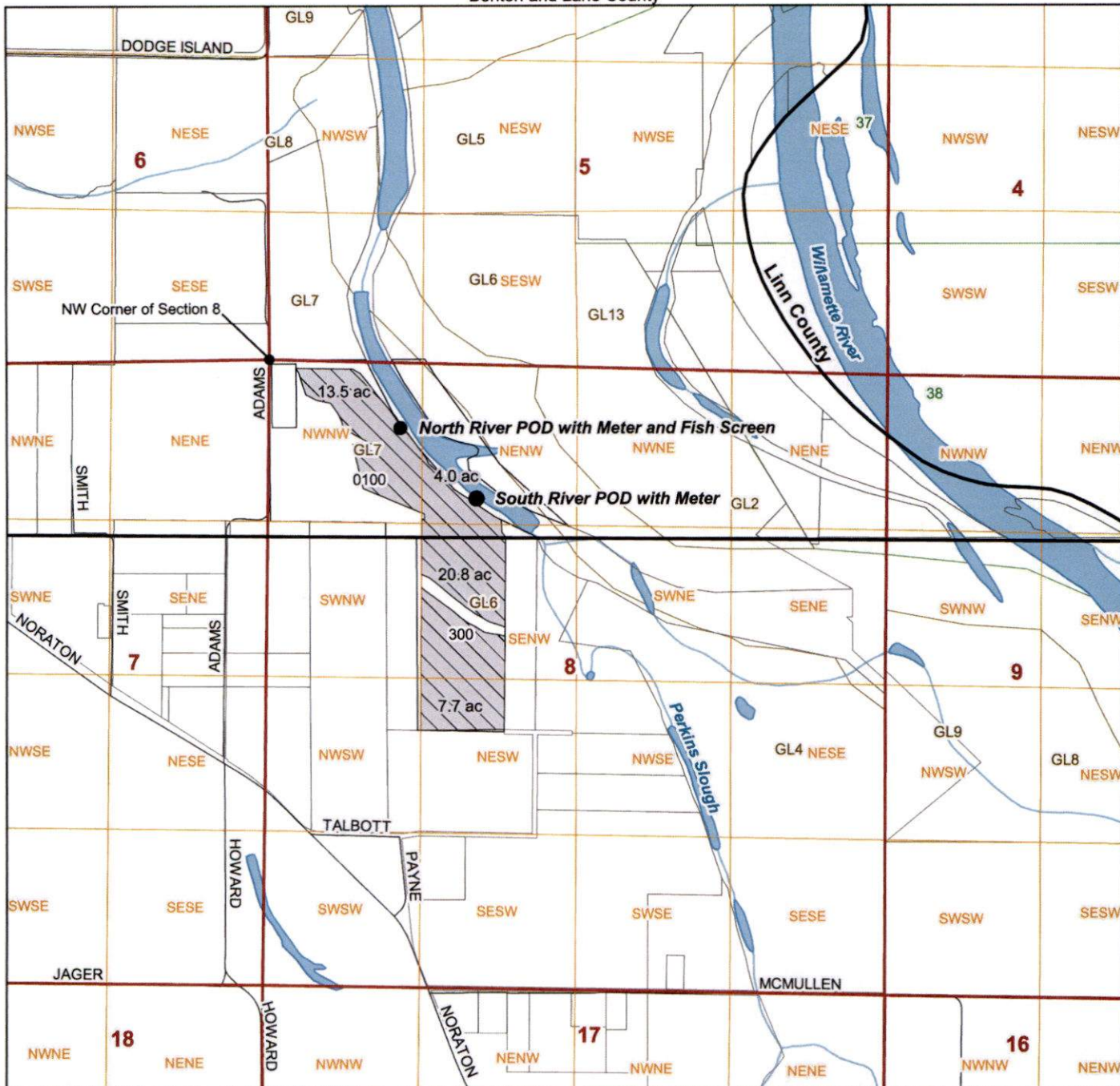

LEGEND

- Point of Diversion (POD)
- ▨ Place of Use (POU), 46.0 ac
- Tax lots
- Roads
- Waterbody
- Watercourse

POD Location Description

South River POD: 1,160 feet South and 1800 feet East from NW corner of Section 8 (NENW), Township 15 South, Range 4 West (WM)

North River POD: 510 feet South and 1,135 feet East from the NW corner of Section 8 (NWNW), Township 15 South, Range 4 West (WM)

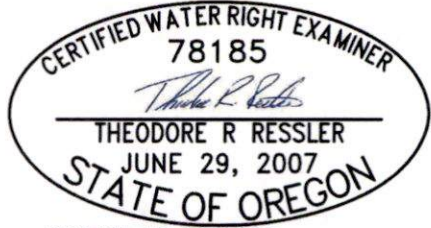

Received
FEB 06 2026

OWRD

RENEWS: 12-31-2026

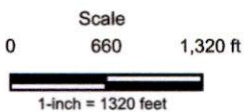

Date: 1/9/2026
Data Sources: Benton County, Lane County, OWRD, USGS, BLM
Disclaimer: This map is not intended to provide legal dimensions or property ownership lines.



Project\Hubbard_Family\0_GIS\1_SWR_Files\1_SWR_Maps\Hubbard.cgr

Received

FEB 06 2026

OWRD

Attachment 2
Water Right Transfer Information

4. On March 4, 2024, the Department issued a Preliminary Determination proposing to approve Transfer T-14090 and mailed a copy to the applicant. Additionally, notice of the Preliminary Determination for the transfer application was published on the Department's weekly notice on March 5, 2024, pursuant to ORS 540.520 and OAR 690-380-4020. No protests were filed in response to the notice.

5. The right to be transferred is as follows:

Certificate: 14153 in the name of RICHARD C KUEHNER (perfected under Permit S-12753)

Use: IRRIGATION OF 46.0 ACRES

Priority Date: JULY 30, 1937

Rate: 0.58 CUBIC FOOT PER SECOND

Limit/Duty: The amount of water used for irrigation, together with the amount secured under any other right existing for the same lands, shall be limited to ONE-EIGHTIETH of one cubic foot per second per acre, or its equivalent for each acre irrigated, and shall be further limited to a diversion of not to exceed 2.5 acre-feet per acre for each acre irrigated during the irrigation season of each year.

Source: WILLAMETTE RIVER, tributary of the COLUMBIA RIVER

Authorized Point of Diversion:

Twp	Rng	Mer	Sec	Q-Q
15 S	4 W	WM	8	NE NW

Authorized Place of Use:

IRRIGATION						
Twp	Rng	Mer	Sec	Q-Q	GLot	Acres
15 S	4 W	WM	8	NE NW	7	4.0
15 S	4 W	WM	8	NW NW	7	13.5
15 S	4 W	WM	8	SE NW	6	20.8
15 S	4 W	WM	8	NE SW		7.7
Total						46.0

Received
FEB 06 2026
OWRD

6. Certificate 14153 does not describe the original point of diversion (POD), the applicant has provided a name for this original POD describing it as South River POD.

7. Transfer Application T-14090 proposes an additional point of diversion approximately 890 feet upstream to:

Twp	Rng	Mer	Sec	Q-Q	GLot	Measured Distances
15 S	4 W	WM	8	NW NW	7	NORTH RIVER POD - 510 FEET SOUTH AND 1135 FEET EAST FROM THE NW CORNER OF SECTION 8

8. The Oregon Department of Fish and Wildlife (ODFW) has determined that a fish screening and/or by-pass device is necessary at the new point of diversion to prevent fish from entering the diversion and/or safely transport fish back to the body of water from which the fish were diverted and that the diversion is not currently equipped with an appropriate

fish screening and/or by-pass device. This diversion may be eligible for screening cost share funds.

Transfer Review Criteria [OAR 690-380-0100(14), 690-380-4010(2) and 690-380-2110(2)]

9. Water has been used within the five-year period prior to submittal of Transfer Application T-14090 according to the terms and conditions of the right. There is no information in the record that would demonstrate that the right is subject to forfeiture under ORS 540.610.
10. A water delivery system sufficient to use the full amount of water allowed under the existing right was present within the five-year period prior to submittal of Transfer Application T-14090.
11. The water right is subject to transfer as defined in ORS 540.505(4) and OAR 690-380-0100(14).
12. The proposed point of diversion diverts water from the same source of surface water as the authorized point of diversion, as required by OAR 690-380-2110(2).
13. The proposed change, as conditioned, would not result in enlargement of the right.
14. The proposed change, as conditioned, would not result in injury to other existing water rights.
15. All other application requirements are met.

Conclusions of Law

The additional point of diversion proposed in Transfer Application T-14090 is consistent with the requirements of ORS 540.505 to 540.580 and OAR 690-380-5000.

Now, therefore it is ORDERED:

1. The additional point of diversion proposed in Transfer Application T-14090 is approved.
2. The right to the use of the water is restricted to beneficial use at the place of use described and is subject to all other conditions and limitations contained in Certificate 14153 and any related decree.
3. Approval of this transfer application does not constitute nor grant legal access onto or through another person's property for purposes of accessing the new point of diversion.
4. Water right Certificate 14153 is cancelled.
5. The quantity of water diverted at the new additional point of diversion (North River POD), together with that diverted at the original point of diversion (South River POD), shall not exceed the quantity of water lawfully available at the original point of diversion (South River POD).

6. Water shall be acquired from the same source of surface water as the original point of diversion (South River POD).
7. Water use measurement conditions:
 - a. Before water use may begin under this order, the water user shall install a totalizing flow meter, or, with prior approval of the Director, another suitable measuring device, at each point of diversion (new and existing).
 - b. The water user shall maintain the meters or measuring devices in good working order.
 - c. The water user shall allow the Watermaster access to the meters or measuring devices; provided however, where the meters or measuring devices are located within a private structure, the Watermaster shall request access upon reasonable notice.
8. Prior to diverting water, the water user shall install a fish screening and/or by-pass device, as appropriate, at the new point of diversion consistent with the Oregon Department of Fish and Wildlife's (ODFW) design and construction standards. Prior to installation, the water user shall obtain written approval from ODFW that the required screen and/or by-pass device meets ODFW's criteria. Prior to submitting a Claim of Beneficial Use, the water user must obtain written approval from ODFW that the required screening and/or by-pass device was installed to the state's criteria. The water user shall maintain and operate the fish screen and/or by-pass device, as appropriate, at the point of diversion consistent with ODFW's operational and maintenance standards.
9. Full beneficial use of the water shall be made, consistent with the terms of this order, on or before **October 1, 2025**. A Claim of Beneficial Use prepared by a Certified Water Right Examiner shall be submitted by the applicant to the Department within one year after the deadline for completion of the change and full beneficial use of the water.
10. After satisfactory proof of beneficial use is received, a new certificate confirming the right transferred will be issued.

Dated in Salem, Oregon on **MAY 16 2024**

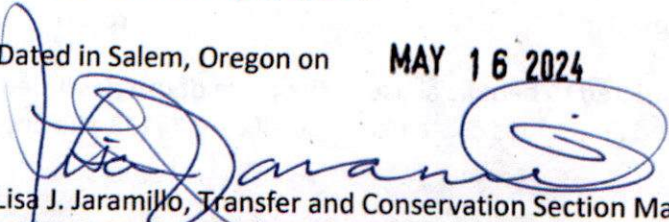
Lisa J. Jaramillo, Transfer and Conservation Section Manager, for
DOUGLAS E. WOODCOCK, ACTING DIRECTOR
Oregon Water Resources Department

Mailing date: **MAY 17 2024**

Received
FEB 06 2026
OWRD

Received
FEB 06 2026
OWRD

Attachment 3
ODFW Correspondence



Oregon

Tina Kotek, Governor

Department of Fish and Wildlife
The Dalles Screen Shop
3561 Klindt Drive
The Dalles, OR 97058
(541) 296-8026
FAX (541) 296-7889
odfw.com

March 20, 2023



Attn. Meredith Morgan
Hubbard Family LLC
1145 Raleigh Road
Glenview, IL 60025

RE: Transfer T-14090

To whom it may concern,

This letter acts as a fish screen preapproval letter regarding fish screening and bypass device requirements set forth by the Oregon Water Resources Department for T-14090.

The fish screen that has been selected is a Sure-Flo SCS4 self-cleaning fish screen. This model of self-cleaning screen, when installed and maintained properly is capable of effectively screening up to 259 gpm, or 0.57 cfs, while protecting all age classes of anadromous salmonids from entrapment and impingement. ODFW concludes that the proposed fish screen will meet National Marine Fisheries Service fish screening criteria.

If there are any questions regarding the preapproval of this screen for Transfer T-14090, please call me at 541-296-8026

Sincerely,

 3/20/2023

Toby Schuyler

Fish Screens and Passage Coordinator

CC. Ted Ressler : Summit Water Resources LLC

Received
FEB 06 2026
OWRD



Oregon

Tina Kotek, Governor

Department of Fish and Wildlife
The Dalles Screen Shop
3561 Klindt Drive
The Dalles, OR 97058
(541) 296-8026
Fax (541) 296-7889
odfw.com

November 10, 2023

Attn. Meredith Morgan
Hubbard Family LLC
1145 Raleigh RD
Glenview, IL 60025

RE: Transfer T-14090

To whom it may concern,

Oregon Department of Fish and Wildlife has reviewed the fish screen associated with your point of diversion at Perkins Slough a tributary of the Willamette River, N 44.286276 W -122.87769, for transfer T-14090. This site was inspected virtually with photos submitted by the landowner.

The fish screen that has been installed at this point of diversion is a Sure-Flo SCS4 end of pipe self-cleaning screen, when installed and maintained properly is capable of screening up to 0.57 cfs or 259 gpm, while protecting all age classes of native fish present from entrapment and impingement. ODFW concludes that this screen will meet current state and federal fish screening criteria. A by-pass device is not required at this point of diversion as this is an end of pipe screen.

This approval is contingent on the following: the screen is installed prior to any withdrawal of water, the screen is installed so that the effective screen area is submerged during operation, the screen is regularly inspected and maintained to ensure it remains in working order, including removing debris as necessary, and the screen is annually inspected when it is not in use.

If you have any questions regarding this letter, please contact me at 541-296-8026

Sincerely,

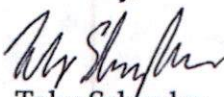
 11/10/2023
Toby Schuyler

NW Region Fish Screen and Passage Coordinator

Received
FEB 06 2026
OWRD



February 2, 2026

Certificates Section
Oregon Water Resources Department
725 Summer Street NE, Suite A
Salem, Oregon 97301-1271

Subject: Claim of Beneficial Use for Transfer T-14090

Jonnine or Codi:

On behalf of the permittee, please find enclosed Claim of Beneficial Use (COBU) report for Transfer T-14090 accompanied by a check in the amount of \$345 for payment of the COBU submittal fee. Please do not hesitate to contact me at 503-701-4535 with questions about the enclosed COBU.

Respectfully submitted,

Theodore Ressler, RG, CWRE
Summit Water Resources LLC

Enclosures:

Claim of Beneficial Use for Transfer T-14090
Check 1614 in the amount of \$345

Cc: Meredith Morgan – Hubbard Family LLC
Doug Morgan

Received
FEB 06 2026
OWRD