

Claim of Beneficial Use

Transfer T-14090

A Water Right held by Hubbard Family LLC
 Township 15 South, Range 4 West, Section 8 (W.M.)
 Benton and Lane County

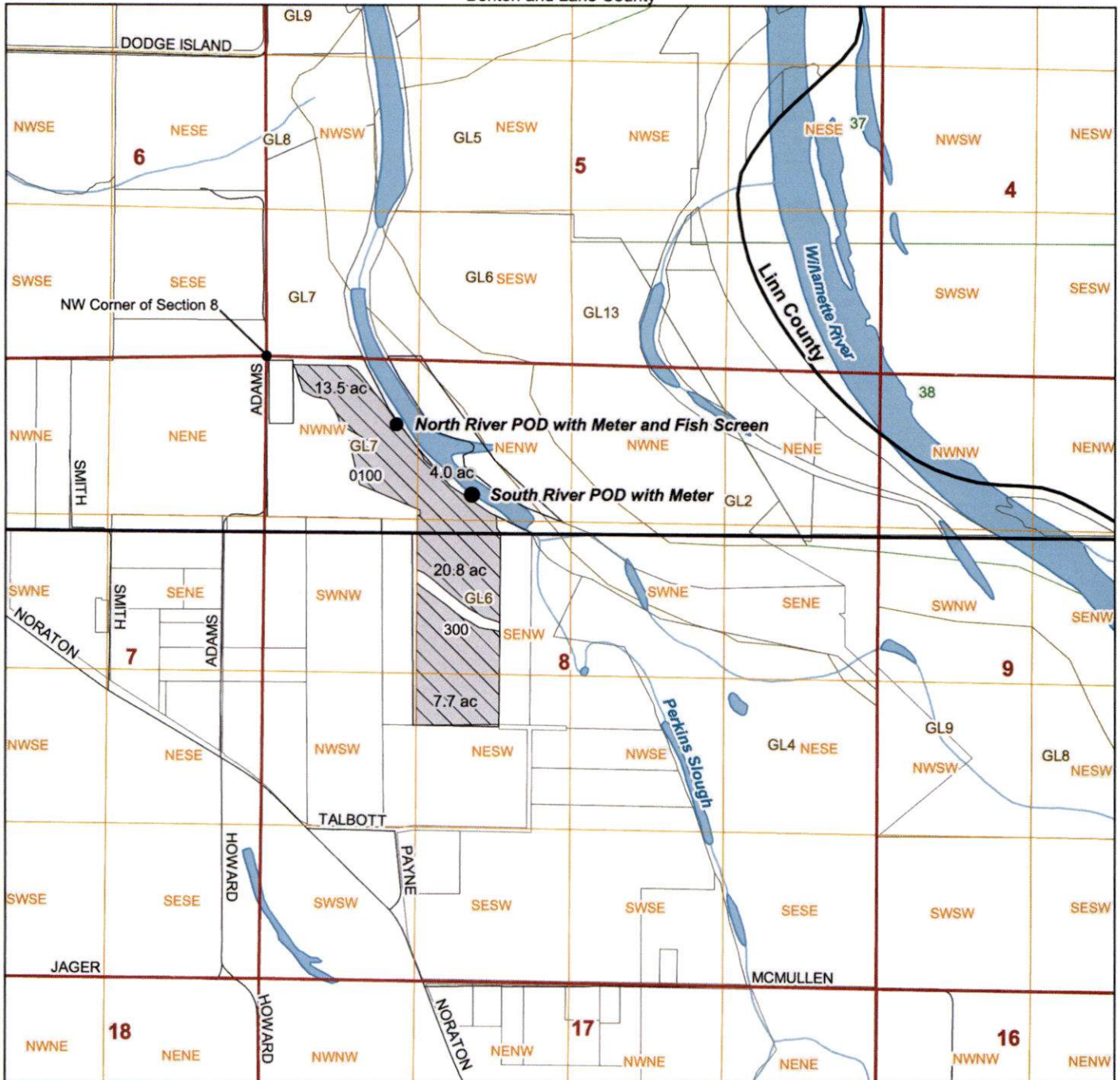

LEGEND

- Point of Diversion (POD)
- ▨ Place of Use (POU), 46.0 ac
- Tax lots
- Roads
- Waterbody
- Watercourse

POD Location Description

South River POD: 1,160 feet South and 1800 feet East from NW corner of Section 8 (NENW), Township 15 South, Range 4 West (WM)

North River POD: 510 feet South and 1,135 feet East from the NW corner of Section 8 (NWNW), Township 15 South, Range 4 West (WM)

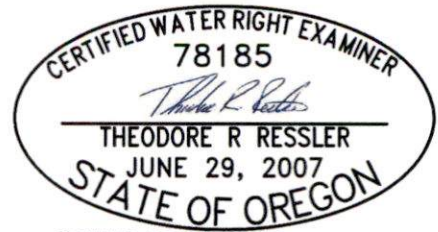

Received
 FEB 06 2026

OWRD

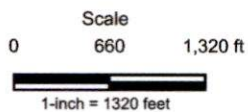

Date: 1/9/2026
 Data Sources: Benton County, Lane County, OWRD, USGS, BLM
 Disclaimer: This map is not intended to provide legal dimensions or property ownership lines.

