

**STATE OF OREGON  
WATER RESOURCES DEPARTMENT**

RECEIPT # **95999**

3850 PORTLAND ROAD NE  
SALEM, OR 97310  
378-8455/378-8130 (FAX)

RECEIVED FROM: Davidson Industries  
BY: \_\_\_\_\_

APPLICATION	
PERMIT	
TRANSFER	

CASH:  CHECK: # X 24-12 OTHER: (IDENTIFY)

TOTAL REC'D \$ 200.00

**01-00-0 WRD MISC CASH ACCT**

842.010	ADJUDICATIONS	\$ <u>200.00</u>
831.087	PUBLICATIONS/MAPS	\$
830.650	PARKING FEES Name/month	\$
_____	OTHER: (IDENTIFY)	\$

**REDUCTION OF EXPENSE**

CASH ACCT.	\$
COST CENTER AND OBJECT CLASS	VOUCHER #

**03-00-0 WRD OPERATING ACCT**

**MISCELLANEOUS:**

840.001	COPY FEES	\$
850.200	RESEARCH FEES	\$
880.109	MISC REVENUE: (IDENTIFY)	\$
520.000	OTHER (P-6): (IDENTIFY)	\$

**WATER RIGHTS:**

842.001	SURFACE WATER	EXAM FEE	842.002	RECORD FEE
842.003	GROUND WATER	\$	842.004	\$
842.005	TRANSFER	\$	842.006	\$

**WELL CONSTRUCTION**

842.022	WELL DRILL CONSTRUCTOR	EXAM FEE	842.023	LICENSE FEE
842.016	WELL DRILL OPERATOR	\$	842.019	\$
_____	LANDOWNER'S PERMIT	\$	842.024	\$

**06-00-0 WELL CONST START FEE:**

842.013	WELL CONST START FEE	\$	CARD #	
_____	MONITORING WELLS	\$	CARD #	

**45-00-0 LOTTERY PROCEEDS**

864.000	LOTTERY PROCEEDS	\$
---------	------------------	----

**07-00-0 HYDRO ACTIVITY**

842.011	POWER LICENSE FEE(FW/WRD)	LIC NUMBER	\$
842.115	HYDRO LICENSE FEE(FW/WRD)		\$
_____	HYDRO APPLICATION		\$

RECEIPT # **95999**

DATED: 1-6-93

BY: D. Bushnell

**SURFACE WATER REGISTRATION CHECKLIST**

(received after July 18, 1990)

CHECK BASIN MAP  NAME MID-COAST # 18 UNADJUDICATED AREA ? OK DWR  
RECEIPT # 95999 S W R NUMBER 577  
CHECK ENCLOSURES DWR PRELIMINARY DATA BASE ENTRY DWR  
ACKNOWLEDGEMENT LETTER DWR ENTER ON STREAM INDEX \_\_\_\_\_  
CHECK QUADRANGLE MAP \_\_\_\_\_ CHECK GLO PLATS \_\_\_\_\_  
WATERMASTER CHECKLIST \_\_\_\_\_ PUBLIC NOTICE PUBLICATION SCR

**FORM REVIEW**

\_\_\_\_\_ blanks filled in  
\_\_\_\_\_ signed  
\_\_\_\_\_ date received stamped

**MAP REVIEW**

source and trib  
\_\_\_\_\_ diversion point location  
\_\_\_\_\_ conveyances (pipes, ditch, etc.)  
 place of use  
 scale  
 township, range, section  
 north arrow  
 CWRE stamp  
 disclaimer  
\_\_\_\_\_ date survey was performed  
\_\_\_\_\_ P.O.B. of survey  
\_\_\_\_\_ dimensions and capacity of diversion system  
 "beneficial use" type title  
 "permanent-quality" paper

WATER RIGHT RECORD CHECK \_\_\_\_\_ FIELD INSPECTION \_\_\_\_\_  
FINAL FILE REVIEW \_\_\_\_\_ FINAL DATA BASE ENTRY \_\_\_\_\_  
ENTER ON PLAT CARDS \_\_\_\_\_

November 16, 1993

WATER  
RESOURCES  
DEPARTMENT

DARYL PETERS  
DAVIDSON INDUSTRIES INC  
PO BOX 7  
MAPLETON OR 97453

RE: SWR-573 THRU SWR-580

Dear Mr Peters,

This will acknowledge the receipt of maps to support the pre-1909 vested water right claims in the name of DAVIDSON INDUSTRIES INC. I have added the maps to the files for a complete review in the future. Thank you for your attention to this matter. If you have any questions, please give me a call.

Sincerely,

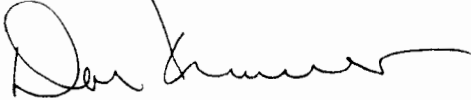

Don Knauer  
Adjudication Specialist

J:\W\S\C\5\SWR-0573.005



3850 Portland Rd NE  
Salem, OR 97310  
(503) 378-3739  
FAX (503) 378-8130

October 18, 1993

MICHAEL N. MCALLISTER  
11301 E. MAPLETON RD  
MAPLETON OR 97453

RE: SWR-573 THRU SWR-580

Dear Mr McAllister,

This will acknowledge the maps you submitted in support of the pre-1909 vested water right claims under the above files. I have reviewed the maps and have noted the necessary additions or corrections. In all cases the revisions are the same; the scale, cross-hatching and mylar. If you have any questions, please give me a call.

Sincerely,

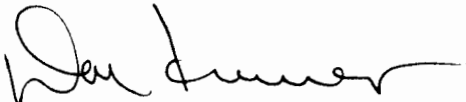

Don Knauer  
Adjudication Specialist

J:\WISIC\SWR-0573.004

577



3850 Portland Rd NE  
Salem, OR 97310  
(503) 378-3739  
FAX (503) 378-8130

STATE OF OREGON  
WATER RESOURCES DEPARTMENT  
INTEROFFICE MEMO

June 1, 1993

TO: SWR FILES 573 THRU 590

FROM: DON KNAUER

SUBJECT: CWRE MAP

MIKE MCCALLISTER, CWRE called to say he will do the survey and prepare the map for these claims. He hopes to get to the field work by august of this year. He said we could expect the maps near the first of september.

SEPT 7, 1993

MIKE MCCALLISTER CALLED TO SAY IT WILL  
BE A COUPLE MORE MONTHS BEFORE  
THE MAP WILL BE COMPLETED. HE'LL SEND  
A PRELIMINARY MAP FOR REVIEW.  
WEEK

STATE OF OREGON  
WATER RESOURCES DEPARTMENT  
INTEROFFICE MEMO

June 1, 1993

TO: SWR FILES 573 THRU 590

FROM: DON KNAUER

SUBJECT: CWRE MAP

MIKE MCCALLISTER, CWRE called to say he will do the survey and prepare the map for these claims. He hopes to get to the field work by august of this year. He said we could expect the maps near the first of september.

May 17, 1993

MIKE MCALLISTER  
11301 E MAPLETON ROAD  
MAPLETON OR 97453

RE: Surface Water Registration Map

Dear MR MCALLISTER,

DAVIDSON INDUSTRIES INC has indicated to the Oregon Water Resources Department (WRD) that you have been hired to prepare the claim of beneficial use map for their Surface Water Registration Statements. Would you please inform me of your anticipated schedule of map preparation and submission to the WRD.

Please mark all correspondence related to these claims with the appropriate file number, SWR-573 thru SWR-580.

Sincerely,



Don Knauer  
Adjudication Specialist

J:\WP51\SWR\CLAIMANT\5\SWR-0577.002



3850 Portland Rd NE  
Salem, OR 97310  
(503) 378-3739  
FAX (503) 378-8130

May 3, 1993

---

WATER  
RESOURCES  
DEPARTMENT

---

DAVIDSON INDUSTRIES, INC.  
PO BOX 7  
MAPLETON OR 97453

Dear SIRS/MADAMS,

This will acknowledge that your Surface Water Registration Statement in the name of DAVIDSON INDUSTRIES, INC. has been received by our office. The fees in the amount of \$200.00 have been received and our receipt #95999 is enclosed. Your registration statement has been numbered SWR-577.

The map you submitted with your claim is not acceptable. ORS 539.240 (2) (d) requires the map be prepared by a Certified Water Right Examiner (CWRE). Within 60 days of this letter you must send a letter to this address indicating you have contracted with a CWRE to prepare your map. You should send your letter to my attention. In your letter you must identify the name of the CWRE who will prepare your registration statement map. We will contact the CWRE to arrange a map submittal deadline.

We will not be able to process your claim until we have received your map. If you have any questions regarding this process, please do not hesitate to give me a call.

Please feel free to contact this office if you have any questions.

Sincerely,

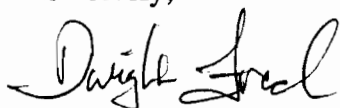

Dwight French  
Adjudication Section

Enclosure

J:\WP51\SWR\CLAIMANT\5\SWR-0577.001



---

3850 Portland Rd NE  
Salem, OR 97310  
(503) 378-3739  
FAX (503) 378-8130



RECEIVED

JAN 05 1993



WATER RESOURCES DEPT.  
SALEM, OREGON

T.17S, R.11W.

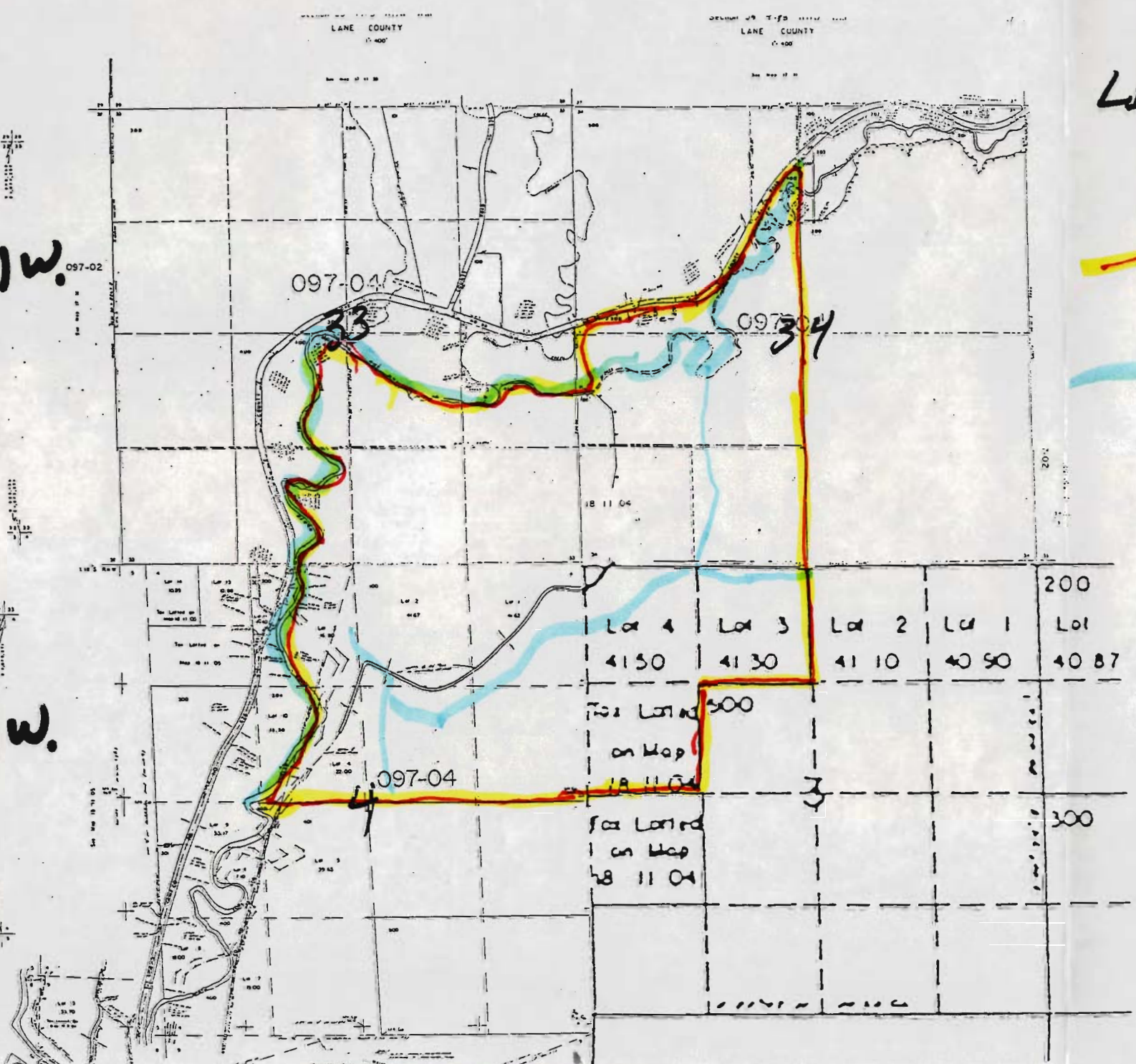
T.18S, R.11W.



# LEGEND

-  Davidsons Ownership
-  Stock Watering





**RECEIVED**

NOV 15 1993

WATER RESOURCES DEPT.  
SALEM, OREGON**STATE OF OREGON  
WATER RESOURCES DEPARTMENT****SURFACE WATER REGISTRATION STATEMENT  
PRE-1909 VESTED WATER RIGHT CLAIM**

1. Name of Registrant: Davidson Industries, Inc.  
Mailing Address: P.O. Box 7  
Mapleton, OR 97453 Telephone No: (503) 268-4422
2. Source of water: North Fork Siuslaw River  
Tributary to: Unnamed tributary to North Fork Siuslaw River
3. Purpose(s) for which water is used: Stock water  
(Irrigation, Stockwater, Domestic, Hydroelectric power, Industrial, Etc.)  
If irrigation, total number of acres irrigated: \_\_\_\_\_
4. Priority Date  
a) Date of first use: April 19, 1899  
b) Date water use development first initiated: April 19, 1899  
c) Name of party who initiated development: Julius A. Pond
5. Amount of water claimed: 0.01, in CFS or GPM  
(Water put to beneficial use)
6. Location of place of use:  
3, 4 Sections, Township 18 ~~N~~/S, Range 11 ~~E~~/W.  
33, 34 Sections, Township 17 ~~N~~/S, Range 11 ~~E~~/W.  
(Attach additional pages if necessary)
7. Usual period of use: January / 01 to December / 31  
month day month day



8. Remarks: \_\_\_\_\_  
\_\_\_\_\_  
\_\_\_\_\_

9. Total fees submitted with claim: \$200.00

Notarized Statement Signed by Claimant.

STATE OF OREGON )  
 ) : ss  
County of Lane )

I, F. David Crowell, having been duly sworn,  
depose and say that I, and being the claimant of the existing surface  
water right described herein, have read the contents of this claim and  
to the best of my knowledge all of the matters stated herein  
are true and correct.

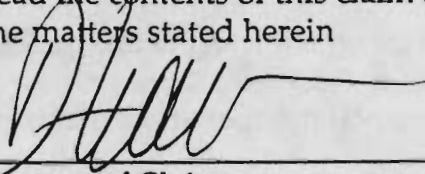

\_\_\_\_\_  
Signature of Claimant

Signed and attested before me this 31st day of December, 1992

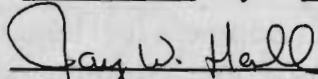

\_\_\_\_\_  
NOTARY PUBLIC for the State of Oregon  
My commission expires: 06/27/93

**THIS FORM MUST BE ACCOMPANIED BY A MAP PREPARED BY A  
CERTIFIED WATER RIGHT EXAMINER (CWRE).**

Certified Water Right Examiner

Name: Michael N. McAllister CWRE#: 082

Address: 11301 E. Mapleton Rd., Mapleton, OR 97453

Telephone: (503) 268-4326



# Davidson Industries Inc.

P. O. BOX 7 • MAPLETON, OREGON • 97453

(503) 268-4422 • FAX (503) 268-9909

"Makers of  
Douglas Fir  
Products"

November 12, 1993

RECEIVED

NOV 15 1993

WATER RESOURCES DEPT.  
SALEM, OREGON

Mr. Don Knauer  
Water Resource Dept.  
3850 Portland Rd. N.E.  
Salem, OR 97310

Dear Mr. Knauer:

Enclosed are the completed maps drawn by Mike McAllister (CWRE) of 11301 East Mapleton Road, Mapleton, Oregon 97453.

The enclosed maps are for:

SWR 573  
SWR 574  
SWR 575

SWR 577  
SWR 578  
SWR 579  
SWR 580

A separate package will be mailed later with map for SWR 576.

If you have any questions, feel free to contact Mike McAllister.

Sincerely,

DAVIDSON INDUSTRIES, INC.



Daryl Peters

DP:co

cc: Mike McAllister  
11301 East Mapleton Road  
Mapleton, OR 97453

T. 17S, R. 11W, W.M.  
 T. 18S, R. 11W, W.M.

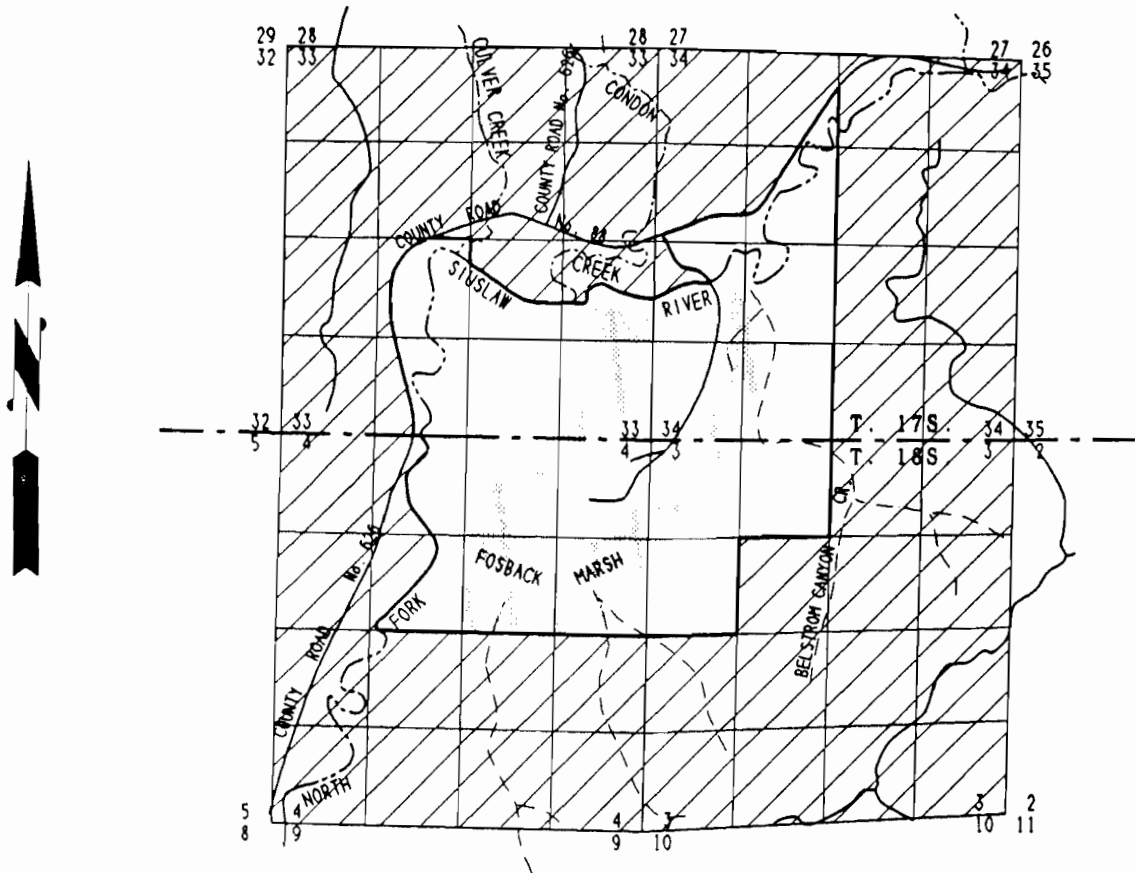

**LEGEND**

- OWNERSHIP BOUNDARY
- ROAD
- NAMED CREEK
- UNNAMED CREEK
- TOWNSHIP LINES
- RIVER
- OUTSIDE OWNERSHIP BOUNDARY

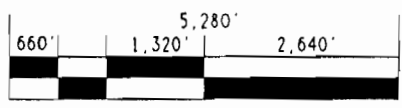

SCALE: 2" = 1 MILE  
 4" = 1 MILE

**PRE-1909 VESTED WATER RIGHT FINAL PROOF MAP**

SWR #577

IN SECTIONS 33 & 34.  
 T. 17S, R. 11W, W.M.  
 IN SECTIONS 3 & 4.  
 T. 18S, R. 11W, W.M.  
 LANE COUNTY, OR

FOR

- 1.) SCALE TO 4" = 1 MILE
- 2.) DELETE CROSS-HATCHING
- 3.) My use

BY:  
 MIKE MCALLISTER ENGINEERING  
 11901 E. MAPLETON ROAD  
 MAPLETON, OREGON 97453

NOTE:  
 THIS MAP IDENTIFIES THE LOCATION OF THE WATER RIGHT ONLY, AND IS NOT INTENDED TO F DIMENSIONS OR LOCATE PROPERTY OWNERSHIP LI





TOWNSHIP 17 S RANGE 11 W

SWR 571

Section	N E				N W				S W				S E			
	NE	NW	SW	SE	NE	NW	SW	SE	NE	NW	SW	SE	NE	NW	SW	SE
	NORTH FORK OF THE SIUSLAW RIVER															
33									X				X	X		
34					X				X	X						
	<u>BELLSTROM CANYON CR &amp; TRIBUTARY</u>															
3A									X	X	X	X				
	<u>OLIVER CREEK</u>															
33									X							

RECEIVED

OCT 14 1993

WATER RESOURCES DEPT  
SALEM, OREGON

11301 E. Mapleton Road  
Mapleton, Oregon 97453

  
**MIKE McALLISTER ENGINEERING**  
Civil Engineer • Certified Water Right Examiner

October 13, 1993

Oregon Water Resources Department  
3850 Portland Road, N.E.  
Salem, Or. 97310

Attention: Don Knauer  
Adjudication Specialist

Re: Water Rights SWR 573-580

Mr. Knauer,

Enclosed are copies of the final draft of the application maps for the above noted water rights. Please review and comment. We will then send the final mylar maps to the Oregon Water Resources Department with the other required information for filing.

Please note that I found it advantageous to use the hatch to show area outside of the ownership boundary, which is not the usual method. I hope this is acceptable, as it makes the maps more legible. Also, I could not use the brackets to show the limit of the area creeks within the quarters of quarters. It seemed better to discontinue the creeks where they would not be utilized or were not eligible for use.

If you have any other ideas that should be added please let me know. I realize you were not expecting all of the maps for this review, but it seemed convenient.

Respectfully,

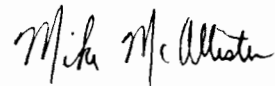

Mike McAllister  
PE, CWRE



# Davidson Industries Inc.

P. O. BOX 7 • MAPLETON, OREGON • 97453

(503) 268-4422 • FAX (503) 268-9909



"Makers of  
Douglas Fir  
Products"

May 14, 1993

**RECEIVED**

**MAY 17 1993**

WATER RESOURCES DEPT.  
SALEM, OREGON

Mr. Don Knauer  
Water Resources Dept.  
3850 Portland Rd. N.E.  
Salem, OR 97310

Dear Mr. Knauer:

Davidson Industries, Inc., has contracted with Mike McAllister (CWRE) of 11301 E. Mapleton Road, Mapleton Oregon 97453 to prepare maps for:

SWR-573  
SWR-574  
SWR-575  
SWR-576  
SWR-577  
SWR-578  
SWR-579  
SWR-580

Please feel free to contact Mike if you need.

Sincerely,

DAVIDSON INDUSTRIES, INC.

Daryl Peters

DC:bn

cc: Mike McAllister  
11301 E. Mapleton Rd.  
Mapleton, OR 97453

*Davidson Industries Inc.*

MAPLETON, OREGON 97453

bjn	DESCRIPTION	GROSS	% D/C	AMT. D	CODE	NET	FOOTAGE
	Surface Water Regist. Stmt.	Pre-1909			759	200.00	

**RECEIVED**

JAN 05 1993

WATER RESOURCES DEPT.  
SALEM, OREGON

PLEASE DETACH BEFORE DEPOSITING