

Name Susan Liebes
By _____
Address 1340 Missouri Flat, Grants Pass, OR
97526

Application No. **60051**
Permit No. **45064**
Certificate No. **56029**

Stream Index, Page No. 15-16 & 3

FEES PAID		
Date	Amount	Receipt No.
<u>4/21/80</u>	<u>35.00</u>	<u>17186</u>
FEES REFUNDED		
Date	Amount	Check No.

Date filed April 21, 1980
Priority April 21, 1980
Action suspended until OK Cert
Return to applicant _____
Date of approval 9-19-80

CONSTRUCTION

Date for beginning 9-19-81
Date for completion 10-1-82
Extended to _____
Date for application of water 10-1-83
Extended to _____

PROSECUTION OF WORK

Form "A" filed _____
Form "B" filed _____
Form "C" filed completed

FINAL PROOF

Blank mailed FEB 26 1987
Proof received _____
Date certificate issued APR 3 1987

ASSIGNMENTS				
Date	To Whom	Address	Volume	Page

REMARKS

CARD FOR A SEP 30 1981

T.37S., R.4&5W., W. M.

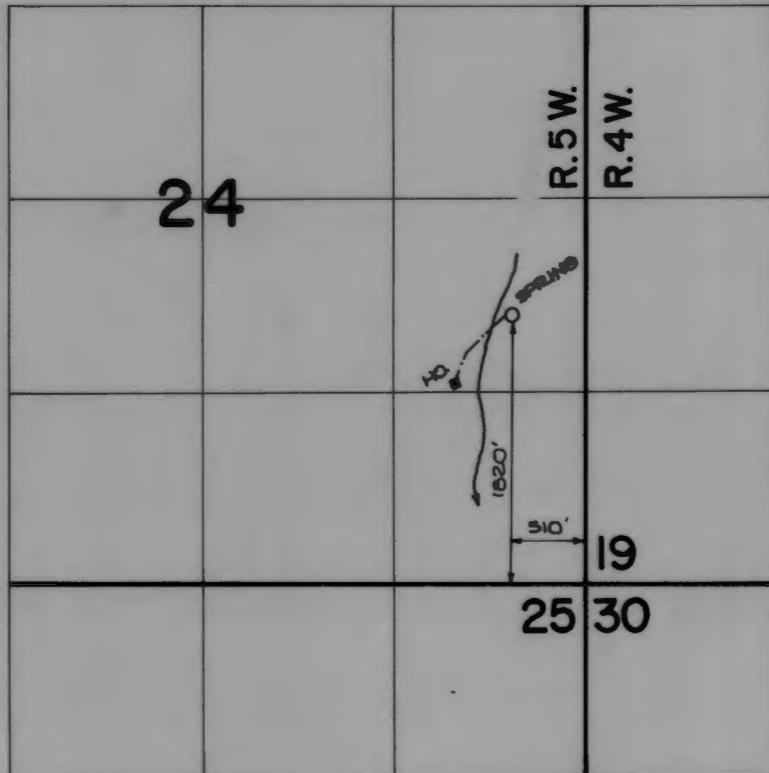

FINAL PROOF SURVEY
UNDER

Application No. **60051** Permit No. **45064**
IN NAME OF

SUSAN LIEBES

Surveyed **MAY 14, 1982**, by **B. SUND**

of 1340 Missouri Flat Road, Grants Pass, State of OR 97526,
has applied beneficially the waters of

a spring

a tributary of Rocky Creek for the purpose of
domestic use for one family including the irrigation of lawn and garden not to
exceed one-half acre in area

under Permit No. 45064 and that the use of said waters has been completed under the
terms of said permit; that the priority of the right dates from

April 21, 1980

that the amount of water for the purposes aforesaid, has been actually beneficially used in the
amount of

0.01 cubic foot per second

or its equivalent in case of rotation, measured at the point of diversion from the stream.
The point of diversion is located in the NE 1/4 SE 1/4, Section 24, T37S, R5W, WM;
1820 feet North and 510 feet West from SE corner Section 24.

The amount of water used for irrigation, together with the amount secured under any other
right existing for the same lands, shall be limited to _____ of one cubic foot per second
per acre,

and shall
conform to such reasonable rotation system as may be ordered by the proper state officer.

A description of the place of use under the right, and to which such right is appurtenant, is
as follows:

NE 1/4 SE 1/4
Section 24
Township 37 South, Range 5 West, WM

I have read the above and foregoing proof of appropriation of water; I know the contents
thereof, and that the facts therein stated are true.

IN WITNESS WHEREOF, I have hereunto set my hand this 2nd day of March,

1987

Susan Shipley
formerly Susan Liebes

T.37S., R.4&5W., W.M.

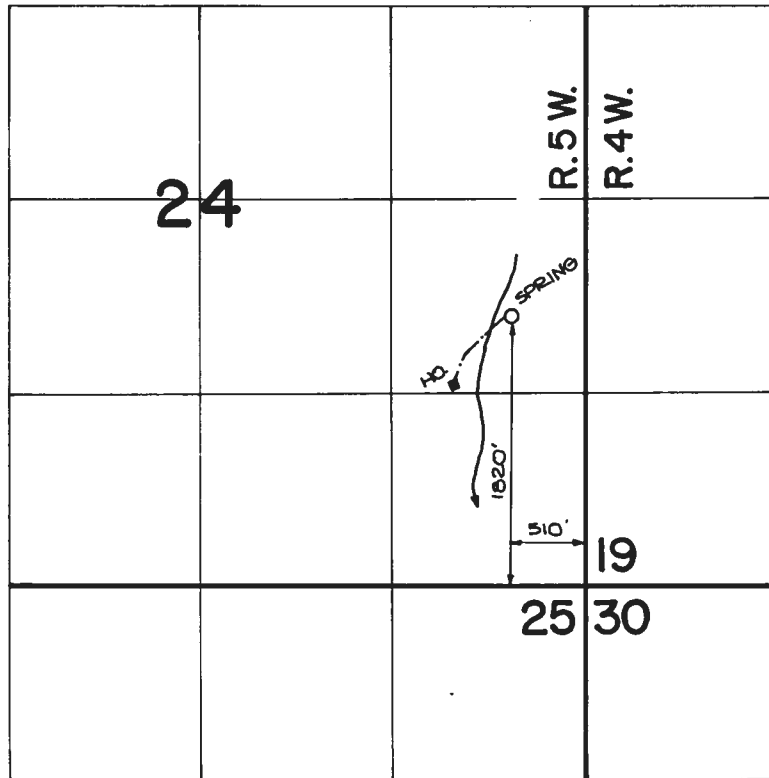

FINAL PROOF SURVEY
UNDER

Application No. ~~60051~~ Permit No. ~~45064~~..
IN NAME OF

.....**SUSAN LIEBES**.....

Surveyed **MAY 14**, 19**82**, by **B. SUND**.....

Application No. 60051

Permit No. 45064 17-1102 2:00 of EARLICK

STATE OF OREGON WATER RESOURCES DEPARTMENT RECEIVED APR 21 1980 WATER RESOURCES DEPT SEASIA, OREGON

Application for Permit to Appropriate Surface Water

I, Suson Liebes (Name of Applicant)

of 1340 Missouri Flat RD Grants Pass (Mailing Address) (City)

State of Oregon 97526 Phone No. (503) 846-6917 (Zip Code)

do hereby make application for a permit to appropriate the following described waters of the State of Oregon:

1. The source of the proposed appropriation is a spring, a tributary of Rocky creek

2. The point of diversion is to be located 1800 ft N and 450 ft W from the SE corner of Sec 24 (Public Land Survey Corner)

(If there is more than one point of diversion, each must be described)

being within the NE 1/4 of the SE 1/4 of Sec 24 Tp 37 S R 5 W, W.M., in the county of Josephine

3. Location of area to be irrigated, or place of use if other than irrigation.

Table with 5 columns: Township, Range, Section, List 1/4 1/4 of Section, List use and/or number of acres to be irrigated. Handwritten entries: 37 S, 5 W, 24, NE 1/4 SE 1/4, Dom. including 1/2 ac.

89520

4/14 P25 46296 MCR 1-587 DM

5-14-72 RES

Application No. 60051 ✓

Permit No. 45064 ✓

Permit to Appropriate the Public Waters of the State of Oregon

This is to certify that I have examined the foregoing application and do hereby grant the same SUBJECT TO EXISTING RIGHTS INCLUDING THE EXISTING FLOW POLICIES ESTABLISHED BY THE WATER POLICY REVIEW BOARD and the following limitations and conditions:

The right herein granted is limited to the amount of water which can be applied to beneficial use and shall not exceed 0.01 cubic feet per second measured at the point of diversion from the stream, or its equivalent in case of rotation with other water users, from a spring ✓

trib. Rocky Creek ✓

The use to which this water is to be applied is domestic use of one family including irrigation of not to exceed one-half acre noncommercial lawn and garden. ✓

If for irrigation, this appropriation shall be limited to - - - of one cubic foot per second or its equivalent for each acre irrigated

and shall be subject to such reasonable rotation system as may be ordered by the proper state officer.

The priority date of this permit is April 21, 1980 ✓

Actual construction work shall begin on or before September 19, 1981 and shall thereafter be prosecuted with reasonable diligence and be completed on or before October 1, 1982

Complete application of the water to the proposed use shall be made on or before October 1, 1985

WITNESS my hand this 19th day of September, 1980

[Handwritten Signature]
Water Resources Director

Application No. 60051

Permit No. 24

T 37 S R 5 W W M Sec. 24

SE Corner Sec. 24

1 inch = 1,000 ft.

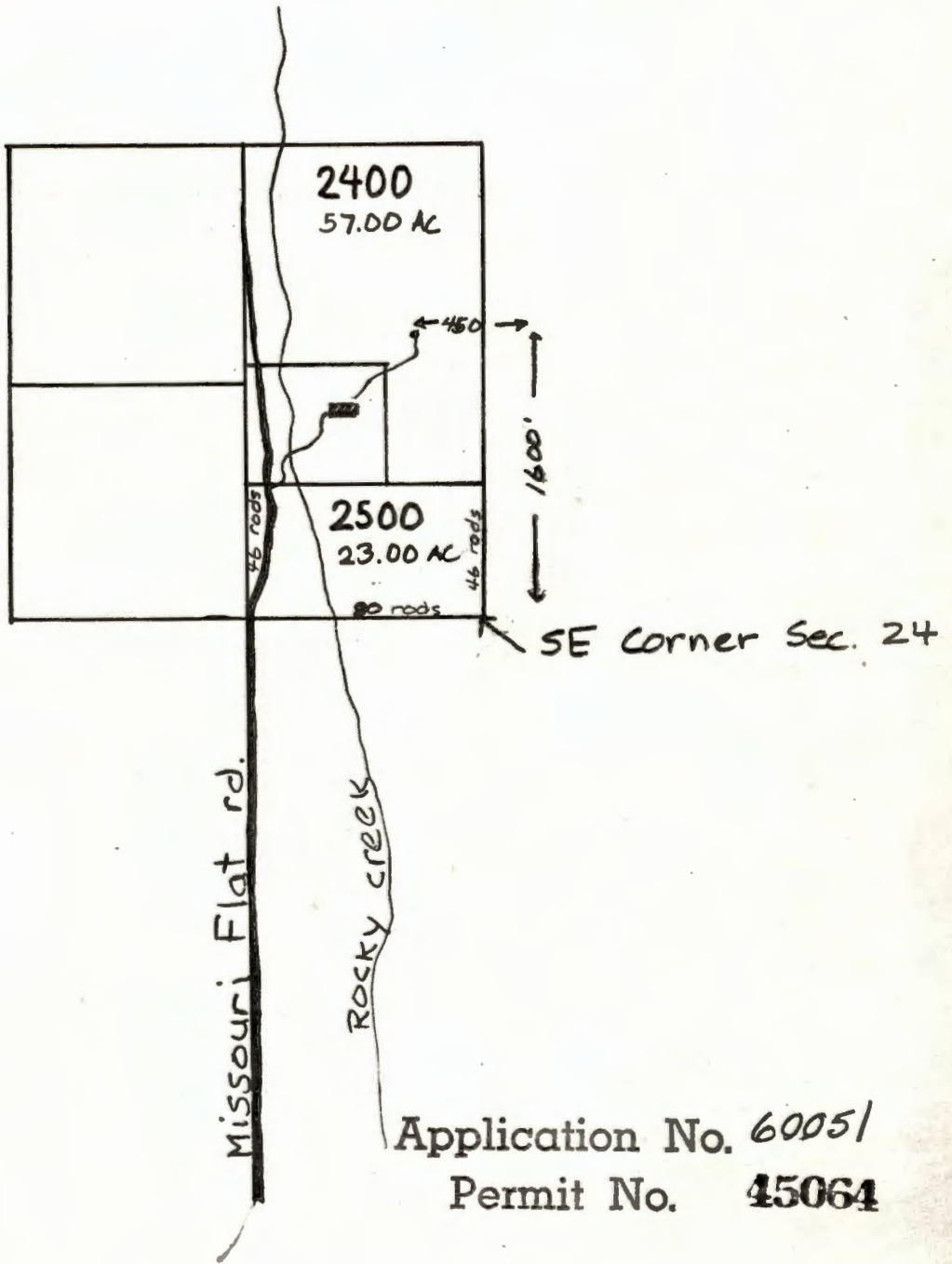

Application No. 60051

Permit No. 45064

RECEIVED

APR 1 1980

WATER RESOURCES DEPT
SALEM, OREGON

FINAL PROOF ON DOMESTIC APPLICATION No. 60051 PERMIT No. 45064
INCLUDING 1/2 ACRE

INFO: NAME: SUSAN LIEBES
ADDRESS: 1340 MISSOURI FLAT RD., GRANTS PASS

TALKED TO: SUSAN

SOURCES: SPRING AREA DUG OUT ABOUT 20' FROM CONCRETE CISTERN

SYSTEM: 20' GALV. PIPE TO 2,000 GAL CONC. TANK WITH BLACK PLASTIC PIPE TO HOUSE.

DOMESTIC USE: No. of Houses: 1

NAMES OF OWNERS LIEBES

WHICH DOM. INTENDED: SAME

DIRECTION: DIRECT

STRUCTURE: _____

PUMP: MAKE: GRAVITY

TYPE: _____

SUCT. OR SIZE _____

$$Q = \frac{(1)(6)}{(450)} = 0.0133 \text{ CFS}$$

DISCHARGE SIZE: _____

MODEL NO.: _____

RATING: _____

MOTOR: MAKE: _____

TYPE: _____

HP: _____

RPM: _____

CONNECTED DIRECT OR PULLEYS: _____

PIPE: NO. FEET:	20'	700'	150'
SIZE:	1"	1"	3/4"
TYPE:	GALV	POLY	GARDEN HOSE

SPRINKLERS: No. HEADS: 2

TYPE: GARDEN TYPE

MODEL NO.: _____

NOZZLE SIZE: 6 GPM.

MAXIMUM: 1

LIFT: FALL: 20'

SUCTON: _____

DISCHARGE: _____

PRESSURE AT HOUSE: Low

USE: DOMESTIC INCLUDING LAWN & GARDEN

TIE MONUMENTS: SIACOR SEC 15 1/2' J. PIPE

SURVEYED: PHOTO 1179-1182



FIELD ENGINEER

DATE: MAY 14, 1982

NOTE: _____

September 19, 1980

Susan Liebes
1340 Missouri Flat
Grants Pass, OR 97526

supporting data.

45064, application No. 60051 with

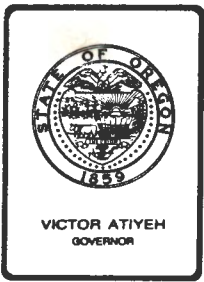

Water Resources Department

MILL CREEK OFFICE PARK

555 13th STREET N.E., SALEM, OREGON 97310

PHONE 378-3066

September 12, 1980

Susan Liebes
1340 Missouri Flat
Grants Pass, OR 97526

REFERENCE: File No. 60051

Your application numbered 60051 to appropriate water has been examined and is satisfactory for issuance of a permit.

Permits will be issued for use of water from Applegate River and its tributaries. However, water may not be available during dry periods. The water may be needed to satisfy existing rights or minimum flow standards.

Sincerely,

Ralph H. Jackson, Supervisor
Application/Permit Section

RHJ:lcj

April 24, 1980

Susan Liebes
1340 Missouri Flat,
Grants Pass, OR 97526

We have received your application for domestic along with the supporting data and fees. Our receipt number 17186 is enclosed. Your application has been filed and assigned number 60051 .

Because of the many applications which have been filed in recent months, we are temporarily behind in our processing. Your application will be examined in detail as soon as possible. We will contact you if we need any additional information.

The permit approving your application will be issued without further correspondence if no additional information is required. Thank you for your patience.

Sincerely,

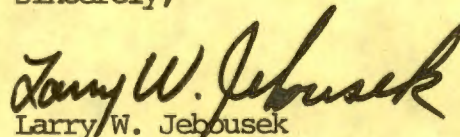
Larry W. Jebousek
Administrator
Water Rights Division

LJW:
Enclosure

Application No. 60051
Permit No. 45064

Order No. 49-75475

Description Sheet

Beginning at a point 46 rods (759 feet) North along the West line of the East Half of the Southeast Quarter of Section 24, Township 37 South, Range 5 West of the Willamette Meridian, Josephine County, Oregon from the South line of said section; thence East 792 feet; thence North parallel to the West line of the East Half of the Southeast Quarter of said section, 660 feet; thence West 792 feet to said West line; thence South along said West line, 660 feet to the true point of beginning.

Exceptions Cont.

-3-

Order No. 49-75475

7. As disclosed by the assessment and tax roll, the premises herein have been specially assessed as "Small Tract Option". If the land becomes disqualified for this special assessment under the statute, an additional tax plus interest may be levied for the last five or lesser number of years in which the land was subject to this special land use assessment.

8. 1976-77 taxes, a lien in an amount to be determined, but not yet payable.

* NOTE: TOGETHER WITH an easement for spring water and transportation thereof as disclosed by an instrument recorded April 26, 1976 in Volume 316, Page 1524.

NOTE: We find no judgments or United States Internal Revenue Liens against Susan Liebes or Narcissa Kelly.

NOTE: Taxes for the year 1975-76 in the amount of \$505.34, paid in full. Code 5, Account No. 37-5-00, Tax Lot No. 2400. (Note: This tax lot covers additional property).

TRANSAMERICA TITLE INSURANCE CO.

BY:

David R. Aldrich
David R. Aldrich
Manager

RECEIVED

APR 21 1980

WATER RESOURCES DEPT
SALEM, OREGON



Application No. 60051

T 37 S R 5 W W M Sec. 24

SE Corner Sec. 24

1 inch = 1,000 ft.

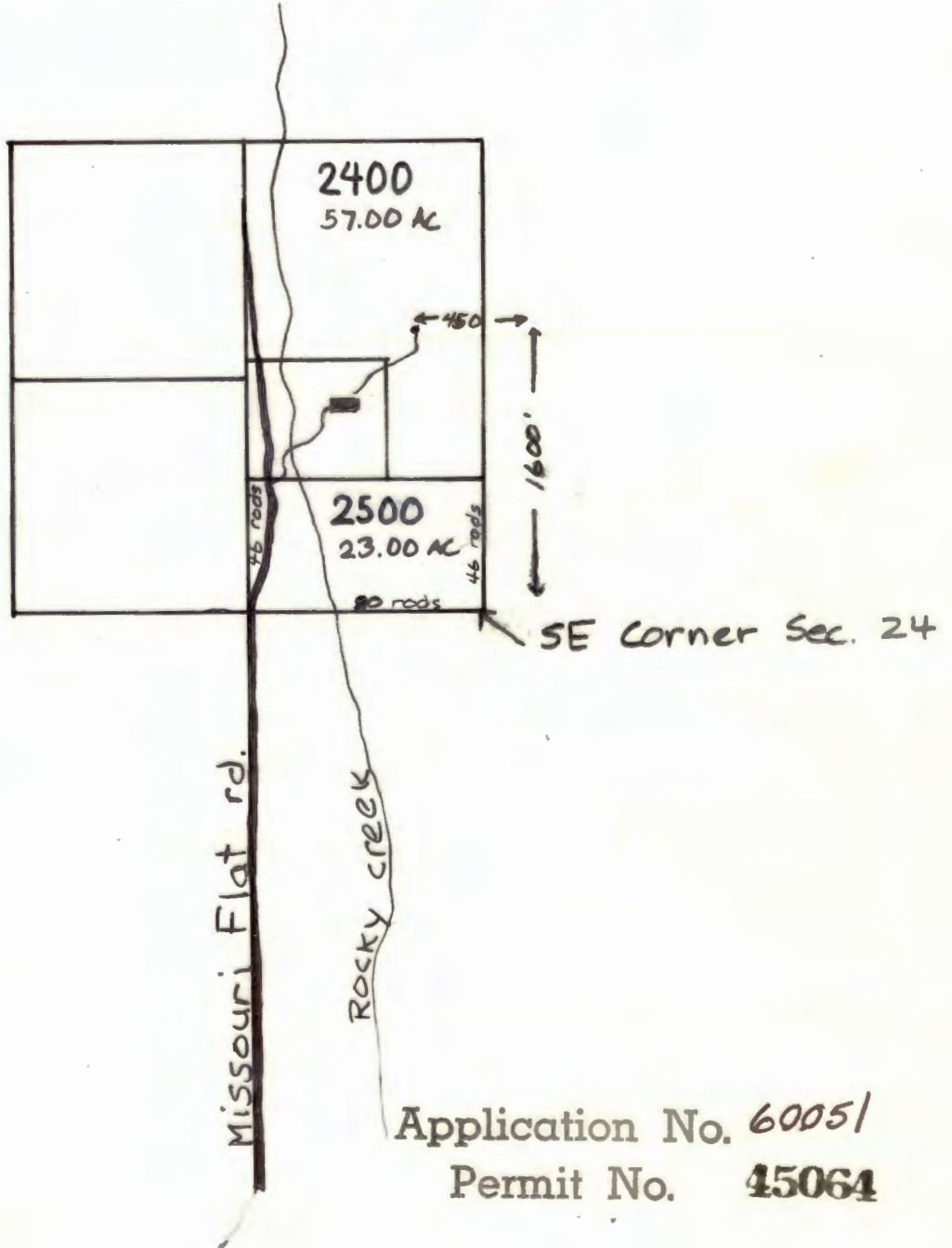

Application No. 60051

Permit No. 45064

RECEIVED
APR 11 1980
WATER RESOURCES DEPT
SALEM, OREGON