

Application No. 1122
Permit No. 524
Certificate No. 1154

Cancelled
(power only)
CANCELLED

FEES PAID		
Date	Amount	Receipt No.
Total		

Name Alice Jordan
By Grants Pass, Ore.
Address Grants Pass, Ore.
Date filed _____
Action suspended until _____

Stream Index, Page No. _____
Application Record, Book No. _____

MINUTE BOOK PAGE 211
Power only
1916

FEES REFUNDED		
Date	Amount	Check No.

Returned to applicant _____
Date completed _____
Date of approval _____

ASSIGNMENTS

Date	To whom	Address	Volume	Page

REMARKS

CONSTRUCTION

Date for beginning _____
Date for completion _____
Extended to _____
Date for application of water _____
Extended to _____

PROSECUTION OF WORK

Form "A" filed _____
Form "B" filed _____
Form "C" filed _____

FINAL PROOF

Blank mailed _____
Proof received _____
Date certificate issued _____
Receipt for recording fee No. _____

W.R.I.S.	
Assembled	<u>10/15/84</u> by <u>CLM</u>
Entered	_____ by _____
Verified	_____ by _____

MIA

S-1'223

STATE OF OREGON
COUNTY OF JOSEPHINE
CERTIFICATE OF WATER RIGHT

THIS CERTIFICATE ISSUED TO

GREG PERDUE
7833 LOWER RIVER ROAD
GRANTS PASS, OR 97526

confirms the right to use the waters of EWE CREEK, a tributary to the ROGUE RIVER for IRRIGATION of 13.0 ACRES.

This right was perfected under permit S-524. The date of priority is DECEMBER 8, 1910. The amount of water to which this right is entitled is limited to an amount actually used beneficially, and shall not exceed 0.16 CUBIC FOOT PER SECOND, or its equivalent in case of rotation, measured at the point of diversion.

The point of diversion is located as follows:

Twp	Rng	Mer	Sec	Q-Q	Measured Distances
36 S	7W	WM	13	NE SE	1180 FEET SOUTH AND 590 FEET WEST FROM THE EAST 1/4 CORNER, SECTION 13

The use shall conform to such reasonable rotation system as may be ordered by the proper state officer.

A description of the place of use is as follows:

Twp	Rng	Mer	Sec	Q-Q	Acres
36 S	7 W	WM	13	NE SE	13.0

The quantity of water diverted at the new point of diversion shall not exceed the quantity of water available from the original point of diversion as follows:

Twp	Rng	Mer	Sec	Q-Q
36 S	6 W	WM	18	SW NW

When required by the Department, the water user shall install and maintain headgate, in-line flow meter, weir, or other suitable devices for measuring and recording the quantity of water diverted. The type and plans of the headgate and measuring device must be approved by the Department prior to beginning construction and shall be installed under the general supervision of the Department.

Water shall be acquired from the same source as the original point of diversion.

NOTICE OF RIGHT TO PETITION FOR RECONSIDERATION OR JUDICIAL REVIEW

This is an order in other than a contested case. This order is subject to judicial review under ORS 183.482. Any petition for judicial review must be filed within the 60-day time period specified by ORS 183.482. Pursuant to ORS 183.482, ORS 536.075 and OAR 137-003-0675, you may petition for judicial review and petition the Director for reconsideration of this order. A petition for reconsideration may be granted or denied by the Director, and if no action is taken within 60 days following the date the petition was filed, the petition shall be deemed denied.

The water user shall maintain and operate fish screening as required by the Oregon Department of Fish and Wildlife to prevent fish from entering the diversion.

The right to the use of the water for the above purpose is restricted to beneficial use on place of use described.

This certificate is issued to confirm a change in POINT OF DIVERSION approved by an order of the Water Resources Director entered September 27, 2001, at Special Order Volume 55, Page 1036, approving Transfer Application T- 8365, and together with Certificate 77736, supersedes Certificate 1154, State Record of Water Right Certificates.

Issued **AUG 29 2013** .



Dwight W. French
Administrator, Water Right Services, for
Phillip C. Ward, Director
Oregon Water Resources Department

Map of the Jordan Pipe Line.

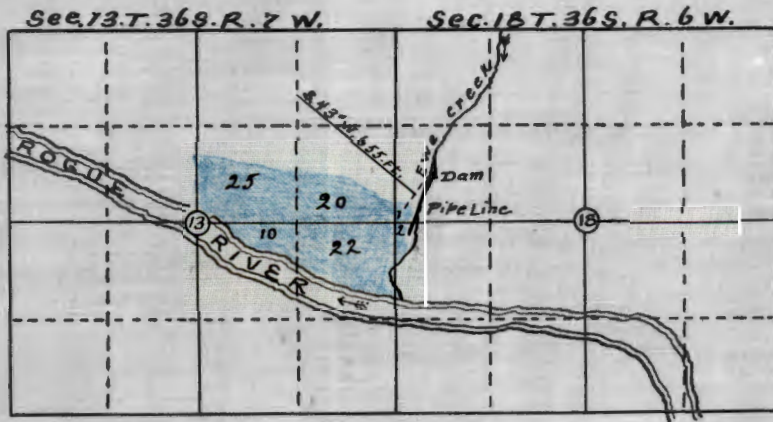

I, Horace C. Hall, of Grants Pass, Oregon, do hereby certify that this map was made from notes taken during an actual survey made by me on December 8, 1910, and that it correctly represents the works described in the accompanying application, together with the location of streams in the immediate vicinity, and has written thereon the area in each smallest legal subdivision which it is proposed to irrigate,

Horace C. Hall
Surveyor,

Application No. 1122
Permit No. 524

OFFICE OF SURVEY ENGINEER
RECEIVED
DEC 8 1910

Annual Statement of Water Power Claimant

Required by Chapter 236, Session Laws of 1911

I conclude this application is abandoned. The property has been sold and no work has been done on the proposition - Wall.

Name of Claimant Alice Jordan,

P. O. Address Grants Pass, Josephine County, Oregon.

Stream from which appropriation is claimed Ewe Creek, a tributary of Rogue River

Date of Initiation of Right December 8, 1910

Maximum Amount of Water Claimed..... Sec. Ft.

Total Average Fall Utilized 10 Ft.

Total Number of Theoretical H. P. Claimed..... 5 Horsepower. ✓

Total Power Developed..... Horsepower.

Location of Point of Diversion from Stream SW NW Sec. 16 Tp. 36 S R. 6 W

Location of Point at Which Water is Returned..... Sec. Tp. R.

Manner of Developing Power turbine wheel

Use to Which Power is Applied domestic use

If Storage Is Used:

Location of Reservoir, Secs., Tp. R.

Capacity of Reservoir, Acre Feet.

Stream from Which Reservoir is Filled.....

Date of Initiation of Storage Right.....

Area of Reservoir, Acres.

Height of Dam, Feet; Mean Depth, Feet.

The foregoing statement is true to the best of my knowledge and belief.

IN WITNESS WHEREOF, I have hereunto set my hand this..... day of....., 191.....

5 H P Exempt. ✓

Claimant.

This statement, accompanied by the necessary fees, should be mailed to the State Engineer at Salem, Oregon. See law on back. Checks, drafts, or money orders should be made payable to the State Engineer.

CHAPTER 236.

AN ACT

Providing for the payment of an annual license fee to the State by claimants to the use of water for power purposes where the water was applied to power generation, and the power generated prior to the 22d day of May, 1909, with suitable penalties for failure to pay the same, and providing the manner for collecting the same. [S. B. 84.]

Be it enacted by the People of the State of Oregon:

Be it enacted by the Legislative Assembly of the State of Oregon:

Section 1. Every person, firm, corporation or association hereinafter called "claimant," claiming the right to the use of water for power development where said water was applied to the development or generation of power, and the power generated thereby prior to the 22nd day of May, 1909, shall on or before the 1st day of January, 1912, and on or before the 1st day of January of each year thereafter, pay to the State of Oregon in advance an annual license fee based upon the theoretical water horsepower claimed under each and every separate claim to water, graduated as follows, to-wit: Ten cents for each and every theoretical water horsepower up to 100, inclusive; five cents for each and every theoretical water horsepower in excess of 100 and up to and including 1,000; and one cent for each and every theoretical water horsepower in excess of 1,000; *provided, however*, upon filing the statement as hereinafter provided, the United States, or the State, or any municipal corporation, claiming the right to the use of water to any extent for the generation of power, or any other claimant to the right to use water for the generation of 25 theoretical water horsepower, or less, shall be exempted from the payment of all fees herein provided.

Section 2. The fees herein provided shall be paid to the State Engineer in advance, and shall be accompanied by a written statement showing the extent of such claim. Said statement shall set forth the name and address of the claimant; the name of the stream from which the water is appropriated or claimed for power development; a description of the forty acres, or smallest legal subdivision in which the point of diversion and point of return are located; the date of the right as

claimed; the maximum amount of water claimed expressed in cubic feet per second of time; the total average fall utilized under such claim; the manner of developing power, and the use to which the power is applied. If the regular flow is supplemented by water stored in a reservoir, the location of such reservoir, its capacity in acre-feet and the stream from which it is filled and fed, should be given, also the date of the right as as claimed, for storage purposes.

Should any claimant fail or neglect to file such statement within the time specified, or fail or neglect to pay such fees within the time specified, the fees due and payable shall be the amount specified in Section 1 of this Act increased twenty-five per cent, and the State shall have a preference lien therefor, together with interest at the rate of ten per cent per annum from date of delinquency, upon the property of the claimant used, or necessary for use, in the development of the right or claim, together with any improvements erected thereon for such development, and upon notice from the State Engineer, the Attorney General shall proceed to foreclose the lien, and collect the amount due, as herein provided, in the same manner as other liens on real property are foreclosed.

Section 3. The filing of a claim to water in excess of the amount to which the claimant is legally entitled shall not operate to vest in such claimant any right to the use of such excess water, nor shall the payment of the annual license fees, provided for herein, operate to vest in any claimant any right to the use of such water beyond the amount to which claimant is legally entitled. The filing of such claim to water shall be conclusive evidence as to the abandonment by the claimant of all rights to water for power purposes in excess of the claim as filed.

Section 4. The amount of theoretical water horsepower upon which fees shall be paid under the provisions of this Act shall be computed by multiplying the maximum amount of water claimed, expressed in cubic feet per second, by the average total fall utilized, expressed in feet, and dividing the product by 8.8.

Filed in the office of the Secretary of State, February 23, 1911.

181

9167

Proof of Appropriation of Water

(In accordance with the provisions of Chapter 216, Laws of Oregon for 1909, and the regulations of the State Water Board thereunder.)

From Cove Creek Tributary of Rogue River

1. Name Alice Jordan, assigned to Ernest E. Myland

2. Postoffice address % C.A. Rustermaier, Eugene, Ore.

3. For what purpose is water used? Irrigation

4. Did you begin the actual construction of the Jordan Pipe Line Ditch,
(or other distributing works described in said permit), on or before Jan. 28, 1912?

Alice Jordan began actual construction of said pipe line ditch in the summer of 1911.

5. Give the date of completion of such construction work Prior to Sept. 1914

6. When was all the water completely applied to the proposed use? August 1914 on the acreage noted under 7

7. The description of land given below corresponds to that found in your permit covering land to be irrigated, or, if for other purposes, the place of use. In the blank column on the right, headed "No. acres actually irrigated," fill in the number of acres you have irrigated in each of the tracts described.

Tp.	Rg.	Sec.	Forty-acre Tract	No. Acres Described in Permit	No. Acres Actually Irrigated
36 S	6 R	18	SW ¹ NW ¹	1	
			NW ¹ SW ¹	2	2
36 S	7 R	13	SE ¹ NE ¹	20	
			SW ¹ NE ¹	25	
			NE ¹ SE ¹	22	22
			NW ¹ SE ¹	10	
<p><u>There was not sufficient water to irrigate only the land as above stated. I do not know the second feet used, I the summer or 1915 was exceptionally dry, I applied the water a little late and used all the water on the acreage indicated.</u></p>					

8. During what months is water beneficially used? June, July August and September

9. State the character of the soil and kind of crops raised Sandy loam and

The crop is alfalfa.

10. Does the accompanying blue print of the map filed with your permit show correctly the location of diverting works and area of land where water is used? Not as now constructed.

11. If not, state wherein such map is in error The works were first constructed as specified in the blue print, but the original dam was washed out in 1914 in the summer of 1915. I constructed a new dam 150 feet below the original dam and took water therefrom in an open ditch on the land indicate in 7.

12. If the dimensions of your ditch or dam do not correspond to those described in your permit, state what changes have been made, giving dimensions of ditch (or other distributing works)

the ditch follows the dotted line indicating the pipe line on the blue print, to the end thereof and thence on to the land irrigated per No. 7 herein.

13. If water is used for power, mining, domestic, municipal, storage, manufacturing, or any other purpose than irrigation, give the extent and method of such use

No use except irrigation.

STATE OF OREGON, }
County of Lane } ss.

I, Ernest E. Hyland, being first duly sworn, depose and say that I have read the above and foregoing proof of appropriation of water; that I know the contents thereof; and that the facts therein stated are true.

IN WITNESS WHEREOF, I have hereunto set my hand this 17th day of June, 1916.

Ernest E. Hyland

Subscribed and sworn to before me this 17th day of June, 1916.

C. A. Wintermeier

PROOF OF APPROPRIATION

Permit No. 524

\$1.00 fee paid

OFFICE OF STATE WATER BOARD
RECEIVED

AUG 14 1916

SALEM, - OREGON.

Approved:



NOTICE OF BEGINNING OF CONSTRUCTION

I, Dan W. Jordan, agent, the holder of Application No. 1122, being Permit No. 624, issued by the State Engineer of the State of Oregon for the appropriation of 4.4 second feet of the waters of Ewe Creek in accordance with the tenor of such permit and the limitations endorsed thereon by the State Engineer, began the actual construction of the works described thereon by the application of water to a beneficial use on the 1st day of Oct, 1911, being within the time limitation as fixed in said permit for the beginning of construction work,

The appropriator should state the manner of beginning construction work, number of men and teams employed, the amount of work completed up to the date of this statement, and any additional information which may be desired to show the beginning of work in good faith.
Work on ditch leading from creek to land, three men about three weeks

IN WITNESS WHEREOF, I have hereunto set my hand this 2 day of Nov

Grant, Ross Oregon
(Present Address)

Alice W. Jordan
(Signature of Applicant)
Dan W. Jordan (agent)

Fill out, detach, and mail to the Secretary, Board of Control, Salem, Oregon.

SALEM, OREGON
MAR 28 1912
RECEIVED
OFFICE OF BOARD OF CONTROL

Jan 18-12
" 13
" 15
Permit No. 624
Application No. 1122

NOTICE OF PROSECUTION OF WORK WITH DILIGENCE

Form D

Alice W. Jordan, holder of Application No. 1122, being holder of Permit No. 624, issued by the State Engineer of the State of Oregon, for the appropriation of 4.4 second feet of the waters of Ewe Creek have, during the year beginning Jan 28, 1912, and ending 1/28, 1913, expended twenty five dollars in the construction of works for the utilization of water under the aforesaid permit. Such construction work being more particularly described as follows:

Here describe briefly the extent of construction work, such as height of dam, length of canal or flume constructed, etc., so that the Board may judge as to whether or not such work is being prosecuted with reasonable diligence as required by law.
Work on dam about 10 ft high also purchased 15 hundred of pipe for which I paid one hundred twenty five dollars

IN WITNESS WHEREOF, I have hereunto set my hand this 31 day of Dec, 1912

Geo. E. Englehart
(Present Address)

Alice W. Jordan
(Signature of Applicant)
by witness her atty in fact

Fill out, detach and mail to the Secretary, Board of Control, Salem, Oregon, on or before the expiration of one year from the date of beginning of work as fixed in your permit; also likewise for each succeeding year, until completion of works, when the notice, Form B, especially prepared for such purpose shall be used.

1/28/12-3-5
Permit No. 624
Application No. 1122

PERMIT NO. 524.

May 13th, 1922.

Mr. Roscoe Howard,
Grants Pass,
Oregon.

Dear Sir:-

Replying to your letter of May 11th with reference to your water rights on Ewe Creek under Permit No. 524, Water right Certificate 1154.

Upon examining our records I am unable to find any water right under the Rogue River adjudication or a permit from this office for the irrigation of 40 acres in the NW NW Sec. 18 Tp 36 S R 6 W with the waters of Ewe Creek.

Ewe Creek is not mentioned in the Rogue River adjudication and we have no record of appropriations prior to December 8, 1910, the priority of your water right.

Trusting you will find this satisfactory, I remain

Very respectfully,

Percy A. Cupper,

State Engineer.

RJS-L.

1122-524

Cent 1154-

Ewe Creek into Rogue River

ROSCOE HOWARD
DES CHUTES, OREGON

Grants Pass,
11 May 1922.

Hon. Percy A. Cupper,
State Engineer,
Salem, Oregon.

Dear Mr. Cupper:

Upon buying the Dixie Ranch my attorney advised me that 24 acres of the ranch, viz: 2 acres in the Northwest quarter of the Southwest quarter, Sec 18 T 36 S, 4 6 W, WM, and 22 acres in the Northeast quarter of the Southeast quarter of Sec 13, T 36 S, R 7 W, WM had a priority dating as of Dec. 8, 1910 on .3 cusec of the waters of Ewe creek, the creek that runs thru this ranch, by virtue of Permit N-524 to Ernest E. Hyland.

There has been some talk in the neighborhood that there was an earlier permit for ten acres on the Hull 40 (NW 1/4 of NW 1/4 S 18 T 36S 6 W, WM).

Will you kindly advise me whether the Dixie Ranch has a prior right to .3 cusec of the waters of Ewe creek or not.

Very truly yours,

Roscoe Howard

Application No. 1122.

October 23, 1916.

Mr. C. A. Wintermeier,
Eugene, Oregon.

Dear Sir:

Enclosed please find my official receipt No. 4756 for \$1.40, which amount was transmitted with your letter of the 21st instant together with affidavit by Ernest E. Hyland in the matter of application No. 1122, permit No. 524. The assignment has been recorded in the miscellaneous records of this office and is returned herewith.

The final water right certificate will be forwarded in the course of a few days under this permit.

Very respectfully,

John H. Lewis,
State Engineer.

RS.
Enc.

5217

La Grande Ore.
Oct 20th 16

John B. Lewis
Salem
Ore

Sir: I would like to know if Fred Brock
has first water right on Big Cabin Creek and
myself on Spring Creek and oblige
Yours truly
W. E. Waldrop

Red ^{app} 3217
Well Waldrop & 1 map

OFFICE OF STATE ENGINEER
RECEIVED
OCT 23 1916
SALEM, OREGON

Application No. 1122.

Feb. 15, 1916.

Mr. C. A. Wintersmeier,

Eugene, Oregon.

Dear Sir:

I am returning herewith affidavit of Ernest E. Hyland in regard to the ownership of the land to be irrigated under application No. 1122, permit No. 524 in the name of Alice W. Jordan. This affidavit has been recorded in the miscellaneous records of this office in accordance with the provisions of Section 6629, L. O. L. The fee for recording same is \$1.40, which amount should be forwarded to this office.

Very respectfully,

Percy A. Cupper,

Acting State Engineer.

RS.

Enc.

*Wrote for 1.40 Oct 20-16
Subst. Eng. file*

C. A. WINTERMEIER

ATTORNEY AT LAW
EUGENE, OREGON

OFFICE OF STATE WATER BOARD

Eugene, Ore. **RECEIVED**
Feb. 10th. 1916

FEB 11 1916

John H. Lewis State Engineer
 Salem Ore.

SALEM, - OREGON.

Dear Sir:

Inclosed please find affidavit of Ernest E. Hyland, who ~~was~~
wishes to make final proof of water right under Permit No. 524

Hoping the same insufficient I remain

Yours very truly,

C. A. Wintermeier

*Inclosed please find check for certified copy mailed
and received*

Application No. 1122.

July 22, 1915.

Mr. Ernest E. Hyland,
Oakridge, Oregon.

Dear Sir:

In reply to your inquiry of the 19th instant with reference to application No. 1122, permit No. 524, in the name of Alice Jordan, I beg to advise that actual construction work under this application was required to begin on or before January 28, 1912, be completed on or before January 28, 1913, and the water completely applied to the proposed use on or before January 28, 1915. Notice of beginning construction work within the required time and notice of prosecution of work with diligence up to December, 1912, has been filed, but no reports have been filed since that time.

If the water was applied to the proposed use within the time fixed in the permit, the right is undoubtedly good. On the other hand, if the work has not been completed and the water applied, it would appear that the rights thereunder have lapsed and I would suggest that a new filing be made in this office. No subsequent filings have been made on the waters of Ewe Creek. Blanks and instructions are enclosed.

If the permit is in good standing at the present time, assignments should be filed showing the transfer to you.

Very respectfully,

Percy A. Cupper,

Acting State Engineer.

PAC-RS.
Enc.

*Eme Creek, to Roger River
Sec 18-36-6W,*

Application II22

land 13-36-7W,

Oakridge Oregon

7/19 1915

John H. Lewis, State Engineer
Salem Oregon;

OFFICE OF STATE ENGINEER
RECEIVED
JUL 20 1915

Dear Sir:

SAL. EM. - - OREGON.

Referring to your letter of July 15th, I am desirous to know what right I have to the water under Alice Jordan permit # 524 issued Jan. 28th, 1911, as I have recently purchased the land described in the permit.

Alice Jordan sold the above described land to W.M. Watson dated Nov. 19 1912, also, (All water rights and privilege acquired through permit # 524 issued by State Engineer of the State of Oregon under date of Jan. 28th 1911). I have no further record of this water right.

Kindly advise me what steps to take to secure this water right, and if necessary to make application, please send me the proper blanks, also I would appreciate the Oregon water laws.

Thanking you in advance, I am

Very truly yours

Ernest E. Byland.

OFFICE OF STATE ENGINEER
RECEIVED
JUL 21 1915
SAL. EM. - - OREGON.

*a-1122-P524
granted Jan 28-11
begin Jan 28-12
comp Jan 28-13
water Jan 28-15*

*Notice begun 80 acres
" Prosecution. Down use 5 H.P. for*

Application No. 1122.

July 15, 1915.

Mr. Ernest E. Hyland,

Oakridge, Oregon.

Dear Sir:

In reply to your inquiry of the 13th instant you are advised that Alice Jordan has secured a permit from this office to appropriate 4.40 cu. ft. of water from Ewe Creek for the development of 3 horsepower and for the irrigation of 3 acres of land in Section 18, and 77 acres of land in the $9\frac{1}{2}$ of the $NE\frac{1}{4}$ and the $E\frac{1}{2}$ of the $SE\frac{1}{4}$ of Section 13, T. 36 S., R. 6 W. The point of diversion is located in the $SW\frac{1}{4}$ of the $NW\frac{1}{4}$ of Sec. 18, T. 36 S., R. 6 W.

Very respectfully,

Percy A. Copper,

MC-RS.

Acting State Engineer.

Oakridge Oregon
July 13th 1915

State Engineer
Salem Oregon
Dear Sir:-

Is there any water right
for irrigation filed on Ewe Creek
in Josephine County, eight miles
below Grants Pass on the Rogue
river in ^{SW NW Sec} sec 18 - T. P. 36 South range
6. west.

Very truly yours
Evelyn Byland
Oakridge Oregon.

A 1122
P-524

Chic Jordan of Grants Pass
Irr & Power 4.50 cu ft.
filed Dec 8 - 1910
granted Jan 28 - 1911.
beg Jan 28 - 12
comp Jan 28 - 13
water Jan 28 - 15

3 @ m Sec 18-366
17701 ~~2440113~~
N 9 10
12294 11/3-36

OFFICE OF STATE ENGINEER
RECEIVED

JAN 13 1915
SAL. FM. . . OREGON.

Form P filed
"

Application No. 1122.

February 17, 1911

113a

Mr. Horace C. Hall,
Grants Pass, Oregon.

Dear Sir,-

I am in receipt of Application No. 1122, by Alice Jordan, being Permit No. 524. The proper records have been made in this office, and I am returning the same herewith.

Thanking you for your kindness in this matter, I remain,

Very respectfully,

State Engineer.

PAC/ME

1122

TWENTY YEARS' EXPERIENCE
IN IRRIGATION AND MINING

HORACE C. HALL
ENGINEER SURVEYOR

OFFICE
ROOM 210 ALBERT BLOCK
OPPOSITE POSTOFFICE

113a

OFFICE OF STATE ENGINEER
RECEIVED
FEB 16 1911

Grants Pass, Ore. Feb. 15, 11

John H. Lewis,
State Engineer,
Salem. Ore.

Dear Sir:- I herewith enclose application for water
right by Alice Jordan, in compliance with your request.

I notice that corrections have been made in your office in
sections 4 & 5, that is "NW" written with a pen in place of "SW"
etc. I do not understand the corrections as they appear to be cor-
rect as originally written.

Respectfully,

Horace C. Hall

BEWKE BOND

Application No. 1122.

113^a

February 3, 1911.

Mr. Horace C. Hall,

Grants Pass, Oregon.

Dear Sir,-

I find that Application No. 1122, in the name of Alice Jordan, being Permt No. 524, was not properly recorded and entered on the records of this office before being returned to you.

I would appreciate it if you would kindly return this permit for the necessary notations on our office records.

Very respectfully,

State Engineer.

PAC/MM

Application No. 1122.

January 31, 1911.

113a

Mr. Horace C. Hall,

Grants Pass, Oregon.

Dear Sir,-

Enclosed herewith please find Application No. 1122, by Alice Jordan, approved, being Permit No. 524, together with one blue print map, and my personal check for \$5.00, being excess fees paid on this application.

Very respectfully,

State Engineer.

PAC/MDM
Incl.

Application No. 1122

#113a

12/7/10

Mr. Horace C. Hall,

Grants Pass, Ore.

Dear Sir:-

Your letter of the 8th inst. enclosing Application No. 1122 for permit to appropriate water from Ewe Creek, in the name of Alice Jordan, together with P. O. money order for \$21.25 to be applied as fees on same, is hereby acknowledged.

Maps in connection with this are also received.

This application will be examined as soon as the same can be reached, and you will be advised further in regard to it.

Very respectfully,

LA

State Engineer.

TWENTY YEARS' EXPERIENCE
IN IRRIGATION AND MINING

HORACE C. HALL
ENGINEER SURVEYOR

1122

OFFICE
ROOM 210 ALBERT BLOCK
OPPOSITE POSTOFFICE

OFFICE OF STATE ENGINEER
RECEIVED
DEC 8 1910

Grants Pass, Ore. Dec. 8, '10.

John H. Lewis,
State Engineer,
Salem, Oregon.

Dear Sir:- I herewith enclose application for
water right for the Jordan pipe line, also draft for \$21.25
filing fees. Please make returns to me.

Respectfully,

Horace C. Hall

113a

C. A. WINTERMEIER
ATTORNEY AT LAW
EUGENE, OREGON

Eugene 8-15-16

State Water Board
Salem, Ore.
Gentlemen:

Inclosed please find P. O. Order in sum of \$1.00
filing fee in Matter of Permit No. 524 of Ernest E. Hyland.

Yours very truly,

C. A. Wintermeier

OFFICE OF STATE WATER BOARD

RECEIVED

AUG 16 1916

SALEM, OREGON.

October 20, 1916.

Mr. C. A. Wintermeier,
Eugene, Oregon.

Permit No. 524.

Dear Sir:

In reply to your letter of the 19th instant in regard to affidavit of ownership under application No. 1122, permit No. 524, you are advised that the letter of the State Engineer dated February 15, 1916, was in error in stating that the assignment had been recorded. It is the custom of that office upon receipt of an assignment or affidavit for record in the miscellaneous records to stamp the same as received on a certain date, and if the fee for recording same was not received, to hold the assignment or affidavit until the fee had been paid. In this case it appears that the affidavit was stamped up as received on a certain date and was again handed to the clerk to write for fees. The Clerk returned the affidavit with the statement that the same had been recorded in the miscellaneous records and asked for \$1.40 fees. I believe you will find that the recording stamp was not signed.

Therefore, if you will return the affidavit together with the \$1.40, the fee provided by law for recording the affidavit, the record will be made and the affidavit returned to you. Upon the recording of the affidavit the water right certificate will be issued in the name of Ernest Hyland.

Trusting you will find this satisfactory and will overlook the error, I am,

Very respectfully,

RS.

M. F. Mera, Secretary.

C. A. WINTERMEIER
ATTORNEY AT LAW
EUGENE, OREGON

Eugene, Ore. 10-19-16.

State Water Board,
Salem, Ore.
Gentlemen:

Application No. 1122 Permit No. 524

Replying to your letter of 12th inst. will state that there must be some mistake in the above entitled matter. Prior to Feb. 15th 1916 I took up the matter with the board with reference to the right of Ernest Hyland to make final application for per, it and was informed that an affidavit was necessary to make the showing in the absence of the formal assignment from Alice Jordan to Ernest Hyland of the water right aforesaid. This affidavit was furnished and duly recorded on the 15th day of Feb. 1916 and returned to me and is now in my possession. The record of which will be found in your office. ~~The first six papers~~ The papers for making final proof were then forwarded to me for execution, and are in your possession at this time. Will you please verify with reference to the affidavit, and then advise me. This affidavit ~~may~~ or the record of it must have been overlooked as my understanding of the matter was to the effect that it was sufficient. Awaiting your further wishes I beg leave to remain

Yours very truly,

C. A. Wintermeier

1122-524

Feb 15-16

CLERK OF THE WATER BOARD
RECEIVED

OCT 20 1916

SALEM, OREGON

October 12, 1916.

Mr. C. A. Wintermeier /

Eugene, Oregon.

Dear Sir:-

In preparing to issue certificate of water right under permit No. 524 which is in the name of Alice Jordan, I find there is no record evidence in the office of the State Engineer, as provided by law, showing this permit has been assigned to Ernest E. Hyland.

If it is impossible to secure an assignment from Alice Jordan to Mr. Hyland an affidavit should be of record in the office of the State Engineer to the effect that it is impossible to locate Alice Jordan, the original permittee, and that Mr. Hyland is now the legal owner of the land and water right.

The fee for recording such an instrument is \$1.00 for the first one hundred words and 10¢ additional for each one hundred words additional. Immediately upon the filing of such an instrument certificate will be issued in the name of Ernest E. Hyland.

Kindly attend to this matter at your very earliest convenience.

Very respectfully,

Secretary.

(Copy to Ernest E. Hyland)

August 14, 1916.

Mr. C. A. Wintermeier.

Eugene, Oregon.

Dear Sir:-

Proof of appropriation of water under permit No. 524 of Ernest B. Hyland, has been received and filed in this office.

This proof appears to be in proper form and upon receipt of the \$1.00 recording fee as required by law, the matter will be presented to the State Water Board at its next meeting for approval and issuance of certificate.

Very respectfully,

Secretary.

GB.

C. A. WINTERMEIER

ATTORNEY AT LAW
EUGENE, OREGON

Eugene, Ore. 8-12-16

State Water Board,
Salem, Ore.

Gentlemen:

Inclosed please find Proof of Appropriation of water In the
Matter of Water Permit No. 525 Application No. 1122 Alice Jordan Orig
inal applicant and a signed to Ernest E. Hyland,

Yours very truly,

C. A. Wintermeier

August 16, 1916.

Mr. C. A. Wintermeier.

Eugene, Oregon.

Dear Sir:-

I am in receipt of yours of the 15th., inclosing
money order for \$1.00, recording fee in connection with permit
No. 524 of Ernest E. Hyland.

Very respectfully,

Secretary.

GB.

June 3, 1916.

Mr. Ernest E. Hyland,
c/o C. A. Wintermeier,
Eugene, Oregon.

Dear Sir:

I note from the records of this office that final proof blanks were forwarded you for execution on Feb. 15, 1916, upon which to submit final proof under permit No. 534 in the name of Alice W. Jordan. Up to this time we have not received final proof under this permit.

We are endeavoring to clear the records of this office of all old filings and would be glad to receive final proof under this permit in order that a final water right certificate may be issued.

Very respectfully,

RS.

M. F. Mers, Secretary.

SUBJECT:

STATE OF OREGON
Application No. 1122.

OFFICE OF THE
STATE ENGINEER

JOHN H. LEWIS, STATE ENGINEER
PRESIDENT OF THE STATE WATER BOARD
SECRETARY OF THE DESERT LAND BOARD

PERCY A. CUPPER
ASSISTANT STATE ENGINEER

SALEM, OREGON, Feb. 11, 1916.

State Water Board,
Building.

Gentlemen:

At the request of Mr. Ernest E. Hyland,
at present owner of the land formerly owned by
alice ~~alise~~ W. Jordan, we have cancelled the power right
under application No. 1122, permit No. 524, but
the right for irrigation is still retained by
the owner of this land.

Very respectfully,

John H. Lewis
John H. Lewis,

RS.

State Engineer.

Cancelled

Power only

L. A.

February 15, 1916.

Ernest E. Hyland,
c/o C. A. Wintermeier,
Eugene, Oregon.

Dear Sir:-

I am inclosing blank for proof of appropriation of water under permit No. 524 which you will please fill out and return to this office, together with \$1.00 to cover recording fee.

Upon receipt of this proof, properly executed, the matter will be presented to the State Water Board at its next meeting for approval and issuance of certificate.

Very respectfully,

Secretary.

RS.

Application No. 1122

Feb. 9, 1916.

Mr. C. A. Wintermeier,
Eugene, Oregon.

Dear Sir:

Complying with your request of the 8th instant to the State Water Board, I am enclosing a certified copy of application No. 1122, permit No. 524, in the name of Alice W. Jordan. The fee provided by law for furnishing this certified copy is \$1.50.

Final proof blanks will be forwarded from the Office of the State Water Board upon receipt of affidavit as to the ownership of this land.

Very respectfully,

John H. Lewis,

RS.

State Engineer.

Enc.

C. A. WINTERMEIER
ATTORNEY AT LAW
EUGENE, OREGON

1122
Eugene, Ore. Feb. 8th. 1916

State Water Board,
Salem, Ore.

Gentlemen:

Water Permit No. 524

Mr. Ernest Hyland wishes to make final proof on the above permit. The record is irregular in that the assignment of the right is not recorded at Salem, but is contained in a certain deed executed by Alice W. Jordan. Mr. Hyland is now the owner of the land and the water right. Will you please make and forward me a certified copy of the ~~NEK~~ application of Alice W. Jordan so that Mr. Hyland can confine his proofs to the application. because he has used all the water in the creek.

If you let me know the cost of the copy by return mail I will forward the same so as not to delay the matter.

Yours very truly,

C. A. Wintermeier

Permit No. 524.

Feb. 5, 1916.

Mr. Ernest S. Hyland,
Box 484,
Eugene, Oregon.

Dear Sir:

In reply to your letter of the 4th instant I note that you now own the land formerly owned by Alice W. Jordan for which a water right under permit No. 524 was secured, and that you are unable to locate Alice W. Jordan in order to secure an assignment of the same. It is probable that the Board will allow you to make final proof under this permit if you will make an affidavit and file the same in this office showing that you own by purchase from Alice W. Jordan the following land for which a water right was secured under application No. 1112, permit No. 524:

1 A SW NW
2 NW SW Sec. 18, T. 36 S. R. 6 W.
20 SE NE
25 SW NE
22 NE SE
10 NW SE, Sec. 13, T. 36 S. R. 7 W.

I will call your attention to the fact that final proof need not be made for all this land unless the same has been irrigated according to the terms of the permit, which required that construction work should begin on or before Jan. 28, 1912, be completed on or before Jan. 28, 1913, and the water completely applied to the proposed use on or before Jan. 28, 1915. Under this permit a right was also secured for the use of 3.4 second feet of water for the development of 5 horsepower. If this right was not developed under the terms of the permit, we would be glad to have you authorize the cancellation of the power right, which cancellation would not interfere with the right for irrigation purposes.

I trust this will give you the desired information and that you will be able to submit proof under this permit.

Very respectfully,

RS.

M. P. Hors, Secretary.

ELKS' CLUB
EUGENE, OREGON

Permit #524

Feb 4th 1916
OFFICE OF STATE WATER BOARD
FEB 5 1916
SALEM, OREGON.

State Water Board
Salem Oregon.

1112-524

Gentlemen:

Yours of the 29th Ult, received.

I own the Alice W. Jordan lands near
Grant Pass Oregon, but have been
unable to locate Mrs. Jordan to secure
her assignment of this water right, but
I am desirous to securing same, I am
using the water to irrigate the said land
and would like very much to secure
a permit for same. What steps shall I
take.

Thanking you in advance for any
information, I am as ever yours

Ernest O. Ryland.

Box 484 Eugene, Ore.

Permit No. 524.

Jan. 29, 1916.

Mr. Ernest E. Hyland,
Oak Ridge, Oregon.

Dear Sir:

I am informed that you are the present owner of the land near Grants Pass formerly owned by Alice W. Jordan. Alice W. Jordan secured permit No. 524 for the use of the water from Ewe Creek for the irrigation of 80 acres of this land and for the development of 5 horsepower. Under the terms of this permit construction work was required to begin on or before January 28, 1912, be completed on or before January 28, 1913, and the water completely applied to the proposed use on or before January 28, 1915.

If the terms of this permit have been complied with and you desire to make final proof on same, you should secure an assignment of this water right from Alice W. Jordan and file the same in this office. The fee for recording same is \$1.00 for the first 100 words and 10¢ for each additional 100 words.

However, if the terms of this permit have not been complied with, we would be glad to have you authorize the cancellation of this permit as it will eliminate the necessity of following the regular procedure for the cancellation of the same.

Please let us hear from you with reference to this matter.

Very respectfully,

RS.

W. F. Nera, Secretary.

JOHN H. LEWIS, STATE ENGINEER
PRESIDENT OF THE BOARD, SALEM
JAMES T. CHINNOCK
SUPERINTENDENT WATER DIVISION No. 1, SALEM
GEO. T. COCHRAN
SUPERINTENDENT WATER DIVISION No. 2, LA GRANDE

M. F. MERS, SECRETARY

STATE OF OREGON

OFFICE OF THE
STATE WATER BOARD

Permit No. 524.

SALEM, OREGON, Jan. 27, 1916

OFFICE OF THE STATE WATER BOARD
RECEIVED
JAN 29 1916

SALEM, OREGON.

County Assessor,

Grants Pass, Oregon.

Dear Sir:

Will you please give me the name and present address of the present owner or owners of the Alice W. Jordan place as follows; 1A SW NW, 2 A NW SW, Sec. 18, S $\frac{1}{2}$ NE, N $\frac{1}{2}$ SE, Sec. 13, T. 36 S. R. 7 W.?

Very respectfully,

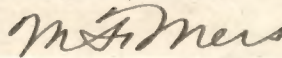

M. F. Mers, Secretary.

RS.



Grants Pass, Or. Jan. 28, 1916

Dear Sir:

Our records show the above described property to belong to ERNEST E. HYLAND, Oak Ridge, Oregon.

Yours very truly,

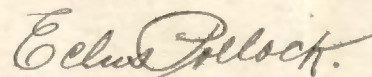

Assessor.

Permit No. 524.

Jan. 27, 1916

County Assessor,

Grants Pass, Oregon.

Dear Sir:

Will you please give me the name and present address of the present owner or owners of the Alice W. Jordan place as follows: 1A SW NW, 2 A NW SW, Sec. 18, $8\frac{1}{2}$ NE, $N\frac{1}{2}$ SE, Sec. 13, T. 36 S. R. 7 W.?

Very respectfully,

RS.

M. F. Mers. Secretary.

Permit No. 524.

Dec. 29, 1915

Mr. Horace C. Hall,

Grants Pass, Oregon.

Dear Sir:

I am enclosing a letter that should be forwarded to Alice W. Jordan, or to Mr. W. A. Fuller. We are endeavoring to clear the records of this office of all uncompleted permits and would like to have the holder of the permit to authorize the cancellation of the same if the water has not been used according to the terms of the permit. If you know the address of Alice W. Jordan, please forward the letter to her. Stamp is enclosed.

I am writing you in this matter because your name appears as witness on the application.

Very respectfully,

RS.

M. F. Hersh, Secretary.

Encs.

Permit No. 524.

Dec. 18, 1915.

Alice W. Jordan,
c/o W. A. Fuller,
Grants Pass, Oregon.

Dear Madam:

I note from the records of this office that you have not filed notice of complete application of water to beneficial use under your permit No. 524 issued by the State Engineer. As the time for the complete application of water expired Jan. 28, 1915, and no extension of time has been requested, we presume you have abandoned your water right, and if so, we would be glad to have you authorize the cancellation of the permit on the records of this office. However, if you have not abandoned the permit, final proof blanks will be forwarded you upon receipt of notice of complete application of water, form for which is enclosed.

Please let us hear from you with reference to this matter.

Very respectfully,

RS.

M. P. Mers, Secretary.

Form C enclosed.

Grant Pass

December 4, 1913.

Alice Jordan,

Grant Pass, Oregon.

Dear Madam:-

In accordance with the provisions of Section 6576 L.O.L. and the order of the State Water Board fixing the rate of payment at $12\frac{1}{2}\%$ per theoretical horsepower per annum, you should forward to this office on or before January 2, 1914, fees in the sum of \$1.21, for power development under your Permit No. 524. The time for completion of your plant expired Jan. 28, 1913, hence \$.58 of the above amount is for the year 1913, and the balance for 1914.

Very respectfully,

Secretary.

BOARD OF WATER COMMISSIONERS
STATE OF OREGON

JOHN H. LEWIS, STATE ENGINEER
PRESIDENT OF THE BOARD
SALEM, OREGON

JAMES T. CHINNOCK
SUPERINTENDENT WATER DIVISION No. 1
SALEM, OREGON

GEO. T. COCHRAN
SUPERINTENDENT WATER DIVISION No. 2
LA GRANDE, OREGON

M. F. MERS
SECRETARY

STATE OF OREGON
BOARD OF CONTROL

SALEM, OREGON _____